

GENERAL INDEX

FOR DETAILED INDEX OF PLANS SEE SHEET NO. 2

| DESCRIPTION | NUMBER OF SHEETS |
|--------------------------------|------------------|
| TITLE SHEET | 1 |
| DETAILED INDEX | 1 |
| GENERAL NOTES | 1 |
| TYPICAL SECTIONS | 3 |
| QUANTITIES | 5 |
| PLAN AND PROFILES | 5 |
| SPECIAL DESIGN - ROADWAY ITEMS | 29 |
| BRIDGE DRAWINGS | |
| SPECIAL DESIGN - BRIDGES | 49 |
| CROSS-SECTIONS | |
| TOTAL SHEETS | 94 |

06-16-04

STATE OF MISSISSIPPI

MISSISSIPPI DEPARTMENT OF TRANSPORTATION

PLAN AND PROFILE OF PROPOSED STATE HIGHWAY STATE PROJECT NO. STP-0061-01(008)

MISS. SR. 7 AT US OLD 49W HUMPHREYS

103043/301000

SCALES

| | |
|------------------|-----------------------------|
| PLAN | 1 IN. = 100 FT. |
| PROFILE { | HOR. 1 IN. = 100 FT. |
| | VERT. 1 IN. = 10 FT. |
| LAYOUT | 1 IN. = 887.39 FT. |

| FED. ROAD REG. NO. | STATE | PROJECT NO. | SHEET NO. |
|--------------------|-------|------------------|-----------|
| 4 | MISS. | STP-0061-01(008) | 1 |

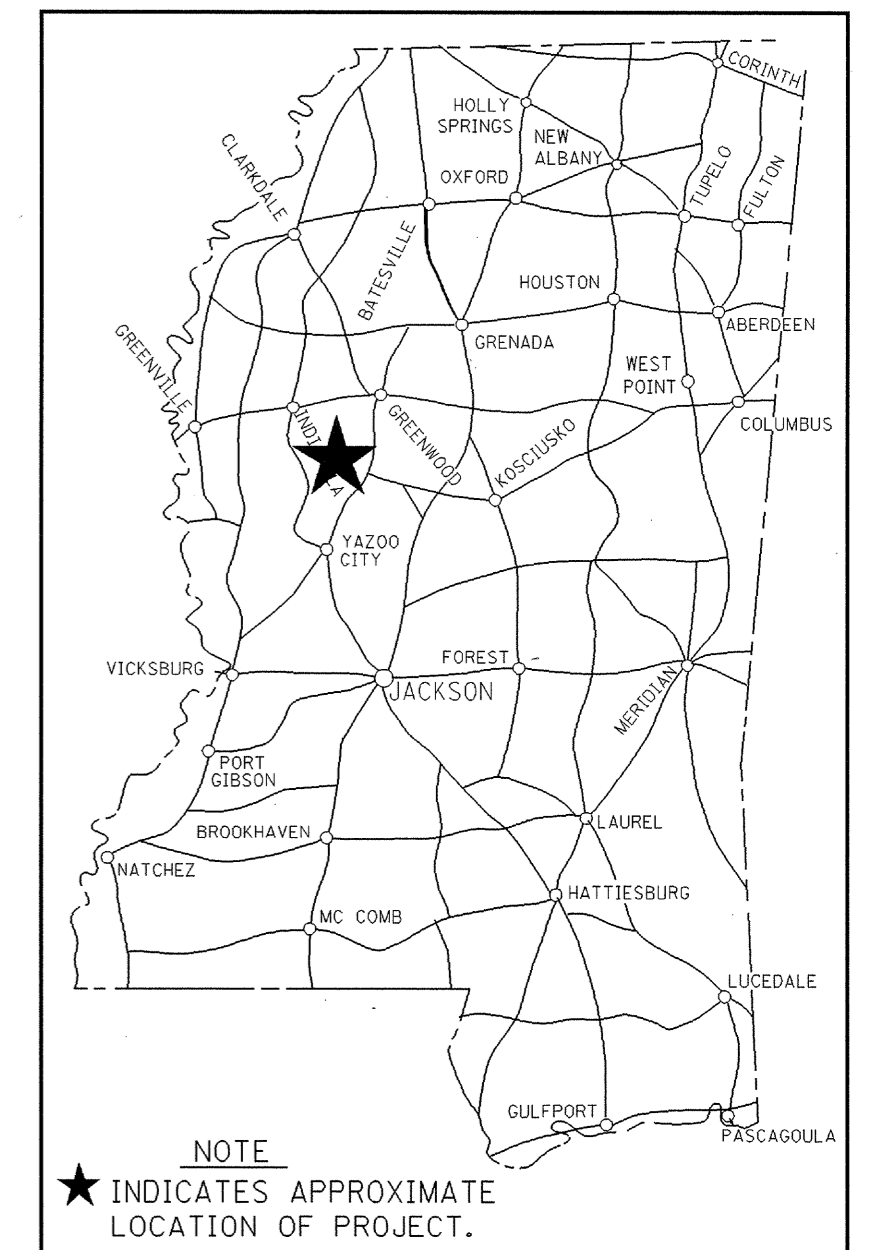

BRIDGE STRUCTURES REQ'D.

BOX BRIDGES REQ'D.

STA. 10 + 00
OLD HWY. 49W

B.O.P. STA 92 + 90.630
HWY 7

E.O.P. STA 112 + 00.000

STA. 16 + 90.604
OLD HWY. 49W

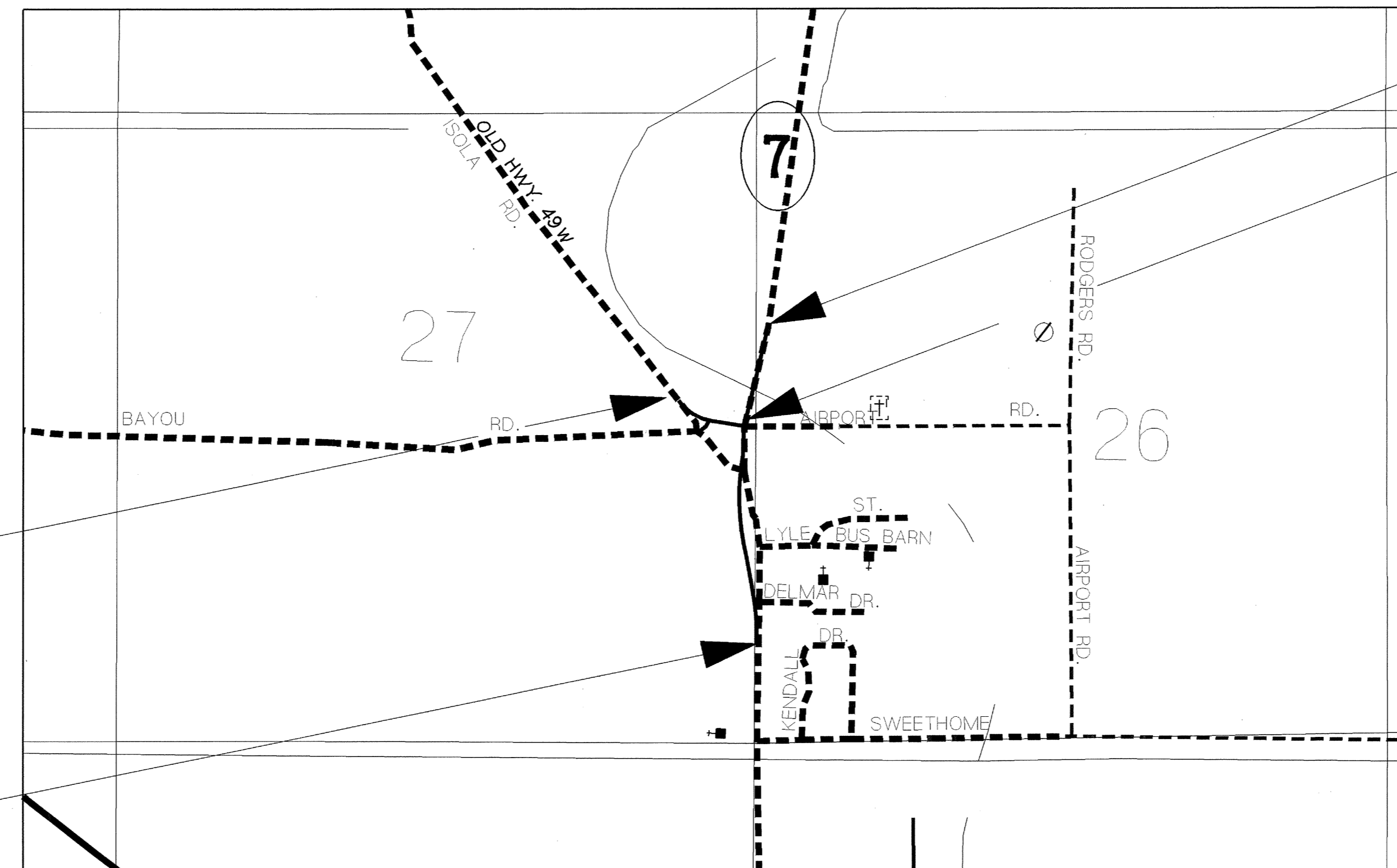

DESIGN CONTROL

65 MPH = V (SPEED DESIGN)

ADT (2004) = 1470 ; ADT (2022) = 2100

DHV = 230 ; D = 50 % T = 12 %

PERMITS ACQUIRED BY MDT

WETLANDS AND WATERS PERMITS (NECESSARY FOR ULTIMATE IMPROVEMENTS ONLY):

| P.E. NO. | STP-0061-01(008) | WATERS | WETLANDS |
|---------------------|-------------------------------------|-------------------------------------|-------------------------------------|
| NATIONWIDE #14 | <input checked="" type="checkbox"/> | <input checked="" type="checkbox"/> | <input checked="" type="checkbox"/> |
| NATIONWIDE (OTHER)* | <input checked="" type="checkbox"/> | <input checked="" type="checkbox"/> | <input checked="" type="checkbox"/> |
| GENERAL* | <input checked="" type="checkbox"/> | <input checked="" type="checkbox"/> | <input checked="" type="checkbox"/> |
| INDIVIDUAL (404)* | <input checked="" type="checkbox"/> | <input checked="" type="checkbox"/> | <input checked="" type="checkbox"/> |

* ACQUISITION OF PERMITS FOR TEMPORARY IMPACTS DURING CONSTRUCTION ARE THE RESPONSIBILITY OF THE CONTRACTOR

STORMWATER PERMIT

Y REQUIRED, CNOI SUBMITTED BY MDT (DISTRIBUTED AREA = 5 ACRES + INTB 6484)

S REQUIRED, SCNOI TO BE SUBMITTED BY CONTRACTOR (1 TO 4.99 ACRES) (INTB 6483)

N NO STORMWATER PERMIT REQUIRED (<1 ACRE)

APPROVED BY: CKP DATE: 6/16/04

CONVENTIONAL SYMBOLS

- COUNTY LINE
- TOWN CORPORATION LINE
- SECTION LINE
- EXISTING ROAD OR TRAVELED WAY
- PROPOSED ROAD OR TRAVELED WAY
- RAILROAD
- SURVEY LINE
- BRIDGES

EQUATIONS

HWY 7 STA. 107 + 75.739 BK. = STA. 103 + 46.560 AH. (+ 429.179 FT.)

LENGTH DATA

| | | | |
|----------------------------|--------------|-------|-----|
| LENGTH OF ROADWAY (HWY 7) | 2338.549 FT. | 0.443 | MI. |
| LENGTH OF ROADWAY (HWY 49) | 690.604 FT. | 0.131 | MI. |
| LENGTH OF BRIDGES | | 0.574 | MI. |
| LENGTH OF PROJECT (NET) | | 0.000 | MI. |
| LENGTH OF EXCEPTIONS | | 0.574 | MI. |
| LENGTH OF PROJECT (GROSS) | | | |

EXCEPTIONS

6.16.2004 8:33 AM TITLE.DGN RURAL ARTERIAL

APPROVED: *Harry James* 6/16/04
CHIEF ENGINEER DATE

APPROVED: *James B. ...* 06-16-04
EXECUTIVE DIRECTOR DATE

MISSISSIPPI DEPARTMENT OF TRANSPORTATION

APPROVED: _____ DATE _____
DIVISION ADMINISTRATOR

FEDERAL HIGHWAY ADMINISTRATION
DEPARTMENT OF TRANSPORTATION

1st O. REV.

| | |
|-------|------------------|
| STATE | PROJECT NO. |
| MISS. | STP-0061-01(008) |

| DESCRIPTION OF SHEET | WKG. NO. | SH. NO. | DESCRIPTION OF SHEET | REV. DATE | WKG. NO. | SH. NO. |
|-----------------------------------------------------------|----------|---------|-------------------------------------------------------------------------------------|-----------|----------|---------|
| TITLE SHEET (1) | | 1 | | | | |
| DETAILED INDEX & GENERAL NOTES (2) | | | STANDARD DRAWINGS - ROADWAY SHEETS (20) | | | |
| DETAILED INDEX | DI-1 | 2 | | | | |
| GENERAL NOTES | GN-1 | 3 | PAVEMENT MARKING DETAILS FOR 2 & 4-LANE DIVIDED ROADWAYS | 12-01-99 | PM-1 | 120 |
| TYPICAL SECTION SHEETS (3) | | | EROSION CONTROL | | EC-1 | 140 |
| TYPICAL SECTION - NEW CONSTRUCTION AND WIDENING & OVERLAY | TS-1 | 4 | TYPICAL TEMPORARY EROSION CONTROL MEASURES (SILT FENCE, HAY BALES, & BRUSH BARRIER) | | TEC-1 | 142 |
| TYPICAL SECTION - PAVED APRONS | TS-2 | 5 | TYPICAL TEMPORARY EROSION CONTROL MEASURES (SLOPE DRAIN AND TYPE A SILT BASIN) | | TEC-2 | 143 |
| TYPICAL SECTION - LANE WIDENING | TS-3 | 6 | DETAILS OF DITCH TREATMENT | | DT-1 | 145 |
| QUANTITY SHEETS (5) | | | TRAFFIC CONTROL PLAN WITH FLAGGER (ONE-LANE CLOSURE OF TWO WAY TRAFFIC) | | TCP-1 | 250 |
| SUMMARY OF QUANTITIES | SQ-1 | 7 | HIGHWAY SIGN AND BARRICADE DETAILS FOR CONSTRUCTION PROJECTS | | TCP-10 | 259 |
| SUMMARY OF QUANTITIES | SQ-2 | 8 | TRAFFIC CONTROL PLAN MOBILE OPERATIONS MULTILANE ROADS AND TWO-LANE ROADS | 12-01-99 | TCP-11 | 260 |
| ESTIMATED QUANTITIES | EQ-1 | 9 | | | | |
| ESTIMATED QUANTITIES | EQ-2 | 10 | TRAFFIC CONTROL PLAN : UNEVEN PAVEMENT DETAILS | | TCP-14 | 263 |
| ESTIMATED QUANTITIES | EQ-3 | 11 | TEMPORARY STRIPING FOR TRAFFIC CONTROL 2-LANE AND 4 LANE DIVIDED HIGHWAYS. | | TCP-15 | 264 |
| PLAN & PROFILE SHEETS (5) | | | RIGHT OF WAY MARKERS | 03-01-02 | RW-1 | 270 |
| REALIGNED HWY 7 | 3 | 12 | RURAL DRIVEWAYS | | RD-1 | 271 |
| DELMAR RD. | 3A | 13 | TYPICAL GRADING TRANSITION BETWEEN CUTS & FILLS | | GT-1 | 272 |
| LYLE RD. | 3B | 14 | SIGHT FLARES | | SF-1 | 273 |
| RELOCATE OLD HWY 49 | 4 | 15 | SUPERELEVATION TRANSITION - CASE I (2% NORMAL SUBGRADE) | 03-01-02 | SE-2A | 276 |
| COUNTY RD. ON OLD HWY 49 @ STA. 13+65.47 | 4A | 16 | DRIVEWAYS, CURB & GUTTER, & SIDEWALK | | SD-1 | 287 |
| SPECIAL DESIGN SHEETS (9) | | | PIPE CULVERT INSTALLATION | | PI-1 | 300 |
| TYPICAL TRAFFIC CONTROL PLANS | TC-1 | 17 | CONCRETE PIPE COLLAR | | PC-1 | 301 |
| TYPICAL TRAFFIC CONTROL PLANS | TC-2 | 18 | FLARED END SECTION FOR CONCRETE PIPE | | FE-1 | 328 |
| TYPICAL TRAFFIC CONTROL PLANS | TC-3 | 19 | FLARED END SECTION FOR CONCRETE ARCH PIPE | | FE-1A | 329 |
| TYPICAL TRAFFIC CONTROL PLANS | TC-4 | 20 | | | | |
| TYPICAL TRAFFIC CONTROL PLANS | TC-5 | 21 | | | | |
| PAVEMENT MARKING DETAILS | PMD-1 | 22 | CROSS SECTIONS (49) | | | 901-949 |
| INTERSECTION DETAIL | ID-1 | 23 | TOTAL SHEETS (94) | | | |
| INTERSECTION DETAIL | ID-2 | 24 | | | | |
| VEGETATION SCHEDULE | VS-1 | 25 | | | | |

7/7/2004 9:48 AM D:\INDEX.DGN MISSISSIPPI DEPARTMENT OF TRANSPORTATION ROADWAY DESIGN DIVISION

| BRELAND | | |
|----------------------------|-----------|-----|
| PS & E PLANS-DATE 06/16/04 | | |
| FMS CON. #103043 / 30100 | | |
| REVISIONS | | |
| DATE | SHEET NO. | BY |
| 7-7-04 | 5,7 | CLB |
| | | |
| | | |
| | | |

| | |
|----------------------------------------------------------------------|------------------------|
| MISSISSIPPI DEPARTMENT OF TRANSPORTATION | |
| DETAILED INDEX | |
| PROJECT NO. STP-0061-01(008) COUNTY : HUMPHREYS | WORKING NUMBER DI-1 |
| FILENAME: dindex.dgn DESIGN TEAM BRELAND CHECKED _____ DATE _____ | SHEET NUMBER 2 |