

GENERAL INDEX

FOR DETAILED INDEX OF PLANS SEE SHEET NO. 2

DESCRIPTION	NUMBER OF SHEETS
TITLE SHEET	1
DETAILED INDEX	
GENERAL NOTES	
TYPICAL SECTIONS	
QUANTITIES	
PLAN AND PROFILES	
SPECIAL DESIGN - ROADWAY ITEMS	
BRIDGE DRAWINGS	
SPECIAL DESIGN - BRIDGES	
CROSS-SECTIONS	

TOTAL SHEETS

① 09-07-04

STATE OF MISSISSIPPI

MISSISSIPPI DEPARTMENT OF TRANSPORTATION

PLAN AND PROFILE OF PROPOSED STATE HIGHWAY STATE PROJECT NO. MP-1145-41(007)

MS 145 FROM JEFFERSON ST TO MCCULLOUGH BLVD. LEE CO.

FMS CON 302767/301000

SCALES

PLAN	1 IN. = 100 FT.
PROFILE	HOR. 1 IN. = 100 FT.
	VERT. 1 IN. = 10 FT.
LAYOUT	1 IN. = FT.

BRIDGE STRUCTURES REQ'D.

B.O.P. STA. 248 + 82

E.O.P. STA. 292 + 40

BOX BRIDGES REQ'D.

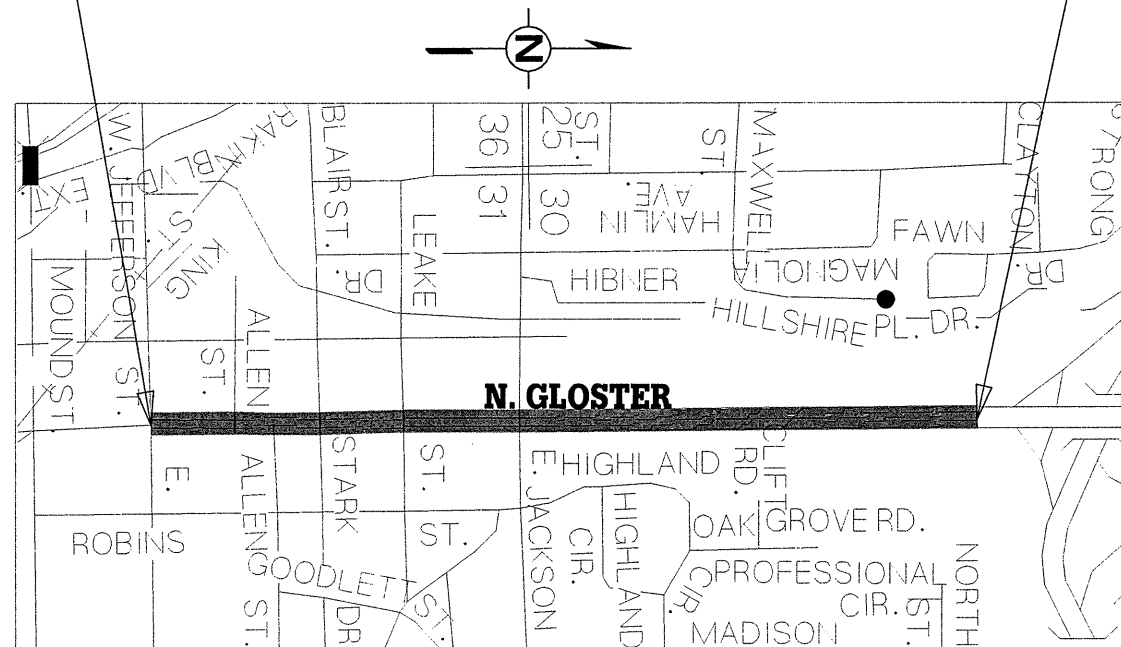

FED. ROAD REG. NO.	STATE	PROJECT NO.	SHEET NO.
4	MISS.		1

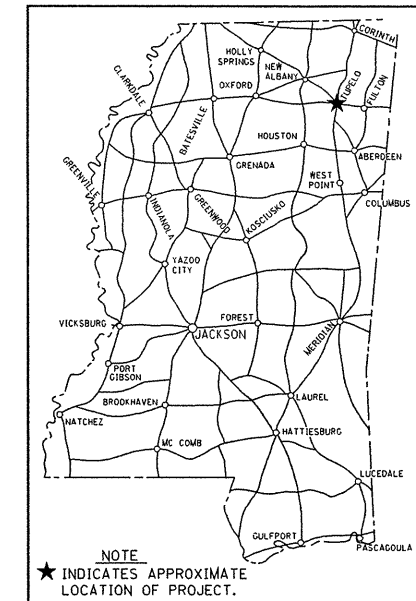

NOTE
★ INDICATES APPROXIMATE LOCATION OF PROJECT.

PERMITS ACQUIRED BY MDOT

WETLANDS AND WATERS PERMITS (NECESSARY FOR ULTIMATE IMPROVEMENTS ONLY):		
	WATERS	WETLANDS
NATIONWIDE #14	N	N
NATIONWIDE (OTHER)*	N	N
GENERAL*	N	N
INDIVIDUAL (404)*	N	N
* ACQUISITION OF PERMITS FOR TEMPORARY IMPACTS DURING CONSTRUCTION ARE THE RESPONSIBILITY OF THE CONTRACTOR		
STORMWATER PERMIT N		
Y	REQUIRED, CNOI SUBMITTED BY MDOT (DISTRIBUTED AREA = 5 ACRES +) (INTB 6484)	
S	REQUIRED, SCNOI TO BE SUBMITTED BY CONTRACTOR (1 TO 4.99 ACRES) (INTB 6483)	
N	NO STORMWATER PERMIT REQUIRED (<1 ACRE)	
APPROVED BY: <i>CKP</i> DATE: <i>9/7/04</i>		

CONVENTIONAL SYMBOLS

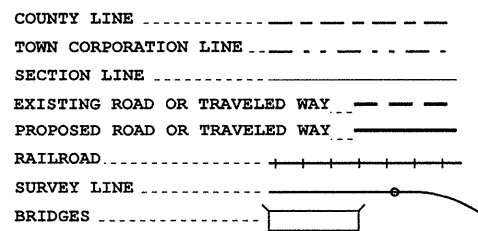

EQUATIONS

EXCEPTIONS

LENGTH DATA

LENGTH OF ROADWAY	4358 FT.	0.825 MI.
LENGTH OF BRIDGES	FT.	MI.
LENGTH OF PROJECT (NET)		0.825 MI.
LENGTH OF EXCEPTIONS	FT.	MI.
LENGTH OF PROJECT (GROSS)		0.825 MI.

APPROVED BY:	<i>Walter L. Kame</i>	DATE:	<i>9/7/04</i>
CHIEF ENGINEER			
EXECUTIVE DIRECTOR	<i>[Signature]</i>	DATE:	<i>09-07-04</i>
MISSISSIPPI DEPARTMENT OF TRANSPORTATION			
APPROVED:			
DIVISION ADMINISTRATOR		DATE	
FEDERAL HIGHWAY ADMINISTRATION DEPARTMENT OF TRANSPORTATION			

