

GENERAL INDEX

FOR DETAILED INDEX OF PLANS SEE SHEET NO. 2

DESCRIPTION	NUMBER OF SHEETS
TITLE SHEET	1
SITE PLAN & DETAILED INDEX	1
GENERAL NOTES	
TYPICAL SECTIONS	
QUANTITIES	
PLAN AND PROFILES	
SPECIAL DESIGN - BUILDING DRAWINGS	26
BRIDGE DRAWINGS	
SPECIAL DESIGN - BRIDGES	
CROSS-SECTIONS	

TOTAL SHEETS 28

10-14-04

STATE OF MISSISSIPPI

MISSISSIPPI DEPARTMENT OF TRANSPORTATION

**PLANS OF PROPOSED
COMMISSIONER'S OFFICE BUILDING
AT TUPELO**

STATE PROJECT NO. BWO-1129-41(001)

501397/301000

LEE COUNTY

PROJECT SITE

N. GLOSTER ST.

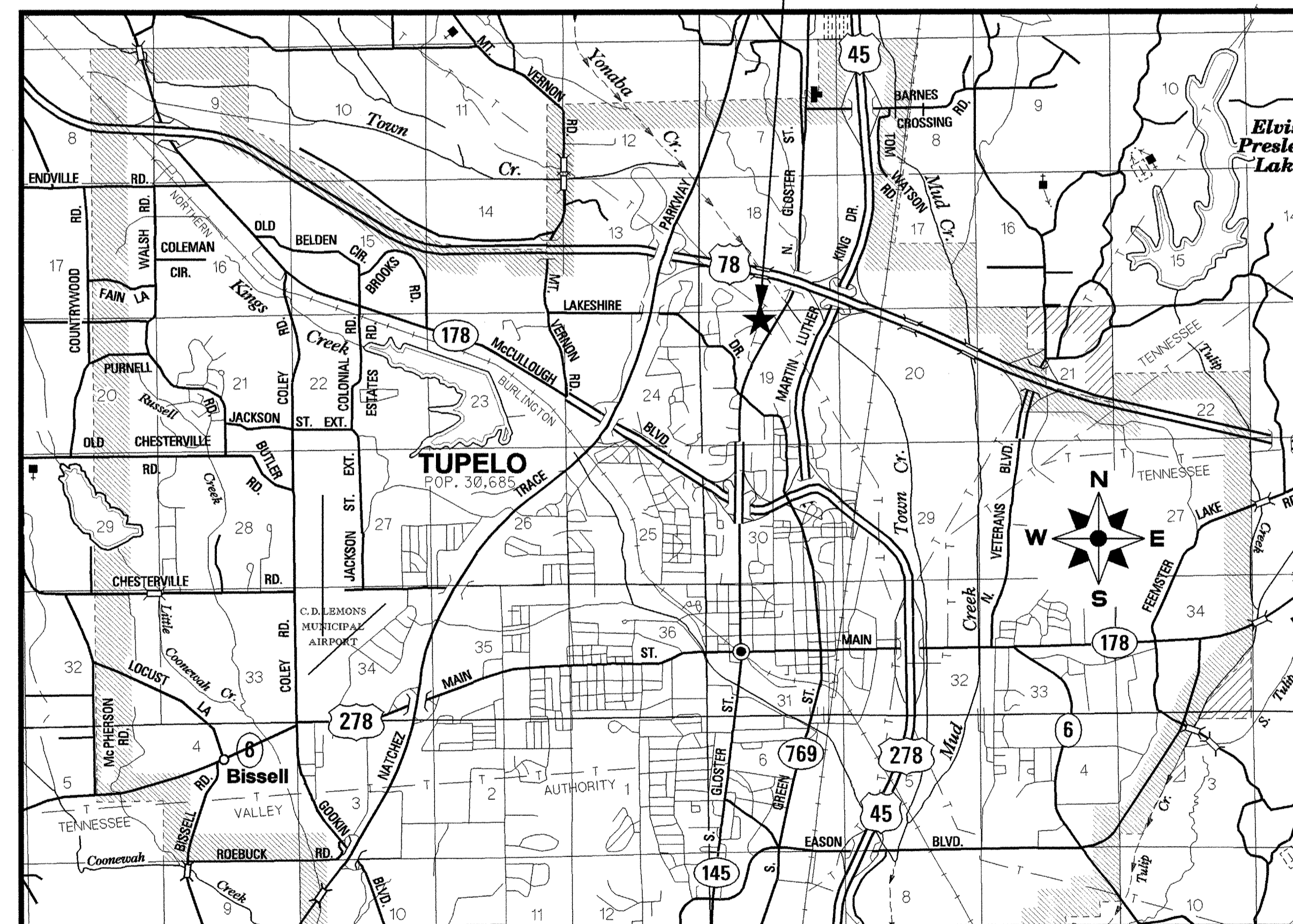

FED. ROAD REG. NO.	STATE	PROJECT NO.	SHEET NO.
4	MISS.		1

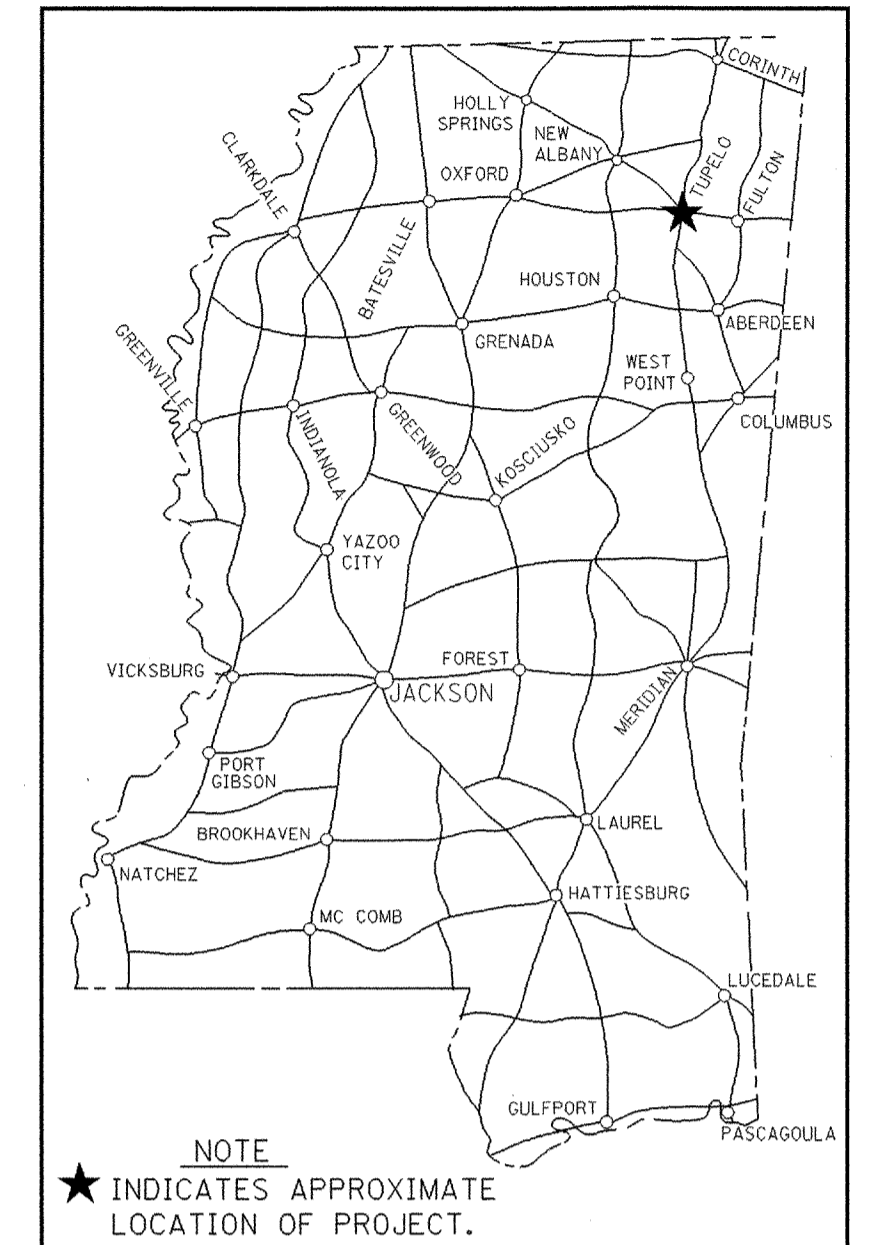

NOTE
★ INDICATES APPROXIMATE LOCATION OF PROJECT.

DESIGN CONTROL

MPH = V (SPEED DESIGN)

ADT () = : ADT () =

DHV = : D = % T = %

PERMITS ACQUIRED BY MDOT

WETLANDS AND WATERS PERMITS (NECESSARY FOR ULTIMATE IMPROVEMENTS ONLY):

	WATERS	WETLANDS
NATIONWIDE #14	N	N
NATIONWIDE (OTHER)*	N	N
GENERAL*	N	N
INDIVIDUAL (404)*	N	N

* ACQUISITION OF PERMITS FOR TEMPORARY IMPACTS DURING CONSTRUCTION ARE THE RESPONSIBILITY OF THE CONTRACTOR

STORMWATER PERMIT N

Y REQUIRED, SCNDI SUBMITTED BY MDOT (DISTRIBUTED AREA = 5 ACRES + (NTB 6484)

S REQUIRED, SCNDI TO BE SUBMITTED BY CONTRACTOR (1 TO 4.99 ACRES) (NTB 6483)

N NO STORMWATER PERMIT REQUIRED (<1 ACRE)

APPROVED BY: *[Signature]* DATE: 9-23-04

CONVENTIONAL SYMBOLS

- COUNTY LINE -----
- TOWN CORPORATION LINE -----
- SECTION LINE -----
- EXISTING ROAD OR TRAVELED WAY -----
- PROPOSED ROAD OR TRAVELED WAY -----
- RAILROAD -----
- SURVEY LINE -----
- BRIDGES -----

PS & E PLANS - DATE 10-14-04

REVISIONS		
DATE	SHEET NO.	BY

APPROVED: *[Signature]* ASU 9/23/04 DATE

CHIEF ENGINEER

[Signature] 9-29-04 DATE

EXECUTIVE DIRECTOR

MISSISSIPPI DEPARTMENT OF TRANSPORTATION

APPROVED:

DIVISION ADMINISTRATOR DATE

FEDERAL HIGHWAY ADMINISTRATION DEPARTMENT OF TRANSPORTATION

SHEET NO.	WORKING NO.	DESCRIPTION
1	1	TITLE PAGE
2	A1.1	SITE PLAN
3	A2.1	FLOOR PLAN
4	A2.2	REFLECTED CEILING PLAN
5	A2.3	ROOF PLAN
6	A3.1	ELEVATIONS
7	A4.1	SECTIONS
8	A4.2	WALL SECTIONS
9	A4.3	SECTIONS AND DETAILS
10	A5.1	DOOR AND WINDOW DETAILS
11	A6.1	INTERIOR ELEVATIONS
12	A6.2	CABINET SECTIONS
13	S1.0	FOUNDATION AND FLOOR FRAMING PLAN
14	S1.1	ROOF FRAMING PLAN
15	S2.1	FOUNDATION DETAILS
16	S2.2	FOUNDATION DETAILS
17	P0.1	PLUMBING LEGEND, ABBREVIATIONS, AND GENERAL NOTES
18	P1.0	PLUMBING SITE PLAN
19	P2.1	PLUMBING FLOOR PLAN
20	P3.1	PLUMBING SCHEDULES, DETAILS, AND RISER DIAGRAM
21	MO.1	HVAC LEGEND, ABBREVIATIONS, AND GENERAL NOTES
22	M2.1	HVAC FLOOR PLAN
23	M3.1	HVAC SCHEDULE AND DETAILS
24	E0.1	ELECTRICAL LEGEND, ABBREVIATIONS, AND GENERAL NOTES
25	E1.0	ELECTRICAL SITE PLAN
26	E2.1	ELECTRICAL FLOOR PLAN: POWER, COMMUNICATIONS, AND SECURITY
27	E3.1	ELECTRICAL DETAILS
28	E4.1	ELECTRICAL SCHEDULES AND POWER RISER DIAGRAM

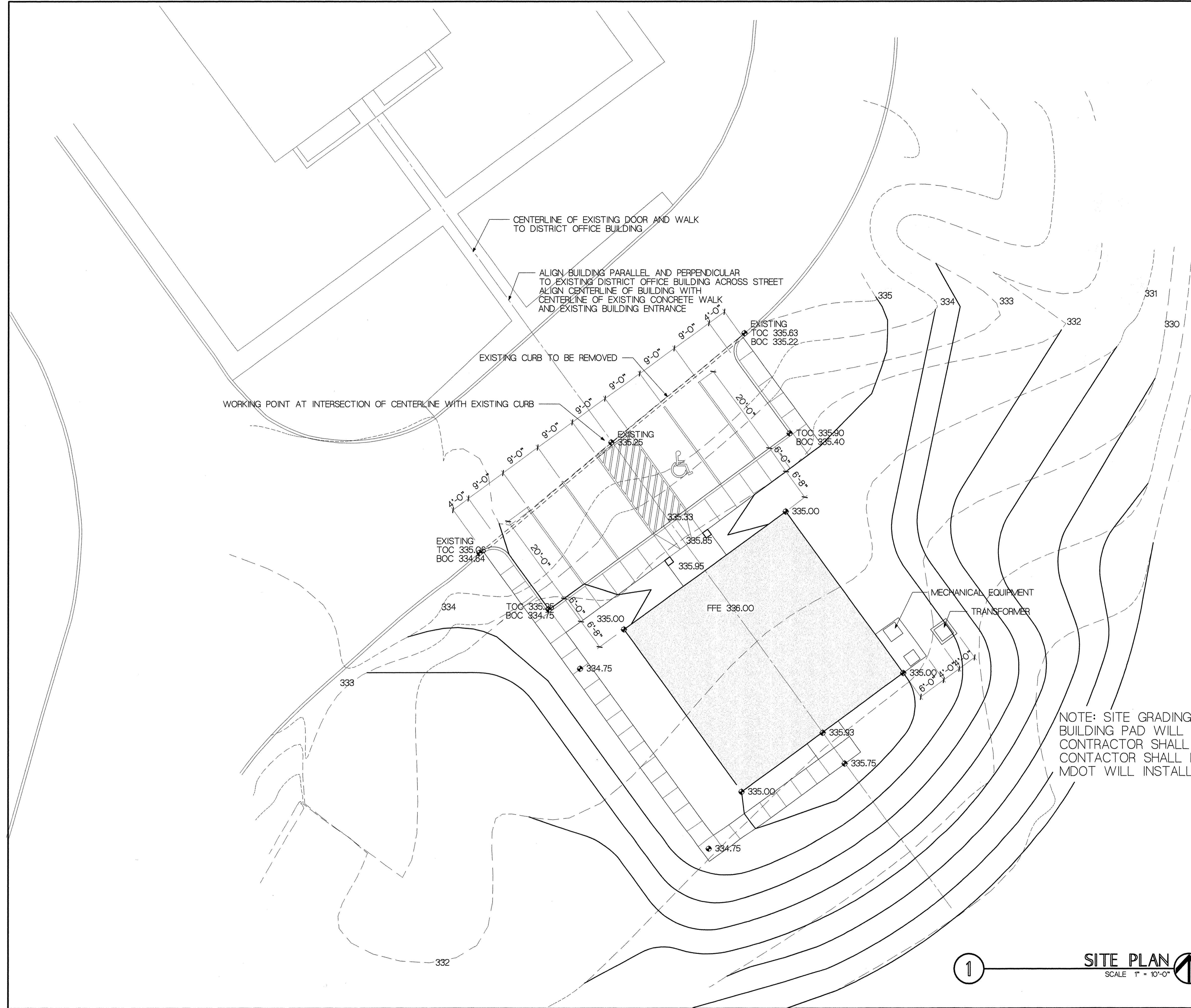

NOTE: SITE GRADING SHOWN FOR GENERAL BIDDING INFORMATION ONLY. BUILDING PAD WILL BE PREPARED BY MDOT TO APPROXIMATE ELEVATIONS INDICATED. CONTRACTOR SHALL PREPARE CURB CUTS, CONCRETE CURBS, WALKS AND RAMPS. CONTRACTOR SHALL BE RESPONSIBLE FOR SITE IMPROVEMENTS AND FINAL GRADING. MDOT WILL INSTALL ASPHALT PAVING AND RELATED PAVEMENT STRIPING.

1 SITE PLAN
SCALE 1" = 10'-0"

MISSISSIPPI DEPARTMENT OF TRANSPORTATION COMMISSIONER'S OFFICE BUILDING LEE COUNTY		SITE PLAN	
FILENAME: h:\2004\04018.pj DESIGN TEAM: AV JD TP CHECKED: _____ DATE: 10-8-04	DATE: _____ BY: _____		