

GENERAL INDEX

FOR DETAILED INDEX OF PLANS SEE SHEET NO. 2

DESCRIPTION	NUMBER OF SHEETS
TITLE SHEET	1
DETAILED INDEX	1
GENERAL NOTES	
TYPICAL SECTIONS	
QUANTITIES	
PLAN AND PROFILES	
SPECIAL DESIGN - SITEWORK DRAWINGS	27
BRIDGE DRAWINGS	
SPECIAL DESIGN - BRIDGES	
CROSS-SECTIONS	
TOTAL SHEETS	29

STATE OF MISSISSIPPI
MISSISSIPPI DEPARTMENT OF TRANSPORTATION

PLANS OF PROPOSED
SITE IMPROVEMENTS FOR
DISTRICT SEVEN AT McCOMB
STATE PROJECT NO. LWO-7031-57(005)

501416/302000

① 10-11-06

PIKE COUNTY

FED. ROAD REG. NO.	STATE	PROJECT NO.	SHEET NO.
4	MISS.		1

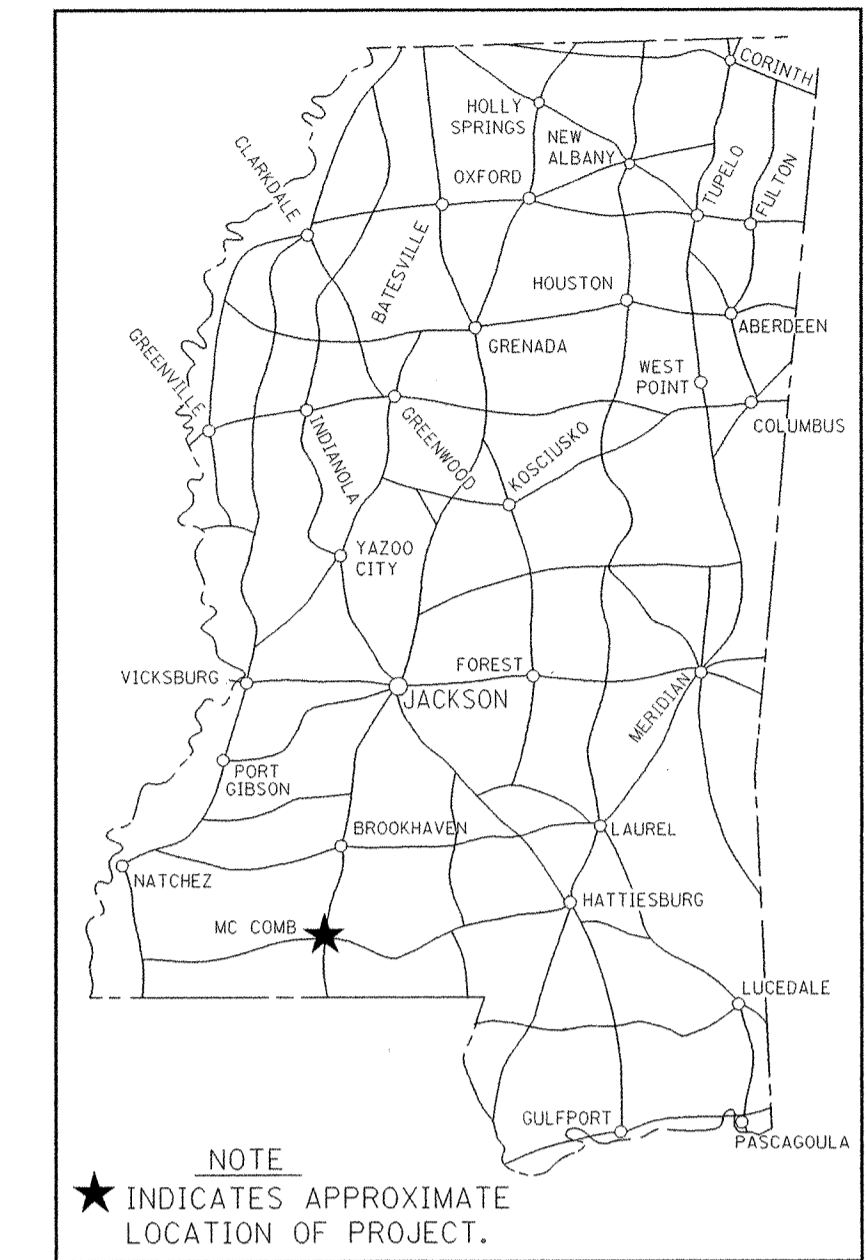

DISTRICT 7 COMPLEX
HWY 51 NORTH

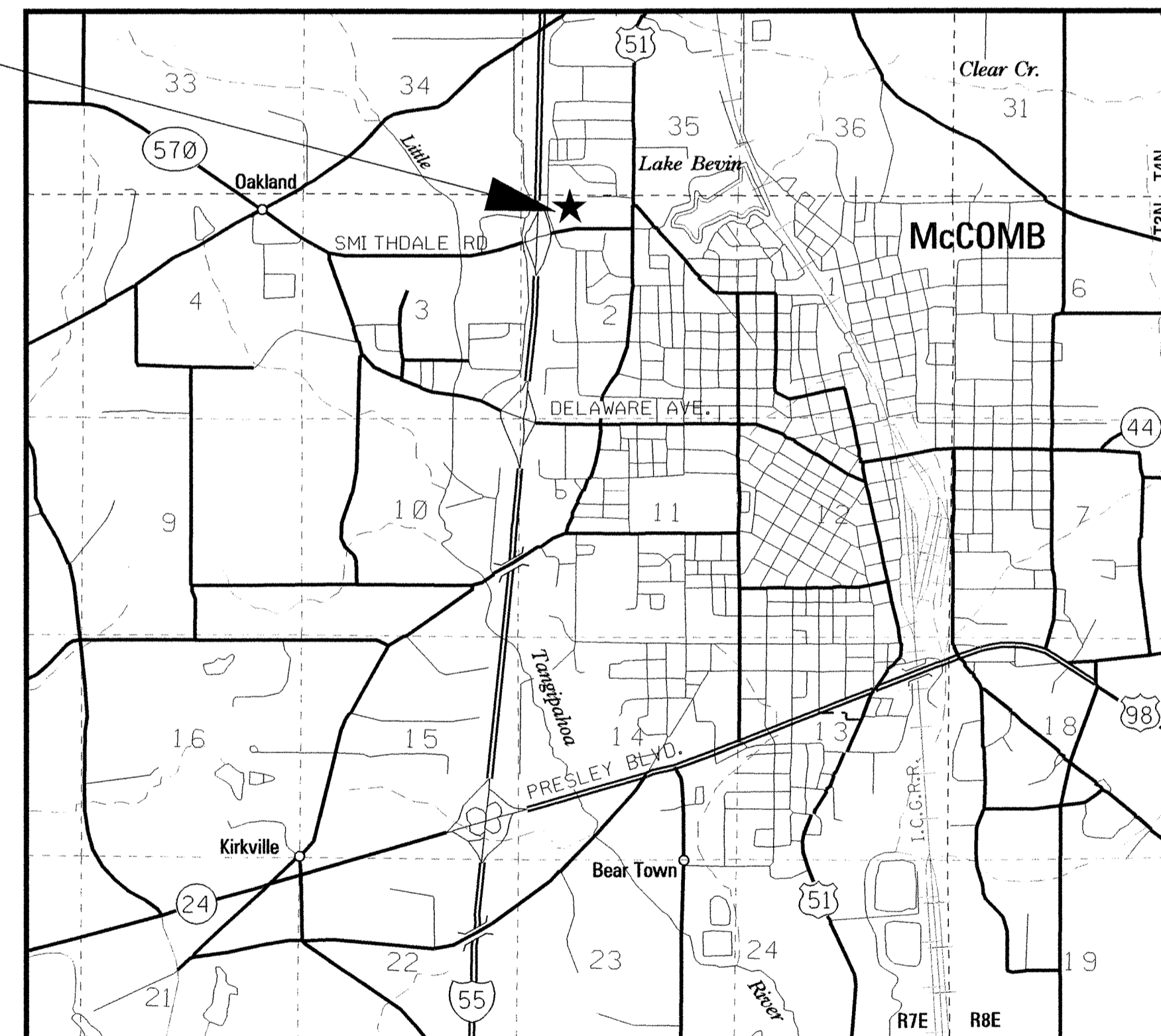

DESIGN CONTROL
MPH = V (SPEED DESIGN)

ADT () = : ADT () =
DHV = : D = % T = %

PERMITS ACQUIRED BY MDOT

WETLANDS AND WATERS PERMITS (NECESSARY FOR ULTIMATE IMPROVEMENTS ONLY):

	WATERS	WETLANDS
NATIONWIDE #14	N	N
NATIONWIDE (OTHER)*	N	N
GENERAL*	N	N
INDIVIDUAL (404)*	N	N

* ACQUISITION OF PERMITS FOR TEMPORARY IMPACTS DURING CONSTRUCTION ARE THE RESPONSIBILITY OF THE CONTRACTOR

STORMWATER PERMIT S

Y REQUIRED, CNOI SUBMITTED BY MDOT (DISTRIBUTED AREA = 5 ACRES + INTB 6484)

S REQUIRED, SCNOI TO BE SUBMITTED BY CONTRACTOR (1 TO 4.99 ACRES) (INTB 6483)

N NO STORMWATER PERMIT REQUIRED (<1 ACRE)

APPROVED BY: *JD* DATE: 10-9-06

CONVENTIONAL SYMBOLS

- COUNTY LINE -----
- TOWN CORPORATION LINE -----
- SECTION LINE -----
- EXISTING ROAD OR TRAVELED WAY -----
- PROPOSED ROAD OR TRAVELED WAY -----
- RAILROAD -----
- SURVEY LINE -----
- BRIDGES -----

DATE	REVISIONS	BY	APPROVED:	DATE
			<i>Larry Lee James</i> CHIEF ENGINEER	10/6/06
			<i>Samuel R. ...</i> EXECUTIVE DIRECTOR	10-6-06
			MISSISSIPPI DEPARTMENT OF TRANSPORTATION	
			APPROVED:	
			DIVISION ADMINISTRATOR	DATE
			FEDERAL HIGHWAY ADMINISTRATION DEPARTMENT OF TRANSPORTATION	

