

GENERAL INDEX

FOR DETAILED INDEX OF PLANS SEE SHEET NO. 2

DESCRIPTION	NUMBER OF SHEETS
TITLE SHEET	1
DETAILED INDEX	2
GENERAL NOTES	1
TYPICAL SECTIONS	13
QUANTITIES	13
PLAN AND PROFILES	37
SPECIAL DESIGN - ROADWAY ITEMS	35
STANDARD DRAWINGS	29
SPECIAL DESIGN - BRIDGES	17
CROSS-SECTIONS	252
TOTAL SHEETS	400

STATE OF MISSISSIPPI

MISSISSIPPI DEPARTMENT OF TRANSPORTATION

PLAN AND PROFILE OF PROPOSED STATE HIGHWAY FEDERAL AID PROJECT NO. STP-0044-02(014)

012-22-06

S.R. 30 FROM S.R. 145 TO EXISTING S.R. 30 EAST OF BOONEVILLE (BOONEVILLE BYPASS) PRENTISS COUNTY

FMS CON: 101800/301000

FED. ROAD REG. NO.	STATE	PROJECT NO.	SHEET NO.
4	MISS.	STP-0044-02(014)	1

NOTE
★ INDICATES APPROXIMATE LOCATION OF PROJECT.
LAT. 34°37' LONG. 88°32' (APPROX. MIDDLE OF PROJECT)

SCALES

PLAN	1 IN. = 100 FT.
PROFILE	HOR. 1 IN. = 100 FT.
	VERT. 1 IN. = 10 FT.
LAYOUT	1 IN. = 3000 FT.

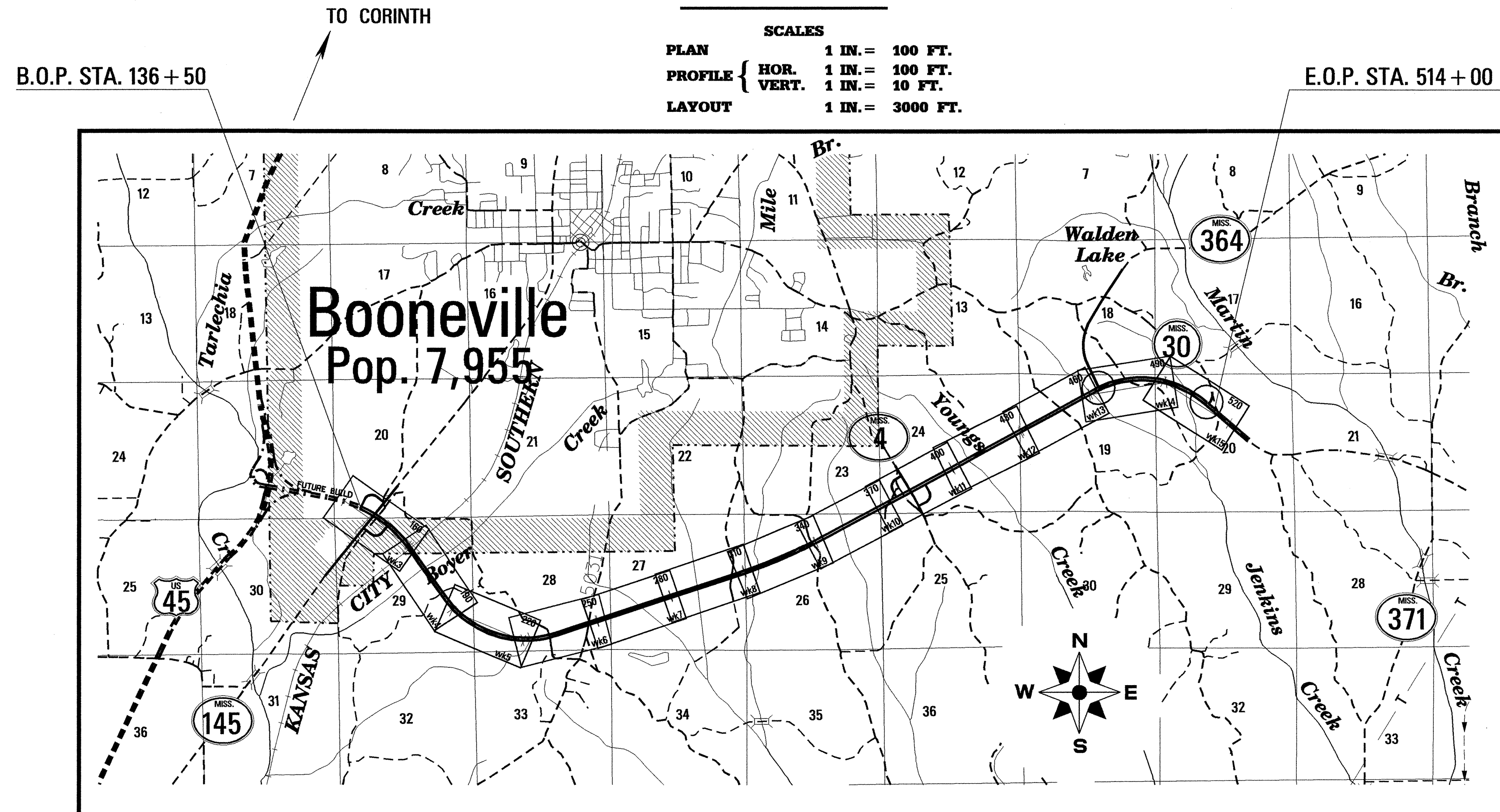

BRIDGE STRUCTURES REQ'D.

STA. 1422+43.34 TO STA. 1426+10.68
SPANS: 1@70', 2@110', 1@75'
LENGTH: 367.34' ALONG Q
SKEW: 5°44'51.8"

STA. 158+48.94 TO STA. 160+84.15 RT.
SPANS: 1@70', 1@90', 1@70'
LENGTH: 235.21' ALONG Q
SKEW: 0°

STA. 37+45.30 TO STA. 41+41.55
SPANS: 1@88', 2@109, 1@88'
LENGTH: 396.25' ALONG Q
SKEW: 0°

BOX BRIDGE'S REQ'D.

STA. 169+08.00 TRIPLE 10'X12' BOX BRIDGE
LENGTH 34.898' ALONG Q

CONVENTIONAL SYMBOLS

- COUNTY LINE -----
- TOWN CORPORATION LINE -----
- SECTION LINE -----
- EXISTING ROAD OR TRAVELED WAY -----
- PROPOSED ROAD OR TRAVELED WAY -----
- RAILROAD -----
- SURVEY LINE -----
- BRIDGES -----

TO TUPELO

EQUATIONS

NONE

LENGTH DATA

LENGTH OF ROADWAY	37,514.8 FT.	7.105 ML.
LENGTH OF BRIDGES	235.2 FT.	0.045 ML.
LENGTH OF PROJECT (NET)	37,750.0	7.150 ML.
LENGTH OF EXCEPTIONS	0 FT.	0 ML.
LENGTH OF PROJECT (GROSS)	37,750.0	7.150 ML.

EXCEPTIONS

NONE

DESIGN CONTROL	
70 MPH = V (SPEED DESIGN)	
ADT (2003) = 5900 ; ADT (2023) = 11,900	
DHV = 1200 ; D = 50 % T = 18 %	
PERMITS ACQUIRED BY MDT	
WETLANDS AND WATERS PERMITS (NECESSARY FOR ULTIMATE IMPROVEMENTS ONLY):	
NATIONWIDE #14	<input type="checkbox"/> WATERS <input type="checkbox"/> WETLANDS
NATIONWIDE (OTHER)*	<input type="checkbox"/> WATERS <input type="checkbox"/> WETLANDS
GENERAL*	<input checked="" type="checkbox"/> WATERS <input checked="" type="checkbox"/> WETLANDS
INDIVIDUAL (404)*	<input checked="" type="checkbox"/> WATERS <input checked="" type="checkbox"/> WETLANDS
* ACQUISITION OF PERMITS FOR TEMPORARY IMPACTS DURING CONSTRUCTION ARE THE RESPONSIBILITY OF THE CONTRACTOR	
STORMWATER PERMIT <input checked="" type="checkbox"/>	
Y	REQUIRED CNOI SUBMITTED BY MDT (DISTRIBUTED AREA = 5 ACRES / INTB 6484)
S	REQUIRED SCNOI TO BE SUBMITTED BY CONTRACTOR (1 TO 4.99 ACRES / INTB 6483)
N	NO STORMWATER PERMIT REQUIRED (<1 ACRE)
APPROVED BY: CKP DATE: 12/21/06	

ACCESS CONTROL

(a) NOTE: THIS PROJECT IS DECLARED BY THE MISSISSIPPI TRANSPORTATION COMMISSION TO BE A TYPE 1 CONTROLLED ACCESS FACILITY FROM STA. 136+50 TO STA. 165+26 AND A TYPE 2B CONTROLLED ACCESS FACILITY FROM STA. 165+26 TO STA. 513+50, AS DEFINED IN AND SUBJECT TO ALL RESTRICTION SHOWN BY ORDER OF SAID COMMISSION DATED 22nd DAY OF OCTOBER, 2002 IN MINUTE BOOK 9, PAGES 1189 AND 1190, AND AUTHORIZED UNDER SECTION 65-1-10(i) MCA (1972, AS AMENDED).

(b) NOTE: ACCESS TO AND EXIT FROM THIS HIGHWAY WILL BE PERMITTED ONLY THROUGH INTERCHANGE OR SUCH OTHER POINTS AS MAY BE ESTABLISHED BY PUBLIC AUTHORITY AND AS SHOWN ON THE PLANS. 121

APPROVED BY:	<i>Larry Lee James</i>	DATE: 12/21/06
CHIEF ENGINEER		
APPROVED BY:	<i>Samuel R. Bunnell</i>	DATE: 12-21-06
EXECUTIVE DIRECTOR		
MISSISSIPPI DEPARTMENT OF TRANSPORTATION		
APPROVED:		
DIVISION ADMINISTRATOR		DATE
FEDERAL HIGHWAY ADMINISTRATION DEPARTMENT OF TRANSPORTATION		

DESCRIPTION OF SHEET	REVISION DATE	WKG. NO.	SH. NO.
TITLE SHEET (1)			1
DETAILED INDEX & GENERAL NOTES (3)			
DETAILED INDEX		DI-1	2
GENERAL NOTES		GN-1	3
DETAILED INDEX (BRIDGE)		DI-BR	4
TYPICAL SECTIONS (13)			
TYPICAL SECTION		TS-1	5
TYPICAL SECTION		TS-2	6
TYPICAL SECTION		TS-3	7
TYPICAL SECTION		TS-4	8
TYPICAL SECTION		TS-5	9
TYPICAL SECTION		TS-6	10
TYPICAL SECTION		TS-7	11
TYPICAL SECTION		TS-8	12
TYPICAL SECTION		TS-9	13
TYPICAL SECTION		TS-10	14
TYPICAL SECTION		TS-11	15
TYPICAL SECTION		TS-12	16
TYPICAL SECTION		TS-13	17
QUANTITY SHEETS (4)			
SUMMARY OF QUANTITIES		SQ-1	18
SUMMARY OF QUANTITIES		SQ-2	19
SUMMARY OF QUANTITIES		SQ-3	20
SUMMARY OF QUANTITIES (BRIDGE)		SQ-BR	21
ESTIMATED QUANTITIES (9)			
ESTIMATED QUANTITIES		EQ-1	22
ESTIMATED QUANTITIES		EQ-2	23
ESTIMATED QUANTITIES		EQ-3	24
ESTIMATED QUANTITIES		EQ-4	25
ESTIMATED QUANTITIES		EQ-5	26
ESTIMATED QUANTITIES		EQ-6	27
ESTIMATED QUANTITIES		EQ-7	28
ESTIMATED QUANTITIES TRAFFIC CONTROL SIGNS		EQ-8	29
ESTIMATED QUANTITIES TRAFFIC (BRIDGE ITEMS)		EQ-BR	30
PLAN & PROFILE SHEETS (37)			
MAINLINE - STA. 130+00.00 TO STA. 160+00.00		WK 3	31
HWY. 145 - STA. 1409+00.00 TO STA. 1438+00.00		WK 3A	32
HWY. 145 DETOUR - STA. 415+00.00 TO STA. 433+24.78		WK 3B	33
NW RAMP - STA. 20+00.00 TO STA. 31+34.178		WK 3C	34
SE RAMP - STA. 40+00.00 TO STA. 50+89.17		WK 3D	35
MAINLINE - STA. 160+00.00 TO STA. 190+00.00		WK 4	36
CO. RD. 5010 - STA. 4+00.00 TO STA. 22+50.00		WK 4A	37
MAINLINE - STA. 190+00.00 TO STA. 220+00.00		WK 5	38
MAINLINE - STA. 220+00.00 TO STA. 250+00.00		WK 6	39
CO. RD. 5008 - STA. 26+73.530 TO STA. 43+24.989		WK 6A	40
MEADOW CREEK RD. - STA. 23+54.980 TO STA. 47+02.628		WK 6B	41
MAINLINE - STA. 250+00.00 TO STA. 280+00.00		WK 7	42
MAINLINE - STA. 280+00.00 TO STA. 310+00.00		WK 8	43
CO. RD. 5061 - STA. 20+03.310 TO STA. 38+79.062		WK 8A	44
MAINLINE - STA. 310+00.00 TO STA. 340+00.00		WK 9	45
CO. RD. 5051 - STA. 21+05.890 TO STA. 37+83.079		WK 9A	46
MAINLINE - STA. 340+00.00 TO STA. 370+00.00		WK 10	47
FRONTAGE RD. @ STA. 363+00 RT. - STA. 59+93.222 TO STA. 70+00.000		WK 10A	48
MAINLINE - STA. 370+00.00 TO STA. 400+00.00		WK 11	49
HWY. 4 REALIGNMENT - STA. 15+00.00 TO STA. 46+00.00		WK 11A	50
NW RAMP - STA. 60+00.00 TO STA. 70+03.752		WK 11B	51
SE RAMP - STA. 80+00.00 TO STA. 90+17.967		WK 11C	52
FRONTAGE RD. - HWY. 4 REALIGN. @ STA. 28+39.000 - STA. 3+37.658 TO STA. 9+50.000		WK 11D	53
MAINLINE - STA. 400+00.00 TO STA. 430+00.00		WK 12	54
FRONTAGE RD. @ STA. 400+17.21 - STA. 8+67.140 TO STA. 12+40.749		WK 12A	55
MAINLINE - STA. 430+00.00 TO STA. 460+00.00		WK 13	56
CO. RD. 3101 - STA. 13+74.930 TO STA. 41+75.000		WK 13A	57

DESCRIPTION OF SHEET	REVISION DATE	WKG. NO.	SH. NO.
MAINLINE - STA. 460+00.00 TO STA. 490+00.00		WK 14	58
PROPOSED MS 364 - STA. 100+00.00 TO STA. 130+00.00		WK 14A	59
PROPOSED MS 364 - STA. 130+00.00 TO STA. 144+00.00		WK 14B	60
EXISTING HWY. 30 - STA. 181+00.00 TO STA. 193+00		WK 14C	61
CO. RD. 3121 REALIGNMENT - STA. 29+00.000 TO STA. 43+19.000		WK 14D	62
MAINLINE - STA. 490+00.00 TO STA. 514+00.00		WK 15	63
FRONTAGE RD. @ STA. 494+00 - STA. 6+00.825 TO STA. 30+00.000		WK 15A	64
CO. RD. 3121 - STA. 30+00.000 TO STA. 38+75.170		WK 15B	65
HWY. 30 REALIGNMENT - STA. 341+60.463 TO STA. 350+23.645		WK 15C	66
LOCAL RD. REALIGNMENT @ STA. 517+00 - STA. 19+50.180 TO STA. 30+00.000		WK 15D	67
SPECIAL DESIGN SHEETS (35)			
MISCELLANEOUS CONSTRUCTION DETAILS		MCD-1	68
INTERSECTION DETAIL - HWY. 145 NW RAMP - 1 OF 2		ID-1	69
INTERSECTION DETAIL - HWY. 145 NW RAMP - 2 OF 2		ID-2	70
INTERSECTION DETAIL - HWY. 145 SE RAMP - 1 OF 2		ID-3	71
INTERSECTION DETAIL - HWY. 145 SE RAMP - 2 OF 2		ID-4	72
INTERSECTION DETAIL - CO. RD. 5010 - REALIGNMENT		ID-5	73
INTERSECTION DETAIL - CO. RD. 5008 - REALIGNMENT		ID-6	74
INTERSECTION DETAIL - MEADOW CREEK RD. - REALIGNMENT		ID-7	75
INTERSECTION DETAIL - CO. RD. 5061 - REALIGNMENT		ID-8	76
INTERSECTION DETAIL - CO. RD. 5051 - REALIGNMENT		ID-9	77
INTERSECTION DETAIL - HWY. 4 NW RAMP - 1 OF 2		ID-10	78
INTERSECTION DETAIL - HWY. 4 NW RAMP - 2 OF 2		ID-11	79
INTERSECTION DETAIL - HWY. 4 SE RAMP - 1 OF 2		ID-12	80
INTERSECTION DETAIL - HWY. 4 SE RAMP - 2 OF 2		ID-13	81
INTERSECTION DETAIL - CO. RD. 3101 - REALIGNMENT		ID-14	82
INTERSECTION DETAIL - PROPOSED MS 364		ID-15	83
INTERSECTION DETAIL - CO. RD. 3121 - REALIGNMENT		ID-16	84
INTERSECTION DETAIL - HWY. 30 - REALIGNMENT		ID-17	85
INTERSECTION DETAIL - LOC. RD. @ HWY. 30 - STA. 517+50		ID-18	86
VEGETATION SCHEDULE		VS-1	87
TRAFFIC CONTROL CONSTRUCTION SIGNS		TC-1	88
TRAFFIC CONTROL CONSTRUCTION SIGNS		TC-2	89
TRAFFIC CONTROL CONSTRUCTION SIGNS		TC-3	90
TRAFFIC CONTROL LOCAL ROADS		TC-4	91
TRAFFIC CONTROL MAINLINE RAMPS		TC-5	92
TRAFFIC CONTROL LOCAL ROAD RAMPS		TC-6	93
TRAFFIC CONTROL HWY. 145 - PHASE 1		TC-7	94
TRAFFIC CONTROL HWY. 145 - PHASE 2		TC-8	95
TRAFFIC CONTROL HWY. 145 - PHASE 3		TC-9	96
TRAFFIC CONTROL HWY. 4 - PHASE 1		TC-10	97
TRAFFIC CONTROL HWY. 4 - PHASE 2		TC-11	98
GUARD RAIL : RUB RAIL HARDWARE SHEET		GR-RR	99
GUARD RAIL : BRIDGE END SECTION TYPE "I" (WOOD POSTS)	03-01-02	GR-2F	100
GUARD RAIL : BRIDGE END SECTION TYPE "I" (STEEL POSTS)		GR-2G	100.1
TYPICAL TEMP. EROSION CONTROL MEASURES (TYPE "D" SILT BASIN)		TEC-D	100.3
STANDARD DRAWINGS - ROADWAY SHEETS (29) OCT. 1, 1998 VERSION			
BRIDGE END PAVEMENT		BE-1	107
PAVEMENT MARKING DETAILS FOR 2 & 4-LANE DIVIDED ROADWAYS	12-01-99	PM-1	120
EROSION CONTROL		EC-1	140
TYPICAL TEMPORARY EROSION CONTROL MEASURES (SILT FENCE, HAY BALES & BRUSH BARRIER)		TEC-1	142
TYPICAL TEMPORARY EROSION CONTROL MEASURES (SLOPE DRAIN AND TYPE A SILT BARRIER)		TEC-2	143

1/24/2007 8:47 AM DL.DGN

△

BOGGAN

PS & E PLANS - 12-22-06		
FMS CON. # 101000/301000		
REVISIONS		
DATE	SHEET NO.	BY
1-18-07	2,4,18,19,20,21 & 30	TAD
1-24-07	7, 8, 9 & 17	TAD

REMOVED SHEET		TAD BY		MISSISSIPPI DEPARTMENT OF TRANSPORTATION	
REVISION		BY		DETAILED INDEX	
DATE		BY		PROJECT NO.: STP-0044-02(014)	
DATE		BY		COUNTY : PRENTISS	
DATE		BY		WORKING NUMBER	
DATE		BY		DI-1	
DATE		BY		SHEET NUMBER	
DATE		BY		2	
DATE		BY		FILENAME: di.dgn	
DATE		BY		DESIGN TEAM BOGGAN CHECKED DATE	

DESCRIPTION OF SHEET

REVISION DATE WKG. NO. SH. NO.

DETAILS OF DITCH TREATMENT		DT-1	145
GUARD RAIL : "W" BEAM (WOOD POSTS)	03-01-02	GR-1	180
GUARD RAIL : THRIE BEAM (WOOD POSTS)	03-01-02	GR-1A	181
GUARD RAIL : "W" BEAM (STEEL POSTS)	03-01-02	GR-1B	182
GUARD RAIL : MODIFIED THRIE BEAM (STEEL POSTS)	03-01-02	GR-1C	183
GUARD RAIL : TYPICAL INSTALLATION AT BRIDGE APPROACHES FOR TWO-LANE, TWO-WAY HIGHWAYS	12-01-99	GR-4A	195
GUARD RAIL : MISCELLANEOUS HARDWARE	03-01-02	GR-HW	202
TYPICAL GUARD RAIL DELINEATION	03-01-02	SN-8C	236
TRAFFIC CONTROL PLAN WITH FLAGGER (ONE-LANE CLOSURE OF TWO WAY TRAFFIC)		TCP-1	250
HIGHWAY SIGN AND BARRICADE DETAILS FOR CONSTRUCTION PROJECTS		TCP-10	259
TRAFFIC CONTROL PLAN MOBILE OPERATIONS MULTILANE ROADS AND TWO-LANE ROADS	12-01-99	TCP-11	260
TRAFFIC CONTROL PLAN : UNEVEN PAVEMENT DETAILS		TCP-14	263
TEMPORARY STRIPING FOR TRAFFIC CONTROL TWO-LANE AND FOUR-LANE DIVIDED HIGHWAY	12-01-99	TCP-15	264
RURAL DRIVEWAYS		RD-1	271
TYPICAL GRADING TRANSITION BETWEEN CUTS & FILLS		GT-1	272
SIGHT FLARES	12-01-99	SF-1	273
SUPERELEVATION TRANSITION - CASE I (2% NORMAL SUBGRADE)	3-01-02	SE-2A	276
DRIVEWAYS, CURB & GUTTER, AND SIDEWALK		SD-1	287
PIPE CULVERT INSTALLATION		PI-1	300
PIPE COLLAR - CONCRETE		PC-1	301
JUNCTION BOX FOR PIPE CULVERTS		JB-1	302
TYPE I MEDIAN INLET (24" PIPE & UNDER)	10-01-98	MI-1	306
FLARED END SECTION FOR CONCRETE PIPE		FE-1	328
FLARED END SECTION FOR CONCRETE ARCH PIPE		FE-1A	329
DETAILS OF NORMAL UNDERDRAIN AND AND STORM DRAIN USED AS UNDERDRAIN		UD-1	331
SPECIAL DESIGN BRIDGE SHEETS (81)			
BASIC CULVERT DRAWING-BARREL JOINT LOCATIONS-NORMAL AND SKEWED CULVERTS GROUP I DIAGRAMS		IBJL-1	366.1
BASIC CULVERT DRAWING-BARREL JOINT LOCATIONS-NORMAL AND SKEWED CULVERTS GROUP II DIAGRAMS		IBJL-1	366.2
BASIC CULVERT DRAWING-BARREL JOINT LOCATIONS-NORMAL AND SKEWED CULVERTS GROUP III DIAGRAMS		IBJL-1	366.3
SKEWED COLLAR DETAILS FOR BOX STRUCTURES		ICJS-1	368
BASIC CULVERT DRAWING-SINGLE CELL-HEIGHT 8 FT.-SPANS 8-20 FT.		IBS-8-2W	371.1
BASIC CULVERT DRAWING-SINGLE CELL-HEIGHT 8 FT.-SPANS 8-20 FT.		IBS-8-2W	371.2
BASIC CULVERT DRAWING-SINGLE CELL-HEIGHT 10 FT.-SPANS 10-22 FT.		IBS-10-2W	372.1
BASIC CULVERT DRAWING-SINGLE CELL-HEIGHT 10 FT.-SPANS 10-22 FT.		IBS-10-2W	372.2
WINGS WITH 3:1 SLOPE FOR BASIC CULVERT DRAWING-SINGLE CELL HEIGHTS 6-12FT.-SPANS 6-24 FT.		IWS-3	374
WINGS WITH 3:1 SLOPE FOR BASIC CULVERT DRAWING-SINGLE CELL HEIGHTS 6-12FT.-SPANS 6-24 FT.		IWS-3	375.1
WINGS WITH 3:1 SLOPE FOR BASIC CULVERT DRAWING-SINGLE CELL HEIGHTS 6-12FT.-SPANS 6-24 FT.		IWS-3	375.2
BOX CULVERT DWG-IBS CULVERTS MOD. FOR HIGH COVER-WINGS WITH 3:1 SLOPE		IBSM-3W	380
BOX CULVERT DWG-IBS CULVERTS MOD. FOR HIGH COVER-WINGS WITH 3:1 SLOPE		IBSM-3W	381
BOX CULVERT DWG-15 DEG. SKEW DETAILS-WINGS WITH 3:1 SLOPE			
SINGLE AND DOUBLE CELL CULVERTS		15K-15-3W	397.1
BOX CULVERT DWG-15 DEG. SKEW DETAILS-WINGS WITH 3:1 SLOPE			
SINGLE AND DOUBLE CELL CULVERTS		15K-15-3W	397.2
BOX CULVERT DWG-30 DEG. SKEW DETAILS-WINGS WITH 3:1 SLOPE			
SINGLE AND DOUBLE CELL CULVERTS		15K-30-3W	400.1
BOX CULVERT DWG-30 DEG. SKEW DETAILS-WINGS WITH 3:1 SLOPE			
SINGLE AND DOUBLE CELL CULVERTS		15K-30-3W	400.2
SEE SHEET WORKING NUMBER DI-BR FOR ITEMIZED LISTING OF ADDITIONAL BRIDGE SHEETS			
CROSS SECTIONS (252)			
MAINLINE HWY. 30			901 - 974
HWY. 145 REALIGNMENT			975 - 981
HWY. 145 DETOUR			982 - 986
HWY. 145 NORTHWEST LOOP			987 - 992
HWY. 145 SOUTHEAST LOOP			993 - 998
COUNTY ROAD 5010			999 -1008
COUNTY ROAD 5008			1009-1017
MEADOW CREEK ROAD			1018-1029
COUNTY ROAD 5061			1030-1038
COUNTY ROAD 5051			1039-1046
FRONTAGE ROAD @ 363+00 HWY. 30			1047-1051
HWY. 4 REALIGNMENT			1052-1072
HWY. 4 NORTHWEST RAMP			1073-1079

DESCRIPTION OF SHEET

REVISION DATE WKG. NO. SH. NO.

HWY. 4 SOUTHEAST RAMP			1080-1086
FRONTAGE ROAD @ HWY. 4 NORTHWEST RAMP			1087-1088
FRONTAGE ROAD @ 400+00 HWY. 30			1089-1090
COUNTY ROAD 3101			1091-1108
HWY. 364			1109-1122
COUNTY ROAD 3121 REALIGNMENT @ HWY. 364			1123-1127
COUNTY ROAD 3121 REALIGNMENT @ HWY. 364			1128-1132
FRONTAGE ROAD @ 494+00 HWY. 30			1133-1139
COUNTY ROAD 3121 REALIGNMENT @ HWY. 30			1140-1144
EXISTING HWY. 30 TIE IN			1145-1148
LOCAL ROAD @ 517+50 HWY. 30			1149-1152
TOTAL SHEETS (400)			

GENERAL NOTES

- LIST OF PUBLIC UTILITIES:
 - BELL SOUTH TELEPHONE COMPANY - JACKSON, MS
 - PRENTISS COUNTY POWER ASSOCIATION - BOONEVILLE, MS
 - BIG V WATER ASSOC. - BOONEVILLE, MS
 - BOONEVILL GAS & WATER - BOONEVILLE, MS
 - WHEELER WATER ASSOC. - WHELLER, MS
 - VISTA III MEDIA LLC - BOONEVILLE, MS
 - TENNESSEE VALLEY AUTHORITY
- THE LOCATION AND SPACING OF SIGNS, SHOWN ON THE TRAFFIC CONTROL PLANS, ARE APPROXIMATE AND MAY BE ADJUSTED AS NECESSARY TO FIT FIELD CONDITIONS.
- A SOIL PROFILE HAS BEEN PREPARED FOR THIS PROJECT USING SAMPLES TAKEN FROM HOLES AT THE LOCATIONS INDICATED IN THE TEST REPORTS. THIS SOIL PROFILE IS ON FILE IN THE DISTRICT AND CENTRAL CONSTRUCTION OFFICES AND IS AVAILABLE FOR EXAMINATION. THE DEPARTMENT DOES NOT GUARANTEE THAT THE MATERIALS AS SHOWN IN THE REPORTS ARE NECESSARILY TO BE FOUND OUTSIDE THE TEST HOLES.
- IT SHALL BE THE RESPONSIBILITY OF THE CONTRACTOR TO PROTECT EXISTING STRUCTURES SUCH AS PIPES, INLETS, APRONS, BRIDGES, ETC. FROM DAMAGE WHICH MIGHT OCCUR DURING CONSTRUCTION. EXTREME CARE SHOULD BE EXERCISED IN UNDERCUT AREAS AND THE UNDERCUT DEPTH MAY BE ADJUSTED AT CROSS DRAINS, AS DIRECTED BY THE ENGINEER. THE CONTRACTOR SHALL REPLACE OR REPAIR, AS DIRECTED BY THE ENGINEER, ANY STRUCTURES DAMAGED DURING THE LIFE OF THE CONTRACT. NO PAYMENT WILL BE MADE FOR REPLACEMENT OR REPAIR OF DAMAGED ITEMS.
- ALL EXISTING HEADWALLS, CULVERT PIPES, OR OTHER OBSTRUCTIONS NOT COVERED BY A SPECIFIC PAY ITEM, ITEM, WHICH CONFLICT WITH REQUIRED CONSTRUCTION SHALL BE REMOVED AT THE CONTRACTOR'S EXPENSE AS AN ABSORBED ITEM. EXISTING PIPES THAT ARE TO BE ABANDONED IN PLACE SHALL BE PLUGGED ON EACH END WITH CONCRETE. (ABSORBED ITEM)
- VOIDS CREATED BY THE REMOVAL OF POSTS, CONCRETE ANCHORS, FOOTINGS, ETC. SHALL BE BACKFILLED AND TAMPED IN ACCORDANCE WITH SECTION 203 OF THE MISSISSIPPI STANDARD SPECIFICATIONS FOR ROAD AND BRIDGE CONSTRUCTION.
- EXISTING UNDERGROUND UTILITY LINES ARE SHOWN ON THE DRAWINGS BASED UPON THE BEST INFORMATION AVAILABLE TO THE ENGINEER. THE ENGINEER CAN NOT AND DOES NOT WARRANT THAT THIS INFORMATION IS COMPLETE OR ACCURATE. THE CONTRACTOR MUST COORDINATE DIRECTLY WITH THE INVOLVED UTILITY OWNERS TO HAVE UNDERGROUND UTILITY LINES FIELD LOCATED IN ADVANCE OF CONSTRUCTION.
- WORK ON STRUCTURES FOR THIS PROJECT REQUIRES EXCAVATION IN THE IMMEDIATE VICINITY OF TRAFFIC AND ADJACENT PROPERTIES. THEREFORE, THE RISK OF A FAILURE OCCURING DURING EXCAVATION REQUIRES THAT EXTREME CAUTION BE EXERCISED. IT SHALL BE THE CONTRACTOR'S RESPONSIBILITY TO PLACE WHAT BRACING, SHORING, OR GROUND SUPPORT SYSTEM THAT IS DEEMED NECESSARY TO PREVENT A FAILURE AND PROTECT THE PERSONS WORKING NEAR THE EXCAVATION, THE PUBLIC THAT MAY BE ABOVE THE EXCAVATION OR ANY STRUCTURES ADJACENT TO THE EXCAVATION. ALL COSTS FOR DESIGNING, DRAWING, AND CONSTRUCTING THE FACILITY, SHALL BE INCLUDED IN THE PRICE BID FOR CONTRACT ITEMS.
- THE EROSION CONTROL DEVICES REFERENCED IN THESE PLANS ARE A MINIMUM REQUIREMENT. IT IS THE RESPONSIBILITY OF THE CONTRACTOR TO INSURE THAT SILT DOES NOT LEAVE THE RIGHT OF WAY OR CONTAMINATE WATERS OF THE U.S. DURING CONSTRUCTION. THE CONTRACTOR SHALL SUBMIT AN EROSION CONTROL PLAN PRIOR TO COMMENCEMENT OF WORK AND MAINTAIN THE PLAN DURING CONSTRUCTION.
- FLUORESCENT ORANGE SHEETING SHALL BE USED ON ALL CONSTRUCTION AND TRAFFIC CONTROL SIGNS EXCEPT FOR THOSE DESIGNATED ON THE PLANS TO BE BLACK LEGEND AND BORDER ON WHITE BACKGROUND.
- 25% SHRINKAGE FACTOR USED IN THE EARTHWORK CALCULATIONS IS FOR DESIGN ESTIMATING PURPOSES ONLY.
- EXISTING RIP RAP TO BE SHAPED AS DIRECTED BY THE ENGINEER. (COST ABSORBED)
- FULL COLLARS ARE TO BE USED AT ALL BOX CULVERT EXTENSIONS AND AT ALL BOX CULVERTS CONSTRUCTION JOINTS. (SEE WK.NO. ICJ-1 FOR DETAILS)
- ALL TRAFFIC CONTROL DEVICES ON THIS PROJECT SHALL COMPLY WITH PART VI OF THE MUTCD (LATEST EDITION).

12/20/2006 2:13 PM DL.DGN

MISSISSIPPI DEPARTMENT OF TRANSPORTATION	
DETAILED INDEX GENERAL NOTES	
PROJECT NO.: STP-0044-02(014) COUNTY : PRENTISS	WORKING NUMBER GN-1
FILENAME: di.dgn	SHEET NUMBER 3
DESIGN TEAM BOGGAN	CHECKED _____ DATE _____

DESCRIPTION OF SHEETS SPECIAL DESIGN SHEETS BRIDGE DRAWINGS	WORKING NUMBER	SHEET NUMBER
UNDERPASS AT STA. 142+17.69 S.R. 30 UNDER U.S. HWY. 145	A1 OF 19	466
UNDERPASS AT STA. 142+17.69 S.R. 30 UNDER U.S. HWY. 145	A2 OF 19	467
GENERALIZED SOIL PROFILE	A3 OF 19	468
END BENT NO. 1 DETAILS	A4 OF 19	469
END BENT NO. 5 DETAILS	A5 OF 19	470
END BENT DETAILS	A6 OF 19	471
INT. BENTS NO. 2, 3, & 4 DETAILS	A7 OF 19	472
INT. BENT DETAILS	A8 OF 19	473
70 FT. SPAN DETAILS	A9 OF 19	474
110 FT. SPAN DETAILS	A10 OF 19	475
110 FT. SPAN DETAILS	A11 OF 19	476
75 FT. SPAN DETAILS	A12 OF 19	477
SPAN DETAILS	A13 OF 19	478
MISCELLANEOUS SPAN DETAILS	A14 OF 19	479
RAILING DETAILS	A15 OF 19	480
70 FT. BEAM DETAILS (END SPANS) BEAMS 70-1 THRU 70-9 (TYPE IV)	A16 OF 19	481
110 FT. BEAM DETAILS (INT. SPAN) BEAMS 110-1 THRU 110-9 (TYPE IV)	A17 OF 19	482
75 FT. BEAM DETAILS (END SPAN) BEAMS 75-1 THRU 75-9 (TYPE IV)	A18 OF 19	483
PAD DETAILS	A19 OF 19	484

DESCRIPTION OF SHEETS SPECIAL DESIGN SHEETS BRIDGE DRAWINGS	WORKING NUMBER	SHEET NUMBER
UNDERPASS AT STA. 382+16.34 S.R. 30 UNDER S.R. 4	C1 OF 18	502
UNDERPASS AT STA. 382+16.34 S.R. 30 UNDER S.R. 4	C2 OF 18	503
GENERALIZED SOIL PROFILE	C3 OF 18	504
END BENT NO. 1 DETAILS	C4 OF 18	505
END BENT NO. 5 DETAILS	C5 OF 18	506
END BENT DETAILS	C6 OF 18	507
INT. BENTS NO. 2 & 4 DETAILS	C7 OF 18	508
INT. BENT NO. 3 DETAILS	C8 OF 18	509
INT. BENT DETAILS	C9 OF 18	510
88 FT. SPAN NO. 1 DETAILS	C10 OF 18	511
88 FT. SPAN NO. 4 DETAILS	C11 OF 18	512
88 FT. SPAN DETAILS	C12 OF 18	513
109 FT. SPAN NO. 2 DETAILS	C13 OF 18	514
109 FT. SPAN DETAILS	C14 OF 18	515
MISCELLANEOUS SPAN DETAILS	C15 OF 18	516
RAILING DETAILS	C16 OF 18	517
88 FT. BEAM DETAILS (END SPAN) BEAM 88-1 THRU 88-14 (TYPE IV)	C17 OF 18	518
110 FT. BEAM DETAILS (INT. SPAN) BEAM 110-1 THRU 110-9 (TYPE IV)	C18 OF 18	519

DESCRIPTION OF SHEETS SPECIAL DESIGN SHEETS BRIDGE DRAWINGS	WORKING NUMBER	SHEET NUMBER
OVERPASS AT STA. 158+48.94 RT. LN. S.R. 30 OVER THE KANSAS CITY SOUTHERN RAILWAY COMPANY	B1 OF 17	485
OVERPASS AT STA. 158+48.94 RT. LN. S.R. 30 OVER THE KANSAS CITY SOUTHERN RAILWAY COMPANY	B2 OF 17	486
GENERALIZED SOIL PROFILE	B3 OF 17	487
END BENT NO. 1R DETAILS	B4 OF 17	488
END BENT NO. 4R DETAILS	B5 OF 17	489
END BENT DETAILS	B6 OF 17	490
INT. BENT NO. 2R DETAILS	B7 OF 17	491
INT. BENT NO. 3R DETAILS	B8 OF 17	492
INT. BENT DETAILS	B9 OF 17	493
70 FT. SPANS NO. 1R & 3R DETAILS	B10 OF 17	494
70 FT. SPAN DETAILS	B11 OF 17	495
114 FT. SPAN NO. 2R DETAILS	B12 OF 17	496
114 FT. SPAN DETAILS	B13 OF 17	497
MISCELLANEOUS SPAN DETAILS	B14 OF 17	498
RAILING DETAILS	B15 OF 17	499
70 FT. BEAM DETAILS (END SPAN) BEAMS 70-1 THRU 70-6 (TYPE III)	B16 OF 17	500
114 FT. BEAM DETAILS (INT. SPAN) BEAMS 114-1 THRU 114-6 (TYPE IV)	B17 OF 17	501

DESCRIPTION OF SHEETS SPECIAL DESIGN SHEETS BRIDGE DRAWINGS	WORKING NUMBER	SHEET NUMBER
TRIPLE CELL 10 FT. x 12 FT. BOX BRIDGE AT STA. 169+08.00 (S.R. 30)	AA1 OF 2	766
ELEVATION & LAYOUT BARREL DETAILS	AA2 OF 2	767
SINGLE CELL 10 FT. x 10 FT. BOX CULVERT AT STA. 315+50.00 (S.R. 30)	BB1 OF 2	768
ELEVATION & LAYOUT BARREL DETAILS	BB2 OF 2	769
SINGLE CELL 8 FT. x 8 FT. BOX CULVERT AT STA. 353+30.00 (S.R. 30)	CC1 OF 2	770
ELEVATION & LAYOUT BARREL DETAILS	CC2 OF 2	771
SINGLE CELL 8 FT. x 8 FT. BOX CULVERT AT STA. 460+70.00 (S.R. 30)	DD1 OF 2	772
ELEVATION & LAYOUT BARREL DETAILS	DD2 OF 2	773
SINGLE CELL 8 FT. x 8 FT. BOX CULVERT AT STA. 497+52.00 (S.R. 30)	EE1 OF 2	774
ELEVATION & LAYOUT BARREL DETAILS	EE2 OF 2	775

BRIDGE DIVISION		
DATE	SHEET NO.	BY
1/18/07	485 - 501	JBR

MISSISSIPPI DEPARTMENT OF TRANSPORTATION			
DETAILED INDEX (BRIDGE)			
PROJECT 101800/301000 STP-0044-02(014)			
PRENTISS		COUNTY	
DESIGNED <u>MRD</u>	DATE <u>1/18/07</u>	TRACED <u>CADD</u>	WORKING NUMBER DI-BR
CHECKED <u>BJJ</u>	ISSUED <u>MKC</u>	DATE <u>2/22/06</u>	SHEET NUMBER 4