

1st O. REV. GENERAL INDEX

FOR DETAILED INDEX OF PLANS SEE SHEET NO. 2

DESCRIPTION	NUMBER OF SHEETS
TITLE SHEET	1
DETAILED INDEX	1
GENERAL NOTES	
TYPICAL SECTIONS	1
QUANTITIES	3
PLAN AND PROFILES	
SPECIAL DESIGN - ROADWAY ITEMS	20
BRIDGE DRAWINGS	
SPECIAL DESIGN - BRIDGES	
CROSS-SECTIONS	
<b>TOTAL SHEETS</b>	<b>26</b>

STATE OF MISSISSIPPI

MISSISSIPPI DEPARTMENT OF TRANSPORTATION

**PLAN AND PROFILE OF PROPOSED STATE HIGHWAY**  
**STATE PROJECT NO. MP-3012-76(010)**

11-10-06

WIDEN AND OVERLAY  
 SR 12 FROM SR 1 TO LEROY PERCY STATE PARK  
 WASHINGTON COUNTY

303221/301000

**SCALES**

<b>PLAN</b>	<b>1 IN. = 100 FT.</b>
<b>PROFILE</b>	<b>HOR. 1 IN. = 100 FT.</b>
	<b>VERT. 1 IN. = 10 FT.</b>
<b>LAYOUT</b>	<b>1 IN. = 3000 FT.</b>

FED. ROAD REG. NO.	STATE	PROJECT NO.	SHEET NO.
4	MISS.	MP-3012-76(010)	1

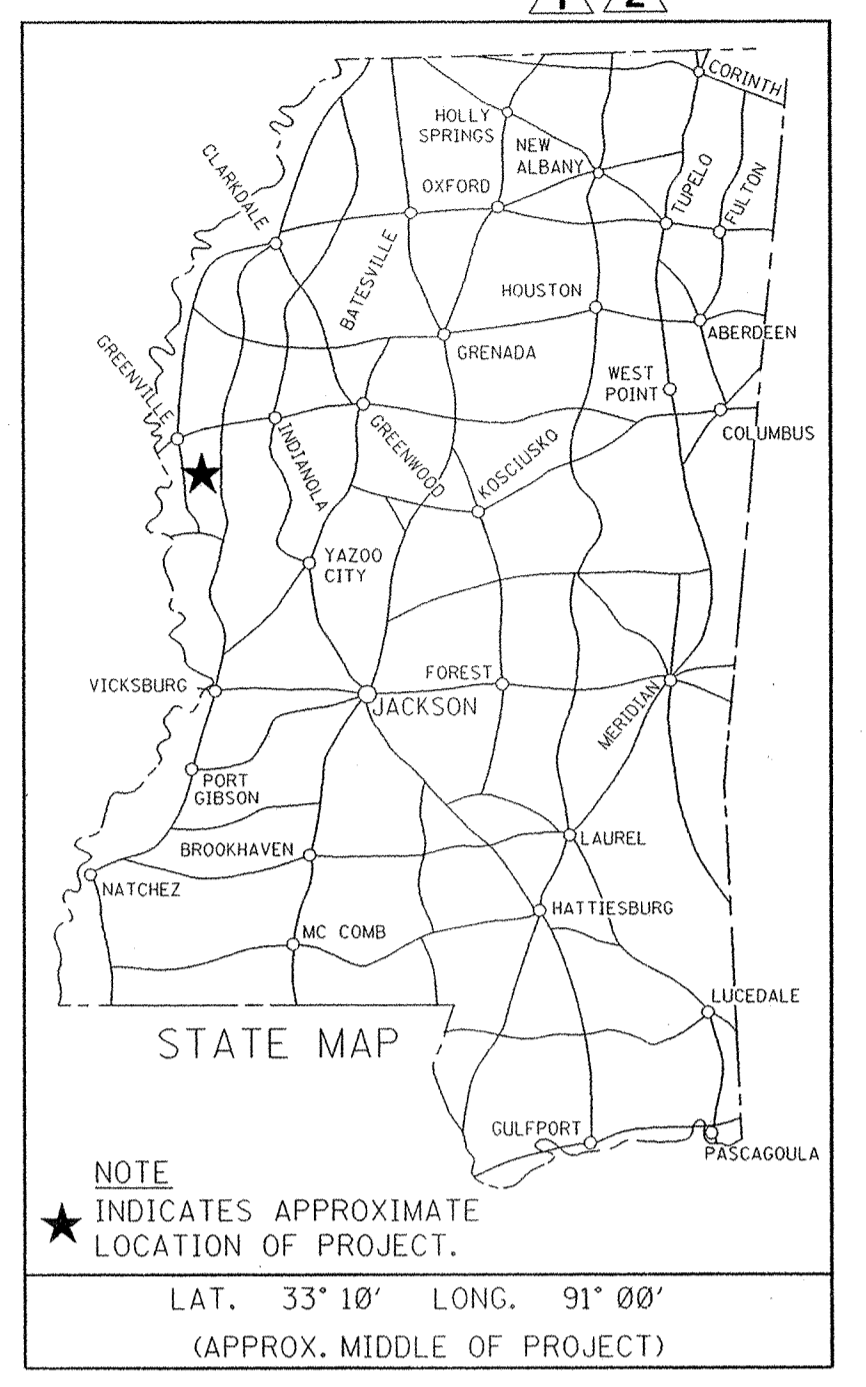

BOP LOG MILE 0.000

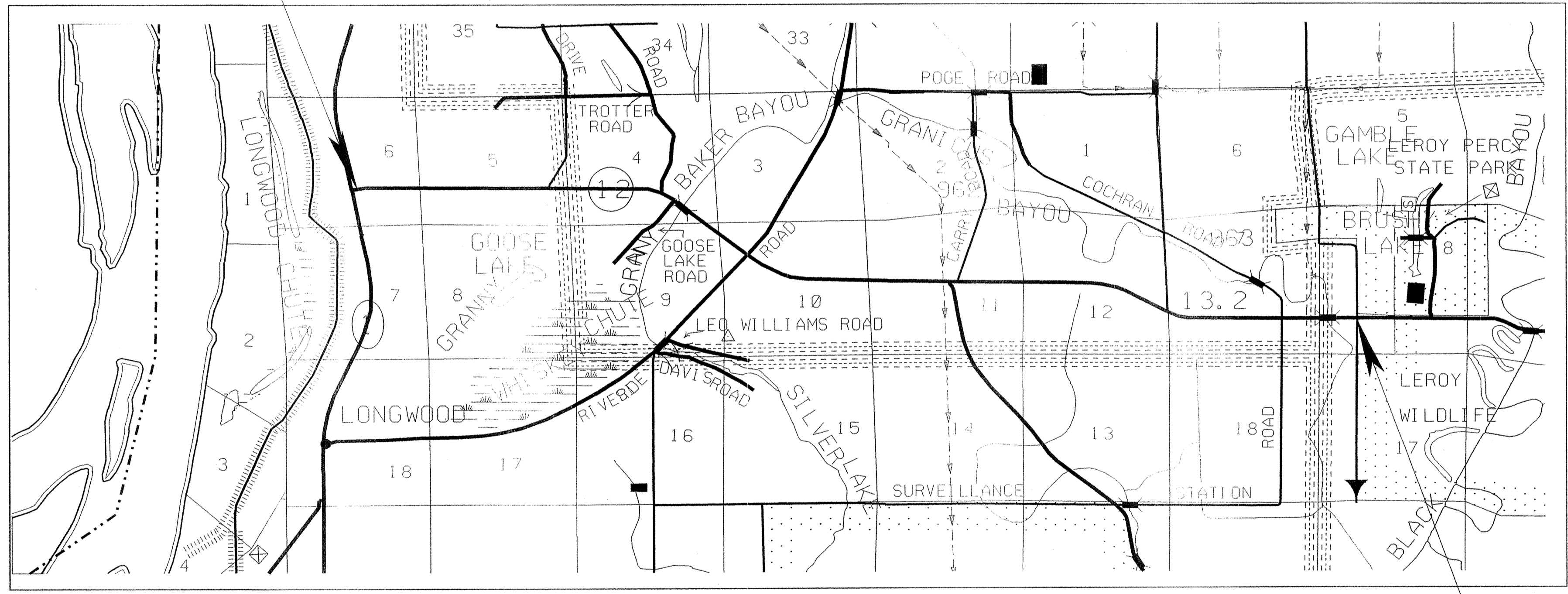

EOP LOG MILE 7.179

**PERMITS ACQUIRED BY MDOT**

WETLANDS AND WATERS PERMITS (NECESSARY FOR ULTIMATE IMPROVEMENTS ONLY):

	WATERS	WETLANDS
NATIONWIDE #14	<input type="checkbox"/>	<input type="checkbox"/>
NATIONWIDE (OTHER)*	<input type="checkbox"/>	<input type="checkbox"/>
GENERAL*	<input type="checkbox"/>	<input type="checkbox"/>
INDIVIDUAL (404)*	<input type="checkbox"/>	<input type="checkbox"/>

\* ACQUISITION OF PERMITS FOR TEMPORARY IMPACTS DURING CONSTRUCTION ARE THE RESPONSIBILITY OF THE CONTRACTOR

STORMWATER PERMIT	
Y REQUIRED, CNOI SUBMITTED BY MDOT (DISTRIBUTED AREA - 5 ACRES + INTB 6484)	<input type="checkbox"/>
S REQUIRED, SCNOI TO BE SUBMITTED BY CONTRACTOR (1 TO 4.99 ACRES) (INTB 6483)	<input type="checkbox"/>
N NO STORMWATER PERMIT REQUIRED (<1 ACRE)	<input type="checkbox"/>

APPROVED BY: *[Signature]* DATE: 11-10-2006

**CONVENTIONAL SYMBOLS**

- COUNTY LINE -----
- TOWN CORPORATION LINE -----
- SECTION LINE -----
- EXISTING ROAD OR TRAVELED WAY -----
- PROPOSED ROAD OR TRAVELED WAY -----
- RAILROAD -----
- SURVEY LINE -----
- BRIDGES -----

**EQUATIONS**

**LENGTH DATA**

LENGTH OF ROADWAY	FT.	7.179	MI.
LENGTH OF BRIDGES	FT.		MI.
LENGTH OF PROJECT (NET)			MI.
LENGTH OF EXCEPTIONS	FT.		MI.
LENGTH OF PROJECT (GROSS)		7.179	MI.

**EXCEPTIONS**

APPROVED: *[Signature]* 11/10/06  
 CHIEF ENGINEER DATE

APPROVED: *[Signature]* 11-10-06  
 EXECUTIVE DIRECTOR DATE

MISSISSIPPI DEPARTMENT OF TRANSPORTATION

APPROVED: \_\_\_\_\_ DATE \_\_\_\_\_  
 DIVISION ADMINISTRATOR

FEDERAL HIGHWAY ADMINISTRATION  
 DEPARTMENT OF TRANSPORTATION

3/13/2007 9:07 AM TITLE.DGN MISSISSIPPI DEPARTMENT OF TRANSPORTATION

DESCRIPTION OF SHEET

WKG. NO. SH. NO.

GENERAL NOTES

TITLE SHEET (1)			1
DETAILED INDEX & GENERAL NOTES (1)		DI-1	2
TYPICAL SECTION SHEETS (1)			
TYPICAL SECTION		TS-1	3
QUANTITY SHEETS (3)			
SUMMARY OF QUANTITIES		SQ-1	4
SUMMARY OF QUANTITIES		SQ-2	5
ESTIMATED QUANTITIES FOR TRAFFIC CONTROL		TCPQ-1	6
SPECIAL DESIGN SHEETS (4)			
DETAIL OF CONSTRUCTION SIGNING		DCS-1	7
LOCATION OF R-16 (DOUBLE FINE SIGNS)		MDS-1	8
RUMBLE STRIPES (GROUND-IN)		RS-1	9
GUARDRAIL: RUB RAIL HARDWARE SHEET		GR-RR	10
STANDARD DRAWINGS - ROADWAY SHEETS (16)			
PAVEMENT MARKING DETAILS FOR 2 & 4-LANE DIVIDED ROADWAYS	12-01-99	PM-1	120
TYPICAL TEMPORARY EROSION CONTROL MEASURES (SILT FENCE, HAY BALES, & BRUSH BARRIER)		TEC-1	142
GUARD RAIL : "W" BEAM (STEEL POSTS)		GR-1B	182
GUARD RAIL : MODIFIED THRIE BEAM (STEEL POSTS)		GR-1C	183
GUARD RAIL : TYPICAL INSTALLATION AT BRIDGE APPROACHES FOR 2-LANE, 2-WAY HIGHWAY	12-01-99	GR-4A	195
GUARD RAIL : BRIDGE END SECTION - TYPE "I" (STEEL POSTS)		GR-2G	191
GUARD RAIL : MISCELLANEOUS HARDWARE		GR-HW	202
TYPICAL INSTALLATION & DETAILS OF DELINEATORS AND DISTANCE REFERENCE SIGNS		SN-8	233
TYPICAL GUARD RAIL DELINEATION	3-01-02	SN-8C	236
TRAFFIC CONTROL PLAN WITH FLAGGER (ONE-LANE CLOSURE OF TWO WAY TRAFFIC)		TCP-1	250
HIGHWAY SIGN AND BARRICADE DETAILS FOR CONSTRUCTION PROJECTS		TCP-10	259
TRAFFIC CONTROL PLAN MOBILE OPERATIONS MULTILANE ROADS AND TWO-LANE ROADS	12-01-99	TCP-11	260
TRAFFIC CONTROL PLAN : UNEVEN PAVEMENT DETAILS		TCP-14	263
TEMPORARY STRIPING FOR TRAFFIC CONTROL 2-LANE AND 4-LANE DIVIDED HIGHWAYS	12-01-99	TCP-15	264
RURAL DRIVEWAYS		RD-1	271
PIPE CULVERT INSTALLATION		PI-1	300
TOTAL SHEETS (25)			

- ① THE LOCATION AND SPACING OF SIGNS, SHOWN ON THE TRAFFIC CONTROL PLANS, ARE APPROXIMATE AND MAY BE ADJUSTED AS NECESSARY TO FIT FIELD CONDITIONS.
- ② ALL TRAFFIC CONTROL DEVICES ON THIS PROJECT SHALL COMPLY WITH PART VI OF THE MUTCD (LATEST EDITION).
- ③ FLUORESCENT ORANGE SHEETING SHALL BE USED ON ALL CONSTRUCTION AND TRAFFIC CONTROL SIGNS EXCEPT FOR THOSE DESIGNATED ON THE PLANS TO BE BLACK LEGEND AND BORDER ON WHITE BACKGROUND.
- ④ VOIDS CREATED BY THE REMOVAL OF POSTS, CONCRETE ANCHORS, FOOTINGS, ETC. SHALL BE BACKFILLED AND TAMPED IN ACCORDANCE WITH SECTION 203 OF THE MISSISSIPPI STANDARD SPECIFICATIONS FOR ROAD AND BRIDGE CONSTRUCTION.
- ⑤ IT SHALL BE THE RESPONSIBILITY OF THE CONTRACTOR TO PROTECT AGAINST EXISTING STRUCTURES SUCH AS PIPES, INLETS, APRONS, BRIDGES, ETC. THE CONTRACTOR SHALL REPLACE OR REPAIR AT NO COST TO THE STATE ANY STRUCTURES DAMAGED DURING THE LIFE OF THE CONTRACT.
- ⑥ INCIDENTAL WORK SUCH AS MOWING, REMOVING VEGITATION, SHAPING AND COMPACTING SHOULDERS (INCLUDING THE BASE FOR PAVED APRONS) AND OTHER INCIDENTAL WORK NECESSARY TO COMPLETE THE WORK WILL NOT BE MEASURED FOR SEPARATE PAYMENT. THE COST OF THIS WORK WILL BE ABSORBED IN OTHER BID ITEMS.
- ⑦ GRANULAR MATERIAL REMOVED FROM TRENCH WIDENING SHALL BE USED ON THE SHOULDERS TO RAISE SHOULDER GRADE TO PROPOSED NEW ELEVATION.
- ⑧ ORANGE PLAQUE PLACED ON POSTED CONSTRUCTION SPEED LIMIT SIGNS SHALL BE ABSORBED IN OTHER PAY ITEMS .
- ⑨ WHEN PLACING PERMANENT STRIPE A SPRAY DEVICE SHALL BE USED ONLY WHEN APPLYING RUMBLE STRIPES. AN EXTRUSION HEAD SHALL BE USED WHEN PLACING ALL OTHER THERMOPLASTIC STRIPE.
- ⑩ LOCAL ROADS SHALL BE MILLED TO THE BACK OF CURB, THE BOP AND EOP SHALL BE MILLED FOR A SMOOTH TRANSITION BACK TO THE EXISTING PAVEMENT, AND THE BRIDGE ENDS OF THE BRIDGE OVER BAKER BAYOU SHALL BE MILLED AS DIRECTED BY THE ENGINEER.
- ⑪ THE BRIDGE OVER GRANICUS BAYOU SHALL BE MILLED 2.5" AND OVERLAID WITH 1" OF 9.5 mm LEVELING AND 1.5" OF 9.5mm HOT MIX ASPHALT
- ⑫ LOCAL ROADS ARE TO BE PAVED TO THE ROW LIMITS. LOCAL ROAD AND DRIVEWAY PADS ARE TO BE OVERLAID WITH 1.5" AND VARIABLE 9.5mm ST HOT MIX ASPHALT.
- ⑬ EXISTING RAISED PAVEMENT MARKERS SHALL BE REMOVED BEFORE PLACING HOT MIX ASPHALT
- ⑭ WHERE MILLING OF THE ROADWAY IS REQUIRED, THE CONTRACTOR SHALL PROVIDED AN OUTLET IN THE EXISTING SHOULDERS AT SUFFICIENT INTERVALS TO PREVENT POOLING OR STANDING WATER ON THE MILLED SURFACE. THIS WORK SHALL BE ABSORBED IN OTHER BID ITEMS
- ⑮ MINOR CLEARING MAY BE REQUIRED, AS DIRECTED BY THE ENGINEER. COST TO BE ABSORBED, NOT A SEPARATE PAY ITEM.
- ⑯ ANY REFERENCE TO PROJECT NUMBER STP-0018-01(025) IS TO BE UNDERSTOOD THAT PROJECT NO. MP-3012-76(010) IS THE CORRECT NUMBER.

PLAN ROADWAY DESIGN DIVISION MISSISSIPPI DEPARTMENT OF TRANSPORTATION 2/13/2007 9:47 AM INDEX.DGN

FINAL PLANS-DATE - 11-10-06		
FMS CON. # 303221/301000		
REVISIONS		
DATE	SHEET NO.	BY
30207	1 & 2	GTW
31307	1, 2, & 4	GTW

DISTRICT 3

MISSISSIPPI DEPARTMENT OF TRANSPORTATION			
<b>DETAILED INDEX</b>			
PROJECT NO. MP-3012-76(010)			
COUNTY : WASHINGTON			
WORKING NUMBER		DI-1	
SHEET NUMBER		2	
3/007	REVISION	DATE	FILENAME:
3/027	REVISED PROJ. NO. AND NOTE		DESIGN TEAM
3/1307	REVISED PROJ. NO. AND NOTE		CHECKED
			DATE

ab