

FOR DETAILED INDEX OF PLANS SEE SHEET NO. 2

| DESCRIPTION                        | NUMBER OF SHEETS |
|------------------------------------|------------------|
| TITLE SHEET                        | 1                |
| DETAILED INDEX                     | 3                |
| GENERAL NOTES                      | 1                |
| TYPICAL SECTIONS                   | 13 Δ             |
| QUANTITIES                         | 16               |
| PLAN AND PROFILES                  | 33               |
| SPECIAL DESIGN - ROADWAY ITEMS     | 119              |
| STANDARD DRAWINGS - ROADWAY SHEETS | 64               |
| BRIDGE DRAWINGS                    | 19               |
| CROSS-SECTIONS                     | 14 Δ             |

TOTAL SHEETS 283 ΔΔ

① 6-15-06  
RE: ② 11-16-06

STATE OF MISSISSIPPI  
MISSISSIPPI DEPARTMENT OF TRANSPORTATION

PLAN AND PROFILE OF PROPOSED  
STATE HIGHWAY  
FEDERAL AID PROJECT NO. NH-0015-02(114)PH3

U.S. HWY 84  
AT COLLINS  
COVINGTON COUNTY

102069/302000

SCALES

|         |                      |
|---------|----------------------|
| PLAN    | 1 IN. = 100 FT.      |
| PROFILE | HOR. 1 IN. = 100 FT. |
|         | VERT. 1 IN. = 10 FT. |
| LAYOUT  | 1 IN. = 1500 FT.     |

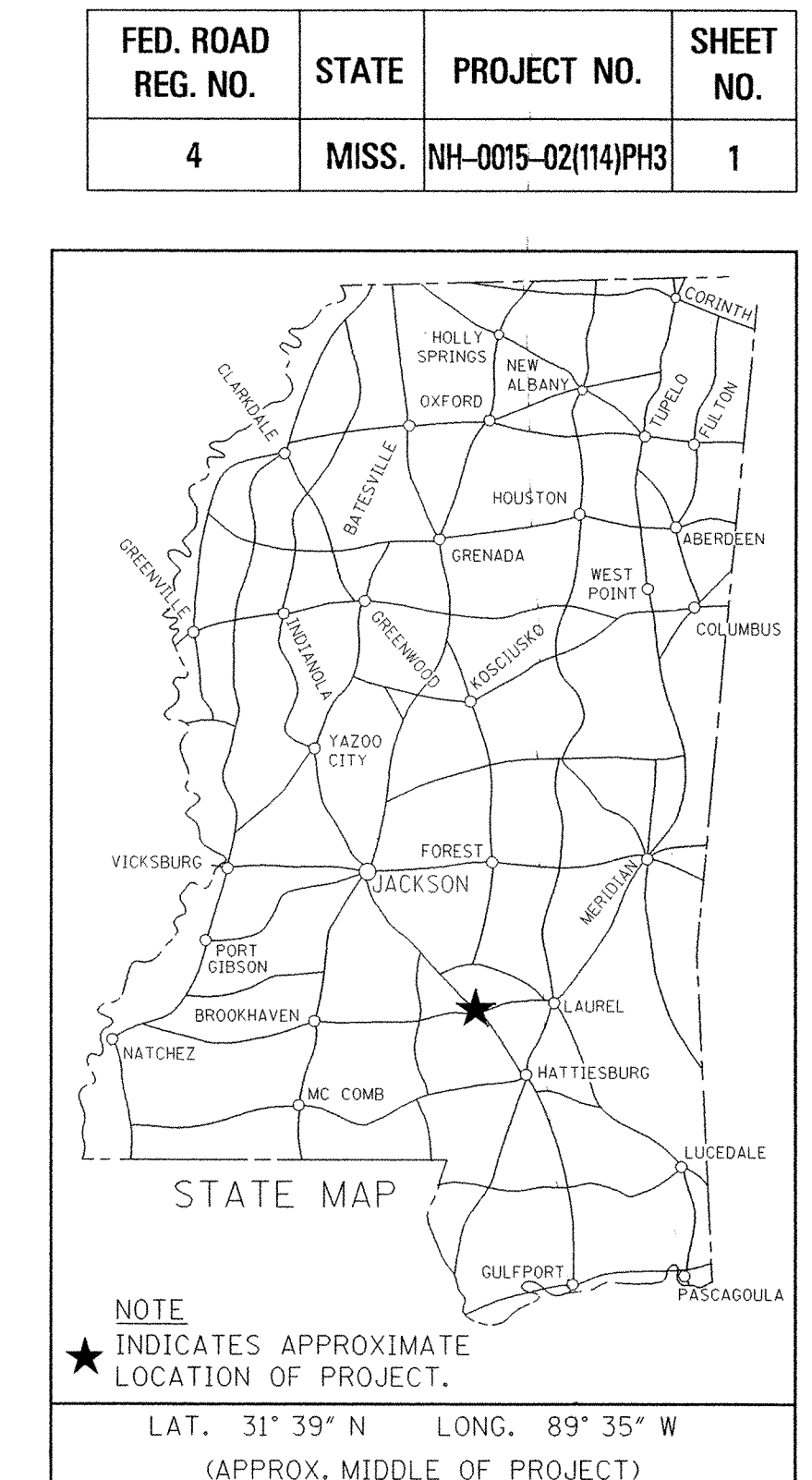

BRIDGE STRUCTURES IN PLACE

- Ⓐ - U.S. HWY. 49  
RT. LN. - STA. 637+40.854 (1 @ 79', 2 @ 81', 1 @ 79' SPANS) (L = 322.292')  
LT. LN. - STA. 637+40.854 (1 @ 79', 2 @ 81', 1 @ 79' SPANS) (L = 322.292')
- Ⓑ - I.C. RAILROAD  
RT. LN. - STA. 650+07.861 (4 @ 90' SPANS) (L = 363.417')  
LT. LN. - STA. 649+80.709 (4 @ 90' SPANS) (L = 361.891')
- Ⓒ - OKATOMA CREEK  
RT. LN. - STA. 663+02.434 (4 @ 75', 1 @ 100', 1 @ 140', 1 @ 100', 4 @ 75' SPANS)  
(L = 942.250')  
LT. LN. - STA. 663+38.060 (4 @ 75', 1 @ 100', 1 @ 140', 1 @ 100', 4 @ 75' SPANS)  
(L = 942.250')
- Ⓓ - S.E. RAMP / I.C. RAILROAD  
STA. 50+84.995 (4 @ 90' SPANS) (L = 362.385')
- Ⓔ - N.E. RAMP / I.C. RAILROAD  
STA. 47+00.022 (5 @ 100' SPANS) (L = 502.823')

BOX BRIDGES IN PLACE

- ⒶⒶ - STA. 726+15 (US 84) (SK. 11'56'49")  
TRIPLE CELL 18' X 12'  
LENGTH ALONG @ 57.15'
- ⒷⒷ - STA. 1387+47 (US 49)  
TRIPLE CELL 12' X 8'  
LENGTH ALONG @ 39.33'

CONVENTIONAL SYMBOLS

- COUNTY LINE -----
- TOWN CORPORATION LINE -----
- SECTION LINE -----
- EXISTING ROAD OR TRAVELED WAY -----
- PROPOSED ROAD OR TRAVELED WAY -----
- RAILROAD -----
- SURVEY LINE -----
- BRIDGES -----

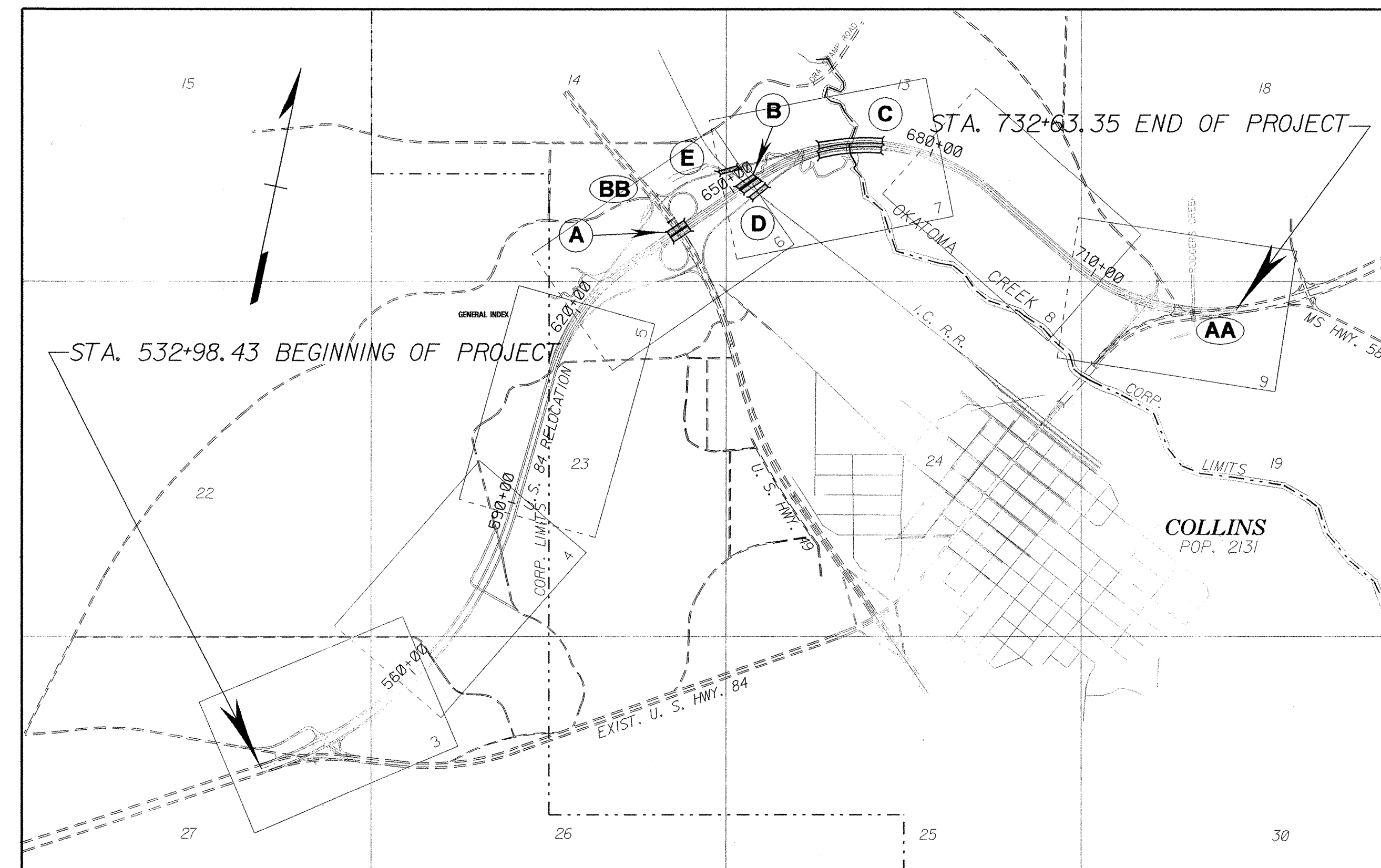

LENGTH DATA

|                           |              |           |
|---------------------------|--------------|-----------|
| LENGTH OF ROADWAY         | 18279.81 FT. | 3.462 MI. |
| LENGTH OF BRIDGES         | 1685.11 FT.  | 0.319 MI. |
| LENGTH OF PROJECT (NET)   |              | 3.781 MI. |
| LENGTH OF EXCEPTIONS      | 19964.92 FT. | 0 MI.     |
| LENGTH OF PROJECT (GROSS) |              | 3.781 MI. |

DESIGN CONTROL

65 MPH = V (SPEED DESIGN)

ADT (2006) = 4900 ; ADT (2026) = 8800

DHV = 970 D = 60% T = 18%

PERMITS ACQUIRED BY MDOT

WETLANDS AND WATERS PERMITS (NECESSARY FOR ULTIMATE IMPROVEMENTS ONLY):

|                     | WATERS                              | WETLANDS                            |
|---------------------|-------------------------------------|-------------------------------------|
| NATIONWIDE #14      | <input checked="" type="checkbox"/> | <input checked="" type="checkbox"/> |
| NATIONWIDE (OTHER)* | <input checked="" type="checkbox"/> | <input checked="" type="checkbox"/> |
| GENERAL*            | <input checked="" type="checkbox"/> | <input checked="" type="checkbox"/> |
| INDIVIDUAL (404)*   | <input checked="" type="checkbox"/> | <input checked="" type="checkbox"/> |

\* ACQUISITION OF PERMITS FOR TEMPORARY IMPACTS DURING CONSTRUCTION ARE THE RESPONSIBILITY OF THE CONTRACTOR

STORMWATER PERMIT

Y REQUIRED, CANI SUBMITTED BY MDOT (DISTRIBUTED AREA = 5 ACRES - INTB 6484)

S REQUIRED, SCNOI TO BE SUBMITTED BY CONTRACTOR (I TO 4.99 ACRES) (INTB 6483)

N NO STORMWATER PERMIT REQUIRED (<1 ACRE)

APPROVED BY: CKP DATE: 11/16/06

NOTES: (A) This project is declared by the Transportation Commission to be a Controlled Access Facility within the meaning of Chapter 314, Mississippi Laws of 1956, and is subject to all restrictions as shown by order of said Commission dated 24 NOVEMBER 1998 in the minute book 6 page 1469.

(B) Access to and exit from this highway will be permitted only through interchange or such other points as may be established by public authority and as shown on the plans.

|  |               |
|--|---------------|
| APPROVED:  | 79            |
| CHIEF ENGINEER   | 11-16-06 DATE |
| EXECUTIVE DIRECTOR   | 11-16-06 DATE |
| MISSISSIPPI DEPARTMENT OF TRANSPORTATION                       |               |
| APPROVED:  |               |
| DIVISION ADMINISTRATOR   | DATE          |
| FEDERAL HIGHWAY ADMINISTRATION<br>DEPARTMENT OF TRANSPORTATION |               |

| DESCRIPTION OF SHEET   | WKG. NO. | SH. NO. | DESCRIPTION OF SHEET  | WKG. NO.                             | SH. NO.                          |
|--|----------|---------|---|--------------------------------------|----------------------------------|
| TITLE SHEET (1)  |          | 1       | HWY 84, LT. LANE-STA. 680+00 TO STA. 710+00<br>HWY 84, RT. LANE-STA. 680+00 TO STA. 710+00<br>HWY 84, LT. LANE-STA. 710+00 TO E.O.P.<br>HWY 84, RT. LANE-STA. 710+00 TO E.O.P.<br>LOCAL RD @ STA. 719+36.26 ML<br>TEMP. CONNECTIONS NEAR B.O.P. | 8LT<br>8RT<br>9LT<br>9RT<br>9A<br>9B | 58<br>59<br>60<br>61<br>62<br>63 |
| DETAILED INDEX & GENERAL NOTES (4)                                   |          |         |   |                                      |                                  |
| DETAILED INDEX   | DI-1     | 2       |   |                                      |                                  |
| DETAILED INDEX   | DI-2     | 3       |   |                                      |                                  |
| DETAILED INDEX   | DI-3     | 3.1     |   |                                      |                                  |
| GENERAL NOTES  | GN-1     | 4       |   |                                      |                                  |
| TYPICAL SECTION SHEETS (13)  |          |         | SPECIAL DESIGN SHEETS (119)   |                                      |                                  |
| TYPICAL SECTION - PROP. U.S. 84                                      | TS-1     | 5       | VEGETATION SCHEDULE   | VS-1                                 | 64                               |
| TYPICAL SECTION - FUTURE MS 184 NEAR BOP & EOP                       | TS-2     | 6       | DETAIL OF INTERSECTION @ STA. 543+25.00 M.L.  | DOI-1                                | 65                               |
| TYPICAL SECTION - HWY 49   | TS-3     | 7       | DETAIL OF INTERSECTION @ STA. 563+42.69 M.L.  | DOI-2                                | 66                               |
| TYPICAL SECTION - LOCAL ROADS  | TS-4     | 8       | DETAIL OF INTERSECTION @ STA. 578+00 M.L.   | DOI-3                                | 67                               |
| TYPICAL SECTION - LOCAL ROADS  | TS-5     | 9       | DETAIL OF INTERSECTION @ SW RAMP CONN. HWY 84/HWY 49 INTERCHANGE  | DOI-4                                | 68                               |
| TYPICAL SECTION - INTERCHANGE LOOPS & RAMPS                          | TS-6     | 10      | DETAIL OF INTERSECTION @ STA. 1367+34.97 HWY 49   | DOI-5                                | 69                               |
| TYPICAL SECTION - INTERCHANGE RAMP                                   | TS-7     | 11      | DETAIL OF INTERSECTION @ STA. 1397+84.99 HWY 49   | DOI-6                                | 70                               |
| TYPICAL SECTION - TEMPORARY CONNECTION                               | TS-8     | 12      | DETAIL OF INTERSECTION @ NE RAMP CONN. HWY 84/HWY 49 INTERCHANGE  | DOI-7                                | 71                               |
| TYPICAL SECTION - TEMP. WIDENING & OVERLAY OF EXIST U.S. 84 NEAR EOP | TS-9     | 13      | DETAIL OF INTERSECTION @ STA. 719+00 M.L.   | DOI-8                                | 72                               |
| TYPICAL SECTION - CHANNELIZED INTERSECTIONS FUTURE MS 184            | TS-10    | 14      | DETAIL OF INTERSECTION @ (TEMP.) PROP. HWY 84 & PROP. MS 184  | DOI-9                                | 73                               |
| TYPICAL SECTION - CHANNELIZED INTERSECTION LOCAL ROADS               | TS-11    | 15      | DETAIL OF INTERSECTION @ (TEMP.) SALEM CHURCH RD. & HWY 84  | DOI-10                               | 74                               |
| TYPICAL SECTION - CROSS-OVERS  | TS-12    | 16      | PAVEMENT MARKING-STA. 531+00 TO STA. 538+00 HWY 84  | PMD-1                                | 75                               |
| TYPICAL SECTION - MISC. TYPICAL SECTION DETAILS ONE-WAY TRAFFIC      | TS-13    | 17      | PAVEMENT MARKING-STA. 538+00 TO STA. 550+00 HWY 84  | PMD-2                                | 76                               |
| QUANTITY SHEETS (16)   |          |         | PAVEMENT MARKING-PROP. HWY. 184   | PMD-2A                               | 76.1                             |
| SUMMARY OF QUANTITIES  | SQ-1     | 18      | PAVEMENT MARKING-STA. 550+00 TO STA. 560+00 HWY 84  | PMD-3                                | 77                               |
| SUMMARY OF QUANTITIES  | SQ-2     | 19      | PAVEMENT MARKING-STA. 560+00 TO STA. 572+00 HWY 84  | PMD-4                                | 78                               |
| SUMMARY OF QUANTITIES  | SQ-3     | 20      | PAVEMENT MARKING-STA. 572+00 TO STA. 584+00 HWY 84  | PMD-5                                | 79                               |
| SUMMARY OF PERMANENT SIGNING QUANTITIES                              | SQS-1    | 21      | PAVEMENT MARKING-STA. 583+00 TO STA. 594+00 HWY 84  | PMD-6                                | 80                               |
| SUMMARY OF QUANTITIES (TRAFFIC SIGNAL)                               | TSQ-1    | 22      | PAVEMENT MARKING-STA. 594+00 TO STA. 605+00 HWY 84  | PMD-7                                | 81                               |
| DIRECTIONAL SIGN QUANTITIES  | DSQ-1    | 23      | PAVEMENT MARKING-STA. 605+00 TO STA. 616+00 HWY 84  | PMD-8                                | 82                               |
| DIRECTIONAL SIGN QUANTITIES  | DSQ-2    | 24      | PAVEMENT MARKING-STA. 616+00 TO STA. 627+00 HWY 84  | PMD-9                                | 83                               |
| STANDARD ROADSIDE SIGN QUANTITIES                                    | SRS-1A   | 25      | PAVEMENT MARKING-STA. 627+00 TO STA. 638+00 HWY 84  | PMD-10                               | 84                               |
| STANDARD ROADSIDE SIGN QUANTITIES                                    | SRS-1B   | 26      | PAVEMENT MARKING-STA. 638+00 TO STA. 649+00 HWY 84  | PMD-10A                              | 85                               |
| STANDARD ROADSIDE SIGN QUANTITIES                                    | SRS-1C   | 27      | PAVEMENT MARKING-NE LOOP & NE RAMPS   | PMD-10B                              | 86                               |
| STANDARD ROADSIDE SIGN QUANTITIES                                    | SRS-2    | 28      | PAVEMENT MARKING-STA. 1377+00 TO STA. 1389+00 HWY 49  | PMD-10C                              | 87                               |
| ESTIMATED QUANTITIES   | EQ-1     | 29      | PAVEMENT MARKING-STA. 1389+00 TO STA. 1402+00 HWY 49  | PMD-10D                              | 88                               |
| ESTIMATED QUANTITIES   | EQ-2     | 29.1    | PAVEMENT MARKING-STA. 638+00 TO STA. 649+00 HWY 84  | PMD-11                               | 89                               |
| ESTIMATED QUANTITIES   | EQ-3     | 29.2    | PAVEMENT MARKING-NE LOOP & NE RAMPS   | PMD-11A                              | 90                               |
| ESTIMATED QUANTITIES   | EQ-4     | 29.3    | PAVEMENT MARKING-STA. 649+00 TO STA. 660+00 HWY 84  | PMD-12                               | 91                               |
| ESTIMATED QUANTITIES FOR TRAFFIC CONTROL                             | TCPQ-1   | 30      | PAVEMENT MARKING-STA. 660+00 TO STA. 671+00 HWY 84  | PMD-13                               | 92                               |
| PLAN & PROFILE SHEETS (33)   |          |         | PAVEMENT MARKING-STA. 671+00 TO STA. 682+00 HWY 84  | PMD-14                               | 93                               |
| HWY 84, LT. LANE-STA. 531+00 TO STA. 561+00                          | 3LT      | 31      | PAVEMENT MARKING-STA. 682+00 TO STA. 693+00 HWY 84  | PMD-15                               | 94                               |
| HWY 84, RT. LANE-B.O.P. TO STA. 560+00                               | 3RT      | 32      | PAVEMENT MARKING-STA. 693+00 TO STA. 704+00 HWY 84  | PMD-16                               | 95                               |
| TEMP. CONNECTION NEAR B.O.P.   | 3A       | 33      | PAVEMENT MARKING-STA. 704+00 TO STA. 715+00 HWY 84  | PMD-17                               | 96                               |
| LOCAL RD @ STA. 543+25 ML  | 3B       | 34      | PAVEMENT MARKING-STA. 715+00 TO STA. 726+00 HWY 84  | PMD-18                               | 97                               |
| RAMP & TEMP. CONNECTION ON L.R.                                      | 3C       | 35      | PAVEMENT MARKING-STA. 28+00 TO STA. 37+00 LOCAL ROAD  | PMD-18A                              | 98                               |
| TEMPORARY CONNECTION   | 3D       | 36      | PAVEMENT MARKING-STA. 726+00 TO STA. 732+63 HWY 84  | PMD-19                               | 99                               |
| HWY 84, LT. LANE-STA. 561+00 TO STA. 590+00                          | 4LT      | 37      | DETAILS OF CONSTRUCTION SIGNING   | DCS-1                                | 100                              |
| HWY 84, RT. LANE-STA. 560+00 TO STA. 590+00                          | 4RT      | 38      | TRAFFIC CONTROL PROJECT OVERVIEW PHASE 1  | TC-1                                 | 100.01                           |
| LOCAL RD. @ STA. 563+42.69 ML  | 4A       | 39      | TRAFFIC CONTROL NEAR B.O.P. PHASE 1   | TC-2                                 | 100.02                           |
| LOCAL RD. @ STA. 578+00 ML   | 4B       | 40      | TRAFFIC CONTROL L.R. @ STA. 563+42.69 ML & L.R. @ STA. 578+00.00 ML PHASE 1   | TC-3                                 | 100.03                           |
| HWY 84, LT. LANE-STA. 590+00 TO STA. 620+00                          | 5LT      | 41      | TRAFFIC CONTROL HWY 49 UP TO STA. 1382+00 PHASE 1   | TC-4                                 | 100.04                           |
| HWY 84, RT. LANE-STA. 590+00 TO STA. 620+00                          | 5RT      | 42      | TRAFFIC CONTROL HWY 49 BEYOND STA. 1382+00 PHASE 1  | TC-5                                 | 100.05                           |
| HWY 84, LT. LANE-STA. 620+00 TO STA. 650+00                          | 6LT      | 43      | TRAFFIC CONTROL NEAR E.O.P. PHASE 1   | TC-6                                 | 100.06                           |
| HWY 84, RT. LANE-STA. 620+00 TO STA. 650+00                          | 6RT      | 44      | TRAFFIC CONTROL PROJECT OVERVIEW PHASE 2  | TC-7                                 | 100.07                           |
| HWY 84, & HWY 49, INTERCHANGE  | 6A       | 45      | TRAFFIC CONTROL NEAR B.O.P. PHASE 2   | TC-8                                 | 100.08                           |
| SW RAMP  | 6B       | 46      | TRAFFIC CONTROL NEAR B.O.P. PHASE 2   | TC-9                                 | 100.09                           |
| SW LOOP & SW RAMP CONNECTION   | 6C       | 47      | TRAFFIC CONTROL DETAILS NEAR B.O.P. PHASE 2   | TC-10                                | 100.10                           |
| NW RAMP  | 6D       | 48      | TRAFFIC CONTROL L.R. @ STA. 563+42.69 ML & L.R. @ STA. 578+00.00 ML PHASE 2   | TC-11                                | 100.11                           |
| NE RAMP  | 6E       | 49      | TRAFFIC CONTROL HWY 49 UP TO STA. 1382+00 PHASE 2   | TC-12                                | 100.12                           |
| NW LOOP & NW RAMP CONNECTION   | 6F       | 50      | TRAFFIC CONTROL HWY 49 BEYOND STA. 1382+00 PHASE 2  | TC-13                                | 100.13                           |
| SE RAMP  | 6G       | 51      | TRAFFIC CONTROL NEAR E.O.P. PHASE 2   | TC-14                                | 100.14                           |
| HWY 49-STA. 1365+00 TO STA. 1384+00                                  | 6H       | 52      |   |                                      |                                  |
| HWY 49-STA. 1384+00 TO STA. 1401+99.996                              | 6I       | 53      |   |                                      |                                  |
| ORA-WILLIAMSBURG RD.   | 6J       | 54      |   |                                      |                                  |
| SUNSET RD.   | 6K       | 55      |   |                                      |                                  |
| HWY 84, LT. LANE-STA. 650+00 TO STA. 680+00                          | 7LT      | 56      |   |                                      |                                  |
| HWY 84, RT. LANE-STA. 650+00 TO STA. 680+00                          | 7RT      | 57      |   |                                      |                                  |

PLAN ROADWAY DESIGN DIVISION MISSISSIPPI DEPARTMENT OF TRANSPORTATION 4/26/2007 10:01 AM I:INDEX.DGN

**FMS CONSTR. NO.: 102069 / 302000**

|                            |                            |     |
|----------------------------|----------------------------|-----|
| PS & E PLANS-DATE 06/15/06 |                            |     |
| REVISIONS                  |                            |     |
| DATE                       | SHEET NO.                  | BY  |
| 2-01-07                    | 1, 2, 3.1, 18-20,          |     |
|                            | 100.01, 100.07, 100.19     | GSW |
| 4-26-07                    | 1, 3.1, 12, 18, 19, 20, 22 | BRB |

**R. SUTTERFIELD**

|  |              |         |                |
|--|--------------|---------|----------------|
| MISSISSIPPI DEPARTMENT OF TRANSPORTATION |              |         |                |
| <b>DETAILED INDEX</b>                    |              |         |                |
| PROJECT NO. NH-0015-02(114)PH3           |              |         | WORKING NUMBER |
| COUNTY : COVINGTON                       |              |         | DI-1           |
| FILENAME: INDEX.DGN                      | SHEET NUMBER |         | 2              |
| DESIGN TEAM                              | MOREA        | CHECKED | DATE           |

1st O. REV.

|       |                    |
|-------|--------------------|
| STATE | PROJECT NO.        |
| MISS. | NH-0015-02(114)PH3 |

| DESCRIPTION OF SHEET  | REVISION DATE | WKG. NO.  | SH. NO.   | DESCRIPTION OF SHEET | WKG. NO. | SH. NO. |
|---|---------------|-----------|-----------|----------------------|----------|---------|
| SUPERELEVATION TRANSITION - CASE I (2% NORMAL SUBGRADE)   | 03-01-02      | SE-2A     | 276       |                      |          |         |
| SUPERELEVATION TRANSITION - CASE I ROTATION ABOUT CENTERLINE (URBAN FACILITY, V = 50 mph/h)                 | 03-01-02      | SE-2E     | 280       |                      |          |         |
| SUPERELEVATION TRANSITION ROTATION ABOUT CENTERLINE (URBAN FACILITY, < 45 mph/h)                            |               | SF-2G     | 282       |                      |          |         |
| INTERCHANGE DESIGN FOR HIGH SPEED TAPERED EXIT RAMP   |               | IR-1      | 283       |                      |          |         |
| INTERCHANGE DESIGN FOR HIGH SPEED PARALLEL EXIT RAMP  | 03-01-02      | IR-1A     | 284       |                      |          |         |
| INTERCHANGE DESIGN FOR LOOP ENTRANCE RAMP   |               | IR-2      | 285       |                      |          |         |
| INTERCHANGE DESIGN FOR HIGH SPEED PARALLEL ENTRANCE RAMP  | 03-01-02      | IR-2A     | 286       |                      |          |         |
| DRIVEWAYS, CURB & GUTTER, & SIDEWALK  |               | SD-1      | 287       |                      |          |         |
| DRIVEWAYS, INTEGRAL CURB, & SIDEWALK  |               | SD-2      | 288       |                      |          |         |
| MISCELLANEOUS DETAIL SHEET 1. STACKED PIPE JOINT  |               |           |           |                      |          |         |
| 2. EXCAVATION AT GRADE POINTS   |               | MDS-1     | 290       |                      |          |         |
| DETAILS OF PAVED FLUMES   |               | PF-1      | 291       |                      |          |         |
| PIPE CULVERT INSTALLATION   |               | PI-1      | 300       |                      |          |         |
| PIPE COLLAR - CONCRETE  |               | PC-1      | 301       |                      |          |         |
| TYPE I MEDIAN INLET   | 03-01-02      | MI-1      | 306       |                      |          |         |
| DETAILS OF GRATES FOR MEDIAN INLETS   |               | IG-1      | 314       |                      |          |         |
| DETAILS OF GRATES FOR GUTTER INLETS   |               | IG-2      | 315       |                      |          |         |
| GUTTER INLET FOR TYPE 2 CURB (OUTLET 90° TO ROADWAY)  |               | GI-1      | 316       |                      |          |         |
| PAVED INLET APRON AND MEDIAN DITCH PLUG   |               | PA-1      | 318       |                      |          |         |
| FLARED END SECTION FOR CONCRETE PIPE  |               | FE-1      | 328       |                      |          |         |
| STANDARD DRAWINGS - BRIDGE SHEETS (19)  |               |           |           |                      |          |         |
| BOX CULVERT DRAWING - BARREL JOINT LOCATIONS - NORMAL & SKEWED CULVERTS GROUP I DIAGRAMS                    |               | IBJL-1    | 366.1     |                      |          |         |
| BOX CULVERT DRAWING - BARREL JOINT LOCATIONS - NORMAL & SKEWED CULVERTS GROUP II DIAGRAMS                   |               | IBJL-1    | 366.2     |                      |          |         |
| BOX CULVERT DRAWING - BARREL JOINT LOCATIONS - NORMAL & SKEWED CULVERTS GROUP III DIAGRAMS                  |               | IBJL-1    | 366.3     |                      |          |         |
| COLLAR DETAILS FOR BOX STRUCTURES (SINGLE, DOUBLE, TRIPLE, AND QUADRUPLE)                                   |               | ICJ-1     | 367       |                      |          |         |
| SKEWED COLLAR DETAILS FOR BOX STRUCTURES (SINGLE, DOUBLE, TRIPLE, AND QUADRUPLE)                            |               | ICJS-1    | 368       |                      |          |         |
| BASIC CULVERT DRAWING - SINGLE CELL, HEIGHT - 10 FT., SPANS - 10-22 FT., SHEET 1 OF 2                       |               | IBS-10-2W | 372.1     |                      |          |         |
| BASIC CULVERT DRAWING - SINGLE CELL, HEIGHT - 10 FT., SPANS - 10-22 FT., SHEET 2 OF 2                       |               | IBS-10-2W | 372.2     |                      |          |         |
| WINGS WITH 3:1 SLOPE FOR BASIC CULVERT DRAWING, SINGLE CELL, HEIGHT 6-12 FT., SPANS 6-24 FT., SHEET 1 OF 3  |               | IWS-3     | 374       |                      |          |         |
| WINGS WITH 3:1 SLOPE FOR BASIC CULVERT DRAWING, SINGLE CELL, HEIGHT 6-12 FT., SPANS 6-24 FT., SHEET 2 OF 3  |               | IWS-3     | 375.1     |                      |          |         |
| WINGS WITH 3:1 SLOPE FOR BASIC CULVERT DRAWING, SINGLE CELL, HEIGHT 6-12 FT., SPANS 6-24 FT., SHEET 3 OF 3  |               | IWS-3     | 375.2     |                      |          |         |
| BASIC CULVERT DRAWING - DOUBLE CELL, HEIGHT - 6 FT., SPANS - 12-32 FT., SHEET 1 OF 2                        |               | IBD-6-2W  | 383.1     |                      |          |         |
| BASIC CULVERT DRAWING - DOUBLE CELL, HEIGHT - 6 FT., SPANS - 12-32 FT., SHEET 2 OF 2                        |               | IBD-6-2W  | 383.2     |                      |          |         |
| WINGS WITH 3:1 SLOPE FOR BASIC CULVERT DRAWING, DOUBLE CELL, HEIGHT 6-12 FT., SPANS 12-40 FT., SHEET 1 OF 3 |               | IWD-3     | 387       |                      |          |         |
| WINGS WITH 3:1 SLOPE FOR BASIC CULVERT DRAWING, DOUBLE CELL, HEIGHT 6-12 FT., SPANS 12-40 FT., SHEET 2 OF 3 |               | IWD-3     | 388.1     |                      |          |         |
| WINGS WITH 3:1 SLOPE FOR BASIC CULVERT DRAWING, DOUBLE CELL, HEIGHT 6-12 FT., SPANS 12-40 FT., SHEET 3 OF 3 |               | IWD-3     | 388.2     |                      |          |         |
| BOX CULVERT DRAWING IBD CULVERTS MODIFIED FOR HIGH COVER WINGS WITH 3:1 SLOPE, SHEET 1 OF 2                 |               | IBDM-3W   | 393       |                      |          |         |
| BOX CULVERT DRAWING IBD CULVERTS MODIFIED FOR HIGH COVER WINGS WITH 3:1 SLOPE, SHEET 2 OF 2                 |               | IBDM-3W   | 394       |                      |          |         |
| BOX CULVERT DRAWING 30° SKEW DETAILS, WINGS WITH 3:1 SLOPE, SINGLE & DOUBLE CELL CULVERTS, 1 OF 2           |               | ISK-30-3W | 400.1     |                      |          |         |
| BOX CULVERT DRAWING 30° SKEW DETAILS, WINGS WITH 3:1 SLOPE, SINGLE & DOUBLE CELL CULVERTS, 2 OF 2           |               | ISK-30-3W | 400.2     |                      |          |         |
|   |               |           | 901-903   |                      |          | ▲       |
|   |               |           | 967-970   |                      |          | ▲       |
|   |               |           | 1018-1020 |                      |          | ▲       |
|   |               |           | 1044-1047 |                      |          | ▲       |
| CROSS SECTIONS (14)   |               |           |           |                      |          |         |
| TOTAL SHEETS (283)  |               |           |           |                      |          | ▲ ▲     |

4/26/2007 10:01 AM INDEX.DGN MISSISSIPPI DEPARTMENT OF TRANSPORTATION

|  |           |              |                |
|--|-----------|--------------|----------------|
| MISSISSIPPI DEPARTMENT OF TRANSPORTATION |           |              |                |
| <b>DETAILED INDEX</b>                    |           |              |                |
| PROJECT NO. NH-0015-02(114)PH3           |           |              | WORKING NUMBER |
| COUNTY : COVINGTON                       |           |              | DI-3           |
| DATE                                     | INDEX.DGN | SHEET NUMBER |                |
| 4-26-07                                  | INDEX.DGN | 3.1          |                |
| 2-13-07                                  | INDEX.DGN | 3.1          |                |
| REVISION                                 | BY        | DATE         |                |
| REVISED SHEET TOTAL                      | CSW       | DATE         |                |
| REVISE SHEET TOTAL                       | BRB       | DATE         |                |

DESCRIPTION OF SHEET

WKG. NO. SH. NO.

|   |        |        |
|---|--------|--------|
| TRAFFIC CONTROL DETAILS NEAR E.O.P. PHASE 2                                 | TC-15  | 100.15 |
| TRAFFIC CONTROL DETAILS NEAR E.O.P. PHASE 2                                 | TC-16  | 100.16 |
| TRAFFIC CONTROL DETAILS NEAR E.O.P. PHASE 2                                 | TC-17  | 100.17 |
| TRAFFIC CONTROL DETAILS NEAR E.O.P. PHASE 2                                 | TC-18  | 100.18 |
| TRAFFIC CONTROL PROJECT OVERVIEW PHASE 3                                    | TC-19  | 100.19 |
| TRAFFIC CONTROL NEAR B.O.P. PHASE 3   | TC-20  | 100.20 |
| TRAFFIC CONTROL NEAR B.O.P. PHASE 3   | TC-21  | 100.21 |
| TRAFFIC CONTROL NEAR B.O.P. PHASE 3   | TC-22  | 100.22 |
| TRAFFIC CONTROL DETAILS NEAR B.O.P. PHASE 3                                 | TC-23  | 100.23 |
| TRAFFIC CONTROL DETAILS NEAR B.O.P. PHASE 3                                 | TC-24  | 100.24 |
| TRAFFIC CONTROL L.R. @ STA. 563+42.69 ML & L.R. @ STA. 578+00.00 ML PHASE 3 | TC-25  | 100.25 |
| TRAFFIC CONTROL NEAR E.O.P. PHASE 3   | TC-26  | 100.26 |
| TRAFFIC CONTROL NEAR E.O.P. PHASE 3   | TC-27  | 100.27 |
| TRAFFIC CONTROL DETAILS NEAR E.O.P. PHASE 3                                 | TC-28  | 100.28 |
| DRUM PLACEMENT & SHOULDER CLOSURE   | TC-29  | 100.29 |
| MISCELLANEOUS CONSTRUCTION DETAILS  | MCD-1  | 100.30 |
| PERMANENT SIGNING PLANS   | PSP-1  | 100.31 |
| PERMANENT SIGNING PLANS   | PSP-2  | 100.32 |
| PERMANENT SIGNING PLANS   | PSP-3  | 100.33 |
| PERMANENT SIGNING PLANS   | PSP-4  | 100.34 |
| PERMANENT SIGNING PLANS   | PSP-4A | 100.35 |
| PERMANENT SIGNING PLANS   | PSP-4B | 100.36 |
| PERMANENT SIGNING PLANS   | PSP-4C | 100.37 |
| PERMANENT SIGNING PLANS   | PSP-4D | 100.38 |
| PERMANENT SIGNING PLANS   | PSP-5  | 100.39 |
| PERMANENT SIGNING PLANS   | PSP-6  | 100.40 |
| PERMANENT SIGNING PLANS   | PSP-7  | 100.41 |
| PERMANENT SIGNING PLANS   | PSP-8  | 100.42 |
| PERMANENT SIGNING PLANS   | PSP-9  | 100.43 |
| PERMANENT SIGNING DETAILS   | PSD-1  | 100.44 |
| PERMANENT SIGNING DETAILS   | PSD-2  | 100.45 |
| PERMANENT SIGNING DETAILS   | PSD-3  | 100.46 |
| PERMANENT SIGNING DETAILS   | PSD-4  | 100.47 |
| PERMANENT SIGNING DETAILS   | PSD-5  | 100.48 |
| PERMANENT SIGNING DETAILS   | PSD-6  | 100.49 |
| PERMANENT SIGNING DETAILS   | PSD-7  | 100.50 |
| PERMANENT SIGNING DETAILS   | PSD-8  | 100.51 |
| PERMANENT SIGNING DETAILS   | PSD-9  | 100.52 |
| PERMANENT SIGNING DETAILS   | PSD-10 | 100.53 |
| PERMANENT SIGNING DETAILS   | OH-1   | 100.54 |
| PERMANENT SIGNING DETAILS   | OH-2   | 100.55 |
| TRAFFIC SIGNAL PLANS  | TSI-1  | 100.56 |
| TRAFFIC SIGNAL PLANS  | TSI-1A | 100.57 |
| TRAFFIC SIGNAL PLANS  | TSI-2  | 100.58 |
| TRAFFIC SIGNAL PLANS  | TSI-2A | 100.59 |
| TRAFFIC SIGNAL DETAILS  | TSD-1  | 100.60 |
| TRAFFIC SIGNAL DETAILS  | TSD-2  | 100.61 |
| TRAFFIC SIGNAL DETAILS  | TSD-3  | 100.62 |
| TRAFFIC SIGNAL DETAILS  | TSD-4  | 100.63 |
| TRAFFIC SIGNAL DETAILS  | TSD-5  | 100.64 |
| TRAFFIC SIGNAL DETAILS  | TSD-6  | 100.65 |
| FORM GRADES - SE RAMP EXIT (DIAMOND INTERCHANGE)                            | FG-1   | 100.66 |
| FORM GRADES - SE RAMP EXIT (DIAMOND INTERCHANGE)                            | FG-2   | 100.67 |
| FORM GRADES - SE RAMP EXIT (DIAMOND INTERCHANGE)                            | FG-3   | 100.68 |
| FORM GRADES - SE RAMP EXIT (DIAMOND INTERCHANGE)                            | FG-4   | 100.69 |
| FORM GRADES - SE RAMP EXIT (DIAMOND INTERCHANGE)                            | FG-5   | 100.70 |
| FORM GRADES - SE RAMP EXIT (DIAMOND INTERCHANGE)                            | FG-6   | 100.71 |
| FORM GRADES - SE RAMP EXIT (DIAMOND INTERCHANGE)                            | FG-7   | 100.72 |
| FORM GRADES - SE RAMP EXIT (DIAMOND INTERCHANGE)                            | FG-8   | 100.73 |
| FORM GRADES - SE RAMP EXIT (DIAMOND INTERCHANGE)                            | FG-9   | 100.74 |
| FORM GRADES - SE RAMP EXIT (DIAMOND INTERCHANGE)                            | FG-10  | 100.75 |
| GUARDRAIL: BRIDGE END SECTION TYPE "1" (WOOD POSTS)                         | GR-2F  | 100.76 |
| GUARDRAIL: BRIDGE END SECTION, TYPE "1" (STEEL POSTS)                       | GR-2G  | 100.77 |
| GUARDRAIL: RUB RAIL HARDWARE SHEET  | GR-RR  | 100.78 |
| EDGE DRAIN DETAILS  | EDD-1  | 100.79 |
| EDGE DRAIN DETAILS  | EDD-2  | 100.80 |
| DETAILS OF RUMBLE STRIPS (GROUND-IN)  | RS-1   | 100.81 |

DESCRIPTION OF SHEET

REVISION DATE WKG. NO. SH. NO.

|  |        |     |
|--|--------|-----|
| STANDARD DRAWINGS - ROADWAY SHEETS (64)  |        |     |
| BRIDGE END PAVEMENT  | BE-1   | 107 |
| PAVEMENT MARKING DETAILS FOR 2 & 4-LANE DIVIDED ROADWAYS   | PM-1   | 120 |
| PAVEMENT MARKING DETAILS FOR INTERCHANGE ENTRANCE RAMP   | PM-3   | 122 |
| PAVEMENT MARKING DETAILS FOR INTERCHANGE EXIT RAMP   | PM-4   | 123 |
| PAVEMENT MARKING LEGEND DETAILS  | PM-5   | 124 |
| PAVEMENT MARKING LEGEND DETAILS  | PM-6   | 125 |
| EROSION CONTROL  | EC-1   | 140 |
| TYPICAL TEMPORARY EROSION CONTROL MEASURES (SILT FENCE, HAY BALES, & BRUSH BARRIER)  | TEC-1  | 142 |
| TYPICAL TEMPORARY EROSION CONTROL MEASURES (SLOPE DRAIN AND TYPE A SILT BASIN)   | TEC-2  | 143 |
| DETAILS OF DITCH TREATMENT   | DT-1   | 145 |
| GUARD RAIL: "W" BEAM (WOOD POSTS)  | GR-1   | 180 |
| GUARD RAIL: THRIE BEAM (WOOD POSTS)  | GR-1A  | 181 |
| GUARD RAIL: "W" BEAM (STEEL POSTS)   | GR-1B  | 182 |
| GUARD RAIL : TYPICAL INSTALLATION AT BRIDGE APPROACHES   | GR-1C  | 183 |
| FOR DIVIDED HIGHWAYS   | GR-4   | 194 |
| GUARD RAIL : TYPICAL INSTALLATION AT BRIDGE APPROACHES FOR 2-LANE, 2-WAY HIGHWAYS  | GR-4A  | 195 |
| GUARD RAIL : MISCELLANEOUS HARDWARE  | GR-HW  | 202 |
| STANDARD DIRECTIONAL (GUIDE) SIGNS   | SN-1   | 220 |
| ROUTE SHIELDS AND "EXIT ONLY" PANELS   | SN-2   | 221 |
| STANDARD ROADSIDE SIGNS  | SN-3   | 222 |
| STANDARD ROADSIDE SIGNS  | SN-3A  | 223 |
| STANDARD ROADSIDE SIGNS  | SN-3B  | 224 |
| STANDARD ROADSIDE SIGN ASSEMBLY AND INSTALLATION   | SN-4   | 225 |
| STANDARD ROADSIDE SIGN ASSEMBLY AND INSTALLATION   | SN-4A  | 226 |
| STANDARD ROADSIDE SIGN ASSEMBLY AND INSTALLATION   | SN-4B  | 227 |
| TYPICAL INSTALLATION OF GROUND MOUNTED DIRECTIONAL SIGNS   | SN-5   | 228 |
| BREAK-AWAY SIGN SUPPORTS   | SN-6   | 229 |
| BREAK-AWAY SIGN SUPPORTS   | SN-6A  | 230 |
| BREAK-AWAY SIGN SUPPORTS   | SN-6B  | 231 |
| SIGN FACE CONSTRUCTION & ATTACHMENT OF GROUND MOUNTED DIRECTIONAL SIGNS TO STEEL BEAMS (EXTRUDED ALUMINUM PANELS)            | SN-7   | 232 |
| TYPICAL INSTALL. & DETAILS OF DELINEATORS & DISTANCE REFERENCE SIGNS   | SN-8   | 233 |
| TYPICAL INSTALLATION OF DELINEATORS  | SN-8A  | 234 |
| TYPICAL CROSSOVER DELINATION   | SN-8B  | 235 |
| TYPICAL GURADRAIL DELINATION   | SN-8C  | 236 |
| TRAFFIC CONTROL PLAN WITH FLAGGER (1-LANE CLOSURE OF 2-WAY TRAFFIC)  | TCP-1  | 250 |
| TRAFFIC CONTROL PLAN (4-LANE: MEDIAN OR OUTSIDE LANE CLOSURE) (WORK DAY ONLY)  | TCP-2  | 251 |
| TRAFFIC CONTROL PLAN (4-LANE: MEDIAN OR OUTSIDE LANE CLOSURE) (EXTENDED PERIOD)  | TCP-3  | 252 |
| TRAFFIC CONTROL PLAN (INTERSTATES AND OTHER 4-LANE DIVIDED HIGHWAYS) (MEDIAN LANE OR OUTSIDE LANE CLOSURE) (EXTENDED PERIOD) | TCP-4  | 253 |
| TRAFFIC CONTROL PLAN (INTERSTATES AND OTHER 4-LANE DIVIDED HIGHWAYS) (MEDIAN LANE OR OUTSIDE LANE CLOSURE) (WORK DAY ONLY)   | TCP-5  | 254 |
| HIGHWAY SIGN AND BARRICADE DETAILS FOR CONSTRUCTION PROJECTS   | TCP-10 | 259 |
| TRAFFIC CONTROL PLAN MOBILE OPERATIONS MULTILANE ROADS AND TWO-LANE ROADS  | TCP-11 | 260 |
| DETAILS OF OUTSIDE LANE CLOSURE AT EXIT AND ENTRANCE RAMP  | TCP-12 | 261 |
| TRAFFIC CONTROL PLAN FOR TEMPORARY CONSTRUCTION CROSSOVER (WORK DAY ONLY)  | TCP-13 | 262 |
| TRAFFIC CONTROL PLANS UNEVEN PAVEMENT DETAILS  | TCP-14 | 263 |
| TEMPORARY STRIPING FOR TRAFFIC CONTROL 2-LANE & 4-LANE DIVIDED HWYS.   | TCP-15 | 264 |

11/15/2006 1:01:56 PM INDEX.DGN MISSISSIPPI DEPARTMENT OF TRANSPORTATION ROADWAY PLAN DIVISION

|  |             |           |                |
|--|-------------|-----------|----------------|
| MISSISSIPPI DEPARTMENT OF TRANSPORTATION |             |           |                |
| <b>DETAILED INDEX</b>                    |             |           |                |
| PROJECT NO. NH-0015-02(114)PH3           |             |           | WORKING NUMBER |
| COUNTY : COVINGTON                       |             |           | DI-2           |
| DATE                                     | FILENAME:   | INDEX.DGN | SHEET NUMBER   |
|  | DESIGN TEAM | MOREA     | 3              |
|  | CHECKED     |           |                |
|  | DATE        |           |                |

## GENERAL NOTES

- ① THE LOCATION AND SPACING OF SIGNS, SHOWN ON THE TRAFFIC CONTROL PLANS, ARE APPROXIMATE AND MAY BE ADJUSTED AS NECESSARY TO FIT FIELD CONDITIONS.
- ② ALL TRAFFIC CONTROL DEVICES ON THIS PROJECT SHALL COMPLY WITH PART VI OF THE MUTCD (LATEST EDITION).
- ③ PRIOR TO POURING PAVED ISLANDS, THE TRAFFIC ENGINEERING DIVISION SHALL BE NOTIFIED SO THAT SIGNS REQUIRED IN ISLANDS CAN BE LOCATED.
- ④ THE 25% SHRINKAGE FACTOR USED IN EARTHWORK CALCULATIONS IS FOR DESIGN ESTIMATING PURPOSES ONLY.
- ⑤ UTILITIES ON THE DRAWINGS ARE SHOWN IN THEIR ORIGINAL LOCATION BASED UPON THE BEST INFORMATION AVAILABLE TO THE ENGINEER. UTILITIES THAT WERE FOUND TO BE IN CONFLICT WITH CONSTRUCTION HAVE BEEN RELOCATED. PERMITS ARE ON FILE WITH THE DEPARTMENT SHOWING THE APPROXIMATE LOCATION OF UTILITIES RELOCATED WITHIN THE RIGHT-OF-WAY. THE ENGINEER CAN NOT AND DOES NOT WARRANT THAT THIS INFORMATION IS COMPLETE OR ACCURATE. THE CONTRACTOR MUST COORDINATE DIRECTLY WITH THE INVOLVED UTILITY OWNERS TO HAVE UNDERGROUND UTILITY LINES FIELD LOCATED IN ADVANCE OF CONSTRUCTION.
- ⑥ SOME WORK IS REQUIRED OUTSIDE THE PROJECT LIMITS, BEYOND THE B.O.P. AND E.O.P. NO ADDITIONAL COMPENSATION WILL BE MADE FOR SUCH WORK EXCEPT AS PROVIDED BY SPECIFIC PAY ITEMS SHOWN ON THE PLANS.
- ⑦ FLUORESCENT ORANGE SHEETING SHALL BE USED ON ALL CONSTRUCTION AND TRAFFIC CONTROL SIGNS EXCEPT FOR THOSE DESIGNATED ON THE PLANS TO BE BLACK LEGEND AND BORDER ON WHITE BACKGROUND.
- ⑧ THE CONTRACTOR SHALL COORDINATE WITH THE CONTRACTOR FROM ADJACENT PROJECTS IN IMPLEMENTING THE TRAFFIC CONTROL PLAN AS DIRECTED BY THE ENGINEER. ALL CONFLICTING SIGNS SHALL BE COVERED OR REMOVED AS DIRECTED BY THE ENGINEER.
- ⑨ WHERE MILLING OF THE ROADWAY LANES IS REQUIRED, THE CONTRACTOR SHALL PROVIDE OUTLETS IN THE EXISTING SHOULDERS AT SUFFICIENT INTERVALS TO PREVENT POOLING OR STANDING WATER ON THE MILLED SURFACE. (ABSORBED ITEM)
- ⑩ THE EROSION CONTROL DEVICES REFERENCED IN THESE PLANS ARE A MINIMUM REQUIREMENT. IT IS THE RESPONSIBILITY OF THE CONTRACTOR TO INSURE THAT SILT DOES NOT LEAVE THE RIGHT-OF-WAY OR CONTAMINATE WATERS OF THE U.S. DURING CONSTRUCTION. THE CONTRACTOR SHALL SUBMIT AN EROSION CONTROL PLAN PRIOR TO COMMENCEMENT OF WORK AND MAINTAIN THE PLAN DURING CONSTRUCTION.
- ⑪ A SOIL PROFILE HAS BEEN PREPARED FOR THIS PROJECT USING SAMPLES TAKEN FROM HOLES AT THE LOCATIONS INDICATED IN THE TEST REPORTS. THIS SOIL PROFILE IS ON FILE IN THE DISTRICT OFFICES AND IS AVAILABLE FOR EXAMINATION. THE DEPARTMENT DOES NOT GUARANTEE THAT THE MATERIALS AS SHOWN IN THE REPORTS ARE NECESSARILY TO BE FOUND OUTSIDE THE TEST HOLES.
- ⑫ IT SHALL BE THE RESPONSIBILITY OF THE CONTRACTOR TO PROTECT EXISTING STRUCTURES SUCH AS PIPES, INLETS, APRONS, BRIDGES, ETC. FROM DAMAGE WHICH MIGHT OCCUR DURING CONSTRUCTION. EXTREME CARE SHALL BE EXERCISED IN UNDERCUT AREAS AND THE UNDERCUT DEPTH MAY BE ADJUSTED AT CROSS DRAINS, AS DIRECTED BY THE ENGINEER. THE CONTRACTOR SHALL REPLACE OR REPAIR, AS DIRECTED BY THE ENGINEER, ANY STRUCTURES DAMAGED DURING THE LIFE OF THE CONTRACT. NO PAYMENT WILL BE MADE FOR REPLACEMENT OR REPAIR OF DAMAGED ITEMS.
- ⑬ VOIDS CREATED BY THE REMOVAL OF POSTS, CONCRETE ANCHORS, FOOTINGS, ETC. SHALL BE BACKFILLED AND TAMPED IN ACCORDANCE WITH SECTION 203 OF THE MISSISSIPPI STANDARD SPECIFICATIONS FOR ROAD AND BRIDGE CONSTRUCTION.
- ⑭ FOR LIST OF PUBLIC UTILITIES, SEE WORKING SHEET NO. 3LT.
- ⑮ WORK ON STRUCTURES FOR THIS PROJECT REQUIRES EXCAVATION IN THE IMMEDIATE VICINITY OF TRAFFIC AND ADJACENT PROPERTIES, THEREFORE THE RISK OF A FAILURE OCCURRING DURING THE EXCAVATION REQUIRES THAT EXTREME CAUTION BE EXERCISED. IT SHALL BE THE CONTRACTOR'S RESPONSIBILITY TO PLACE WHAT BRACING, SHORING OR GROUND SUPPORT SYSTEM THAT IS DEEMED NECESSARY TO PREVENT A FAILURE AND PROTECT THE PERSONS WORKING NEAR THE EXCAVATION OR ANY STRUCTURE ADJACENT TO THE EXCAVATION. ALL COSTS FOR ANY PROTECTIVE MEASURES, INCLUDING THE MATERIALS AND LABOR FOR DESIGNING, DRAWING AND CONSTRUCTING THE FACILITY, SHALL BE INCLUDED IN THE PRICE BID FOR CONTRACT ITEMS.
- ⑯ ALL POST LENGTHS FOR SIGNS SHALL BE VERIFIED IN THE FIELD PRIOR TO FABRICATION.
- ⑰ ALL PLASTIC DRUMS SHALL HAVE A BALLASTING COLLAR MADE FROM RECYCLED TRUCK TIRES OR OTHER SUITABLE MATERIAL.
- ⑱ CONES (IF REQ'D.) SHALL BE NARROW PROFILE WITH A MINIMUM HEIGHT OF 28" AND A MINIMUM WEIGHT OF 10 POUNDS. CONES USED IN SPEED ZONES EQUAL TO OR GREATER THAN 45 MPH SHALL BE NARROW PROFILE WITH A MINIMUM HEIGHT OF 28" AND A MINIMUM WEIGHT OF 6.8 POUNDS. ALL CONES SHALL BE APPROVED BY THE ENGINEER PRIOR TO USE.
- ⑲ EXISTING EDGE DRAINS ON HWY. 84 NEAR E.O.P. AND/OR B.O.P. ARE TO BE REMOVED OR TIED IN TO NEW EDGE DRAINS DURING CONSTRUCTION.

11-15-2005 10:57 AM D:\NOTES\DN

|  |  |  |                |
|--|--|--|----------------|
|  |  | MISSISSIPPI DEPARTMENT OF TRANSPORTATION |                |
|  |  | <b>GENERAL NOTES</b>                     |                |
|  |  | PROJECT: NH-0015-02(114)PH3              | WORKING NUMBER |
|  |  | COUNTY: COVINGTON                        | GN-1           |
|  |  | FILENAME: gnotes.dgn                     | SHEET NUMBER   |
|  |  | DESIGN TEAM MOREA CHECKED DATE           | 4              |