

FOR DETAILED INDEX OF PLANS SEE SHEET NO. 2

DESCRIPTION	NUMBER OF SHEETS
TITLE SHEET	1
DETAILED INDEX	1
GENERAL NOTES	1
TYPICAL SECTIONS	3
QUANTITIES	2
PLAN AND PROFILES	2
SPECIAL DESIGN - ROADWAY ITEMS	12
BRIDGE DRAWINGS	2
SPECIAL DESIGN - BRIDGES	2
CROSS-SECTIONS	2
TOTAL SHEETS	20

STATE OF MISSISSIPPI

MISSISSIPPI DEPARTMENT OF TRANSPORTATION

PLAN AND PROFILE OF PROPOSED STATE HIGHWAY

FEDERAL AID PROJECT NO. NH-0002-08(013)MP

03-15-07

U.S. 45 FROM PRENTISS /ALCORN COUNTY LINE
TO MS 145 IN CORINTH
ALCORN COUNTY

FMS CON: 104667/301000

SCALES

PLAN	1 IN. = 100 FT.
PROFILE	HOR. 1 IN. = 100 FT.
	VERT. 1 IN. = 10 FT.
LAYOUT	1 IN. = FT.

B.O.P. 23+43.56

BRIDGE STRUCTURES REQ'D.

NONE

BOX BRIDGES REQ'D.

NONE

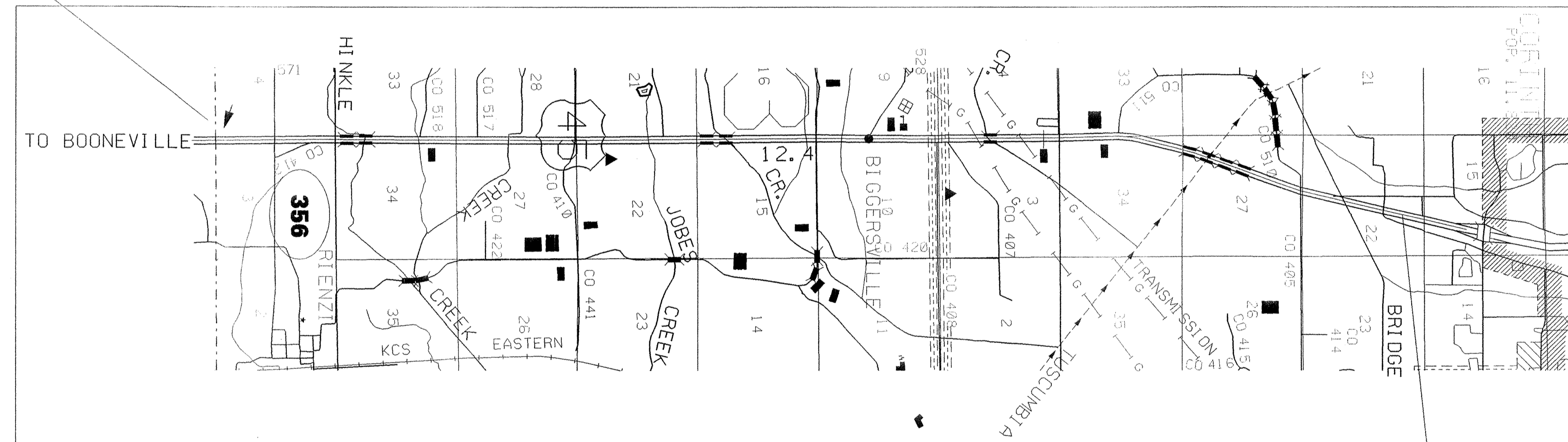

E.O.P. 93+00

FED. ROAD REG. NO.	STATE	PROJECT NO.	SHEET NO.
4	MISS.	NH-0002-08(013)MP	1

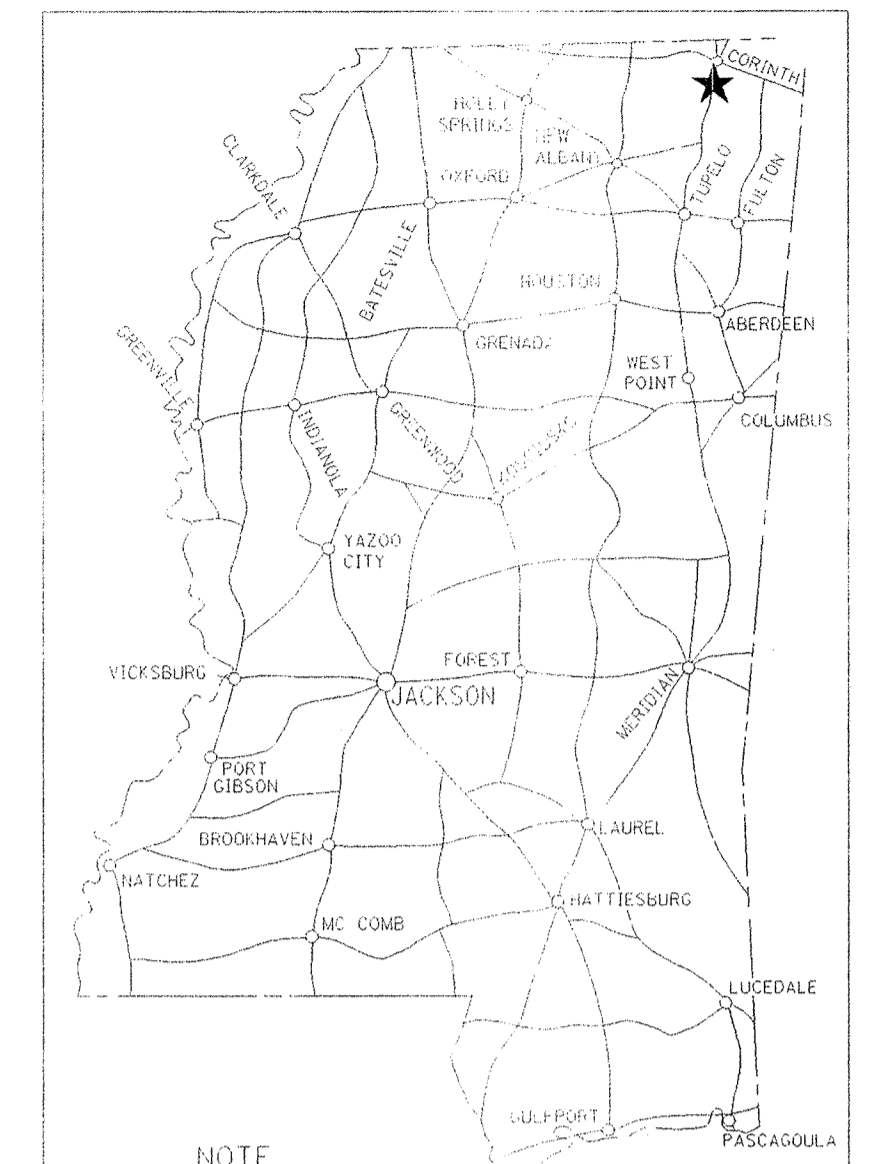

NOTE
★ INDICATES APPROXIMATE LOCATION OF PROJECT.
LAT. 34°49'18" N LONG. 88°33'32" W
(APPROX. MIDDLE OF PROJECT)

DESIGN CONTROL

MPH = V (SPEED DESIGN)

ADT () = : ADT () =
DHV = : D = % T = %

PERMITS ACQUIRED BY MDT

WETLANDS AND WATERS PERMITS (NECESSARY FOR ULTIMATE IMPROVEMENTS ONLY):

	WATERS	WETLANDS
NATIONWIDE #14	N	N
NATIONWIDE (OTHER)*	N	N
GENERAL*	N	N
INDIVIDUAL (404)*	N	N

* ACQUISITION OF PERMITS FOR TEMPORARY IMPACTS DURING CONSTRUCTION ARE THE RESPONSIBILITY OF THE CONTRACTOR

STORMWATER PERMIT N

Y REQUIRED, CWDI SUBMITTED BY MDT (DISTRIBUTED AREA = 5 ACRES + INTB 6484)
S REQUIRED, SCNDI TO BE SUBMITTED BY CONTRACTOR (1 TO 4.99 ACRES) (INTB 6483)
N NO STORMWATER PERMIT REQUIRED (<1 ACRE)

APPROVED BY: JCR DATE: 03/15/07

CONVENTIONAL SYMBOLS

- COUNTY LINE
- TOWN CORPORATION LINE
- SECTION LINE
- EXISTING ROAD OR TRAVELED WAY
- PROPOSED ROAD OR TRAVELED WAY
- RAILROAD
- SURVEY LINE
- BRIDGES

EQUATIONS

486 + 84.20 BK = 5 + 55.20 AH

LENGTH DATA

LENGTH OF ROADWAY	49,581.44 FT.	9.390 MI.
LENGTH OF BRIDGES	5,504.00 FT.	1.043 MI.
LENGTH OF PROJECT (NET)	55,085.44 FT.	10.433 MI.
LENGTH OF EXCEPTIONS		
LENGTH OF PROJECT (GROSS)	55,085.44 FT.	10.433 MI.

EXCEPTIONS

NONE

REVISIONS	DATE	BY	APPROVED:	DATE
			<i>Henry Lee James</i> CHIEF ENGINEER	3/15/07
			<i>Samuel R. Bean</i> EXECUTIVE DIRECTOR	3/15/07
MISSISSIPPI DEPARTMENT OF TRANSPORTATION				
APPROVED:				
DIVISION ADMINISTRATOR				DATE
FEDERAL HIGHWAY ADMINISTRATION				DATE
DEPARTMENT OF TRANSPORTATION				

3/20/2007 9:26 AM P:\TITLE SHEET.DGN

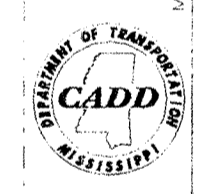

1 st O. REV.

STATE	PROJECT NO.
MISS.	NH-0002-08(013)MP



DESCRIPTION OF SHEET

REVISION DATE WKG. NO. SH. NO.

TITLE SHEET (1)			1
DETAILED INDEX (1)		DI-1	2
GENERAL NOTES (1)		GN-1	3
TYPICAL SECTION SHEETS (3)			
TYPICAL OVERLAY SECTION		TS-1	4
TYPICAL SECTION - MILLED SECTIONS AT BRIDGE ENDS AND B.O.P. AND E.O.P.		TS-2	5
TYPICAL SECTION - MILLED SECTIONS AT CHANNALIZED INTERSECTIONS		TS-3	6
QUANTITY SHEETS (2)			
SUMMARY OF QUANTITIES		SQ-1	7
SUMMARY OF QUANTITIES (GUARD RAIL)		EQ-1	8
SPECIAL DESIGN SHEETS (2)			
DETAIL OF CONSTRUCTION SIGNING		DCS-1	9
DETAIL RUMBLE STRIPES (GROUND IN)		RS-1	10
STANDARD DRAWINGS - ROADWAY SHEETS (10)			
PAVEMENT MARKING DETAILS FOR 2-LANE AND 4-LANE DIVIDED HIGHWAYS	(12-01-99)	PM-1	120
GUARDRAIL: "W" BEAM (WOOD POST)	(03-01-02)	GR-1	180
GUARDRAIL: "W" BEAM (STEEL POST)	(03-01-02)	GR-1B	182
GUARD RAIL MISCELLANOUS HARDWARE	(03-01-02)	GR-HW	202
TYPICAL GUARD RAIL DELINEATOR	(03-01-02)	SN-8C	236
TRAFFIC CONTROL PLAN FOR POSTED SPEED LIMIT OF 65 OR 70 MPH		TCP-4	253
TRAFFIC CONTROL PLAN FOR POSTED SPEED LIMIT OF 65 OR 70 MPH		TCP-5	254
HIGHWAY SIGN AND BARRICADE DETAILS FOR CONSTRUCTION PROJECTS		TCP-10	259
TRAFFIC CONTROL PLAN - MOBILE OPERATIONS - MULTILANE ROADS AND TWO-LANE ROADS	(12-01-99)	TCP-11	260
TEMPORARY STRIPING FOR TRAFFIC CONTROL	(12-01-99)	TCP-15	264
TOTAL SHEETS (20)			

DISTRICT

PS & E PLANS-DATE 03/15/07		
FMS CON. # 104667/301000		
REVISIONS		
DATE	SHEET NO.	BY
03/20/07	1, 2, 3	JCR
04/11/07	7	JCR
04/13/07	7	JCR

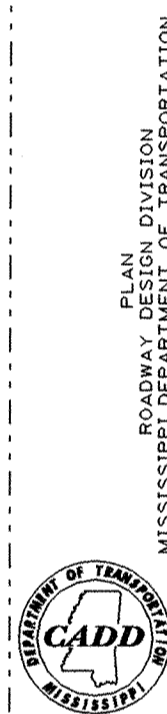

4/13/2007 2:53 PM P21INDEX.DGN

MISSISSIPPI DEPARTMENT OF TRANSPORTATION		110
DETAILED INDEX		
PROJECT NO.: NH-0002-08(013)MP		WORKING NUMBER
COUNTY : ALCORN		DI-1
FILENAME: INDEX.DGN	DESIGN TEAM	SHEET NUMBER
DATE: 03/20/07	CHECKED: _____	2
DATE: 7/28/05	DATE: 7/28/05	



GENERAL NOTES

1. WHERE MILLING OF THE ROADWAY IS REQUIRED, THE CONTRACTOR SHALL PROVIDE OUTLETS IN THE EXISTING SHOULDERS AT SUFFICIENT INTERVALS TO PREVENT POOLING OR STANDING WATER ON THE MILLED SURFACE. (ABSORBED ITEM)
2. 3/4" OF HOT MIX ASPHALT 9.5mm PRELEVELING TO BE PLACED ON MAIN LINE MILLED AREAS BEFORE TURNING TRAFFIC BACK ON IT.
3. THE LOCATION AND SPACING OF SIGNS, SHOWN ON THE TRAFFIC CONTROL PLANS, ARE APPROXIMATE AND MAY BE ADJUSTED AS NECESSARY TO FIT FIELD CONDITIONS.
4. ALL TRAFFIC CONTROL DEVICES ON THIS PROJECT SHALL COMPLY WITH PART VI OF THE MUTCD (LATEST EDITION).
5. FLUORESCENT ORANGE SHEETING SHALL BE USED ON ALL CONSTRUCTION AND TRAFFIC CONTROL SIGNS EXCEPT FOR THOSE DESIGNATED IN PLANS TO BE BLACK LEGEND AND BORDER ON WHITE BACKGROUND.
- ⚠ 6. ANY REFERENCE TO PROJECT NUMBER STP-0002-08(012) IS TO BE UNDERSTOOD THAT NH-0002-08(013)MP IS THE CORRECT PROJECT NUMBER.

PLAN ROADWAY DESIGN DIVISION MISSISSIPPI DEPARTMENT OF TRANSPORTATION
 3/20/2007 9:01 AM P3GENERAL NOTES.DGN

MISSISSIPPI DEPARTMENT OF TRANSPORTATION	
GENERAL NOTES	
PROJECT NO.: NH-0002-08(013)MP [⚠]	
COUNTY: ALCORN	
WORKING NUMBER GN-1	SHEET NUMBER 3
FILENAME: _____	CHECKED _____ DATE _____
DESIGN TEAM _____	DATE _____