

GENERAL INDEX

FOR DETAILED INDEX OF PLANS SEE SHEET NO. 2

DESCRIPTION	NUMBER OF SHEETS
TITLE SHEET	1
DETAILED INDEX	1
GENERAL NOTES	
TYPICAL SECTIONS	1
QUANTITIES	1
PLAN AND PROFILES	
SPECIAL DESIGN - ROADWAY ITEMS	8
BRIDGE DRAWINGS	0
SPECIAL DESIGN - BRIDGES	0
CROSS-SECTIONS	0
TOTAL SHEETS	12

①03-30-07

STATE OF MISSISSIPPI

MISSISSIPPI DEPARTMENT OF TRANSPORTATION

PLAN AND PROFILE OF PROPOSED STATE HIGHWAY STATE PROJECT NO. MP-1014-80(012)

SR 14 FROM ATTALA COUNTY LINE TO NEAR BURROUGHS ROAD WINSTON COUNTY

303218 / 301000

BRIDGE STRUCTURES REQ'D.

NONE

SCALES

PLAN	1 IN. = 100 FT.
PROFILE	HOR. 1 IN. = 100 FT.
	VERT. 1 IN. = 10 FT.
LAYOUT	1 IN. = FT.

BOX BRIDGES REQ'D.

NONE

B.O.P STA. 10+00

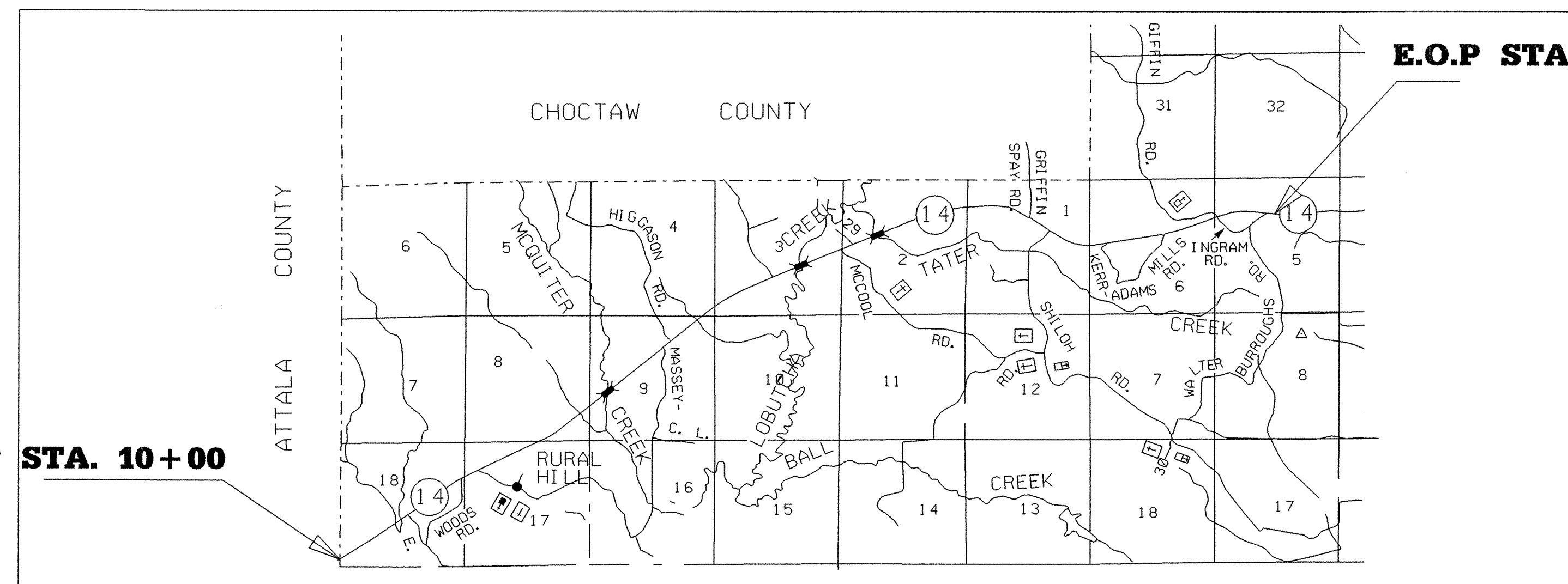

FED. ROAD REG. NO.	STATE	PROJECT NO.	SHEET NO.
4	MISS.	MP-1014-80(012)	1

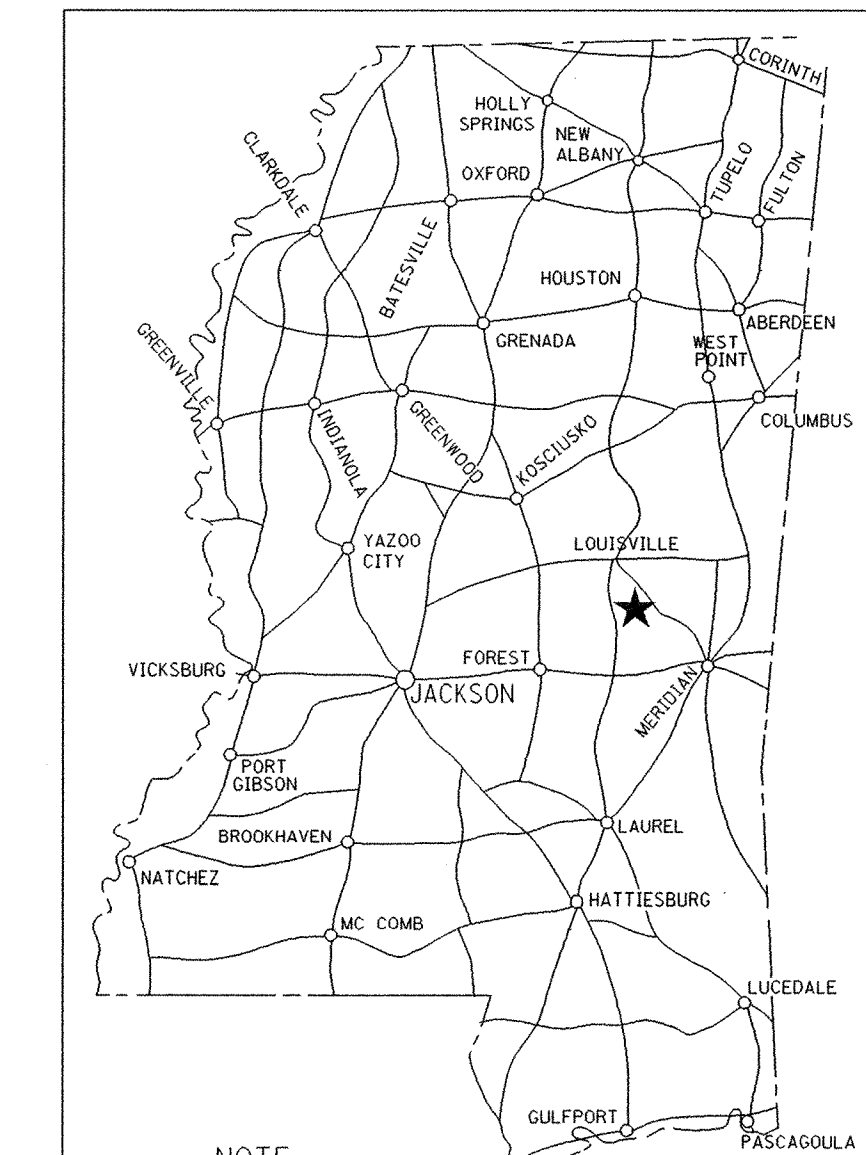

NOTE
★ INDICATES APPROXIMATE LOCATION OF PROJECT.
LAT. N 33° 06' LONG 89° 15' W
(APPROX. MIDDLE OF PROJECT)

DESIGN CONTROL

MPH = V (SPEED DESIGN)

ADT () = : ADT () =

DHV = : D = % T = %

PERMITS ACQUIRED BY MDOT

WETLANDS AND WATERS PERMITS (NECESSARY FOR ULTIMATE IMPROVEMENTS ONLY):

	WATERS	WETLANDS
NATIONWIDE #14	N	N
NATIONWIDE (OTHER)*	N	N
GENERAL*	N	N
INDIVIDUAL (404)*	N	N

* ACQUISITION OF PERMITS FOR TEMPORARY IMPACTS DURING CONSTRUCTION ARE THE RESPONSIBILITY OF THE CONTRACTOR

STORMWATER PERMIT	N
Y REQUIRED, CNOI SUBMITTED BY MDOT (DISTRIBUTED AREA=5 ACRES+(NTB 6484)	
S REQUIRED, SCNOI TO BE SUBMITTED BY CONTRACTOR (1 TO 4.99 ACRES)(NTB 6483)	
N NO STORMWATER PERMIT REQUIRED (<1 ACRE)	
APPROVED BY: JCR DATE: 03/30/07	

CONVENTIONAL SYMBOLS

- COUNTY LINE -----
- TOWN CORPORATION LINE -----
- SECTION LINE -----
- EXISTING ROAD OR TRAVELED WAY -----
- PROPOSED ROAD OR TRAVELED WAY -----
- RAILROAD -----
- SURVEY LINE -----
- BRIDGES -----

EQUATIONS

NONE

EXCEPTIONS

NONE

LENGTH DATA

LENGTH OF ROADWAY	44,402.00 FT.	8.409 MI.
LENGTH OF BRIDGES	478.00 FT.	0.091 MI.
LENGTH OF PROJECT (NET)	44,880.00 FT.	8.500 MI.
LENGTH OF EXCEPTIONS	0.00 FT.	0.000 MI.
LENGTH OF PROJECT (GROSS)	44,880.00 FT.	8.500 MI.

TITLE ROOM, DESIGN DIVISION, MISSISSIPPI DEPARTMENT OF TRANSPORTATION

3/30/2007 9:50 AM OVERLAY HWY 14 (WEST OF LOUISVILLE). DGN

APPROVED: *Larry Le James* 3-30-07
CHIEF ENGINEER DATE

APPROVED: *Larry Le James* 3-30-07
EXECUTIVE DIRECTOR DATE

MISSISSIPPI DEPARTMENT OF TRANSPORTATION

APPROVED: _____
DIVISION ADMINISTRATOR DATE

DATE _____
FEDERAL HIGHWAY ADMINISTRATION
DEPARTMENT OF TRANSPORTATION

DESCRIPTION OF SHEET	REVISION DATE	WKG. NO.	SH. NO.
TITLE SHEET (1)			1
DETAIL INDEX & GENERAL NOTES (1)		DI-1	2
TYPICAL OVERLAY SECTION (1)		TS-1	3
SUMMARY OF QUANTITIES (1)		SQ-1	4
SPECIAL DESIGN - ROADWAY SHEETS (4)			
DETAIL OF TEMPORARY STRIPE ON MAINLINE		TSD-1	5
DETAIL OF CONSTRUCTION SIGNS		DSC-1	6
SIGNING OF TWO-WAY TRAFFIC FOR NO PASSING ZONES		TC-1	7
TYPICAL MILLING @ BRIDGE ENDS		BE-1	8
STANDARD DRAWINGS - ROADWAY SHEETS (4)			
PAVEMENT MARKINGS DETAILS FOR 2-LANE AND 4-LANE DIVIDED HIGHWAYS	(12-01-99)	PM-1	120
TRAFFIC CONTROL PLAN WITH FLAGGER (ONE-LANE CLOSURE OF TWO-WAY TRAFFIC)		TCP-1	250
HIGHWAY SIGN AND BARRICADE DETAILS FOR CONSTRUCTION PROJECTS		TCP-10	259
TRAFFIC CONTROL PLAN - MOBILE OPERATIONS - MULTILANE RDS AND 2-LANE RDS	(12-01-99)	TCP-11	260
TOTAL (12)			

GENERAL NOTES:

- ① WHERE MILLING OF THE ROADWAY LANES IS REQUIRED, THE CONTRACTOR SHALL PROVIDE OUTLETS IN THE EXISTING SHOULDERS AT SUFFICIENT INTERVALS TO PREVENT POOLING OR STANDING WATER ON THE MILLED SURFACE. (ABSORBED COST)
- ② FLUORESENT ORANGE SHEETING SHALL BE USED ON ALL CONSTRUCTION AND TRAFFIC CONTROL SIGNS EXCEPT FOR THOSE DESIGNATED ON THE PLANS TO BE BLACE LEGEND AND BORDER ON THE WHITE BACKGROUND.
- ③ THE LOCATION AND SPACING OF SIGNS, SHOWN ON THE TRAFFIC CONTROL PLANS, ARE APPROXIMATE AND MAY BE ADJUSTED AS NECESSARY TO FIT FIELD CONDITIONS.
- ④ ALL TRAFFIC CONTROL DEVICES ON THIS PROJECT SHALL COMPLY WITH PART VI OF THE MUTCD (LATEST EDITION).

DISTRICT 1

PS & E PLANS-DATE 03/30/07		
FMS CON. # 303218/301		
REVISIONS		
DATE	SHEET NO.	BY

MISSISSIPPI DEPARTMENT OF TRANSPORTATION

93

MISSISSIPPI DEPARTMENT OF TRANSPORTATION														
DETAILED INDEX														
PROJECT NO.: MP-1014-80(012) / 303218301000														
COUNTY: WINSTON														
<table border="1"> <tr> <th>DATE</th> <th>REVISION</th> <th>BY</th> </tr> <tr> <td> </td> <td> </td> <td> </td> </tr> <tr> <td> </td> <td> </td> <td> </td> </tr> </table>	DATE	REVISION	BY							<table border="1"> <tr> <td>WORKING NUMBER</td> <td>DI-1</td> </tr> <tr> <td>SHEET NUMBER</td> <td>2</td> </tr> </table>	WORKING NUMBER	DI-1	SHEET NUMBER	2
DATE	REVISION	BY												
WORKING NUMBER	DI-1													
SHEET NUMBER	2													
FILENAME: _____ DESIGN TEAM _____ CHECKED _____ DATE _____														