

STATE OF MISSISSIPPI  
MISSISSIPPI DEPARTMENT OF TRANSPORTATION

PLAN AND PROFILE OF PROPOSED  
STATE HIGHWAY  
STATE PROJECT NO. MRP-6059-55(043)

04-18-07

BRIDGE REPAIR I-59  
PEARL RIVER COUNTY

F.M.S:303240/301000 CONSTR.

FED. ROAD REG. NO.	STATE	PROJECT NO.	SHEET NO.
4	MISS.	MRP-6059-55(043)	1

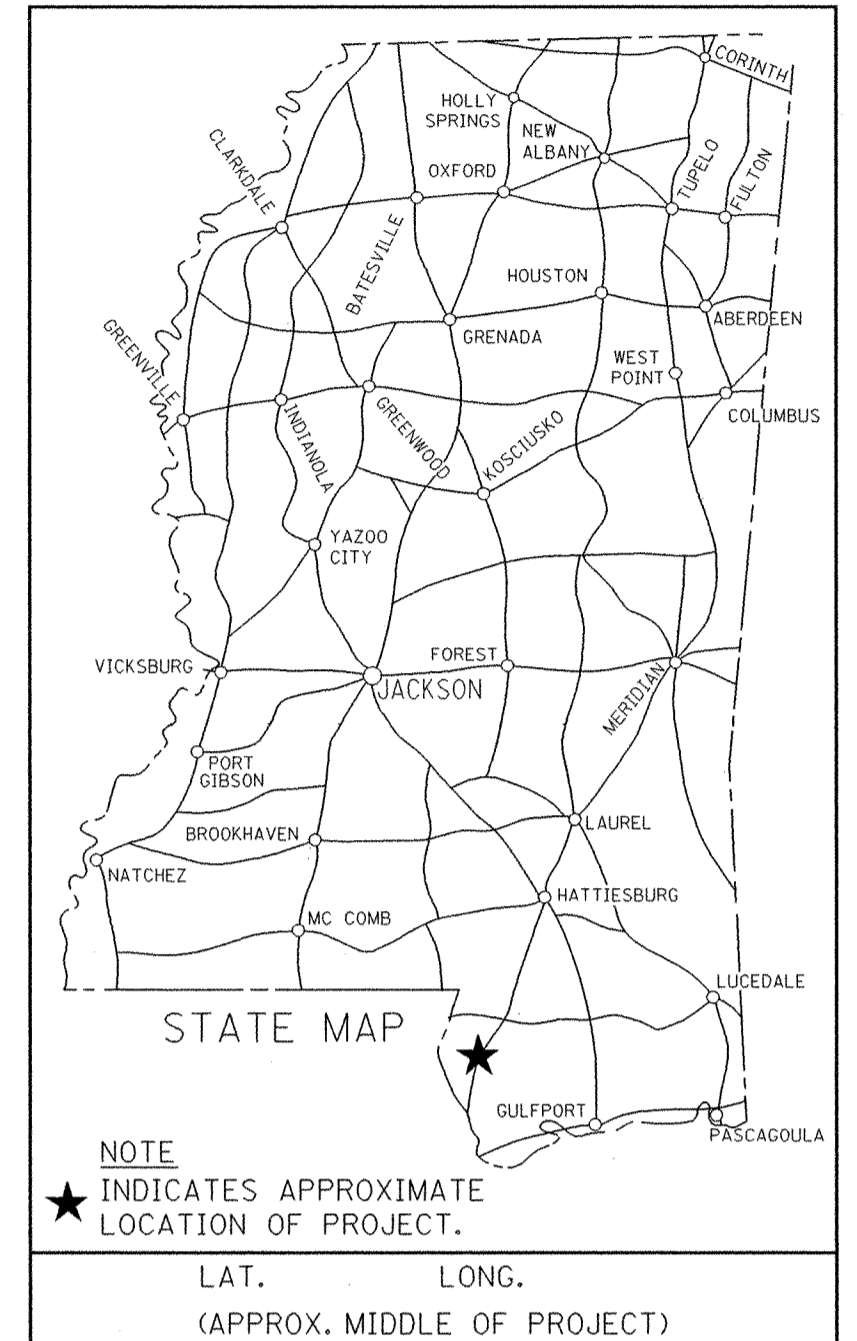

SCALES  
PLAN 1 IN. = 100 FT.  
PROFILE { HOR. 1 IN. = 100 FT.  
VERT. 1 IN. = 10 FT.  
LAYOUT 1 IN. = 3000 FT.

WORK SITE

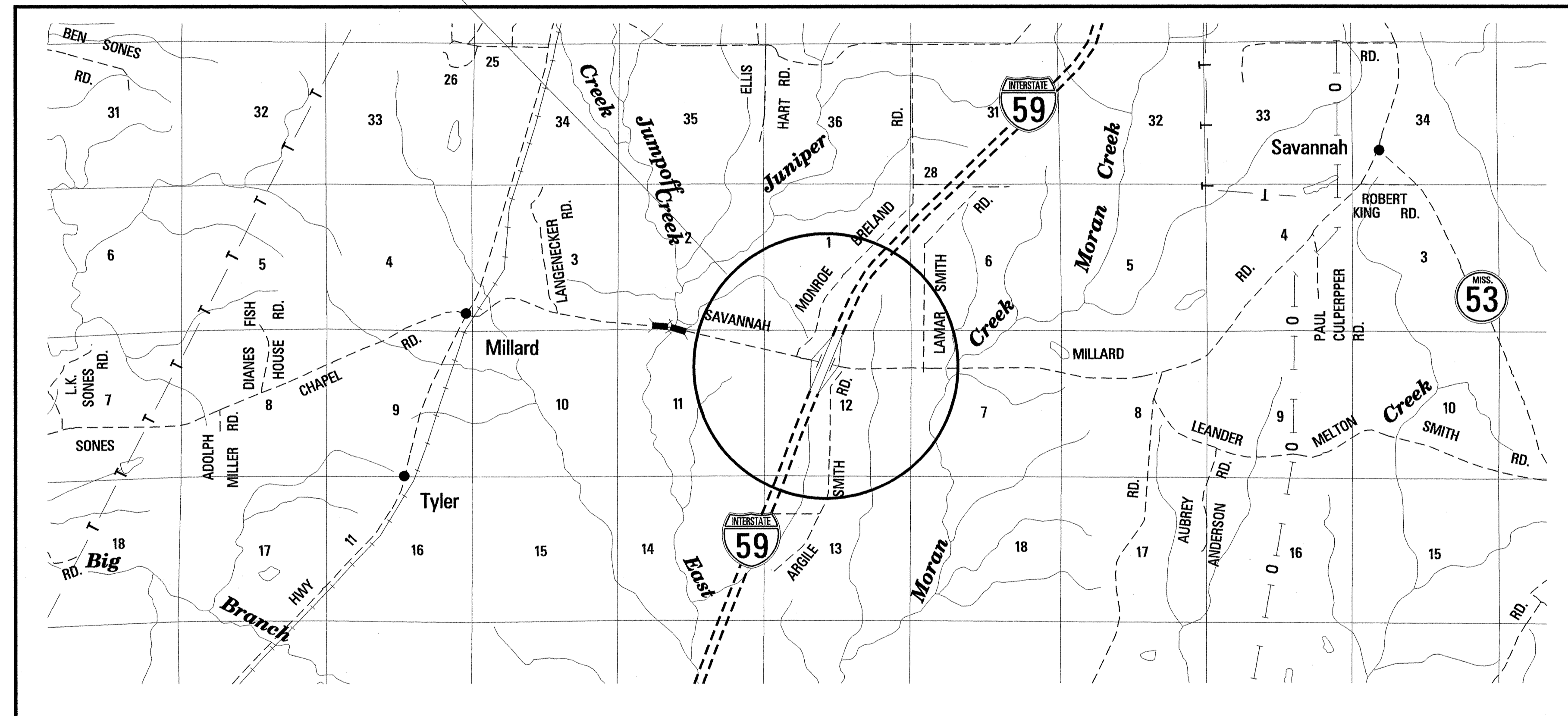

BRIDGE STRUCTURES REQ'D.

BOX BRIDGES REQ'D.



DESIGN CONTROL  
MPH = V (SPEED DESIGN)

ADT ( ) = : ADT ( ) =  
DHV = : D = % T = %

PERMITS ACQUIRED BY MDOT

WETLANDS AND WATERS PERMITS (NECESSARY FOR ULTIMATE IMPROVEMENTS ONLY):

NATIONWIDE #14	<input checked="" type="checkbox"/>	<input checked="" type="checkbox"/>
NATIONWIDE (OTHER)*	<input checked="" type="checkbox"/>	<input checked="" type="checkbox"/>
GENERAL*	<input checked="" type="checkbox"/>	<input checked="" type="checkbox"/>
INDIVIDUAL (404)*	<input checked="" type="checkbox"/>	<input checked="" type="checkbox"/>

\* ACQUISITION OF PERMITS FOR TEMPORARY IMPACTS DURING CONSTRUCTION ARE THE RESPONSIBILITY OF THE CONTRACTOR

STORMWATER PERMIT

Y REQUIRED, CNOI SUBMITTED BY MDOT (DISTRIBUTED AREA = 5 ACRES + JN1B 6484)

S REQUIRED, SCNOI TO BE SUBMITTED BY CONTRACTOR (1 TO 4.99 ACRES) (N1B 6483)

N NO STORMWATER PERMIT REQUIRED (<1 ACRE)

APPROVED BY: ATM DATE: 4-12-07

CONVENTIONAL SYMBOLS

- COUNTY LINE .....
- TOWN CORPORATION LINE .....
- SECTION LINE .....
- EXISTING ROAD OR TRAVELED WAY .....
- PROPOSED ROAD OR TRAVELED WAY .....
- RAILROAD .....
- SURVEY LINE .....
- BRIDGES .....

EQUATIONS

LENGTH DATA

LENGTH OF ROADWAY	FT.	MI.
LENGTH OF BRIDGES	FT.	MI.
LENGTH OF PROJECT (NET)	FT.	MI.
LENGTH OF EXCEPTIONS	FT.	MI.
LENGTH OF PROJECT (GROSS)	FT.	MI.

EXCEPTIONS

APPROVED:	BY	DATE
<i>Harry Lee James</i>		4/12/07
CHIEF ENGINEER		DATE
<i>Samuel R. ...</i>		4-12-07
EXECUTIVE DIRECTOR		DATE
MISSISSIPPI DEPARTMENT OF TRANSPORTATION		
APPROVED:	BY	DATE
DIVISION ADMINISTRATOR		
FEDERAL HIGHWAY ADMINISTRATION DEPARTMENT OF TRANSPORTATION		

DESCRIPTION OF SHEET

WKG.  
NO.      SH.  
NO.

GENERAL NOTES

TITLE SHEET (1)		1
DETAILED INDEX & GENERAL NOTES (1)	DI-1	2
QUANTITY SHEETS (1)		
SUMMARY OF QUANTITIES	SQ-1	3
SPECIAL DESIGN SHEETS (2)		
TRAFFIC CONTROL DETAIL - MEDIAN BARRIER PLACEMENT	TC-1	4
TRAFFIC CONTROL PLAN FOR POSTED SPEED LIMIT OF 65 OR 70 MPH (INTERSTATES AND OTHER 4-LANE DIVIDED HIGHWAYS)(MEDIAN LANE OR OUTSIDE LANE CLOSURE (EXTENDED PERIOD))	SDTCP-4	5
STANDARD DRAWINGS - ROADWAY SHEETS (1) ENGLISH OCT. 1, 1998 VERSION		
MEDIAN BARRIER : CONCRETE (PRECAST)	(03-01-02) MB-2A	205
SPECIAL DESIGN BRIDGE DRAWINGS (12)		
BRIDGE AT STA. 927+04.73 LT. LANE I-59 OVER MILLARD ROAD		
BRIDGE REPAIR	1 OF 3	366
BRIDGE REPAIR DETAILS	2 OF 3	367
40 FT. BEAM DETAILS (INT. SPAN) BEAM 40-7 (TYPE I+2)	3 OF 3	368
BRIDGE "B1" STA. 927+04.73 LT. LN. & "B2" STA. 927+26.52 RT. LN. OVERPASSES AT LOCAL ROAD		
PILE LAYOUT	B1 OF 6	369
END BENT DETAILS	B2 OF 6	370
END BENT DETAILS	B3 OF 6	371
INT. BENT DETAILS	B4 OF 6	372
SKEW SPAN DETAILS	B5 OF 6	373
PRESTRESSED CONCRETE BEAM	B6 OF 6	374
PRESTRESSED CONCRETE BEAM SPAN	PB-3	375
	PS-24	376
TOTAL SHEETS (18)		

- ① FLUORESCENT ORANGE SHEETING SHALL BE USED ON ALL CONSTRUCTION AND TRAFFIC CONTROL SIGNS EXCEPT FOR THOSE DESIGNATED IN PLANS TO BE OTHERWISE.
- ② THE LOCATION AND SPACING OF SIGNS, SHOWN ON THE TRAFFIC CONTROL PLANS, ARE APPROXIMATE AND MAY BE ADJUSTED AS NECESSARY TO FIT FIELD CONDITIONS.
- ③ IN THE EVENT OF HURRICANE CONTRA FLOW, THE CONTRACTOR SHALL ASSIST DISTRICT MAINTENANCE WITH CHANGING CONCRETE MEDIAN BARRIER CONFIGUATION AS SHOWN ON SHEET TC-1 AND REMOVING TRAFFIC CONTROL DEVICES FOR THE ONE LANE CLOSURE.

FOR INFORMATION ONLY

FMS# 303240/301000

PS & E PLANS- 4-18-07		
REVISIONS		
DATE	SHEET NO.	BY

*BR. DiU.*

MISSISSIPPI DEPARTMENT OF TRANSPORTATION	
<b>DETAILED INDEX AND GENERAL NOTES</b>	
PROJECT NO.: MRP-6059-55 (043)	
COUNTY: PEARL RIVER COUNTY	
FILENAME: di.dgn	WORKING NUMBER DI-1
DESIGN TEAM MOOD	CHECKED _____ DATE _____
	SHEET NUMBER 2