

**GENERAL INDEX**

FOR DETAILED INDEX OF PLANS SEE SHEET NO. 2

DESCRIPTION	NUMBER OF SHEETS
TITLE SHEET	1
DETAILED INDEX	1
GENERAL NOTES	1
TYPICAL SECTIONS	1
QUANTITIES	1
PLAN AND PROFILES	14
SPECIAL DESIGN - ROADWAY ITEMS	14
BRIDGE DRAWINGS	
SPECIAL DESIGN - BRIDGES	
CROSS-SECTIONS	
<b>TOTAL SHEETS</b>	<b>18</b>

①06-07-07

**BRIDGE STRUCTURES REQ'D.**

NONE

**B.O.P STA. 100+00**

**BOX BRIDGES REQ'D.**

NONE

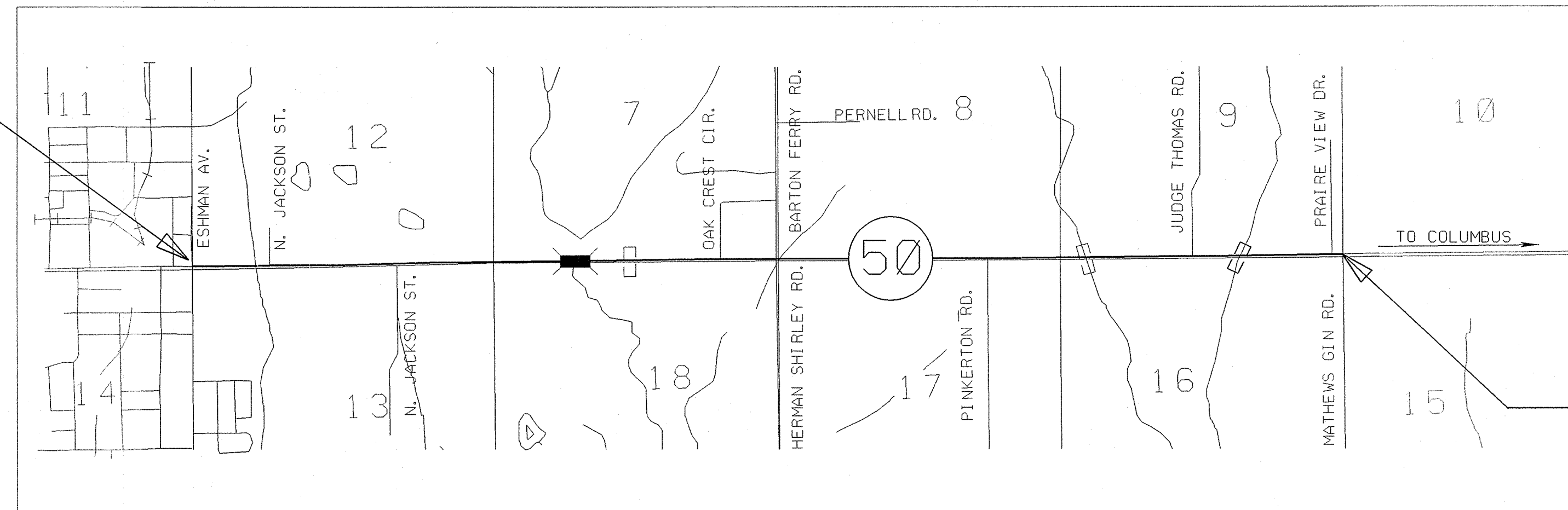

**E.O.P STA. 317+91**

**STATE OF MISSISSIPPI**

**MISSISSIPPI DEPARTMENT OF TRANSPORTATION**

**PLAN AND PROFILE OF PROPOSED STATE HIGHWAY STATE PROJECT NO. MP-1050-13(008)**

**SR 50 FROM WEST POINT TO 4.11 MILES EASTWARD CLAY COUNTY**

**303262 /301000**

**SCALES**

<b>PLAN</b>	1 IN. = 100 FT.
<b>PROFILE</b>	HOR. 1 IN. = 100 FT.
	VERT. 1 IN. = 10 FT.
<b>LAYOUT</b>	1 IN. = FT.

FED. ROAD REG. NO.	STATE	PROJECT NO.	SHEET NO.
4	MISS.	MP-1050-13(008)	1

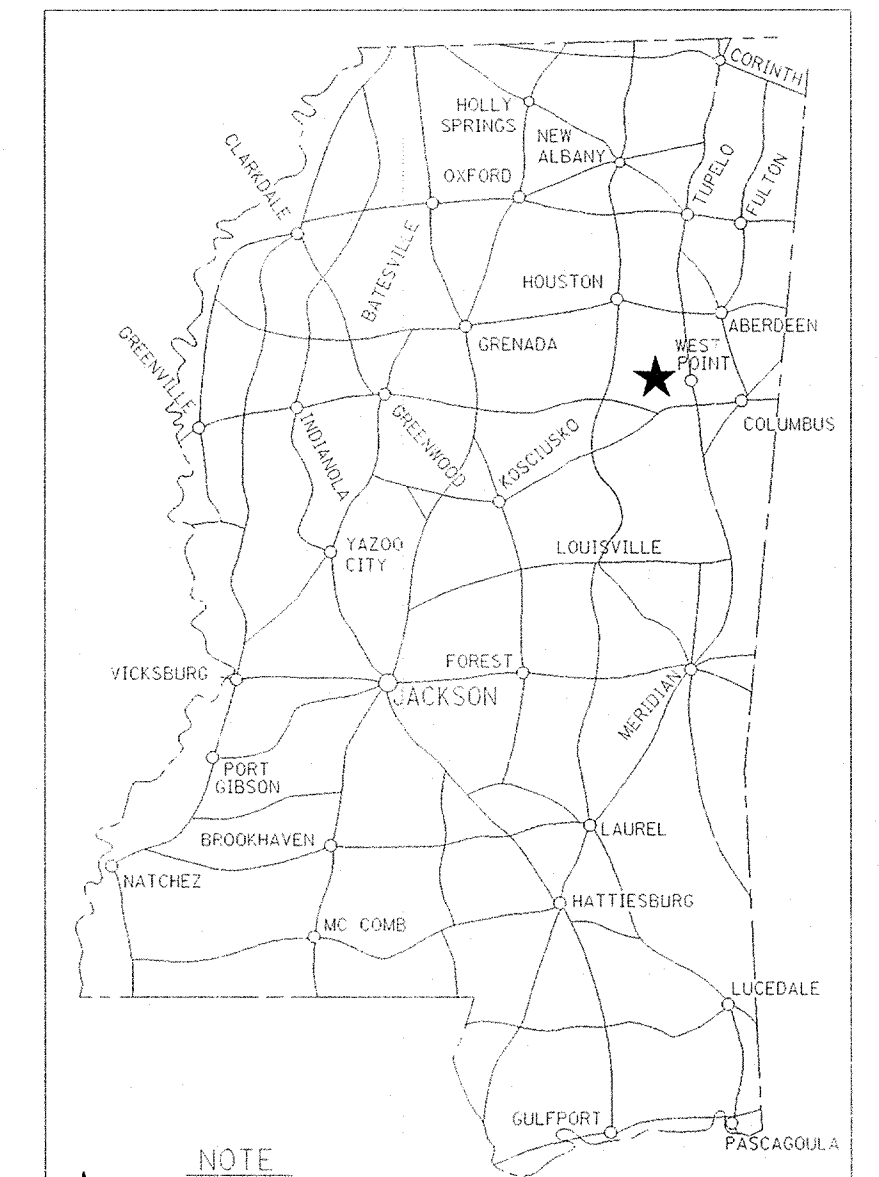

NOTE  
★ INDICATES APPROXIMATE LOCATION OF PROJECT.

LAT. N 33° 36' LONG. W 88° 35'  
(APPROX. MIDDLE OF PROJECT)

**DESIGN CONTROL**

MPH = V (SPEED DESIGN)

ADT ( ) = : ADT ( ) =  
DHV = : D = % T = %

**PERMITS ACQUIRED BY MDOT**

	WATERS	WETLANDS
NATIONWIDE #14	N	N
NATIONWIDE (OTHER)*	N	N
GENERAL*	N	N
INDIVIDUAL (404)*	N	N

\* ACQUISITION OF PERMITS FOR TEMPORARY IMPACTS DURING CONSTRUCTION ARE THE RESPONSIBILITY OF THE CONTRACTOR

STORMWATER PERMIT	N
Y REQUIRED, CNOI SUBMITTED BY MDOT (DISTRIBUTED AREA = 5 ACRES+) (NTB 586)	
S REQUIRED, SCNOI TO BE SUBMITTED BY CONTRACTOR (1 TO 4.99 ACRES) (NTB 14)	
N NO STORMWATER PERMIT REQUIRED (<1 ACRE)	

APPROVED BY: JCR DATE: 06/07/07

**CONVENTIONAL SYMBOLS**

- COUNTY LINE -----
- TOWN CORPORATION LINE -----
- SECTION LINE -----
- EXISTING ROAD OR TRAVELED WAY -----
- PROPOSED ROAD OR TRAVELED WAY -----
- RAILROAD -----
- SURVEY LINE -----
- BRIDGES -----

**EQUATIONS**

NONE

**EXCEPTIONS**

NONE

**LENGTH DATA**

LENGTH OF ROADWAY	21,639.00 FT.	4.098 MI.
LENGTH OF BRIDGES	152.00 FT.	0.029 MI.
LENGTH OF PROJECT (NET)	21,791.00 FT.	4.127 MI.
LENGTH OF EXCEPTIONS	0.00 FT.	0.000 MI.
LENGTH OF PROJECT (GROSS)	21,791.00 FT.	4.127 MI.

E:\7\2007 8:00 AM OVERLAY HWY 50 FROM WEST POINT 4.11 MILES EAST.DGN MISSISSIPPI DEPARTMENT OF TRANSPORTATION

APPROVED: *Larry Lee James* 6-7-07  
CHIEF ENGINEER DATE

*Larry Lee James* 6-7-07  
EXECUTIVE DIRECTOR DATE

MISSISSIPPI DEPARTMENT OF TRANSPORTATION  
APPROVED: \_\_\_\_\_  
DIVISION ADMINISTRATOR DATE

FEDERAL HIGHWAY ADMINISTRATION  
DEPARTMENT OF TRANSPORTATION

DESCRIPTION OF SHEET	REVISION DATE	WKG. NO.	SH. NO.
TITLE SHEET (1)			1
DETAIL INDEX & GENERAL NOTES (1)		DI-1	2
TYPICAL OVERLAY SECTION (1)		TS-1	3
SUMMARY OF QUANTITIES (1)		SQ-1	4
SPECIAL DESIGN - ROADWAY SHEETS (5)			
DETAIL OF TEMPORARY STRIPE ON MAINLINE		TSD-1	5
DETAIL OF CONSTRUCTION SIGNS		DSC-1	6
SIGNING OF TWO-WAY TRAFFIC FOR NO PASSING ZONES		TC-1	7
DETAIL OF CONCRETE ISLANDS		ID-1	8
DETAIL OF CONCORETE ISLANDS		ID-2	9
STANDARD DRAWINGS - ROADWAY SHEETS (9)			
PAVEMENT MARKING DETAIL FOR 2-LANE HIGHWAY	(12-01-99 )	PM-1	120
GUARDRAIL "W" BEAM		GR-1B	182
GUARDRAIL BRIDGE END SECTION TYPE "H" (STEEL POST)		GR-2D	188
TYPICAL GUARDRAIL DELINEATION		SN-8C	236
TRAFFIC CONTROL PLAN WITH FLAGGER (ONE-LANE CLOSURE OF TWO-WAY TRAFFIC )		TCP-1	250
HIGHWAY SIGN AND BARRICADE DETAILS FOR CONSTRUCTION PROJECTS		TCP-10	259
TRAFFIC CONTROL PLAN - MOBILE OPERATIONS - MULTILANE RDS AND 2-LANE RDS		TCP-11	260
DRIVEWAYS, CURB & GUTTER & SIDEWALK		SD-1	287
DRIVEWAYS, INTEGRAL CURB & SIDEWALK		SD-2	288
TOTAL SHEETS = 18			

GENERAL NOTES:

- ① WHERE MILLING OF THE ROADWAY LANES IS REQUIRED, THE CONTRACTOR SHALL PROVIDE OUTLETS IN THE EXISTING SHOULDERS AT SUFFICIENT INTERVALS TO PREVENT POOLING OR STANDING WATER ON THE MILLED SURFACE. (ABSORBED COST)
- ② FLUORESENT ORANGE SHEETING SHALL BE USED ON ALL CONSTRUCTION AND TRAFFIC CONTROL SIGNS EXCEPT FOR THOSE DESIGNATED ON THE PLANS TO BE BLACK LEGEND AND BORDER ON THE WHITE BACKGROUND.
- ③ THE LOCATION AND SPACING OF SIGNS, SHOWN ON THE TRAFFIC CONTROL PLANS, ARE APPROXIMATE AND MAY BE ADJUSTED AS NECESSARY TO FIT FIELD CONDITIONS.
- ④ ALL TRAFFIC CONTROL DEVICES ON THIS PROJECT SHALL COMPLY WITH PART VI OF THE MUTCD (LATEST EDITION).

DISTRICT 1

PS & E PLANS-DATE 06/07/07		
FMS CON. # 303262 / 301000		
REVISIONS		
DATE	SHEET NO.	BY
06/18/07	4	JCR
06/22/07	4	JCR

MISSISSIPPI DEPARTMENT OF TRANSPORTATION	
<b>DETAILED INDEX</b>	
PROJECT NO.: MP-1050-13(008)	
COUNTY: CLAY	
DATE	WORKING NUMBER
DESIGN TEAM	DI-1
CHECKED	SHEET NUMBER
DATE	2

ROADWAY DESIGN PLAN CADD SECTION  
 MISSISSIPPI DEPARTMENT OF TRANSPORTATION