

**SECTION 905 -- PROPOSAL (CONTINUED)**

I (We) further propose to execute the attached contract agreement (Section 902) as soon as the work is awarded to me (us), and to begin and complete the work within the time limit(s) provided for in the Specifications and Advertisement. I (We) also propose to execute the attached contract bond (Section 903) in an amount not less than one hundred (100) percent of the total of my (our) part, but also to guarantee the excellence of both workmanship and materials until the work is finally accepted.

I (We) enclose a certified check, cashier's check or bid bond for **five percent (5%) of total bid** and hereby agree that in case of my (our) failure to execute the contract and furnish bond within Ten (10) days after notice of award, the amount of this check (bid bond) will be forfeited to the State of Mississippi as liquidated damages arising out of my (our) failure to execute the contract as proposed. It is understood that in case I am (we are) not awarded the work, the check will be returned as provided in the Specifications.

Bidder acknowledges receipt of and has added to and made a part of the proposal and contract documents the following addendum (addenda):

ADDENDUM NO.   1   DATED   2/15/2008   ADDENDUM NO.            DATED             
 ADDENDUM NO.            DATED            ADDENDUM NO.            DATED           

Number	Description
1	Revised NTB 1551; Revised Bidsheets; Addendum EBS Download required.

TOTAL ADDENDA:   1    
 (Must agree with total addenda issued prior to opening of bids)

Respectfully Submitted,

DATE \_\_\_\_\_

\_\_\_\_\_  
 Contractor

BY \_\_\_\_\_  
 Signature

TITLE \_\_\_\_\_

ADDRESS \_\_\_\_\_

CITY, STATE, ZIP \_\_\_\_\_

PHONE \_\_\_\_\_

FAX \_\_\_\_\_

E-MAIL \_\_\_\_\_

(To be filled in if a corporation)

Our corporation is chartered under the Laws of the State of \_\_\_\_\_ and the names, titles and business addresses of the executives are as follows:

_____ President	_____ Address
_____ Secretary	_____ Address
_____ Treasurer	_____ Address

The following is my (our) itemized proposal.

# MISSISSIPPI DEPARTMENT OF TRANSPORTATION

SECTION 904 - NOTICE TO BIDDERS NO. 1551

CODE: (SP)

DATE: 02/15/2008

SUBJECT: Scope of Work

PROJECT: MP-6013-37(008) / 303254301 - Lamar County

The contract documents do not include an official set of construction plans but may, by reference, include some Standard Drawings when so specified in a Notice to Bidders entitled, "Standard Drawings". All other references to plans in the contract documents and Standard Specifications for Road and Bridge Construction are to be disregarded.

Work on the project shall consist of the following:

## **SR 13**

### **WIDEN AND OVERLAY APPROXIMATELY 2.4 MILES OF SR 13 FROM THE PEARL RIVER CO. LINE, NORTH 2.4 MILES TO THE CHIP SEAL SECTION.**

(A) Prior to the overlay, centerline alignment shall be determined by the contractor by measuring the existing roadway at 500 feet intervals in tangent sections, and 100 feet intervals in horizontal curves. The existing pavement edge shall be cut to a smooth and near vertical face with an approved cutting device (Not to be measured for separate pay). The section of SR 13 to be widened is the section from the end of the divided section north to the start of the chip seal. The foundation for widening the base shall be built according to the Typical Section (See typical drawing). Material excavated from the trench shall be used to raise the existing shoulder to match the new pavement elevation. Surplus material shall be spread along the edge of the shoulders, foreslopes, or other adjacent areas as directed by the Project Engineer, and will be an absorbed item.

(B) Cold mill the roadway at the B.O.P., E.O.P., US Hwy 11, curb and gutter sections, railroad, and as designated by the Project Engineer to ensure smooth transition of new overlay with existing grade. Asphalt shall be placed on the milled surface within 48 hours of milling. (See Typical Drawings) Milled material shall be delivered and stockpiled for MDOT at the MDOT maintenance yard on US Hwy 11 south of Purvis.

(C) Overlay SR 13 from the Pearl River/ Lamar co. line, north 2.4 miles to the jct. of the chip seal as per the following sections:

- **B.O.P. to the Red Creek Bridge:** Place HMA, MT, 9.5mm Mixture, Leveling on existing chip sealed shoulders to match existing or milled lanes and to provide a four (4%) percent slope in tangent sections. Place a one and one half (1½) inch and variable lift of HMA, MT, 9.5mm Mixture on the existing travel lanes and the paved shoulders.
- **Red Creek Bridge to the railroad crossing:** Cold mill one and one half (1½) inches and variable the full width of the existing asphalt pavement. Place a one and one half (1½) inch and variable lift of HMA, MT, 9.5mm Mixture.

- **Railroad crossing to 5th Street (Business Section):** Place a one and one half (1½) inch and variable lift of HMA, MT, 9.5mm Mixture. In the areas used for parking which have car stops, the contractor shall remove and reset the car stops for the placement of asphalt, costs to be absorbed in other items.
- **5th Street to 10th Street:** Place a one and one half (1½) inch and variable lift of HMA, MT, 9.5mm Mixture.
- **10th Street to E.O.P.:** Excavate two (2) feet wide and three (3) inches deep on both sides of the existing roadway for the widening of the lanes. Material excavated from the trench shall be used to raise the existing shoulder to match the new pavement elevation. Surplus material shall be spread along the edge of the shoulders, foreslopes, or other adjacent areas as directed by the Project Engineer, and will be an absorbed item. Place HMA, MT, 9.5 mm Mixture, Leveling in the area excavate for widening at the same time as a three-fourths (<sup>3</sup>/<sub>4</sub>) inch leveling lift is placed on the existing lanes. Place a one (1) inch and variable lift of HMA, MT, 9.5mm Mixture.

Remove any failed areas on the main facility and repair by backfilling with 19.0mm MT asphalt as directed by the Project Engineer. Approximately 285 tons of (MT) 19.0mm asphalt will be used for base repair. Publicly maintained roads or streets shall be surfaced to the existing R.O.W.; privately owned entrances shall be surfaced a distance of 10 feet & var. from edge of pavement. Any site grading at local roads or drives will not be measured for separate payment but will be considered an absorbed item. Cross slopes shall be increased where practical with contract quantities in an effort to achieve a uniform cross slope of 2%. The existing superelevation in horizontal curves is to be maintained as a minimum. Any work to determine the existing superelevation rate as well as any work to control the laydown equipment for proper placement of the asphalt in the superelevated curves shall be absorbed by the Contractor at no additional costs to the State. The Contractor will mill a 12" rumble strip along the shoulders. The Contractor will place the traffic stripe on the inside 6" of the rumble strip.

(D) All work in business section of SR 13 (from the railroad tracks to 5th Street) shall be done Sunday through Thursday only, from 7:00 P.M. to 6:00 A.M. All operations which are performed during the non-daylight hours shall be properly illuminated to allow for the complete performance and inspection of the work. If the Project Engineer feels that there is not proper lighting for adequate performance and inspection of the work the contractor shall make the necessary adjustments to comply with this request. The cost for the adjustments shall be absorbed by the contractor. Lighting systems shall be positioned such that they do not cause glare to drivers or any nearby homes. When necessary, the lighting systems shall include screening to minimize glare. Prior to the initial start of nighttime operations, a lighting plan shall be submitted to the Project Engineer for review and approval. The lighting plan shall specify the construction area to be lit, and the layout of the lighting systems. The construction is defined as the area in which any and all work related to the construction is on going and is to be performed during the hours of darkness. No nighttime construction shall begin until the lighting plan is approved in writing. All moving equipment used for nighttime operations shall have mounted a lighting system each direction of travel of the equipment. The equipment shall also have a minimum of 0.54 square feet high intensity retroreflective sheeting toward the extremities of each side of the equipment. A minimum of 1.07 square feet of sheeting shall be visible from each direction. All workers shall, during the hours of darkness, wear reflectorized garments as specified for traffic directors. Nighttime operations shall also be illuminated by lighting systems consisting of mobile units of floodlights so that the construction area is lit with a minimum illumination intensity of 54 lux. Floodlight lamps shall be mercury vapor. Battery-powered systems shall consist of banks of batteries. The number and size of battery banks shall be sufficient to permit operation of the lighting system for a minimum of 12 hours. The cost of the complete lighting system shall be borne by the contractor.

(E) Raise the existing shoulders to match the new pavement elevation by blading the existing shoulder material to 4%, the cost of which shall be included in other items bid. If any additional shoulder material is needed, place 1<sup>3</sup>/<sub>4</sub>" and variable borrow excavation. All existing shoulders shall be bladed and dressed to a finished slope of 4% (absorbed) as directed by the Project Engineer. Placement of the borrow excavation on the finished surface course shall not be permitted.

(F) Temporary and permanent striping shall conform to finished stripe specifications for alignment, neatness, reflectivity, and straightness. All permanent pavement markings on asphalt are to be hot thermoplastic. Glass beads applied to thermoplastic shall conform to Section Number - 720.01 (Beads shall be double dropped Class B, High-Visibility first, and then Class A High-Visibility).

(G) Raised pavement markers will be placed at 80 feet intervals in tangents and 40 feet intervals in curves, and in urban limits along the centerline of roadway. Any removals of existing raised pavement markers or rumble bars shall be considered an absorbed item.

The contractor shall erect and maintain construction signing, and provide all signs and traffic handling devices in accordance with Manual Uniform Traffic Control Devices (MUTCD) (the cost is to be included in the price bid for pay item No. 618-A, Maintenance of Traffic).

Incidental work such as removing vegetation, shaping and compaction of shoulder, removing excess asphalt material, project clean-up, and other incidental work necessary to complete the project will not be measured for separate payment, but will be included in other bid items.

# MP-6013-37(008) / 105018301 LAMAR COUNTY

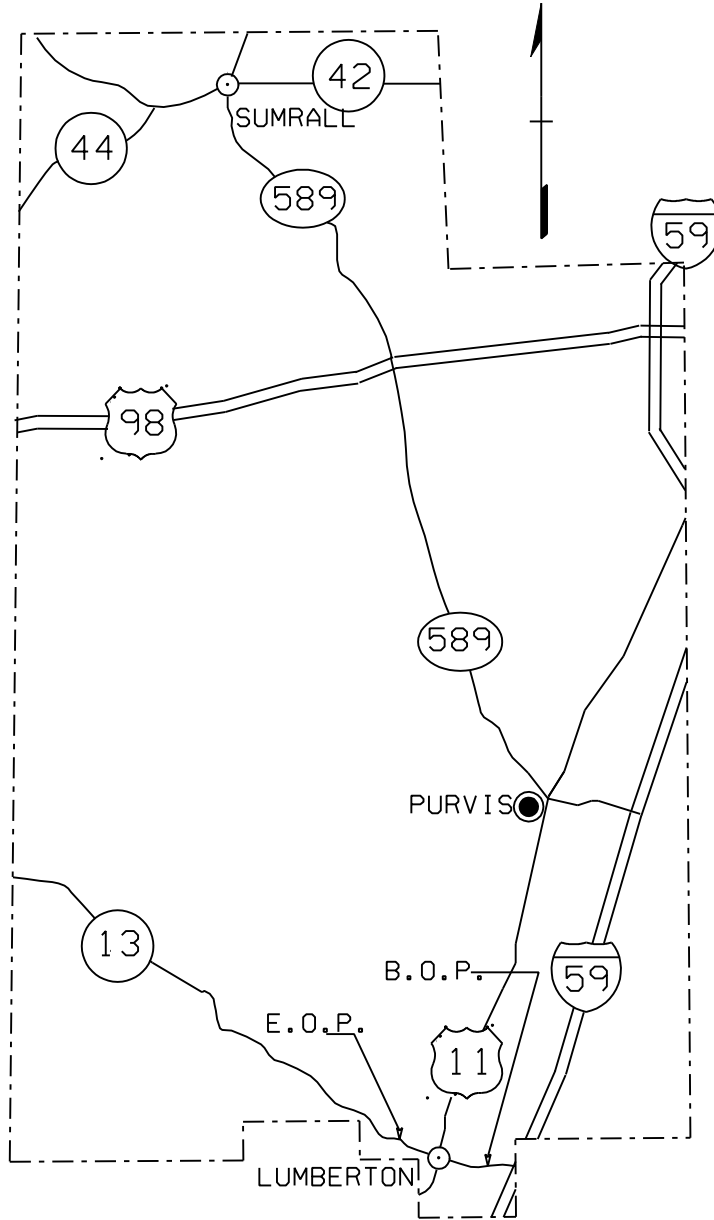

THE ABOVE REFERENCED PROJECT IS FOR WIDENING AND OVERLAYING SR 13 FROM THE PEARL RIVER CO. LINE, NORTH 2.5 MILES TO THE CHIP SEAL JUST NORTH OF THE DIVIDED SECTION.

# PRIVATE DRIVEWAY DETAIL

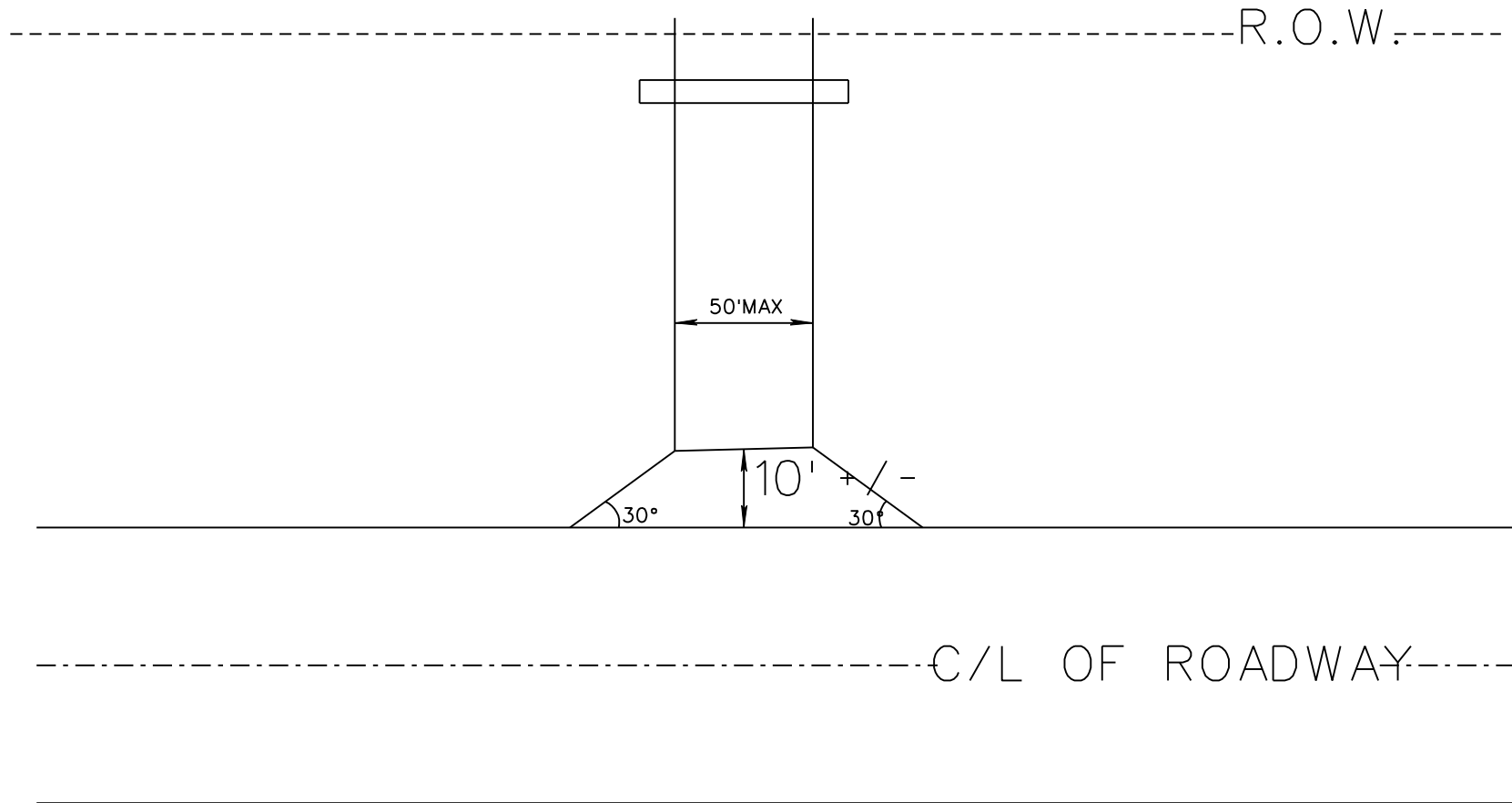

# TYPICAL MILLED TRANSITION AT CURB AND GUTTER JOINING PAVEMENT

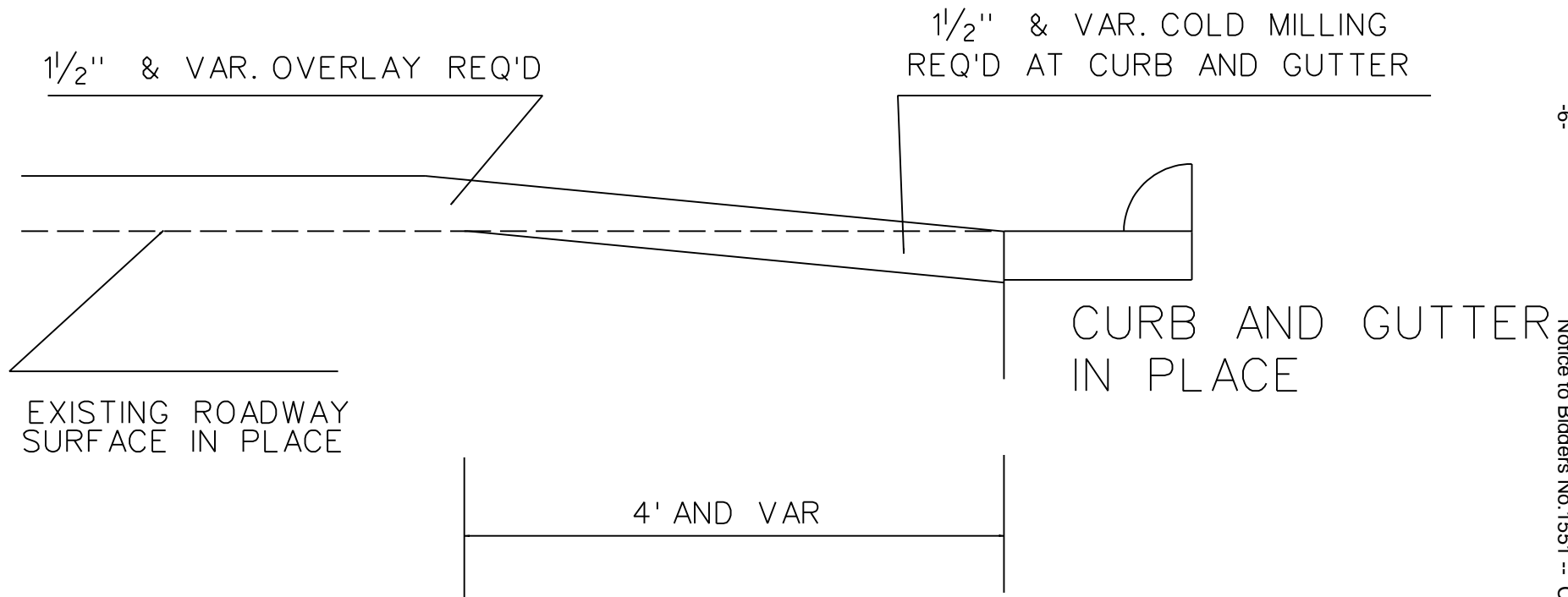

# TYPICAL MILLED TRANSITION AT BRIDGE ABUT. OR PAVEMENT IN PLACE

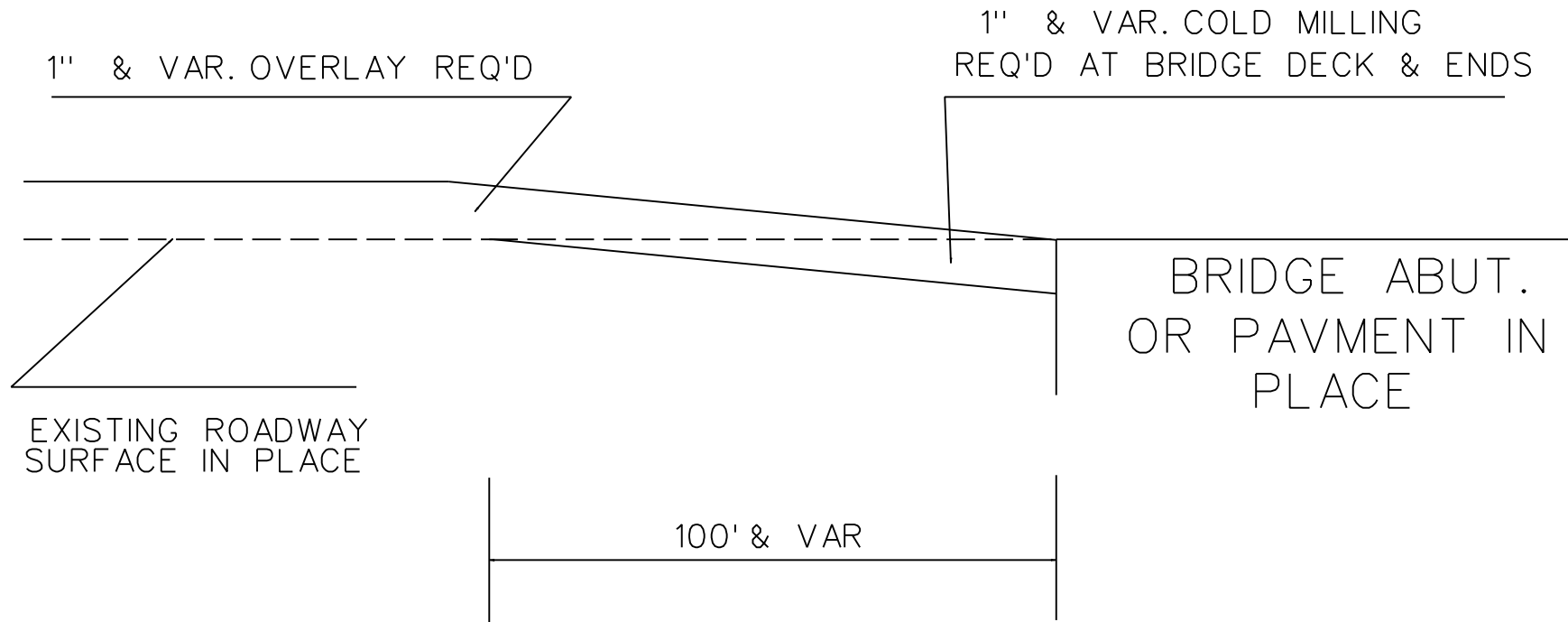



# TYPICAL MILLED TRANSITION AT BRIDGE ABUT. OR PAVEMENT IN PLACE

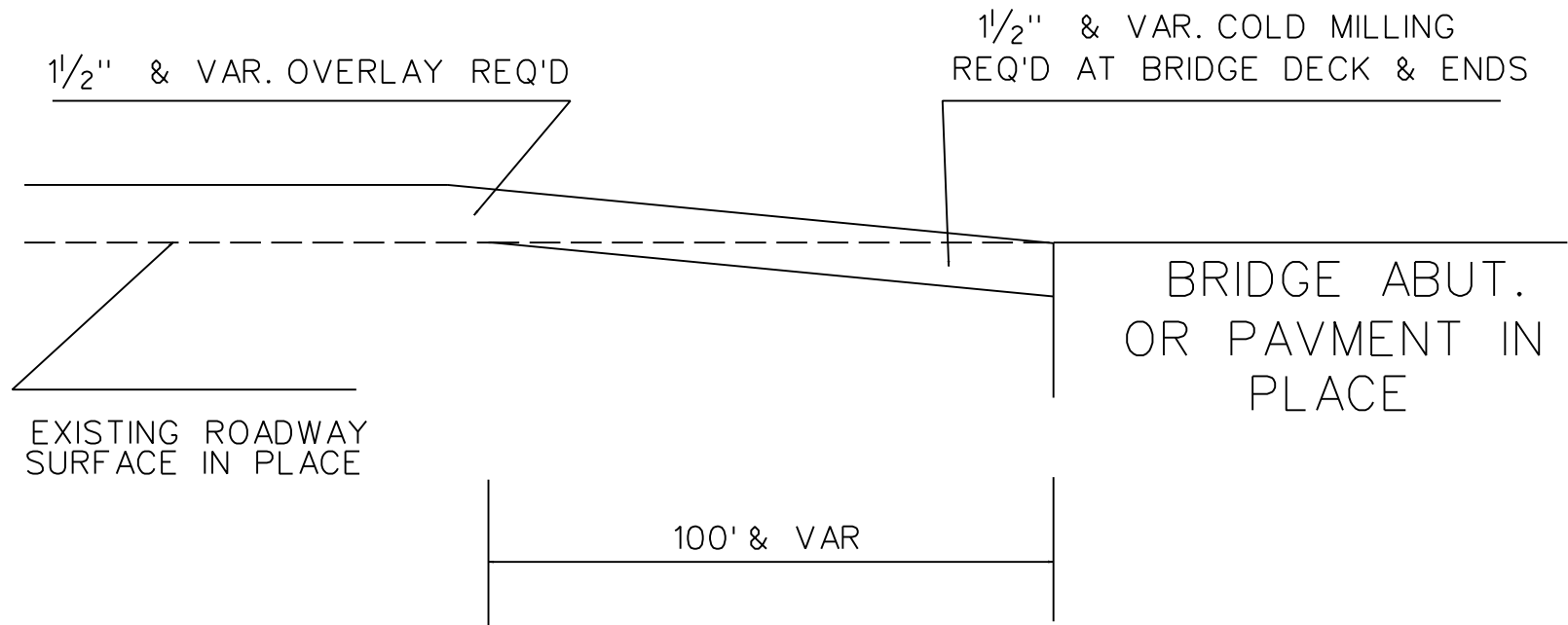

# TYPICAL MILLING DIAGRAM

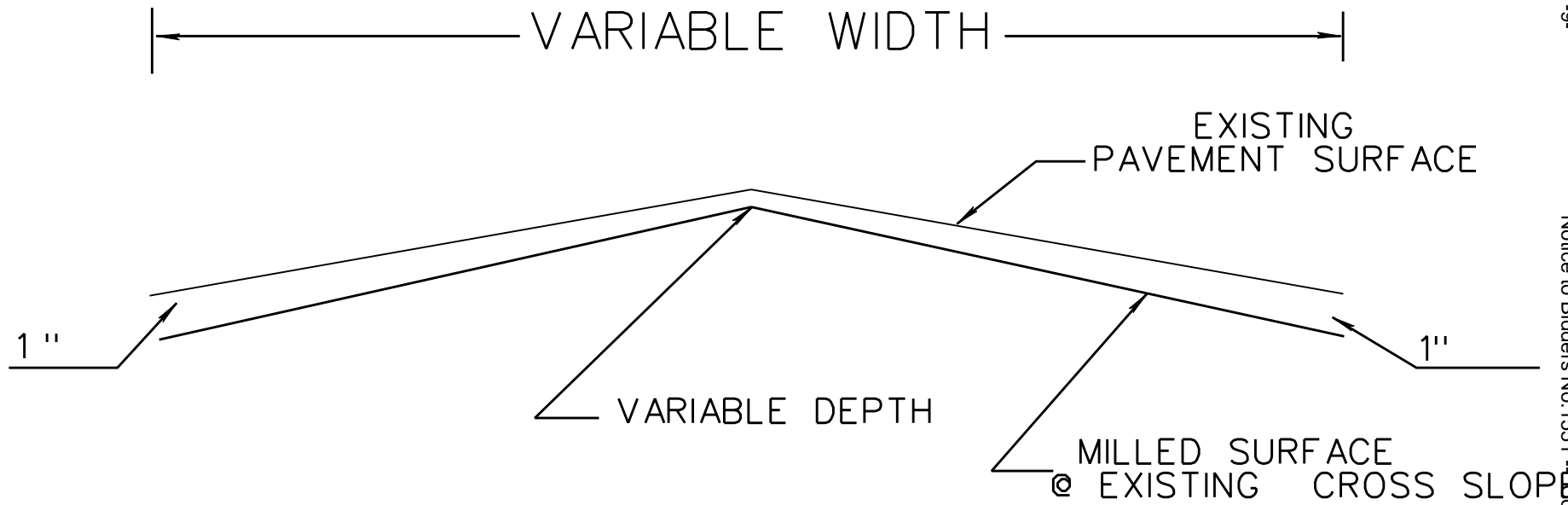

# TYPICAL STRIPING AT RAILROAD CROSSING

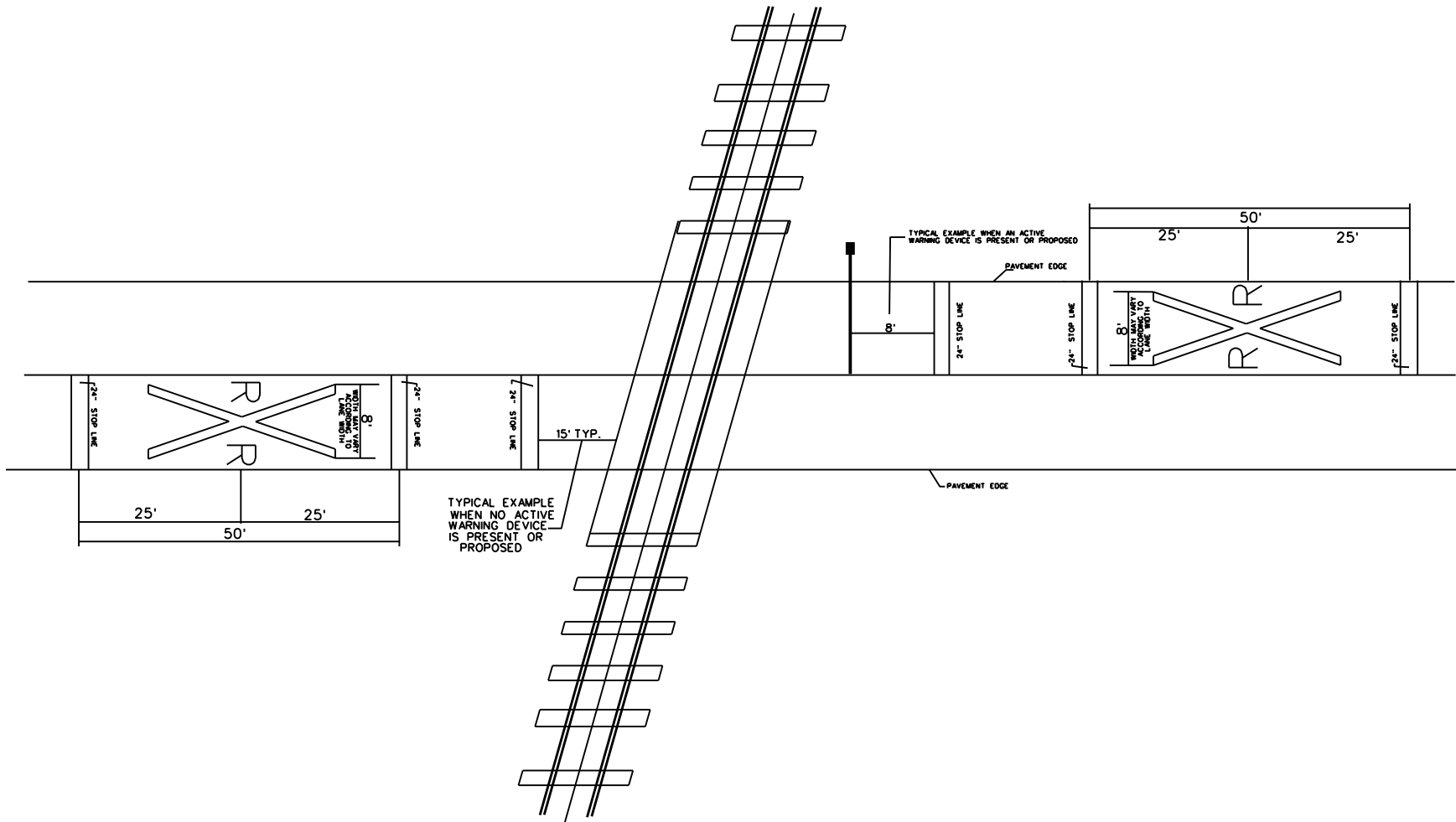

# TYPICAL STRIPING FOR SIMPLE INTERSECTION AT LOCAL ROADS

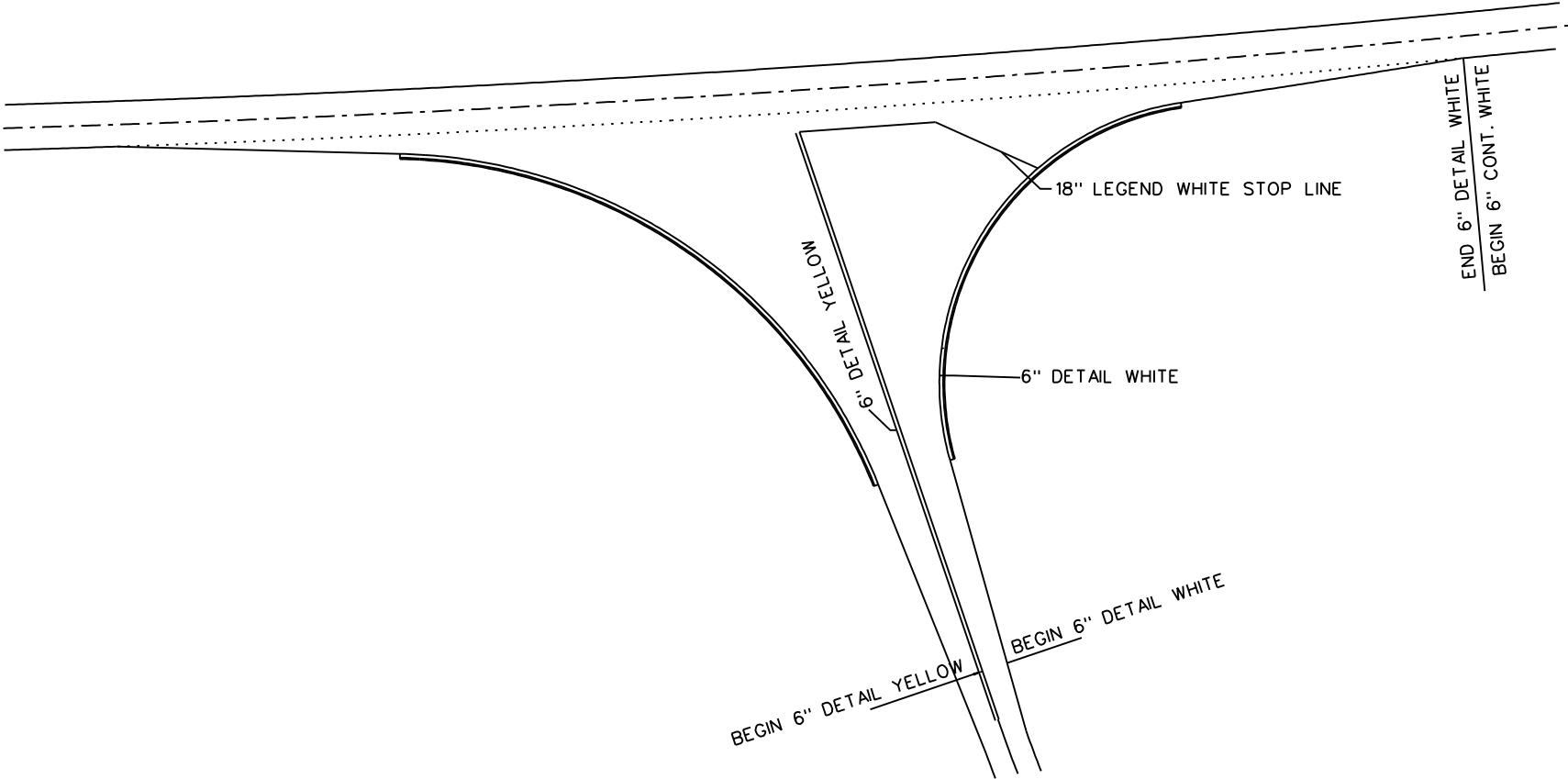

# TYPICAL FOR PAVED TAPER AT LOCAL ROADS

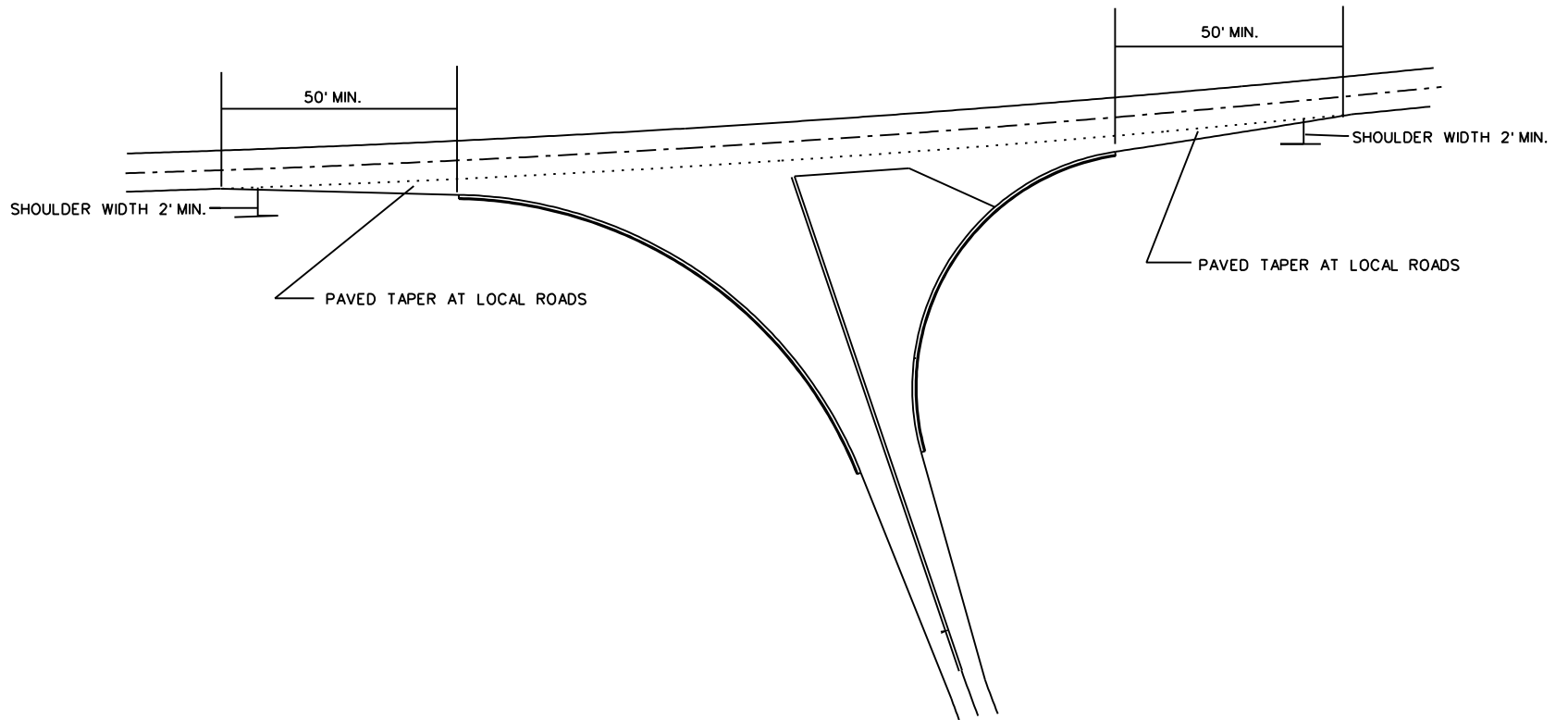

Milling and Overlaying SR 13 from the Pearl River/Lamar County Line to the Boulevard section in Lumberton, known as State Project No. MP-6013-37(008) / 303254301, in the County of Lamar, State of Mississippi.

I (We) agree to complete the entire project within the specified contract time.

**\*\*\* SPECIAL NOTICE TO BIDDERS \*\*\***

**BIDS WILL NOT BE CONSIDERED UNLESS BOTH UNIT PRICES AND ITEM TOTALS ARE ENTERED.  
 BIDS WILL NOT BE CONSIDERED UNLESS THE BID CERTIFICATION LOCATED AT THE END OF THE BID SHEETS IS SIGNED**

**\*\*\*BID SCHEDULE\*\*\***

Line No.	Item Code	Adj Code	Quantity	Units	Description	Unit Price		Item Amount	
						Dollar	Ct	Dollar	Ct
<b>Roadway Items</b>									
0010	202-B076		800	Linear Feet	Removal of Traffic Stripe				
0020	202-B078		550	Square Yard	Removal of Pavement, All Types and Depths				
0030	203-E103	(E)	740	Cubic Yard	Borrow Excavation, LVM, Class B7-6				
0040	406-A001 Changed 02/15/2008		16,510	Square Yard	Cold Milling of Bituminous Pavement, All Depths				
0050	618-A001		1	Lump Sum	Maintenance of Traffic	XXXXXXXX	XXX		
0060	618-B001		1	Square Feet	Additional Construction Signs	10.	00	10.	00
0070	619-A1002		10	Mile	Temporary Traffic Stripe, Continuous White				
0080	619-A2002		4	Mile	Temporary Traffic Stripe, Continuous Yellow				

Line No.	Item Code	Adj Code	Quantity	Units	Description	Unit Price		Bid Amount	
0090	619-A3006		2	Mile	Temporary Traffic Stripe, Skip White				
0100	619-A4006		2	Mile	Temporary Traffic Stripe, Skip Yellow				
0110	619-A5001		3,240	Linear Feet	Temporary Traffic Stripe, Detail				
0120	619-A6001		3,250	Linear Feet	Temporary Traffic Stripe, Legend				
0130	626-A002		1	Mile	6" Thermoplastic Traffic Stripe, Skip White				
0140	626-D002		1	Mile	6" Thermoplastic Traffic Stripe, Skip Yellow				
0150	626-E002		1	Mile	6" Thermoplastic Traffic Stripe, Continuous Yellow				
0160	626-G001		4,710	Linear Feet	Thermoplastic Detail Stripe, White				
0170	626-G002		3,890	Linear Feet	Thermoplastic Detail Stripe, Yellow				
0180	626-H001		938	Square Feet	Thermoplastic Legend, White				
0190	626-H002		3,250	Linear Feet	Thermoplastic Legend, White				
0200	627-K001		360	Each	Red-Clear Reflective High Performance Raised Markers				

Line No.	Item Code	Adj Code	Quantity	Units	Description	Unit Price		Bid Amount	
0210	627-L001		115	Each	Two-Way Yellow Reflective High Performance Raised Markers				
0220	628-J002		400	Linear Feet	6" High Performance Cold Plastic Traffic Stripe, Continuous White				
0230	628-L002		200	Linear Feet	6" High Performance Cold Plastic Traffic Stripe, Skip Yellow				
0240	628-M002		200	Linear Feet	6" High Performance Cold Plastic Traffic Stripe, Continuous Yellow				
0250	907-403-A007	(BA1)	285	Ton	Hot Mix Asphalt, MT, 19-mm mixture				
0260	907-403-A010	(BA1)	5,600	Ton	Hot Mix Asphalt, MT, 9.5-mm mixture				
0270	907-403-B006	(BA1)	2,500	Ton	Hot Mix Asphalt, MT, 9.5-mm mixture, Leveling				
0280	907-626-C003		5	Mile	6" Thermoplastic Double Drop Edge Stripe, Continuous White				
0290	907-626-F006		2	Mile	6" Thermoplastic Double Drop Edge Stripe, Continuous Yellow, 90 mil min				



\*\*\* BID CERTIFICATION \*\*\*

TOTAL BID.....\$\_\_\_\_\_

\*\*\* SIGNATURE STATEMENT \*\*\*

BIDDER ACKNOWLEDGES THAT HE/SHE HAS CHECKED ALL ITEMS IN THIS PROPOSAL FOR ACCURACY AND CERTIFIED THAT THE FIGURES SHOWN THEREIN CONSTITUTE THEIR OFFICIAL BID.

\_\_\_\_\_  
BIDDER'S SIGNATURE

\_\_\_\_\_  
BIDDER'S COMPANY

\_\_\_\_\_  
BIDDER'S FEDERAL TAX ID NUMBER