

**GENERAL INDEX**

FOR DETAILED INDEX OF PLANS SEE SHEET NO. 2

**STATE OF MISSISSIPPI**

**MISSISSIPPI DEPARTMENT OF TRANSPORTATION**

**PLAN AND PROFILE OF PROPOSED  
STATE HIGHWAY  
STATE PROJECT NO. MP-1341-58(005)**

*004-09-08*

*SR 341 FROM CALHOUN COUNTY LINE TO SR 9  
PONTOTOC COUNTY*

**FMS CON: 303384/301000**

**SCALES**

**PLAN** 1 IN. = 100 FT.  
**PROFILE** { **HOR.** 1 IN. = 100 FT.  
                  **VERT.** 1 IN. = 10 FT.  
**LAYOUT** 1 IN. = FT.

FED. ROAD REG. NO.	STATE	PROJECT NO.	SHEET NO.
4	MISS.	MP-1341-58(005)	1

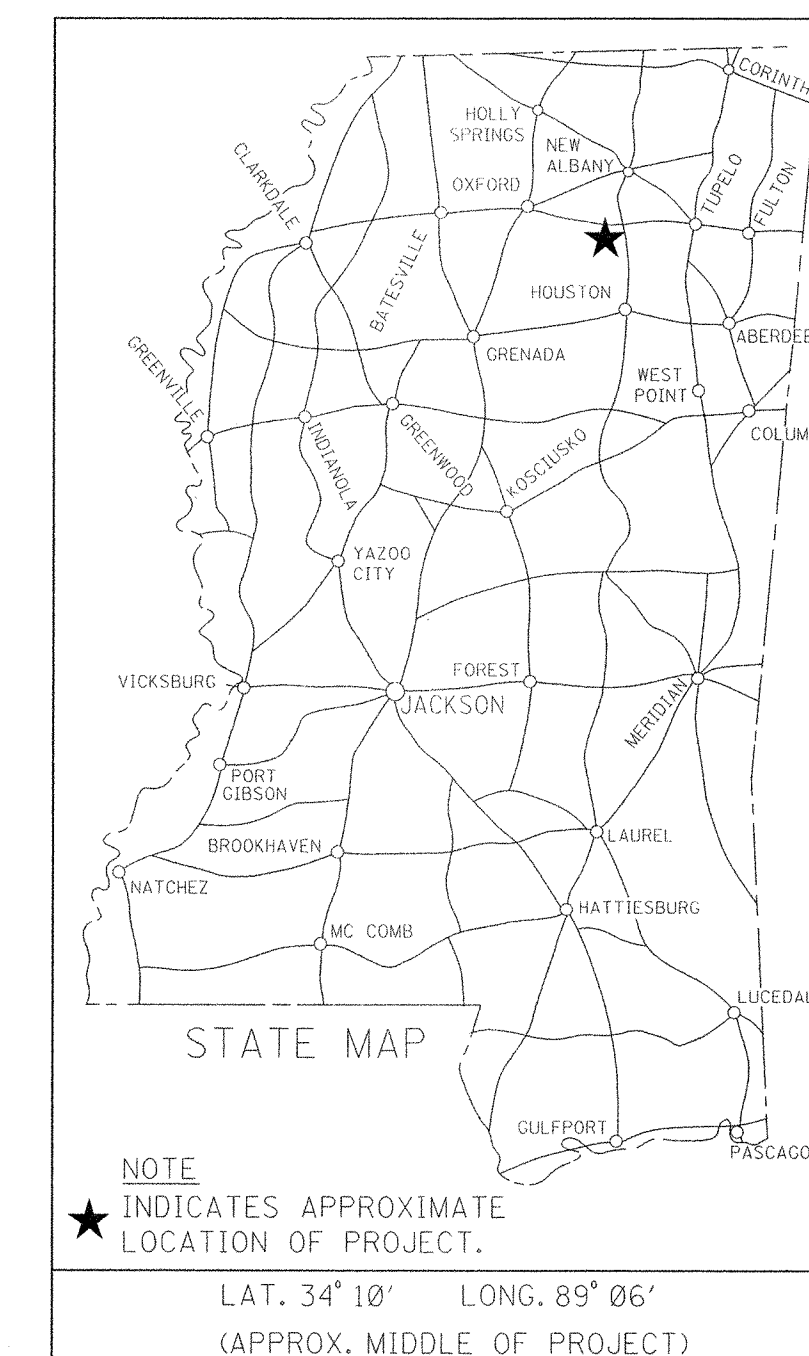

NOTE  
★ INDICATES APPROXIMATE LOCATION OF PROJECT.  
LAT. 34° 18' LONG. 89° 06'  
(APPROX. MIDDLE OF PROJECT)

**EXISTING BRIDGES**  
Bridge #33.5 Sta 109+59 TO 110+16  
Bridge #35.4 Sta 184+83 TO 186+49  
Bridge #41.4 Sta 489+87 TO 491+67  
Bridge #47.0 Sta 784+07 TO 785+27

**EXISTING BOX BRIDGES**  
**NONE**

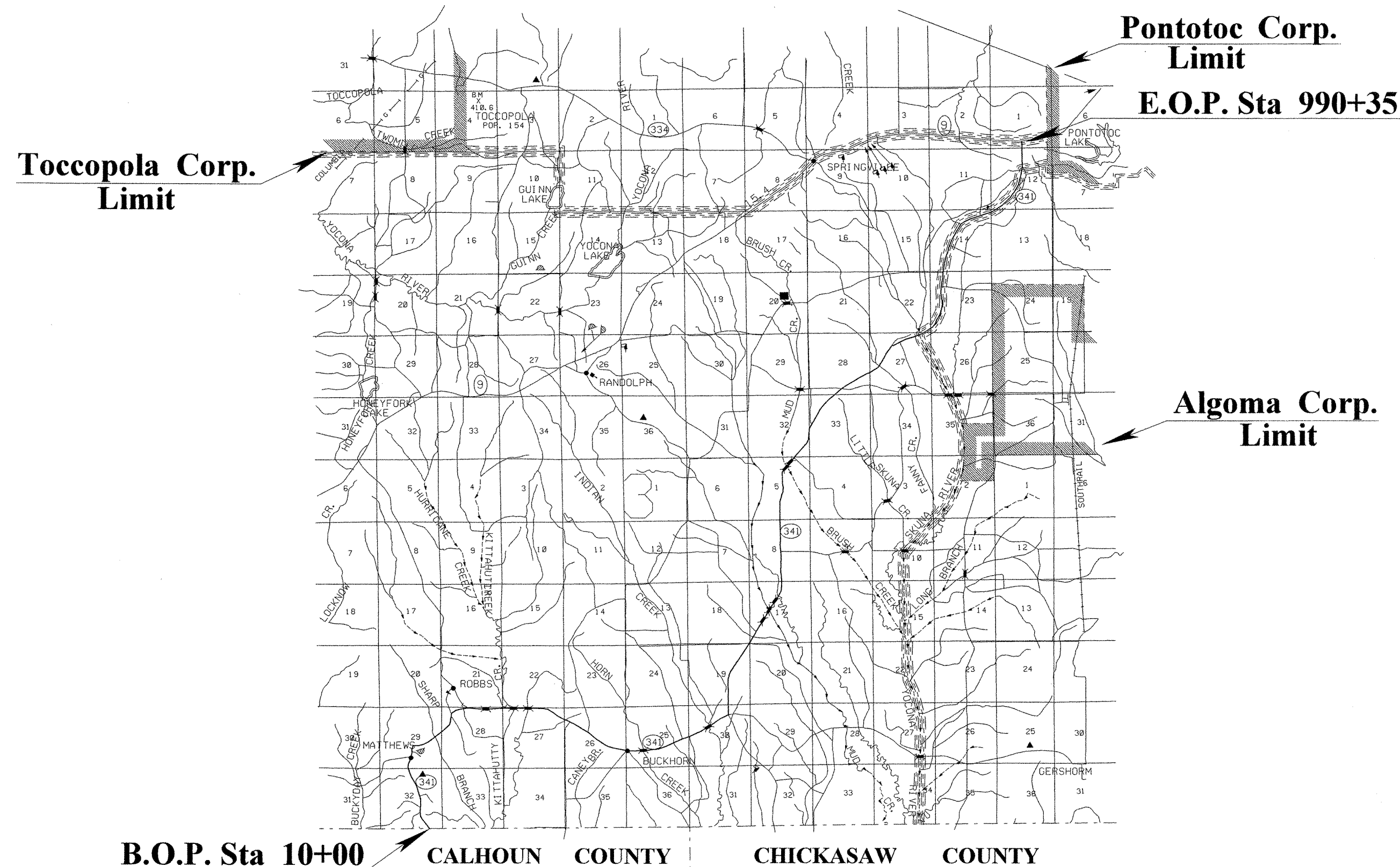

**DESIGN CONTROL**  
MPH = V (SPEED DESIGN)  
ADT ( ) = : ADT ( ) =  
DHV = : D = % T = %

**PERMITS ACQUIRED BY MDT**  
WETLANDS AND WATERS PERMITS (NECESSARY FOR ULTIMATE IMPROVEMENTS ONLY):

	WATERS	WETLANDS
NATIONWIDE #14	<input type="checkbox"/>	<input type="checkbox"/>
NATIONWIDE (OTHER)*	<input type="checkbox"/>	<input type="checkbox"/>
GENERAL*	<input type="checkbox"/>	<input type="checkbox"/>
INDIVIDUAL (404)*	<input type="checkbox"/>	<input type="checkbox"/>

\* ACQUISITION OF PERMITS FOR TEMPORARY IMPACTS DURING CONSTRUCTION ARE THE RESPONSIBILITY OF THE CONTRACTOR

**STORMWATER PERMIT**

**Y** REQUIRED, CNOI SUBMITTED BY MDT (DISTRIBUTED AREA=5 ACRES+)(NTB 6484)  
**S** REQUIRED, SCNOI TO BE SUBMITTED BY CONTRACTOR (1 TO 4.99 ACRES)(NTB 6483)  
**N** NO STORMWATER PERMIT REQUIRED (<1 ACRE)

APPROVED BY: *JCR* DATE: *04/09/08*

**CONVENTIONAL SYMBOLS**

- COUNTY LINE -----
- TOWN CORPORATION LINE -----
- SECTION LINE -----
- EXISTING ROAD OR TRAVELED WAY -----
- PROPOSED ROAD OR TRAVELED WAY -----
- RAILROAD -----
- SURVEY LINE -----
- BRIDGES -----

**EQUATIONS**

NONE

**EXCEPTIONS**

NONE

**LENGTH DATA**

LENGTH OF ROADWAY	97512	FT.	18.468	MI.
LENGTH OF BRIDGES	523	FT.	0.099	MI.
LENGTH OF PROJECT (NET)	98035		18.567	MI.
LENGTH OF EXCEPTIONS		FT.		MI.
LENGTH OF PROJECT (GROSS)	98035		18.567	MI.

REVISIONS	DATE	BY	APPROVED:	DATE
			<i>Harry Lee James</i>	<i>4/8/08</i>
			CHIEF ENGINEER	DATE
			<i>Ray R. Brown</i>	DATE
			EXECUTIVE DIRECTOR	DATE
			MISSISSIPPI DEPARTMENT OF TRANSPORTATION	
			APPROVED:	
			DIVISION ADMINISTRATOR	DATE
			FEDERAL HIGHWAY ADMINISTRATION DEPARTMENT OF TRANSPORTATION	

TITLE ROADWAY DESIGN DIVISION MISSISSIPPI DEPARTMENT OF TRANSPORTATION

4/8/2008 11:37 PM TITLE SHEET.DGN

