

GENERAL INDEX

FOR DETAILED INDEX OF PLANS SEE SHEET NO. 2

STATE OF MISSISSIPPI
MISSISSIPPI DEPARTMENT OF TRANSPORTATION

PLAN AND PROFILE OF PROPOSED
STATE HIGHWAY
STATE PROJECT NO. MP-1366-71(004)
MP-1760-71(001)

04-09-08

SR 366 FROM SR 25 TO ALA LINE
AND SR 760 FROM SR 25 TO SR 366
TISHOMINGO CO

303385/301000
303385/302000

FED. ROAD REG. NO.	STATE	PROJECT NO.	SHEET NO.
4	MISS.	MP-1366-71(004) MP-1760-71(001)	1

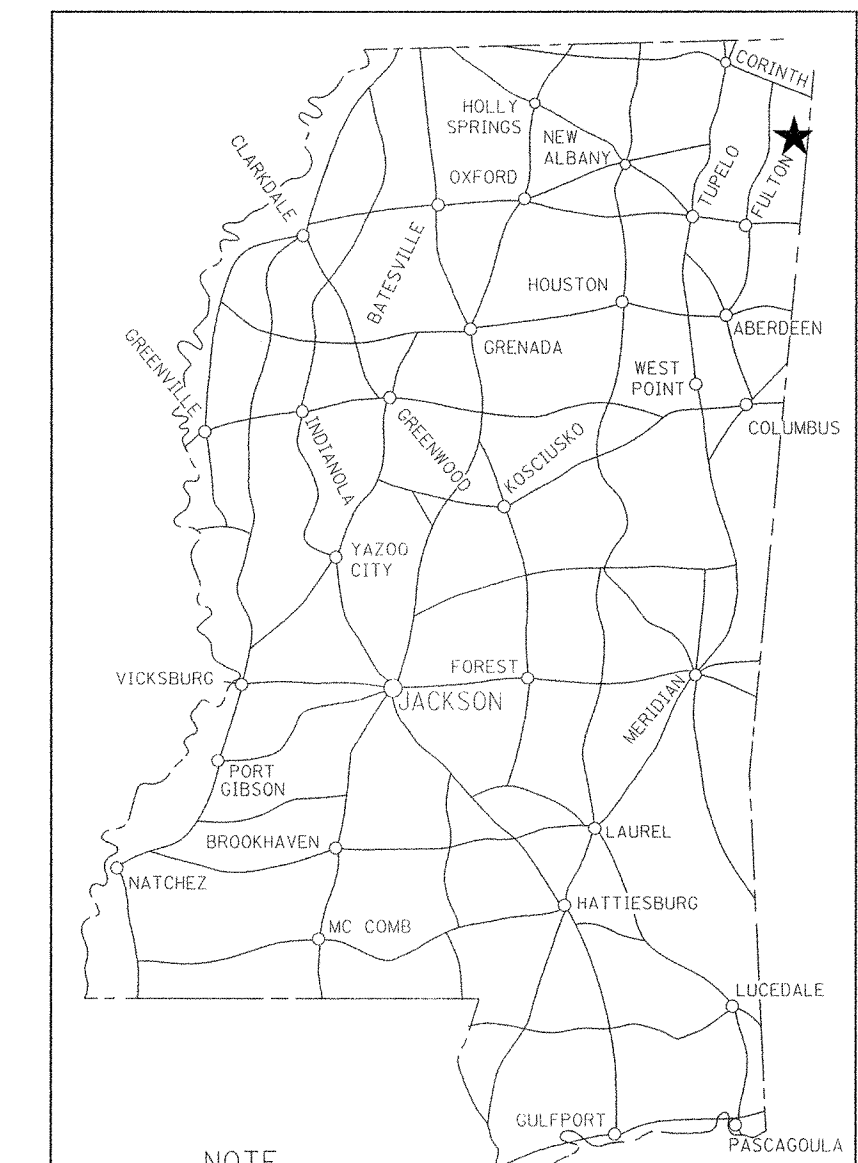

NOTE
★ INDICATES APPROXIMATE LOCATION OF PROJECT.
LAT. 34°29'18"N
LONG. 88°11'19"W
(APPROX. MIDDLE OF PROJECT)

BRIDGE STRUCTURES REQ'D.
NONE

B.O.P. STA. 1+78

BOX BRIDGE'S REQ'D.
NONE

B.O.P. STA. 1+32

E.O.P. STA. 84+70

E.O.P. STA. 221+58

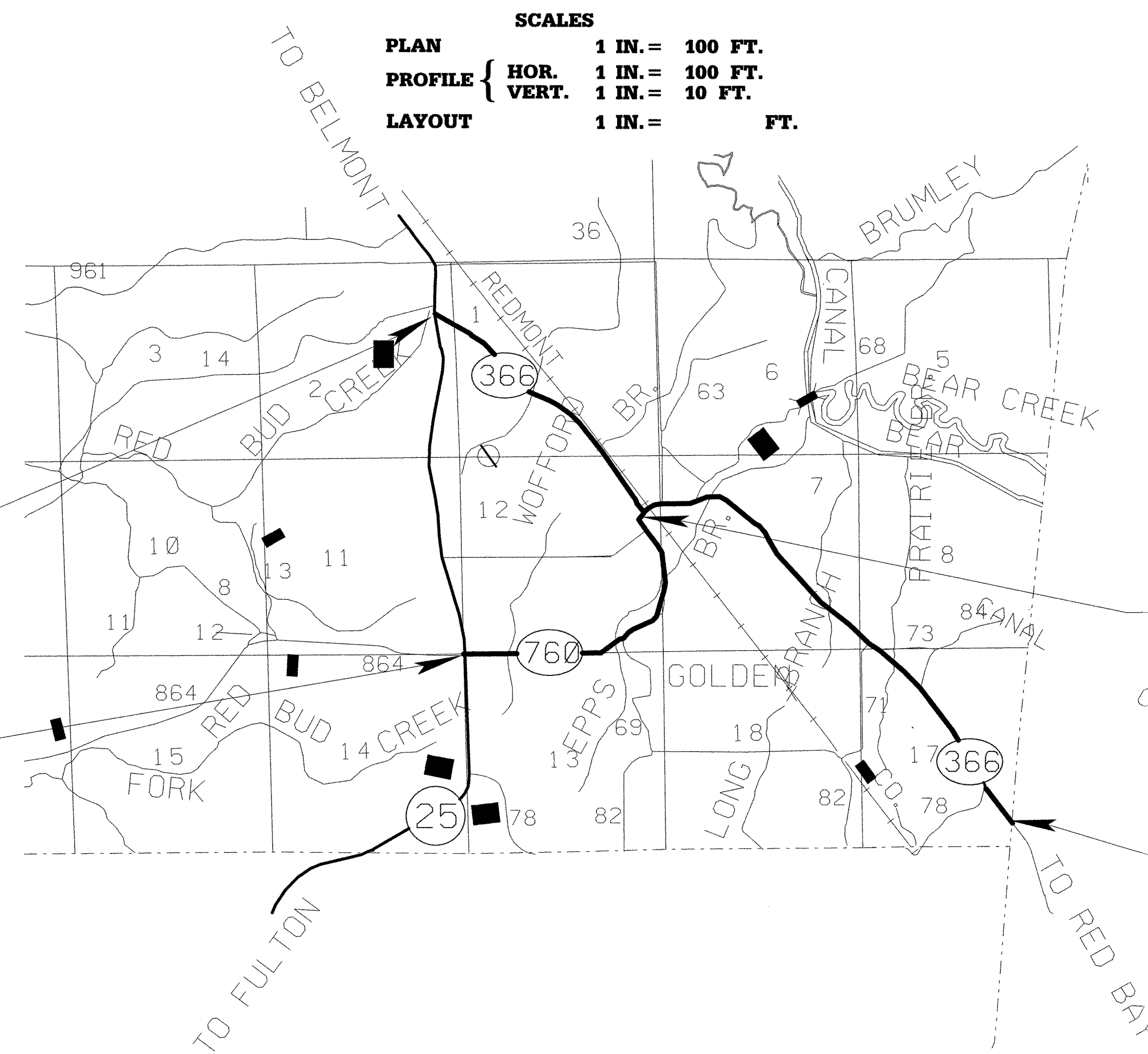

SCALES
PLAN 1 IN. = 100 FT.
PROFILE { HOR. 1 IN. = 100 FT.
VERT. 1 IN. = 10 FT.
LAYOUT 1 IN. = 100 FT.

DESIGN CONTROL		
MPH = V (SPEED DESIGN)		
ADT () = :	ADT () =	
DHV = :	D = %	T = %
PERMITS ACQUIRED BY MDOT		
WETLANDS AND WATERS PERMITS (NECESSARY FOR ULTIMATE IMPROVEMENTS ONLY):		
NATIONWIDE #14	WATERS	WETLANDS
NATIONWIDE (OTHER)*	<input checked="" type="checkbox"/>	<input checked="" type="checkbox"/>
GENERAL*	<input checked="" type="checkbox"/>	<input checked="" type="checkbox"/>
INDIVIDUAL (404)*	<input checked="" type="checkbox"/>	<input checked="" type="checkbox"/>
* ACQUISITION OF PERMITS FOR TEMPORARY IMPACTS DURING CONSTRUCTION ARE THE RESPONSIBILITY OF THE CONTRACTOR		
STORMWATER PERMIT <input checked="" type="checkbox"/>		
Y	REQUIRED (NOI SUBMITTED BY MDOT (DISTRIBUTED AREA=5 ACRES)/(NTB 586))	
S	REQUIRED (NOI TO BE SUBMITTED BY CONTRACTOR (1 TO 4.99 ACRES)/(NTB 14))	
N	NO STORMWATER PERMIT REQUIRED (<1 ACRE)	
APPROVED BY: SCR DATE: 04/09/08		

CONVENTIONAL SYMBOLS

- COUNTY LINE -----
- TOWN CORPORATION LINE -----
- SECTION LINE -----
- EXISTING ROAD OR TRAVELED WAY -----
- PROPOSED ROAD OR TRAVELED WAY -----
- RAILROAD -----
- SURVEY LINE -----
- BRIDGES -----

EQUATIONS
NONE

EXCEPTIONS
NONE

LENGTH DATA

	301000	302000	TOTAL
LENGTH OF ROADWAY	21980 FT.	4.163 MI.	8338 FT.
LENGTH OF BRIDGES	0 FT.	0 MI.	1.579 MI.
LENGTH OF PROJECT (NET)	0 FT.	4.163 MI.	0 FT.
LENGTH OF EXCEPTIONS	0 FT.	0 MI.	5.742 MI.
LENGTH OF PROJECT (GROSS)	0 FT.	4.163 MI.	0 FT.
			5.742 MI.

APPROVED:	<i>Kamy Lee James</i>	4/9/08
CHIEF ENGINEER		DATE
EXECUTIVE DIRECTOR	<i>Sam R. Brown</i>	DATE
MISSISSIPPI DEPARTMENT OF TRANSPORTATION		
APPROVED:		
DIVISION ADMINISTRATOR		DATE
FEDERAL HIGHWAY ADMINISTRATION DEPARTMENT OF TRANSPORTATION		

