

STATE OF MISSISSIPPI

MISSISSIPPI DEPARTMENT OF TRANSPORTATION

PLAN AND PROFILE OF PROPOSED STATE HIGHWAY STATE PROJECT NO. MP-2007-47(004)

OVERLAY OF MISS. HWY. NO. 7 BETWEEN WALL DOXEY STATE PARK AND MISS. HWY. NO. 4

FMS 303439 / 301000

MARSHALL COUNTY

①04-21-08

STA. 635 + 65.40 - B.O.P.

STA. 907 + 57.24 - E.O.P.

SCALES
PLAN 1 IN. = 100 FT.
PROFILE { HOR. 1 IN. = 100 FT.
 VERT. 1 IN. = 10 FT.
LAYOUT 1 IN. = 3500 FT.

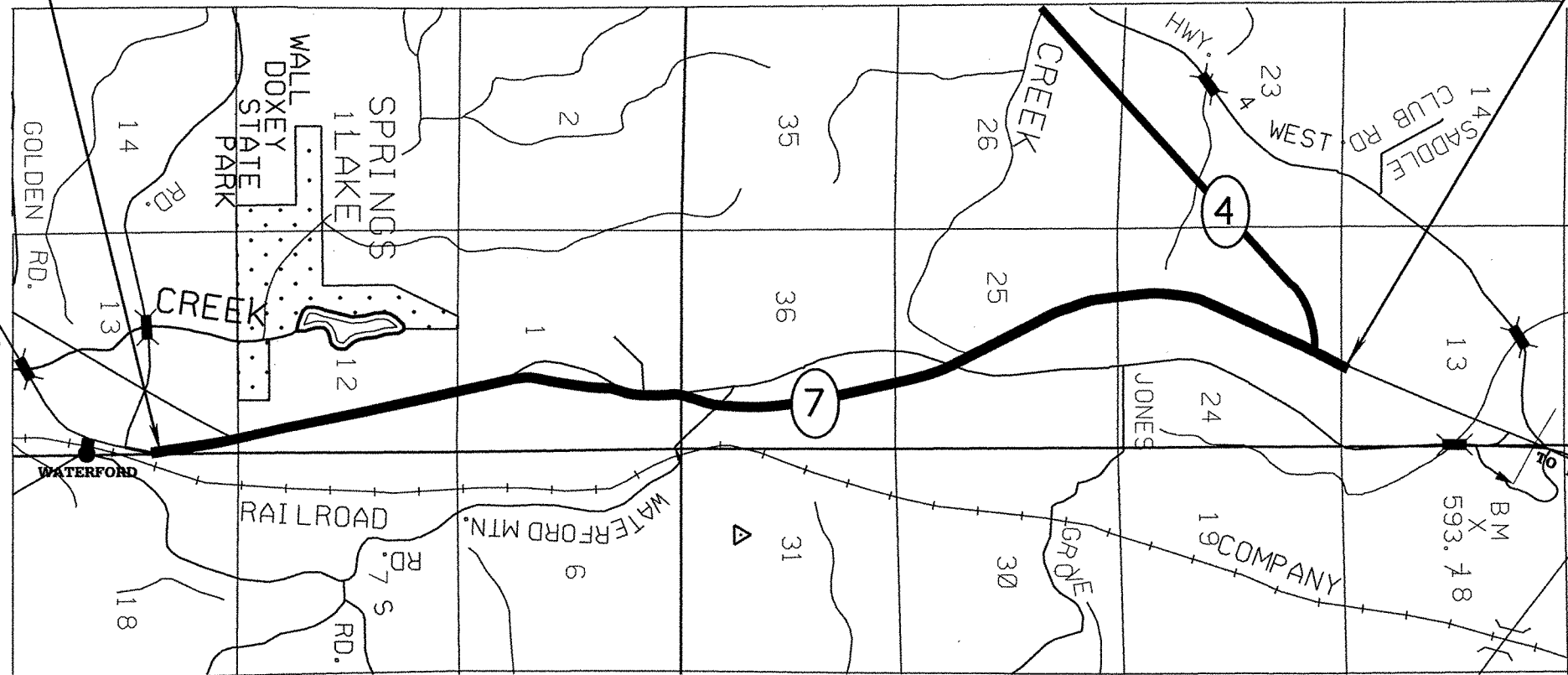

FED. ROAD REG. NO.	STATE	PROJECT NO.	SHEET NO.
4	MISS.	MP-2007-47(004)	1

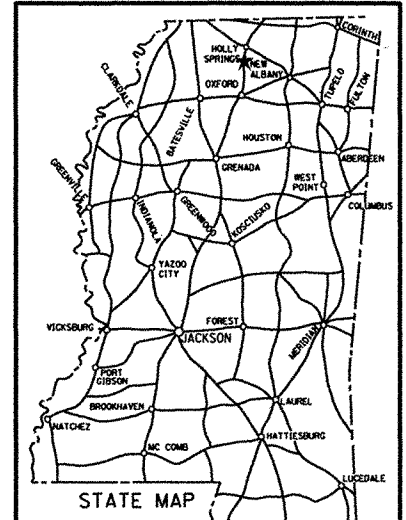

NOTE
★ INDICATES APPROXIMATE LOCATION OF PROJECT.
LAT. N 34° 41' 45" LONG. W 89° 27' 43"
(APPROX. MIDDLE OF PROJECT)

DESIGN CONTROL	
65 MPH = V (SPEED DESIGN)	
ADT () = ; ADT () =	
DHV = ; D = % T = %	

PERMITS ACQUIRED BY MDOT		
WETLANDS AND WATERS PERMITS (NECESSARY FOR ULTIMATE IMPROVEMENTS ONLY):		
	WATERS	WETLANDS
NATIONWIDE #14	<input checked="" type="checkbox"/>	<input checked="" type="checkbox"/>
NATIONWIDE (OTHER)*	<input checked="" type="checkbox"/>	<input checked="" type="checkbox"/>
GENERAL*	<input checked="" type="checkbox"/>	<input checked="" type="checkbox"/>
INDIVIDUAL (404)*	<input checked="" type="checkbox"/>	<input checked="" type="checkbox"/>
* ACQUISITION OF PERMITS FOR TEMPORARY IMPACTS DURING CONSTRUCTION ARE THE RESPONSIBILITY OF THE CONTRACTOR		
STORMWATER PERMIT <input checked="" type="checkbox"/>		
Y	REQUIRED, CADD SUBMITTED BY MDOT (DISTRIBUTED AREA = 5 ACRES - INTB 388)	
S	REQUIRED, SCAD TO BE SUBMITTED BY CONTRACTOR (1 TO 4.99 ACRES) (INTB 14)	
N	NO STORMWATER PERMIT REQUIRED (<1 ACRE)	
APPROVED BY:	TRP	DATE: 4/18/08

CONVENTIONAL SYMBOLS

- COUNTY LINE
- TOWN CORPORATION LINE
- SECTION LINE
- EXISTING ROAD OR TRAVELED WAY
- PROPOSED ROAD OR TRAVELED WAY
- RAILROAD
- SURVEY LINE
- BRIDGES

EQUATIONS

717 + 33.15 BK = 717 + 14.80 AH. = +18.25 FT.
 735 + 00.00 BK = 735 + 18.09 AH. = -18.09 FT.
 = +0.16 FT.

EXCEPTIONS

NONE

LENGTH DATA

LENGTH OF ROADWAY	27,192 FT.	5.15 MI.
LENGTH OF BRIDGES	NONE FT.	0.000 MI.
LENGTH OF PROJECT (NET)		5.15 MI.
LENGTH OF EXCEPTIONS	NONE FT.	0.000 MI.
LENGTH OF PROJECT (GROSS)		5.15 MI.

APPROVED: *Harry Lee James* 118
 CHIEF ENGINEER DATE 4/18/08
Tommy R. Brown
 EXECUTIVE DIRECTOR DATE 4/18/08
 MISSISSIPPI DEPARTMENT OF TRANSPORTATION
 APPROVED: _____ DATE _____
 DIVISION ADMINISTRATOR
 FEDERAL HIGHWAY ADMINISTRATION
 DEPARTMENT OF TRANSPORTATION

1st O. REV.

STATE	PROJECT NO.
MISS.	MP-2007-47(004)

DESCRIPTION OF SHEET	REVISION	WKG. NO.	SH. NO.	DESCRIPTION OF SHEET	REVISION	WKG. NO.	SH. NO.
<u>TITLE SHEETS (1)</u>				<u>STANDARD DRAWING SHEETS (8)</u>			
TITLE SHEET			1	PAVEMENT MARKING DETAILS FOR 2 & 4-LANE DIVIDED ROADWAYS		PM-1	120
<u>DETAILED INDEX & GENERAL NOTES SHEET (2)</u>				PAVEMENT MARKING DETAIL FOR 4-LANE & 5-LANE UNDIVIDED ROADWAYS		PM-2	121
DETAILED INDEX		DI-1	2	PAVEMENT MARKING LEGEND DETAILS		PM-3	125
GENERAL NOTES		GN-1	3	TRAFFIC CONTROL PLAN WITH FLAGGER (ONE-LANE OF TWO-WAY TRAFFIC)		TCP-1	250
<u>TYPICAL SECTION SHEETS (1)</u>				SHORT DURATION CLOSING OF TWO-LANE TWO-WAY HIGHWAYS		TCP-8	257
TYPICAL SECTION MAINLINE		TS-1	4	HIGHWAY SIGN & BARRICADE DETAILS FOR CONSTRUCTION PROJECTS		TCP-10	259
<u>QUANTITY SHEETS (2)</u>				TEMPORARY STRIPING FOR TRAFFIC CONTROL 2-LANE & 4-LANE DIVIDED HIGHWAYS		TCP-15	264
SUMMARY OF QUANTITIES		SQ-1	5	SUPERELEVATION TRANSITION CASE I ROTATION ABOUT CENTERLINE (2% NORMAL SUBGRADE)		SE-2A	276
SUMMARY OF QUANTITIES		SQ-2	6				
<u>SPECIAL DESIGN SHEETS (6)</u>				TOTAL SHEETS (20)			
MISCELLANEOUS DETAIL		MDS-1	7				
RUMBLE STRIPE (GROUND- IN) 2-LANE HIGHWAY		RS-2L	8				
PAVEMENT MARKING PLANS FOR WALL DOXEY ENTRANCE		PMD-1	9				
PAVEMENT MARKING PLANS FOR WALL DOXEY ENTRANCE		PMD-2	10				
DETAIL OF CONSTRUCTION SIGNING		DCS-1	11				
CURVE DATA TABLES		CDT-1	12				

ROADWAY DESIGN DIVISION C.A.D.D. SECTION MISSISSIPPI DEPARTMENT OF TRANSPORTATION

L.FREDERICK/R. MASSENGILL

PS & E PLANS-DATE 04/21/08		
FMS CON. # 303439/301000		
REVISIONS		
DATE	SHEET NO.	BY
04/25/08	4, 6 & 10	MF

118	
MISSISSIPPI DEPARTMENT OF TRANSPORTATION	
DETAILED INDEX	
PROJECT NO.: MP-2007-47(004)	
COUNTY : MARSHALL	
DATE	WORKING NUMBER
	DI-1
FILENAME: DETAILEDINDEX.DGN	SHEET NUMBER
	2
DESIGN TEAM	CHECKED DATE

COUNTY: MARSHALL

PROJECT NO.: MP-2007-47(004)

STATE	PROJECT NO.
MISS.	MP-2007-47(004)

GENERAL NOTES:

1. THE CONTRACTOR SHALL MAKE A MISSISSIPPI ONE-CALL REQUEST PRIOR TO ANY EXCAVATION OPERATION, EXCEPTING BOTH TRENCH WIDENING AND PAVEMENT REMOVAL AND REPAIR.
2. ANY INCIDENTAL OR NECESSARY GRADING OF ROADWAY DITCHES, AS DIRECTED BY THE ENGINEER, TO BE ABSORBED IN OTHER PAY ITEMS.
3. THE COST OF CLEARING AND GRUBBING TO BE ABSORBED IN OTHER PAY ITEMS.
4. BIDDERS ARE ADVISED THAT CROSS-SLOPES FOR CURVE SUPERELEVATIONS ARE TO BE BUILT IN ACCORDANCE WITH INFORMATION PROVIDED, SHEET 11, BY THE DEPARTMENT AND AS DIRECTED BY THE ENGINEER. TO ASSIST THE CONTRACTOR IN CORRECTLY PLACING THE CROSS SLOPE TRANSITIONS, THE DEPARTMENT WILL PROVIDE, AT THE PRE-CONSTRUCTION CONFERENCE, STATIONING AND PERCENT SLOPE INFORMATION. SUFFICIENT MILLING, PRE-LEVELING, AND/OR LEVELING QUANTITIES ARE PROVIDED, ON SHEET 5, IN THIS CONTRACT TO FACILITATE THIS WORK. ALL TRANSITION CROSS-SLOPES ARE TO BE ESTABLISHED AND CHECKED PRIOR TO PLACEMENT OF THE TOP LIFT OF PAVEMENT.
5. IN ORDER TO EXPEDITE THE SAFE MOVEMENT OF TRAFFIC AND TO PROTECT EACH PHASE OF THE WORK AS IT IS PERFORMED, A FIRM SEQUENCE OF OPERATIONS IS ESSENTIAL. THE WORK SHALL BE BEGUN AND CONTINUALLY PROSECUTED.
6. AS DIRECTED BY THE ENGINEER, REMOVE ANY MATERIAL PRODUCED FROM THE EXCAVATION OPERATION FOR TRENCH WIDENING THAT CANNOT BE REASONABLY ANTICIPATED TO BE USED AS PART OF THE FINAL SHOULDER. THIS REMOVAL SHALL BE ACCOMPLISHED SIMULTANEOUS WITH THE EXCAVATION OPERATION. MATERIAL THAT CANNOT REASONABLY BE ANTICIPATED TO BE USED IN THE FINAL SHOULDER SHALL NOT REMAIN ROLLED UP ON THE EXISTING SHOULDER OR BLADED DOWN THE SLOPE. THERE WILL BE NO SEPARATE PAYMENT FOR THIS WORK WHICH WILL BE INCLUDED IN THE COST OF THE TRENCH WIDENING OPERATIONS.
7. TRENCH WIDENING EXCAVATION MAY INCLUDE THE REMOVAL OF ASPHALT ALONG THE SHOULDER DUE TO PREVIOUS MAINTENANCE REPAIRS. THERE WILL BE NO SEPARATE PAYMENT FOR THIS WORK WHICH WILL BE INCLUDED IN THE COST OF THE TRENCH WIDENING OPERATIONS.
8. SHOULDERS SHALL BE BLADED, SHAPED AND COMPACTED THROUGHOUT THE LENGTH OF THE PROJECT REGARDLESS OF WHETHER GRANULAR MATERIAL IS REQUIRED. MORE MATERIAL THAN IS NECESSARY TO PROPERLY ESTABLISH THESE SHOULDERS MAY RESULT FROM THE FINAL GRADING OF THE SHOULDERS. THE ENGINEER MAY DIRECT THAT SOME OF THIS MATERIAL BE REMOVED FROM THE PROJECT. MATERIAL REMOVED FROM THE PROJECT WILL BE PAID FOR AS 203-G, EXCESS EXCAVATION (LVM) (AH). THIS ITEM MAY INCLUDE SMALL AMOUNTS OF ASPHALT THAT MAY BE WITHIN THESE EXCAVATION LIMITS.
9. ALL DRIVEWAY PADS ARE TO BE PAVED A DISTANCE TO TEN (10) FEET AND SHALL BE TAPERED TO FIT EXISTING CONDITIONS, ALLOWING SMOOTH ENTRY AND EXIT. SEE THE ATTACHED MISCELLANEOUS DETAIL, ON SHEET NO. 7. COUNTY ROADS AND/OR CITY STREETS ARE TO BE PAVED AND/OR MILLED TO THE RIGHT-OF-WAY LINE AS DIRECTED BY THE PROJECT ENGINEER.
10. HIGHWAYS, COUNTY ROADS AND/OR CITY STREETS MAY REQUIRE NEW STRIPE, AS DIRECTED BY THE ENGINEER.
11. THE CONTRACTOR SHALL PROVIDE ALL SIGNS AND TRAFFIC HANDLING DEVICES NECESSARY TO SAFELY MAINTAIN TRAFFIC AROUND OR THROUGH THE WORK AREAS.
12. INCIDENTAL WORK SUCH AS REMOVING VEGETATION, SHAPING AND COMPACTION OF SHOULDERS, INCIDENTAL GRADING OF DRIVEWAYS FOR POSITIVE DRAINAGE AND SLOPE AND OTHER INCIDENTAL WORK THAT IS NECESSARY TO COMPLETE THE WORK WILL NOT BE MEASURED FOR SEPARATE PAYMENT AND THE COST WILL BE INCLUDED IN THE ITEMS BID.
13. IT SHALL BE THE RESPONSIBILITY OF THE CONTRACTOR TO PROTECT THE ROADWAY AND ALL EXISTING STRUCTURES SUCH AS BRIDGES, CURBS AND OTHER FEATURES FROM DAMAGE WHICH MIGHT OCCUR DURING CONSTRUCTION. THE CONTRACTOR SHALL REPLACE OR REPAIR, AS DIRECTED BY THE ENGINEER, ANY STRUCTURES OR PORTION OF THE ROADWAY DAMAGED AS A RESULT OF CONTRACTOR'S OPERATIONS DURING THE LIFE OF THE CONTRACT. NO PAYMENT WILL BE MADE FOR REPLACEMENT OR REPAIR OF DAMAGED ITEMS, CAUSED BY THE CONTRACTOR'S OPERATIONS.
14. DUE CARE SHALL BE TAKEN DURING BOTH THE TRENCH WIDENING AND GRANULAR MATERIAL OPERATIONS TO BLADE MATERIAL TOWARD THE ROADWAY AND AWAY FROM THE DITCH LINE. MATERIAL SHALL BE REMOVED FROM THE ROADWAY GRASS IF INADVERTENTLY BLADED THERE.
15. AT BRIDGE ENDS AND AT THE END OF WORK DAYS, THE CONTRACTOR SHALL PROVIDE A TAPER AT ANY VERTICAL JOINT ON A THREE (3) FOOT TO ONE (1) INCH VERTICAL SLOPE.
16. SHOULD MILLING BE REQUIRED WITHIN A CURB AND GUTTER SECTION, THE CONTRACTOR SHALL CONTINUOUSLY KEEP THE TRAVEL SURFACE FREE FROM SURFACE WATER. THIS MAY REQUIRE CONTINUOUS TWENTY-FOUR (24) HOUR MONITORING AND SWEEPING OF THE PROJECT.

ROADWAY DESIGN DIVISION C.A.S.D. SECTION MISSISSIPPI DEPARTMENT OF TRANSPORTATION

		MISSISSIPPI DEPARTMENT OF TRANSPORTATION	
		GENERAL NOTES	
		PROJECT NO.: MP-2007-47(004)	
		COUNTY : MARSHALL	
		FILENAME: Generalnotes.DGN	
		DESIGN TEAM _____ CHECKED _____ DATE _____	
		WORKING NUMBER	SHEET NUMBER
		GN-1	3

COUNTY : MARSHALL

PROJECT NO.: MP-2007-47(004)