

Melinda L. McGrath
Deputy Executive Director/
Chief Engineer

Brenda Znachko
Deputy Executive Director/
Administration



Steven K. Edwards
Director
Office of Intermodal Pla

Willie Huff
Director
Office of Enforcement

Larry L. "Butch" Brown
Executive Director

P. O. Box 1850 / Jackson, Mississippi 39215-1850 / Telephone (601) 359-7001 / FAX (601) 359-7110 / GoMDOT.com

To: ALL POTENTIAL BIDDERS

Date: 08/22/2008

RE: ER-9354-00(002) & SP-9354-00(002) / 104637301 & 302 -- Hancock County

Bidders are hereby advised that Plan Sheet Nos. 83.1 and 83.2 as referenced in Notice to Bidders No. 2085 of Addendum No. 1, was inadvertently omitted from the plans. Attached for reference is a copy of these two sheets. These sheets show traffic control devices that should be included in the bid price for Maintenance of Traffic. These sheets will be added to the contract by supplemental agreement prior to execution.

Bidders are also advised that the 907-262-B, 8" PVC Pipe, With Joint Restraint, pay items listed on the summary of quantities sheet of the plans are in error. These pay items do not have joint restraints and are the same as pay item nos. 907-262-A.

Your formal acknowledgment of receipt of this notification will be entered into our records and indicates your understanding of the omission of sheet nos. 83.1 & 83.2 and the change to PVC pipe with joints restraints, and that you have bid accordingly. Please sign this sheet and return by FAX to MDOT Contract Administration Engineer at 601-359-7732.

Melinda McGrath, P.E.
Chief Engineer / Deputy Executive Director

Contractor

Authorized Signature



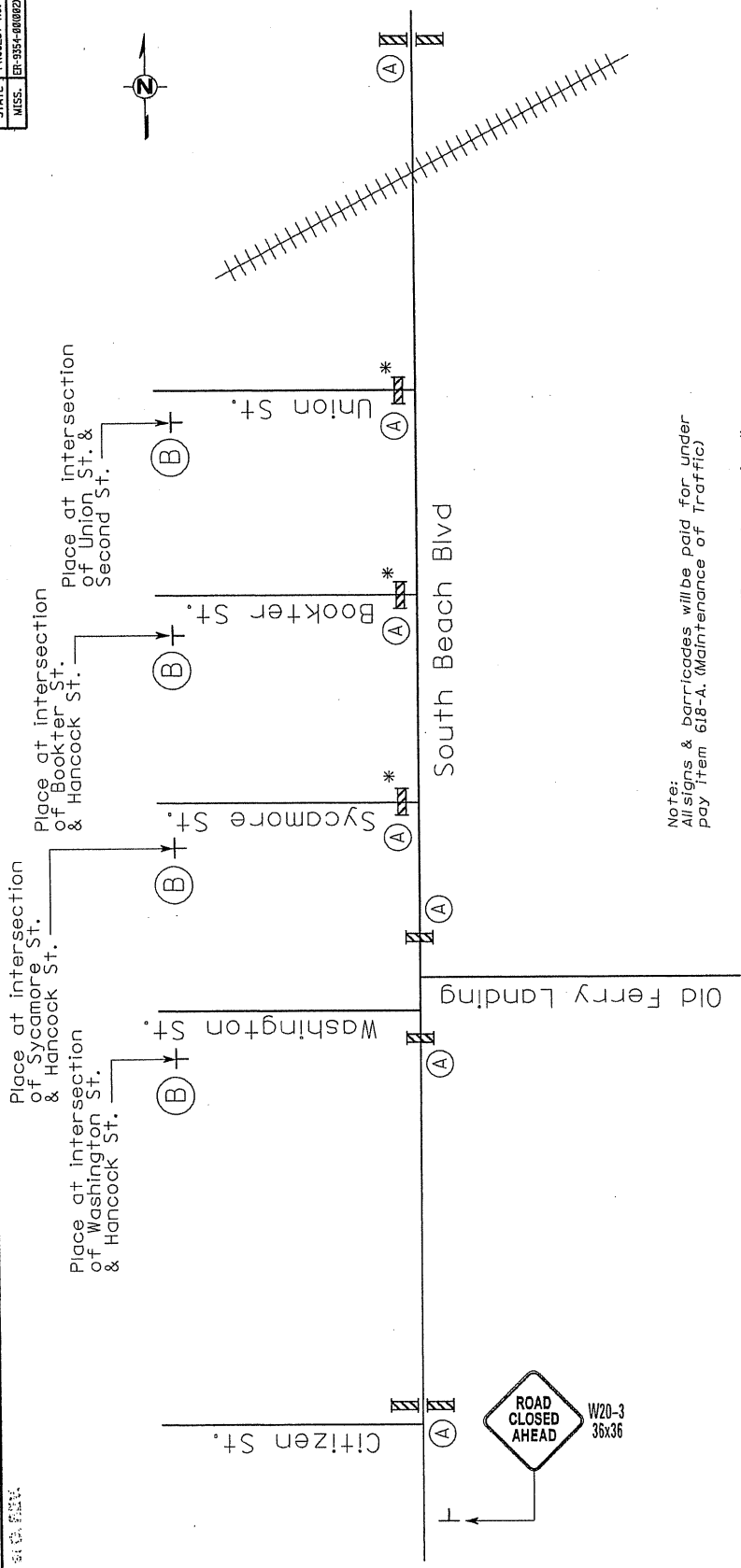

Note:
All signs & barricades will be paid for under
pay item 618-A. (Maintenance of Traffic)

* Single Faced Barricade (R1-1 not required)

Type III Barricade (Single Faced).....36'
Type III Barricade (Double Faced).....48'

SIGNING (TEMPORARY)	
TYPE	QUANTITY
R11-2	6
R11-4	4
R1-1	3

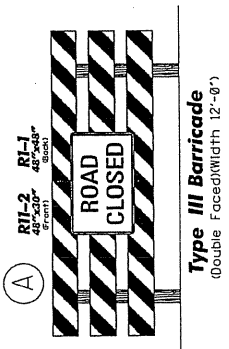
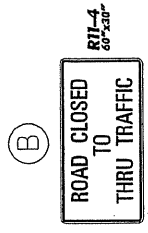

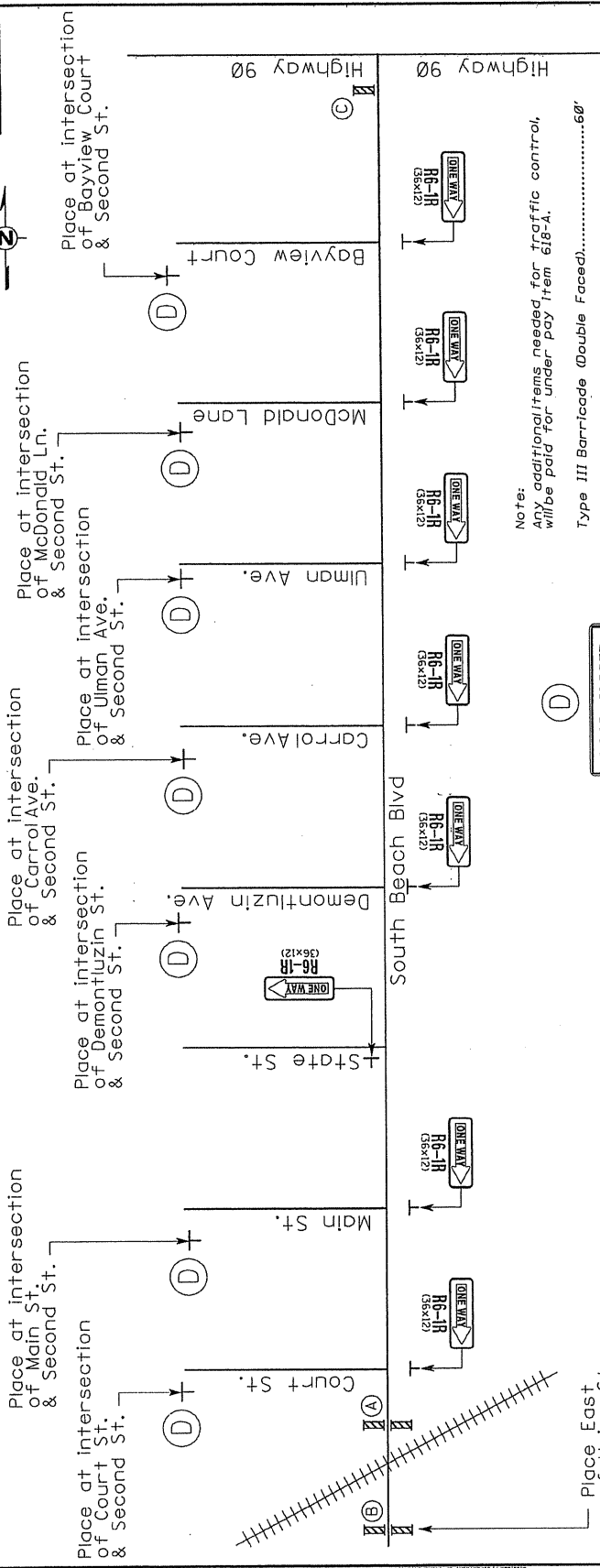

SIGNING (TEMPORARY)		
TYPE	SIZE	QUANTITY
R6-JR	36"x12"	8
R1-1	48"x48"	2
R11-2	48"x30"	2
W1-6R	48"x24"	1
R11-4	60"x30"	8

Note: Any additional items needed for traffic control, will be paid for under pay item 618-A.
Type III Barricade (Double Faced).....60'

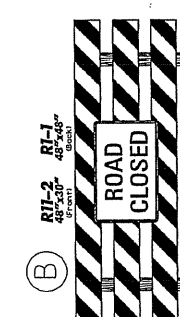
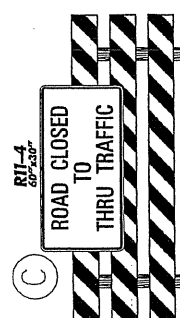
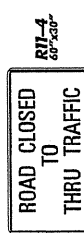

Type III Barricade
(Double Faced/Width 12'-0")

Type III Barricade
(Double Faced/Width 12'-0")

Type III Barricade
(Double Faced/Width 12'-0")

MISSISSIPPI DEPARTMENT OF TRANSPORTATION

Traffic Control Signs
South Beach Blvd

PROJECT NO: ER-3354-00(002)
COUNTY: Hancock
SHEET NUMBER: ICS-2
FILE NAME: ICS10152.GXD
DATE: 08/25/09
SCALE: AS SHOWN