

FOR DETAILED INDEX OF PLANS SEE SHEET NO. 2

STATE OF MISSISSIPPI

MISSISSIPPI DEPARTMENT OF TRANSPORTATION

**PLAN AND PROFILE OF PROPOSED STATE HIGHWAY FEDERAL AID PROJECT NO. STP-0055-01(092)**

09-16-08

ROADWAY LIGHTING ON I-55 AT EXIT 40, BROOKHAVEN 105226/301000  
LINCOLN COUNTY

**SCALES**  
 PLAN 1 IN. = 100 FT.  
 PROFILE { HOR. 1 IN. = 100 FT.  
 VERT. 1 IN. = 10 FT.  
 LAYOUT 1 IN. = 1500 FT.

FED. ROAD REG. NO.	STATE	PROJECT NO.	SHEET NO.
4	MISS.	STP-0055-01(092)	1

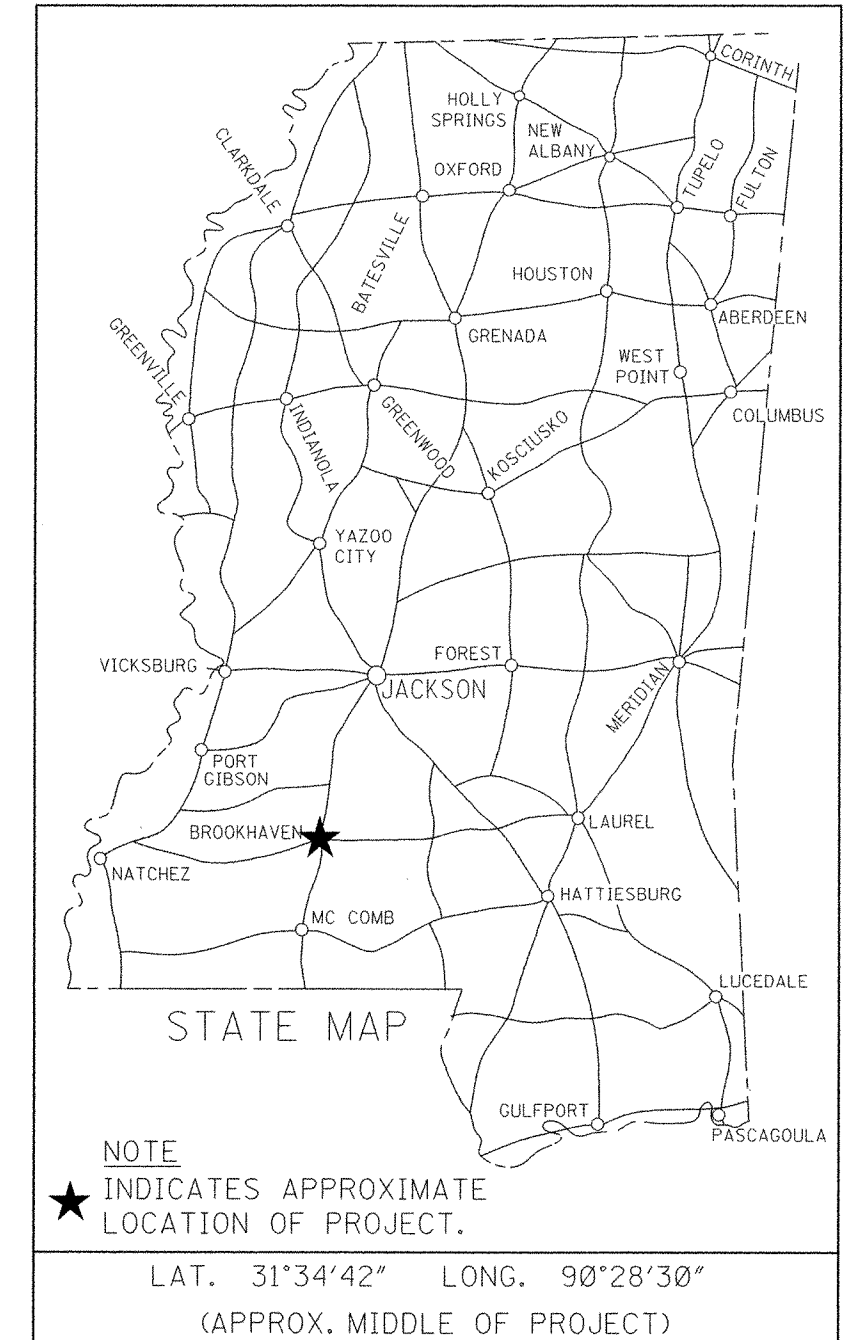

**BRIDGE STRUCTURES REQ'D. NONE**

**BOX BRIDGES REQ'D. NONE**

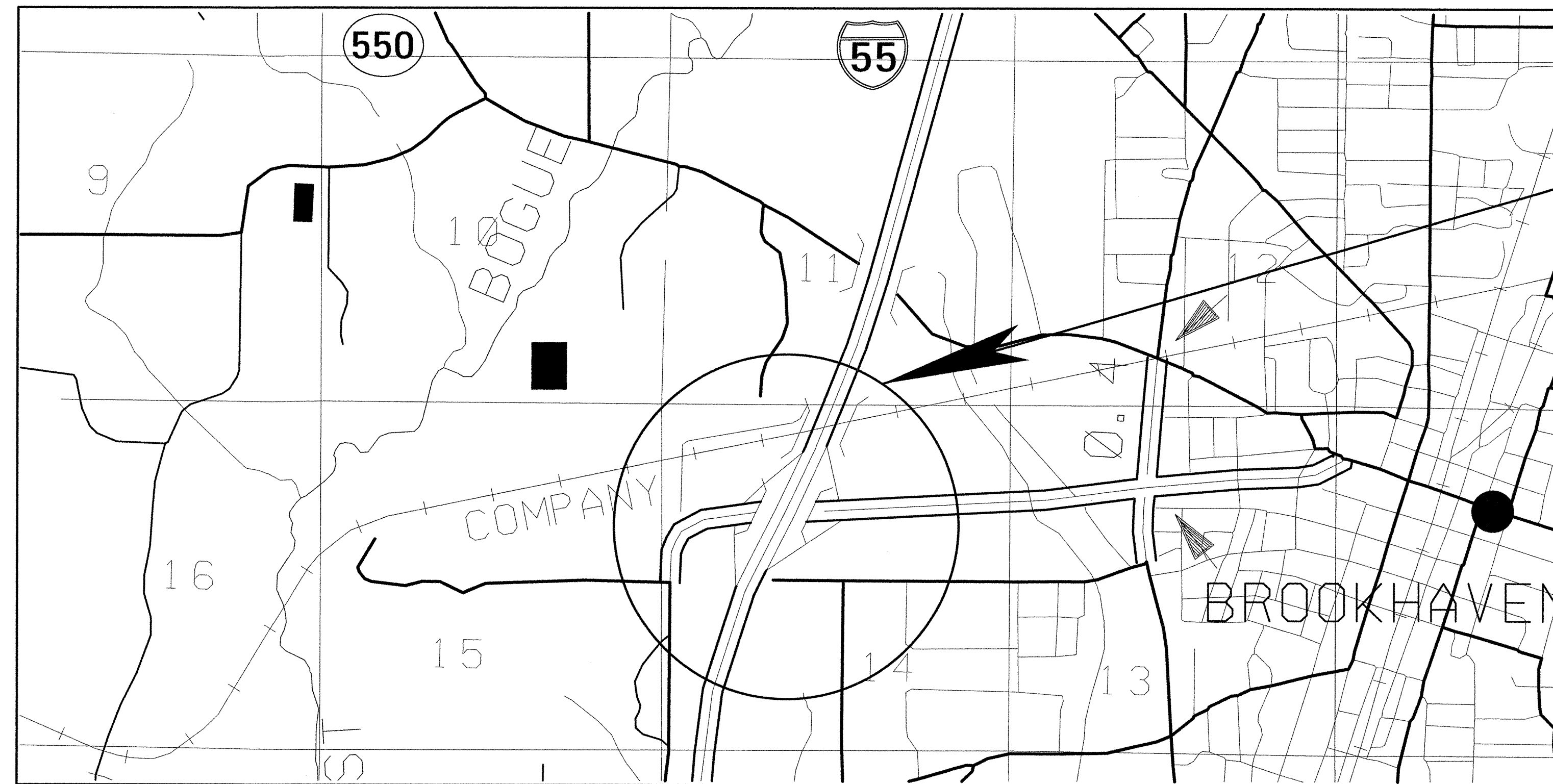

WORK AREA

**DESIGN CONTROL**  
 MPH = V (SPEED DESIGN)  
 ADT ( ) = : ADT ( ) =  
 DHV = : D = % T = %

**PERMITS ACQUIRED BY MDT**  
 WETLANDS AND WATERS PERMITS (NECESSARY FOR ULTIMATE IMPROVEMENTS ONLY):

	WATERS	WETLANDS
NATIONWIDE #14	N	N
NATIONWIDE (OTHER)*	N	N
GENERAL*	N	N
INDIVIDUAL (404)*	N	N

\* ACQUISITION OF PERMITS FOR TEMPORARY IMPACTS DURING CONSTRUCTION ARE THE RESPONSIBILITY OF THE CONTRACTOR

**STORMWATER PERMIT** N

Y REQUIRED, SCNOI SUBMITTED BY MDT (DISTRIBUTED AREA = 5 ACRES + JNTB 586)  
 S REQUIRED, SCNOI TO BE SUBMITTED BY CONTRACTOR (1 TO 4.99 ACRES) JNTB 14  
 N NO STORMWATER PERMIT REQUIRED (<1 ACRE)

APPROVED BY: CKP DATE: 9/16/08

**CONVENTIONAL SYMBOLS**

- COUNTY LINE -----
- TOWN CORPORATION LINE -----
- SECTION LINE -----
- EXISTING ROAD OR TRAVELED WAY -----
- PROPOSED ROAD OR TRAVELED WAY -----
- RAILROAD -----
- SURVEY LINE -----
- BRIDGES -----

**EQUATIONS NONE**

**EXCEPTIONS NONE**

**LENGTH DATA**

LENGTH OF ROADWAY	FT.	MI.
LENGTH OF BRIDGES	FT.	MI.
LENGTH OF PROJECT (NET)	FT.	MI.
LENGTH OF EXCEPTIONS	FT.	MI.
LENGTH OF PROJECT (GROSS)	FT.	MI.

9/15/2008 1:29 PM TITLE SHEET.DGN ROADWAY DESIGN DIVISION MISSISSIPPI DEPARTMENT OF TRANSPORTATION

APPROVED:	<i>Mark M. Smith</i>	9/15/08
BY:	CHIEF ENGINEER	DATE
APPROVED:	<i>Sam R. Brown</i>	9/15/08
BY:	EXECUTIVE DIRECTOR	DATE
MISSISSIPPI DEPARTMENT OF TRANSPORTATION		
APPROVED:		
DIVISION ADMINISTRATOR		DATE
FEDERAL HIGHWAY ADMINISTRATION DEPARTMENT OF TRANSPORTATION		

DESCRIPTION OF SHEET

DESCRIPTION OF SHEET	REVISION DATE	WKG. NO.	SH. NO.
TITLE SHEET (1)		--	1
DETAILED INDEX (1)		DI-1	2
GENERAL NOTES, ABBREVIATIONS & LEGEND (1)		GN-1	3
QUANTITY SHEETS (3)			
SUMMARY OF QUANTITIES		Q-1	4
RECAPITULATION OF QUANTITIES		Q-2	5
ESTIMATED QUANTITIES FOR TRAFFIC CONTROL SIGNS		TCPQ-1	6
PLAN & PROFILE SHEETS (2)			
LIGHTING LAYOUT - Sta. 840+00 to Sta. 861+00		L-1	7
LIGHTING LAYOUT - Sta. 861+00 to Sta. 885+00		L-2	8
SPECIAL DESIGN SHEETS (7)			
LIGHTING DETAILS		LD-1	9
LIGHTING DETAILS		LD-2	10
LIGHTING DETAILS		LD-3	11
LIGHTING DETAILS		LD-4	12
CONSTRUCTION SIGNING		CS-1	13
TRAFFIC CONTROL DETAILS DRUM PLACEMENT AND SHOULDER CLOSURE		TCD-1	14
LOCATION OF R 16-3 SIGNS		TCD-2	15
STANDARD DRAWINGS - ROADWAY SHEETS (5)			
TYPICAL TEMPORARY EROSION CONTROL MEASURES (SILT FENCE, HAY BALES & BRUSH BARRIER)		TEC-1	142
TRAFFIC CONTROL PLAN WITH FLAGGER (ONE LANE CLOSURE OF TWO-WAY TRAFFIC)		TCP-1	250
TRAFFIC CONTROL PLAN FOR POSTED SPEED LIMIT LESS THAN 65 MPH (4-LANE: MEDIAN LANE OR OUTSIDE LANE CLOSURE) (WORK DAY ONLY)		TCP-2	251
TRAFFIC CONTROL PLAN FOR POSTED SPEED LIMIT OF 65 OR 70 MPH (INTERSTATES AND OTHER 4-LANE DIVIDED HIGHWAYS) (MEDIAN OR OUTSIDE LANE CLOSURE) (WORK DAY ONLY)		TCP-5	254
HIGHWAY SIGN AND BARRICADE DETAILS FOR CONSTRUCTION PROJECTS		TCP-10	259
TOTAL SHEETS			20

ROADWAY DESIGN DIVISION C.A.D.D. SECTION  
MISSISSIPPI DEPARTMENT OF TRANSPORTATION

APEX Engineering Corporation

PS & E PLANS-DATE: 9/16/08		
FMS CON. # 105226/301000		
REVISIONS		
DATE	SHEET NO.	BY

		BY		MISSISSIPPI DEPARTMENT OF TRANSPORTATION	
				/08	
		PROJECT NO. STP-0055-01(092)			
				COUNTY : LINCOLN	
				WORKING NUMBER DI-1	
				SHEET NUMBER 2	
DATE	REVISION	FILENAME:	Checked	DATE	
		Detailed Index.dgn			
DESIGN TEAM	CHECKED	DATE			

## GENERAL NOTES:

- ① ALL LIGHTING LOCATIONS WILL BE STAKED IN THE FIELD BY MDOT OR MDOT REPRESENTATIVES. CONTRACTOR SHALL PLACE THE ASSEMBLIES AS STAKED UNLESS DIRECTED OTHERWISE BY THE ENGINEER.
- ② ALL QUANTITIES SHOWN FOR BRANCH CIRCUIT ARE APPROXIMATE AND MAY NOT REFLECT LENGTHS REQUIRED BY THE TERRAIN IN THE FIELD.
- ③ THE CONTRACTOR MAY FIND IT NECESSARY TO CONSTRUCT TEMPORARY RAMPS OR ROADWAYS FOR CONSTRUCTION. THESE MAY BE DONE AT THE APPROVAL OF THE ENGINEER (NOT A SEPARATE PAY ITEM). WHEN NO LONGER REQUIRED, THE RAMPS OR ROADWAYS ARE TO BE REMOVED AND THE AFFECTED AREA(S) GRASSED AND GROWTH ESTABLISHED (NOT A SEPARATE PAY ITEM). ALL TRAFFIC CONTROL DEVICES REQUIRED FOR COMPLIANCE WITH THE MUTCD SHALL BE PROVIDED BY THE CONTRACTOR AT NO COST TO THE STATE.
- ④ IT SHALL BE THE RESPONSIBILITY OF THE CONTRACTOR TO PROTECT EXISTING STRUCTURES SUCH AS PIPES, INLETS, APRONS, BRIDGES, ETC., FROM DAMAGE WHICH MIGHT OCCUR DURING CONSTRUCTION. THE CONTRACTOR SHALL REPLACE OR REPAIR, AS DIRECTED BY THE ENGINEER, ANY STRUCTURES DAMAGED DURING THE LIFE OF THE CONTRACT. NO PAYMENT SHALL BE MADE FOR REPLACEMENT OR REPAIR OF DAMAGED ITEMS.
- ⑤ WHERE THE CONTRACTOR ENCOUNTERS PAVED DITCHES IN ROUTING OF BRANCH CIRCUITS, HE WILL JACK OR BORE UNDER DITCH. THIS IS NOT A SEPARATE PAY ITEM. DAMAGE TO PAVED DITCHES (AND/OR OTHER STRUCTURES) CAUSED BY THE CONTRACTOR DURING THIS PROJECT SHALL BE REPAIRED (AS DIRECTED BY THE ENGINEER) AT NO COST TO THE STATE.
- ⑥ ANY AREAS DISTURBED DURING CONSTRUCTION SHALL BE RESTORED BY THE CONTRACTOR (TO INCLUDE GRASSING AND SITE GRADING) AS DIRECTED BY THE ENGINEER. NOT A SEPARATE PAY ITEM. INCLUDED IN OTHER PAY ITEMS.
- ⑦ EXISTING UNDERGROUND UTILITY LINES ARE SHOWN ON THE DRAWINGS BASED UPON THE BEST INFORMATION AVAILABLE TO THE ENGINEER. THE ENGINEER CANNOT AND DOES NOT WARRANT THAT THIS INFORMATION IS COMPLETE OR ACCURATE. THE CONTRACTOR MUST COORDINATE DIRECTLY WITH THE INVOLVED UTILITY OWNERS TO HAVE UNDERGROUND UTILITY LINES FIELD LOCATED IN ADVANCE OF CONSTRUCTION.
- ⑧ THE COST OF DISPOSING MATERIALS DEEMED EXCESS EXCAVATION BY THE ENGINEER SHALL BE ABSORBED FOR PAYMENT IN OTHER ITEMS.
- ⑨ CONTRACTOR SHALL PROVIDE TOUCH UP GALVANIZING SUPPLIED BY POLE MANUFACTURER TO MATCH POLE FINISH.
- ⑩ METAL POLES SHALL BE SHIPPED TO SITE LOCATION SECURED WITH NYLON OR OTHER SUITABLE TIE DOWN MEANS TO PREVENT DAMAGE TO POLE SURFACE. CABLE OR CHAIN LASHINGS ARE NOT TO BE USED.
- ⑪ FLUORESCENT ORANGE SHEETING SHALL BE USED ON ALL CONSTRUCTION AND TRAFFIC CONTROL SIGNS EXCEPT FOR THOSE DESIGNATED IN PLANS TO BE BLACK LEGEND AND BORDER ON WHITE BACKGROUND.

- ⑫ THE CONTRACTOR MAY JACK OR BORE A SINGLE SLEEVE FOR INSTALLATION OF MULTIPLE BRANCH CIRCUIT CONDUITS AT A ROADWAY CROSSING, RATHER THAN JACKING OR BORING INDIVIDUAL CONDUITS. THE INSTALLATION OF THE SLEEVE AND THE FIRST CONDUIT SHALL BE PAID FOR AT THE BID PRICE FOR UNDERGROUND BRANCH CIRCUIT (JACKED OR BORED). ADDITIONAL CONDUITS PLACED IN THE SLEEVE SHALL BE PAID FOR AT THE BID PRICE OF REGULAR UNDERGROUND BRANCH CIRCUIT. NO ADDITIONAL COMPENSATION WILL BE GIVEN FOR LARGER SLEEVE. SUBMIT SIZE OF SLEEVE AND MATERIALS FOR APPROVAL PRIOR TO INSTALLATION.
- ⑬ THE LOCATION AND SPACING OF SIGNS SHOWN ON THE TRAFFIC CONTROL PLANS ARE APPROXIMATE AND MAY BE ADJUSTED AS NECESSARY TO FIT FIELD CONDITIONS.
- ⑭ THE CONTRACTOR SHALL REPAIR ANY DAMAGE TO THE SHOULDER WHICH MIGHT OCCUR DURING CONSTRUCTION. ANY REPAIR TO SHOULDER WILL BE IN ACCORDANCE WITH THE MISSISSIPPI STANDARD SPECIFICATIONS FOR ROAD AND BRIDGE CONSTRUCTION. NO PAYMENT WILL BE MADE FOR REPAIR OF DAMAGED SHOULDER.
- ⑮ WORK ON STRUCTURES FOR THIS PROJECT REQUIRES EXCAVATION IN THE IMMEDIATE VICINITY OF TRAFFIC AND ADJACENT PROPERTIES. THEREFORE, THE RISK OF A FAILURE OCCURING DURING EXCAVATION REQUIRES THAT EXTREME CAUTION BE EXERCISED. IT SHALL BE THE CONTRACTOR'S RESPONSIBILITY TO PLACE WHAT BRACING, SHORING OR GROUND SUPPORT SYSTEM THAT IS DEEMED NECESSARY TO PREVENT A FAILURE AND PROTECT THE PERSONS WORKING NEAR THE EXCAVATION. ALL COSTS FOR DESIGNING, DRAWING AND CONSTRUCTING THE FACILITY SHALL BE INCLUDED IN THE BID FOR CONTRACT ITEMS.
- ⑯ ALL PLASTIC DRUMS SHALL HAVE TWO BALLASTING COLLARS MADE FROM RECYCLED TRUCK TIRES OR OTHER SUITABLE MATERIAL.
- ⑰ JACK AND BORE SHALL BE MINIMUM 3 FT. BELOW ROAD SURFACE.

## UTILITIES:

CITY OF BROOKHAVEN WATER/SEWER DEPT.	601-833-7721
SOUTHWEST MISS. ELECTRIC POWER ASSOC.	1-800-287-8564
CENTERPOINT ENERGY ENTEX (GAS)	601-833-5471
AT&T (TELEPHONE)	601-445-0189
CABLE ONE (CABLE)	601-833-7991

## LEGEND:

- HA-2 1 (A) LIGHTING ASSEMBLY DESIGNATION AND CIRCUIT NO.  
130' POLE, 8 - 1000 WATT H.P.S. LUMINAIRES (TYPE 130-8-S)
- HA-1 1 (B) LIGHTING ASSEMBLY DESIGNATION AND CIRCUIT NO.  
130' POLE, 4 - 1000 WATT H.P.S. LUMINAIRES (TYPE 130-4-A)
- LA-9 1 (C) LIGHTING ASSEMBLY DESIGNATION AND CIRCUIT NO.  
40' POLE, 2 - 400 WATT H.P.S. LUMINAIRE (TYPE 40-2-12-400)
- LA-1 1 (D) LIGHTING ASSEMBLY DESIGNATION AND CIRCUIT NO.  
40' POLE, 1 - 400 WATT H.P.S. LUMINAIRE (TYPE 40-1-0-400)

	UNDERGROUND WATER LINE
	UNDERGROUND GAS LINE
	OVERHEAD POWER LINE
	SECONDARY POWER CONTROLLER
	UNDERGROUND PULL BOX
	UNDERGROUND JUNCTION BOX
	NEW POWER POLE PROVIDED BY UTILITY
	UNDERGROUND BRANCH CIRCUIT JACKED OR BORED, LENGTH

## ABBREVIATIONS:

PVC	- POLYVINYL CHLORIDE
THW	- THERMOPLASTIC HEAT AND MOISTURE RESISTANT
CIR	- CIRCUIT
I.E.S.	- ILLUMINATING ENGINEERING SOCIETY
LA-3	- LIGHTING ASSEMBLY - NUMBER
O.C.	- ON CENTER
A.W.G.	- AMERICAN WIRE GAUGE
L.F.	- LINEAR FOOT
MDOT	- MISSISSIPPI DEPARTMENT OF TRANSPORTATION
℄	- CENTERLINE

MISSISSIPPI DEPARTMENT OF TRANSPORTATION			
<b>GENERAL NOTES, LEGEND AND ABBREVIATIONS</b>			
PROJECT NO.: STP-0055-01(092)			WORKING NUMBER GN-1
COUNTY: LINCOLN			SHEET NUMBER 3
DATE	DESIGN TEAM	CHECKED	DATE