

**SECTION 905 -- PROPOSAL (CONTINUED)**

I (We) further propose to execute the attached contract agreement (Section 902) as soon as the work is awarded to me (us), and to begin and complete the work within the time limit(s) provided for in the Specifications and Advertisement. I (We) also propose to execute the attached contract bond (Section 903) in an amount not less than one hundred (100) percent of the total of my (our) part, but also to guarantee the excellence of both workmanship and materials until the work is finally accepted.

I (We) enclose a certified check, cashier's check or bid bond for **five percent (5%) of total bid** and hereby agree that in case of my (our) failure to execute the contract and furnish bond within Ten (10) days after notice of award, the amount of this check (bid bond) will be forfeited to the State of Mississippi as liquidated damages arising out of my (our) failure to execute the contract as proposed. It is understood that in case I am (we are) not awarded the work, the check will be returned as provided in the Specifications.

Bidder acknowledges receipt of and has added to and made a part of the proposal and contract documents the following addendum (addenda):

ADDENDUM NO.   1   DATED   2/15/2011   ADDENDUM NO.            DATED             
 ADDENDUM NO.            DATED            ADDENDUM NO.            DATED           

Number	Description
1	Replace Table of Contents, Notice To Bidders No. 3374, and Bidsheets with same; Delete Notice To Bidders No. 1546; Amendment EBS Download required.

TOTAL ADDENDA:   1    
 (Must agree with total addenda issued prior to opening of bids)

Respectfully Submitted,

DATE \_\_\_\_\_

\_\_\_\_\_  
 Contractor

BY \_\_\_\_\_  
 Signature

TITLE \_\_\_\_\_

ADDRESS \_\_\_\_\_

CITY, STATE, ZIP \_\_\_\_\_

PHONE \_\_\_\_\_

FAX \_\_\_\_\_

E-MAIL \_\_\_\_\_

(To be filled in if a corporation)

Our corporation is chartered under the Laws of the State of \_\_\_\_\_ and the names, titles and business addresses of the executives are as follows:

_____ President	_____ Address
_____ Secretary	_____ Address
_____ Treasurer	_____ Address

The following is my (our) itemized proposal.

MP-6084-34(009) / 304065301

Jones County(ies)

Revised 09/21/2005

# MISSISSIPPI DEPARTMENT OF TRANSPORTATION

## TABLE OF CONTENTS

**PROJECT: MP-6084-34(009) / 304065301 -- Jones County**

901--Advertisement

904--Notice to Bidders:

- Governing Specs. - # 1
- Final Cleanup - # 3
- Fiber Reinforced Concrete - # 640
- On-The-Job Training Program - # 777
- Payroll Requirements - # 883
- Rumble Stripe - # 1312
- Errata & Modifications to 2004 Standard Specifications - #1405
- Safety Apparel - # 1808
- Federal Bridge Formula - # 1928
- Non-Quality Control / Quality Assurance Concrete - # 2818
- Petroleum Products Base Price - # 2858
- Standard Drawings - # 2862
- Reduced Speed Limit Signs - # 2937
- Alternate Asphalt Mixture Bid Items - # 3039
- Temporary Traffic paint - # 3131
- Warm Mix Asphalt - # 3242
- Shoulder Wedge - # 3367
- Contract Time - # 3373
- Scope of Work - # 3374

907-101-4: Definitions

907-102-4: Bidding Requirements and Conditions, W/Supplement

907-103-8: Award and Execution of Contract

907-105-3: Cooperation By Contractors, W/Supplement

907-107-7: Legal Relations and Responsibility to Public, W/Supplement

907-108-18: Prosecution and Progress, W/Supplement

907-109-4: Measurement and Payment, W/Supplement

907-304-12: Granular Courses

907-401-2: Hot Mix Asphalt (HMA), W/Supplement

907-401-4: Warm Mix Asphalt (WMA), W/Supplement

907-403-4: Hot Mix Asphalt (HMA), W/Supplement

907-403-9: Warm Mix Asphalt (WMA), W/Supplement

907-407-1: Tack Coat

907-618-1: Additional Signing Requirements, W/Supplement

907-618-4: Placement of Temporary Traffic Stripe

907-626-15: Thermoplastic Traffic Markings

907-626-22: Double Drop Thermoplastic Markings

907-701-4: Hydraulic Cement

- CONTINUED ON NEXT PAGE -

- 907-703-9: Aggregate
- 907-711-4: Synthetic Structural Fiber Reinforcement
- 907-713-2: Admixtures for Concrete
- 907-714-6: Miscellaneous Materials
- 907-720-1: Pavement Marking Materials
- 907-804-13: Concrete Bridges and Structures
  
- 906-3: MDOT On-the-Job Training Program
- 906-6: MDOT On-the-Job Training Program - Alternate Program

SECTION 905 - PROPOSAL,  
PROPOSAL BID SHEETS,  
COMBINATION BID PROPOSAL,  
STATE BOARD OF CONTRACTORS REQUIREMENTS,  
CERTIFICATION REGARDING NON-COLLUSION, DEBARMENT AND SUSPENSION,  
SECTION 902 - CONTRACT FORM, AND SECTION 903 - CONTRACT BOND FORM.

(REVISIONS TO THE ABOVE WILL BE INDICATED ON THE SECOND SHEET  
OF SECTION 905 AS ADDENDA)

# MISSISSIPPI DEPARTMENT OF TRANSPORTATION

SECTION 904 - NOTICE TO BIDDERS NO. 3374

CODE: (SP)

DATE: 02/08/2011

SUBJECT: Scope of Work

PROJECT: MP-6084-34(009) / 304065301 -- Jones County

The contract documents do not include an official set of construction plans but may, by reference, include some Standard Drawings when so specified in a Notice to Bidders entitled, "Standard Drawings". All other references to plans in the contract documents and Standard Specifications for Road and Bridge Construction are to be disregarded.

Work on the project shall consist of the following:

**US 84**  
**OVERLAY APPROXIMATELY 4.3 MILES OF US 84 FROM 3,000 FEET EAST OF**  
**DYKES ROAD (BOP STATION 460+00) TO 300 FEET EAST OF THE**  
**INTERSECTION OF SR 28 (EOP STATION 690+00)**

(A) Prior to the overlay, centerline alignment shall be determined by the Contractor by measuring the existing roadway at 500 feet intervals in tangent sections, and 100 feet intervals in horizontal curves. The existing pavement edge shall be cut to a smooth and near vertical face with an approved cutting device (Not to be measured for separate pay). The foundation for widening the base shall be built according to the Typical Section (see typical drawing). Material excavated while building the foundation for widening shall be used to raise the existing shoulder to match the new pavement elevation. Surplus material shall be spread along the edge of the shoulders, foreslopes, or other adjacent areas as directed by the Project Engineer, and will be an absorbed item. In the areas where MDOT Maintenance forces have previously widened the roadway with asphalt, this material shall be excavated in the normal trench widening operations (Not to be measured for separate pay). In the instance that the Contractor cannot, in the Project Engineer's opinion, adequately incorporate the excess asphalt material from the trench into the shoulder, the excess asphalt material shall be hauled off of the job site (Not to be measured for separate pay).

(B) Cold Mill 1.5" & Variable on US 84 at all the transitions including E.O.P., B.O.P., bridge approaches, and all tie-ins. Mill 1.5" on the outside half of the lane adjacent to the curb and gutter sections of the job. Milled material shall become property of the contractor.

(C) Overlay US 84 with 1.5" & variable 9.5-mm (HT) asphalt mixture from 3,000 feet of East of Dykes Road East 4.3 miles to approximately 300' East of SR 28. Overlay Cross-Overs and Local roads with 9.5-mm (HT) asphalt mixture. Prior to the overlay, a leveling course of ¾" & variable of 9.5-mm HT asphalt shall be required. The foundation for widening the roadway shall be formed by trenching or excavating to the required depth and width (See Typical Drawings.). Trenching or excavating for the trench widening will be absorbed. The asphalt for trench widening shall be

placed at the same time with the ¾” leveling course. Remove any failed areas on the main facility and repair by backfilling with 19-mm HT asphalt as directed by the Project Engineer. Approximately 375 Tons of (HT) 19-mm asphalt will be used for base repair. The following failed areas are to be repaired.

WB outside lane from Station 618+08 to 609+05	225’x12’
WB outside lane from Station 495+00 to 507+15	850’x12’
Hwy 84 WB Entrance Ramp from Hwy 29	30’x6’
EB inside lane from Station 660+00 to 666+62	300’x6’ & 20’x6’

Publicly maintained roads or streets shall be surfaced to the existing R.O.W.; privately owned entrances shall be surfaced a distance of 10 feet & variable from edge of pavement. Any site grading at local roads or drives will not be measured for separate payment but will be considered an absorbed item. Cross slopes shall be increased where practical with contract quantities in an effort to achieve a uniform cross slope of 2%. The Contractor will mill a 12” rumble strip along the inside of the shoulders and place the traffic stripe on the inside 6” of the rumble strip.

(D) Raise the existing shoulders to match the new pavement elevation by placing 2.25” & variable depth 825 crushed stone on the shoulders. Placement of the crushed stone on the finished surface course shall not be permitted. The material shall be mechanically mixed, bladed, rolled and compacted to a finished slope of 4%. Shoulders with existing adequate shoulder material in place shall be bladed to a slope of 4%, the cost of which shall be included in the prices of other items bid.

(E) Temporary striping shall conform to finished stripe specifications for alignment, neatness, reflectivity, and straightness. All permanent pavement markings are to be hot thermoplastic. Edge lines will be placed so as to maintain the original lane width. Glass beads applied to thermoplastic shall conform to Subsection 720.01. Beads shall be double dropped Class B, High-Visibility first and then Class A, High-Visibility. On all bridges and concrete sections of highway, old traffic stripe shall be removed and replaced with [Thermoplastic Stripe](#). Special care should be taken for the placement of Thermoplastic Detail Stripe along the edge of pavement at turn-outs on all local roads and along tapers where Detail Stripe is required as per Typical PMD-1.

(F) Raised pavement markers will be placed as per sheet PM-1 of the Standard Drawings. Any removal of existing raised pavement markers or rumble bars shall be considered an absorbed item. Only flexible adhesive shall be allowed for placement of raised pavement markers meeting the requirements of Subsection 720.03.7.7 of the 2004 Mississippi Standard Specifications for Road and Bridge.

(G) Surface mounted Snap-Back delineators located along the cross-over at the West Jones Elementary School shall be removed prior to overlay operations commencing in this area. MDOT Maintenance forces will remove the delineators and will request a 48 hour notice prior to the commencement of construction operations. MDOT Maintenance forces will replace the Snap-Back delineators once all construction activities have concluded in this area.

The contractor shall erect and maintain construction signing, and provide all signs and traffic handling devices, and shall provide two portable R16-3 signs per work zone or lane closure in

addition to signs required by standard drawings in accordance with Manual Uniform Traffic Control Devices (MUTCD) (the cost is to be included in the price bid for pay item No. 618-A, Maintenance of Traffic).

Incidental work such as removing vegetation, shaping and compaction of shoulder, removing excess asphalt material, project clean-up, and other incidental work necessary to complete the project will not be measured for separate payment, but will be included in other bid items, and must be performed during the operating hours for this project.

**JOINT REPAIR NOTES:**

- THE INTENT OF THE CONTRACT IS TO REMOVE ALL JOINT ARMOR EXISTING AT THE TIME THE CONTRACT IS LET THAT IS DAMAGED, LOOSE, AND/OR HAS BEEN PREVIOUSLY REMOVED IN PART. ANY JOINT ARMOR THAT EXTENDS THE FULL WIDTH OF THE BRIDGE AND IS INTACT AND IN GOOD CONDITION WILL REMAIN. REPAIR JOINTS WITH EPOXY MORTAR AND SEAL JOINTS WITH A SILICONE JOINT SEALANT. IT IS POSSIBLE THAT BETWEEN PLAN PREPARATION AND LETTING TIME, JOINT ARMOR SHOWN TO BE REMOVED MAY HAVE BEEN REMOVED EARLIER BY DEPARTMENT PERSONNEL. ALSO, THE NUMBER OF JOINTS REQUIRING SAWCUTTING MAY CHANGE DUE TO TEMPERATURE CHANGES. QUANTITIES SHALL BE ADJUSTED ACCORDINGLY. PAYMENT FOR JOINT PREPARATION, JOINT REPAIR AND REMOVAL OF JOINT ARMOR SHALL BE PAID FOR AS THE LENGTH ALONG THE BRIDGE DECK ON EACH SIDE OF THE CENTERLINE OF JOINT.
- SAWCUTTING THE JOINT IS REQUIRED AT EXISTING JOINTS THAT HAVE LESS THAN 1 INCH OF OPENING.
- SILICONE SEALED JOINTS ARE REQUIRED AT ALL JOINTS. PAYMENT FOR SILICONE SEALED JOINTS AND SAWCUTTING THE JOINTS SHALL BE PAID FOR AS THE LENGTH ALONG THE CENTERLINE OF JOINT ONLY AND NOT EACH SIDE OF THE JOINT.
- REMOVAL OF EXISTING JOINT SEALANTS WILL NOT BE PAID FOR DIRECTLY AND THEREFOR SHALL BE CONSIDERED AS AN ABSORBED ITEM OF WORK.

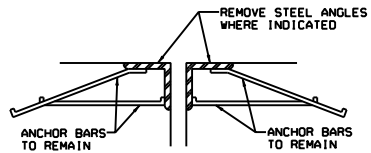

**TYPICAL SECTION AT JOINT REPAIR**  
SHOWING EXISTING JOINT ARMOR TO BE REMOVED

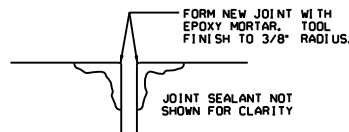

**TYPICAL SECTION AT JOINT REPAIR**  
SHOWING JOINT AFTER EPOXY MORTAR REPAIR

**JOINT REPAIR MORTAR NOTES:**

- JOINT REPAIR MORTAR SHALL BE ONE OF THE FOLLOWING PRODUCTS:
  - "HP-BINDER" SHALL BE AS MANUFACTURED BY HUNT PROCESS CORPORATION, P.O. BOX 688, RIDGELAND, MS 39158, TELEPHONE NO. (601)856-8811, AND INSTALLED ACCORDING TO THE MANUFACTURER'S RECOMMENDATIONS.
  - "POLYMER CONCRETE" SHALL BE AS MANUFACTURED BY POLYMER CONCRETE, INC. P.O. BOX 610, CAMDEN, AL 36726, (205)682-4296, AND INSTALLED ACCORDING TO THE MANUFACTURER'S RECOMMENDATIONS.
  - "CERATECH PAVEMENT VR" SHALL BE AS MANUFACTURED BY CERATECH, INC., 3037 TUGGLE IVES DR., BUFORD, GA 30519, TELEPHONE NO. (770)831-0794, AND INSTALLED ACCORDING TO THE MANUFACTURER'S RECOMMENDATIONS.

**GENERAL NOTES:**

- SPECIFICATIONS: MISSISSIPPI STANDARD SPECIFICATIONS FOR ROAD AND BRIDGE CONSTRUCTION, 2004.
- NO CHANGE OF PLANS WILL BE PERMITTED EXCEPT BY WRITTEN APPROVAL OF THE BRIDGE ENGINEER. MINOR CHANGES OF DETAIL OF DESIGN OR CONSTRUCTION PROCEDURE MAY BE AUTHORIZED BY THE BRIDGE ENGINEER PROVIDED SUCH CHANGES WILL NOT BE CAUSE FOR CONTRACT PRICE ADJUSTMENT.
- WORK FOR WHICH NO PAY ITEM IS PROVIDED IN THE PROPOSAL WILL NOT BE PAID FOR DIRECTLY AND COMPENSATION THEREFOR WILL BE INCLUDED IN THE PRICES AND PAYMENTS FOR BID ITEMS.

**NOTE:**  
SEALANT SHALL BE ON THE MDOT LIST OF APPROVED SILICONE JOINT SEALING COMPOUNDS FOR BRIDGE JOINTS APPLIED ACCORDING TO THE MANUFACTURER'S DIRECTIONS.

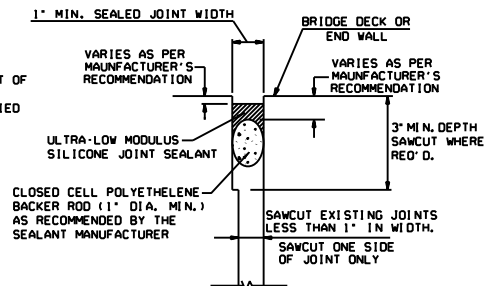

**TYPICAL SECTION AT SAWCUT & SEALED JOINT**  
SHOWING SILICONE SEALED JOINT AFTER SAWCUT AND REPAIR WITH EPOXY MORTAR

ESTIMATED QUANTITIES			
PAY ITEM NO.	PAY ITEM	QUANTITY	UNIT
808-A	JOINT PREPARATION	---	LIN. FT.
907-824-PP	BRIDGE REPAIR (JOINT REPAIR) PER PLANS	---	LIN. FT.
907-824-PP	BRIDGE REPAIR (REMOVAL OF JOINT ARMOR) PER PLANS	---	LIN. FT.
907-824-PP	BRIDGE REPAIR (SILICONE SEALED JOINTS) PER PLANS	---	LIN. FT.
907-824-PP	BRIDGE REPAIR (SAWCUT JOINTS) PER PLANS	---	LIN. FT.

MISSISSIPPI DEPARTMENT OF TRANSPORTATION	
DETAILS OF BRIDGE DECK JOINT REPAIR	
DATE	DESIGN YEAR
CHECKED	DATE
WORKING NUMBER BR-1	SHEET NUMBER

MISSISSIPPI DEPARTMENT OF TRANSPORTATION  
 BRIDGE DIVISION  
 BRIDGE ENGINEERING SECTION  
 BRIDGE ENGINEER: J. L. HARRIS  
 BRIDGE DESIGNER: J. L. HARRIS  
 BRIDGE CHECKER: J. L. HARRIS  
 BRIDGE DATE: 11/11/03

Overlying approximately 4 miles of U.S. 84 from east of Dykes Road to east of SR 28, known as State Project No. MP-6084-34(009) / 304065301, in the County of Jones, State of Mississippi.

I (We) agree to complete the entire project within the specified contract time.

**\*\*\* SPECIAL NOTICE TO BIDDERS \*\*\***

**BIDS WILL NOT BE CONSIDERED UNLESS BOTH UNIT PRICES AND ITEM TOTALS ARE ENTERED.  
 BIDS WILL NOT BE CONSIDERED UNLESS THE BID CERTIFICATION LOCATED AT THE END OF THE BID SHEETS IS SIGNED**

**\*\*\*BID SCHEDULE\*\*\***

Line No.	Item Code	Adj Code	Quantity	Units	Description	Unit Price		Item Amount	
						Dollar	Ct	Dollar	Ct
<b>Roadway Items</b>									
0010	202-B076		1,200	Linear Feet	Removal of Traffic Stripe				
0020	202-B078		1,920	Square Yard	Removal of Pavement, All Types and Depths				
0030	406-A001		13,415	Square Yard	Cold Milling of Bituminous Pavement, All Depths				
0040	423-A001		13	Mile	Rumble Strips, Ground In				
0050	609-D002	(S)	168	Linear Feet	Combination Concrete Curb and Gutter Type 2				
0060	616-A001	(S)	32	Square Yard	Concrete Median and/or Island Pavement, 4-inch				
0070	616-A003	(S)	5	Square Yard	Concrete Median and/or Island Pavement, 10-inch				
0080	618-A001		1	Lump Sum	Maintenance of Traffic	XXXXXXXX	XXX		



Line No.	Item Code	Adj Code	Quantity	Units	Description	Unit Price		Bid Amount	
0090	618-B001		1	Square Feet	Additional Construction Signs	10.	00	10.	00
0100	619-A1002		16	Mile	Temporary Traffic Stripe, Continuous White				
0110	619-A2002		13	Mile	Temporary Traffic Stripe, Continuous Yellow				
0120	619-A3006		18	Mile	Temporary Traffic Stripe, Skip White				
0130	619-A5001		7,400	Linear Feet	Temporary Traffic Stripe, Detail				
0140	619-A6001		4,000	Linear Feet	Temporary Traffic Stripe, Legend				
0150	627-B001		230	Each	Two-Way Clear Reflective Raised Markers				
0160	627-K001		957	Each	Red-Clear Reflective High Performance Raised Markers				
0170	627-L001		128	Each	Two-Way Yellow Reflective High Performance Raised Markers				
0180	628-I002 Deleted 02/11/2011					XXXXXXXXXX	XXX	XXXXXXXXXX	XXX
0190	628-J002 Deleted 02/11/2011					XXXXXXXXXX	XXX	XXXXXXXXXX	XXX
0200	628-M002 Deleted 02/11/2011					XXXXXXXXXX	XXX	XXXXXXXXXX	XXX

Line No.	Item Code	Adj Code	Quantity	Units	Description	Unit Price		Bid Amount	
0210	635-A001		810	Linear Feet	Vehicle Loop Assemblies				
0220	907-304-F001	(GT )	4,200	Ton	Size 825 Crushed Stone Base				
0230	907-407-A001	(A2 )	15,000	Gallon	Asphalt for Tack Coat				
0240	907-626-A003		9	Mile	6" Thermoplastic Traffic Stripe, Skip White				
0250	907-626-B003		3,450	Linear Feet	6" Thermoplastic Traffic Stripe, Continuous White				
0260	907-626-C003		7	Mile	6" Thermoplastic Double Drop Edge Stripe, Continuous White				
0270	907-626-C004		2	Mile	6" Thermoplastic Edge Stripe, Continuous White				
0280	907-626-E004		1	Mile	6" Thermoplastic Traffic Stripe, Continuous Yellow				
0290	907-626-F003		6	Mile	6" Thermoplastic Double Drop Edge Stripe, Continuous Yellow				
0300	907-626-G004		21,222	Linear Feet	Thermoplastic Detail Stripe, White				
0310	907-626-G005		17,005	Linear Feet	Thermoplastic Detail Stripe, Yellow				
0320	907-626-H004		1,754	Linear Feet	Thermoplastic Legend, White				

Line No.	Item Code	Adj Code	Quantity	Units	Description	Unit Price		Bid Amount	
0330	907-626-H005		550	Square Feet	Thermoplastic Legend, White				
0340	907-824-PP002		128	Linear Feet	Bridge Repair, Joint Repair, Per Plans				
0350	907-824-PP008		384	Linear Feet	Bridge Repair, Silicone Sealed Joint, Per Plans				
<b>ALTERNATE GROUP AA NUMBER 1</b>									
0360	907-403-A002 (BA1)		375	Ton	Hot Mix Asphalt, HT, 19-mm mixture				
0370	907-403-A005 (BA1)		16,700	Ton	Hot Mix Asphalt, HT, 9.5-mm mixture				
0380	907-403-B003 (BA1)		9,600	Ton	Hot Mix Asphalt, HT, 9.5-mm mixture, Leveling				
<b>ALTERNATE GROUP AA NUMBER 2</b>									
0390	907-403-M009 (BA1)		16,700	Ton	Warm Mix Asphalt, HT, 9.5-mm mixture				
0400	907-403-M011 (BA1)		375	Ton	Warm Mix Asphalt, HT, 19-mm mixture				
0410	907-403-N008 (BA1)		9,600	Ton	Warm Mix Asphalt, HT, 9.5-mm mixture, Leveling				

\*\*\* BID CERTIFICATION \*\*\*

TOTAL BID.....\$\_\_\_\_\_

\*\*\* SIGNATURE STATEMENT \*\*\*

BIDDER ACKNOWLEDGES THAT HE/SHE HAS CHECKED ALL ITEMS IN THIS PROPOSAL FOR ACCURACY AND CERTIFIED THAT THE FIGURES SHOWN THEREIN CONSTITUTE THEIR OFFICIAL BID.

\_\_\_\_\_  
BIDDER'S SIGNATURE

\_\_\_\_\_  
BIDDER'S COMPANY

\_\_\_\_\_  
BIDDER'S FEDERAL TAX ID NUMBER