

**SECTION 905 -- PROPOSAL (CONTINUED)**

I (We) further propose to execute the attached contract agreement (Section 902) as soon as the work is awarded to me (us), and to begin and complete the work within the time limit(s) provided for in the Specifications and Advertisement. I (We) also propose to execute the attached contract bond (Section 903) in an amount not less than one hundred (100) percent of the total of my (our) part, but also to guarantee the excellence of both workmanship and materials until the work is finally accepted.

I (We) enclose a certified check, cashier's check or bid bond for **five percent (5%) of total bid** and hereby agree that in case of my (our) failure to execute the contract and furnish bond within Ten (10) days after notice of award, the amount of this check (bid bond) will be forfeited to the State of Mississippi as liquidated damages arising out of my (our) failure to execute the contract as proposed. It is understood that in case I am (we are) not awarded the work, the check will be returned as provided in the Specifications.

Bidder acknowledges receipt of and has added to and made a part of the proposal and contract documents the following addendum (addenda):

ADDENDUM NO.   1   DATED   7/18/2011   ADDENDUM NO.            DATED             
 ADDENDUM NO.            DATED            ADDENDUM NO.            DATED           

Number	Description
1	Revised Table of Contents, replace same; Revised NTB # 3578, replaces same; Revised NTB # 3580, replaces same; Delete SP 907-409-1; Revised Bid Sheets, replace same; Amendment EBS Download Required.

TOTAL ADDENDA:   1    
 (Must agree with total addenda issued prior to opening of bids)

Respectfully Submitted,

DATE \_\_\_\_\_

\_\_\_\_\_  
 Contractor

BY \_\_\_\_\_  
 Signature

TITLE \_\_\_\_\_

ADDRESS \_\_\_\_\_

CITY, STATE, ZIP \_\_\_\_\_

PHONE \_\_\_\_\_

FAX \_\_\_\_\_

E-MAIL \_\_\_\_\_

(To be filled in if a corporation)

Our corporation is chartered under the Laws of the State of \_\_\_\_\_ and the names, titles and business addresses of the executives are as follows:

_____ President	_____ Address
_____ Secretary	_____ Address
_____ Treasurer	_____ Address

The following is my (our) itemized proposal.

Revised 09/21/2005

STP-0022-02(051) / 106207301

Neshoba County(ies)

# MISSISSIPPI DEPARTMENT OF TRANSPORTATION

## TABLE OF CONTENTS

**PROJECT: STP-0022-02(051) / 106207301 – Neshoba County**

901--Advertisement

904--Notice to Bidders:

- Governing Specifications - # 1
- Final Cleanup - # 3
- Disadvantaged Business Enterprise, w/ supplement - # 696
- On-The-Job Training Program - # 777
- Payroll Requirements - # 883
- Rumble Stripe - # 1312
- Errata & Modifications to 2004 Standard Specifications - # 1405
- Safety Apparel - # 1808
- Federal Bridge Formula - # 1928
- Department of Labor Ruling - # 2239
- Status of ROW w/ attachments - # 2382
- DBE Forms, Participation and Payment - # 2596
- Petroleum Products Base Price - # 2858
- Standard Drawings - # 2862
- Reduced Speed Limit Signs - # 2937
- Alternate Asphalt Mixture Bid items - # 3039
- Temporary Traffic Paint - # 3131
- Warm Mix Asphalt (WMA) - # 3242
- DUNS Requirement for Federal Funded Projects - # 3414
- Questions Regarding Bidding - # 3425
- Contract Time - # 3578
- Specialty Items - # 3579
- Scope of Work, with attachments - # 3580
- Safety Edge - # 3585

906- :FHWA 1273, with Supplement, Executive Order, & Wage Rates

- 907-101-4: Definitions
- 907-102-8: Bidding Requirements and Conditions
- 907-103-8: Award and Execution of Contract
- 907-104-4: Disposal of Materials
- 907-105-6: Control of Work, w/Supplement
- 907-107-9: Legal Relations & Responsibility to Public
- 907-108-24: Prosecution and Progress
- 907-109-5: Measurement and Payment
- 907-110-2: Wage Rates
- 907-304-12: Granular Courses
- 907-310-1: Stabilizer Aggregate
- 907-401-2: Hot Mix Asphalt (HMA), w/Supplement
- 907-401-4: Warm Mix Asphalt (WMA), w/Supplement

- CONTINUED ON NEXT PAGE -

907-403-4: Hot Mix Asphalt (HMA), w/Supplement  
907-403-9: Warm Mix Asphalt (WMA), w/Supplement  
907-407-1: Tack Coat  
907-413-2: Sawing & Sealing Transverse Joints in Asphalt Pavement  
907-618-4: Placement of Temporary Traffic Stripe  
907-626-15: Thermoplastic Traffic Markings  
907-626-22: Double Drop Thermoplastic Markings  
907-703-9: Aggregates, w/Supplement  
907-707-2: Joint Material  
907-710-1: Fast Dry Solvent Traffic Paint  
907-720-1: Pavement Marking Materials

906-3: On-The-Job Training Program

906-6: On-The-Job Training Program - Alternate Program

SECTION 905 - PROPOSAL, PROPOSAL BID SHEETS

COMBINATION BID PROPOSAL

CERTIFICATION OF PERFORMANCE - PRIOR FEDERAL-AID CONTRACTS

CERTIFICATION REGARDING NON-COLLUSION, DEBARMENT AND SUSPENSION

SECTION 902- CONTRACT FORM, AND SECTION 903 - CONTRACT BOND FORMS

FORM -- OCR-485

(REVISIONS TO THE ABOVE WILL BE INDICATED ON THE SECOND SHEET  
OF SECTION 905 AS ADDENDA)

**MISSISSIPPI DEPARTMENT OF TRANSPORTATION**

**SECTION 904 - NOTICE TO BIDDERS NO. 3578**

**CODE: (SP)**

**DATE: 07/15/2011**

**SUBJECT: Contract Time**

**PROJECT: STP-0022-02(051) 106207301 – Neshoba County**

The calendar date for completion of work to be performed by the Contractor for this project shall be **November 23, 2011** which date or extended date as provided in Subsection 907-108.06 shall be the end of contract time. It is anticipated that the Notice of Award will be issued no later than **August 9, 2011** and the effective date of the Notice to Proceed / Beginning of Contract Time will be simultaneous with the execution of the contract.

*A progress schedule as referenced to in Subsection 907-108.03 will not be required for this contract.*

**MISSISSIPPI DEPARTMENT OF TRANSPORTATION**

**SECTION 904 – NOTICE TO BIDDERS NO. 3580**

**CODE: (SP)**

**DATE: 07/15/2011**

**SUBJECT: Scope of Work**

**PROJECT: STP-0022-02(051) / 106207-301 – Neshoba County**

The contract documents do not include an official set of construction plans but may by reference, include some Standard Drawings when so specified in a Notice to Bidders entitled, “Standard Drawings”. All other references to plans in the contract documents and Standard Specifications for Road and Bridge Construction are to be disregarded.

Work on the project shall consist of the following:

Mill & overlay approximately 12.6 miles of existing asphalt pavement on SR 15 in Neshoba County beginning at the Newton/Neshoba County Line near Union (Station 85+00) and ending just south of Philadelphia at Station 753+43.

**Station 85+00 (BOP) to Station 228+36 (Full-Depth HMA)**

Work in this area shall consist of milling the existing pavement to a depth of 2 inches on the existing slope and placing 2 inches and variable of 12.5 mm HMA/WMA, MT, per the attached details and typical sections.

**Station 228+36 to Station 519+50 (Full-Depth HMA)**

Work in this area shall consist of milling the existing pavement to a depth of 3 inches on the existing slope and placing Geotextile Fabric for Underseal, Type IV, Asphalt Cement for Underseal (PG 67-22) and 1 ½ inches and variable of HMA/WMA, 12.5mm Mix, MT, Leveling. The width of the Geotextile Fabric placement shall be 24 feet. The surface course shall be 1 ½ inches and variable of HMA/WMA, 9.5 mm Mix, MT. Placement of the initial leveling lifts for this section shall be placed for **BOTH** adjacent lanes for the limits of a given days production. Care shall be taken to maintain the integrity of the additional fabric extended for the overlap while placing milling the adjacent asphalt.

**Station 519+50 to Station 753+43 (HMA over JRCP)**

Work in this area shall consist of milling the existing pavement to a depth of 2 inches on the existing slope and placing 2 inches and variable of 12.5mm HMA/WMA, MT, per the attached details and typical sections. Sawing and sealing of the transverse joint shall be completed within seven (7) days after the placement of HMA/WMA, 12.5mm, MT. The saw cut joints shall be directly over the existing JRCP joints and shall be accurately

located by a method employing pins and string line. The pins shall be accurately located prior to paving. All work involved will be paid by Pay Item No. 413-E, Sawing and Sealing Transverse Joints in Asphalt Pavement.

### **Guardrail Replacement**

Remove and replace guardrail from stations 289+27 to 291+60 and 622+14 to 624+59. The specific locations and quantities are shown on the following sheets. The guardrail, including the applicable bridge end sections, terminal end sections, delineators, etc., shall be placed in accordance with the Standard Drawings, unless otherwise specified by the Engineer. The pay item for removal of guardrail shall include the bridge end sections, posts, terminal end sections, etc. All guardrail removed is to be replaced the same day and prior to reopening the adjacent lane of traffic. Voids created by the removal of posts, concrete anchors, footings, etc. shall be backfilled and tamped in accordance with Section 203 of the Standard Specifications.

### **General Notes:**

Prior to beginning the milling/overlaying operations, any failed areas in the existing pavement shall be removed and repaired as directed by the Engineer. Payment for removal and disposal of failed areas will be made using the appropriate pay items. Potholes are to be patched in a timely manner and prior to beginning the asphalt overlay. Patching of potholes shall be considered an absorbed item.

Traffic will not be allowed to run on the milled surface; therefore, any milled area shall be paved prior to opening. Overnight lane closures will not be allowed for this operation. Milling shall be performed as required to insure a smooth grade transition at all mainline tie-ins, county roads, bridges, etc. Milling operations shall be in accordance with the contract documents and the MDOT Standard Specifications for Road and Bridge Construction. Temporary pavement joints (paper joints) shall be at least 3 paper-widths long shall be used at all milled tie-ins and shall be adequately maintained. Milling ties at bridge joints shall be performed in such a manner as to provide a perpendicular joint face. The concrete pavement shall not be damaged by the milling operations; any damage shall be repaired at the Contractor's expense.

Publicly maintained roads shall be milled and paved to the existing right-of-way. Driveway aprons will be paved to the shoulder line. Existing aprons are to be bladed, shaped, and compacted prior to paving as shown by the attached typical drawings. Following placement of asphalt, material bladed aside for aprons shall be pulled back to the asphalt pavement edge as directed by the Engineer, all costs to be included in the price bid for items bid. Granular material and/or Size I Stabilizer Aggregate should be placed around the pads as required and/or as directed by the Engineer.

It shall be the responsibility of the Contractor to protect existing structures such as pipes, inlets, aprons, bridges, etc. from damage which might occur during construction. The

Contractor shall replace or repair, as directed by the engineer, any structures damaged during the life of the contract. No payment will be made for replacement or repair of damaged items.

Any signs that are in conflict with construction of this project shall be removed and relocated by the Contractor as directed by the Engineer, the cost of which is to be absorbed in other items bid.

The Contractor shall erect and maintain construction signing and provide all signs and traffic control devices necessary to safely maintain traffic around and through the work areas in accordance with the Traffic Control Plan and the MUTCD. The cost is to be included in the price bid for Pay Item No. 618-A, Maintenance of Traffic. Fluorescent orange sheeting shall be used on all construction and traffic control signs except those designated in the plans to be black legend and border on white background. Standard roadside construction signs and barricades will be paid for using the appropriate pay items.

Roadside construction signs, barrels, etc. shall be placed in accordance with the attached drawings or as directed by the Engineer. W20-1 signs shall be placed on all public road approaches as shown or as directed.

All channelized intersections will be milled completely to a depth of 2 inches. The Reclaimed Asphalt Pavement (RAP) material removed by any milling operation shall be come the property of the contractor with the exception of 10,000 tons or 50% of the total anticipated RAP material, whichever is less, to be stockpiled at the MDOT Philadelphia Maintenance Headquarters located at 1115 Highway 15 Bypass, Philadelphia. The Contractor will be required to coordinate efforts with the Maintenance Office to effectively stockpile the milled material as directed by the Engineer. All costs associated with the hauling, placing, and stockpiling the State retained material shall be included in the price bid for cold milling.

Incidental work such as removing vegetation, shaping and compacting shoulders, removing and resetting signs and/or mailboxes, removing excess asphalt material, project clean-up, and other items of incidental work necessary to complete the project will not be measured for separate payment and will be considered included in the prices of items bid.

The Contractor shall on a daily basis, remove all debris from within the roadway and a 30-foot clear zone which in the opinion of the Engineer, is a hazard to the traveling public. This activity shall begin with the beginning of work or the beginning of the contract time, whichever comes first. No direct payment will be made for the debris removal; the cost is to be included in the prices of items bid. Failure of the Contractor to remove the debris as prescribed herein shall be just cause for withholding the monthly progress estimate payment or suspending active operations until the debris is satisfactorily removed by the Contractor.

Where applicable, the existing shoulders are to be raised to match the new pavement elevation by placing variable depth Granular Material (Class 5, Group C) on the existing shoulders. Placement of the granular material on the finished asphalt course shall not be permitted. The material shall be bladed, rolled, and compacted to a finished slope of four percent (4%). Placement of this material shall be performed to provide a uniform and compacted shoulder with a minimum depth and width of material placed. Shoulders with adequate shoulder material in place shall be bladed to a slope of four percent (4%). The cost of blading will be an absorbed item and is to be included in the price of other items bid.

Removal of the existing shoulder material shall be coincident with the milling/overlaying operation to prevent the possible ponding of water. No payment will be made for blading or removal of the existing shoulder material. Any surplus material shall be spread along the edge of the shoulders, foreslopes, or other adjacent areas as directed by the Engineer and will be an absorbed item. Material which cannot be placed in adjacent areas and deemed to be excess excavation by the Engineer shall be removed; the cost is to be included in the prices for other items bid.

Existing raised pavement markers are to be removed prior to beginning the overlay operation. No measurement will be made for separate payment; the cost is to be included in the prices for other items bid.

Temporary traffic stripe will be required immediately after the required overlay and prior to opening area to traffic. Temporary stripe is to be placed in the same location and configuration as the permanent stripe.

All permanent striping will be thermoplastic, double drop. The width of the permanent striping shall be six (6) inches. Edge lines will be placed so as to maintain the lane width as indicated on typical section drawings. In addition to these markings, high performance raised pavement markers will be placed on the centerline at eighty (80) Linear Feet intervals in tangents, forty (40) Linear Feet intervals in curves, and twenty (20) Linear Feet intervals on county roads or streets back to the right of way as directed by the Engineer. 2-Way Clear raised pavement markers shall be placed on side road radius as per attached typical drawing.

Thermoplastic Stripe will be used on all bridges and will installed as per specification listed in the 2004 Standard Specifications for Road and Bridge Construction Mississippi Department of Transportation in Section 626.03.1.2 with attention drawn to the following paragraph.

“When thermoplastic material is to be applied to Portland cement concrete pavements or bridge surfaces, a binder-sealer of the type and amount recommended by the manufacturer of the thermoplastic material shall be applied prior to placement of the thermoplastic material. On other pavement surfaces, a binder-sealer shall be applied under those conditions recommended by the manufacturer of the thermoplastic material.”



Rumble stripe will be placed throughout the project limits in accordance with the attached details.

Sta. 753+43 E. O. P.

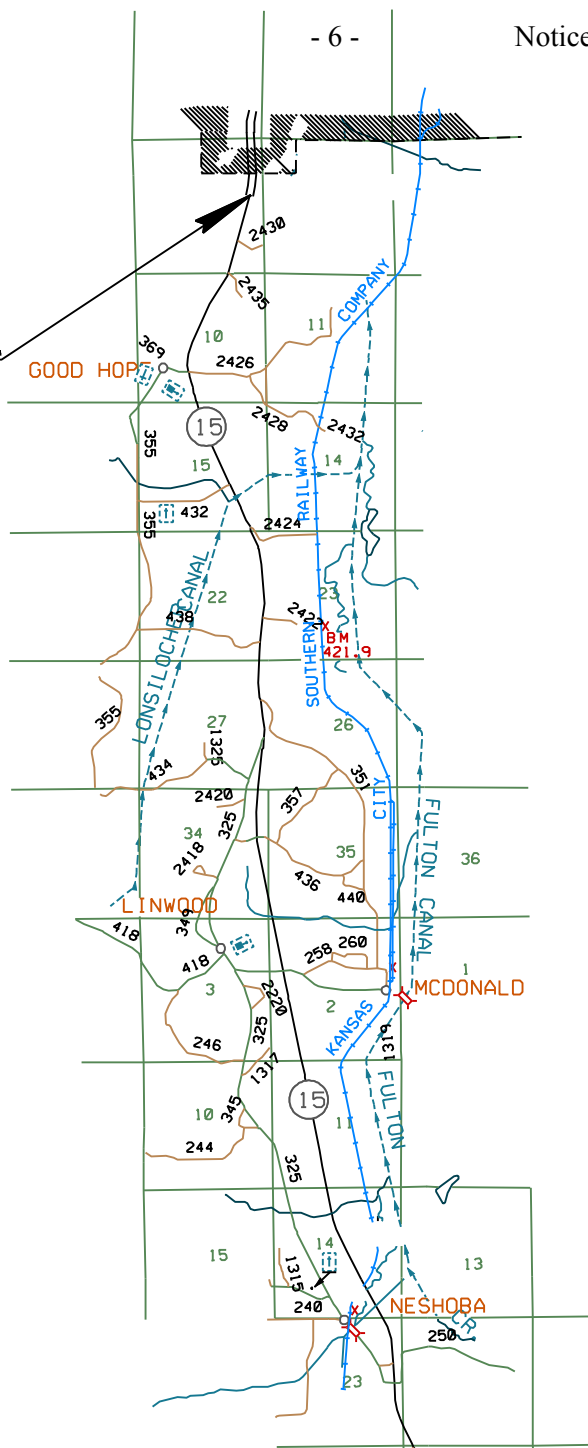

STP-0022-02 (051)  
 106207/301000  
 Highway 15  
 Neshoba County

Sta. 85+00 B. O. P.

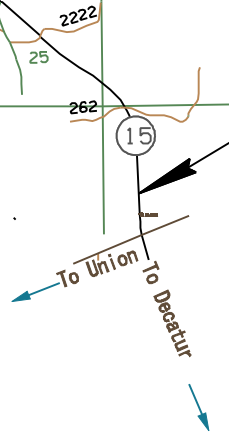

# Typical Section - County Roads

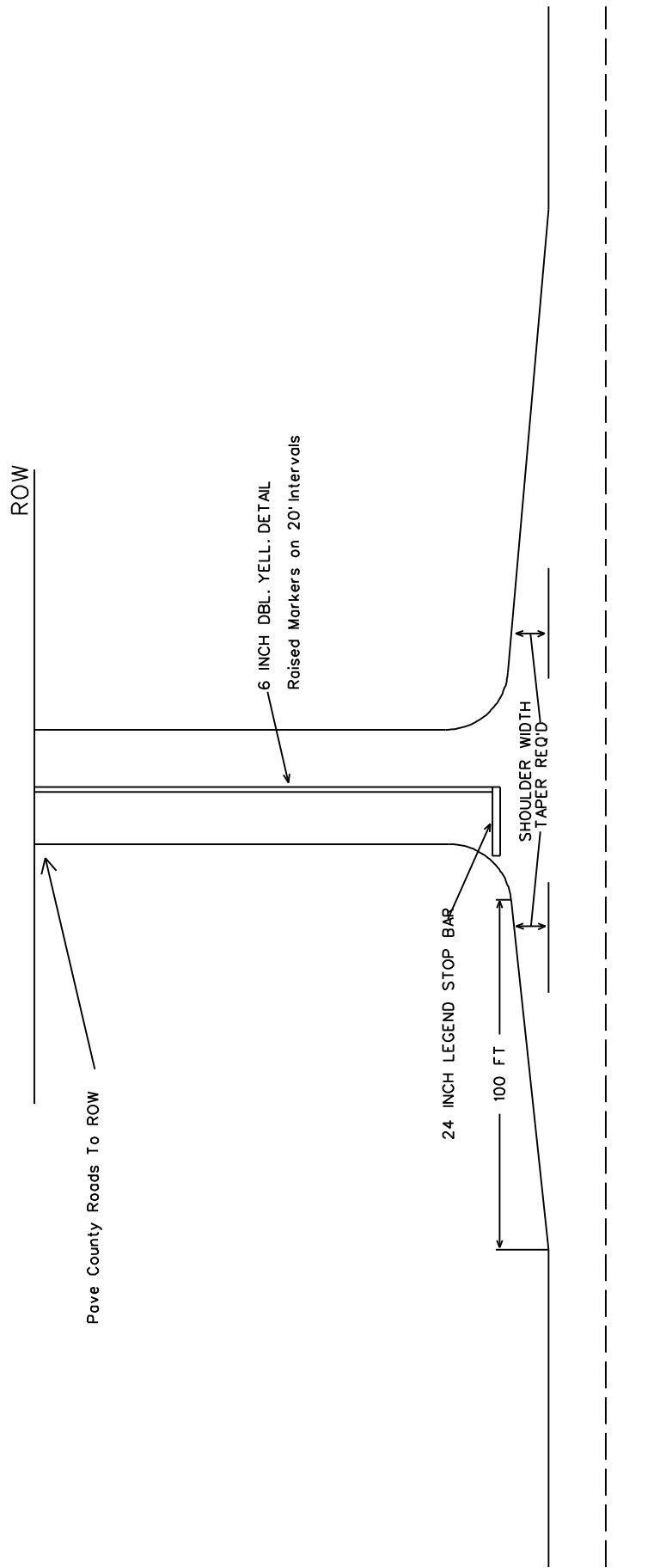

STATE	PROJECT NO.
MISS.	SP-000-05400-10

## TYPICAL FOR RAISED PAVEMENT MARKERS PLACED ON SIDE ROAD RADIUS

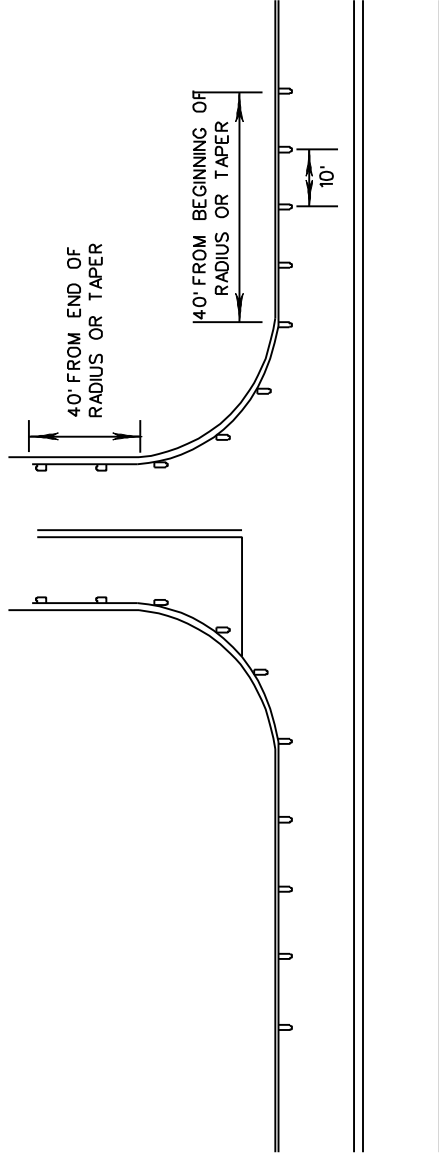

- NOTE 1. MARKERS SHALL BE PLACED EVERY 10 FEET.
- NOTE 2. MARKERS SHALL BE VISIBLE FROM THE TRAVELING MOTORIST ON STATE DESIGNATED HIGHWAYS.
- NOTE 3. MARKERS SHALL BE HIGH PERFORMANCE TWO WAY CLEAR.
- NOTE 4. FIVE (5) MARKERS SHALL BE PLACED ALONG MAINLINE EDGE STRIPE.
- NOTE 5. MARKERS FOR COUNTY ROADS SHALL CONTINUE DOWN THE EDGE STRIPE A DISTANCE OF 40 FEET.

MISSISSIPPI DEPARTMENT OF TRANSPORTATION	
<b>LOCAL ROAD DETAIL #1</b>	
PROJECT NO. :	
COUNTY :	
FILE NAME: LRD-LOCAL	
DATE: _____	SCALE: _____
	15

TYPICAL RAMP/PAD DETAIL

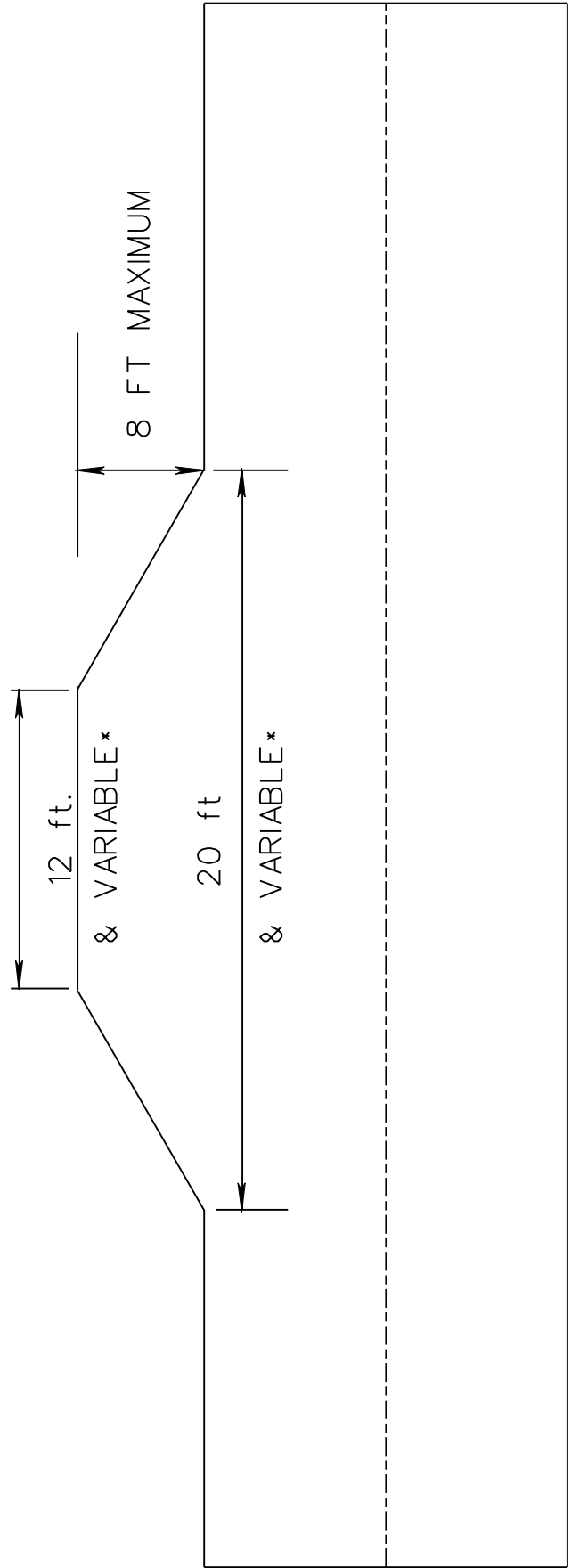

\*This is an average width.

# Typical Section HWY 15

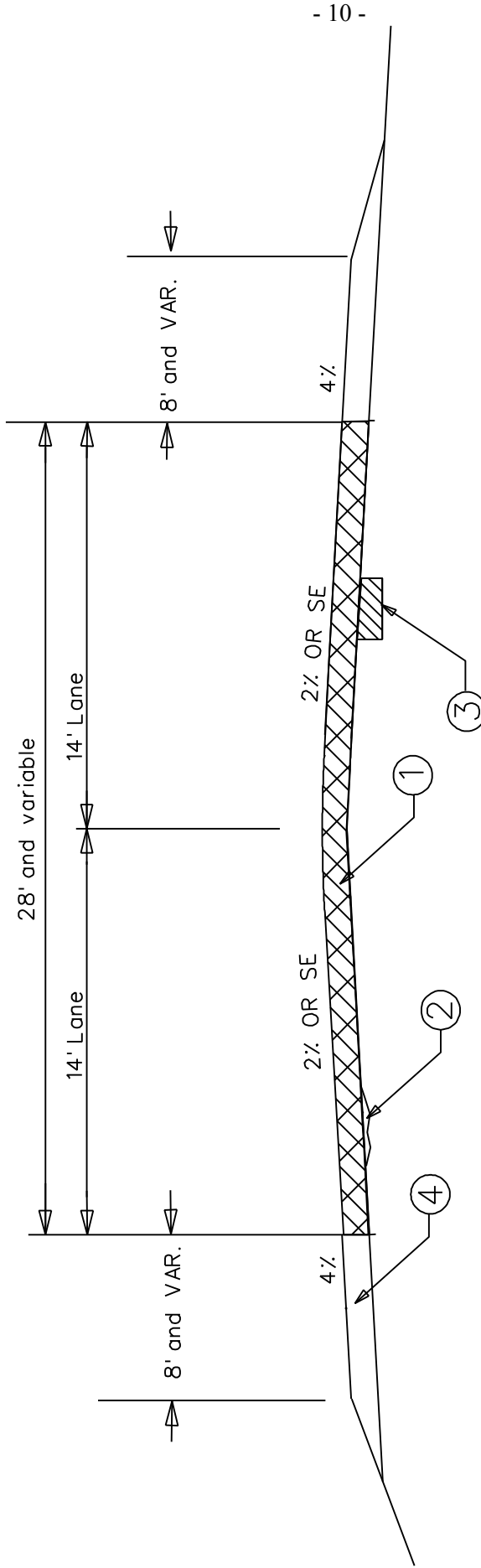

STA. 85+00 (BOP) TO STA. 228+36

- ① Mill 2 inches and variable and overlay with 2 inches and variable of HMA/WMA, 12.5mm Mix, MT.
- ② 12.5mm HMA/WMA, Mix MT, Leveling, AS DIRECTED BY ENGINEER.
- ③ Failed Areas to be removed and backfilled with HMA/WMA, 12.5mm Mix MT Leveling as directed.
- ④ Variable width and depth Granular Material, (Cl. 5, Grp. C) AS DIRECTED BY ENGINEER.

# Typical Section

HWY 15

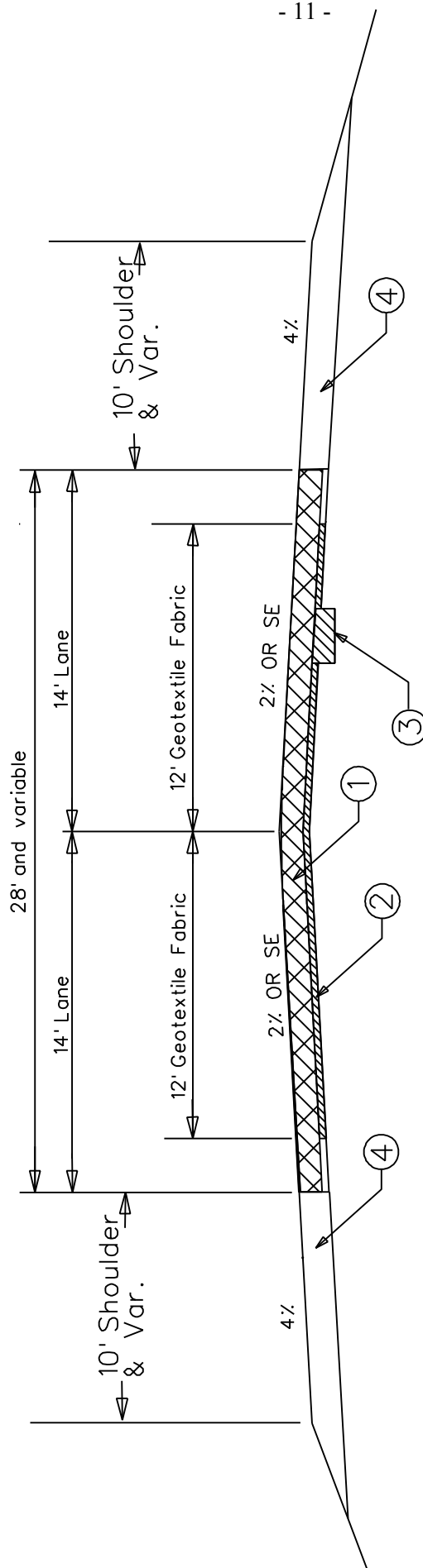

STA. 228+36 TO STA 519+50

- ① Mill 3 inches and place one lift of 1 1/2 inches and variable HMA/WMA, 12.5mm Mix, MT Leveling, and then one lift of 1 1/2 inches and variable HMA/WMA, 9.5mm Mix, MT.
- ② Place Geotextile paving Fabric, Type IV immediately prior to placing leveling course.
- ③ Failed Areas to be removed and back filled with HMA/WMA, 12.5mm Mix, MT Leveling as directed.
- ④ Variable width and depth Granular Mat' (Cl. 5, Grp. C) AS DIRECTED BY ENGINEER.

**GUARDRAIL ITEMS**

STATION	Guard Rail Lengths				Terminal End Section	Bridge End Section, Type A	Bridge End Section, Type G, Modified	Guard Delineators		Removal of Guardrail	Remarks
	DIST. A	DIST. B	DIST. C	DIST. D				White	Yellow		
289+53		150		75	2		2	7		300	
291+44		150		75	2		2	7		200	
622+14		150		75	2			7		200	
624+54		150		75	2			7		300	
		LF		LF	EACH	EACH	EACH	EACH		LF	
		600		300	8	4	4	28	0	1000	



# Typical Section HWY 15

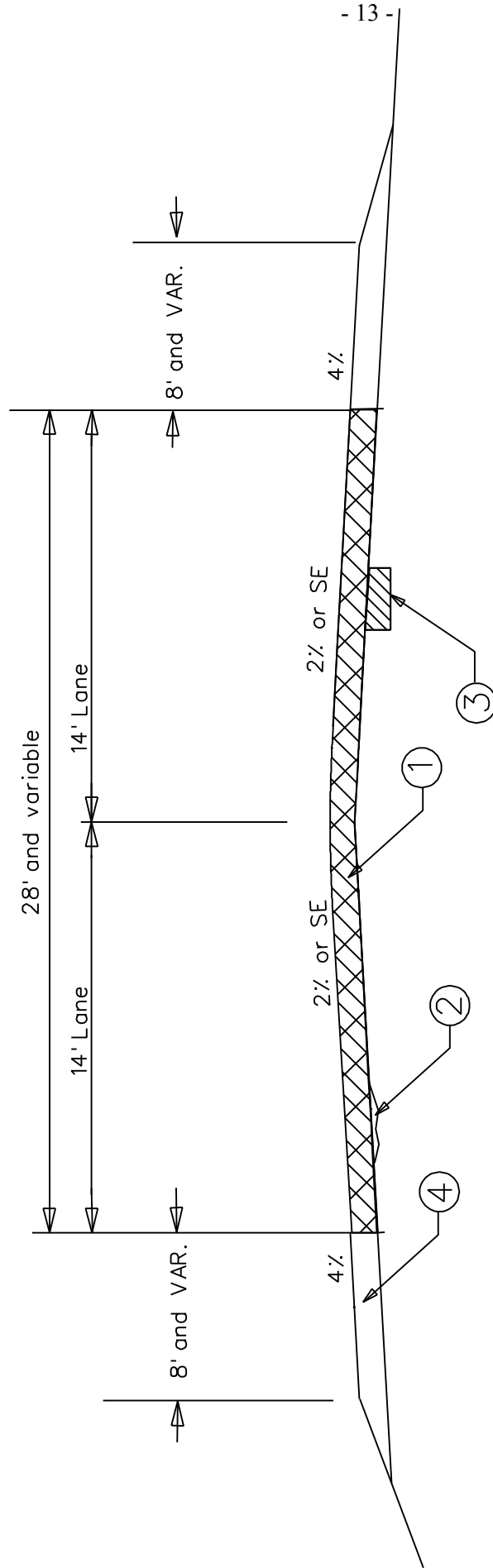

STA. 519+50 TO STA. 753+43 (EOP)

- ① Mill 2 inches and overlay with 2 inches and variable of HMA/WMA, 12.5mm Mix, MT.
- ② 12.5mm HMA/WMA, Mix MT, Leveling, AS DIRECTED BY ENGINEER.
- ③ Failed Areas to be removed and back filled with HMA/WMA, 12.5mm Mix MT Leveling as directed.
- ④ Variable width and depth Granular Material, (Cl. 5, Grp. C) AS DIRECTED BY ENGINEER.

Note: Saw and seal joints in HMA overlay over joints in J.R.C.P.

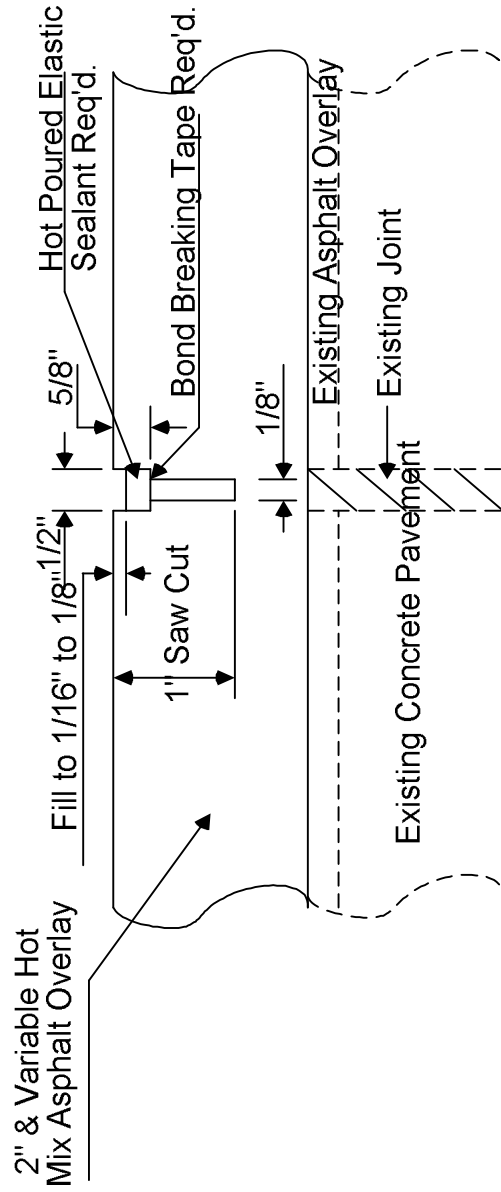

**DETAIL OF SAWING AND SEALING TRANSVERSE JOINTS**

STATE	PROJECT NO.
MISS.	

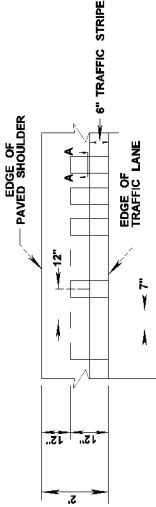

**DETAIL "A"**

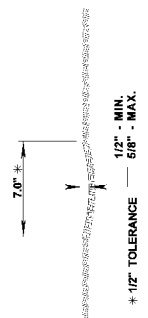

**SECTION "A-A"**

- GENERAL NOTES**
- GROUND-IN RUMBLE STRIPES SHALL BE APPLIED ON LEFT AND RIGHT SHOULDERS OF ALL PAVED SHOULDERS ON THIS PROJECT
  - GROUND-IN RUMBLE STRIPES SHALL BE OMITTED ACROSS PRINCIPAL INTERSECTING ROADWAYS OR OTHER INTERRUPTIONS IN NORMAL SHOULDER WIDTH AS DIRECTED BY THE ENGINEER
  - COST TO BE PAID FOR USING APPROPRIATE PAY ITEMS
  - GROUND-IN RUMBLE STRIPES SHALL BE APPLIED TO MAINLINE ONLY.
  - DO NOT USE WHERE TRAVEL LANE IS LESS THAN 11' WIDE.

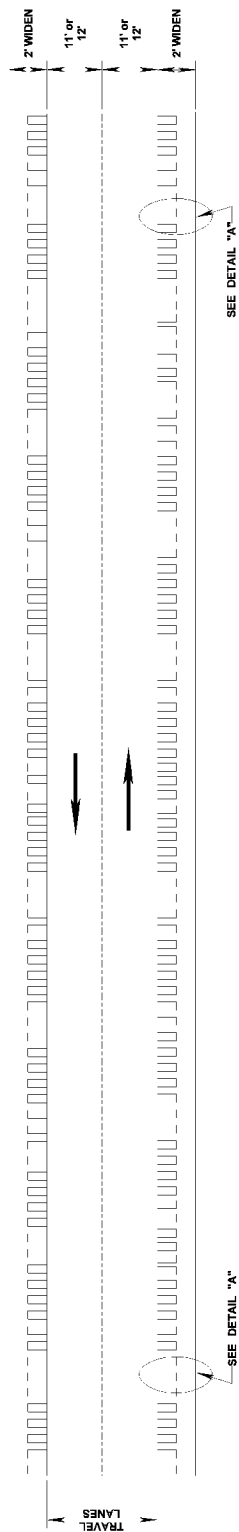

**PLAN**  
NOT TO SCALE

MISSISSIPPI DEPARTMENT OF TRANSPORTATION	
PROJECT NUMBER	338
FILE NAME	RS-2LL
SHEET NUMBER	1
DATE	08/02/05
DESIGN TEAM	s reeves
CHECKED	

### Construction Signing Detail

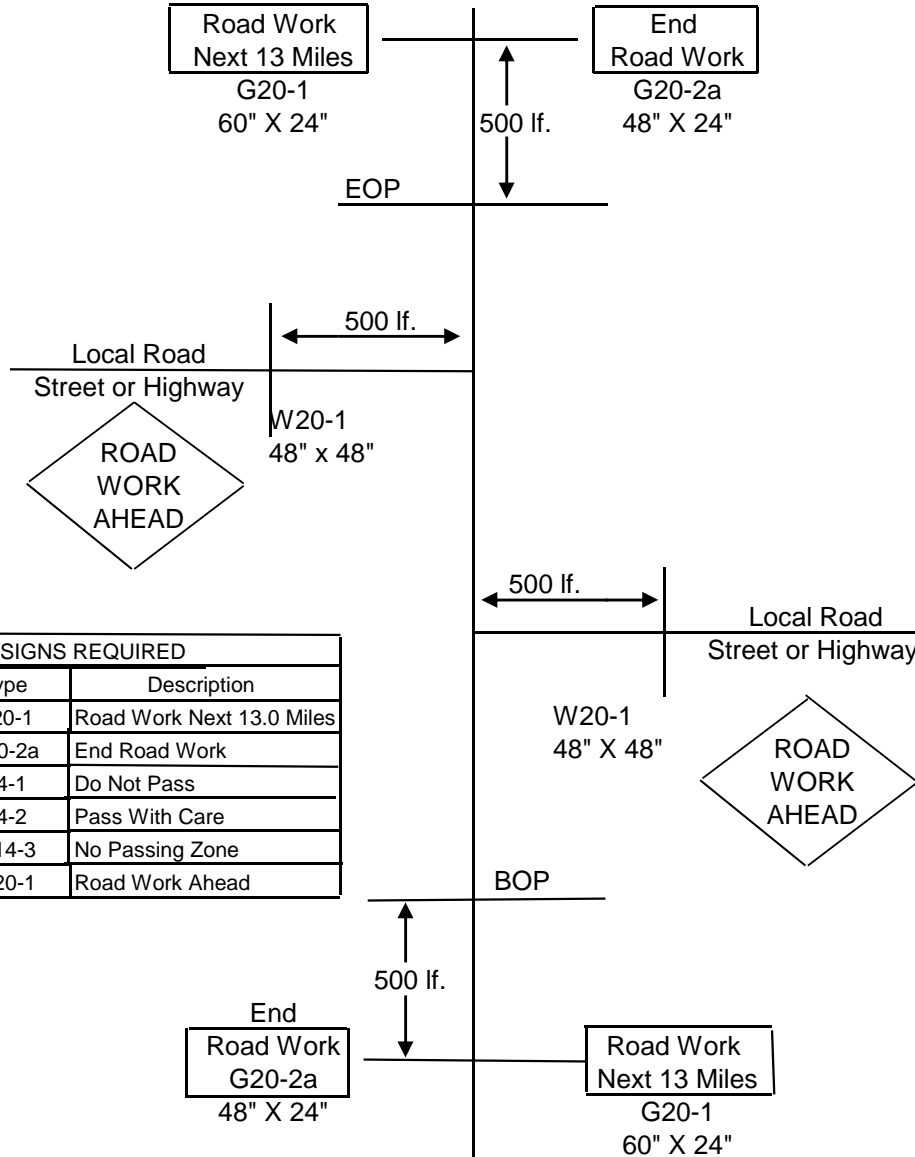

CONSTRUCTION SIGNS REQUIRED		
Quantity	Type	Description
2	G20-1	Road Work Next 13.0 Miles
2	G20-2a	End Road Work
158	R4-1	Do Not Pass
26	R4-2	Pass With Care
23	W14-3	No Passing Zone
17	W20-1	Road Work Ahead

**Notes:**

One (1) W20-1 "ROAD WORK AHEAD" sign is required at each Local Road, Street or highway entering the project.

G20-1 & G20-2a signs are to be mounted on 6 ft. Type III Double Faced Barricades.

R4-1 "DO NOT PASS", R4-2 "PASS WITH CARE" and W14-3 "No Passing Zone" signs are required in accordance with subsection 618.03.3 and as specified in the MUTCD. If no passing zones are 1,000 lf. or more, install additional R4-1 "DO NOT PASS" signs on maximum spacing of 750 lf.

Fluorescent orange sheeting shall be used on all construction and traffic control signs except for R4-1 and R4-2 signs, which shall be black legend and border on white background. All non-portable signing will be paid under Pay Item No. 619-D1 & 619-D2. All portable signing (lane closure etc.) will be paid under Pay Item No. 618-A Maintenance of Traffic.

Mill and Overlay approximately 13 miles of SR 15 from Newton County Line to beginning of 4-Lane at Philadelphia, known as Federal Aid Project No. STP-0022-02(051) / 106207301, in Neshoba County.

I (We) agree to complete the entire project within the specified contract time.

\*\*\* SPECIAL NOTICE TO BIDDERS \*\*\*

**BIDS WILL NOT BE CONSIDERED UNLESS BOTH UNIT PRICES AND ITEM TOTALS ARE ENTERED.**

**BIDS WILL NOT BE CONSIDERED UNLESS THE BID CERTIFICATION LOCATED AT THE END OF THE BID SHEETS IS SIGNED**

\*\*\*BID SCHEDULE\*\*\*

Line No.	Item Code	Adj Code	Quantity	Units	Description	Unit Price		Item Amount	
						Dollar	Ct	Dollar	Ct
<b>Roadway Items</b>									
0010	202-B005		800	Square Yard	Removal of Asphalt Pavement, All Depths				
0020	202-B087		1,000	Linear Feet	Removal of Guard Rail, Including Rails, Posts and Terminal Ends				
0030	310-B001	(GY)	100	Cubic Yard	Size I Stabilizer Aggregate, Coarse				
0040	406-A001		231,407	Square Yard	Cold Milling of Bituminous Pavement, All Depths				
0050	409-B001		36,300	Gallon	Asphalt Cement for Fabric Underseal				
0060	423-A001		26	Mile	Rumble Strips, Ground In				
0070	606-B001		900	Linear Feet	Guard Rail, Class A, Type 1				
0080	606-D001		4	Each	Guard Rail, Bridge End Section, Type A				

Section 905  
 Proposal (Sheet 2 - 2)

STP-0022-02(051) / 106207301  
 Neshoba County

Line No.	Item Code	Adj Code	Quantity	Units	Description	Unit Price	Bid Amount
0090	606-D007		4	Each	Guard Rail, Bridge End Section, Type G, Modified		
0100	606-E002		8	Each	Guard Rail, Terminal End Section, Flared		
0110	618-A001		1	Lump Sum	Maintenance of Traffic	XXXXXXXXXX XXX	
0120	619-A1002		39	Mile	Temporary Traffic Stripe, Continuous White		
0130	619-A2002		20	Mile	Temporary Traffic Stripe, Continuous Yellow		
0140	619-A4006		17	Mile	Temporary Traffic Stripe, Skip Yellow		
0150	619-A5001		20,000	Linear Feet	Temporary Traffic Stripe, Detail		
0160	619-A6001		2,400	Linear Feet	Temporary Traffic Stripe, Legend		
0170	619-D1001		1,064	Square Feet	Standard Roadside Construction Signs, Less than 10 Square Feet		
0180	619-D2001		292	Square Feet	Standard Roadside Construction Signs, 10 Square Feet or More		
0190	619-G4005		24	Linear Feet	Barricades, Type III, Double Faced		
0200	627-J001		600	Each	Two-Way Clear Reflective High Performance Raised Markers		

Section 905  
 Proposal (Sheet 2 - 3)

STP-0022-02(051) / 106207301  
 Neshoba County

Line No.	Item Code	Adj Code	Quantity	Units	Description	Unit Price	Bid Amount
0210	627-L001		2,000	Each	Two-Way Yellow Reflective High Performance Raised Markers		
0220	630-F001		28	Each	Delineators, Guard Rail, White		
0230	907-304-A001	(GY)	21,000	Cubic Yard	Granular Material, LVM, Class 5, Group C		
0240	907-407-A001	(A2)	38,300	Gallon	Asphalt for Tack Coat		
0250 Changed 07/18/2011	409-A002		77,637	Square Yard	Geotextile Fabric For Underseal, Type V		
0260	907-413-E001		21,900	Linear Feet	Sawing and Sealing Transverse Joints in Asphalt Pavement		
0270	907-606-PP002		4	Each	Guard Rail, Bridge Connector, Per Plans		
0280	907-626-C003		25	Mile	6" Thermoplastic Double Drop Edge Stripe, Continuous White		
0290	907-626-D006		10	Mile	6" Thermoplastic Double Drop Traffic Stripe, Skip Yellow		
0300	907-626-E006		13	Mile	6" Thermoplastic Double Drop Traffic Stripe, Continuous Yellow		
0310	907-626-G006		25,000	Linear Feet	Thermoplastic Double Drop Detail Stripe, White		
0320	907-626-G007		6,500	Linear Feet	Thermoplastic Double Drop Detail Stripe, Yellow		

Section 905  
 Proposal (Sheet 2 - 4)

STP-0022-02(051) / 106207301  
 Neshoba County

Line No.	Item Code	Adj Code	Quantity	Units	Description	Unit Price	Bid Amount
0330	907-626-H009		1,800	Linear Feet	Thermoplastic Double Drop Legend, White		
<b>ALTERNATE GROUP AA NUMBER 1</b>							
0340	907-403-A006 (BA1)		17,901	Ton	Hot Mix Asphalt, MT, 12.5-mm mixture		
0350	907-403-A010 (BA1)		9,000	Ton	Hot Mix Asphalt, MT, 9.5-mm mixture		
0360	907-403-B004 (BA1)		8,000	Ton	Hot Mix Asphalt, MT, 12.5-mm mixture, Leveling		
<b>ALTERNATE GROUP AA NUMBER 2</b>							
0370	907-403-M002 (BA1)		17,901	Ton	Warm Mix Asphalt, MT, 12.5-mm mixture		
0380	907-403-M006 (BA1)		9,000	Ton	Warm Mix Asphalt, MT, 9.5-mm mixture		
0390	907-403-N006 (BA1)		8,000	Ton	Warm Mix Asphalt, MT, 12.5-mm mixture, Leveling		



\*\*\* BID CERTIFICATION \*\*\*

TOTAL BID.....\$

\*\*\* DBE/WBE SECTION \*\*\*

Complete item nos. 1, 2, and/or 3 as appropriate. See Notice to Bidders addressing Disadvantaged Business Enterprises in Highway Construction.

1. I/We agree that no less than \_\_\_\_\_ percent shall be expended with small business concerns owned and controlled by socially and economically disadvantaged individuals (DBE and WBE).
2. Classification of Bidder: Small Business (DBE) \_\_\_\_\_ Small Business (WBE) \_\_\_\_\_
3. A joint venture with a Small Business (DBE/WBE): \_\_\_\_\_

\*\*\* SIGNATURE STATEMENT \*\*\*

BIDDER ACKNOWLEDGES THAT HE/SHE HAS CHECKED ALL ITEMS IN THIS PROPOSAL FOR ACCURACY AND CERTIFIED THAT THE FIGURES SHOWN THEREIN CONSTITUTE THEIR OFFICIAL BID.

\_\_\_\_\_  
BIDDER'S SIGNATURE

\_\_\_\_\_  
BIDDER'S COMPANY

\_\_\_\_\_  
BIDDER'S FEDERAL TAX ID NUMBER