

SECTION 905 -- PROPOSAL (CONTINUED)

I (We) further propose to execute the attached contract agreement (Section 902) as soon as the work is awarded to me (us), and to begin and complete the work within the time limit(s) provided for in the Specifications and Advertisement. I (We) also propose to execute the attached contract bond (Section 903) in an amount not less than one hundred (100) percent of the total of my (our) part, but also to guarantee the excellence of both workmanship and materials until the work is finally accepted.

I (We) enclose a certified check, cashier's check or bid bond for **five percent (5%) of total bid** and hereby agree that in case of my (our) failure to execute the contract and furnish bond within Ten (10) days after notice of award, the amount of this check (bid bond) will be forfeited to the State of Mississippi as liquidated damages arising out of my (our) failure to execute the contract as proposed. It is understood that in case I am (we are) not awarded the work, the check will be returned as provided in the Specifications.

Bidder acknowledges receipt of and has added to and made a part of the proposal and contract documents the following addendum (addenda):

ADDENDUM NO. 1 DATED 7/11/2012 ADDENDUM NO. DATED
 ADDENDUM NO. 2 DATED 7/16/2012 ADDENDUM NO. DATED

Number	Description
1	Revised Table of Contents, replace same; Revised FHWA 1273, replace same; Revised FHWA 1273 Executive Order, replace same; Added Supplement to S.P. 907-102-8, Bid Sheets, replace same; Amendment EBS Download Required.
2	Revised Table of Contents, replace same; Revised NTB 3971, replace same; Added S.P. 907-625-4, replace same; Bid Sheets, replace same; Amendment EBS Download Required.

TOTAL ADDENDA: 2
 (Must agree with total addenda issued prior to opening of bids)

Respectfully Submitted,

DATE _____

 Contractor

BY _____
 Signature

TITLE _____

ADDRESS _____

CITY, STATE, ZIP _____

PHONE _____

FAX _____

E-MAIL _____

(To be filled in if a corporation)

Our corporation is chartered under the Laws of the State of _____ and the names, titles and business addresses of the executives are as follows:

_____ President	_____ Address
_____ Secretary	_____ Address
_____ Treasurer	_____ Address

The following is my (our) itemized proposal.

STP-9999-02(248) / 106420301 District 2 County(ies)

MISSISSIPPI DEPARTMENT OF TRANSPORTATION

TABLE OF CONTENTS

PROJECT: STP-9999-02(248) / 106420301 – District 2

901--Advertisement

904--Notice to Bidders: Governing Specifications - # 1
 Disadvantaged Business Enterprise, w/ supplement - # 696
 Payroll Requirements - # 883
 Errata & Modifications to 2004 Standard Specifications - # 1405
 Safety Apparel - # 1808
 Federal Bridge Formula - # 1928
 Department of Labor Ruling - # 2239
 Status of ROW w/ attachments - # 2382
 DBE Forms, Participation and Payment - # 2596
 Reduced Speed Limit Signs - # 2937
 DUNS Requirement for Federal Funded Projects - # 3414
 Questions Regarding Bidding - # 3425
 Wage Rates - #3512
 Type III Barricade Rails - #3655
 Standard Drawings - # 3770
 Contract Time - #3970
 Scope of Work - #3971

906- : FHWA 1273, with Supplement, Executive Order, & Wage Rates

907-101-4: Definitions
907-102-8: Bidding Requirements and Conditions
907-103-8: Award and Execution of Contract
907-104-1: Partnering Process
907-104-4: Disposal of Materials
907-105-6: Control of Work, w/Supplement
907-107-9: Legal Relations & Responsibility to Public, w/Supplement
907-108-24: Prosecution and Progress
907-109-5: Measurement and Payment, w/Supplement
907-110-2: Wage Rates
907-625-4: High Build Painted Traffic Markings
907-626-3: Thermoplastic Markings
907-626-5: Inverted Profile Thermoplastic Traffic Stripe
907-626-15: Thermoplastic Traffic Markings
907-720-1: Pavement Marking Materials

SECTION 905 - PROPOSAL, PROPOSAL BID SHEETS

COMBINATION BID PROPOSAL

CERTIFICATION OF PERFORMANCE - PRIOR FEDERAL-AID CONTRACTS

CERTIFICATION REGARDING NON-COLLUSION, DEBARMENT AND SUSPENSION

SECTION 902- CONTRACT FORM, AND SECTION 903 - CONTRACT BOND FORMS

FORM -- OCR-485

(REVISIONS TO THE ABOVE WILL BE INDICATED ON THE SECOND SHEET
OF SECTION 905 AS ADDENDA)

MISSISSIPPI DEPARTMENT OF TRANSPORTATION

SECTION 904 - NOTICE TO BIDDERS NO. 3971

CODE: (SP)

DATE: 6/14/2012

SUBJECT: Scope of Work

PROJECT: STP-9999-02(248) / 106420301 – District 2

The contract documents do not include an official set of construction plans but may, by reference; include some Standard Drawings when so specified in a Notice to Bidders entitled, “Standard Drawings”. All other references to plans in the contract documents and Standard Specifications for Road and Bridge Construction are to be disregarded.

In general, the work to be accomplished using the pay items and corresponding specifications set forth in this contract is for the furnishing of material and the placement of pavement markings in accordance with the Standard Specifications, special provisions and enclosed drawings as applicable. Maps are included of each county within the District showing the routes or segments of routes on which pavement markings are to be placed. Estimated quantities are shown by route for each county.

Removal of existing pavement markings on the bridge deck surfaces will be required prior to placement of the new pavement markings.

The contractor shall be responsible for any damage caused by the contractor’s operations to the existing raised pavement markers (for example, painting over reflective surfaces). The contractor is responsible for establishing all the necessary controls to insure that the pavement surface cleaning or other preparation necessary to insure a proper bond prior to placement of the pavement markings. The contractor is also responsible for minor blading of the shoulders to establish a suitable area for restriping; this is not meant to be blading the entire shoulder width, but only that directly related to stripe placement. This work will not be measured for separate payment. Costs associated with this work shall be included in the unit prices for other bid items.

The contractor shall provide all traffic handling devices in accordance with the Standard Specifications, special provisions and enclosed drawings. Payment shall be made under pay item number 618-A, (Maintenance of Traffic).

Incidental work that is necessary to complete the work shall not be measured for separate payment, and the cost shall be included in the items bid.

19.00 miles

2-

Notice To Bidders No. 3971 -- Cont'd.

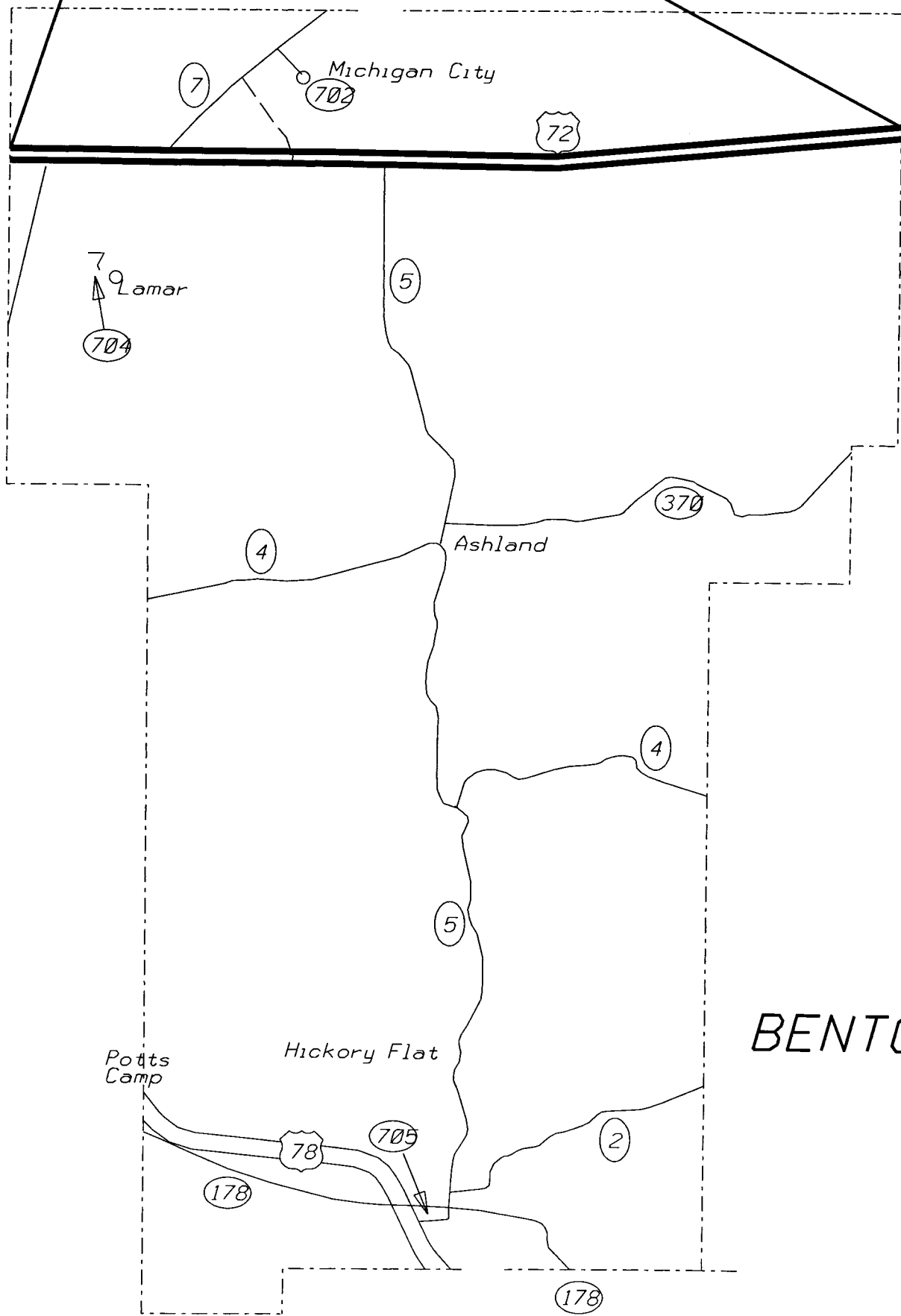

BENTON

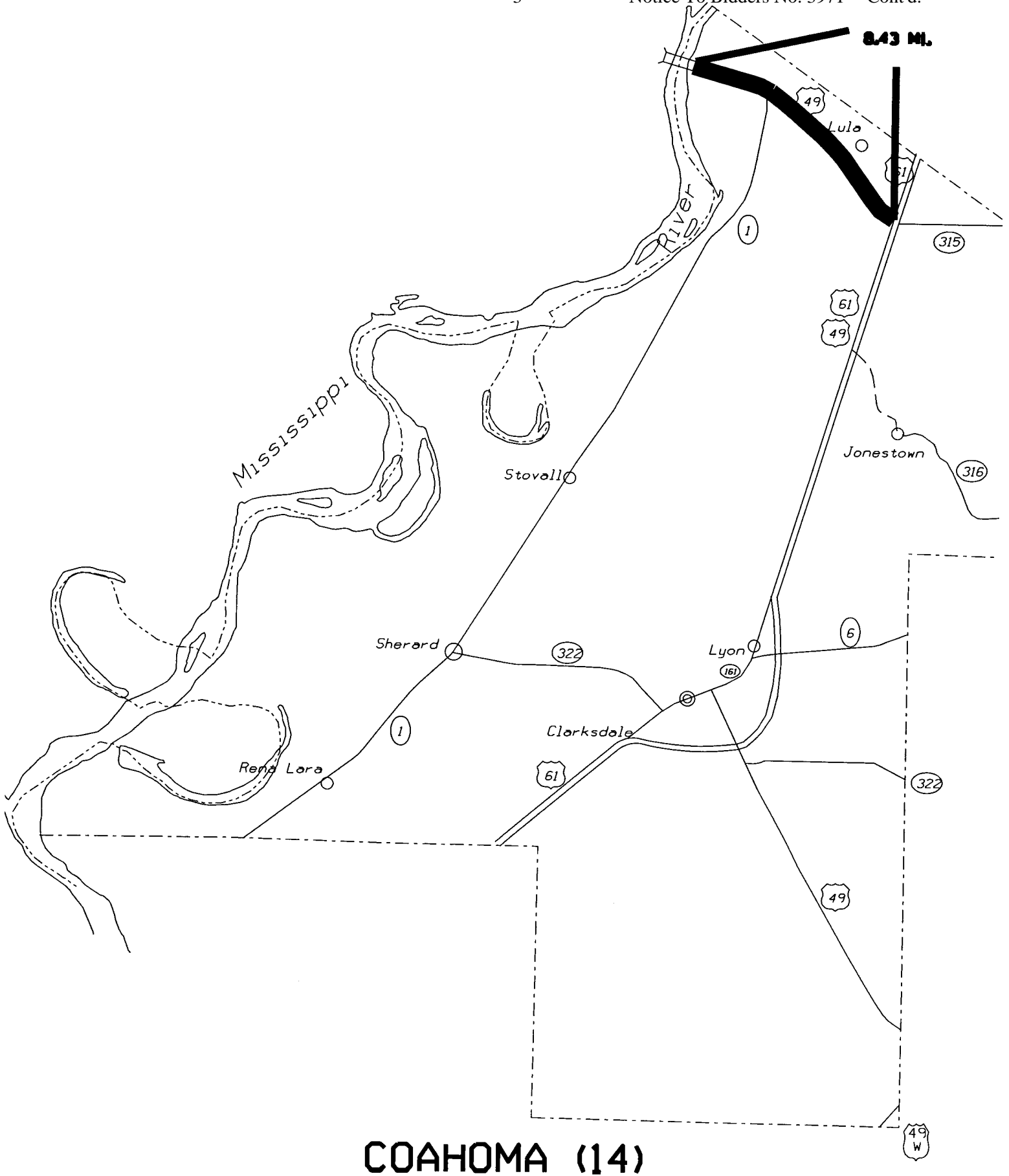

COAHOMA (14)

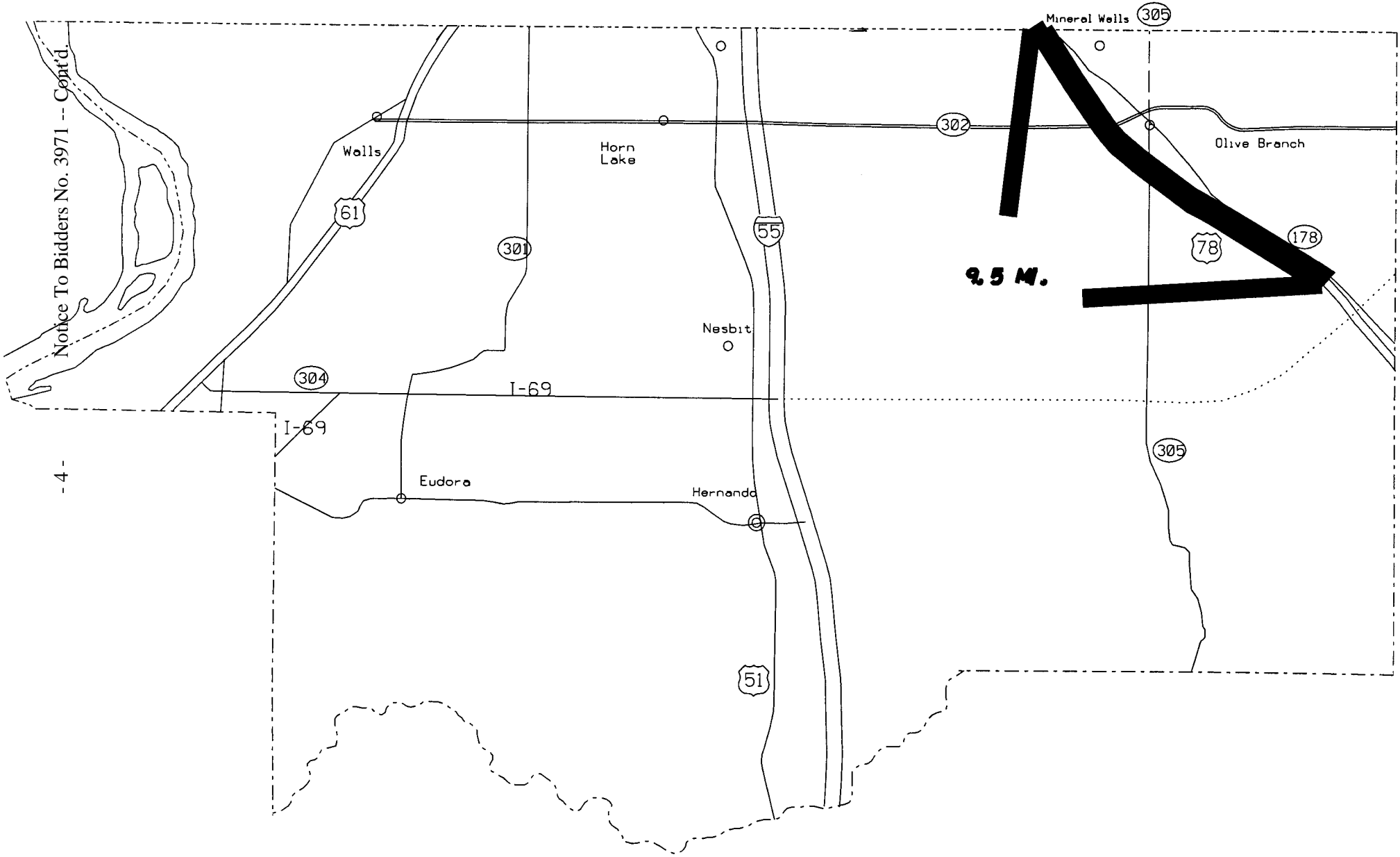

DESOTO (17)

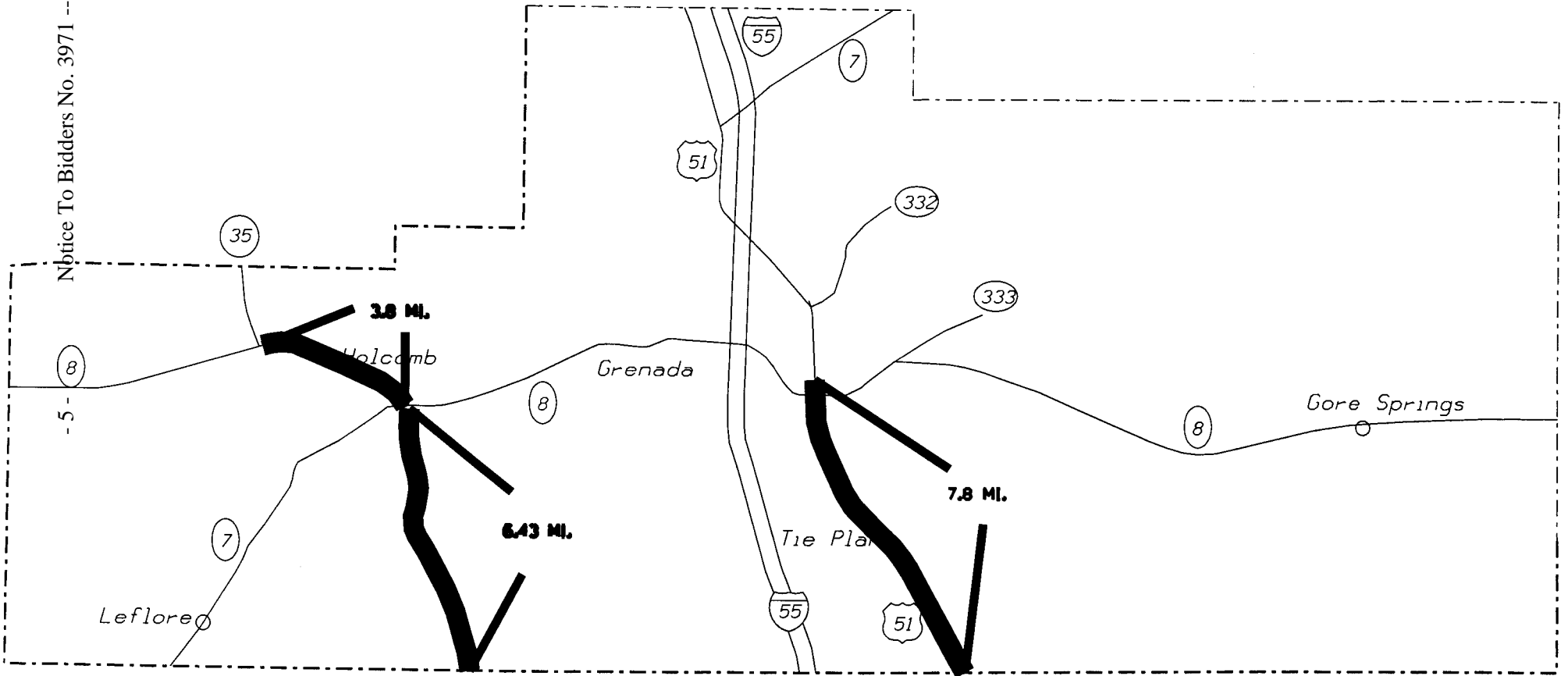

GRENADA (22)

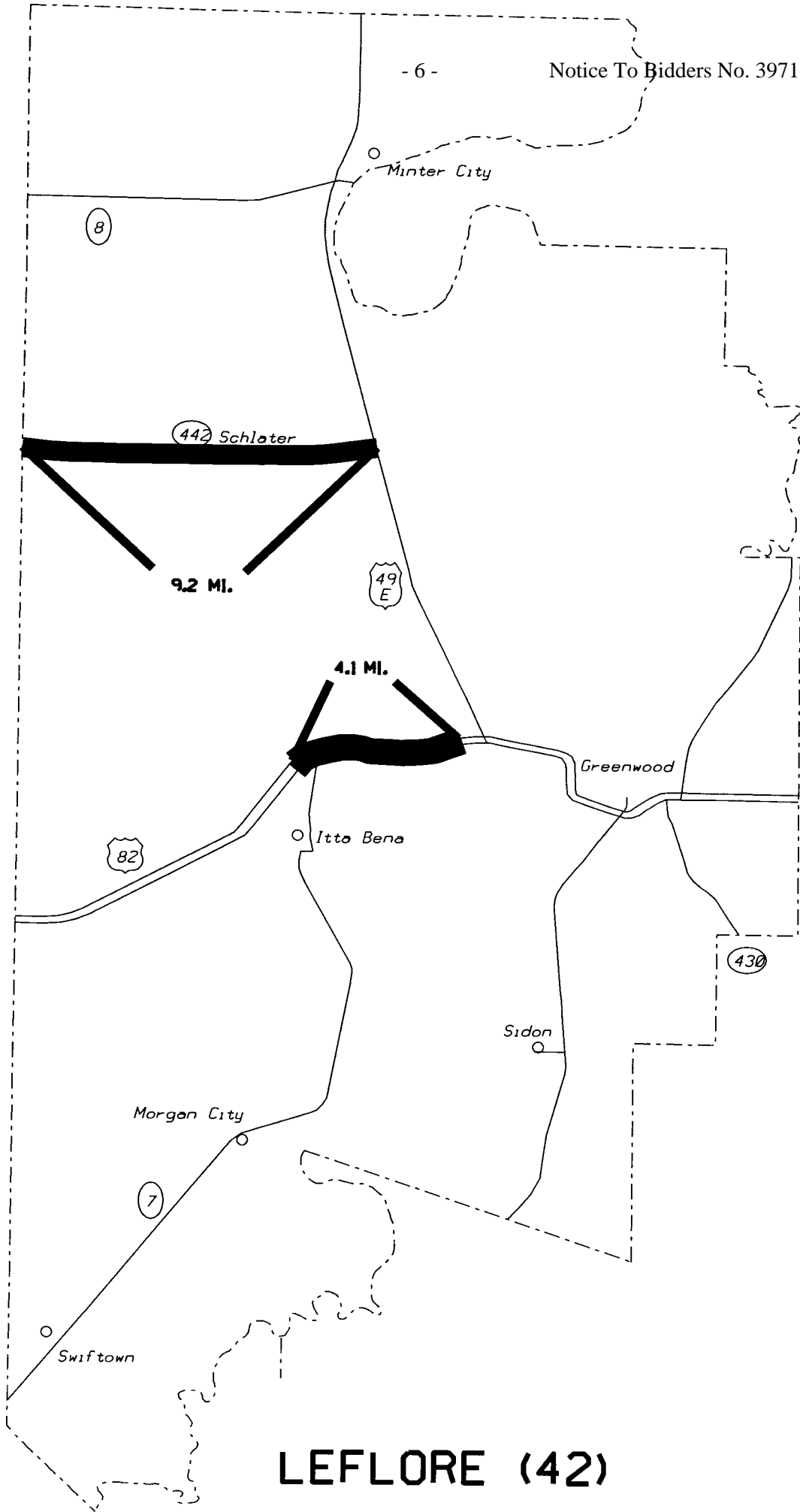

LEFLORE (42)

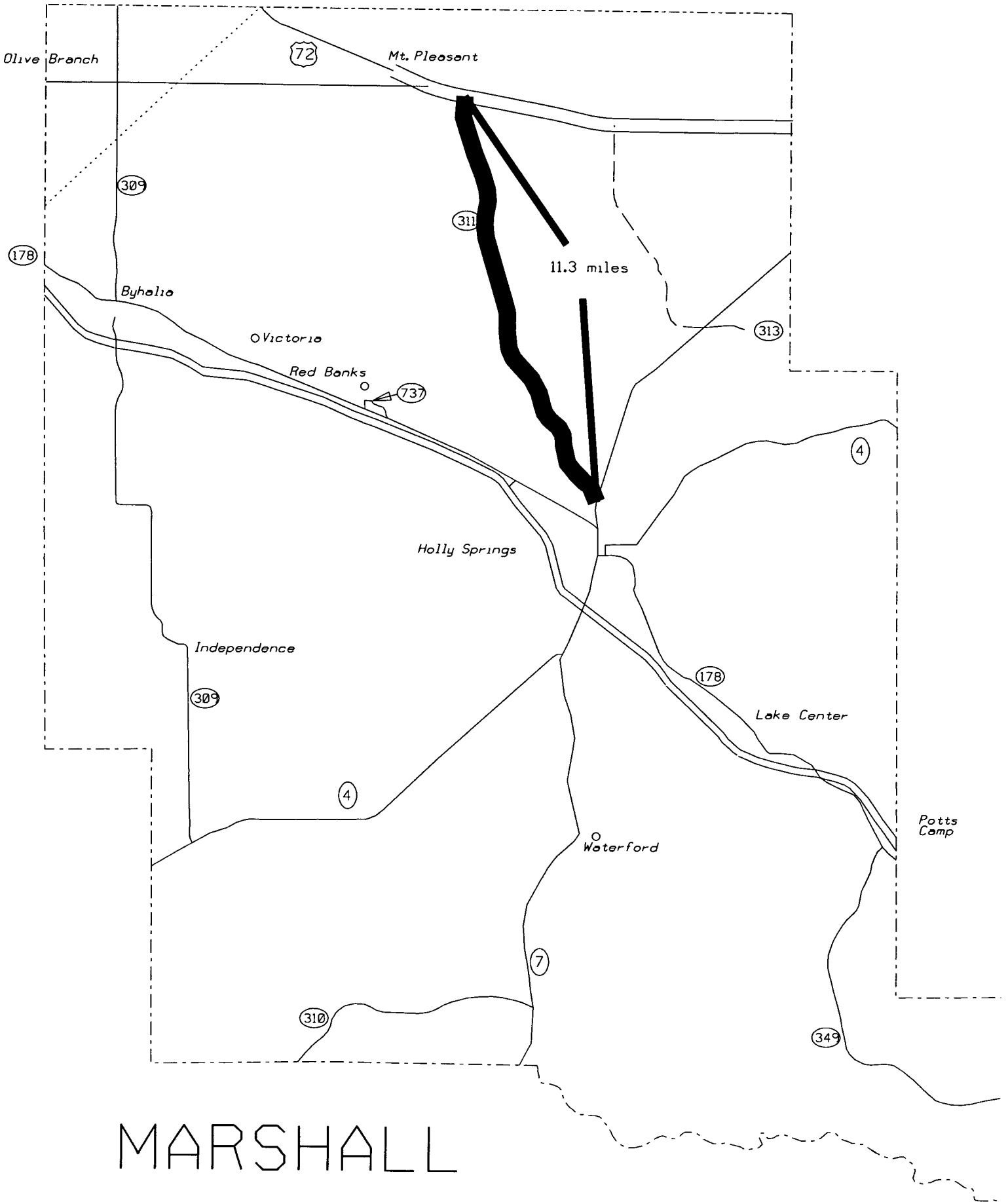

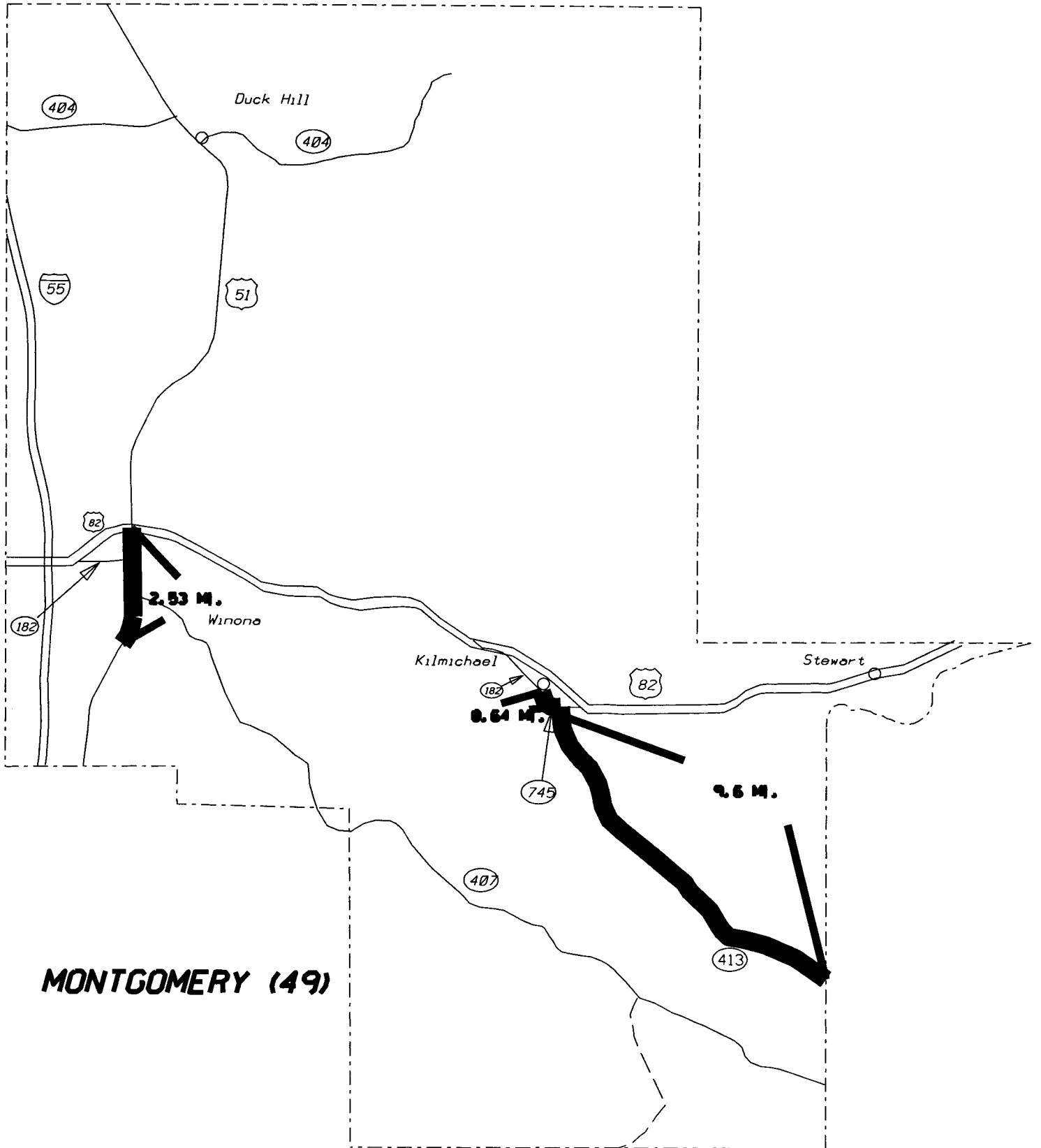

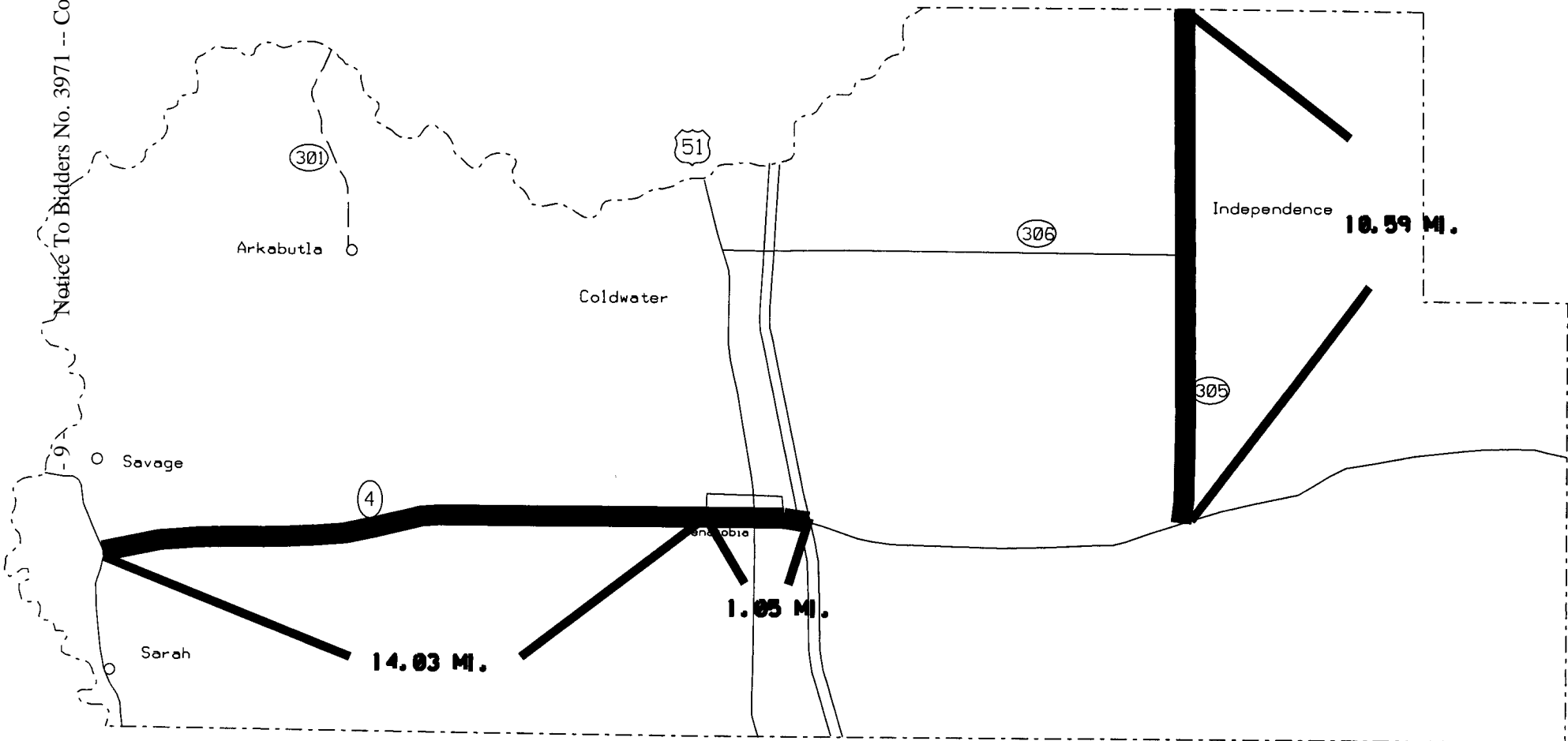

TATE (69)

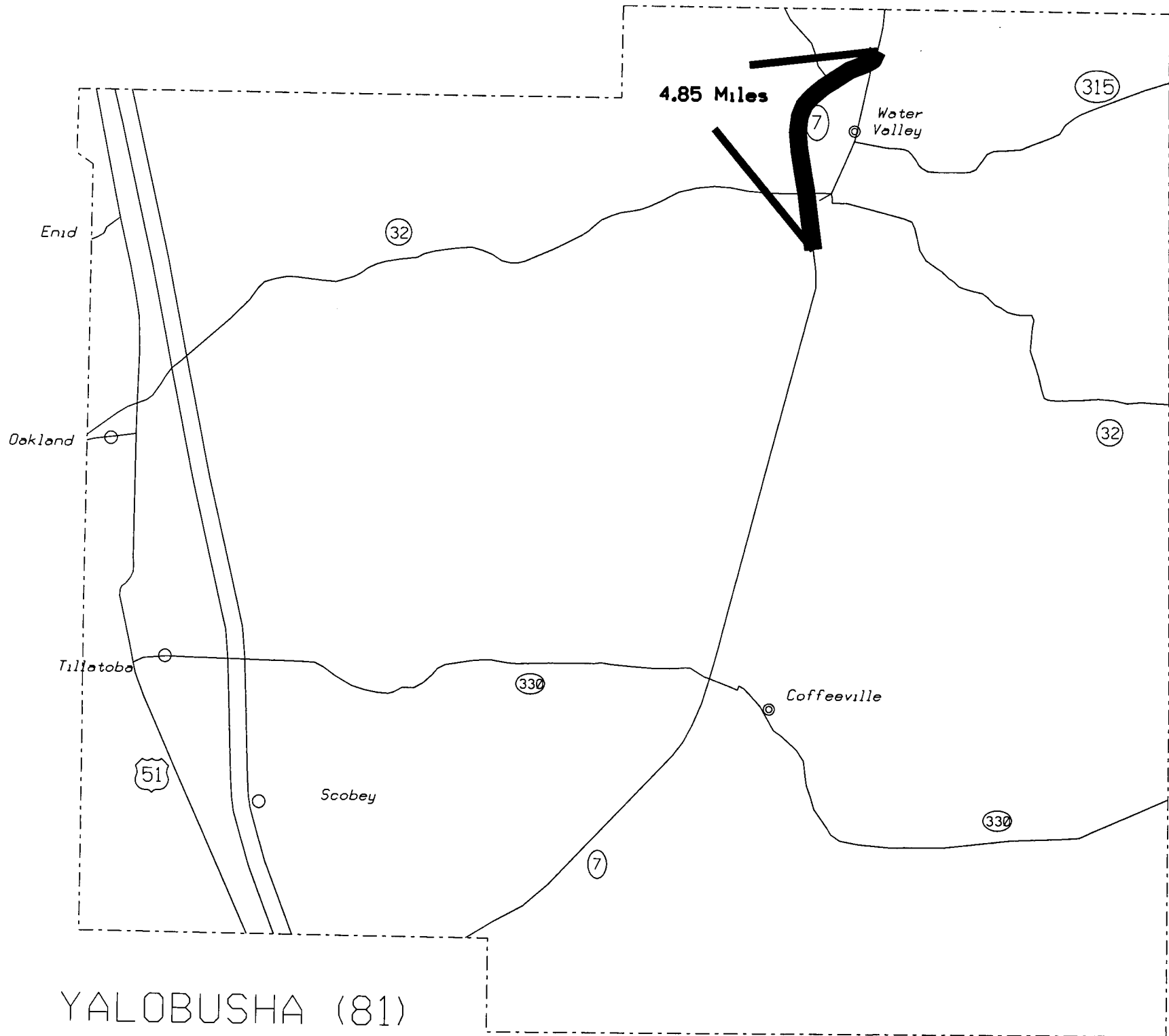

YALOBUSHA (81)

**STP-9999-02(248) / 106420-301000
District Wide Stripe -District 2**

Montgomery County

Pay Item No.	Description	Unit	Quantity		
			US 51	SR 413	SR 745
202-B076	Removal of Traffic Stripe	Linear Feet	0	4,872	0
907-625-A004	Traffic Stripe, High Build, Skip White	Mile	0.00	0.00	0.00
907-625-B004	Traffic Stripe, High Build, Skip Yellow	Mile	0.00	0.00	0.00
907-625-C004	Traffic Stripe, High Build, Continuous White	Mile	0.00	0.00	0.00
907-625-D004	Traffic Stripe, High Build, Continuous Yellow	Mile	0.00	0.00	0.00
907-625-E003	Detail Traffic Stripe, High Build	Linear Feet	0	0	0
907-625-F005	Legend, High Build	Square Feet	0	0	0
907-625-F006	Legend, High Build	Linear Feet	0	0	0
907-626-U002	4" Thermoplastic Traffic Stripe, Skip White, 40-mil min.	Mile	0.00	0.00	0.00
907-626-V002	4" Thermoplastic Traffic Stripe, Continuous White, 40-mil min.	Mile	0.00	0.00	1.23
907-626-W002	4" Thermoplastic Traffic Stripe, Skip Yellow, 40-mil min.	Mile	0.00	0.00	0.00
907-626-X002	4" Thermoplastic Traffic Stripe, Continuous Yellow, 40-mil min.	Mile	0.00	0.00	1.43
907-626-Y001	Thermoplastic Detail Stripe, White, 4" Equivalent Length, 40-mil min.	Linear Feet	0	0	560
907-626-Y003	Thermoplastic Detail Stripe, Yellow, 4" Equivalent Length, 40-mil min.	Linear Feet	0	0	0
907-626-Z001	Thermoplastic Legend, White, 4" Equivalent Length, 40-mil min.	Linear Feet	0	0	902
907-626-Z002	Thermoplastic Legend, White, 4" Equivalent Length, 40-mil min.	Square Feet	0	0	0
907-626-U004	6" Thermoplastic Traffic Stripe, Skip White, 40-mil min.	Mile	0.00	0.00	0.00
907-626-V004	6" Thermoplastic Traffic Stripe, Continuous White, 40-mil min.	Mile	1.47	18.35	0.00
907-626-W004	6" Thermoplastic Traffic Stripe, Skip Yellow, 40-mil min.	Mile	0.00	7.70	0.00
907-626-X004	6" Thermoplastic Traffic Stripe, Continuous Yellow, 40-mil min.	Mile	1.35	9.10	0.00
907-626-Y002	Thermoplastic Detail Stripe, White, 6" Equivalent Length, 40-mil min.	Linear Feet	200	0	0
907-626-Y004	Thermoplastic Detail Stripe, Yellow, 6" Equivalent Length, 40-mil min.	Linear Feet	2,300	0	0
907-626-Z003	Thermoplastic Legend, White, 6" Equivalent Length, 40-mil min.	Linear Feet	3,114	0	0
907-626-Z004	Thermoplastic Legend, White, 6" Equivalent Length, 40-mil min.	Square Feet	0	0	0
907-628-I001	4" High Performance Cold Plastic Traffic Stripe, Skip White	Linear Feet	0	0	0
907-628-J001	4" High Performance Cold Plastic Traffic Stripe, Continuous White	Linear Feet	0	0	0
907-628-L001	4" High Performance Cold Plastic Traffic Stripe, Skip Yellow	Linear Feet	0	0	0
907-628-M001	4" High Performance Cold Plastic Traffic Stripe, Continuous Yellow	Linear Feet	0	0	0
628-P001	High Performance Cold Plastic Traffic Stripe, Legend, White	Square Feet	0	0	0
628-I002	6" High Performance Cold Plastic Traffic Stripe, Skip White	Linear Feet	0	0	0
628-J002	6" High Performance Cold Plastic Traffic Stripe, Continuous White	Linear Feet	0	2436	0
628-L002	6" High Performance Cold Plastic Traffic Stripe, Skip Yellow	Linear Feet	0	1218	0
628-M002	6" High Performance Cold Plastic Traffic Stripe, Continuous Yellow	Linear Feet	0	1218	0

**STP-9999-02(248) / 106420-301000
District Wide Stripe -District 2**

Tate County

Pay Item No.	Description	Unit	Quantity		Comments
			SR 4*	SR 305**	
202-B076	Removal of Traffic Stripe	Linear Feet	125	0	
907-625-A004	Traffic Stripe, High Build, Skip White	Mile	0.00	0.00	*Skip bridge replacement project limits in Moore Bottom
907-625-B004	Traffic Stripe, High Build, Skip Yellow	Mile	0.00	0.00	
907-625-C004	Traffic Stripe, High Build, Continuous White	Mile	0.00	0.00	
907-625-D004	Traffic Stripe, High Build, Continuous Yellow	Mile	0.00	0.00	
907-625-E003	Detail Traffic Stripe, High Build	Linear Feet	0	0	**Skip bridge replacement project limits
907-625-F005	Legend, High Build	Square Feet	0	0	
907-625-F006	Legend, High Build	Linear Feet	0	0	
907-626-U002	4" Thermoplastic Traffic Stripe, Skip White, 40-mil min.	Mile	0.68	0.00	***4" Detail White includes 1,200 Linear Feet for raised rumbles at intersections.
907-626-V002	4" Thermoplastic Traffic Stripe, Continuous White, 40-mil min.	Mile	15.54	0.00	
907-626-W002	4" Thermoplastic Traffic Stripe, Skip Yellow, 40-mil min.	Mile	16.49	0.00	
907-626-X002	4" Thermoplastic Traffic Stripe, Continuous Yellow, 40-mil min.	Mile	14.23	0.00	
907-626-Y001	Thermoplastic Detail Stripe, White, 4" Equivalent Length, 40-mil min.	Linear Feet	3,283	0	
907-626-Y003	Thermoplastic Detail Stripe, Yellow, 4" Equivalent Length, 40-mil min.	Linear Feet	3,606	1,696	
907-626-Z001	Thermplastic Legend, White, 4" Equivalent Length, 40-mil min.	Linear Feet	968	0	
907-626-Z002	Thermplastic Legend, White, 4" Equivalent Length, 40-mil min.	Square Feet	167	0	
907-626-U004	6" Thermoplastic Traffic Stripe, Skip White, 40-mil min.	Mile	0.00	0.00	
907-626-V004	6" Thermoplastic Traffic Stripe, Continuous White, 40-mil min.	Mile	0.00	16.56	
907-626-W004	6" Thermoplastic Traffic Stripe, Skip Yellow, 40-mil min.	Mile	0.00	6.31	
907-626-X004	6" Thermoplastic Traffic Stripe, Continuous Yellow, 40-mil min.	Mile	0.00	9.78	
907-626-Y002	Thermoplastic Detail Stripe, White, 6" Equivalent Length, 40-mil min.	Linear Feet	0	2,276	
907-626-Y004	Thermoplastic Detail Stripe, Yellow, 6" Equivalent Length, 40-mil min.	Linear Feet	0	5,900	
907-626-Z003	Thermplastic Legend, White, 6" Equivalent Length, 40-mil min.	Linear Feet	0	551	
907-626-Z004	Thermplastic Legend, White, 6" Equivalent Length, 40-mil min.	Square Feet	0	142	
907-628-I001	4" High Performance Cold Plastic Traffic Stripe, Skip White	Linear Feet	0	0	
907-628-J001	4" High Performance Cold Plastic Traffic Stripe, Continuous White	Linear Feet	125	0	
907-628-L001	4" High Performance Cold Plastic Traffic Stripe, Skip Yellow	Linear Feet	0	0	
907-628-M001	4" High Performance Cold Plastic Traffic Stripe, Continuous Yellow	Linear Feet	0	0	
628-P001	High Performance Cold Plastic Traffic Stripe, Legend, White	Square Feet	0	0	
628-I002	6" High Performance Cold Plastic Traffic Stripe, Skip White	Linear Feet	0	0	
628-J002	6" High Performance Cold Plastic Traffic Stripe, Continuous White	Linear Feet	0	0	
628-L002	6" High Performance Cold Plastic Traffic Stripe, Skip Yellow	Linear Feet	0	0	
628-M002	6" High Performance Cold Plastic Traffic Stripe, Continuous Yellow	Linear Feet	0	0	

**STP-9999-02(248) / 106420-301000
District Wide Stripe -District 2**

**Desoto
County**

Pay Item No.	Description	Unit	Quantity
			US 78
202-B076	Removal of Traffic Stripe	Linear Feet	0
907-625-A004	Traffic Stripe, High Build, Skip White	Mile	0.00
907-625-B004	Traffic Stripe, High Build, Skip Yellow	Mile	0.00
907-625-C004	Traffic Stripe, High Build, Continuous White	Mile	0.00
907-625-D004	Traffic Stripe, High Build, Continuous Yellow	Mile	0.00
907-625-E003	Detail Traffic Stripe, High Build	Linear Feet	0
907-625-F005	Legend, High Build	Square Feet	0
907-625-F006	Legend, High Build	Linear Feet	0
907-626-U002	4" Thermoplastic Traffic Stripe, Skip White, 40-mil min.	Mile	0.00
907-626-V002	4" Thermoplastic Traffic Stripe, Continuous White, 40-mil min.	Mile	0.00
907-626-W002	4" Thermoplastic Traffic Stripe, Skip Yellow, 40-mil min.	Mile	0.00
907-626-X002	4" Thermoplastic Traffic Stripe, Continuous Yellow, 40-mil min.	Mile	0.00
907-626-Y001	Thermoplastic Detail Stripe, White, 4" Equivalent Length, 40-mil min.	Linear Feet	0
907-626-Y003	Thermoplastic Detail Stripe, Yellow, 4" Equivalent Length, 40-mil min.	Linear Feet	0
907-626-Z001	Thermplastic Legend, White, 4" Equivalent Length, 40-mil min.	Linear Feet	0
907-626-Z002	Thermplastic Legend, White, 4" Equivalent Length, 40-mil min.	Square Feet	0
907-626-U004	6" Thermoplastic Traffic Stripe, Skip White, 40-mil min.	Mile	20.000
907-626-V004	6" Thermoplastic Traffic Stripe, Continuous White, 40-mil min.	Mile	22.755
907-626-W004	6" Thermoplastic Traffic Stripe, Skip Yellow, 40-mil min.	Mile	0.000
907-626-X004	6" Thermoplastic Traffic Stripe, Continuous Yellow, 40-mil min.	Mile	23.318
907-626-Y002	Thermoplastic Detail Stripe, White, 6" Equivalent Length, 40-mil min.	Linear Feet	39,600
907-626-Y004	Thermoplastic Detail Stripe, Yellow, 6" Equivalent Length, 40-mil min.	Linear Feet	9,637
907-626-Z003	Thermplastic Legend, White, 6" Equivalent Length, 40-mil min.	Linear Feet	204
907-626-Z004	Thermplastic Legend, White, 6" Equivalent Length, 40-mil min.	Square Feet	77
907-628-I001	4" High Performance Cold Plastic Traffic Stripe, Skip White	Linear Feet	0
907-628-J001	4" High Performance Cold Plastic Traffic Stripe, Continuous White	Linear Feet	0
907-628-L001	4" High Performance Cold Plastic Traffic Stripe, Skip Yellow	Linear Feet	0
907-628-M001	4" High Performance Cold Plastic Traffic Stripe, Continuous Yellow	Linear Feet	0
628-P001	High Performance Cold Plastic Traffic Stripe, Legend, White	Square Feet	0
628-I002	6" High Performance Cold Plastic Traffic Stripe, Skip White	Linear Feet	0
628-J002	6" High Performance Cold Plastic Traffic Stripe, Continuous White	Linear Feet	0
628-L002	6" High Performance Cold Plastic Traffic Stripe, Skip Yellow	Linear Feet	0
628-M002	6" High Performance Cold Plastic Traffic Stripe, Continuous Yellow	Linear Feet	0

**STP-9999-02(248) / 106420-301000
District Wide Stripe -District 2**

Leflore County

Pay Item No.	Description	Unit	Quantity	
			SR 442	US 82
202-B076	Removal of Traffic Stripe	Linear Feet	0	0
907-625-A004	Traffic Stripe, High Build, Skip White	Mile	0.00	8.73
907-625-B004	Traffic Stripe, High Build, Skip Yellow	Mile	0.00	0.00
907-625-C004	Traffic Stripe, High Build, Continuous White	Mile	0.00	7.99
907-625-D004	Traffic Stripe, High Build, Continuous Yellow	Mile	0.00	8.18
907-625-E003	Detail Traffic Stripe, High Build	Linear Feet	0	12,141
907-625-F005	Legend, High Build	Square Feet	0	351
907-625-F006	Legend, High Build	Linear Feet	0	2,120
907-626-U002	4" Thermoplastic Traffic Stripe, Skip White, 40-mil min.	Mile	0.00	0.00
907-626-V002	4" Thermoplastic Traffic Stripe, Continuous White, 40-mil min.	Mile	18.16	0.00
907-626-W002	4" Thermoplastic Traffic Stripe, Skip Yellow, 40-mil min.	Mile	9.15	0.00
907-626-X002	4" Thermoplastic Traffic Stripe, Continuous Yellow, 40-mil min.	Mile	0.23	0.00
907-626-Y001	Thermoplastic Detail Stripe, White, 4" Equivalent Length, 40-mil min.	Linear Feet	200	0
907-626-Y003	Thermoplastic Detail Stripe, Yellow, 4" Equivalent Length, 40-mil min.	Linear Feet	0	0
907-626-Z001	Thermplastic Legend, White, 4" Equivalent Length, 40-mil min.	Linear Feet	440	0
907-626-Z002	Thermplastic Legend, White, 4" Equivalent Length, 40-mil min.	Square Feet	0	0
907-626-U004	6" Thermoplastic Traffic Stripe, Skip White, 40-mil min.	Mile	0.00	0.00
907-626-V004	6" Thermoplastic Traffic Stripe, Continuous White, 40-mil min.	Mile	0.00	0.00
907-626-W004	6" Thermoplastic Traffic Stripe, Skip Yellow, 40-mil min.	Mile	0.00	0.00
907-626-X004	6" Thermoplastic Traffic Stripe, Continuous Yellow, 40-mil min.	Mile	0.00	0.00
907-626-Y002	Thermoplastic Detail Stripe, White, 6" Equivalent Length, 40-mil min.	Linear Feet	0	0
907-626-Y004	Thermoplastic Detail Stripe, Yellow, 6" Equivalent Length, 40-mil min.	Linear Feet	0	0
907-626-Z003	Thermplastic Legend, White, 6" Equivalent Length, 40-mil min.	Linear Feet	0	0
907-626-Z004	Thermplastic Legend, White, 6" Equivalent Length, 40-mil min.	Square Feet	0	0
907-628-I001	4" High Performance Cold Plastic Traffic Stripe, Skip White	Linear Feet	0	0
907-628-J001	4" High Performance Cold Plastic Traffic Stripe, Continuous White	Linear Feet	0	0
907-628-L001	4" High Performance Cold Plastic Traffic Stripe, Skip Yellow	Linear Feet	0	0
907-628-M001	4" High Performance Cold Plastic Traffic Stripe, Continuous Yellow	Linear Feet	0	0
628-P001	High Performance Cold Plastic Traffic Stripe, Legend, White	Square Feet	0	0
628-I002	6" High Performance Cold Plastic Traffic Stripe, Skip White	Linear Feet	0	0
628-J002	6" High Performance Cold Plastic Traffic Stripe, Continuous White	Linear Feet	0	0
628-L002	6" High Performance Cold Plastic Traffic Stripe, Skip Yellow	Linear Feet	0	0
628-M002	6" High Performance Cold Plastic Traffic Stripe, Continuous Yellow	Linear Feet	0	0

**STP-9999-02(248) / 106420-301000
District Wide Stripe -District 2**

Grenada County

Pay Item No.	Description	Unit	Quantity		
			SR 35	SR 8	US 51
202-B076	Removal of Traffic Stripe	Linear Feet	846	2,044	1,124
907-625-A004	Traffic Stripe, High Build, Skip White	Mile	0.00	0.00	0.00
907-625-B004	Traffic Stripe, High Build, Skip Yellow	Mile	0.00	0.00	0.00
907-625-C004	Traffic Stripe, High Build, Continuous White	Mile	0.00	0.00	0.00
907-625-D004	Traffic Stripe, High Build, Continuous Yellow	Mile	0.00	0.00	0.00
907-625-E003	Detail Traffic Stripe, High Build	Linear Feet	0	0	0
907-625-F005	Legend, High Build	Square Feet	0	0	0
907-625-F006	Legend, High Build	Linear Feet	0	0	0
907-626-U002	4" Thermoplastic Traffic Stripe, Skip White, 40-mil min.	Mile	0.00	0.00	7.34
907-626-V002	4" Thermoplastic Traffic Stripe, Continuous White, 40-mil min.	Mile	0.00	0.00	7.89
907-626-W002	4" Thermoplastic Traffic Stripe, Skip Yellow, 40-mil min.	Mile	0.00	0.00	5.59
907-626-X002	4" Thermoplastic Traffic Stripe, Continuous Yellow, 40-mil min.	Mile	0.00	0.00	6.97
907-626-Y001	Thermoplastic Detail Stripe, White, 4" Equivalent Length, 40-mil min.	Linear Feet	0	0	9,428
907-626-Y003	Thermoplastic Detail Stripe, Yellow, 4" Equivalent Length, 40-mil min.	Linear Feet	0	0	6,199
907-626-Z001	Thermplastic Legend, White, 4" Equivalent Length, 40-mil min.	Linear Feet	0	0	2,699
907-626-Z002	Thermplastic Legend, White, 4" Equivalent Length, 40-mil min.	Square Feet	0	0	2,686
907-626-U004	6" Thermoplastic Traffic Stripe, Skip White, 40-mil min.	Mile	0.00	0.00	0.00
907-626-V004	6" Thermoplastic Traffic Stripe, Continuous White, 40-mil min.	Mile	13.16	7.50	7.97
907-626-W004	6" Thermoplastic Traffic Stripe, Skip Yellow, 40-mil min.	Mile	6.14	3.44	3.24
907-626-X004	6" Thermoplastic Traffic Stripe, Continuous Yellow, 40-mil min.	Mile	3.83	1.73	0.32
907-626-Y002	Thermoplastic Detail Stripe, White, 6" Equivalent Length, 40-mil min.	Linear Feet	1,222	0	4,523
907-626-Y004	Thermoplastic Detail Stripe, Yellow, 6" Equivalent Length, 40-mil min.	Linear Feet	1,940	484	12,622
907-626-Z003	Thermplastic Legend, White, 6" Equivalent Length, 40-mil min.	Linear Feet	1,410	595	957
907-626-Z004	Thermplastic Legend, White, 6" Equivalent Length, 40-mil min.	Square Feet	0	0	362
907-628-I001	4" High Performance Cold Plastic Traffic Stripe, Skip White	Linear Feet	0	0	281
907-628-J001	4" High Performance Cold Plastic Traffic Stripe, Continuous White	Linear Feet	0	0	281
907-628-L001	4" High Performance Cold Plastic Traffic Stripe, Skip Yellow	Linear Feet	0	0	281
907-628-M001	4" High Performance Cold Plastic Traffic Stripe, Continuous Yellow	Linear Feet	0	0	281
628-P001	High Performance Cold Plastic Traffic Stripe, Legend, White	Square Feet	0	0	32.8
628-I002	6" High Performance Cold Plastic Traffic Stripe, Skip White	Linear Feet	0	0	0
628-J002	6" High Performance Cold Plastic Traffic Stripe, Continuous White	Linear Feet	564	1022	0
628-L002	6" High Performance Cold Plastic Traffic Stripe, Skip Yellow	Linear Feet	282	0	0
628-M002	6" High Performance Cold Plastic Traffic Stripe, Continuous Yellow	Linear Feet	0	1022	0

STP-9999-02(248) / 106420-301000
District Wide Stripe -District 2

**Marshall
County**

Pay Item No.	Description	Unit	Quantity
			SR 311
202-B076	Removal of Traffic Stripe	Linear Feet	0
907-625-A004	Traffic Stripe, High Build, Skip White	Mile	0.00
907-625-B004	Traffic Stripe, High Build, Skip Yellow	Mile	0.00
907-625-C004	Traffic Stripe, High Build, Continuous White	Mile	0.00
907-625-D004	Traffic Stripe, High Build, Continuous Yellow	Mile	0.00
907-625-E003	Detail Traffic Stripe, High Build	Linear Feet	0
907-625-F005	Legend, High Build	Square Feet	0
907-625-F006	Legend, High Build	Linear Feet	0
907-626-U002	4" Thermoplastic Traffic Stripe, Skip White, 40-mil min.	Mile	0.00
907-626-V002	4" Thermoplastic Traffic Stripe, Continuous White, 40-mil min.	Mile	0.00
907-626-W002	4" Thermoplastic Traffic Stripe, Skip Yellow, 40-mil min.	Mile	0.00
907-626-X002	4" Thermoplastic Traffic Stripe, Continuous Yellow, 40-mil min.	Mile	0.00
907-626-Y001	Thermoplastic Detail Stripe, White, 4" Equivalent Length, 40-mil min.	Linear Feet	0
907-626-Y003	Thermoplastic Detail Stripe, Yellow, 4" Equivalent Length, 40-mil min.	Linear Feet	0
907-626-Z001	Thermplastic Legend, White, 4" Equivalent Length, 40-mil min.	Linear Feet	0
907-626-Z002	Thermplastic Legend, White, 4" Equivalent Length, 40-mil min.	Square Feet	0
907-626-U004	6" Thermoplastic Traffic Stripe, Skip White, 40-mil min.	Mile	0.00
907-626-V004	6" Thermoplastic Traffic Stripe, Continuous White, 40-mil min.	Mile	24.09
907-626-W004	6" Thermoplastic Traffic Stripe, Skip Yellow, 40-mil min.	Mile	9.58
907-626-X004	6" Thermoplastic Traffic Stripe, Continuous Yellow, 40-mil min.	Mile	9.49
907-626-Y002	Thermoplastic Detail Stripe, White, 6" Equivalent Length, 40-mil min.	Linear Feet	2,350
907-626-Y004	Thermoplastic Detail Stripe, Yellow, 6" Equivalent Length, 40-mil min.	Linear Feet	3,470
907-626-Z003	Thermplastic Legend, White, 6" Equivalent Length, 40-mil min.	Linear Feet	1,280
907-626-Z004	Thermplastic Legend, White, 6" Equivalent Length, 40-mil min.	Square Feet	93
907-628-I001	4" High Performance Cold Plastic Traffic Stripe, Skip White	Linear Feet	0
907-628-J001	4" High Performance Cold Plastic Traffic Stripe, Continuous White	Linear Feet	0
907-628-L001	4" High Performance Cold Plastic Traffic Stripe, Skip Yellow	Linear Feet	0
907-628-M001	4" High Performance Cold Plastic Traffic Stripe, Continuous Yellow	Linear Feet	0
628-P001	High Performance Cold Plastic Traffic Stripe, Legend, White	Square Feet	0
628-I002	6" High Performance Cold Plastic Traffic Stripe, Skip White	Linear Feet	0
628-J002	6" High Performance Cold Plastic Traffic Stripe, Continuous White	Linear Feet	0
628-L002	6" High Performance Cold Plastic Traffic Stripe, Skip Yellow	Linear Feet	0
628-M002	6" High Performance Cold Plastic Traffic Stripe, Continuous Yellow	Linear Feet	0

STP-9999-02(248) / 106420-301000
District Wide Stripe -District 2

**Coahoma
County**

Pay Item No.	Description	Unit	Quantity
			US 49
202-B076	Removal of Traffic Stripe	Linear Feet	0
907-625-A004	Traffic Stripe, High Build, Skip White	Mile	0.00
907-625-B004	Traffic Stripe, High Build, Skip Yellow	Mile	8.14
907-625-C004	Traffic Stripe, High Build, Continuous White	Mile	16.23
907-625-D004	Traffic Stripe, High Build, Continuous Yellow	Mile	1.39
907-625-E003	Detail Traffic Stripe, High Build	Linear Feet	1,099
907-625-F005	Legend, High Build	Square Feet	192
907-625-F006	Legend, High Build	Linear Feet	288
907-626-U002	4" Thermoplastic Traffic Stripe, Skip White, 40-mil min.	Mile	0.00
907-626-V002	4" Thermoplastic Traffic Stripe, Continuous White, 40-mil min.	Mile	0.00
907-626-W002	4" Thermoplastic Traffic Stripe, Skip Yellow, 40-mil min.	Mile	0.00
907-626-X002	4" Thermoplastic Traffic Stripe, Continuous Yellow, 40-mil min.	Mile	0.00
907-626-Y001	Thermoplastic Detail Stripe, White, 4" Equivalent Length, 40-mil min.	Linear Feet	0
907-626-Y003	Thermoplastic Detail Stripe, Yellow, 4" Equivalent Length, 40-mil min.	Linear Feet	0
907-626-Z001	Thermoplastic Legend, White, 4" Equivalent Length, 40-mil min.	Linear Feet	0
907-626-Z002	Thermoplastic Legend, White, 4" Equivalent Length, 40-mil min.	Square Feet	0
907-626-U004	6" Thermoplastic Traffic Stripe, Skip White, 40-mil min.	Mile	0.00
907-626-V004	6" Thermoplastic Traffic Stripe, Continuous White, 40-mil min.	Mile	0.00
907-626-W004	6" Thermoplastic Traffic Stripe, Skip Yellow, 40-mil min.	Mile	0.00
907-626-X004	6" Thermoplastic Traffic Stripe, Continuous Yellow, 40-mil min.	Mile	0.00
907-626-Y002	Thermoplastic Detail Stripe, White, 6" Equivalent Length, 40-mil min.	Linear Feet	0
907-626-Y004	Thermoplastic Detail Stripe, Yellow, 6" Equivalent Length, 40-mil min.	Linear Feet	0
907-626-Z003	Thermoplastic Legend, White, 6" Equivalent Length, 40-mil min.	Linear Feet	0
907-626-Z004	Thermoplastic Legend, White, 6" Equivalent Length, 40-mil min.	Square Feet	0
907-628-I001	4" High Performance Cold Plastic Traffic Stripe, Skip White	Linear Feet	0
907-628-J001	4" High Performance Cold Plastic Traffic Stripe, Continuous White	Linear Feet	0
907-628-L001	4" High Performance Cold Plastic Traffic Stripe, Skip Yellow	Linear Feet	0
907-628-M001	4" High Performance Cold Plastic Traffic Stripe, Continuous Yellow	Linear Feet	0
628-P001	High Performance Cold Plastic Traffic Stripe, Legend, White	Square Feet	0
628-I002	6" High Performance Cold Plastic Traffic Stripe, Skip White	Linear Feet	0
628-J002	6" High Performance Cold Plastic Traffic Stripe, Continuous White	Linear Feet	0
628-L002	6" High Performance Cold Plastic Traffic Stripe, Skip Yellow	Linear Feet	0
628-M002	6" High Performance Cold Plastic Traffic Stripe, Continuous Yellow	Linear Feet	0

STP-9999-02(248) / 106420-301000
District Wide Stripe -District 2

Yalobusha
County

Pay Item No.	Description	Unit	Quantity
			SR 7
202-B076	Removal of Traffic Stripe	Linear Feet	0
907-625-A004	Traffic Stripe, High Build, Skip White	Mile	9.69
907-625-B004	Traffic Stripe, High Build, Skip Yellow	Mile	0.60
907-625-C004	Traffic Stripe, High Build, Continuous White	Mile	6.99
907-625-D004	Traffic Stripe, High Build, Continuous Yellow	Mile	7.51
907-625-E003	Detail Traffic Stripe, High Build	Linear Feet	58,097
907-625-F005	Legend, High Build	Square Feet	0
907-625-F006	Legend, High Build	Linear Feet	1,376
907-626-U002	4" Thermoplastic Traffic Stripe, Skip White, 40-mil min.	Mile	0.00
907-626-V002	4" Thermoplastic Traffic Stripe, Continuous White, 40-mil min.	Mile	0.00
907-626-W002	4" Thermoplastic Traffic Stripe, Skip Yellow, 40-mil min.	Mile	0.00
907-626-X002	4" Thermoplastic Traffic Stripe, Continuous Yellow, 40-mil min.	Mile	0.00
907-626-Y001	Thermoplastic Detail Stripe, White, 4" Equivalent Length, 40-mil min.	Linear Feet	0
907-626-Y003	Thermoplastic Detail Stripe, Yellow, 4" Equivalent Length, 40-mil min.	Linear Feet	0
907-626-Z001	Thermoplastic Legend, White, 4" Equivalent Length, 40-mil min.	Linear Feet	0
907-626-Z002	Thermoplastic Legend, White, 4" Equivalent Length, 40-mil min.	Square Feet	0
907-626-U004	6" Thermoplastic Traffic Stripe, Skip White, 40-mil min.	Mile	0.00
907-626-V004	6" Thermoplastic Traffic Stripe, Continuous White, 40-mil min.	Mile	0.00
907-626-W004	6" Thermoplastic Traffic Stripe, Skip Yellow, 40-mil min.	Mile	0.00
907-626-X004	6" Thermoplastic Traffic Stripe, Continuous Yellow, 40-mil min.	Mile	0.00
907-626-Y002	Thermoplastic Detail Stripe, White, 6" Equivalent Length, 40-mil min.	Linear Feet	0
907-626-Y004	Thermoplastic Detail Stripe, Yellow, 6" Equivalent Length, 40-mil min.	Linear Feet	0
907-626-Z003	Thermoplastic Legend, White, 6" Equivalent Length, 40-mil min.	Linear Feet	0
907-626-Z004	Thermoplastic Legend, White, 6" Equivalent Length, 40-mil min.	Square Feet	0
907-628-I001	4" High Performance Cold Plastic Traffic Stripe, Skip White	Linear Feet	0
907-628-J001	4" High Performance Cold Plastic Traffic Stripe, Continuous White	Linear Feet	0
907-628-L001	4" High Performance Cold Plastic Traffic Stripe, Skip Yellow	Linear Feet	0
907-628-M001	4" High Performance Cold Plastic Traffic Stripe, Continuous Yellow	Linear Feet	0
628-P001	High Performance Cold Plastic Traffic Stripe, Legend, White	Square Feet	0
628-I002	6" High Performance Cold Plastic Traffic Stripe, Skip White	Linear Feet	0
628-J002	6" High Performance Cold Plastic Traffic Stripe, Continuous White	Linear Feet	0
628-L002	6" High Performance Cold Plastic Traffic Stripe, Skip Yellow	Linear Feet	0
628-M002	6" High Performance Cold Plastic Traffic Stripe, Continuous Yellow	Linear Feet	0

**STP-9999-02(248) / 106420-301000
District Wide Stripe -District 2**

Benton County

Pay Item No.	Description	Unit	Quantity
			US 72
202-B076	Removal of Traffic Stripe	Linear Feet	0
907-625-A004	Traffic Stripe, High Build, Skip White	Mile	0.00
907-625-B004	Traffic Stripe, High Build, Skip Yellow	Mile	0.00
907-625-C004	Traffic Stripe, High Build, Continuous White	Mile	0.00
907-625-D004	Traffic Stripe, High Build, Continuous Yellow	Mile	0.00
907-625-E003	Detail Traffic Stripe, High Build	Linear Feet	0
907-625-F005	Legend, High Build	Square Feet	0
907-625-F006	Legend, High Build	Linear Feet	0
907-626-U002	4" Thermoplastic Traffic Stripe, Skip White, 40-mil min.	Mile	0.00
907-626-V002	4" Thermoplastic Traffic Stripe, Continuous White, 40-mil min.	Mile	0.00
907-626-W002	4" Thermoplastic Traffic Stripe, Skip Yellow, 40-mil min.	Mile	0.00
907-626-X002	4" Thermoplastic Traffic Stripe, Continuous Yellow, 40-mil min.	Mile	0.00
907-626-Y001	Thermoplastic Detail Stripe, White, 4" Equivalent Length, 40-mil min.	Linear Feet	0
907-626-Y003	Thermoplastic Detail Stripe, Yellow, 4" Equivalent Length, 40-mil min.	Linear Feet	0
907-626-Z001	Thermoplastic Legend, White, 4" Equivalent Length, 40-mil min.	Linear Feet	0
907-626-Z002	Thermoplastic Legend, White, 4" Equivalent Length, 40-mil min.	Square Feet	0
907-626-U004	6" Thermoplastic Traffic Stripe, Skip White, 40-mil min.	Mile	38.96
907-626-V004	6" Thermoplastic Traffic Stripe, Continuous White, 40-mil min.	Mile	44.34
907-626-W004	6" Thermoplastic Traffic Stripe, Skip Yellow, 40-mil min.	Mile	0.24
907-626-X004	6" Thermoplastic Traffic Stripe, Continuous Yellow, 40-mil min.	Mile	40.28
907-626-Y002	Thermoplastic Detail Stripe, White, 6" Equivalent Length, 40-mil min.	Linear Feet	37,601
907-626-Y004	Thermoplastic Detail Stripe, Yellow, 6" Equivalent Length, 40-mil min.	Linear Feet	34,976
907-626-Z003	Thermoplastic Legend, White, 6" Equivalent Length, 40-mil min.	Linear Feet	12,421
907-626-Z004	Thermoplastic Legend, White, 6" Equivalent Length, 40-mil min.	Square Feet	250
907-628-I001	4" High Performance Cold Plastic Traffic Stripe, Skip White	Linear Feet	0
907-628-J001	4" High Performance Cold Plastic Traffic Stripe, Continuous White	Linear Feet	0
907-628-L001	4" High Performance Cold Plastic Traffic Stripe, Skip Yellow	Linear Feet	0
907-628-M001	4" High Performance Cold Plastic Traffic Stripe, Continuous Yellow	Linear Feet	0
628-P001	High Performance Cold Plastic Traffic Stripe, Legend, White	Square Feet	0
628-I002	6" High Performance Cold Plastic Traffic Stripe, Skip White	Linear Feet	0
628-J002	6" High Performance Cold Plastic Traffic Stripe, Continuous White	Linear Feet	0
628-L002	6" High Performance Cold Plastic Traffic Stripe, Skip Yellow	Linear Feet	0
628-M002	6" High Performance Cold Plastic Traffic Stripe, Continuous Yellow	Linear Feet	0

**STP-9999-02(248) / 106420-301000
District Wide Stripe -District 2**

Project Total

Pay Item No.	Description	Unit	
202-B076	Removal of Traffic Stripe	Linear Feet	9,011
907-625-A004	Traffic Stripe, High Build, Skip White	Mile	18.42
907-625-B004	Traffic Stripe, High Build, Skip Yellow	Mile	8.74
907-625-C004	Traffic Stripe, High Build, Continuous White	Mile	31.21
907-625-D004	Traffic Stripe, High Build, Continuous Yellow	Mile	17.08
907-625-E003	Detail Traffic Stripe, High Build	Linear Feet	71,337
907-625-F005	Legend, High Build	Square Feet	542
907-625-F006	Legend, High Build	Linear Feet	3,784
907-626-U002	4" Thermoplastic Traffic Stripe, Skip White, 40-mil min.	Mile	8.03
907-626-V002	4" Thermoplastic Traffic Stripe, Continuous White, 40-mil min.	Mile	42.82
907-626-W002	4" Thermoplastic Traffic Stripe, Skip Yellow, 40-mil min.	Mile	31.23
907-626-X002	4" Thermoplastic Traffic Stripe, Continuous Yellow, 40-mil min.	Mile	22.86
907-626-Y001	Thermoplastic Detail Stripe, White, 4" Equivalent Length, 40-mil min.	Linear Feet	13,471
907-626-Y003	Thermoplastic Detail Stripe, Yellow, 4" Equivalent Length, 40-mil min.	Linear Feet	11,501
907-626-Z001	Thermplastic Legend, White, 4" Equivalent Length, 40-mil min.	Linear Feet	5,009
907-626-Z002	Thermplastic Legend, White, 4" Equivalent Length, 40-mil min.	Square Feet	2,853
907-626-U004	6" Thermoplastic Traffic Stripe, Skip White, 40-mil min.	Mile	58.96
907-626-V004	6" Thermoplastic Traffic Stripe, Continuous White, 40-mil min.	Mile	156.20
907-626-W004	6" Thermoplastic Traffic Stripe, Skip Yellow, 40-mil min.	Mile	36.65
907-626-X004	6" Thermoplastic Traffic Stripe, Continuous Yellow, 40-mil min.	Mile	99.21
907-626-Y002	Thermoplastic Detail Stripe, White, 6" Equivalent Length, 40-mil min.	Linear Feet	87,772
907-626-Y004	Thermoplastic Detail Stripe, Yellow, 6" Equivalent Length, 40-mil min.	Linear Feet	71,329
907-626-Z003	Thermplastic Legend, White, 6" Equivalent Length, 40-mil min.	Linear Feet	20,532
907-626-Z004	Thermplastic Legend, White, 6" Equivalent Length, 40-mil min.	Square Feet	924
907-628-I001	4" High Performance Cold Plastic Traffic Stripe, Skip White	Linear Feet	281
907-628-J001	4" High Performance Cold Plastic Traffic Stripe, Continuous White	Linear Feet	406
907-628-L001	4" High Performance Cold Plastic Traffic Stripe, Skip Yellow	Linear Feet	281
907-628-M001	4" High Performance Cold Plastic Traffic Stripe, Continuous Yellow	Linear Feet	281
628-P001	High Performance Cold Plastic Traffic Stripe, Legend, White	Square Feet	33
628-I002	6" High Performance Cold Plastic Traffic Stripe, Skip White	Linear Feet	0
628-J002	6" High Performance Cold Plastic Traffic Stripe, Continuous White	Linear Feet	4,022
628-L002	6" High Performance Cold Plastic Traffic Stripe, Skip Yellow	Linear Feet	1,500
628-M002	6" High Performance Cold Plastic Traffic Stripe, Continuous Yellow	Linear Feet	2,240

MISSISSIPPI DEPARTMENT OF TRANSPORTATION

SPECIAL PROVISION NO. 907-625-4

CODE: (SP)

DATE: 02/02/2010

SUBJECT: High Build Painted Traffic Markings

Section 625, Painted Traffic Markings, of the 2004 Edition of the Mississippi Standard Specifications for Road and Bridge Construction as amended by this special provision is applicable to High Build Painted Traffic Markings only.

SECTION 907-625 - HIGH BUILD PAINTED TRAFFIC MARKINGS

907-625-01--Description. This work consists of furnishing and applying reflective white or yellow paint for high build pavement striping in accordance with plan details, the MUTCD and these specifications.

907-625.02--Materials. The high build traffic paint shall be quick dry water-borne traffic paint to be applied on asphalt or Portland cement concrete pavements. The paint must perform properly when preheated to 110° to 130°F and accept glass beads so that the spheres are imbedded to a depth of 50 percent of their diameter.

All paint materials, including vehicle, pigment, paste, driers, thinners, and mixed paint shall conform to the requirements of these specifications unless otherwise stipulated. Paint shall be furnished ready-mixed or in paste or powder form, as may be specified, and shall be of the type and color shown on the plans or as otherwise indicated. All paints for incorporation in the work shall be manufactured in the United States. Any paint that has caked, hardened or otherwise deteriorated shall not be used.

907-625.02.1--Sampling and Testing. Sampling and testing of paint shall be in accordance with the appropriate method in Federal Test Method No. 141, ASTM and/or Mississippi Test Method.

Sampling at the option of the Department will be performed at the point of manufacture or at a designated point of delivery. When the paint is sampled at the point of manufacture, the Department representative shall be given full access to the manufacturing process.

The Central Laboratory may utilize x-ray analysis, gas chromatography, infrared, or ultra violet spectral analysis of the paint or its components to determine whether specified ingredients were used. Paint found not to be in compliance with the approved formula shall not be used.

A sample may be taken by MDOT at random from the initial shipment of each batch received by the Contractor and forwarded to the Central Testing Laboratory and tested for compliance with all requirements of this specification. If the test results fail, another sample will be taken from the same batch number and re-tested. Unacceptable test results shall be cause to reject the entire batch of traffic paint.

907-625.02.2--Containers and Marking. Paint shall be shipped in sturdy leak proof containers. The size of the containers shall be at the option of the Contractor unless specified otherwise in the contract.

Each container or label thereon shall be marked as follows:

- Net weight in pounds
- Net volume in U. S. gallons
- Color
- Code number
- Batch number
- Name and percentage of each component
- Name and address of manufacturer
- Date of manufacture

In addition, each container and labeling thereon shall meet the requirements of State and Federal Regulations for transporting the paint.

907-625.02.3--High Build Water Borne Traffic Paint. This material shall be a rapid setting waterborne compound suitable for use with hot application equipment and applied at the rate of 37.5 gallons per mile to produce a 6-inch solid line thickness of 22 wet mils. The material shall meet the requirements Specification Adherence of Table 1. The paint shall contain Rohm & Haas Rhoplex Fastrack HD-21A emulsion with 48.5 - 49.5 percent solids content or Dow DT 400NA acrylic emulsion with 49.5 - 51.5 percent solids content or approved equal. White paint shall contain a minimum of 1.0 pound per gallon of titanium dioxide conforming to ASTM D 476 and the yellow paint shall be Hansa Yellow (11-2400). The paint shall be tested by analytical infrared (IR) spectroscopy.

**Table 1
Water Borne Traffic Paint Physical Properties**

Property	Requirements		Test Method
	Min	Max	
PH	9.9		ASTM E 70
Viscosity, at 25°C Krebs Unit	78	95	ASTM D 562
Drying Time Minutes	--	10	ASTM D 711
Total Solids,%	73	79	ASTM D 2369
Weight Per Gallon, Lb./Gal			ASTM D 1475
White	13.7		
Yellow	13.1		
Daylight Reflectance, %			ASTM E 1349
White	Not less than 85%, relative to magnesium oxide	--	Federal Test Method No. 141
Yellow	Not less than 54%, relative to magnesium oxide	--	Federal Test Method No. 141
Color	Pass		ASTM D 6628
Pigment Composition	Pass		3
IR	Pass		4

* No theoretical empirical factor shall be applied in determining the pigment percent of the paint. Percent pigment will not be calculated by adding back the burned off organic constituents of the pigment.

Color -- Yellow shall conform to requirements of the Table 2 listed below when tested in accordance with ASTM E 1349.

**Table 2
Water Borne Traffic Paint Color Specification Limits (Daytime)**

Color	1		2		3		4	
	x	y	x	y	x	y	x	y
Yellow	0.493	0.473	0.518	0.464	0.486	0.428	0.469	0.452

The four pairs of chromaticity coordinates determine the acceptable color in terms of the CIE 1931 Standard Colorimetric System measured with Standard Illuminant D65.

907-625.02.3--Glass Beads. Glass beads shall meet the requirements of Subsection 720.01 for Class 'B' High Visibility beads and applied at a rate of 450 pound per mile of 6-inch wide solid stripe.

907-625.03--Construction Requirements.

907-625.03.1--Equipment. Selection of proper equipment to produce satisfactory results within the following requirements shall be the responsibility of the Contractor.

- a) Equipment shall permit traffic to pass safely within the limits of the roadway surface and shoulder while operating.
- b) Equipment shall be designed for placement of both solid and skip line stripes of the spacing shown on the plans with square, neat stripe ends.
- c) Equipment shall provide a method for cleaning the surface of dust immediately prior to placement of striping materials.
- d) Equipment shall provide a gravity bead dispenser for drop-on application of glass beads.
- e) The equipment shall provide accurate regulation of the application rate and shall have a tachometer or other approved device to ensure uniform paint application at the designated rate. The equipment shall be adjustable for applying one, two or three adjacent lines simultaneously at the specified spacing and be equipped with a device capable of following a control line. Operation of the unit shall be such that paint will not be spattered or blown on another stripe. The unit shall be designed to properly agitate the paint while in operation.
- f) The equipment may be equipped with a heat exchanger to heat the paint to reduce drying time.
- g) The operation shall include a trailing vehicle equipped with a flashing arrow board.

907-625.03.2--Surface Preparation. All areas to be painted shall be thoroughly cleaned. Cleaning may be done by hand brooms, rotary brooms, air blast, scrapers, or whatever combination of equipment is necessary to clean the pavement thoroughly without damage to the surface. Before edge striping, particular care shall be taken to remove all vegetation, loose soil, and the like from the area to be painted. Should other methods fail, the surface shall be wetted with a water jet and scrubbed as necessary to dislodge all foreign material. After washing, the surface shall be allowed to dry thoroughly, and all films of dried mud apparent after surface drying shall be removed before application of paint. Painting shall follow as closely as practicable after the surface has been cleaned and dried, but no paint shall be applied until the surface has been inspected and permission given to proceed. The cost for preparing the surface shall be included in the unit prices for the marking items.

Upon request, the Engineer will establish control points for markings, by type and color, at necessary intervals not to exceed 600 feet. The Contractor shall preserve and apply markings in conformity with control points established.

907-625.03.3--Weather Limitations. No paint striping shall be done when the pavement surface is not thoroughly dried, when the air is foggy or misty, when the air or surface temperature is below 50°F, or when wind or other condition causes a film of dust to be deposited on the surface after cleaning and before striping can be done or causes displacement of striping material.

907-625.03.4--Application. The longitudinal joint or existing centerline stripe shall be used in determining the location of the centerline of new striping. In the absence of a longitudinal joint or existing stripe, the location of the centerline of new striping shall be located by the Contractor with the approval of the Engineer. Skip line individual intervals will not be marked. No striping material shall be applied over a guide string line.

Paint Preparation. Immediately before application, paints shall be agitated and mixed thoroughly to a uniform consistency, free from lumps or agglomerates. Paints shall be kept covered to retain volatiles. Paints shall not be thinned without approval.

Application Rate. Paint shall be applied at the rate of 37.5 gallons per mile to produce a 6-inch solid line at a thickness of 22 wet mils. Glass beads shall be applied according to Subsection 907-625.02.3.

Paint may be heated in heat exchangers to accelerate drying to a temperature between 110° and 130°F for water borne paint.

907-625.03.5--Tolerances. The length and width of lines shall be within a tolerance of plus or minus three inches and plus or minus 1/8 inch, respectively. For skip markings, the tolerance for intervals shall not exceed the line length tolerance.

Markings applied at less than minimum material rates, deviating from true alignment by more than one inch in 50 feet, exceeding stipulated length and width tolerances, and showing light spots, faulty distribution of beads, smears, or other deficiencies or irregularities shall be removed and replaced. Removal methods shall be in accordance with Subsection 619.03.2.

907-625.03.6--Protection. The newly painted markings shall be protected so that, insofar as possible, paint will not be picked up by the tires of passing vehicles. Warning signs shall be placed at the beginning of a wet line and at points well in advance of the marking equipment. For the benefit of the Contractor, small flags or other similarly effective small objects may be placed near freshly applied lines at frequent intervals to reduce crossings by traffic. Damaged portions of stripes shall be effaced and replaced by the Contractor at no additional cost to the State.

Operations shall be conducted so that traffic can move without undue hindrance. When public traffic is being maintained, warning signs at the starting end shall be moved forward as sections of stripe dry sufficiently to prevent pick-up under traffic.

907-625.04--Method of Measurement. High build painted traffic markings completed in accordance with the plans and specifications will be measured by the mile or by the linear foot,

as indicated, from end-to-end of individual stripes. In the case of skip lines the measurement will include skips. The length used to measure centerline, lane lines and edge stripes will be the horizontal length computed along the stationed control line.

Detail traffic stripe will be measured by the linear foot from end-to-end of individual stripes. Measurement will be made along the surface of each stripe and will exclude nominal skip intervals where specified. Stripes more than six inches in width will be converted to equivalent lengths of six-inch stripe.

Legend will be measured as provided for legend in Subsection 626.04.

907-625.05--Basis of Payment. High build painted traffic markings will be paid for at the contract unit price per mile, linear foot, or square foot as applicable, which shall be full compensation for preparation of the surface, furnishing and applying all materials, protection of wet paint; and for furnishing all labor, tools, equipment and incidentals necessary to complete the work.

The prices thus paid shall be full compensation for completing the work.

Payment will be made under:

- 907-625-A: Traffic Stripe, High Build, Skip White - per linear foot or mile
- 907-625-B: Traffic Stripe, High Build, Skip Yellow - per linear foot or mile
- 907-625-C: Traffic Stripe, High Build, Continuous White - per linear foot or mile
- 907-625-D: Traffic Stripe, High Build, Continuous Yellow - per linear foot or mile
- 907-625-E: Detail Traffic Stripe, High Build - per linear foot
- 907-625-F: Legend, High Build - per square foot or linear foot

Stripe replacement on various routes, known as Federal Aid Project No. STP-9999-02(248) / 106420301 in District 2.

I (We) agree to complete the entire project within the specified contract time.

*** SPECIAL NOTICE TO BIDDERS ***
BIDS WILL NOT BE CONSIDERED UNLESS BOTH UNIT PRICE AND ITEM TOTALS ARE ENTERED.
BIDS WILL NOT BE CONSIDERED UNLESS THE BID CERTIFICATION LOCATED AT THE END OF THE BID SHEETS IS SIGNED

BID SCHEDULE

Line No.	Item Code	Adj Code	Quantity	Units	Description	Unit Price		Item Amount	
						Dollar	Ct	Dollar	Ct
Roadway Items									
0010	202-B076		9,011	Linear Feet	Removal of Traffic Stripe				
0020	618-A001		1	Lump Sum	Maintenance of Traffic	XXXXXXXXXX	XXX		
0030	907-625-A004 Changed 07/16/2012		18	Mile	Traffic Stripe, High Build, Skip White				
0040	907-625-B004 Changed 07/16/2012		9	Mile	Traffic Stripe, High Build, Skip Yellow				
0050	907-625-C004 Changed 07/16/2012		37	Mile	Traffic Stripe, High Build, Continuous White				
0060	907-625-D004 Changed 07/16/2012		17	Mile	Traffic Stripe, High Build, Continuous Yellow				
0070	907-625-E003 Changed 07/16/2012		71,337	Linear Feet	Detail Traffic Stripe, High Build				
0080	907-625-F005 Changed 07/16/2012		542	Square Feet	Legend, High Build				

Line No.	Item Code	Adj Code	Quantity	Units	Description	Unit Price	Bid Amount	
0090	907-625-F006		3,784	Linear Feet	Legend, High Build			
	Changed 07/16/2012							
0100	628-P001		33	Square Feet	High Performance Cold Plastic Legend, White			
0110	907-626-U002		8	Mile	4" Thermoplastic Traffic Stripe, Skip White, 40-mil min.			
0120	907-626-U004		59	Mile	6" Thermoplastic Traffic Stripe, skip, White, 40-mil min.			
0130	907-626-V002		43	Mile	4" Thermoplastic Traffic Stripe, Continuous White, 40-mil min.			
0140	907-626-V004		156	Mile	6" Thermoplastic Traffic Stripe, Continuous White, 40-mil min.			
0150	907-626-W002		31	Mile	4" Thermoplastic Traffic Stripe, Skip Yellow, 40-mil min.			
0160	907-626-W004		57	Mile	6" Thermoplastic Traffic Stripe, Skip Yellow, 40-mil min.			
0170	907-626-X002		23	Mile	4" Thermoplastic Traffic Stripe, Continuous Yellow, 40-mil min.			
0180	907-626-X004		99	Mile	6" Thermoplastic Traffic Stripe, Continuous Yellow, 40-mil min.			
0190	907-626-Y001		13,411	Linear Feet	Thermoplastic Detail Traffic Stripe, White, 4" Equivalent Length, 40-mil. min.			
0200	907-626-Y002		87,772	Linear Feet	Thermoplastic Detail Traffic Stripe, White, 6" Equivalent Length, 40-mil. min.			

Line No.	Item Code	Adj Code	Quantity	Units	Description	Unit Price	Bid Amount	
0210	907-626-Y003		11,501	Linear Feet	Thermoplastic Detail Traffic Stripe, Yellow, 6" Equivalent Length, 40-mil. min.			
0220	907-626-Y004		71,329	Linear Feet	Thermoplastic Detail Traffic Stripe, Yellow, 6" Equivalent Length, 40-mil. min.			
0230	907-626-Z001		5,009	Linear Feet	Thermoplastic Legend, White, 4" Equivalent Length, 40-mil. min.			
0240	907-626-Z002		2,853	Square Feet	Thermoplastic Legend, White, 4" Equivalent Length, 40-mil. min.			
0250	907-626-Z003		20,532	Linear Feet	Thermoplastic Legend, White, 6" Equivalent Length, 40-mil. min.			
0260	907-626-Z004		924	Square Feet	Thermoplastic Legend, White, 6" Equivalent Length, 40-mil. min.			
0270	907-628-I001		281	Linear Feet	4" High Performance Cold Plastic Traffic Stripe, Skip White			
0280	907-628-J001		4,022	Linear Feet	6" High Performance Cold Plastic Traffic Stripe, Continuous White			
0290	907-628-L001		281	Linear Feet	4" High Performance Cold Plastic Traffic Stripe, Skip Yellow			
0300	907-628-M001		281	Linear Feet	4" High Performance Cold Plastic Traffic Stripe, Continuous Yellow			
ALTERNATE GROUP AA NUMBER 1								
0310	628-J002		4,022	Linear Feet	6" High Performance Cold Plastic Traffic Stripe, Continuous White			

Line No.	Item Code	Adj Code	Quantity	Units	Description	Unit Price	Bid Amount	
0320	628-L002		1,500	Linear Feet	6" High Performance Cold Plastic Traffic Stripe, Skip Yellow			
0330	628-M002		2,240	Linear Feet	6" High Performance Cold Plastic Traffic Stripe, Continuous Yellow			
ALTERNATE GROUP A NUMBER 2								
0340	907-626-J003		4,022	Linear Feet	6" Inverted Profile Thermoplastic Traffic Stripe, Continuous White			
0350	907-626-K003		1,500	Linear Feet	6" Inverted Profile Thermoplastic Traffic Stripe, Skip Yellow			
0360	907-626-L001		2,240	Linear Feet	6" Inverted Profile Thermoplastic Traffic Stripe, Continuous Yellow			

These Bid Sheets Are Not For
 Bidding Purposes Using
 Generate Bid Sheets Bid
 Expedite Bid

*** BID CERTIFICATION ***

TOTAL BID.....\$ _____

*** DBE/WBE SECTION ***

Complete item nos. 1, 2, and/or 3 as appropriate. See Notice to Bidders addressing Disadvantaged Business Enterprises in Highway Construction.

1. I/We agree that no less than _____ percent shall be expended with small business concerns owned and controlled by socially and economically disadvantaged individuals (DBE and WBE)
2. Classification of Bidder: Small Business (DBE) _____ Small Business (WBE) _____
3. A joint venture with a Small Business (DBE/WBE): _____

*** SIGNATURE STATEMENT ***

BIDDER ACKNOWLEDGES THAT HE/SHE HAS CHECKED ALL ITEMS IN THIS PROPOSAL FOR ACCURACY AND CERTIFIED THAT THE FIGURES SHOWN THEREIN CONSTITUTE THEIR OFFICIAL BID.

BIDDER'S SIGNATURE

BIDDER'S COMPANY

BIDDER'S FEDERAL TAX ID NUMBER

These Bid Sheets Are Not For
Generate Bidding Purposes Using
Expedite Bid