

SECTION 905 -- PROPOSAL (CONTINUED)

I (We) further propose to execute the attached contract agreement (Section 902) as soon as the work is awarded to me (us), and to begin and complete the work within the time limit(s) provided for in the Specifications and Advertisement. I (We) also propose to execute the attached contract bond (Section 903) in an amount not less than one hundred (100) percent of the total of my (our) part, but also to guarantee the excellence of both workmanship and materials until the work is finally accepted.

I (We) enclose a certified check, cashier's check or bid bond for **five percent (5%) of total bid** and hereby agree that in case of my (our) failure to execute the contract and furnish bond within Ten (10) days after notice of award, the amount of this check (bid bond) will be forfeited to the State of Mississippi as liquidated damages arising out of my (our) failure to execute the contract as proposed. It is understood that in case I am (we are) not awarded the work, the check will be returned as provided in the Specifications.

Bidder acknowledges receipt of and has added to and made a part of the proposal and contract documents the following addendum (addenda):

ADDENDUM NO. 1 DATED 2/19/2014 ADDENDUM NO. DATED
 ADDENDUM NO. DATED ADDENDUM NO. DATED

Number	Description
1	Revised Table of Contents; Add NTB No. 4909; Added or Revised Plan Sheet Nos. 2, 74-77, & 80; Amendment EBS Download Required.

TOTAL ADDENDA: 1
 (Must agree with total addenda issued prior to opening of bids)

Respectfully Submitted,

DATE _____

 Contractor

BY _____
 Signature

TITLE _____

ADDRESS _____

CITY, STATE, ZIP _____

PHONE _____

FAX _____

E-MAIL _____

(To be filled in if a corporation)

Our corporation is chartered under the Laws of the State of _____ and the names, titles and business addresses of the executives are as follows:

_____ President	_____ Address
_____ Secretary	_____ Address
_____ Treasurer	_____ Address

The following is my (our) itemized proposal.

BR-0845-00(006) / 103326301

Lafayette County(ies)

Revised 09/21/2005

MISSISSIPPI DEPARTMENT OF TRANSPORTATION

TABLE OF CONTENTS

PROJECT: BR-0845-00(006) / 103326301 – Lafayette County

901--Advertisement

904--Notice to Bidders:

- Governing Specs. - # 1
- Final Cleanup - # 3
- Quantity for Fillet Concrete - # 6
- Fiber Reinforced Concrete - # 640
- Errata & Modifications to 2004 Standard Specifications - # 1405
- Federal Bridge Formula - # 1928
- Status of ROW, W/Attachments - # 2382
- Non-Quality Control/Quality Assurance Concrete - # 2818
- Reduced Speed Limit Signs - # 2937
- Alternate Asphalt Mixture Bid Items - # 3039
- Temporary Traffic Paint - # 3131
- Storm Water Discharge Associated with Construction Activities
(≥5 Acres) - # 3581
- Additional Erosion Control Requirements – # 3612
- Type III Barricade Rails - # 3655
- Petroleum Products Base Price - # 3893
- Questions Regarding Bidding - # 3980
- Stay-In-Place Metal Forms - # 4084
- Temporary Steel Bracing - # 4085
- Disadvantaged Business Enterprise, W/Supplement - # 4103
- Rumble Stripe - # 4189
- Safety Apparel - # 4214
- Exposure to Severe Sulfate Areas Below Ground Level - # 4300
- Terminal End Sections - # 4308
- Alternate Crushed Stone Base Bid Items - # 4473
- DBE Forms, Participation, and Payment - # 4488
- Warm Mix Asphalt (WMA) - # 4524
- Electronic Addendum Process - # 4526
- Manual on Uniform Traffic Control Devices (MUTCD) - # 4565
- DUNS Requirement for Federal Funded Projects - # 4566
- Adjustments for Bituminous Materials - # 4612
- Intermediate Diaphragms - # 4660
- Payroll Requirements - # 4661
- Detour Bridge Railing - # 4738
- Contract Time - # 4796
- Specialty Items - # 4797
- Placement of Fill Material in Federally Regulated Areas - # 4798
- Environmental Commitments - # 4799
- Bridge Preformed Joint Seal - # 4800
- Seismic Piling - # 4804
- Construction Requirements - # 4808
- Bridge Plan Notes - # 4909

906: Required Federal Contract Provisions -- FHWA-1273, W/ Supplements

-- CONTINUED ON NEXT PAGE --

907-101-4:	Definitions
907-102-10:	Bidding Requirements and Conditions
907-103-8:	Award and Execution of Contract
907-104-1:	Partnering Process
907-104-5:	Scope of Work
907-105-7:	Control of Work
907-107-13:	Legal Relations & Responsibility to Public
907-107-14:	Contractor's Protection Plan), <u>W/ Supplement</u>
907-108-30:	Prosecution and Progress
907-109-6:	Measurement and Payment, <u>W/ Supplement</u>
907-110-2:	Wage Rates
907-225-3:	Grassing
907-226-2:	Temporary Grassing
907-227-10:	Hydroseeding
907-234-5:	Siltation Barriers
907-237-4:	Wattles
907-240-2:	Interlocking Flexible Block Erosion Control System
907-245-2:	Triangular Silt Dikes
907-246-3:	Sandbags & Rockbags
907-247-1:	Temporary Stream Diversion
907-249-1:	Riprap for Erosion Control
907-304-13:	Granular Courses
907-401-2:	Hot Mix Asphalt (HMA), <u>W/ Supplement</u>
907-401-6:	Warm Mix Asphalt (WMA)
907-403-4:	Hot Mix Asphalt (HMA), <u>W/ Supplement</u>
907-403-12:	Warm Mix Asphalt (WMA)
907-407-1:	Tack Coat
907-413-5:	Sawing & Sealing Transverse Joints in Asphalt Pavement
907-601-1:	Structural Concrete
907-603-8:	Culverts & Storm Drains
907-605-3:	Underdrains
907-617-3:	Right-Of-Way Markers
907-618-9:	Placement of Temporary Traffic Stripe
907-618-12:	Construction and Removal of Detour Bridge
907-619-5:	Changeable Message Signs
907-626-5:	Inverted Profile Thermoplastic Traffic Stripe
907-626-25:	Thermoplastic Traffic Markings
907-699-5:	Construction Stakes
907-701-4:	Hydraulic Cement
907-702-3:	Polyphosphoric Acid (PPA) Modification of Petroleum Asphalt Cement
907-703-11:	Aggregates
907-708-6:	Non-Metal Drainage Structures
907-709-1:	Metal Pipe
907-710-1:	Fast Dry Solvent Traffic Paint
907-711-4:	Synthetic Structural Fiber Reinforcement
907-713-3:	Admixtures for Concrete
907-714-8:	Miscellaneous Materials
907-715-4:	Roadside Development Materials
907-720-2:	Pavement Marking Materials
907-803-6:	Deep Foundations
907-804-13:	Concrete Bridges and Structures, <u>W/ Supplement</u>

-- CONTINUED ON NEXT PAGE --

906-7: Training Special Provision

SECTION 905 - PROPOSAL,
PROPOSAL BID ITEMS,
COMBINATION BID PROPOSAL,
CERTIFICATION OF PERFORMANCE - PRIOR FEDERAL-AID CONTRACTS,
CERTIFICATION REGARDING NON-COLLUSION, DEBARMENT AND SUSPENSION,
SECTION 902 - CONTRACT FORM, AND SECTION 903 - CONTRACT BOND FORMS,
PILE DRIVING FORM,
OCR-485.

(REVISIONS TO THE ABOVE WILL BE INDICATED ON THE SECOND SHEET
OF SECTION 905 AS ADDENDA)

MISSISSIPPI DEPARTMENT OF TRANSPORTATION

SECTION 904- NOTICE TO BIDDERS NO. 4909

CODE: (SP)

DATE: 2/18/2014

SUBJECT: Bridge Plan Notes

PROJECT: BR-0845-00(006) / 103326301 – Lafayette County

The Bidders are hereby advised that sixth note on Sheets 8094, 8095, and 8096 shall state the following:

“The bridge railing shall have a minimum LRFD rating of test level two (TL-2).”

The remaining reference to crash testing has been eliminated.

The Bidders are also hereby advised that the first note on Sheet 8016 shall state the following:

“Steel Pipe Piling Shall Conform To ASTM A252, Grade 2 (Fy = 35 ksi) And Shall Be Either Seamless Or Spiral Butt-Welded.”

ADDENDUM

STATE	PROJECT NO.
MISS.	BR-0845-00(006)

DESCRIPTION OF SHEET

WKG. NO. SH. NO.

DESCRIPTION OF SHEET

WKG. NO. SH. NO.

TITLE SHEET (1)		1	SPECIAL DESIGN SHEETS (CONTINUED)		
DETAIL INDEX & GENERAL NOTES (4)			DETAIL OF CONSTRUCTION SIGNING – SITE 4	DCS-4	45
			TRAFFIC CONTROL PLAN – DETOUR SITE 4	TCP-4	46
DETAIL INDEX	DI-1	2	TRAFFIC CONTROL DETAIL – PHASE I SITE 4	TCD-9	47
DETAIL INDEX	DI-2	3	TRAFFIC CONTROL DETAIL – PHASE II SITE 4	TCD-10	48
GENERAL NOTES	GN-1	4	TRAFFIC CONTROL DETAIL – PHASE III SITE 4	TCD-11	49
GENERAL NOTES	GN-2	5			
DETAIL INDEX – BRIDGE (SEE BRIDGE DETAIL INDEX SHEET 8001)			DETAIL OF CONSTRUCTION SIGNING – SITE 5	DCS-5	50
			TRAFFIC CONTROL DETAIL – PHASE I SITE 5	TCD-12	51
			TRAFFIC CONTROL DETAIL – PHASE II SITE 5	TCD-13	52
TYPICAL SECTION SHEETS (3)					
TYPICAL SECTION – NEW CONSTRUCTION, WIDENING AND OVERLAY	TS-1	6	DETAIL OF CONSTRUCTION SIGNING – PHASE I SITE 6	DCS-6	53
TYPICAL SECTION – CONSTRUCTION REMOVAL OF DETOUR ROAD	TS-2	7	TRAFFIC CONTROL DETAIL – PHASE II SITE 6	TCD-14	54
TYPICAL SECTION – CONSTRUCTION OF ACCESS AND SERVICE ROAD	TS-3	8			
			DETAIL OF CONSTRUCTION SIGNING – SITE 7	DCS-7	55
			TRAFFIC CONTROL DETAIL – PHASE I SITE 7	TCD-15	56
QUANTITY SHEETS (12)					
SUMMARY OF QUANTITIES	SQ-1	9	DETAIL OF CONSTRUCTION SIGNING – SITE 8	DCS-8	57
SUMMARY OF QUANTITIES	SQ-2	10	TRAFFIC CONTROL PLAN – DETOUR SITE 8	TCP-8	58
SUMMARY OF QUANTITIES	SQ-3	11	TRAFFIC CONTROL DETAIL – PHASE I SITE 8	TCD-16	59
SUMMARY OF QUANTITIES – BRIDGE (SEE BRIDGE DETAIL INDEX SHEET 8001)			TRAFFIC CONTROL DETAIL – PHASE II SITE 8	TCD-17	60
ESTIMATED QUANTITIES – DRAINAGE STRUCTURES	EQ-1	12	TRAFFIC CONTROL DETAIL – PHASE III SITE 8	TCD-18	61
ESTIMATED QUANTITIES – EROSION CONTROL, EARTHWORK	EQ-2	13			
ESTIMATED QUANTITIES – DRIVEWAYS AND TEMPORARY DRIVEWAYS	EQ-3	14	PAVEMENT MARKING DETAILS – (SITE 1 FINAL PHASE ROAD IS OPEN TO ALL TRAFFIC)	PMD-1	62
ESTIMATED QUANTITIES – BRIDGE END PAVEMENT, REMOVAL OF PAVEMENT AND BOX BRIDGES	EQ-4	15	PAVEMENT MARKING DETAILS – (SITE 2 PHASE II TRAFFIC ON DETOUR RD.)	PMD-2	63
ESTIMATED QUANTITIES – SIDE DRAINS, GUARD RAIL AND REMOVAL OF PIPES	EQ-5	16	PAVEMENT MARKING DETAILS – (SITE 2 FINAL PHASE ROAD IS OPEN TO ALL TRAFFIC)	PMD-3	64
ESTIMATED QUANTITIES – TEMPORARY GUARD RAIL, GUARD RAIL AND GURB AND GUTTER	EQ-6	17	PAVEMENT MARKING DETAILS – (SITE 3 PHASE II TRAFFIC ON DETOUR RD.)	PMD-4	65
ESTIMATED QUANTITIES – TRAFFIC CONTROL SIGNS	EQ-7	18	PAVEMENT MARKING DETAILS – (SITE 3 FINAL PHASE ROAD IS OPEN TO ALL TRAFFIC)	PMD-5	66
STANDARD ROADSIDE SIGN QUANTITIES	SRS-1	19	PAVEMENT MARKING DETAILS – (SITE 4 PHASE II TRAFFIC ON DETOUR RD.)	PMD-6	67
STANDARD ROADSIDE SIGN QUANTITIES	SRS-2	20	PAVEMENT MARKING DETAILS – (SITE 4 FINAL PHASE ROAD IS OPEN TO ALL TRAFFIC)	PMD-7	68
ESTIMATED QUANTITIES – BRIDGE (SEE BRIDGE DETAIL INDEX SHEET 8001)			PAVEMENT MARKING DETAILS – (SITE 5 FINAL PHASE ROAD IS OPEN TO ALL TRAFFIC)	PMD-8	69
			PAVEMENT MARKING DETAILS – (SITE 6 FINAL PHASE ROAD IS OPEN TO ALL TRAFFIC)	PMD-9	70
			PAVEMENT MARKING DETAILS – (SITE 7 FINAL PHASE ROAD IS OPEN TO ALL TRAFFIC)	PMD-10	71
			PAVEMENT MARKING DETAILS – (SITE 8 PHASE II TRAFFIC ON DETOUR RD.)	PMD-11	72
			PAVEMENT MARKING DETAILS – (SITE 8 FINAL PHASE ROAD IS OPEN TO ALL TRAFFIC)	PMD-12	73
			DRIVEWAYS, CURB & GUTTER, & SIDEWALK	SDSD-1	74
			DRIVEWAYS, CURB & GUTTER, & SIDEWALK	SDSD-2	75
			MISCELLANEOUS TYPICAL SECTION DETAILS TWO-WAY TRAFFIC	MTS-1	76
			MISCELLANEOUS DETAIL SHEET DRUM PLACEMENT AND LOW SHOULDER	MDS-1	77
			TYPICAL TEMPORARY EROSION CONTROL MEASURES (SLOPE DRAINS AND TYPE "A" SILT BASIN)		
			TRAFFIC CONTROL DRUM PLACEMENT DETAILS AND SHOULDER CLOSURE	TEC-2	78
			LANE CLOSURE DETAIL (PRECAST CONCRETE BARRIER)	TCP-SC	79
			RUMBLE STRIPS (GROUND IN) 2 LANE	LCD-1	80
			RIGHT-OF-WAY MARKER	RS-2L	81
			RIGHT-OF-WAY MARKER – COORDINATE SHEET (SITE 1 – SITE 4)	ROW-1	82
			RIGHT-OF-WAY MARKER – COORDINATE SHEET (SITE 5 – SITE 8)	ROW-1	83
			DETAILS OF BARRICADES	ROW-2	84
			SUPERELEVATION RUNOFF CASE 1 ROTATION ABOUT CENTERLINE	RCD-1	85
			SUPERELEVATION CASE 1 ROTATION ABOUT CENTERLINE (2% NORMAL SUBGRADE)	SDRO-1	86
			TYPICAL INSTALLATION AND DETAILS OF DELINEATORS	SDSE-2A	87
			AND DISTANCE REFERENCE SIGNS	SDSN-8	88
			HIGHWAY SIGN AND BARRICADE DETAILS FOR CONSTRUCTION PROJECTS	SDTCP-10	89
			GUARD RAIL : (TEMPORARY) TYPICAL INSTALLATION AT	TGR-1	90
			DETOUR BRIDGE ENDS		

PLAN AND PROFILE SHEETS (12)

MAINLINE HWY. 328 STA. 93+00 BOP TO STA. 118+00	3	21
MAINLINE STA. 189+00 TO STA. 199+00	4	22
DETOUR ROAD STA. 9+00 TO STA. 21+50	4-A	23
MAINLINE STA. 255+00 TO STA. 270+00	5	24
DETOUR ROAD STA. 2+00 TO STA. 21+00	5-A	25
MAINLINE STA. 396+00 TO STA. 412+00	6	26
DETOUR ROAD STA. 7+00 TO STA. 21+00	6-A	27
MAINLINE STA. 474+00 TO STA. 482+00	7	28
MAINLINE STA. 517+50 TO STA. 524+00	8	29
MAINLINE STA. 532+00 TO STA. 539+00	9	30
MAINLINE STA. 603+00 TO EOP STA. 616+00	10	31
DETOUR ROAD STA. 0+00 TO STA. 18+00	10-A	32

SPECIAL DESIGN SHEETS (107)

DETAIL OF CONSTRUCTION SIGNING – SITE 1	DCS-1	33
TRAFFIC CONTROL DETAIL – PHASE I SITE 1	TCD-1	34
TRAFFIC CONTROL DETAIL – PHASE II SITE 1	TCD-2	35
DETAIL OF CONSTRUCTION SIGNING – SITE 2	DCS-2	36
TRAFFIC CONTROL PLAN – DETOUR SITE 2	TCP-2	37
TRAFFIC CONTROL DETAIL – PHASE I SITE 2	TCD-3	38
TRAFFIC CONTROL DETAIL – PHASE II SITE 2	TCD-4	39
TRAFFIC CONTROL DETAIL – PHASE III SITE 2	TCD-5	40
DETAIL OF CONSTRUCTION SIGNING – SITE 3	DCS-3	41
TRAFFIC CONTROL DETAIL – PHASE I SITE 3	TCD-6	42
TRAFFIC CONTROL DETAIL – PHASE II SITE 3	TCD-7	43
TRAFFIC CONTROL DETAIL – PHASE III SITE 3	TCD-8	44

PS & E PLANS-DATE 12-26-2013		
FMS CON. # 103326/301000		
REVISIONS		
DATE	SHEET NO.	BY
1/21/14	3, 9-18, 23-28, 41, 42, 50, 53, 55, 128-139	GSW
1/24/14	3, 10, 11	GSW
2/14/14	2, 74, 75, 76, 77, 80	GSW

MISSISSIPPI DEPARTMENT OF TRANSPORTATION	
DETAILED INDEX	
PROJECT NO. BR-0845-00(006) COUNTY : LAFAYETTE	
WORKING NUMBER DI-1	SHEET NUMBER 2
FILENAME: INDEX.DGN	DESIGN TEAM: J. DAVIS
DATE: 2-14-14	CHECKED: _____

2/14/2014 2:53 PM I:INDEX.DGN

ADDENDUM

4" CAST IRON DRAIN PIPE PLACED WHERE DESIGNATED ELSEWHERE ON PLANS OR BY THE ENGINEER. PAYMENT FOR THE PIPE SHALL BE MADE ON A SEPARATE BASIS.

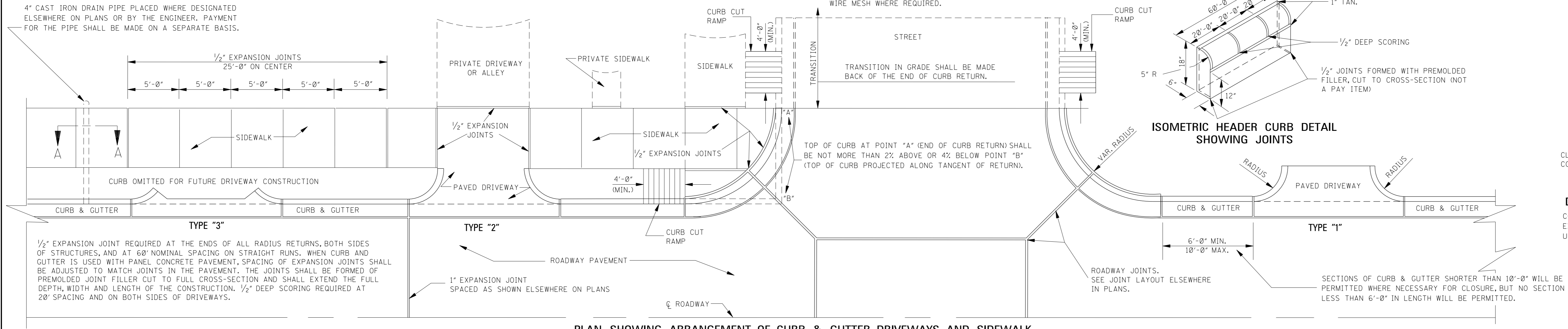

ISOMETRIC HEADER CURB DETAIL SHOWING JOINTS

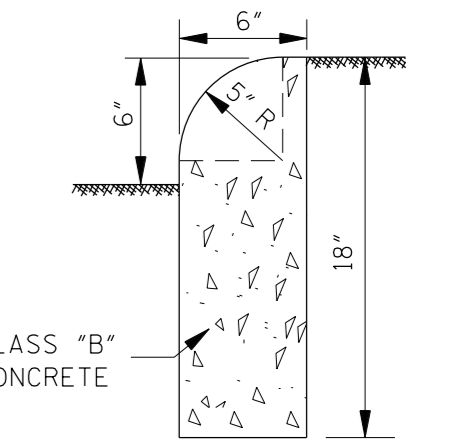

DETAIL OF HEADER CURB
CONTRACTION JOINTS REQUIRED AT 20' O.C.
EXPANSION JOINTS REQUIRED AT 60' O.C.
UNLESS OTHERWISE DIRECTED BY ENGINEER.

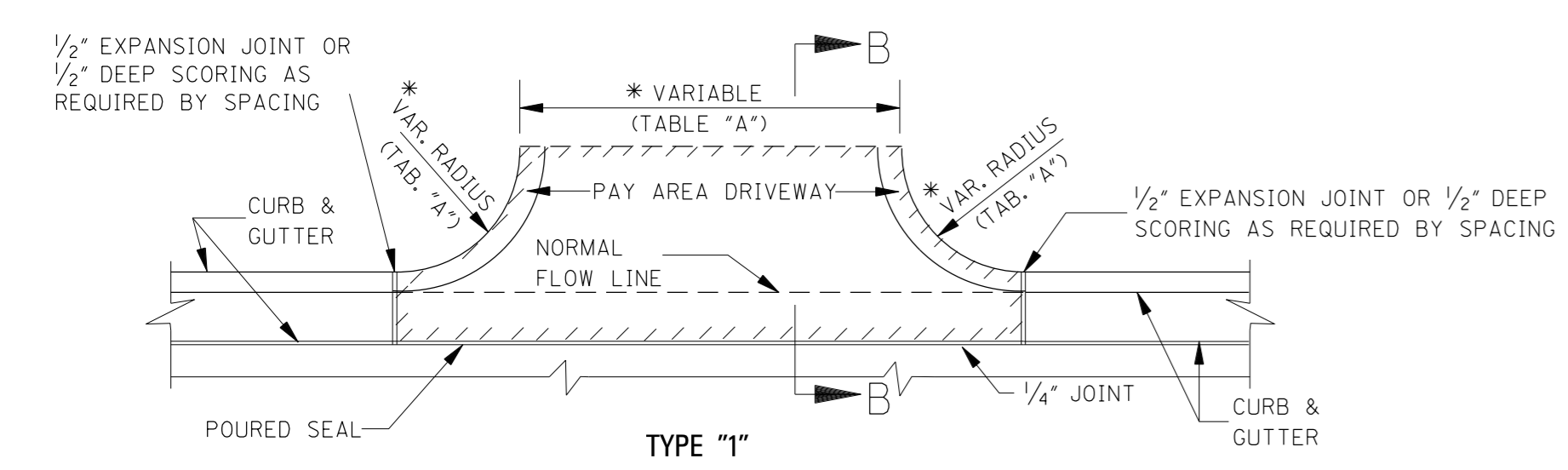

TYPE "1" PLAN OF CONCRETE DRIVEWAY

11,058 yd² FOR DRIVEWAY 16'-0" IN WIDTH.
0,574 yd² FOR EACH ADDED OR SUBTRACTED FOOT OF WIDTH.
NOTE: THIS DRIVEWAY AREA EXAMPLE IS COMPUTED ON THE BASIS OF 3'-0" RADIUS. PAYMENT FOR CURB RADIUS SHALL BE INCLUDED IN COMPENSATION FOR DRIVEWAY.

*TABLE "A"		
DRIVEWAY TYPE	DRIVEWAY WIDTH (ft)	CURB RETURN RADIUS (ft)
RESIDENTIAL	16'	3' - 10'
COMMERCIAL/INDUSTRIAL	30' - 50'	5' - 30'

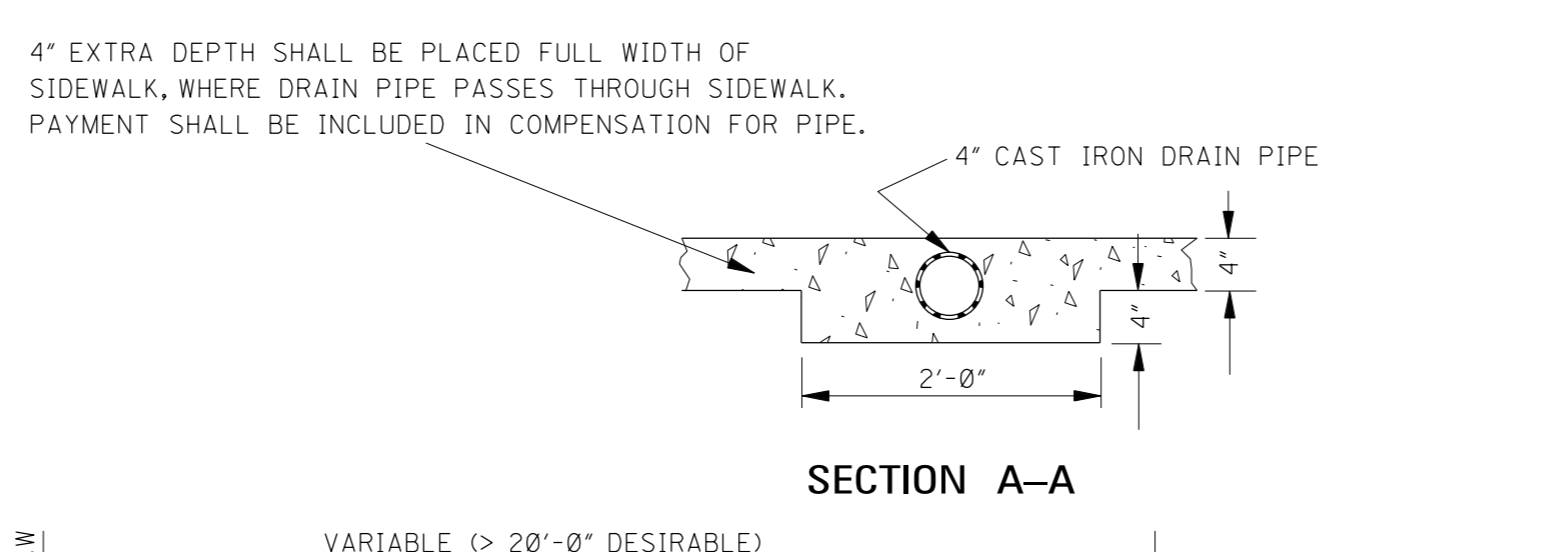

SECTION A-A

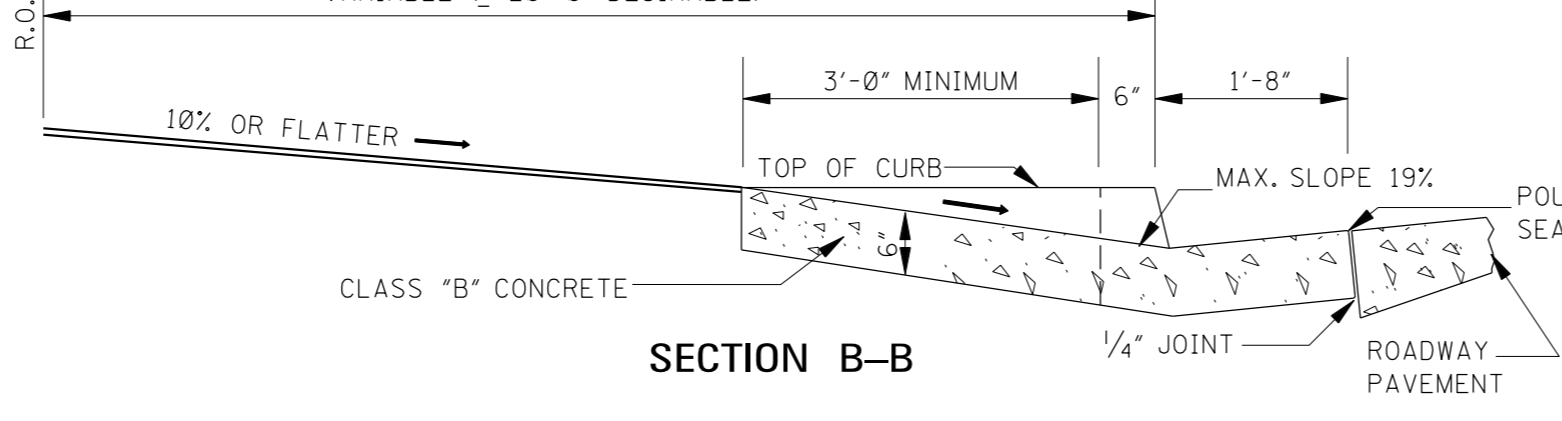

SECTION B-B

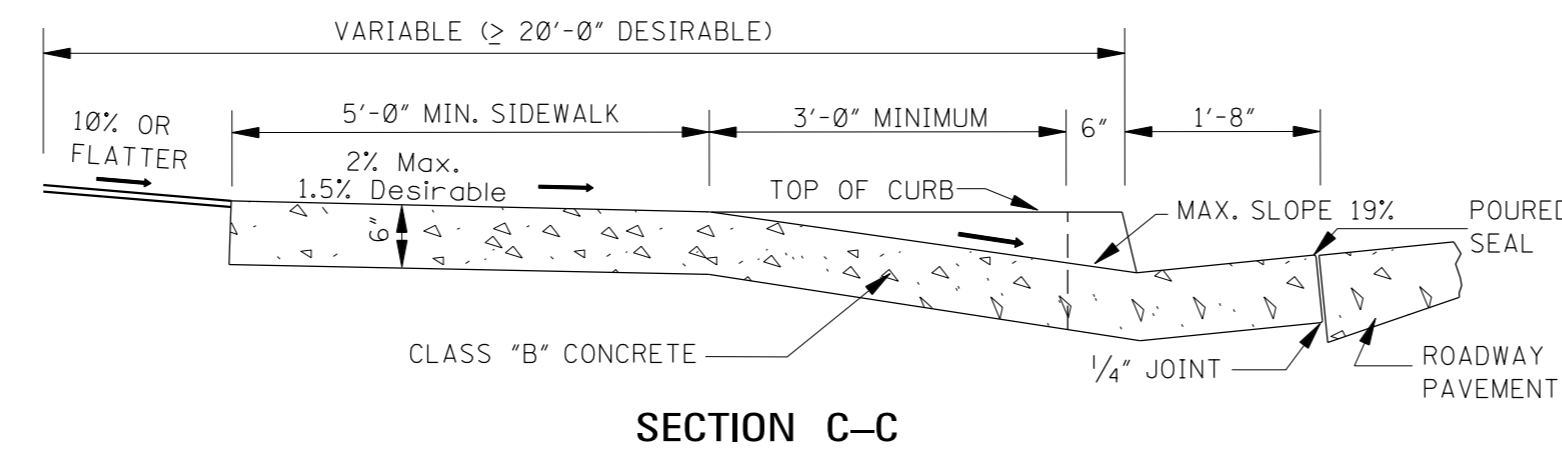

SECTION C-C

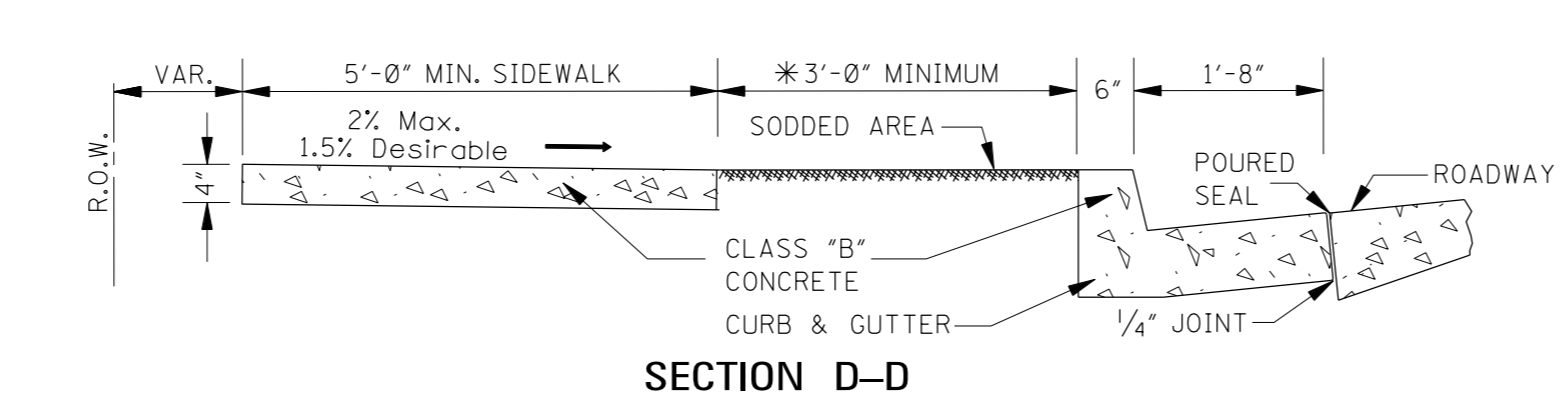

SECTION D-D

*NOTE: BUFFER ZONE IS REQUIRED UNLESS THERE ARE RIGHT OF WAY CONSTRAINTS. WHERE THERE ARE ROW CONSTRAINTS, THE BUFFER ZONE MAY BE OMITTED ONLY IF ALL ADA REQUIREMENTS CAN BE MET.

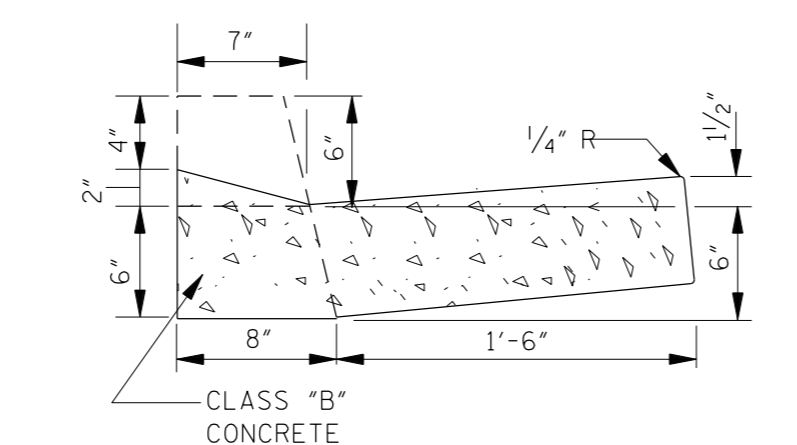

SECTION E-E

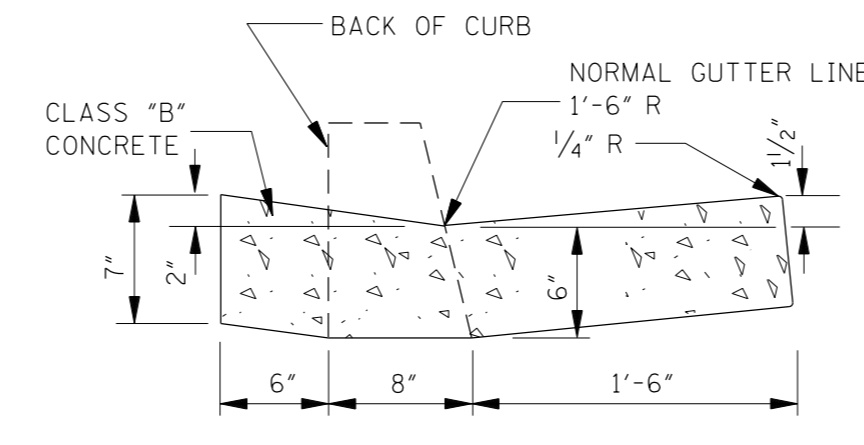

DETAIL OF VALLEY GUTTER

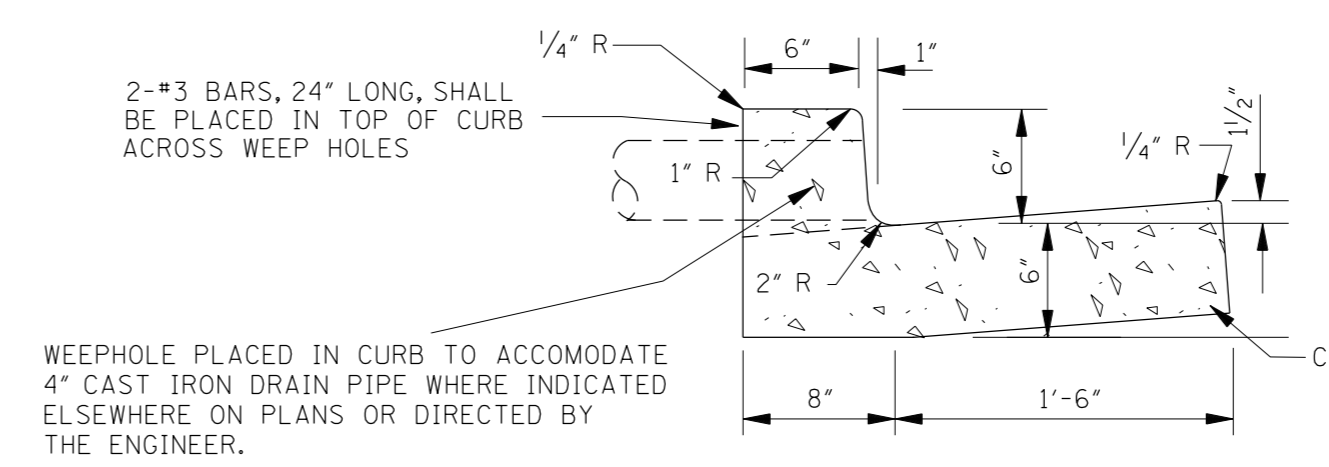

TYPE "1" DETAIL OF COMBINATION CURB & GUTTER

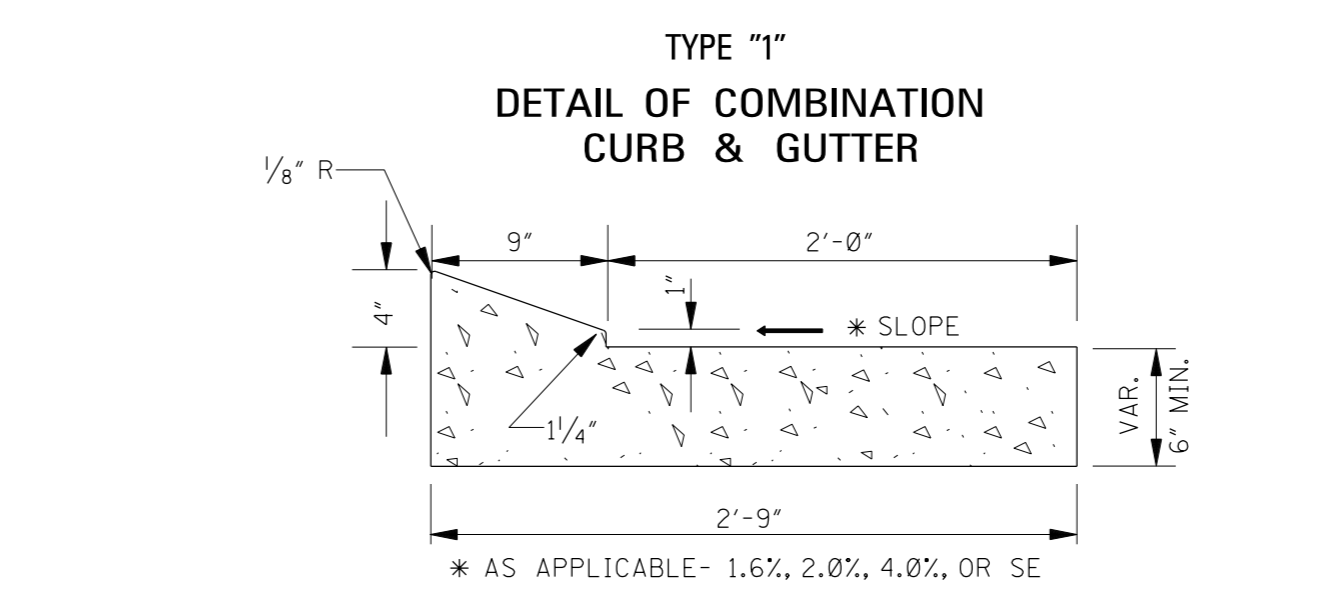

TYPE "2" DETAIL OF COMBINATION CURB & GUTTER

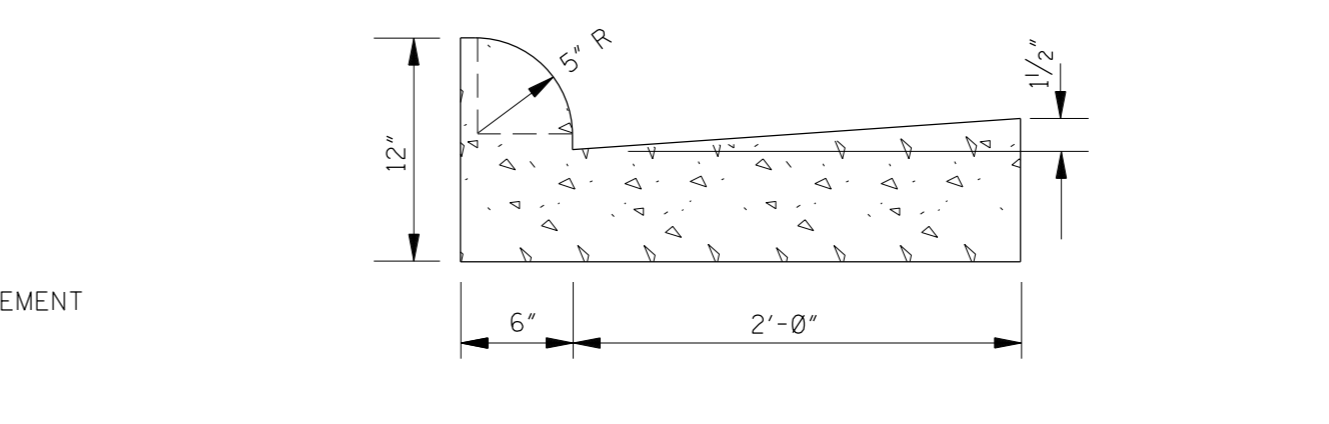

TYPE "3A" DETAIL OF COMBINATION CURB & GUTTER

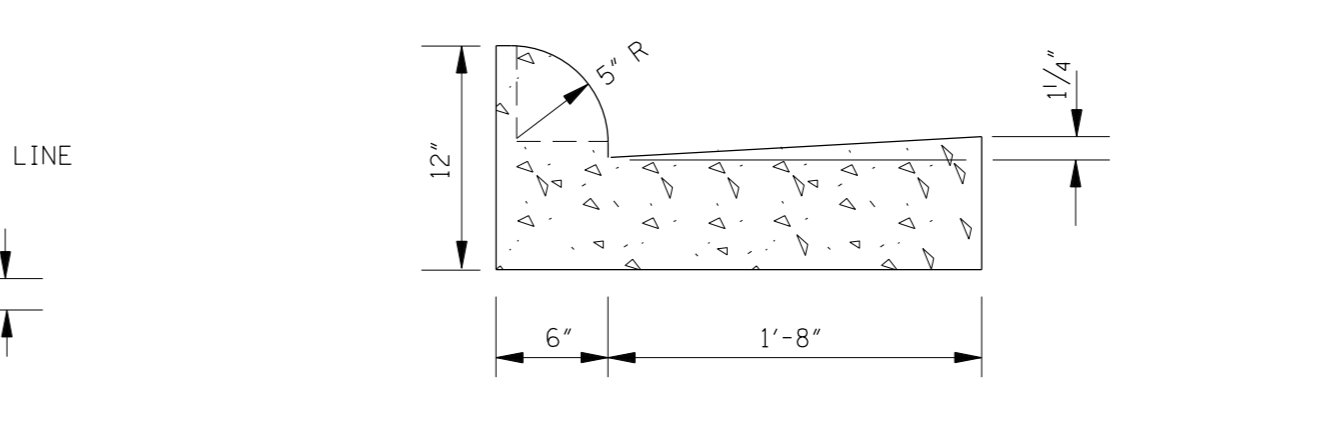

TYPE "3B" DETAIL OF COMBINATION CURB & GUTTER

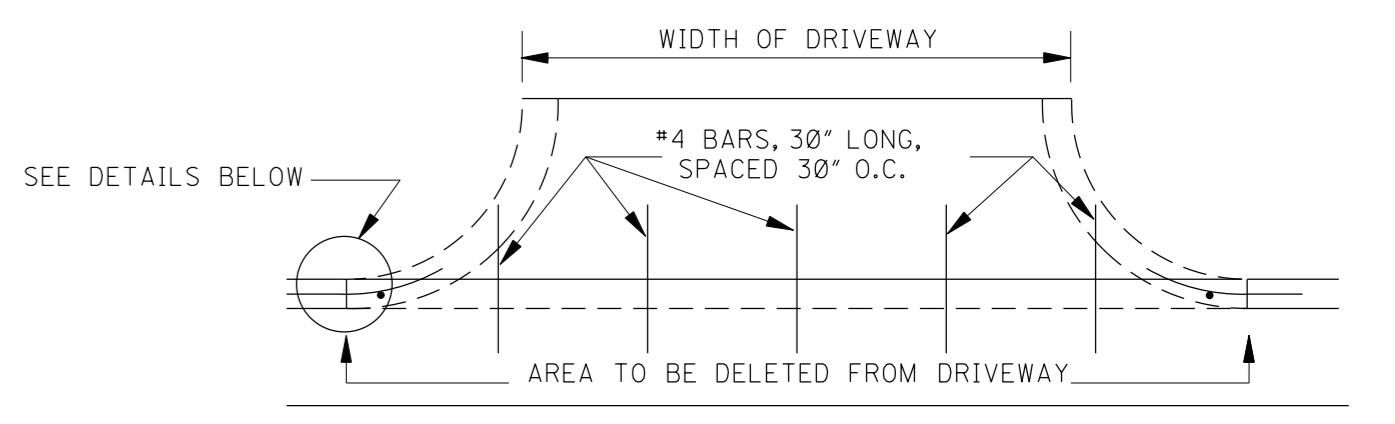
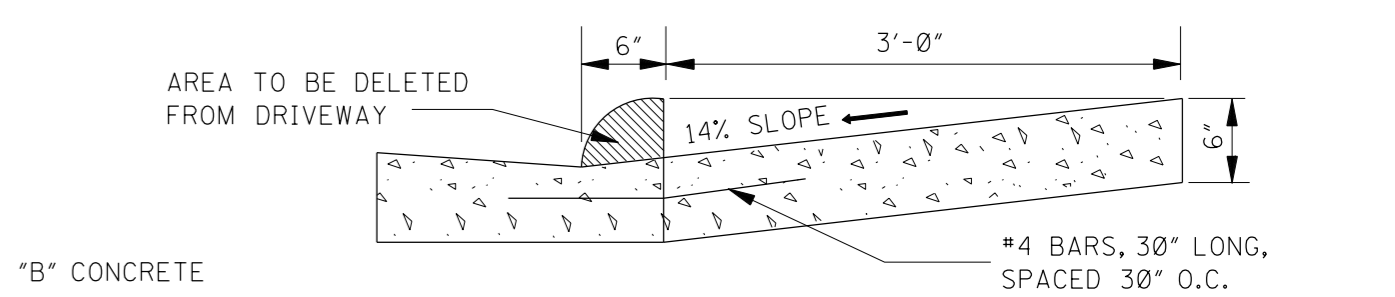

PERMISSIBLE DRIVEWAY CONSTRUCTION METHOD FOR SLIP-FORM PLACEMENT OF CURB & GUTTER

- GENERAL NOTES:
- THE STANDARD SPECIFICATIONS ADOPTED BY THE MISSISSIPPI DEPARTMENT OF TRANSPORTATION SHALL, UNLESS OTHERWISE SPECIFIED HEREIN, APPLY TO ALL ITEMS INCLUDED ON THIS DRAWING.
 - TRAVERSE CONTRACTION JOINTS ARE REQUIRED AT 20' ON CENTER FOR ALL CONCRETE DRIVEWAYS THAT EXTEND PAST THE END OF THE CURB RETURN. A 1/2" WIDE EXPANSION JOINT IS REQUIRED AT THE END OF THE CURB RETURN AND AT 60' ON CENTER THROUGHOUT THE LENGTH OF THE DRIVEWAY. A LONGITUDINAL CONTRACTION JOINT IS REQUIRED FOR ALL DRIVEWAYS EXCEEDING 20' IN WIDTH.
 - SEE SHEET SDCCR-1 FOR DETAILS OF CURB-CUT RAMPS.

MISSISSIPPI DEPARTMENT OF TRANSPORTATION	
DRIVEWAYS, CURB & GUTTER & SIDEWALK	
PROJECT NO.: BR-0845-00(006) COUNTY: LAFAYETTE	
FILENAME: SDSD-1.DGN	
DATE	CHECKED
DESIGN TEAM	DATE

WORKING NUMBER	SDSD-1
SHEET NUMBER	74

2-14-14 1:45 PM SDSD-1.DGN

ADDENDUM

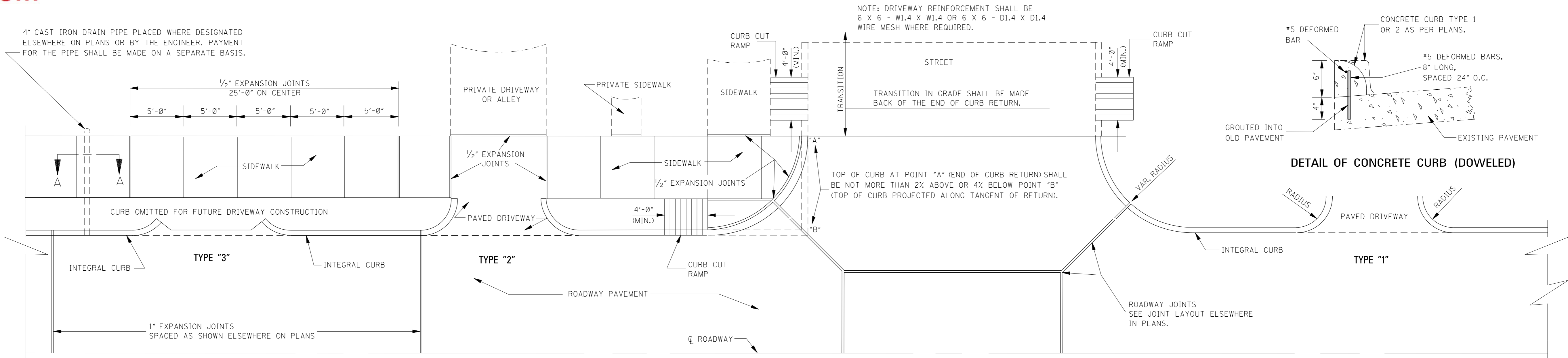

PLAN SHOWING ARRANGEMENT OF INTEGRAL CURB, DRIVEWAYS AND SIDEWALK

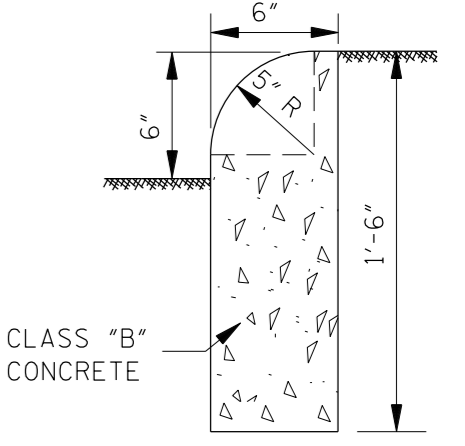
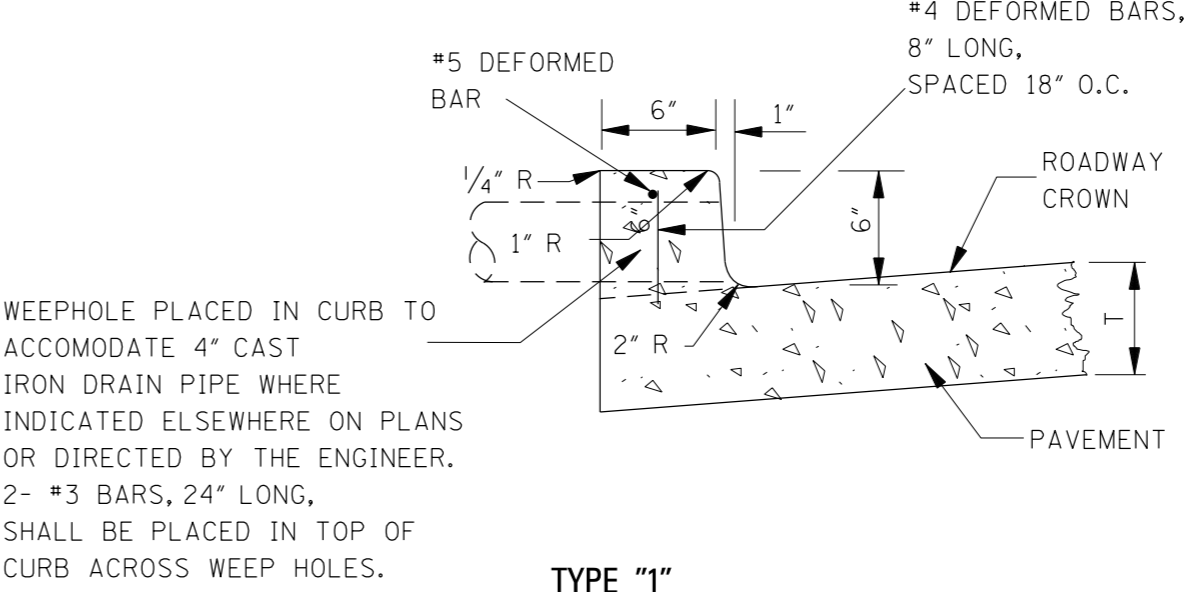
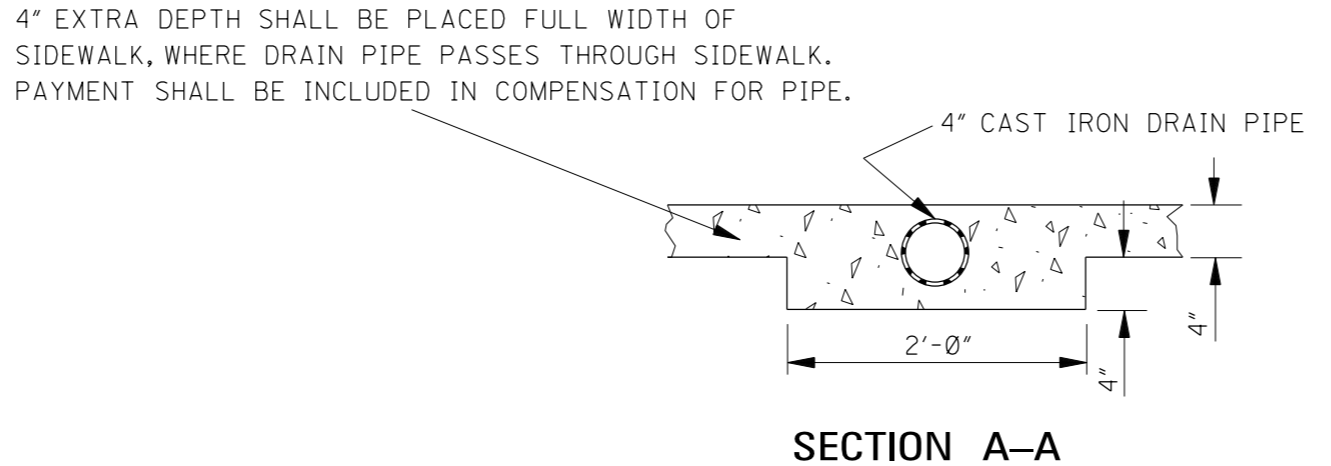
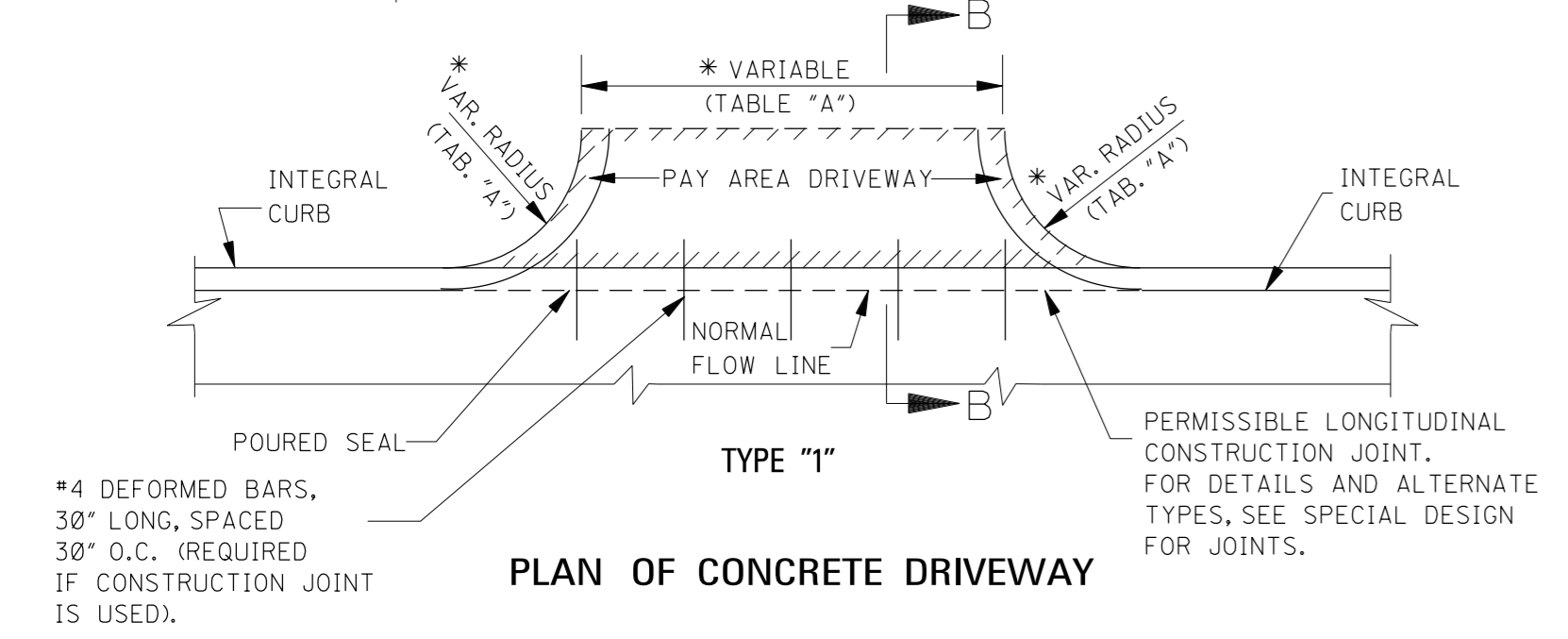

*TABLE "A"		
DRIVEWAY TYPE	DRIVEWAY WIDTH (FT)	CURB RETURN RADIUS (FT)
RESIDENTIAL	16'	3' - 10'
COMMERCIAL / INDUSTRIAL	30' - 50'	5' - 30'

5.761 yd² FOR DRIVEWAY 16'-0" IN WIDTH. 0.333 yd² FOR EACH ADDED OR SUBTRACTED FOOT OF WIDTH. NOTE: THIS DRIVEWAY AREA EXAMPLE IS COMPUTED ON THE BASIS OF 3'-0" RADIUS. PAYMENT FOR CURB RADIUS SHALL BE INCLUDED IN COMPENSATION FOR DRIVEWAY.

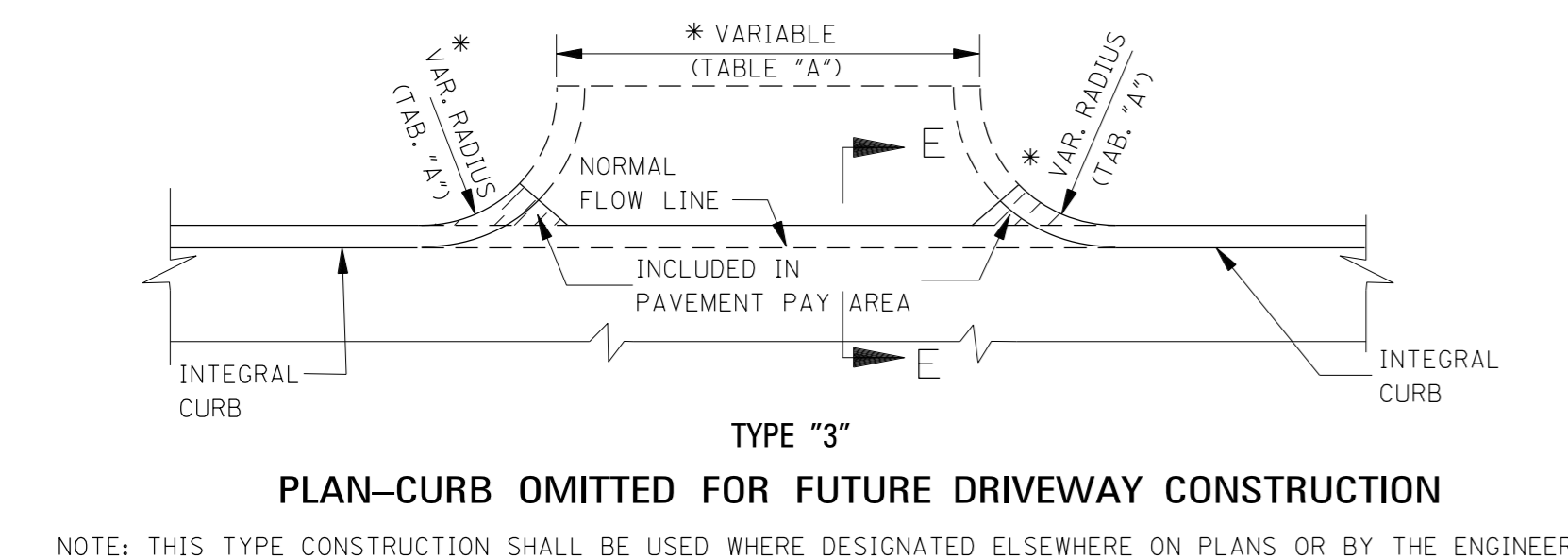
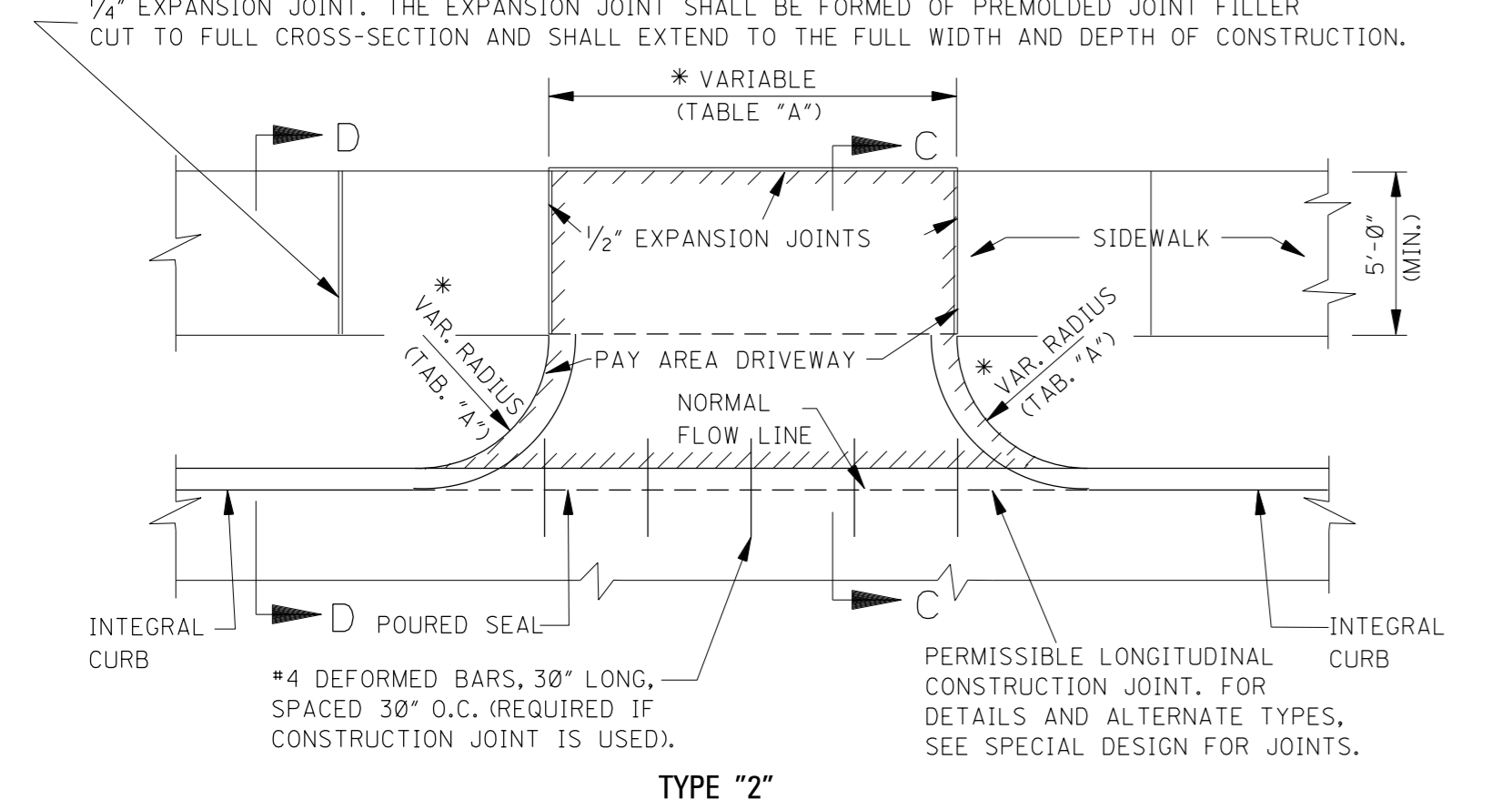
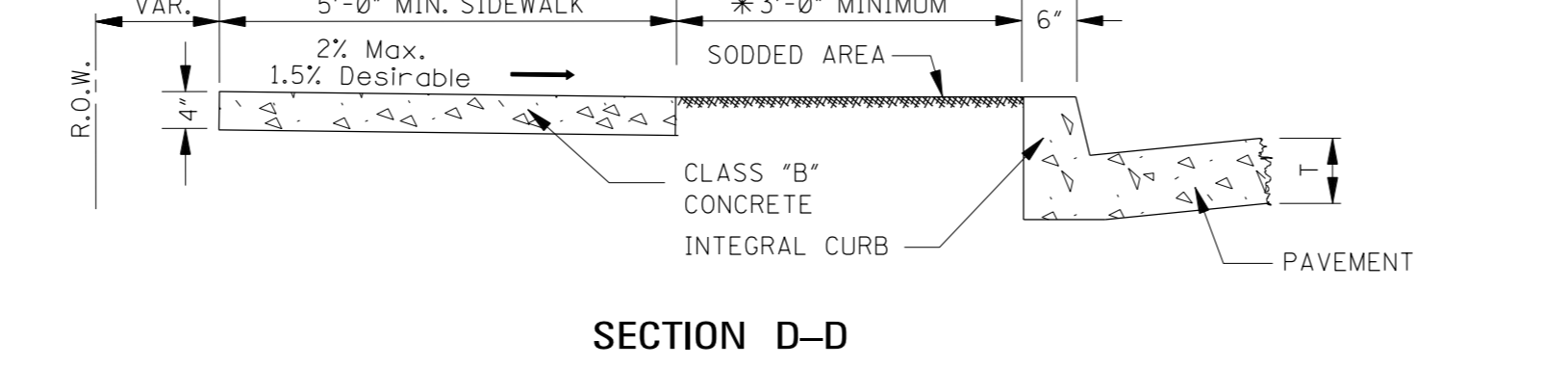
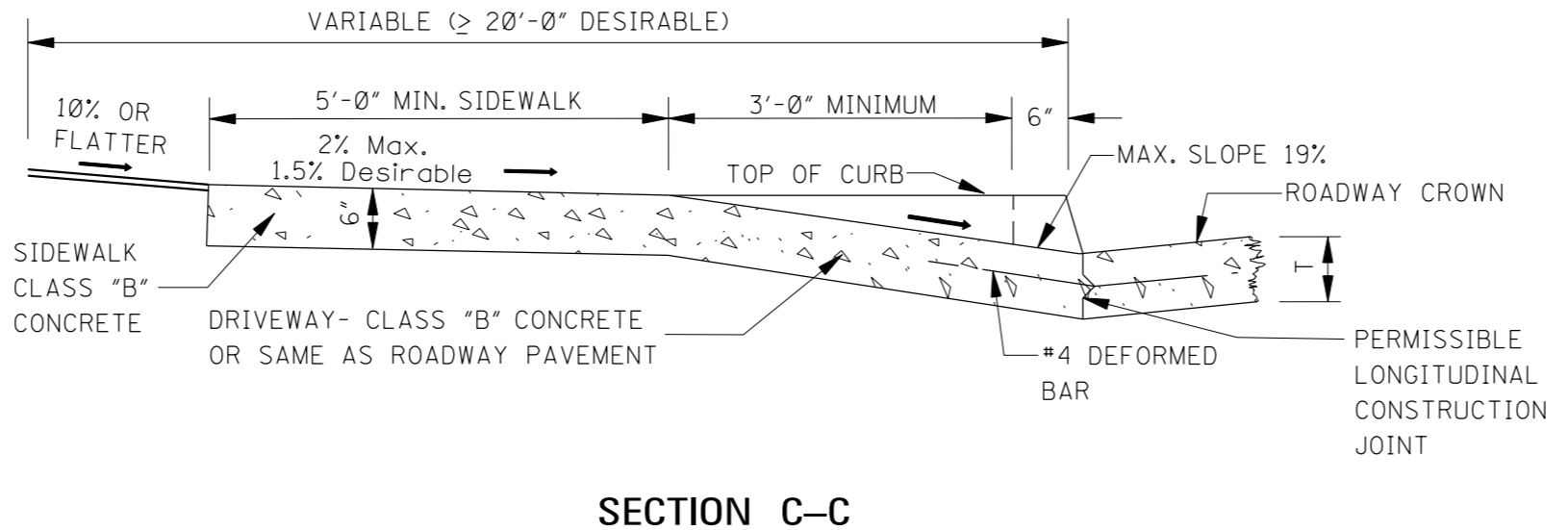
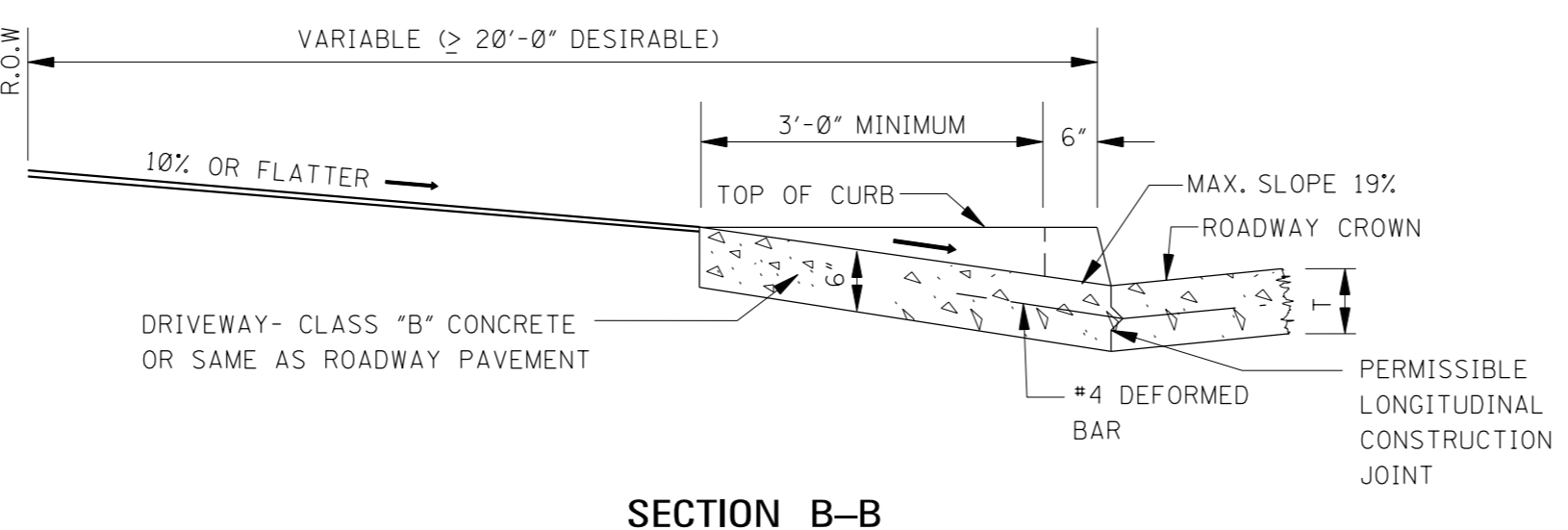

- GENERAL NOTES:
- THE STANDARD SPECIFICATIONS ADOPTED BY THE MISSISSIPPI DEPARTMENT OF TRANSPORTATION SHALL, UNLESS OTHERWISE SPECIFIED HEREIN, APPLY TO ALL ITEMS INCLUDED ON THIS DRAWING.
 - TRAVERSE CONTRACTION JOINTS ARE REQUIRED AT 20' ON CENTER FOR ALL CONCRETE DRIVEWAYS THAT EXTEND PAST THE END OF THE CURB RETURN. A 1/2" WIDE EXPANSION JOINT IS REQUIRED AT THE END OF THE CURB RETURN AND AT 60' ON CENTER THROUGHOUT THE LENGTH OF THE DRIVEWAY. A LONGITUDINAL CONTRACTION JOINT IS REQUIRED FOR ALL DRIVEWAYS EXCEEDING 20' IN WIDTH.
 - SEE SHEET SDCCR-1 FOR DETAILS OF CURB-CUT RAMPS.

MISSISSIPPI DEPARTMENT OF TRANSPORTATION	
DRIVEWAYS, INTEGRAL CURB & SIDEWALK	
PROJECT NO.: BR-0845-00(006) COUNTY: LAFAYETTE	
FILENAME: SDSD-2.DGN	
DATE	CHECKED
DESIGN TEAM	DATE

CSW	BY
REVISION	
ADDED SHEET	

WORKING NUMBER
SDSD-2
SHEET NUMBER
75

2/14/2014 1:51 PM SDSD-2.DGN

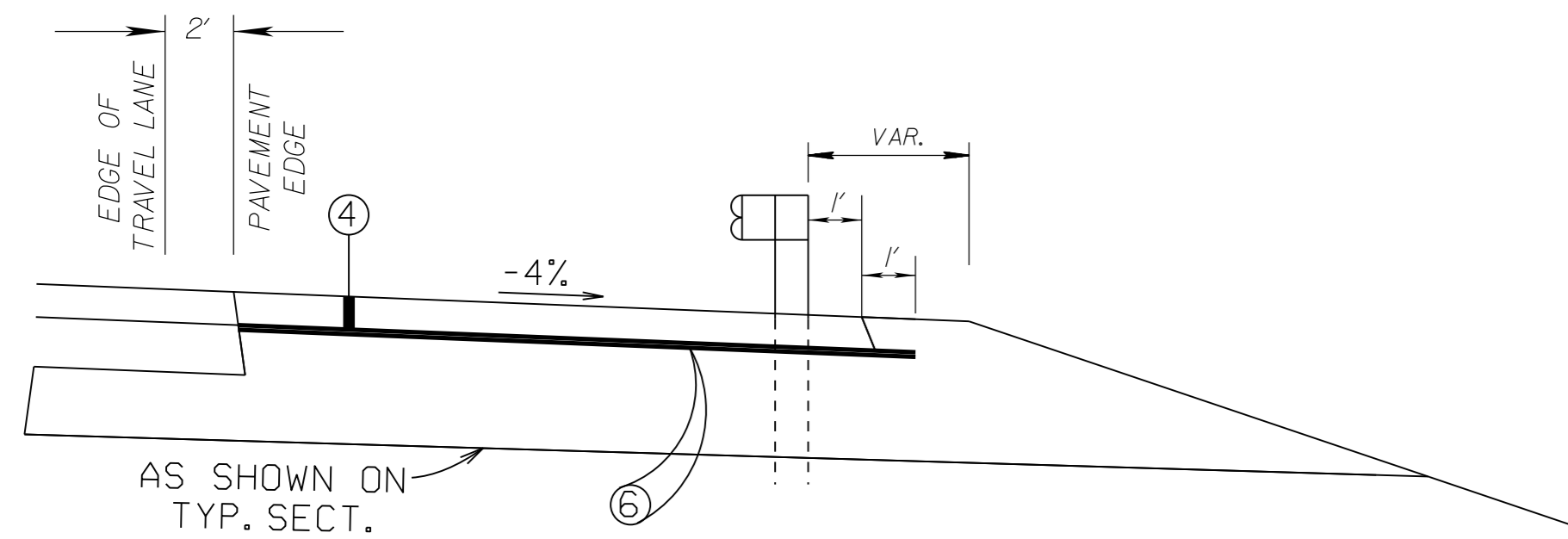

SECTION A-A

- ④ TOP 2 LIFTS OF ASPHALT AS SHOWN ON TYPICAL SECTION.
- ⑥ PRIME COAT (MAY BE DELETED WHEN PERMITTED BY THE ENGINEER).

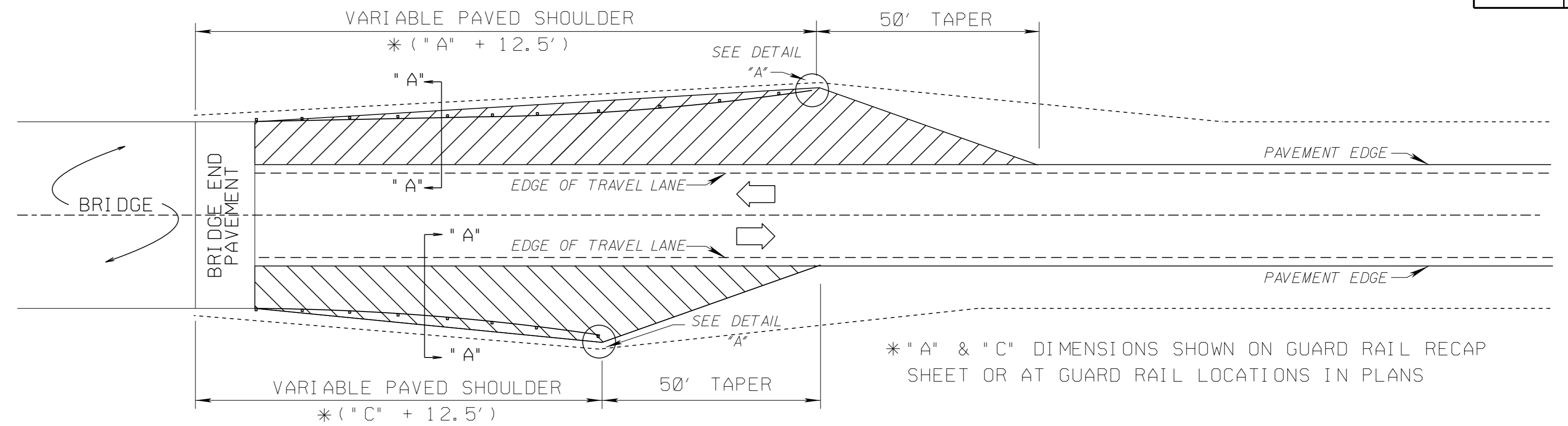

DETAIL OF PAVED SHOULDERS AT BRIDGE ENDS
SEE SECTION "A" - "A"

* "A" & "C" DIMENSIONS SHOWN ON GUARD RAIL RECAP SHEET OR AT GUARD RAIL LOCATIONS IN PLANS

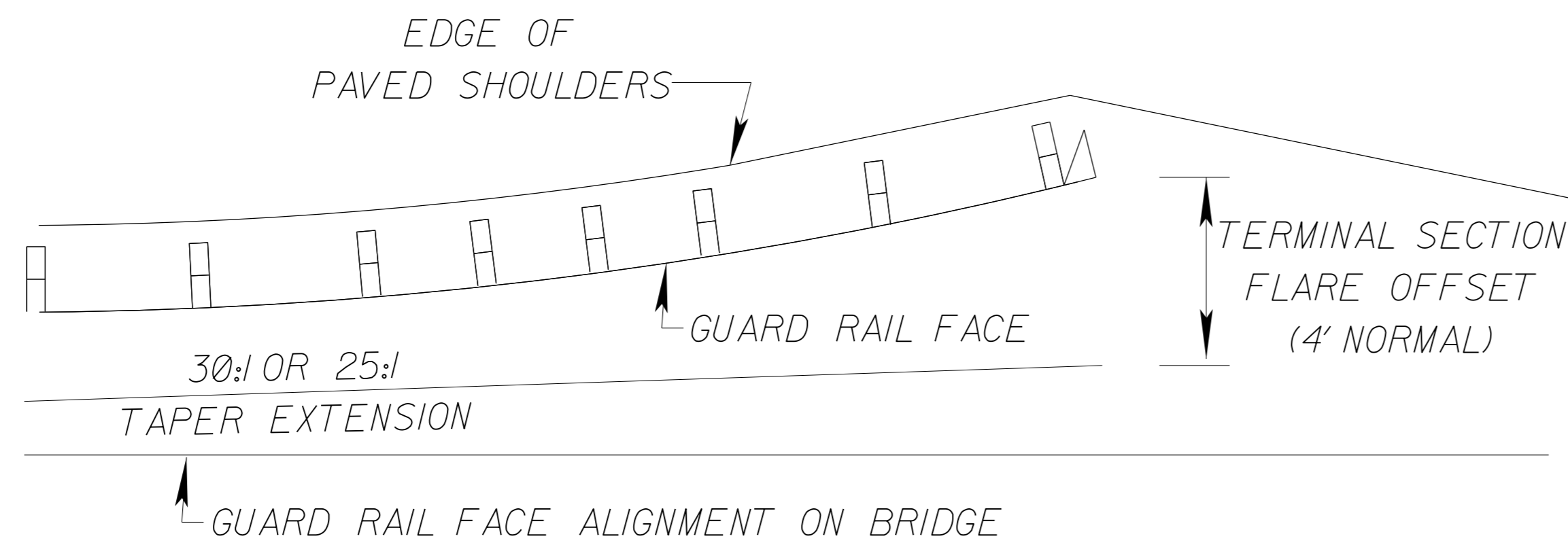

DETAIL "A"
SEE GUARD RAIL INSTALLATION SHEETS FOR OTHER DETAILS

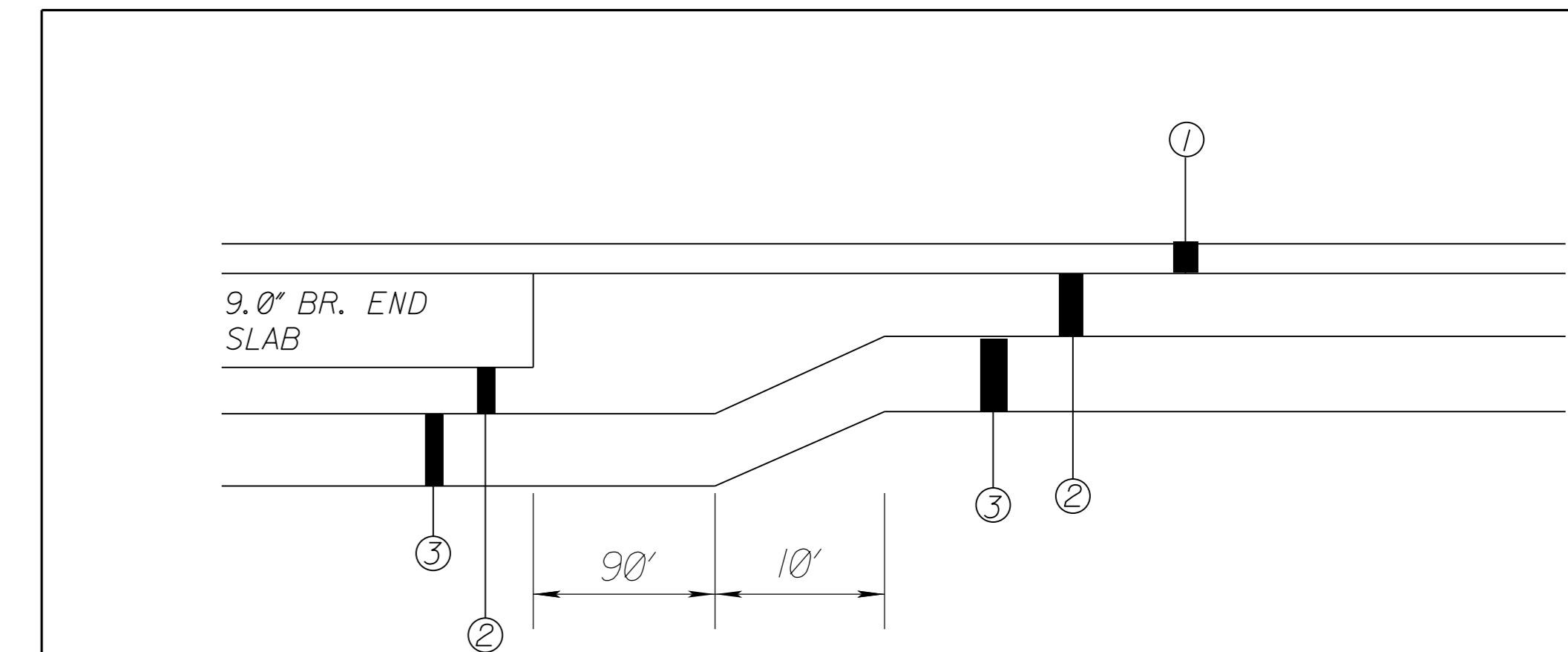

DETAIL FOR PAVEMENT TRANSITION AT BRIDGE ENDS

- ① 1.50" ASPHALT, ST (9.5 mm MIX) (1 @ 1.50")
- ② 3.0" ASPHALT, ST (19 mm MIX) (1 @ 3.0")
- ③ 8.0" CRUSHED STONE W/ GEOTEXTILE FABRIC TYPE V (NON-WOVEN)

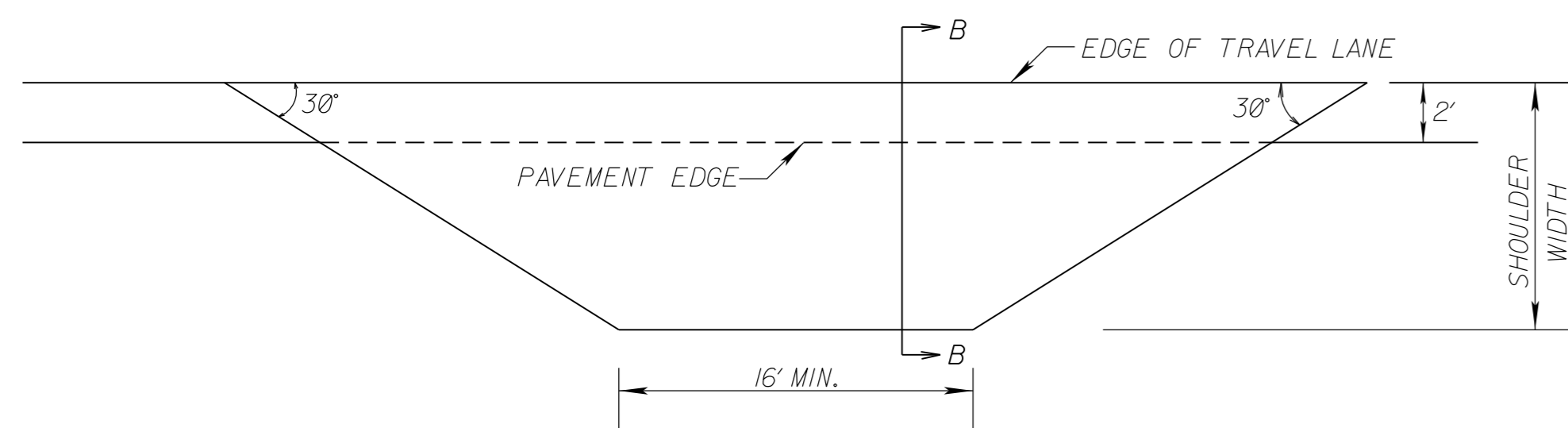

DETAIL OF PAVED APRON
SEE SECTION B-B

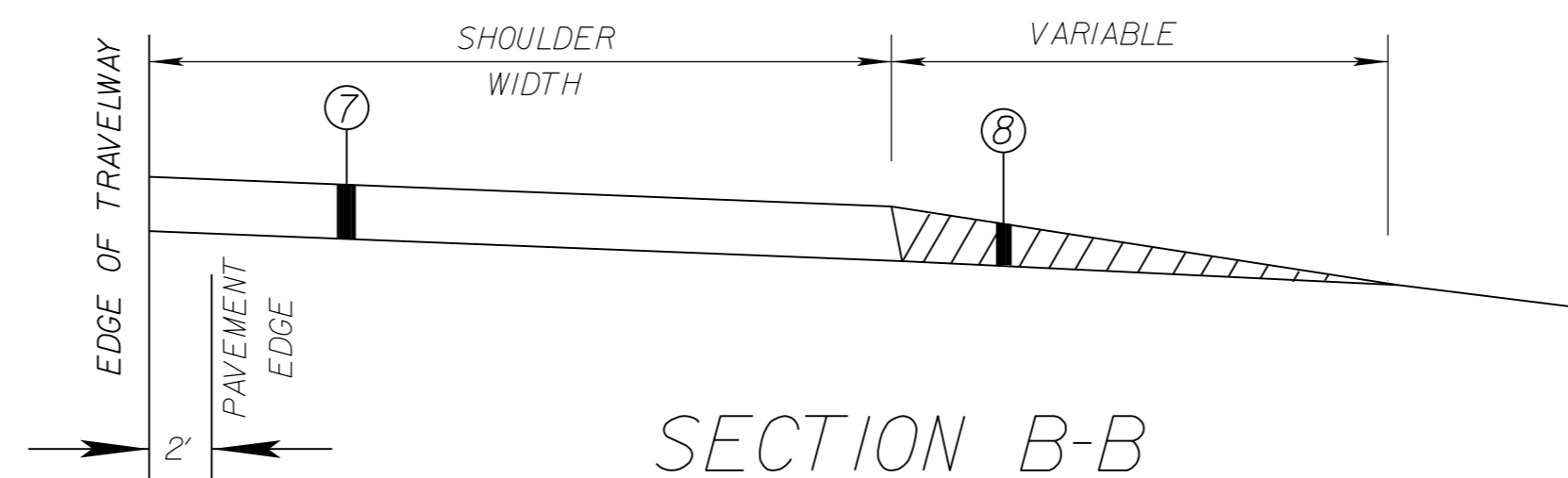

- ⑦ TOP 2 LIFTS OF ASPHALT AS SHOWN ON TYPICAL SECTION.
- ⑧ VARIABLE DEPTH GRANULAR MATERIAL AS SHOWN ON TYPICAL SECTION

2/14/2014 1:54 PM SPECIAL DESIGN.DGN MISSISSIPPI DEPARTMENT OF TRANSPORTATION

MISSISSIPPI DEPARTMENT OF TRANSPORTATION		
<p>MISCELLANEOUS TYPICAL SECTION DETAILS ONE-WAY TRAFFIC</p>		
PROJECT NO. : BR-0845-00(006)	COUNTY : LAFAYETTE	WORKING NUMBER MTS-1
FILENAME: SPECIAL DESIGN.DGN	DESIGN TEAM: J.DAVIS	SHEET NUMBER 76

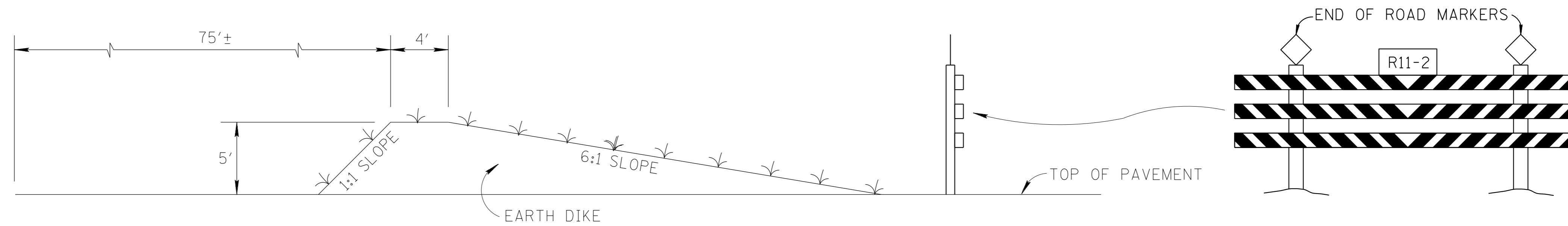
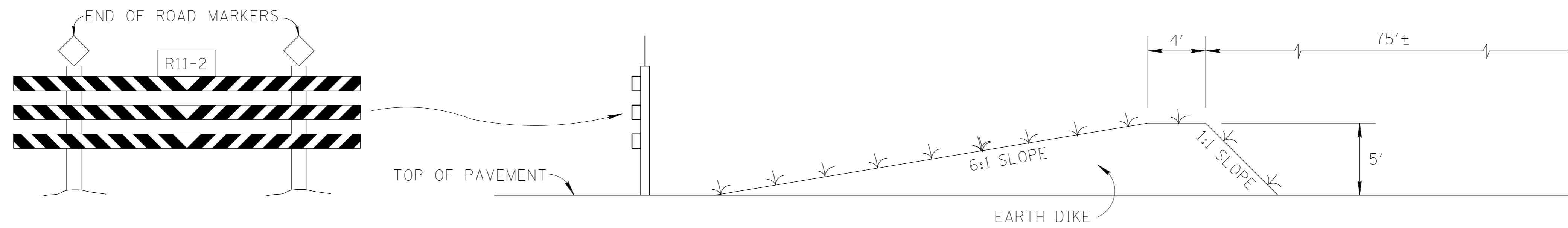

ROADWAY CLOSURE DETAIL
(LONG-TERM)

TYPE III BARRICADE REQ'D. (24' WIDE)
(RED AND WHITE STRIPES - ENCAPSULATED
LENS REFLECTIVE SHEETING). END OF ROAD
MARKERS ARE ABSORBED PAY ITEMS (18"
DIAMOND ENCAPSULATED LENS PANELS).
BARRICADES AND SIGNS TO BE PAID FOR
UNDER PAY ITEM 619-G4008. BARRICADES
(PERMANENT) TO REMAIN IN PLACE AFTER
COMPLETION OF PROJECT.

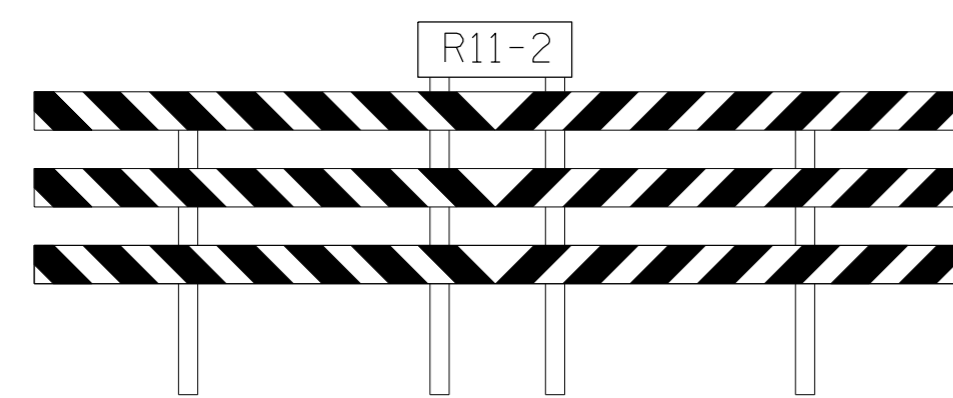

DETAIL OF BARRICADE
FOR LONG-TERM LANE CLOSURE

TYPE III BARRICADE REQ'D. (WIDTH VARIES;
SEE PLANS) (RED AND WHITE STRIPES -
ENCAPSULATED LENS REFLECTIVE SHEETING).
BARRICADES AND SIGNS TO BE PAID FOR
UNDER PAY ITEM 675-G4008. BARRICADES
(PERMANENT) TO REMAIN IN PLACE AFTER
COMPLETION OF PROJECT.

NOTE:
ITEMS ON THIS SHEET TO BE USED ONLY
IF CALLED FOR ELSEWHERE ON THE PLANS
OR IF DIRECTED BY THE ENGINEER.

MISSISSIPPI DEPARTMENT OF TRANSPORTATION	
MISCELLANEOUS DETAIL SHEET	
DRUM PLACEMENTS & LOW SHOULDER	
PROJECT NO. BR-0845-00(006) COUNTY: LAFAYETTE	
WORKING NUMBER	MDS-1
FILENAME: SPECIAL DESIGN.DGN	SHEET NUMBER
DESIGN TEAM J. DAVIS CHECKED _____ DATE _____	77

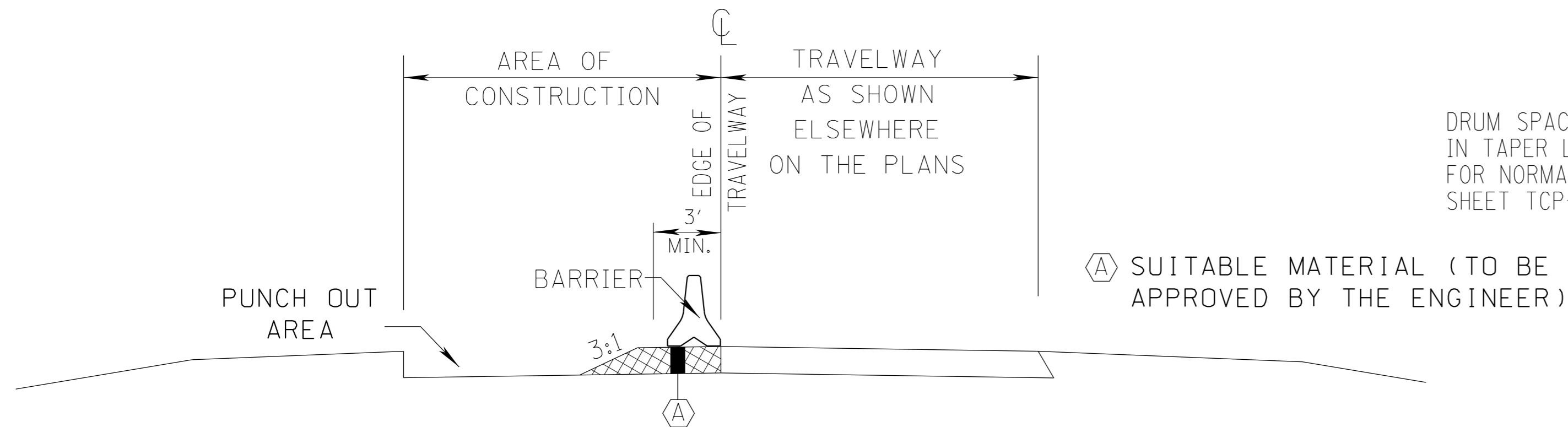

ELEVATION VIEW FOR POSITIVE BARRIER

- ① MATERIAL USED TO SUPPORT POSITIVE BARRIER MUST BE AT SAME ELEVATION AS PAVEMENT IN ADJACENT TRAVELWAY.
- ② DELINEATORS REQUIRED ON ALL NON-REFLECTIVE BARRIER, AS SHOWN ON WORKING NO. MB-2A.

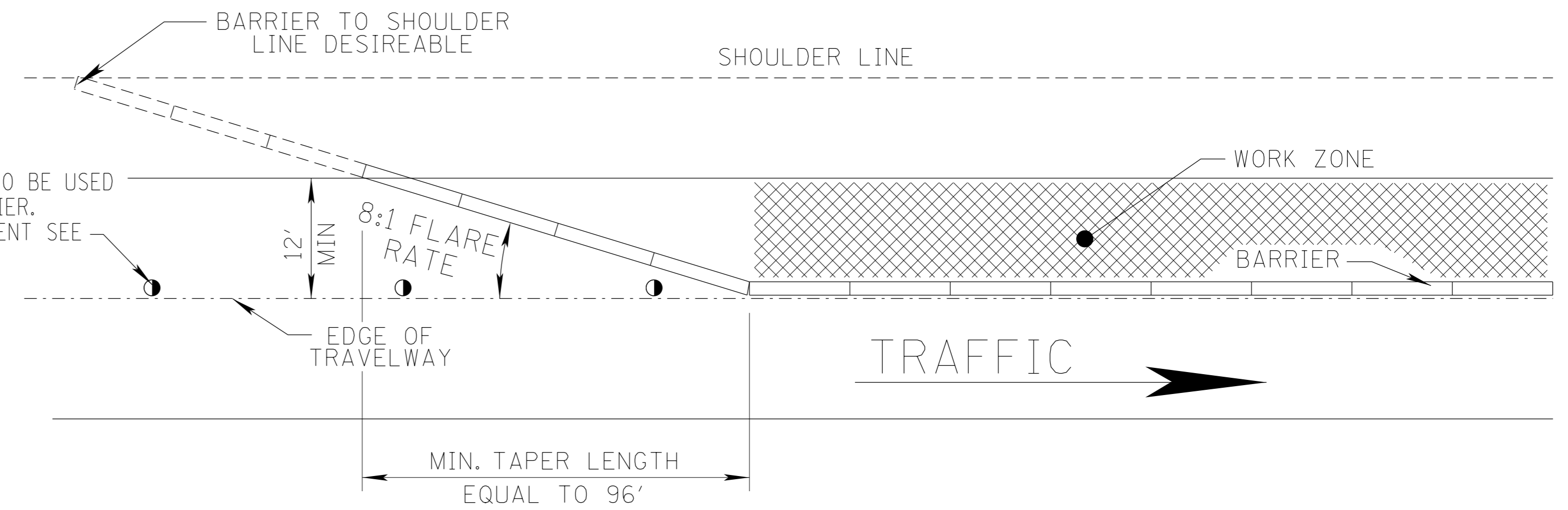

DETAIL OF TAPER FOR POSITIVE BARRIER IN WORK ZONE

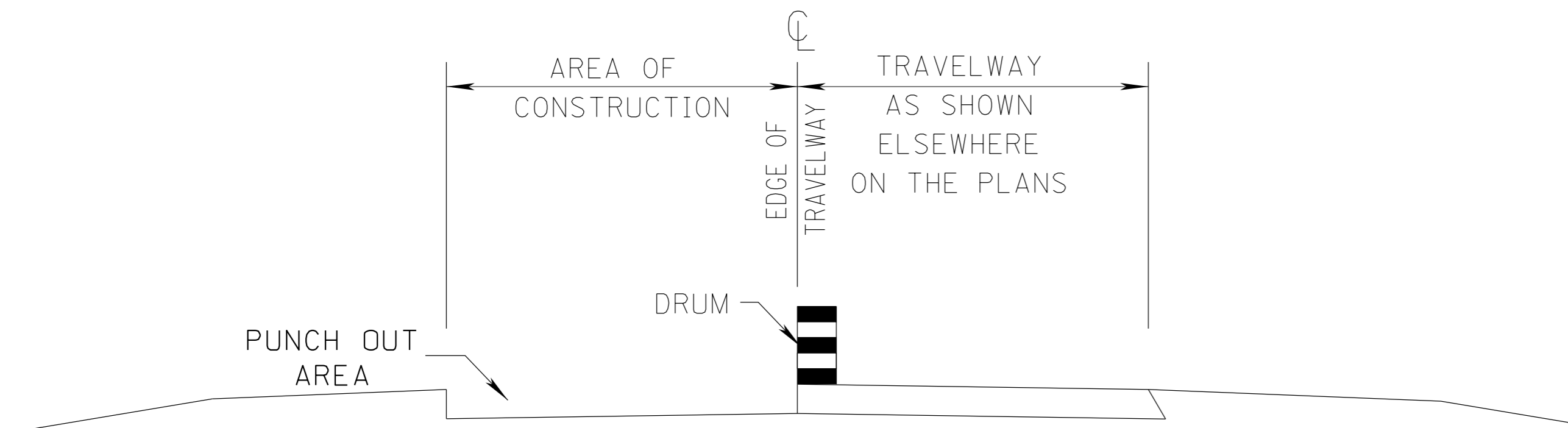

ELEVATION VIEW FOR DRUM

- ① LANE CLOSURES WITH OPEN PUNCH OUT AREAS MAY NOT BE LEFT UNATTENDED WHEN DRUMS ARE BEING USED FOR LANE CLOSURE

PLAN C.A.D.S. SECTION MISSISSIPPI DEPARTMENT OF TRANSPORTATION



MISSISSIPPI DEPARTMENT OF TRANSPORTATION	
LANE CLOSURE DETAILS	
(PRECAST CONCRETE BARRIER)	
PROJECT NO. : BR-0845-00(006)	
COUNTY : LAFAYETTE	
WORKING NUMBER	LCD-1
FILENAME: V8_dgns/bartap.dgn.	SHEET NUMBER
2-14-14 DATE	80
DESIGN TEAM	CHECKED DATE