

SECTION 905 -- PROPOSAL (CONTINUED)

I (We) further propose to execute the attached contract agreement (Section 902) as soon as the work is awarded to me (us), and to begin and complete the work within the time limit(s) provided for in the Specifications and Advertisement. I (We) also propose to execute the attached contract bond (Section 903) in an amount not less than one hundred (100) percent of the total of my (our) part, but also to guarantee the excellence of both workmanship and materials until the work is finally accepted.

I (We) enclose a certified check, cashier's check or bid bond for **five percent (5%) of total bid** and hereby agree that in case of my (our) failure to execute the contract and furnish bond within Ten (10) days after notice of award, the amount of this check (bid bond) will be forfeited to the State of Mississippi as liquidated damages arising out of my (our) failure to execute the contract as proposed. It is understood that in case I am (we are) not awarded the work, the check will be returned as provided in the Specifications.

Bidder acknowledges receipt of and has added to and made a part of the proposal and contract documents the following addendum (addenda):

ADDENDUM NO. 1 DATED 4/15/2014 ADDENDUM NO. DATED
ADDENDUM NO. DATED ADDENDUM NO. DATED

Number	Description
1	Revise NTB No. 4940; Amendment EBS Download Required.

TOTAL ADDENDA: 1
(Must agree with total addenda issued prior to opening of bids)

Respectfully Submitted,

DATE _____

Contractor

BY _____
Signature

TITLE _____

ADDRESS _____

CITY, STATE, ZIP _____

PHONE _____

FAX _____

E-MAIL _____

(To be filled in if a corporation)

Our corporation is chartered under the Laws of the State of _____ and the names, titles and business addresses of the executives are as follows:

_____ President	_____ Address
_____ Secretary	_____ Address
_____ Treasurer	_____ Address

The following is my (our) itemized proposal.

Revised 09/21/2005

MP-6057-21(007) / 305186301

Greene County(ies)

MISSISSIPPI DEPARTMENT OF TRANSPORTATION

SECTION 904 - NOTICE TO BIDDERS NO. 4940

CODE: (SP)

DATE: 03/10/2014

SUBJECT: Scope of Work

PROJECT: MP-6057-21(007) / 305186301 -- Greene County

The contract documents do not include an official set of construction plans but may, by reference, include some Standard Drawings when so specified in a Notice to Bidders entitled, "Standard Drawings". All other references to plans in the contract documents and Standard Specifications for Road and Bridge Construction are to be disregarded.

Work on the project shall consist of the following:

STATE ROUTE 57
OVERLAY STATE ROUTE 57, FROM THE GEORGE COUNTY LINE
NORTH TO JCT. OF SR 198, 7.2 MILES
STA. 496+84 TO STA. 882+30

(A) Prior to the overlay, centerline alignment shall be determined by the Contractor by measuring the existing roadway at 500-foot intervals in tangent sections, and 100-foot intervals in horizontal curves.

(B) Cold mill 100-foot transitions at the B.O.P. and E.O.P., also cold mill 100-foot transitions on the north and south sides of the rail road right-of-way; local roads to ROW as directed by the Project Engineer, bridge approaches and any other areas designated by the Project Engineer to ensure smooth transition of new overlay with existing grade. (See Typical Drawings).

(C) Five areas have been identified for base repair. They are located as follows:

<u>Location</u>	<u>Lane</u>	<u>Size</u>	<u>Area (sf)</u>
Station 509+34	Right	6' x 10'	60
Station 509+45	Left	6' x 10'	60
Station 547+84	Left	6' x 56'	336
Station 691+75	Left	6' x 75'	450
Station 703+30	Right	6' x 100'	600

These failed areas shall be repaired by full depth removal and backfilling. Approximately 66 tons of Ultra-Thin Asphalt Pavement will be used for backfill in all removal sections. Additional areas may be added as required by the Project Engineer.

(D) Eight locations have been identified to be pre-leveled to remove rutting in the wheel paths.

They are located as follows:

Location	Lane	Size	Area (sf)
Station 564+20	Left & Right	22' x 100'	2,200
Station 686+30	Right	11' x 170'	1,870
Station 686+90	Left	6' x 100	600
Station 689+50	Left	6' x 40'	240
Station 690+90	Right	6' x 75'	450
Station 830+60	Left & Right	22'x 106'	2,332
Station 842+20	Left & Right	22' x 50'	1,100
Station 843+70	Left	6' x 100'	600

185 tons have been added to Pay Item 907-411-A001, Ultra-Thin Asphalt Pavement, for the leveling of these locations.

(E) Prior to placement of the asphalt, all raised pavement markers throughout the project shall be removed (cost absorbed). Overlay State Route 57 and all side roads to state ROW, with 3/4" Ultra-Thin Asphalt ST mixture. Publicly maintained roads or streets shall be surfaced to the existing R.O.W. only if they have an existing asphalt surface; privately owned entrances shall be surfaced a distance of 10 feet & variable from edge of pavement. Any site grading at local roads or drives will not be measured for separate payment but will be considered an absorbed item.

(F) The Mean Roughness Index (MRI) shall be used to determine the pavement smoothness. Smoothness incentive/disincentive will be governed by special provision for MRI. All incentive/disincentive will be based on theoretical tonnage.

(G) Temporary and permanent striping shall be placed where existing stripes are located, and shall conform to finished stripe specifications for alignment, neatness, reflectivity, and straightness. When the centerline or turn lane stripe is removed during milling operations, temporary stripe shall be placed prior to opening the roadway to traffic. All permanent pavement markings on asphalt are to be hot thermoplastic. Edge lines will be placed so as to maintain the original lane width. Glass beads applied to thermoplastic shall conform to Subsection 720.01.

(H) Raised pavement markers will be placed at 80-foot intervals in tangents and 40-foot intervals in curves along the centerline of roadway. Only flexible adhesive shall be allowed for placement of raised pavement markers meeting the requirements of Subsection 720.03.7.7 of the Mississippi Standard Specifications for Road and Bridges

(I) The existing shoulders shall be raised to match the new pavement with Crushed Stone Base. Placement of the shoulder material(s) on the finished surface course shall not be permitted. The material(s) shall be bladed, rolled, and compacted to a finished slope of 4% where practical. Shoulders with existing adequate shoulder material in place shall be bladed to a slope of 4%, the cost of which shall be included in the prices of other items bid.

(J) It shall be the responsibility of the Contractor to protect existing structures such as pipes, inlets, aprons, bridges, etc. from damage which might occur during construction. The Contractor shall replace or repair, as directed by the Engineer, any structures damaged during the life of the contract. No payment will be made for the replacement or repair of damaged items.

(K) Incidental work such as removing vegetation, shaping and compaction of shoulder, removing excess asphalt material, project clean-up, and other incidental work necessary to complete the project will not be measured for separate payment, but will be included in other bid items.

(L) If pavement section marking tape is encountered on this project, it shall be located prior to overlaying and placed back in same location after paving operations have ceased. The section marking shall be eight inch high performance cold plastic detail stripe and shall be four feet in length. The marking shall be centered across the centerline stripe. The cost of this item shall be absorbed in other bid items.

(M) All Construction signing as well as Plastic Traffic Drums and Barricades are included in the bid for Pay Item 618-A, Maintenance of Traffic. Fluorescent orange sheeting shall be used on all construction and traffic control signs except for R4-1 and R4-2 signs which shall be black legend and border on white background. The Contractor shall erect and maintain construction signing, and provide all signs and traffic handling devices in accordance with Manual Uniform Traffic Control Devices (MUTCD).

MP - 6057 - 21 (007) / 305186301
GREENE CO

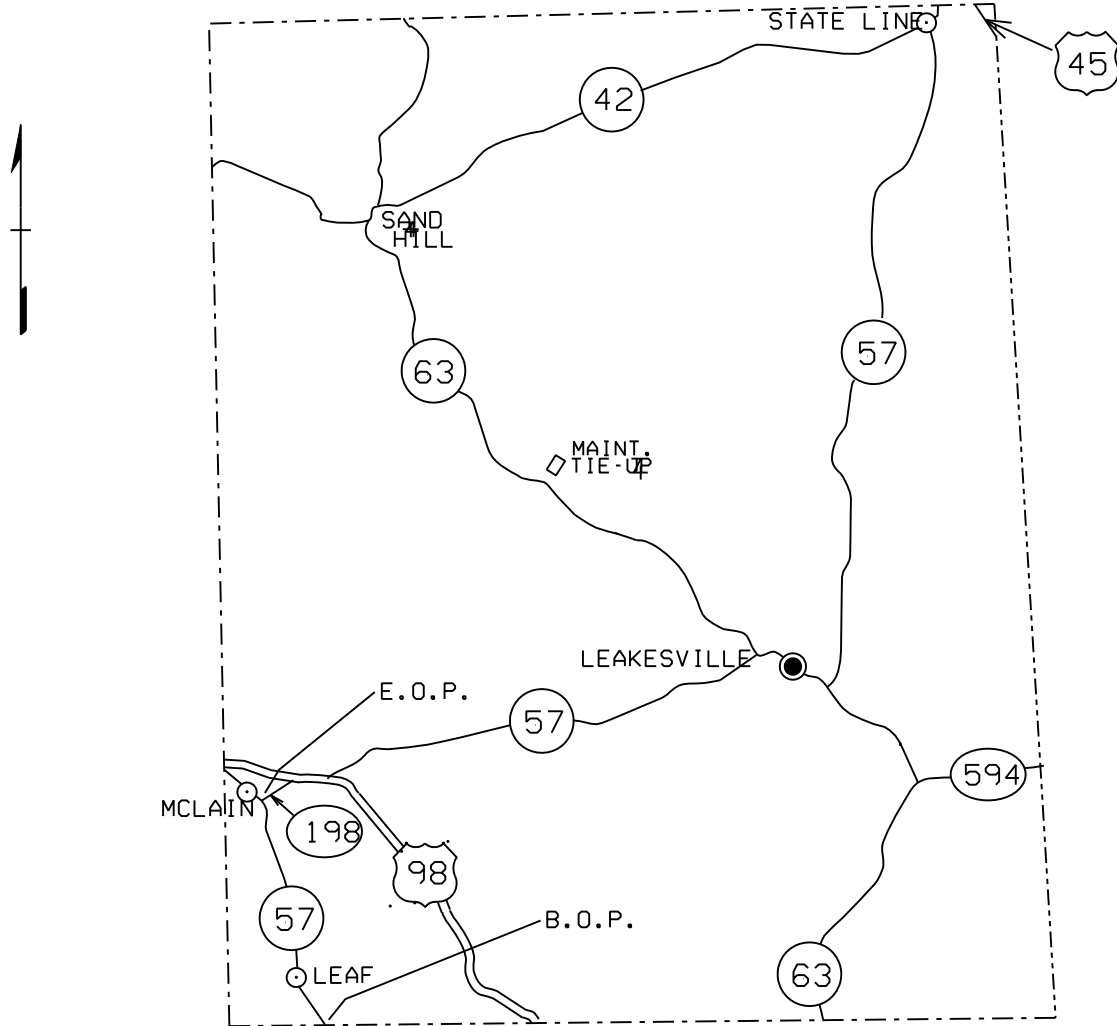

THE ABOVE REFERENCED PROJECT IS FOR
OVERLAYING SR 57 FROM THE GEORGE
COUNTY LINE, NORTH TO THE JUNCTION
OF STATE ROUTE 198.

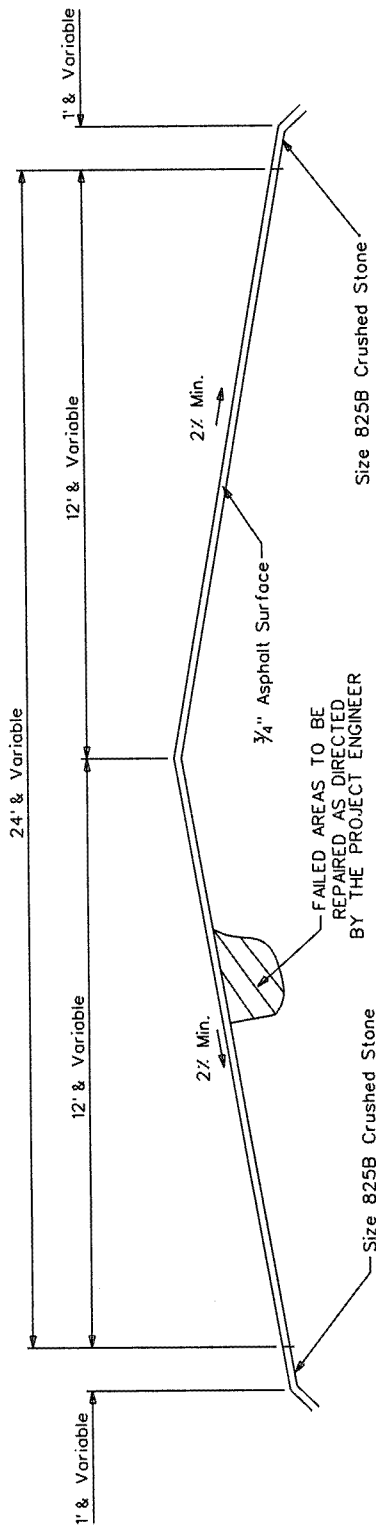

NOTES:

- (1) THE EXISTING PAVEMENT EDGE SHALL BE CUT TO A SMOOTH AND NEAR VERTICAL FACE WITH AN APPROVED CUTTING DEVICE. (NOTE MEASURED FOR SEPARATE PAY.)
- (2) TRUE CENTERLINE PAVEMENT ALIGNMENT SHALL BE DETERMINED BY THE CONTRACTOR BY MEASURING THE EXISTING ROADWAY AT 500ft. INTERVALS IN TANGENT SECTIONS, AND 100ft. INTERVALS IN HORIZONTAL CURVES.

TYPICAL MILLING DIAGRAM

(As Per Part B of Scope of Work)

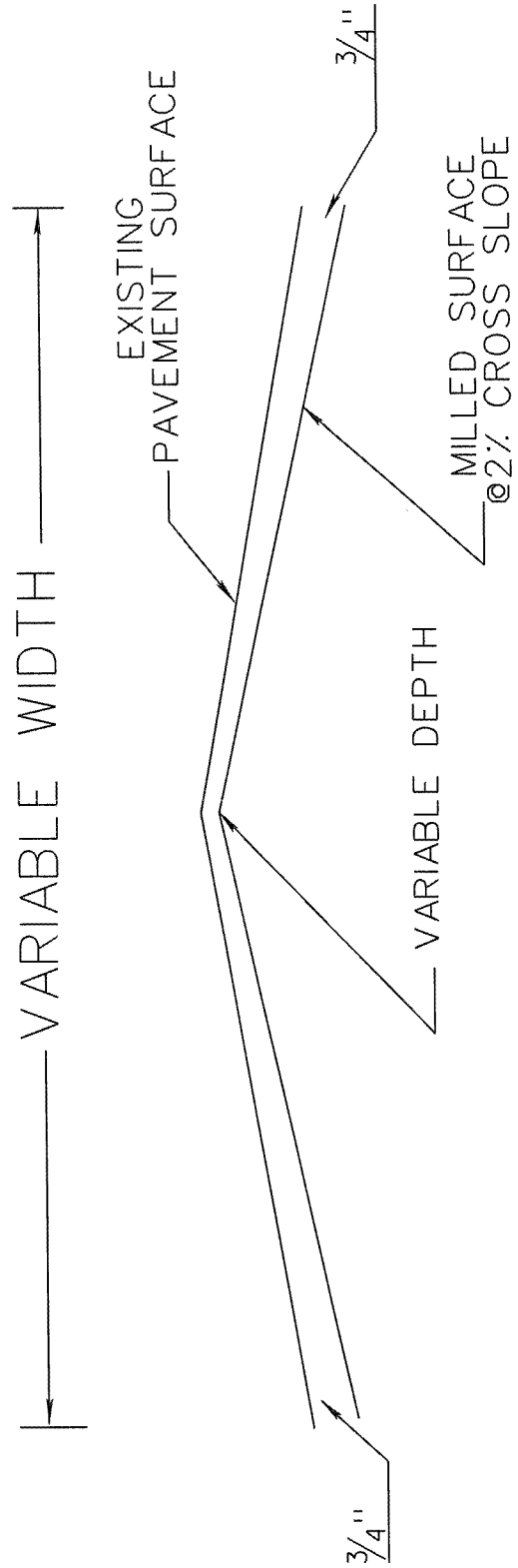

TYPICAL MILLED TRANSITION AT BRIDGE ABUT. OR PAVEMENT IN PLACE

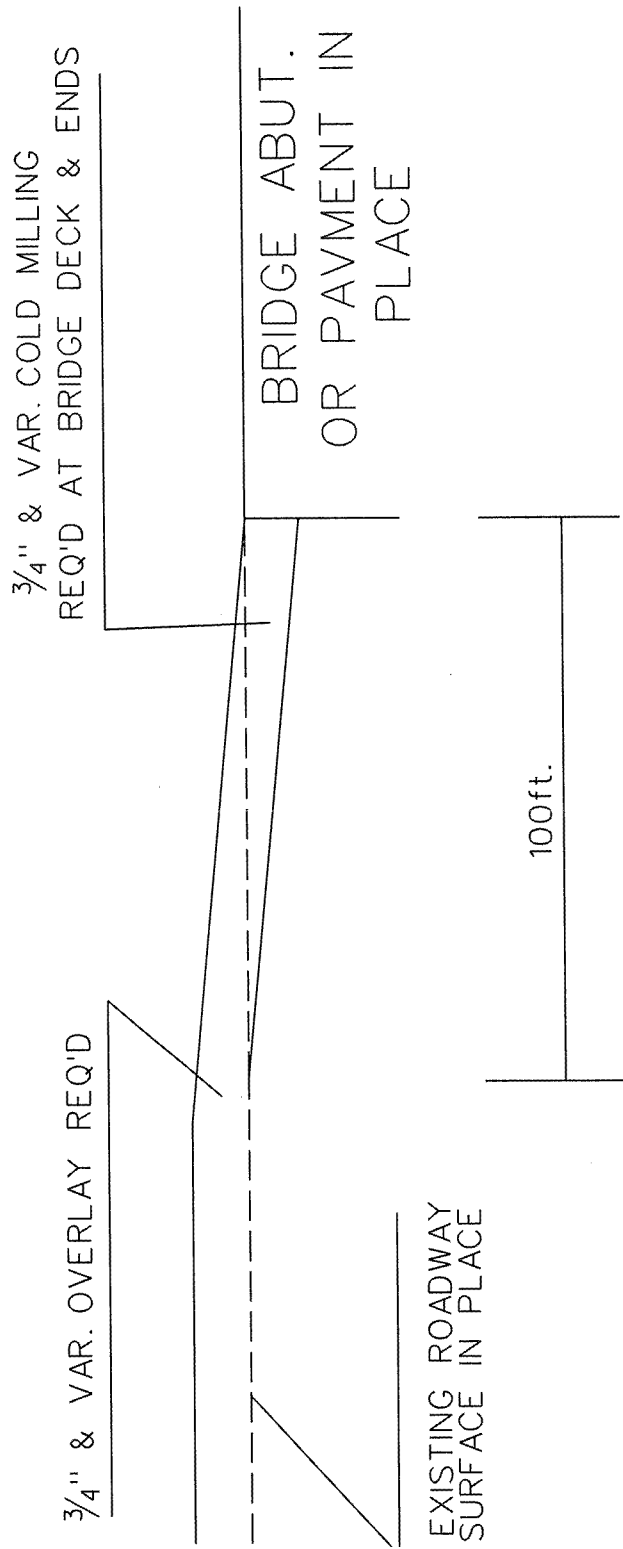

PRIVATE DRIVEWAY DETAIL

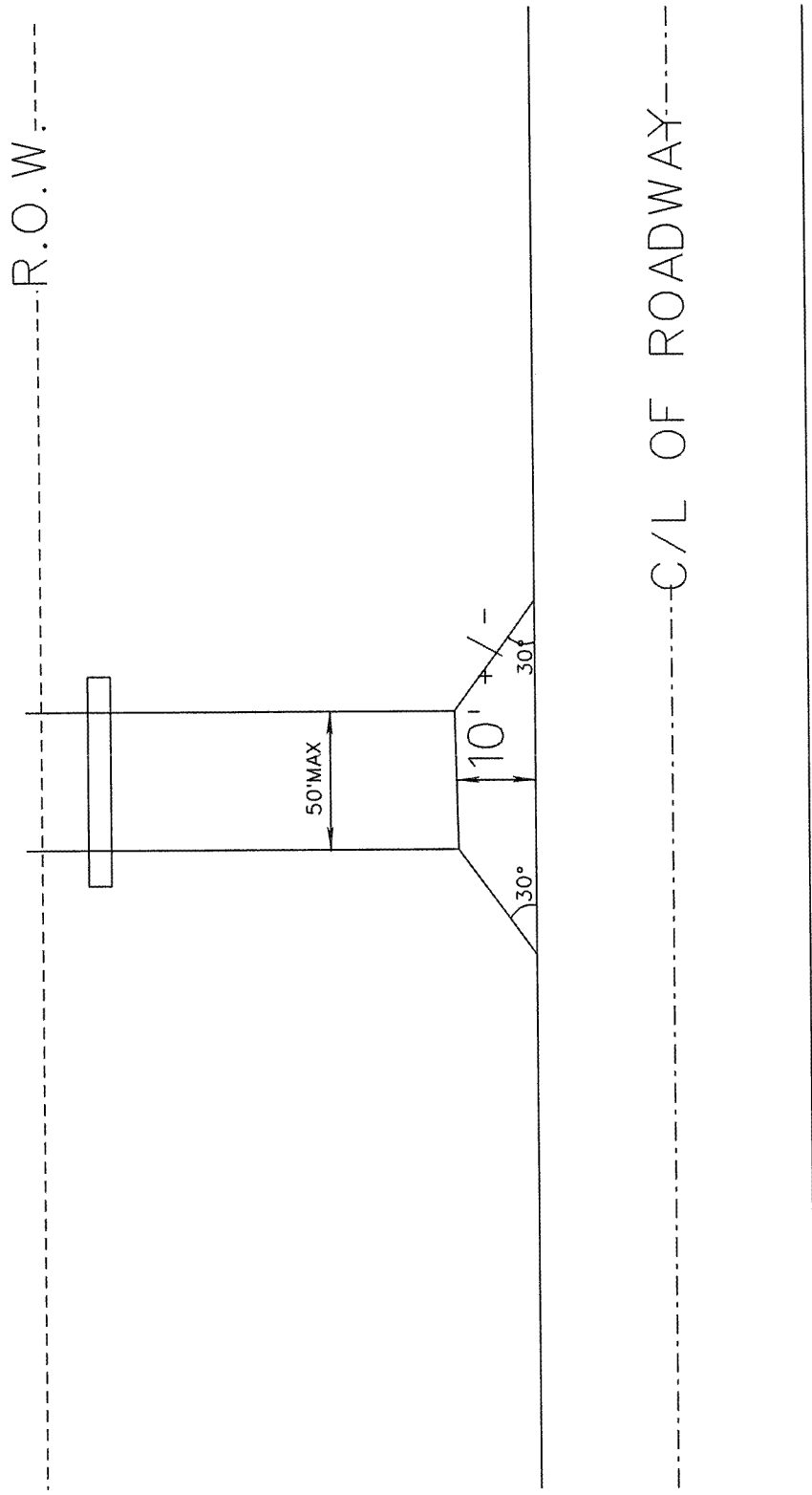

TYPICAL FOR PAVED TAPER AT LOCAL ROADS

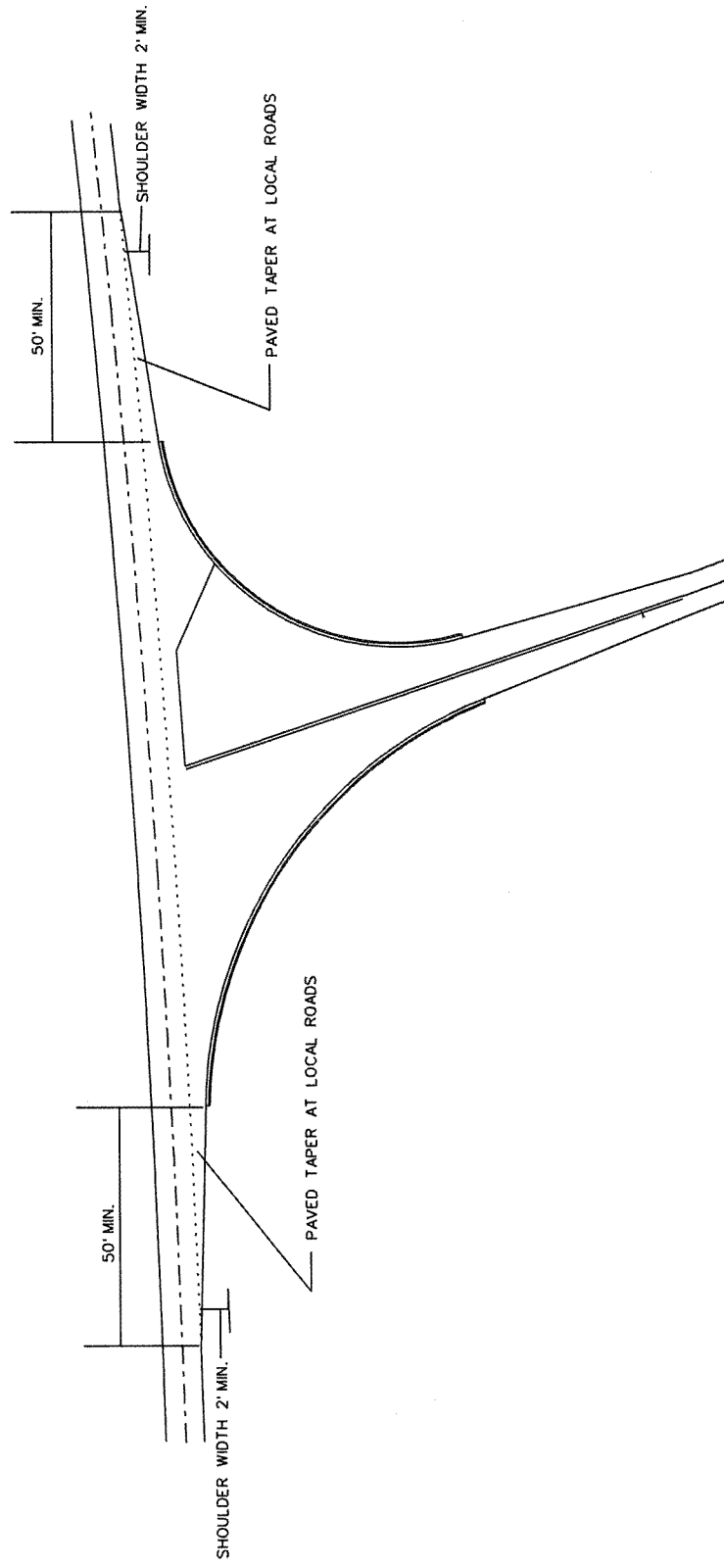

TYPICAL STRIPING FOR SIMPLE INTERSECTION AT LOCAL ROADS

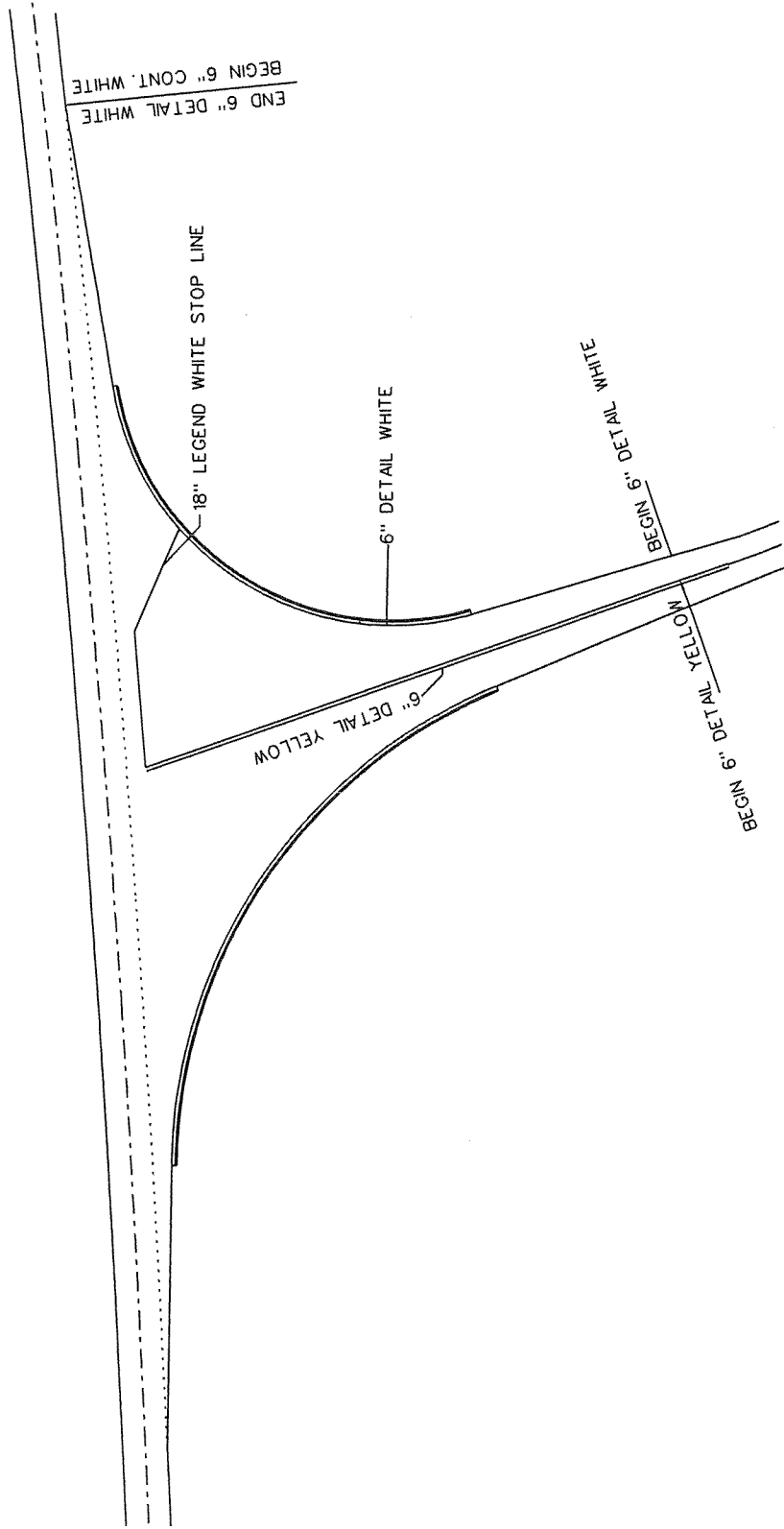

STATE	PROJECT NO.
MISS.	

TYPICAL FOR RAISED PAVEMENT MARKERS
PLACED ON SIDE ROAD RADIUS

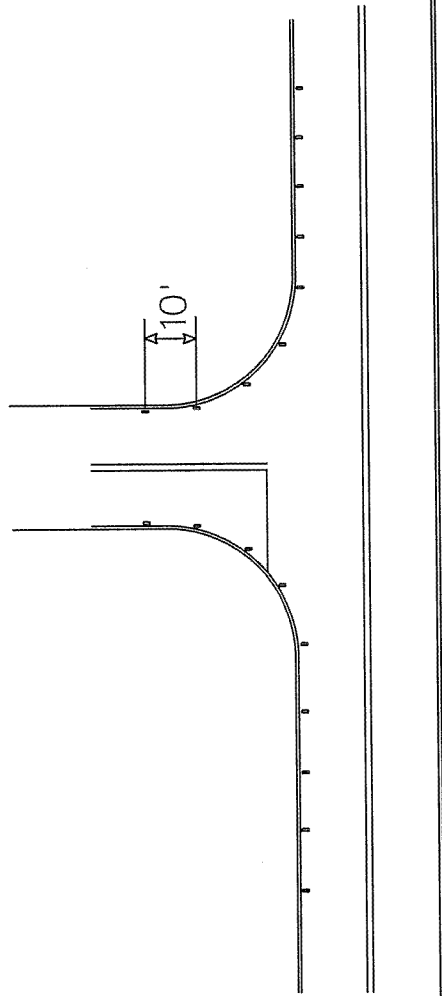

- NOTE 1. MARKERS SHALL BE PLACED EVERY 10 FEET.
- NOTE 2. MARKERS SHALL BE VISIBLE FROM THE TRAVELING MOTORIST ON STATE DESIGNATED HIGHWAYS.
- NOTE 3. MARKERS SHALL BE HIGH PERFORMANCE TWO WAY CLEAR.

MISSISSIPPI DEPARTMENT OF TRANSPORTATION	
2-LANE	
RAISED PAVEMENT MARKERS	
PLACED ON SIDE ROADS	
DATE	DATE
BY	BY
REVISION	REVISION
FILE NAME	FILE NAME
EXPIRE TIME	EXPIRE TIME
PROJECT NUMBER	PROJECT NUMBER
SHEET NUMBER	SHEET NUMBER