

SECTION 905 -- PROPOSAL (CONTINUED)

I (We) hereby certify by digital signature and electronic submission via Bid Express of the Section 905 proposal below, that all certifications, disclosures and affidavits incorporated herein are deemed to be duly executed in the aggregate, fully enforceable and binding upon delivery of the bid proposal. I (We) further acknowledge that this certification shall not extend to the bid bond or alternate security which must be separately executed for the benefit of the Commission. This signature does not cure deficiencies in any required certifications, disclosures and/or affidavits. I (We) also acknowledge the right of the Commission to require full and final execution on any certification, disclosure or affidavit contained in the proposal at the Commission's election upon award. Failure to so execute at the Commission's request within the time allowed in the Standard Specifications for execution of all contract documents will result in forfeiture of the bid bond or alternate security.

Bidder acknowledges receipt of and has added to and made a part of the proposal and contract documents the following addendum (addenda):

ADDENDUM NO. 1 DATED 9/19/2016 ADDENDUM NO. DATED
 ADDENDUM NO. DATED ADDENDUM NO. DATED

Number	Description
1	Revised Table of Contents; Add NTB Nos. 3704, & 6691; Amendment EBS Download Required.

TOTAL ADDENDA: 1
 (Must agree with total addenda issued prior to opening of bids)

Respectfully Submitted,

DATE _____

 Contractor

BY _____
 Signature

TITLE _____

ADDRESS _____

CITY, STATE, ZIP _____

PHONE _____

FAX _____

E-MAIL _____

(To be filled in if a corporation)

Our corporation is chartered under the Laws of the State of _____ and the names, titles and business addresses of the executives are as follows:

 President Address

 Secretary Address

 Treasurer Address

The following is my (our) itemized proposal.

NHPP-0002-06(022)/ 107209301000

Lee County(ies)

Revised 01/26/2016

**MISSISSIPPI DEPARTMENT OF TRANSPORTATION
TABLE OF CONTENTS**

PROJECT: NHPP-0002-06(022)/107209301 - Lee

Section 901 - Advertisement

Section 904 - Notice to Bidders

#1	Governing Specifications
#3	Final Cleanup
#640	Fiber Reinforced Concrete
#927	Use of Fly Ash in Stone Matrix Asphalt (SMA)
#1405	Errata & Modifications to 2004 Standard Specifications
#1928	Federal Bridge Formula
#2382	Status of ROW, w/ Attachments
#3067	Storm Water Discharge Associated with Construction Activities (≥ 1 and < 5 Acres)
#3131	Temporary Traffic Paint
#3612	Additional Erosion Control Requirements
#3704	Use of Precast Drainage Units
#3893	Petroleum Products Base Price
#4189	Rumble Stripe
#4214	Safety Apparel
#4473	Alternate Crushed Stone Base Bid Items
#4526	Electronic Addendum Process
#4565	Manual on Uniform Traffic Control Devices (MUTCD)
#5044	Questions Regarding Bidding
#5053	Contractor Correspondence
#5405	Traffic Control Devices
#5411	Safety Edge
#5412	Weight Limits
#5545	Burn-in Period
#5556	DUNS Requirement for Federal Funded Projects
#5824	Adjustments for Bituminous Materials
#5865	Non-Quality Control / Quality Assurance Concrete
#5866	Payroll Requirements
#5896	DBE Forms, Participation and Payment
#6411	Disadvantaged Business Enterprise, w/ Supplement
#6601	Contract Time
#6602	Specialty Items
#6603	Road Closure Restrictions
#6691	Cooperation Between Contractors
906	Required Federal Contract Provisions -- FHWA 1273, w/Supplements

Section 907 - Special Provisions

907-101-4	Definitions
907-102-12	Bidding Requirements and Conditions
907-103-11	Award and Execution

PROJECT: NHPP-0002-06(022)/107209301 - Lee

907-104-5	Scope of Work
907-104-6	Partnering Process
907-105-9	Control of Work, w/ Supplement
907-107-13	Legal Relations and Responsibility to Public, w/ Supplement
907-107-14	Contractor's Protection Plan, w/ Supplement
907-108-38	Prosecution and Progress
907-109-8	Measurement and Payment
907-110-2	Wage Rates
907-216-1	Solid Sodding
907-225-5	Grassing
907-226-3	Temporary Grassing
907-227-10	Hydroseeding
907-234-5	Siltation Barriers
907-237-4	Wattles
907-245-2	Triangular Silt Dikes
907-246-3	Sandbags & Rockbags
907-249-1	Riprap for Erosion Control
907-304-13	Granular Courses
907-401-5	Stone Matrix Asphalt (SMA), w/ Supplement
907-401-7	Asphalt Pavements, w/ Supplement
907-403-13	Stone Matrix Asphalt (SMA), w/ Supplement
907-403-14	Asphalt Pavements
907-406-4	Cold Milling
907-407-2	Tack Coat
907-601-1	Structural Concrete
907-618-9	Placement of Temporary Traffic Stripe
907-618-13	Temporary Construction Signs
907-626-25	Thermoplastic Traffic Markings
907-630-16	Sign Supports
907-639-8	Traffic Signal and ITS Equipment Poles
907-641-6	Signal Radar Detection
907-642-5	Solid State Traffic Actuated Controllers
907-645-5	Flashing Assembly
907-658-8	Networking Equipment
907-699-5	Construction Stakes
907-701-5	Hydraulic Cement, w/ Supplement
907-702-5	Specifications for Bituminous Materials
907-703-12	Aggregates, w/ Supplement
907-708-6	Non-Metal Drainage Structures
907-710-1	Fast Dry Solvent Traffic Paint
907-711-4	Synthetic Structural Fiber Reinforcement
907-713-6	Admixtures for Concrete
907-714-3	Stabilizing Fibers
907-714-8	Miscellaneous Materials
907-715-4	Roadside Development Materials
907-720-2	Pavement Marking Materials
907-721-5	Ground Mounted Sign Supports

PROJECT: NHPP-0002-06(022)/107209301 - Lee

907-804-19 Concrete Bridges and Structures, w/ Supplement
907-815-2 Sediment Control Stone

Section 905 - Proposal, Proposal Bid Items, Combination Bid Proposal
Certification of Performance - Prior Federal-Aid Contracts
Certification Regarding Non-Collusion, Debarment and Suspension
SAM.GOV Registration and DUNS Number
Section 902 - Contract Form
Section 903 - Contract Bond Forms
Form -- OCR-485

(REVISIONS TO THE ABOVE WILL BE INDICATED ON THE SECOND SHEET
OF SECTION 905 AS ADDENDA)

09/19/2016 01:49 PM

MISSISSIPPI DEPARTMENT OF TRANSPORTATION

SECTION 904 - NOTICE TO BIDDERS NO. 3704

CODE: (SP)

DATE: 11/30/2011

SUBJECT: Use of Precast Drainage Units

Bidders attention is brought to the content of Subsection 601.02.3 regarding precast units. MDOT Drawing Sheet Nos. PCU-1 and PCU-2 address MDOT approved precast drainage units. The Contractor must make a request to the Project Engineer for approval to use precast units other than the ones shown on Drawing Sheet No. PCU-1 or PCU-2.

Bidders are advised that precast drainage unit tops are only allowed on units shown on Drawing Sheet No. PCU-1. Cast-In-Place drainage unit tops are required on units shown on Drawing Sheet No. PCU-2.

GENERAL DATA

INLET OR JUNCTION BOX FEET	WALL THICKNESS INCHES	INSET INCHES	OUTSIDE DIMENSION ON TOP OF COVER INCHES	BASE RISE		RISER HEIGHT		WEIGHTS	
				INCHES	INCHES	LB	LB	LB	LB
2 X 2	3.10	24	24	31	24.54	19.48	300	401	800
2 X 3	5	24	24	36	46	24.54	450	735	815
2 X 5	6	24	24	60	70	24.54	1548	1114	1577

2 X 2 WALL REINFORCEMENT (SQ. IN. PER LIN. FT.)

DEPTH OF INSTALLATION FT.	BASE		TOP RISER		INTERIOR RISER #1		INTERIOR RISER #2		INTERIOR RISER #4	
	AREA	LB/FT	AREA	LB/FT	AREA	LB/FT	AREA	LB/FT	AREA	LB/FT
0.4	0.07	3.842	-	-	-	-	-	-	-	-
0.5	0.14	7.684	0.07	3.842	-	-	-	-	-	-
0.512	0.20	7.786	0.07	3.842	0.13	5.862	-	-	-	-

2 X 3 WALL REINFORCEMENT (SQ. IN. PER LIN. FT.)

DEPTH OF INSTALLATION FT.	BASE		TOP RISER		INTERIOR RISER #1		INTERIOR RISER #2		INTERIOR RISER #4	
	AREA	LB/FT	AREA	LB/FT	AREA	LB/FT	AREA	LB/FT	AREA	LB/FT
0.4	0.10	5.840	-	-	-	-	-	-	-	-
0.5	0.20	9.680	0.10	5.840	-	-	-	-	-	-
0.512	0.29	9.659	0.10	5.840	0.20	9.528	-	-	-	-

3 X 5 WALL REINFORCEMENT (SQ. IN. PER LIN. FT.)

DEPTH OF INSTALLATION FT.	BASE		TOP RISER		INTERIOR RISER #1		INTERIOR RISER #2		INTERIOR RISER #4	
	AREA	LB/FT	AREA	LB/FT	AREA	LB/FT	AREA	LB/FT	AREA	LB/FT
0.4	0.14	6.560	-	-	-	-	-	-	-	-
0.5	0.28	13.120	0.14	6.560	-	-	-	-	-	-
0.512	0.39	13.054	0.14	6.560	0.28	13.120	0.14	6.560	0.28	13.120

COVER/BOTTOM REINFORCEMENT

INLET OR JUNCTION BOX	COVER	LEB/STEEL		BOTTOM	LEB/STEEL
		AREA	LB/FT		
2 X 2	44 @ 3" EW	13.247	13.247	WWF-WLS X WLS - 3 X 3	10.000
2 X 3	44 @ 3" EW	17.689	17.689	WWF-WLS X WLS - 3 X 3	14.602
2 X 5	44 @ 3" EW	36.141	36.141	WWF-WLS X WLS - 3 X 3	37.206

NOTE: REINFORCEMENT STEEL USE PER REINFORCEMENT SCHEDULE. TOTAL BAR WEIGHT (TOP PLUS ANY INTERIOR RISERS) BASE HEIGHT + TOTAL HEIGHT OF RISER + COVER, HOLE AND GRATE OPENINGS NOT REDUCED.

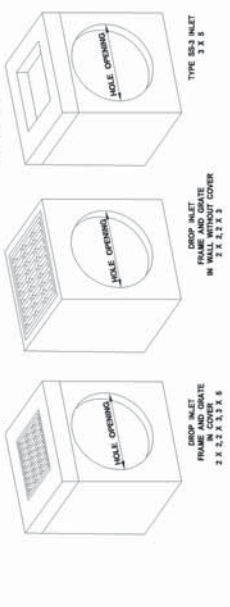

MAXIMUM PIPE SIZE

INLET OR JUNCTION BOX	ROUND RCP	ARCH RCP
2 X 2	12	18
2 X 3	12	24
2 X 5	12	30

CONCRETE QUANTITIES

INLET OR JUNCTION BOX	BOTTOM		RISER		COVER	
	C.Y.	SQ. FT.	C.Y.	SQ. FT.	C.Y.	SQ. FT.
2 X 2	0.074	0.999	0.133	1.667	0.133	1.667
2 X 3	0.148	1.998	0.266	3.334	0.266	3.334
2 X 5	0.296	3.996	0.532	6.668	0.532	6.668

NOTE: CONCRETE QUANTITIES PER INSTALLATION BOX BOTTOM + (TOTAL RISER HEIGHT) (PIPE CIVITY COVER) + GRATE OPENING NOT HOLE OPENING.

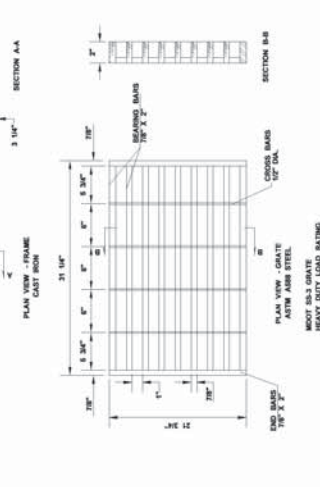
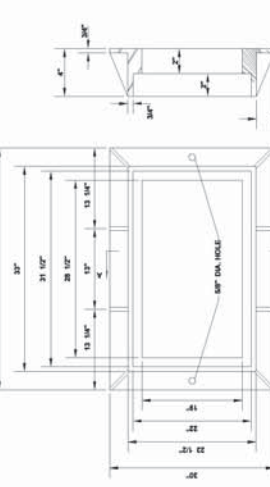

GENERAL NOTES:
 1. CONCRETE SHALL HAVE COMPRESSIVE STRENGTH OF 4000 PSI MINIMUM AT 28 DAYS.
 2. REINFORCING FOR BOTTOM AND WALLS SHALL BE WELDED WIRE FABRIC, ASTM A-185, AND OF THE AREA AS SHOWN IN TABLE.
 3. REINFORCING FOR COVER SHALL BE ASTM A618 AND OF THE SIZE AS SHOWN IN TABLE AND JOINT TO BE SEALED WITH FLEXIBLE PLASTIC GASKET FOR JOINT CONDUIT, ASHITO SPECIFICATION #1719 OR MEET SPECIFICATION.
 4. 5.2 1/2" LIFTING HOLES TO BE LOCATED ON EACH SIDE OF BOX SECTIONS FOR HANDLING.
 5. GROUT FOR JOINING PIPE TO PRECAST UNITS WILL BE A COMMERCIAL MASONRY GROUT MEETING MEET SPECIFICATIONS.
 6. WHEN INTERIOR RISERS ARE REQUIRED, UNITS SHALL BE MARKED TO IDENTIFY EACH UNIT.
 7. CONCRETE & REINFORCING STEEL FOR PRECAST INLETS AND JUNCTION BOXES SHALL BE PAID FOR AS THE CALCULATED QUANTITY SHOWN ON THE RECAP SHEET FOR CAST-IN-PLACE INLETS & JUNCTION BOXES.

MINIMUM PIPE DEPTH TO THE INVERT

ROUND RCP SIZE	DEPTH TO INVERT IN FEET	ARCH RCP SIZE	DEPTH TO INVERT IN FEET
12	27	18	33
18	33	24	39
24	39	30	45
30	45	36	51
36	51	42	57

CONCRETE QUANTITIES

INLET OR JUNCTION BOX	BOTTOM		RISER		COVER	
	C.Y.	SQ. FT.	C.Y.	SQ. FT.	C.Y.	SQ. FT.
2 X 2	0.074	0.999	0.133	1.667	0.133	1.667
2 X 3	0.148	1.998	0.266	3.334	0.266	3.334
2 X 5	0.296	3.996	0.532	6.668	0.532	6.668

NOTE: CONCRETE QUANTITIES PER INSTALLATION BOX BOTTOM + (TOTAL RISER HEIGHT) (PIPE CIVITY COVER) + GRATE OPENING NOT HOLE OPENING.

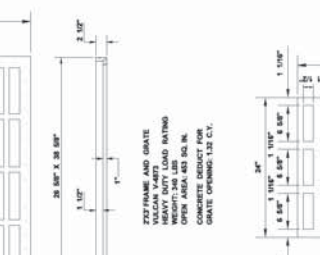

GENERAL NOTES:
 1. CONCRETE SHALL HAVE COMPRESSIVE STRENGTH OF 4000 PSI MINIMUM AT 28 DAYS.
 2. REINFORCING FOR BOTTOM AND WALLS SHALL BE WELDED WIRE FABRIC, ASTM A-185, AND OF THE AREA AS SHOWN IN TABLE.
 3. REINFORCING FOR COVER SHALL BE ASTM A618 AND OF THE SIZE AS SHOWN IN TABLE AND JOINT TO BE SEALED WITH FLEXIBLE PLASTIC GASKET FOR JOINT CONDUIT, ASHITO SPECIFICATION #1719 OR MEET SPECIFICATION.
 4. 5.2 1/2" LIFTING HOLES TO BE LOCATED ON EACH SIDE OF BOX SECTIONS FOR HANDLING.
 5. GROUT FOR JOINING PIPE TO PRECAST UNITS WILL BE A COMMERCIAL MASONRY GROUT MEETING MEET SPECIFICATIONS.
 6. WHEN INTERIOR RISERS ARE REQUIRED, UNITS SHALL BE MARKED TO IDENTIFY EACH UNIT.
 7. CONCRETE & REINFORCING STEEL FOR PRECAST INLETS AND JUNCTION BOXES SHALL BE PAID FOR AS THE CALCULATED QUANTITY SHOWN ON THE RECAP SHEET FOR CAST-IN-PLACE INLETS & JUNCTION BOXES.

HOLE OPENING

ROUND RCP SIZE	OPENING		ARCH		CONCRETE OPENING (C.V.)
	INCHES	INCHES	INCHES	INCHES	
12	12	12	12	12	12
18	18	18	18	18	18
24	24	24	24	24	24
30	30	30	30	30	30
36	36	36	36	36	36



WHEN HOLE OPENING IS IN 2" FROM WALL, THE HOLE SHALL BE CAST AND SHALL BE REINFORCED WITH 2" DIA. BARS. THE HOLE SHALL BE REINFORCED WITH 2" DIA. BARS. THE HOLE SHALL BE REINFORCED WITH 2" DIA. BARS.

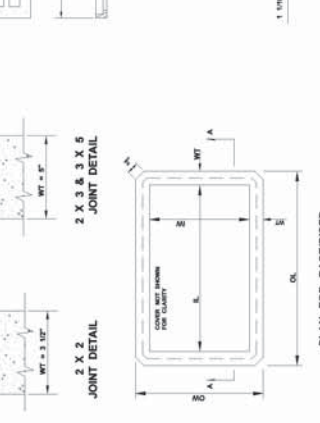
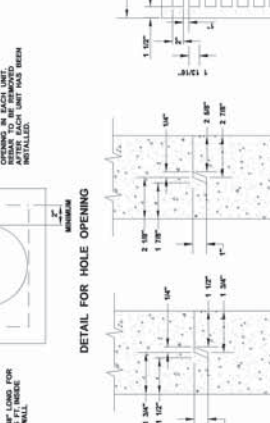

GENERAL NOTES:
 1. CONCRETE SHALL HAVE COMPRESSIVE STRENGTH OF 4000 PSI MINIMUM AT 28 DAYS.
 2. REINFORCING FOR BOTTOM AND WALLS SHALL BE WELDED WIRE FABRIC, ASTM A-185, AND OF THE AREA AS SHOWN IN TABLE.
 3. REINFORCING FOR COVER SHALL BE ASTM A618 AND OF THE SIZE AS SHOWN IN TABLE AND JOINT TO BE SEALED WITH FLEXIBLE PLASTIC GASKET FOR JOINT CONDUIT, ASHITO SPECIFICATION #1719 OR MEET SPECIFICATION.
 4. 5.2 1/2" LIFTING HOLES TO BE LOCATED ON EACH SIDE OF BOX SECTIONS FOR HANDLING.
 5. GROUT FOR JOINING PIPE TO PRECAST UNITS WILL BE A COMMERCIAL MASONRY GROUT MEETING MEET SPECIFICATIONS.
 6. WHEN INTERIOR RISERS ARE REQUIRED, UNITS SHALL BE MARKED TO IDENTIFY EACH UNIT.
 7. CONCRETE & REINFORCING STEEL FOR PRECAST INLETS AND JUNCTION BOXES SHALL BE PAID FOR AS THE CALCULATED QUANTITY SHOWN ON THE RECAP SHEET FOR CAST-IN-PLACE INLETS & JUNCTION BOXES.

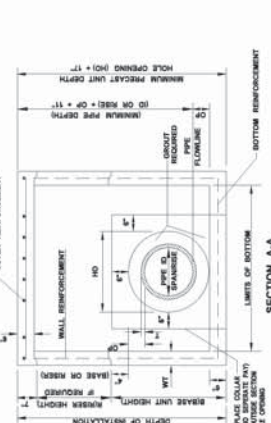

GENERAL NOTES:
 1. CONCRETE SHALL HAVE COMPRESSIVE STRENGTH OF 4000 PSI MINIMUM AT 28 DAYS.
 2. REINFORCING FOR BOTTOM AND WALLS SHALL BE WELDED WIRE FABRIC, ASTM A-185, AND OF THE AREA AS SHOWN IN TABLE.
 3. REINFORCING FOR COVER SHALL BE ASTM A618 AND OF THE SIZE AS SHOWN IN TABLE AND JOINT TO BE SEALED WITH FLEXIBLE PLASTIC GASKET FOR JOINT CONDUIT, ASHITO SPECIFICATION #1719 OR MEET SPECIFICATION.
 4. 5.2 1/2" LIFTING HOLES TO BE LOCATED ON EACH SIDE OF BOX SECTIONS FOR HANDLING.
 5. GROUT FOR JOINING PIPE TO PRECAST UNITS WILL BE A COMMERCIAL MASONRY GROUT MEETING MEET SPECIFICATIONS.
 6. WHEN INTERIOR RISERS ARE REQUIRED, UNITS SHALL BE MARKED TO IDENTIFY EACH UNIT.
 7. CONCRETE & REINFORCING STEEL FOR PRECAST INLETS AND JUNCTION BOXES SHALL BE PAID FOR AS THE CALCULATED QUANTITY SHOWN ON THE RECAP SHEET FOR CAST-IN-PLACE INLETS & JUNCTION BOXES.

GENERAL DATA				WEIGHTS			
SS-2 INLET SIZE	WALL THICKNESS	INSIDE DIMENSION	BASE HEIGHT	BOTTOM	BASE RISER	INLET TOP	EXTENSION TOP
FEET	INCHES	INCHES	INCHES	LB	LB	LB	LB
3 X 6	6	48	24.42	115	1114	102	1575

3" x 6" WALL REINFORCEMENT (SQ. IN. PER LIN. FT.)			
DEPTH OF INSTALLATION	BASE	TOP RISER	INTERIOR RISER #1
FEET	AREA	AREA	AREA
0-8	0.30	26.975	0.50
0-10	0.38	33.975	0.60
0-12	0.46	40.975	0.74
0-14	0.54	47.975	0.90
0-16	0.62	54.975	1.06
0-18	0.70	61.975	1.24
0-20	0.78	68.975	1.42
0-22	0.86	75.975	1.61
0-24	0.94	82.975	1.80

CONCRETE QUANTITIES			
SS-2 INLET SIZE	EXTENSION	TOP	EXTENSION
FEET	C.Y.	C.Y.	LB/STEEL
3	0.275	0.644	116.696
6	0.550	1.288	233.392

BOTTOM/EXTENSION REINFORCEMENT			
SS-2 INLET SIZE	BOTTOM	TOP	EXTENSION
FEET	LB/STEEL	LB/STEEL	LB/STEEL
3	355	38.500	38.305
6	710	77.000	76.610

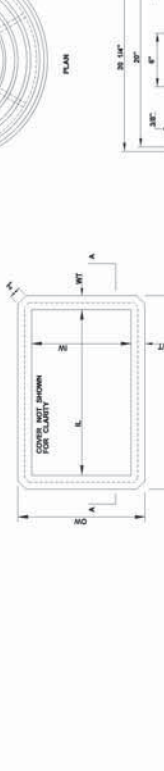

MINIMUM PIPE DEPTH WITHOUT EXTENSION TOP OF CURB UNIT TO PIPE INVERT			
ROUND RCP SIZE	DEPTH INCHES	ARCH RCP SIZE	DEPTH INCHES
12	20	4	0.977
15	25	4.5	0.933
18	30	5	0.889
21	35	5.5	0.845
24	40	6	0.801
27	45	6.5	0.757
30	50	7	0.713

MINIMUM PIPE DEPTH WITH EXTENSION TOP OF CURB UNIT TO PIPE INVERT			
ROUND RCP SIZE	DEPTH INCHES	ARCH RCP SIZE	DEPTH INCHES
12	65	-	-
15	68	-	-
18	71	-	-
21	74	-	-
24	77	-	-
27	80	-	-
30	83	-	-

HOLE OPENING			
ROUND RCP SIZE	INCHES	ARCH RCP SIZE	INCHES
12	20	4	0.977
15	25	4.5	0.933
18	30	5	0.889
21	35	5.5	0.845
24	40	6	0.801
27	45	6.5	0.757
30	50	7	0.713

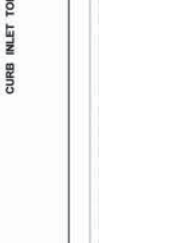
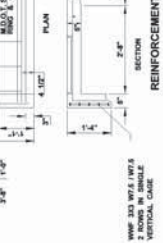
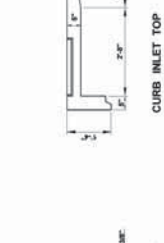
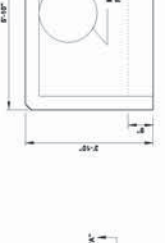

HOLE OPENING			
ROUND RCP SIZE	INCHES	ARCH RCP SIZE	INCHES
12	20	4	0.977
15	25	4.5	0.933
18	30	5	0.889
21	35	5.5	0.845
24	40	6	0.801
27	45	6.5	0.757
30	50	7	0.713

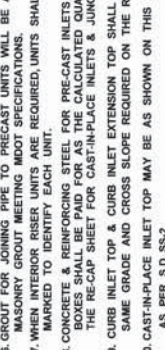
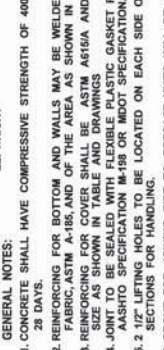
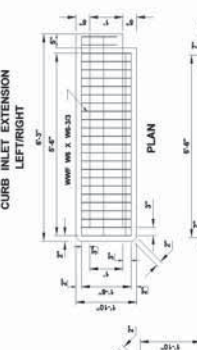
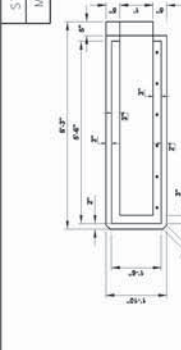
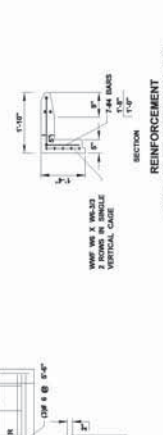
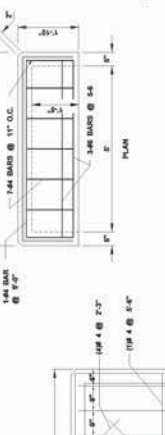
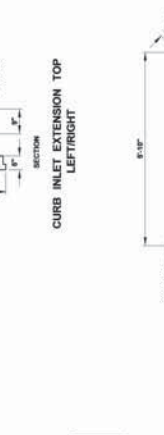
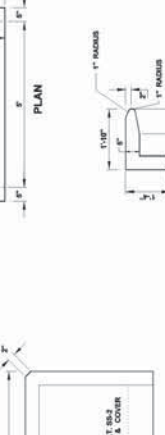
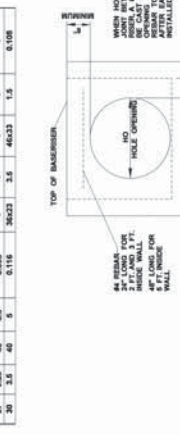

- GENERAL NOTES:
- CONCRETE SHALL HAVE COMPRESSIVE STRENGTH OF 4000 PSI MINIMUM AT 28 DAYS.
 - REINFORCING FOR BOTTOM AND WALLS MAY BE WELDED WIRE FABRIC, ASTM A-185, AND OF THE AREA AS SHOWN IN TABLE.
 - REINFORCING FOR COVER SHALL BE ASTM A618/A AND OF THE AREA AS SHOWN IN TABLE.
 - JOINTS SHALL BE SEALED WITH FLEXIBLE PLASTIC GASKET FOR JOINT CONDUIT, ASHTO SPECIFICATION M-198 OR MDOT SPECIFICATION.
 - 5.2 1/2" LIFTING HOLES TO BE LOCATED ON EACH SIDE OF BOX SECTIONS FOR HANDLING.
 - GROUT FOR JOINING PIPE TO PRECAST UNITS WILL BE A COMMERCIAL MASONRY GROUT MEETING MDOT SPECIFICATIONS.
 - WHEN INTERIOR RISER UNITS ARE REQUIRED, UNITS SHALL BE MARKED TO IDENTIFY EACH UNIT.
 - CONCRETE & REINFORCING STEEL FOR PRE-CAST INLETS AND JUNCTION BOXES SHALL BE PAID FOR AS THE CALCULATED QUANTITY SHOWN ON THE RE-CAP SHEET FOR CAST-IN-PLACE INLETS & JUNCTION BOXES.
 - CURB INLET TOP & CURB INLET EXTENSION TOP SHALL BE FINISHED AT THE SAME GRADE AND CROSS SLOPE REQUIRED ON THE ROADWAY PLANS OR AS PER S.D. SS-2.

DESIGNER	DATE
CHECKER	DATE
APPROVED	DATE

MISSISSIPPI DEPARTMENT OF TRANSPORTATION
 PRECAST UNITS
 SS-2 PRECAST INLET
 (30" CONCRETE ROUND PIPE AND UNDER)
 (36" x 23" CONCRETE ARCH PIPE AND UNDER)

PROJECT NUMBER	PCU-2
SHEET NUMBER	
FILE NAME	00033.RCP.CS1.S5.2.GD01
DESIGN TEAM	
DATE	12/14/18

MISSISSIPPI DEPARTMENT OF TRANSPORTATION

SECTION 904 - NOTICE TO BIDDERS NO. 6691

CODE: (SP)

DATE: 9/19/2016

SUBJECT: Cooperation Between Contractors

PROJECT: NHPP-0002-06(022) / 107209301 – Lee County

The Bidder's attention is hereby called to Subsection 105.07, Cooperation between Contractors, of the 2004 Edition of the Mississippi Standard Specifications for Road and Bridge Construction.

The Bidder is advised that this project adjoins the following adjacent project that will be under construction:

HSIP-0002-07(016) / 106990301 (Intersection Improvements at US 45 & Ripley Road).

The Contractor shall cooperate in all respects and shall coordinate construction of all phases of work with the Contractor of the adjoining project.