

SECTION 905 -- PROPOSAL (CONTINUED)

I (We) hereby certify by digital signature and electronic submission via Bid Express of the Section 905 proposal below, that all certifications, disclosures and affidavits incorporated herein are deemed to be duly executed in the aggregate, fully enforceable and binding upon delivery of the bid proposal. I (We) further acknowledge that this certification shall not extend to the bid bond or alternate security which must be separately executed for the benefit of the Commission. This signature does not cure deficiencies in any required certifications, disclosures and/or affidavits. I (We) also acknowledge the right of the Commission to require full and final execution on any certification, disclosure or affidavit contained in the proposal at the Commission's election upon award. Failure to so execute at the Commission's request within the time allowed in the Standard Specifications for execution of all contract documents will result in forfeiture of the bid bond or alternate security.

Bidder acknowledges receipt of and has added to and made a part of the proposal and contract documents the following addendum (addenda):

ADDENDUM NO. 1 DATED 4/13/2017 ADDENDUM NO. DATED
ADDENDUM NO. DATED ADDENDUM NO. DATED

Number	Description
1	Revised NTB No. 50; Revised Bid Items; Added or Revised Plan Sheet Nos. 2, 7, 13, 17, 27, & 37; Amendment EBS Download Required.

TOTAL ADDENDA: 1
(Must agree with total addenda issued prior to opening of bids)

Respectfully Submitted,

DATE _____

Contractor

BY _____
Signature

TITLE _____

ADDRESS _____

CITY, STATE, ZIP _____

PHONE _____

FAX _____

E-MAIL _____

(To be filled in if a corporation)

Our corporation is chartered under the Laws of the State of _____ and the names, titles and business addresses of the executives are as follows:

President Address

Secretary Address

Treasurer Address

The following is my (our) itemized proposal.

MP-7550-43(009)/ 306060301000

Lincoln County(ies)

MISSISSIPPI DEPARTMENT OF TRANSPORTATION

SECTION 904 - NOTICE TO BIDDERS NO. 50

CODE: (SP)

DATE: 4/13/2017

SUBJECT: Contract Time

PROJECT: MP-7550-43(009) / 306060301- Lincoln County

The completion of work to be performed by the Contractor for this project will not be a specified date but shall be when all allowable working days are assessed, or any extension thereto as provided in Subsection 108.06. It is anticipated that the Notice of Award will be issued no later than **May 9, 2017**.

The Contractor shall request a Notice to Proceed / Beginning of Contract Time date between the date of the **Execution of Contract and July 13, 2017**.

Should the Contractor not request a Notice to Proceed by **July 13, 2017**, the date for the Notice to Proceed and Beginning of Contract Time will be **July 13, 2017**.

65 Working Days have been allowed for the completion of work on this project.

The progress schedule for this project shows the Notice to Proceed and Beginning of Contract Time starting at the latest possible date. If the Contractor requests a Notice to Proceed earlier than this date, the Contractor shall submit a revised progress schedule showing the work beginning at the new Notice to Proceed and Beginning of Contract Time date.

Overlay approximately 8 miles of SR 550 From Bowie Mill Road Est to US 51 in Brookhaven, known as State Project No. MP-7550-43-(009) / 306060301 Lincoln County.

Line No.	Item Code	Adj Code	Quantity	Units	Description [Fixed Unit Price]
Roadway Items					
0010	202-B007		905	Square Yard	Removal of Asphalt Pavement, All Depths
0020	202-B240		763	Linear Feet	Removal of Traffic Stripe
0030	203-G002	(E)	317	Cubic Yard	Excess Excavation, LVM, AH
0040	221-A001	(S)	1	Cubic Yard	Concrete Paved Ditch
0050	304-A008	(GY)	4,213	Cubic Yard	Granular Material, LVM, Class 6, Group D
0060	403-A002	(BA1)	57	Ton	12.5-mm, MT, Asphalt Pavement
0070	403-A005	(BA1)	114	Ton	19-mm, MT, Asphalt Pavement
0080	403-A014	(BA1)	15,628	Ton	9.5-mm, MT, Asphalt Pavement
0090	403-B011	(BA1)	908	Ton	9.5-mm, MT, Asphalt Pavement, Leveling
0100	406-A002		8,694	Square Yard	Cold Milling of Bituminous Pavement, All Depths
0110	407-A001	(A2)	13,075	Gallon	Asphalt for Tack Coat
0120	412-A001		936	Square Feet	Pre-Grinding
0130	423-A001		13	Mile	Rumble Strips, Ground In
0140	503-C010		1,878	Linear Feet	Saw Cut, Full Depth
0150	601-B001	(S)	1	Cubic Yard	Class "B" Structural Concrete, Minor Structures
0160	602-A001	(S)	50	Pounds	Reinforcing Steel
0170	604-B001		500	Pounds	Gratings
0180	606-B001		863	Linear Feet	Guard Rail, Class A, Type 1
0190	606-E007		14	Each	Guard Rail, Terminal End Section, Non-Flared
0200	609-D008	(S)	1,336	Linear Feet	Combination Concrete Curb and Gutter Type 3A
0210	616-A001	(S)	506	Square Yard	Concrete Median and/or Island Pavement, 10-inch
0220	618-A001		1	Lump Sum	Maintenance of Traffic
0230	618-B001		1	Square Feet	Additional Construction Signs
0240	619-A1001		18	Mile	Temporary Traffic Stripe, Continuous White
0250	619-A2001		17	Mile	Temporary Traffic Stripe, Continuous Yellow
0260	619-A4002		4	Mile	Temporary Traffic Stripe, Skip Yellow
0270	619-A5001		6,756	Linear Feet	Temporary Traffic Stripe, Detail
0280	619-A6001		249	Square Feet	Temporary Traffic Stripe, Legend
0290	619-A6002		2,188	Linear Feet	Temporary Traffic Stripe, Legend
0300	620-A001		1	Lump Sum	Mobilization
0310	626-B004		15	Mile	6" Thermoplastic Traffic Stripe, Continuous White
0320	626-D003		2	Mile	6" Thermoplastic Traffic Stripe, Skip Yellow

Line No.	Item Code	Adj Code	Quantity	Units	Description [Fixed Unit Price]
0330	626-E004		10	Mile	6" Thermoplastic Traffic Stripe, Continuous Yellow
0340	626-G002		4,040	Linear Feet	Thermoplastic Detail Stripe, White
0350	626-G003		1,429	Linear Feet	Thermoplastic Detail Stripe, Yellow
0360	626-H004		248	Square Feet	Thermoplastic Legend, White
0370	626-H005		2,072	Linear Feet	Thermoplastic Legend, White
0380	627-J001		620	Each	Two-Way Clear Reflective High Performance Raised Markers
0390	627-K001		10	Each	Red-Clear Reflective High Performance Raised Markers
0400	627-L001		845	Each	Two-Way Yellow Reflective High Performance Raised Markers
0410	627-P001		13	Each	Two-Way Blue Reflective High Performance Raised Markers
0420	630-F006		84	Each	Delineators, Guard Rail, White
ALTERNATE GROUP AA NUMBER 1					
0430	304-F001	(GT)	146	Ton	3/4" and Down Crushed Stone Base
ALTERNATE GROUP AA NUMBER 2					
0440	304-F002	(GT)	146	Ton	Size 610 Crushed Stone Base
ALTERNATE GROUP AA NUMBER 3					
0450	304-F003	(GT)	146	Ton	Size 825B Crushed Stone Base
ALTERNATE GROUP BB NUMBER 1					
0460	907-624-B002		692	Linear Feet	6" Inverted Profile Thermoplastic Traffic Stripe, Continuous White
0470	907-624-C001		100	Linear Feet	6" Inverted Profile Thermoplastic Traffic Stripe, Skip Yellow
0480	907-624-D002		183	Linear Feet	6" Inverted Profile Thermoplastic Traffic Stripe, Continuous Yellow
ALTERNATE GROUP BB NUMBER 2					
0490	628-H001		692	Linear Feet	6" High Performance Cold Plastic Traffic Stripe, Continuous White
0500	628-I002		100	Linear Feet	6" High Performance Cold Plastic Traffic Stripe, Skip Yellow
0510	628-J001		183	Linear Feet	6" High Performance Cold Plastic Traffic Stripe, Continuous Yellow

ADDENDUM

DESCRIPTION OF SHEET

- TITLE AND LAYOUT SHEET (1)
- DETAILED INDEX (1)
- GENERAL NOTES (1)
- TYPICAL SECTION SHEETS (3)
- TYPICAL SECTION - MAINLINE
- TYPICAL SECTION - MAINLINE
- TYPICAL SECTION - FAILED AREAS
- QUANTITY SHEETS (7)
- SUMMARY OF ESTIMATED QUANTITIES
- SUMMARY OF ESTIMATED QUANTITIES
- ESTIMATED QUANTITY FOR TRAFFIC CONTROL SIGNING
- ESTIMATED QUANTITY FOR MILLING, ASPHALT, AND GRANULAR MATERIAL
- ESTIMATED QUANTITY FOR BASE FAIL REPAIR
- ESTIMATED QUANTITY FOR GUARDRAIL
- ESTIMATED QUANTITY FOR ISLAND, CURB AND GUTTER
- PLAN-PROFILE SHEETS (14)
- STA. 112+21 - STA. 345+00
- STA. 345+00 - STA. 375+00
- STA. 375+00 - STA. 405+00
- STA. 405+00 - STA. 435+00
- STA. 435+00 - STA. 465+00
- STA. 465+00 - STA. 495+00
- STA. 495+00 - STA. 525+00
- STA. 525+00 - STA. 555+00
- STA. 555+00 - STA. 585+00
- STA. 585+00 - STA. 615+00
- STA. 615+00 - STA. 645+00
- STA. 645+00 - STA. 675+00
- STA. 675+00 - STA. 705+00
- STA. 705+00 - STA. 734+25.96

SPECIAL DESIGN SHEETS (16)

- DETAIL OF CONSTRUCTION SIGNING
- RUMBLE STRIPE (GROUND-IN) FOR 2-LANE HIGHWAYS
- LOCATION OF R16-3 SIGNS
- TRAFFIC CONTROL DETAILS (DRUM PLACEMENT & SHOULDER CLOSURE)
- HIGHWAY SIGN AND BARRICADE DETAILS FOR CONSTRUCTION PROJECTS
- 2-WAY CLEAR RAISED PAVEMENT MARKERS PLACED ON SIDE ROADS
- GUARDRAIL INSTALLATION METHOD FOR BOX CULVERT
- DETAIL FOR CURB AND ISLAND PAINTING
- GUARDRAIL: TYPICAL INSTALLATION FOR ROADSIDE HAZARDS ON 2-LANE, 2-WAY HIGHWAYS
- MISCELLANEOUS CONSTRUCTION DETAILS
- DRIVEWAYS, CURB & GUTTER, & SIDEWALK
- SPECIAL DESIGN: GUARDRAIL DIMENSIONS
- SPECIAL DESIGN: GUARDRAIL DIMENSIONS
- SPECIAL DESIGN: GUARDRAIL DIMENSIONS
- SPECIAL DESIGN: GUARDRAIL DIMENSIONS
- PAVEMENT MARKING DETAIL (YIELD BARS)

WKG. NO.

DESCRIPTION OF SHEET

SH. NO.

- 1 STANDARD DRAWINGS (15)
- 2 PAVEMENT MARKING DETAILS FOR 2-LANE AND 4-LANE DIVIDED HIGHWAYS
- 3 PAVEMENT MARKINGS LEGEND DETAILS
- 4 PAVEMENT MARKING LEGEND DETAILS
- 5 TYPICAL PLACEMENT OF WARNING SIGNS AND PAVEMENT MARKINGS AT RAILROAD HIGHWAY GRADE CROSSINGS
- 6 GUARDRAIL: "W" BEAM (WOOD POSTS)
- 7 GUARDRAIL: "W" BEAM (STEEL POST)
- 8 GUARDRAIL: MISCELLANEOUS HARDWARE
- 9 GUARDRAIL: TYPICAL GUARDRAIL DELINEATION
- 10 TRAFFIC CONTROL PLAN WITH FLAGGER
- 11 SHORT DURATION CLOSING FOR TWO-LANE TWO-WAY HIGHWAYS
- 12 TRAFFIC CONTROL PLAN MOBILE OPERATIONS MULTILANE ROADS AND TWO-LANE ROADS
- 13 TRAFFIC CONTROL PLANS UNEVEN PAVEMENT DETAILS
- 14 TEMPORARY STRIPING FOR TRAFFIC CONTROL 2-LANE AND 4-LANE DIVIDED HIGHWAYS
- 15 MEDIAN INLET (FLUSH WITH DITCH PLUG)
- 16 DETAIL OF GRATES FOR MEDIAN INLETS
- 17
- 18
- 19
- 20
- 21
- 22
- 23
- 24
- 25
- 26
- 27
- 28
- 29
- 30
- 31
- 32
- 33
- 34
- 35
- 36
- 37
- 38
- 39
- 40
- 41
- 42
- 43

- DI-1
- GN-1
- TS-1
- TS-2
- TS-3
- SO-1
- SO-2
- TCS-1
- EO-1
- EO-2
- EO-3
- EO-4
- WK-3
- WK-4
- WK-5
- WK-6
- WK-7
- WK-8
- WK-9
- WK-10
- WK-11
- WK-12
- WK-13
- WK-14
- WK-15
- WK-16

- PM-1
- PM-5
- PM-6
- PM-7
- GR-1
- GR-1B
- GR-HW
- SN-8C
- TCP-1
- TCP-8
- TCP-11
- TCP-14
- TCP-15
- MI-4A
- IG-1

- 6120
- 6124
- 6125
- 6126
- 6180
- 6182
- 6202
- 6236
- 6250
- 6257
- 6260
- 6263
- 6264
- 6313
- 6314

DISTRICT 7

PS & E PLANS-DATE: 02/22/2017		
FMS CON. # :3065060/301000		
REVISIONS		
DATE	SHEET NO.	BY
03/08	SH. 7.6.12.13.15.20.39.40	CLB
04/04	7.13.17.27.37	CLB

MISSISSIPPI DEPARTMENT OF TRANSPORTATION

DETAILED INDEX

PROJECT NO. MP-7550-43(009)
COUNTY : LINCOLN

WORKING NUMBER: DI-1
SHEET NUMBER: 2

FILENAME: 02\DETAIL_INDEX.DGN
DESIGN TEAM: _____
CHECKED: _____
DATE: _____

BY	REVISION

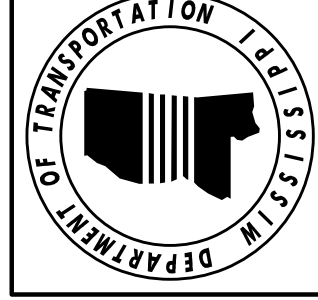

ADDENDUM

STATE	PROJECT NO.
MISS	MP-7550-43(009)

SUMMARY OF QUANTITIES (SHEET 1)

PAY ITEM NO.	PAY ITEM	UNIT	LINCOLN : 306060-301000	
			Prelim	Final
202-B007	Removal of Asphalt Pavement, All Depths	SY	905	
202-B240	Removal of Traffic Stripe	LF	763	
203-G002	Excess Excavation, LVM, AH	CY	317	
221-A001	Concrete Paved Ditch	CY	1	
304-A008	Granular Material, LVM, Class 6, Group D	CY	4,213	
304-F001	3/4" and Down Crushed Stone Base	TON	146	
	OR			
304-F002	Size 610 Crushed Stone Base	TON	146	
	OR			
304-F003	Size 825B Crushed Stone Base	TON	146	
403-A002	12.5-mm, MT, Asphalt Pavement	TON	57	
403-A005	19-mm, MT, Asphalt Pavement	TON	114	
403-A014	9.5-mm, MT, Asphalt Pavement	TON	15,628	
403-B011	9.5-mm, MT, Asphalt Pavement, Leveling	TON	908	
406-A002	Cold Milling of Bituminous Pavement, All Depths	SY	8,694	
407-A001	Asphalt for Tack Coat	GAL	13,075	
412-A001	Pre-Grinding	SF	936	
423-A001	Rumble Strips, Ground In	MI	13	
503-C010	Saw Cut, Full Depth	LF	1,878	
601-B001	Class "B" Structural Concrete, Minor Structures	CY	1	
602-A001	Reinforcing Steel	LBS	50	
604-B001	Gratings	LBS	500	
606-B001	Guard Rail, Class A, Type 1	LF	863	
606-E007	Guard Rail, Terminal End Section, Non-Flared	EA	14	
609-D008	Combination Concrete Curb and Gutter Type 3A	LF	1,336	
616-A001	Concrete Median and/or Island Pavement, 10-inch	SY	506	
618-A001	Maintenance of Traffic	LS	1	
618-B001	Additional Construction Signs	SF	1	
619-A1001	Temporary Traffic Stripe, Continuous White	MI	18	
619-A2001	Temporary Traffic Stripe, Continuous Yellow	MI	17	
619-A4002	Temporary Traffic Stripe, Skip Yellow	MI	4	
619-A5001	Temporary Traffic Stripe, Detail	LF	6,756	
619-A6001	Temporary Traffic Stripe, Legend	SF	249	
619-A6002	Temporary Traffic Stripe, Legend	LF	2,188	
620-A001	Mobilization	LS	1	
907-624-B002	6" Inverted Profile Thermoplastic Traffic Stripe, Continuous White	LF	692	
907-624-C001	6" Inverted Profile Thermoplastic Traffic Stripe, Skip Yellow	LF	100	
907-624-D002	6" Inverted Profile Thermoplastic Traffic Stripe, Continuous Yellow	LF	183	
	OR			
628-H001	6" High Performance Cold Plastic Traffic Stripe, Continuous White	LF	692	
628-I002	6" High Performance Cold Plastic Traffic Stripe, Skip Yellow	LF	100	
628-J001	6" High Performance Cold Plastic Traffic Stripe, Continuous Yellow	LF	183	

- ① TO INCLUDE 518 S.Y. FOR FULL DEPTH PAV'T REPAIRS AND 387 S.Y. FOR ISLANDS
- ② TO INCLUDE 642 L.F. FOR FULL DEPTH PAV'T REPAIRS AND 1,236 L.F. FOR ISLANDS

① ② ③

② ③ ④

①

②

③

03/08/2017	CHANGES IN PAY ITEM QUANTITY	CB
04/04/2017	QUANTITY CHANGES	CB
	Revision	BY

**MISSISSIPPI DEPARTMENT OF TRANSPORTATION
SUMMARY OF QUANTITIES**

Proj No: MP-7550-43(009)	Working Number
County: LINCOLN	SQ-1
FILENAME : SQ	Sheet Number
Design Team	7
Checked	Date

ADDENDUM

STATE	PROJECT NO.
MISS.	MP-7550-43(009)

LINCOLN COUNTY HIGHWAY 550

COMBINATION CONCRETE CURB AND GUTTER REQ'D

WORKING SH. NO.	STATION TO STATION		SIZE	TYPE "3A"	FULL DEPTH SAW CUT	EXCESS EXCAVATION	REMOVAL OF ASPHALT	CONC. MEDIAN AND ISLAND PAV'T (10")	REMARKS
	BEGIN	END							
△ 4	366+81	368+50	169	336	358		90	90	WEST ISLAND @ LLOYD STAR
△ 4	369+00	371+83	284	566	587		154	154	EAST ISLAND @ LLOYD STAR
△ 5	388+90	389+25	35 △	78 △	74 △	2	43 △	43 △	WEST ISLAND @ RESTAURANT
△ 5	389+75	390+08	33 △	78 △	73 △	2	42 △	42 △	EAST ISLAND @ RESTAURANT
△ 6	△ 407+09	△ 407+89	80 △	170 △		5		120 △	EAST ISLAND @ GENERAL STORE
△ 7	△ 726+86	△ 727+38	52 △	108 △	144 △	2 △	58 △	58 △	ISLAND @ KRANE'S GROCERY
TOTALS				1,336 △	1,236 △	11 △	387 △	507 △	
				L.F.	L.F.	C.Y.	S.Y.	S.Y.	

MISSISSIPPI DEPARTMENT OF TRANSPORTATION	
ESTIMATED CONCRETE CURB AND GUTTER QUANTITIES	PROJECT NO.: MP-7550-43(009) COUNTY: LINCOLN
WORKING NUMBER EO-4	FILENAME: 13EQ-3.DGN DESIGN TEAM _____ CHECKED _____ DATE _____
SHEET NUMBER 13	

ADDENDUM

ve ALI-8-10
 7° 26' 23.545" (RT)
 1° 50' 12.114"
 405.068'
 202.819'
 3,119.499'

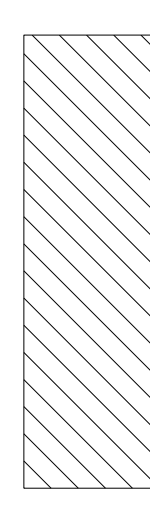
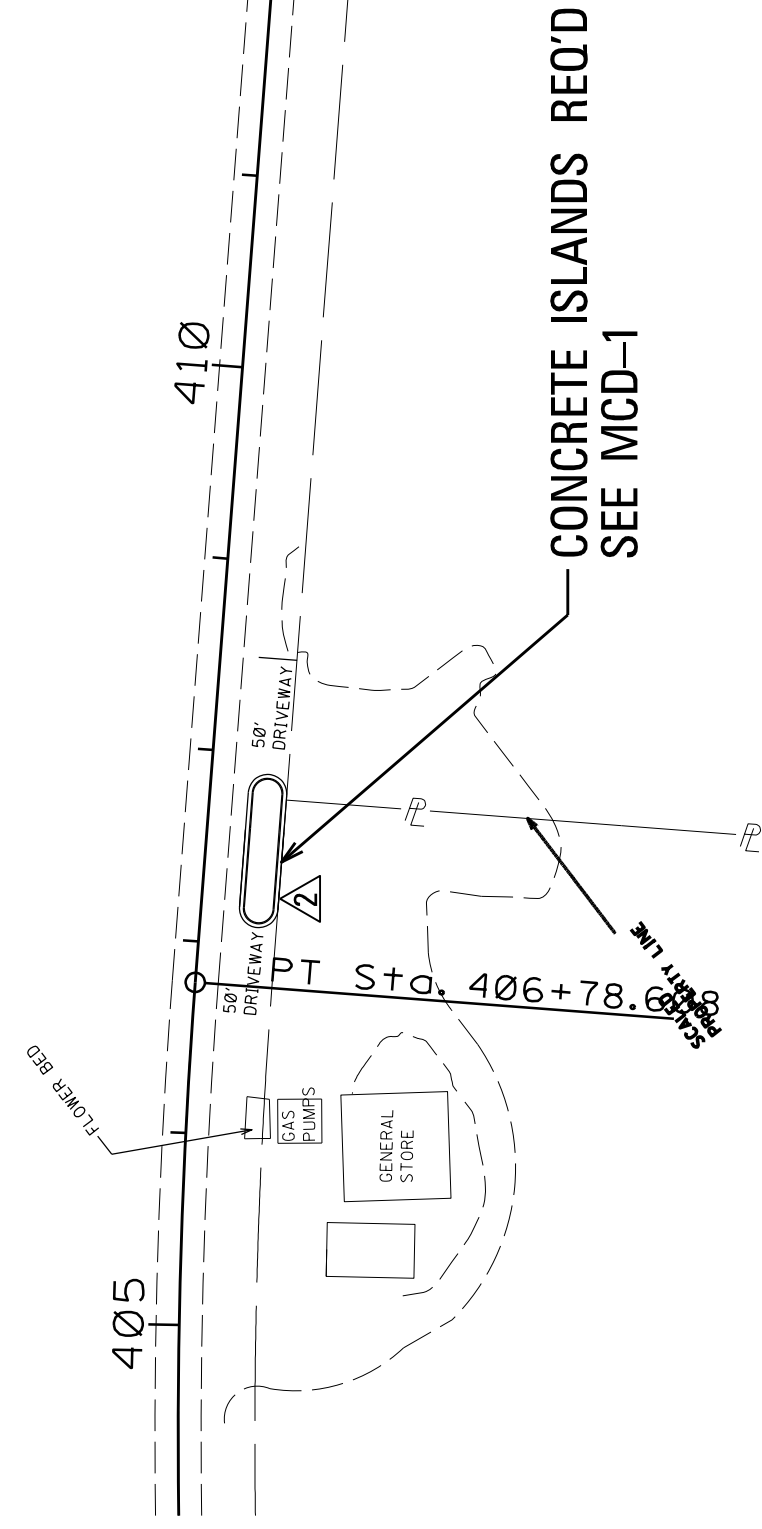

1.5" MILLING REQ'D

Curve BRIDGE-1-1
 $\Delta = 8^\circ 32' 29.986"$ (LT)
 $D = 1^\circ 08' 45.294"$
 $L = 745.4015.294'$
 $T = 373.392'$
 $R = 5,000.002'$

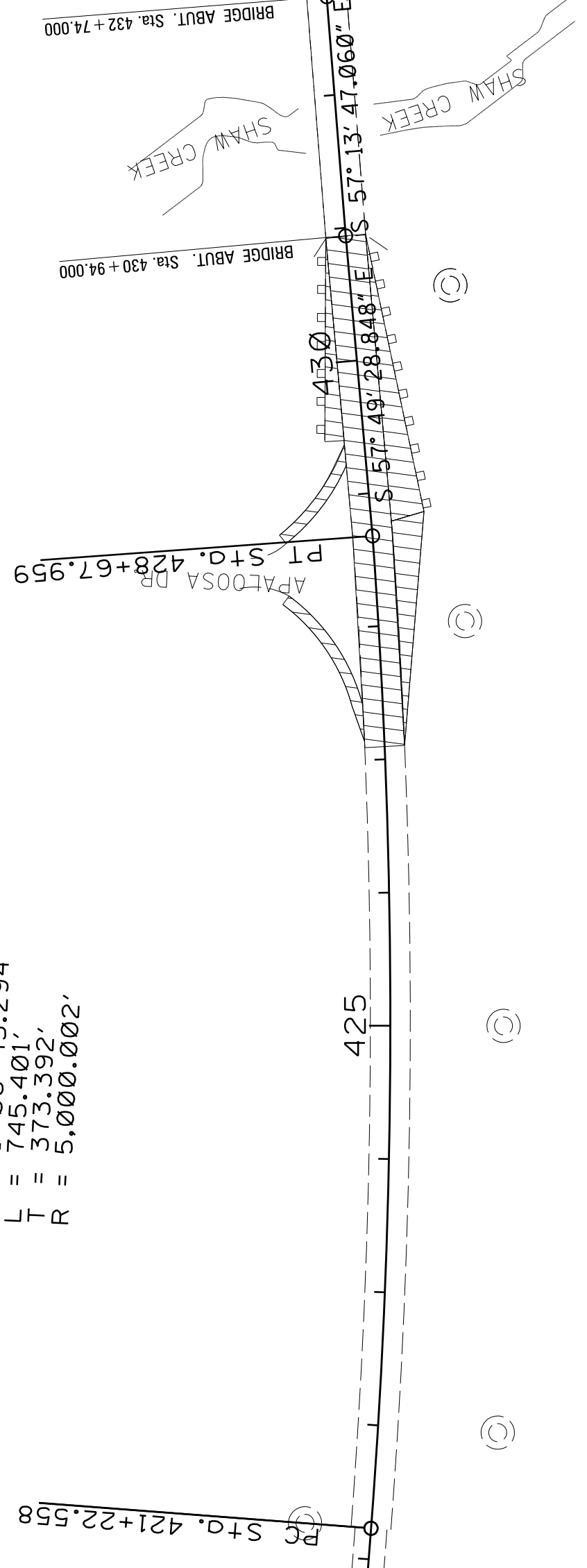

* FOR INFORMATION ONLY *

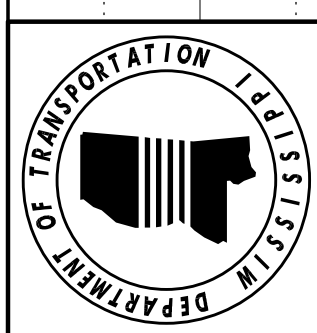
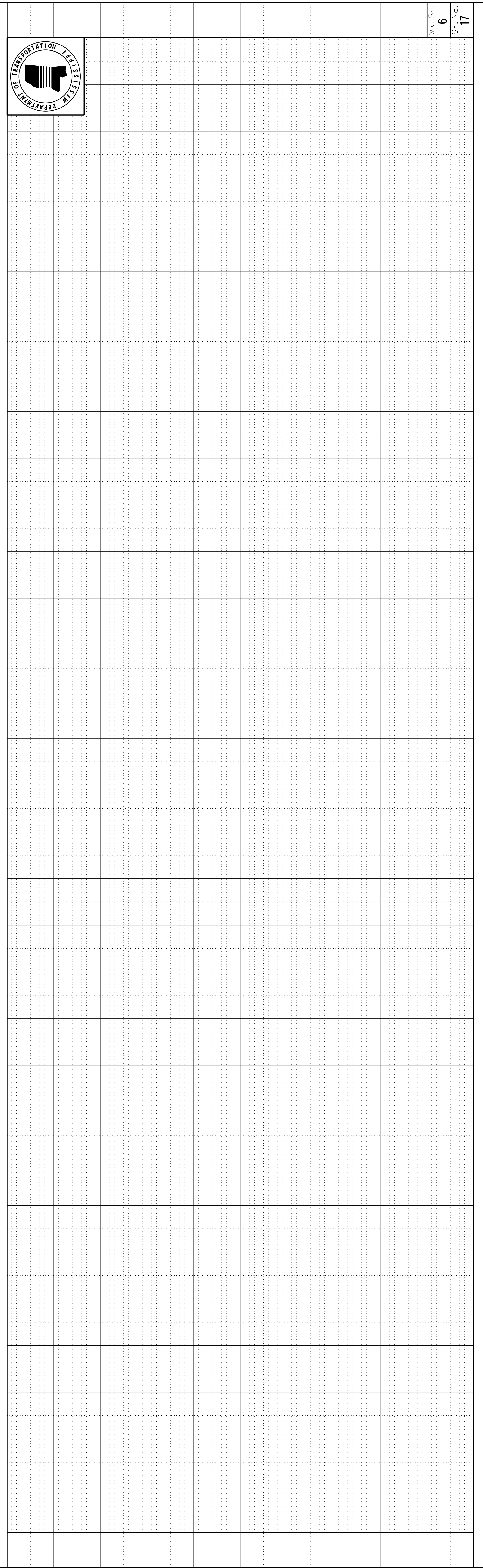

REVISIONS	DATE	BY	CLB
	04/04		

ADDENDUM

STATE MISS. PROJECT NO. MP-7550-43(009)

REVISIONS	DATE	BY
	4/04	CLB

EOP STA. 734 + 02

Curve ALI3.12
 $\Delta = 15^\circ 12' 27.212''$ (RT)
 $D = 31.27' 40.106''$
 $L = 439.380'$
 $LT = 220.989'$
 $R = 1,655.402'$

Curve ALI3.9
 $\Delta = 14^\circ 48' 36.756''$ (RT)
 $D = 31.20' 44.158''$
 $L = 442.860'$
 $LT = 222.672'$
 $R = 1,712.571'$

MEADOWBROOK RD
 PC Sta. 716+04.890

ROOKMAN DRIVE

42" RCP
 GUARDRAIL REQ'D

EQUATION:
 $Y = 0.00000000X^2 + 0.00000000X + 0.00000000$
 BK = 720+47.750
 AH = 720+52.300

PT Sta. 711+59.590
 $N 16^\circ 34' 59.618'' E$

PT Sta. 728+13.830
 $S 71^\circ 26' 34.858'' E$

PT Sta. 723+74.450
 $S 88^\circ 44' 17.029'' E$

POT Sta. 734+23.960

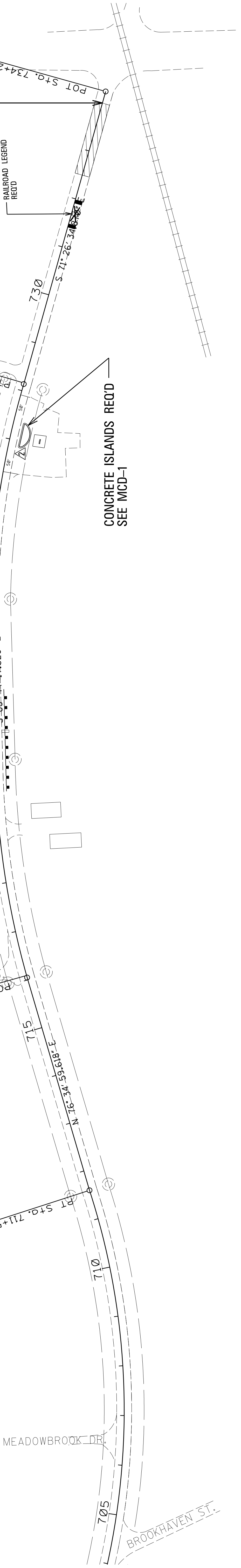

CONCRETE ISLANDS REQ'D
 SEE MCD-1

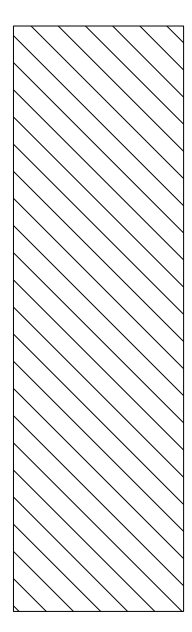

1.5" MILLING REQ'D

* FOR INFORMATION ONLY *

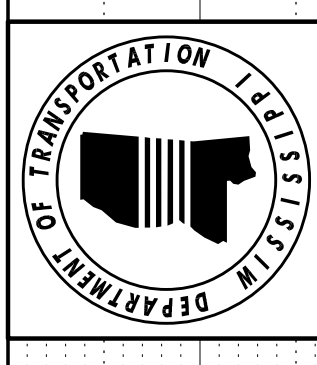

STA. 721 + 10 (LT)
 100' L.F. CLASS A TYPE 1 GUARDRAIL (REQ'D) (GRI-BC)
 2 TERMINAL END SECTION NON FLARED (REQ'D)
 9 GUARDRAIL DELINEATORS "WHITE" (REQ'D)
 37 TONS ASPHALT (REQ'D)

STA. 721 + 10 (RT)
 100' L.F. CLASS A TYPE 1 GUARDRAIL (REQ'D) (GRI-BC)
 2 TERMINAL END SECTION NON FLARED (REQ'D)
 9 GUARDRAIL DELINEATORS "WHITE" (REQ'D)
 37 TONS ASPHALT (REQ'D)

Wk. Sh. 16
 Sh. No. 27

ADDENDUM

FMS CON: 306060/30/000

STATE	PROJECT NO.
MISS.	MP-7550-43(009)

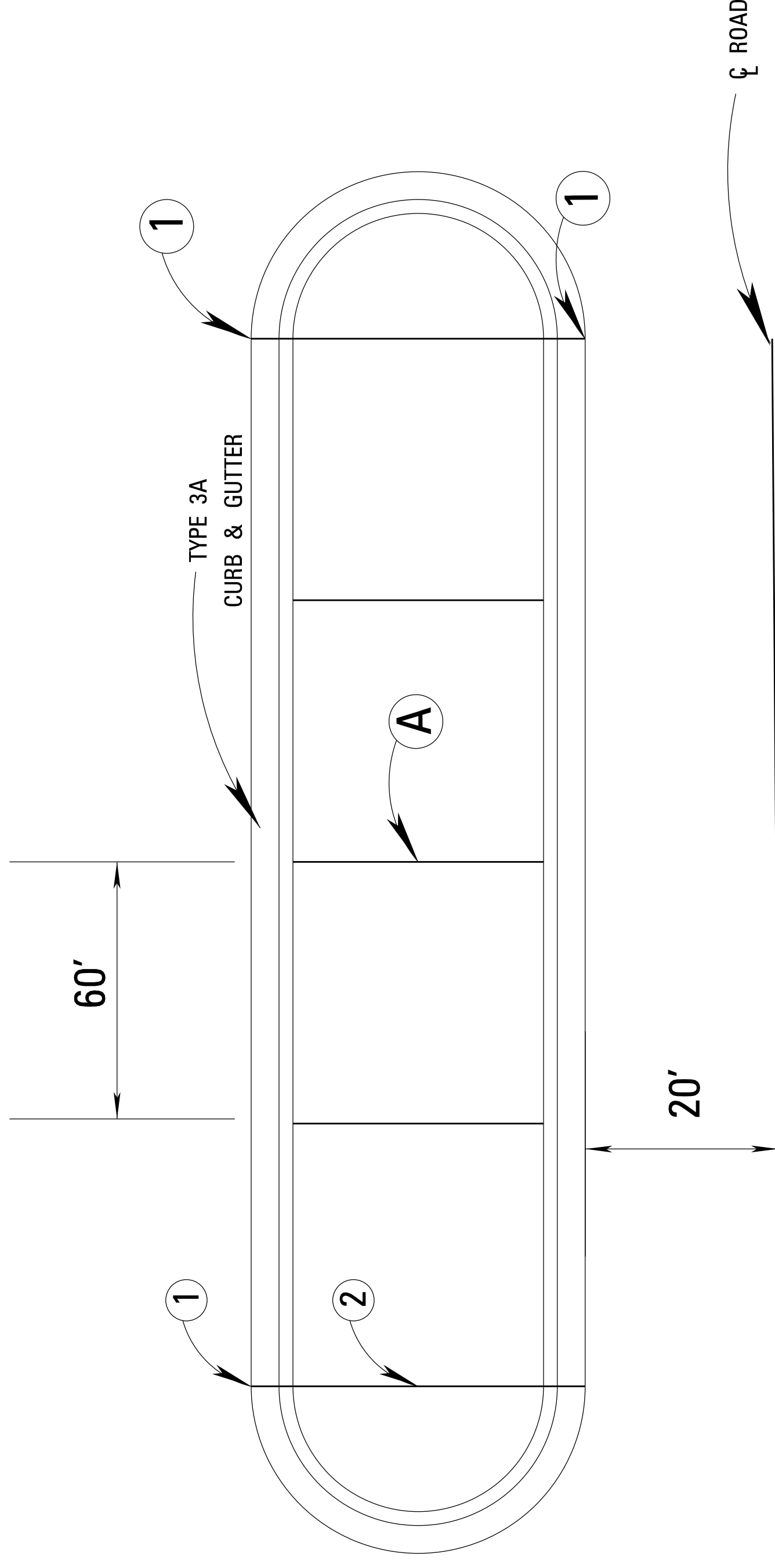

PLAN VIEW OF CURB & GUTTER AT PAVED ISLAND

STATION

- 366 + 81 - 368 + 50
- 369 + 00 - 371 + 83
- 388 + 90 - 389 + 25
- 389 + 76 - 390 + 36
- △ 407 + 09 - 407 + 89

DISTANCE "A"

- 5'
- 5'
- 15'
- 15'
- 15'

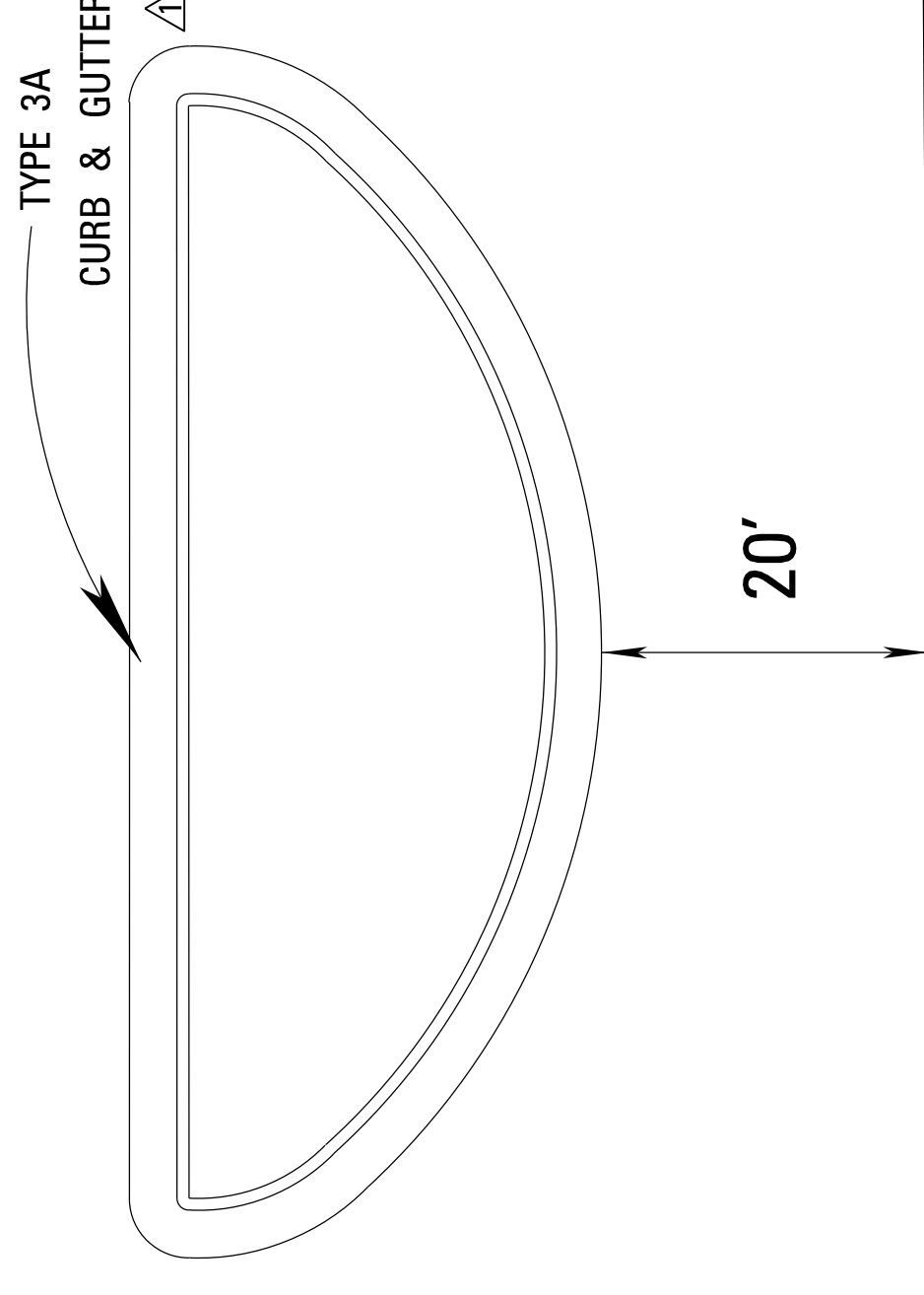

PLAN VIEW OF CURB & GUTTER AT PAVED ISLAND

STATION

- △ 726 + 86 - 727 + 37

DISTANCE "A"

- △ 15'

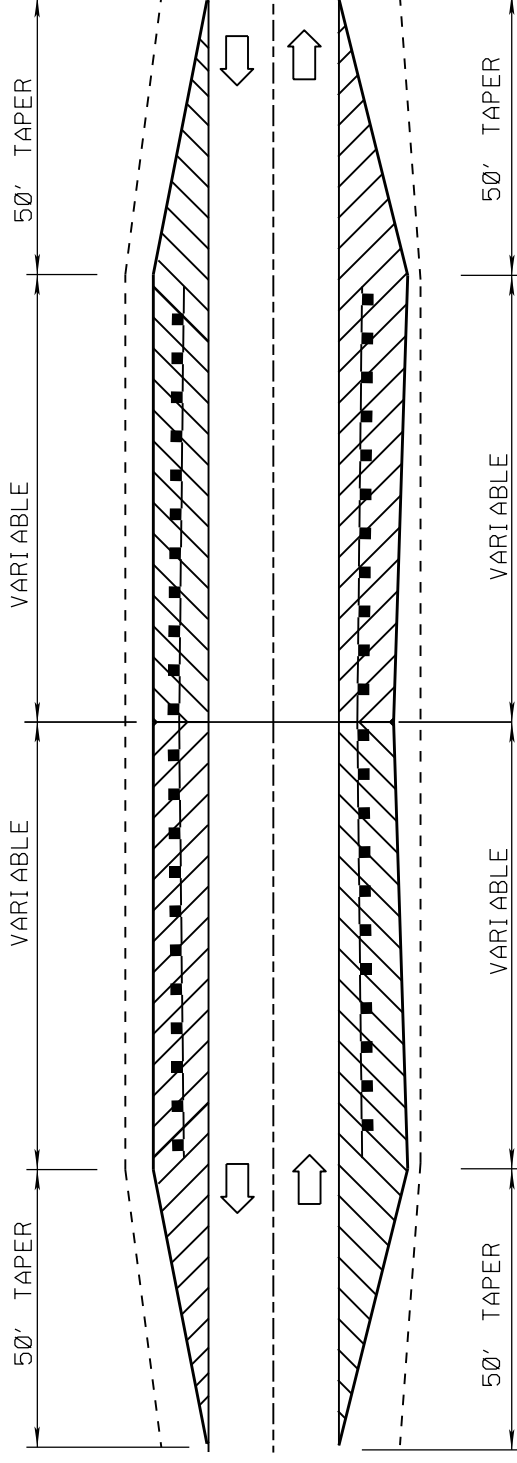

DETAILS OF PAVED SHOULDERS AT GUARDRAIL

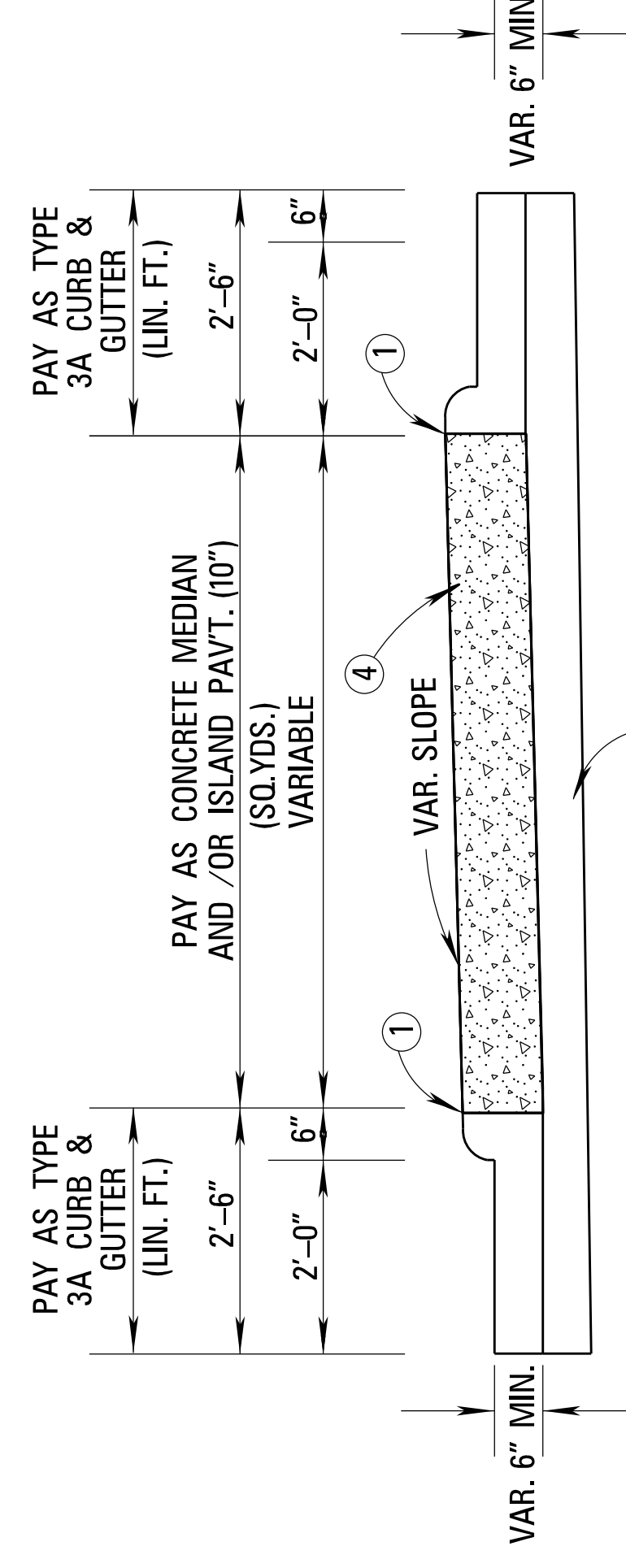

TYPICAL DETAIL OF CURB & GUTTER AT PAVED ISLAND

- ① 1/2" PREMOLED EXPANSION JOINT (NOT A PAY ITEM) (SPACED AS PER SHEETS SDSD-1
- ② 1/2" TOOLED CONTRACTION JOINT OR 1/2" PREMOLED EXPANSION JOINT(NOT A PAY ITEM) (SPACED AS PER SHEETS SDSD-1 OR SDSD-2) AS DIRECTED BY THE ENGINEER.
- ③ 6" GRANULAR MATERIAL CLASS 6, GROUP D, LVM (IF NEEDED)
- ④ 10" DEPTH CLASS "C" STRUCTURAL CONCRETE (FOR MEDIAN & ISLAND PAVEMENT) (PAY ITEM NO. 616-A003)

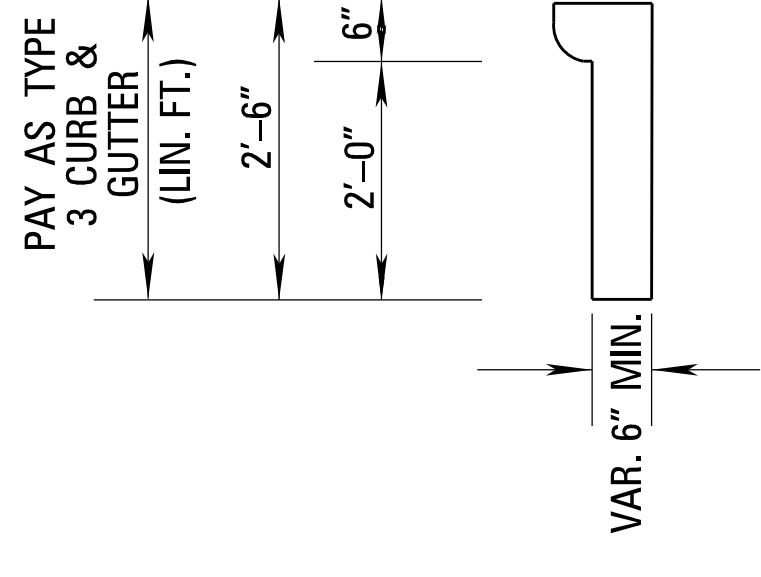

DETAILS OF COMBINATION CURB & GUTTER TYPE 3A

MISSISSIPPI DEPARTMENT OF TRANSPORTATION	
MISCELLANEOUS CONSTRUCTION DETAILS	
BY	REVISION
CLB	REVISED STATIONS: ADDED ISLAND
DATE	04/04
DESIGN TEAM	FILENAME: (37)MCD-1.DGN
CHECKED	DATE
WORKING NUMBER	MCD-1
SHEET NUMBER	37
COUNTY:	LINCOLN
PROJ. NO.:	MP-7550-43 (009)