

STATE	PROJECT NUMBER	SHEET NO.
MISSISSIPPI	BR-9999-01(250)	1

GENERAL INDEX

INCLUDED THIS PROJECT	BEGIN WITH SHEET
<input checked="" type="checkbox"/> ROADWAY	1
<input type="checkbox"/> PERMANENT SIGNS	1001
<input type="checkbox"/> TRAFFIC SIGNALS	2001
<input type="checkbox"/> ITS COMPONENTS	3001
<input type="checkbox"/> LIGHTING	4001
<input type="checkbox"/> (RESERVED)	5001
<input checked="" type="checkbox"/> ROADWAY STANDARD DWGS	6001
<input type="checkbox"/> BOX CULVERT STD. DRAWINGS (LRFD)	7001
<input type="checkbox"/> BOX CULVERT STD. DRAWINGS (STD. SPEC.)	7501
<input checked="" type="checkbox"/> BRIDGE	8001
<input type="checkbox"/> CROSS SECTIONS	9001

STATE OF MISSISSIPPI
MISSISSIPPI DEPARTMENT OF TRANSPORTATION
**PLAN AND PROFILE OF PROPOSED
STATE HIGHWAY
FEDERAL AID PROJECT NO. BR-9999-01(250)**

**BRIDGE JOINT REPAIR DIST. 1
BR #11700 & #11701**

FMS. CONST. NO. 107019/301000

SCALES

PLAN	1 IN. = 100 FT.
PROFILE {	HOR. 1 IN. = 100 FT.
	VERT. 1 IN. = 10 FT.
LAYOUT	1 IN. = 2000 FT.

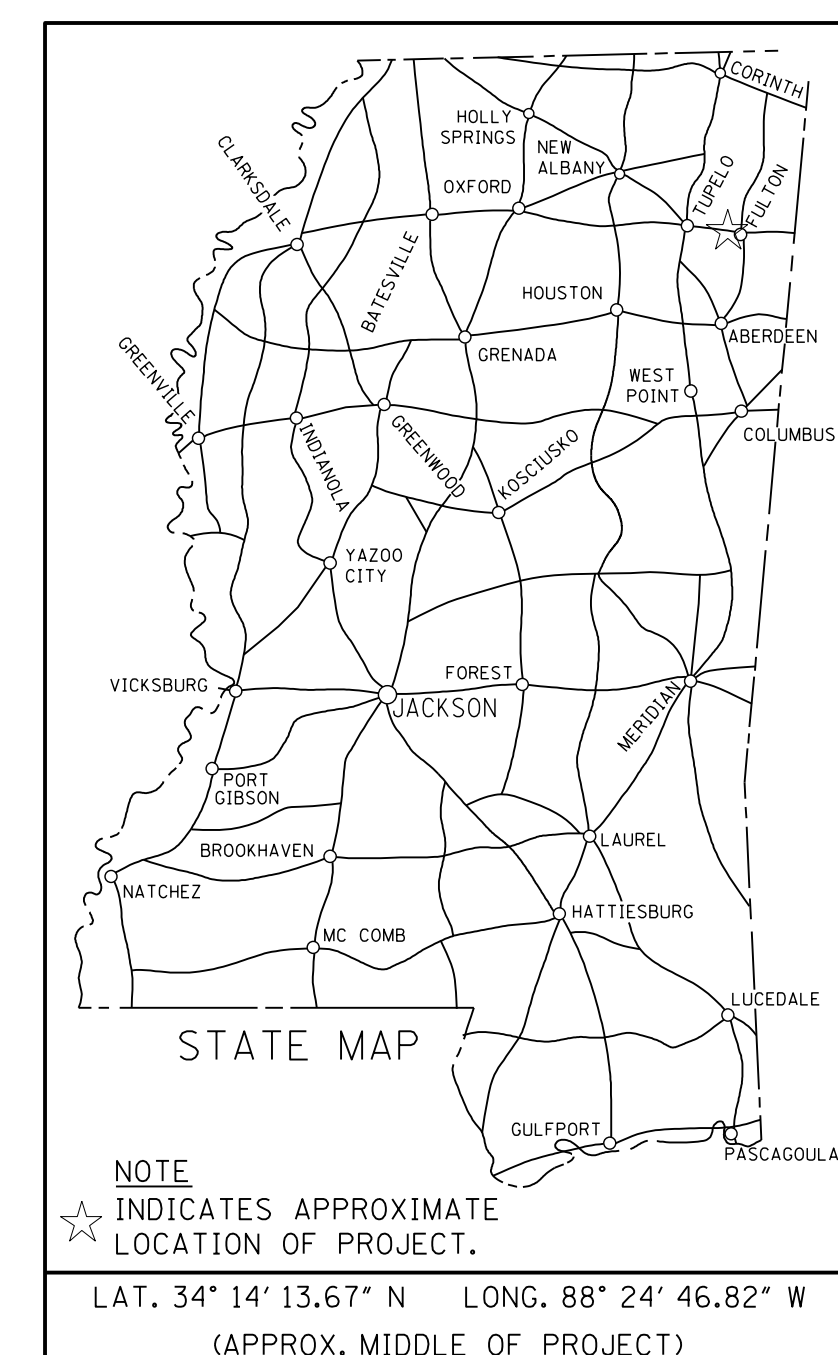

**BRIDGE STRUCTURES REQ'D.
NONE**

**BOX BRIDGES REQ'D.
NONE**

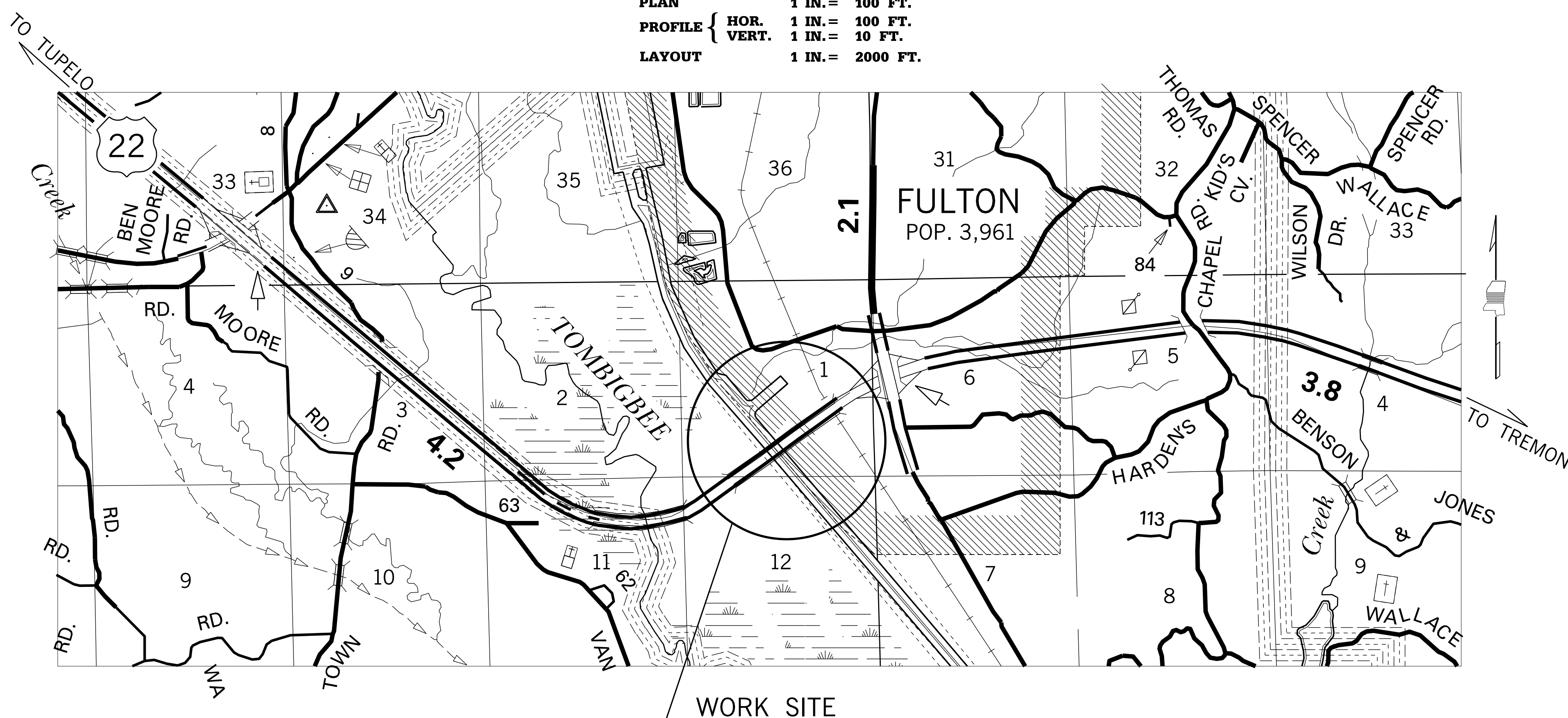

DESIGN CONTROL

MPH = V (SPEED DESIGN)

ADT () = : ADT () =

DHV = : D = % T = %

PERMITS ACQUIRED BY MDOT

WETLANDS AND WATERS PERMITS
(NECESSARY FOR ULTIMATE IMPROVEMENTS ONLY):

	WATERS	WETLANDS
NATIONWIDE #14	N	N
NATIONWIDE (OTHER)*	N	N
GENERAL*	N	N
INDIVIDUAL (404)*	N	N

* ACQUISITION OF PERMITS FOR TEMPORARY IMPACTS DURING CONSTRUCTION ARE THE RESPONSIBILITY OF THE CONTRACTOR

STORMWATER PERMIT	
Y	REQUIRED, CNOI SUBMITTED BY MDOT (DISTURBED AREA = 5 ACRES)
S	REQUIRED, CNOI TO BE SUBMITTED BY CONTRACTOR (1 TO 4.99 ACRES)
N	NO STORMWATER PERMIT REQUIRED (<1 ACRE)

APPROVED BY: _____

CONVENTIONAL SYMBOLS

COUNTY LINE	-----
TOWN CORPORATION LINE	-----
SECTION LINE	-----
EXISTING ROAD OR TRAVELED WAY	-----
PROPOSED ROAD OR TRAVELED WAY	-----
RAILROAD	-----
SURVEY LINE	-----
BRIDGES	-----

**EQUATIONS
NONE**

**EXCEPTIONS
NONE**

LENGTH DATA

LENGTH OF ROADWAY	0.00	FT.	0.00	MI.
LENGTH OF BRIDGES	3478.00	FT.	0.66	MI.
LENGTH OF PROJECT (NET)			0.66	MI.
LENGTH OF EXCEPTIONS	0.00	FT.	0.00	MI.
LENGTH OF PROJECT (GROSS)			0.66	MI.

P S & E DATE: 1/3/2017

APPROVED: _____

DEPUTY EXECUTIVE DIRECTOR / CHIEF ENGINEER

EXECUTIVE DIRECTOR

MDOT
MISSISSIPPI DEPARTMENT OF TRANSPORTATION

1/12/2017 08:46:11 A.M. DGN

DESCRIPTION OF SHEET

WKG. NO. **SH. NO.**

GENERAL NOTES

DESCRIPTION OF SHEET	WKG. NO.	SH. NO.
TITLE SHEET (1)		1
DETAILED INDEX AND GENERAL NOTES (1) DETAILED INDEX AND GENERAL NOTES	DI-1	2
QUANTITY SHEETS (1) SUMMARY OF QUANTITIES	SQ-1	3
SPECIAL DESIGN SHEETS (5) DETAIL CONSTRUCTION SIGNING	DCS-1	4
TRAFFIC CONTROL PLAN FOR POSTED SPEED 65 TO 70 MPH (EXTENDED PERIOD)	SDTCP-4	5
LANE CLOSURE DETAILS FULL DEPTH CONCRETE REPAIR	LCD-1	6
HIGHWAY SIGN AND BARRICADE DETAILS FOR CONSTRUCTION PROJECTS	SDTCP-10	7
LOCATION OF R16-3 SIGNS	SSD-1	8
STANDARD DRAWINGS - ROADWAY SHEETS (3) MEDIAN BARRIER, CONCRETE (PRECAST)	MB-2A	6205
TRAFFIC CONTROL PLAN FOR POSTED SPEED 65 TO 70 MPH (WORK DAY ONLY)	TCP-5	6254
DETAILS OF OUTSIDE LANE CLOSURE AT EXIT AND ENTRANCE RAMPS	TCP-12	6261
BRIDGE SHEETS (21) (BRIDGE SHEETS BEGIN AT 8001)		
TOTAL SHEETS (32)		

- ① THE LOCATION AND SPACING OF SIGNS, SHOWN ON THE TRAFFIC CONTROL PLANS, ARE APPROXIMATE AND MAY BE ADJUSTED AS NECESSARY TO FIT FIELD CONDITIONS.

- ② FLUORESCENT ORANGE SHEETING SHALL BE USED ON ALL CONSTRUCTION AND TRAFFIC CONTROL SIGNS EXCEPT FOR THOSE DESIGNATED IN PLANS TO BE BLACK LEGEND AND WHITE BACKGROUND.

- ③ IT SHALL BE THE RESPONSIBILITY OF THE CONTRACTOR TO PROTECT EXISTING STRUCTURES SUCH AS, BUT NOT LIMITED TO, PIPES, INLETS, APRONS, BRIDGES, ETC. FROM DAMAGE WHICH MIGHT OCCUR DURING CONSTRUCTION. EXTREME CARE SHALL BE EXERCISED IN UNDERCUT AREAS (IF ANY) AND UNDERCUT DEPTH MAY BE ADJUSTED AT CROSS DRAINS, AS DIRECTED BY THE ENGINEER. THE CONTRACTOR SHALL REPLACE OR REPAIR, AS DIRECTED BY THE ENGINEER, ANY STRUCTURES DAMAGED DURING THE LIFE OF THE CONTRACT. NO PAYMENT WILL BE MADE FOR REPLACEMENT OR REPAIR TO DAMAGED STRUCTURES.

- ④ ALL TRAFFIC CONTROL DEVICES ON THIS PROJECT SHALL COMPLY WITH PART VI OF THE MUTCD (LATEST EDITION).

- ⑤ ALL PLASTIC DRUMS SHALL HAVE A BALLASTING COLLAR MADE FROM RECYCLED TRUCK TIRES OR OTHER SUITABLE MATERIALS.

- ⑥ WHERE PRE-FORMED SEALED JOINTS ARE BEING REMOVED FROM THE BRIDGE, PRECAST MEDIAN BARRIERS (MB-2A) WILL BE PLACED ACCORDING TO SPECIAL DESIGN SHEET LCD-1.

PS & E PLANS-DATE 1/13/17		
FMS CON. # 107019/301000		
REVISIONS		
DATE	SHEET NO.	BY

1/12/2017 11:50:18 DI-1.DGN

MISSISSIPPI DEPARTMENT OF TRANSPORTATION	
DETAILED INDEX	
COUNTY: ITAWAMBA	
PROJ. NO.: BR-9999-01(250)	
FILENAME: DI-1.DGN	
DESIGN TEAM _____ CHECKED _____ DATE _____	
WORKING NUMBER	DI-1
SHEET NUMBER	2