

STATE	PROJECT NUMBER	SHEET NO.
MISSISSIPPI	MP-1047-13(003)	1

**GENERAL INDEX**

INCLUDED THIS PROJECT	BEGIN WITH SHEET
<input type="checkbox"/> ROADWAY .....	1
<input type="checkbox"/> PERMANENT SIGNS .....	1001
<input type="checkbox"/> TRAFFIC SIGNALS .....	2001
<input type="checkbox"/> ITS COMPONENTS .....	3001
<input type="checkbox"/> LIGHTING .....	4001
<input type="checkbox"/> (RESERVED) .....	5001
<input checked="" type="checkbox"/> ROADWAY STANDARD DWGS .....	6001
<input type="checkbox"/> BOX CULVERT STD. DRAWINGS (LRFD) ....	7001
<input type="checkbox"/> BOX CULVERT STD. DRAWINGS (STD. SPEC.)	7501
<input type="checkbox"/> BRIDGE .....	8001
<input type="checkbox"/> CROSS SECTIONS .....	9001

**STATE OF MISSISSIPPI**  
**MISSISSIPPI DEPARTMENT OF TRANSPORTATION**

**PLAN AND PROFILE OF PROPOSED STATE HIGHWAY**  
**STATE PROJECT NO. MP-1047-13(003)**

SR 47 FM SR 50 TO CHICKASAW COUNTY LINE  
CLAY COUNTY

FMS. CONST. NO. 306064/ 301000

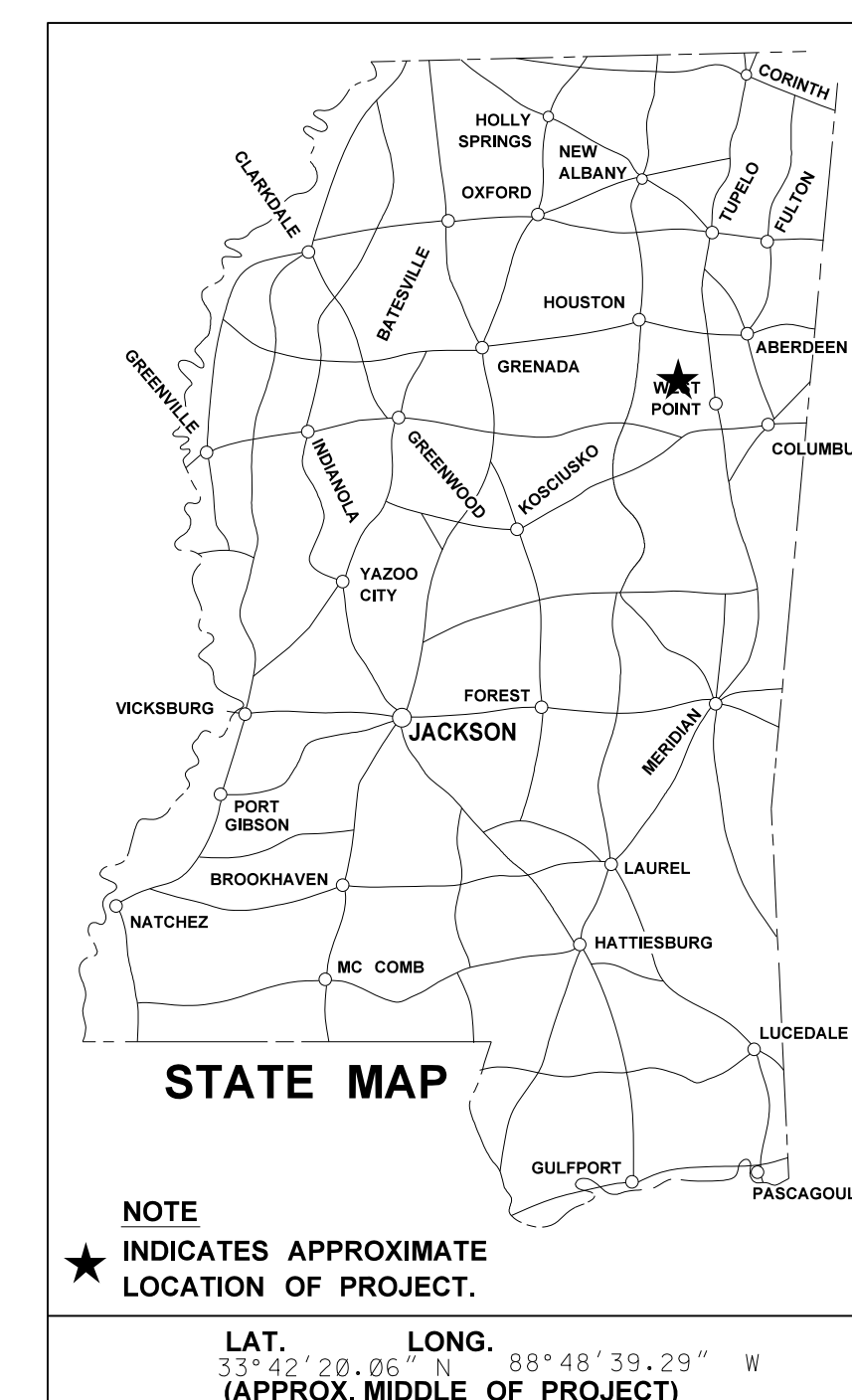

E.O.P. 947 + 44 +/-

**BRIDGE STRUCTURES REQ'D.**

**NONE**

**BOX BRIDGES REQ'D.**

**NONE**

**SCALES**

<b>PLAN</b>	1 IN. = 100 FT.
<b>PROFILE</b> {	<b>HOR.</b> 1 IN. = 100 FT.
	<b>VERT.</b> 1 IN. = 10 FT.
<b>LAYOUT</b>	1 IN. = FT.

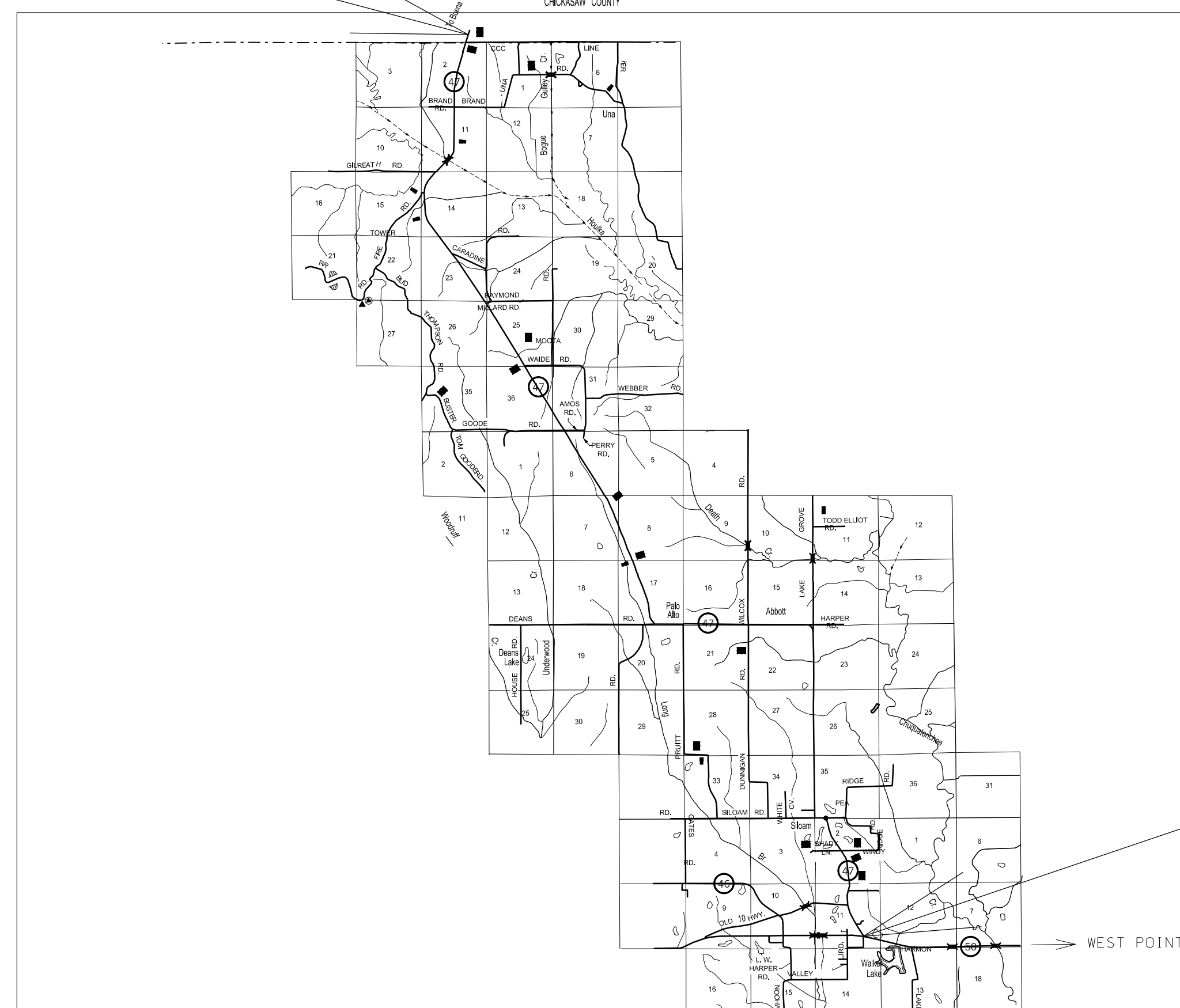

B.O.P. 10 + 00 +/-

**CONVENTIONAL SYMBOLS**

COUNTY LINE .....	-----
TOWN CORPORATION LINE .....	-----
SECTION LINE .....	-----
EXISTING ROAD OR TRAVELED WAY .....	-----
PROPOSED ROAD OR TRAVELED WAY .....	-----
RAILROAD .....	-----
SURVEY LINE .....	-----
BRIDGES .....	-----

**EQUATIONS**

**NONE**

**EXCEPTIONS**

**NONE**

**LENGTH DATA**

LENGTH OF ROADWAY	93,744 FT.	17.75 MI.
LENGTH OF BRIDGES	703 FT.	0.13 MI.
LENGTH OF PROJECT (NET)		17.62 MI.
LENGTH OF EXCEPTIONS	FT.	MI.
LENGTH OF PROJECT (GROSS)		17.62 MI.

**DESIGN CONTROL**

MPH = V (SPEED DESIGN)

ADT ( ) = : ADT ( ) =

DHV = : D = % T = %

**PERMITS ACQUIRED BY MDOT**

WETLANDS AND WATERS PERMITS (NECESSARY FOR ULTIMATE IMPROVEMENTS ONLY):

	WATERS	WETLANDS
NATIONWIDE #14	<b>N</b>	<b>N</b>
NATIONWIDE (OTHER)*	<b>N</b>	<b>N</b>
GENERAL*	<b>N</b>	<b>N</b>
INDIVIDUAL (404)*	<b>N</b>	<b>N</b>

\* ACQUISITION OF PERMITS FOR TEMPORARY IMPACTS DURING CONSTRUCTION ARE THE RESPONSIBILITY OF THE CONTRACTOR

**STORMWATER PERMIT** **N**

Y REQUIRED CNDI SUBMITTED BY MDOT (DISTURBED AREA = 5 ACRES)

S REQUIRED SCNDI TO BE SUBMITTED BY CONTRACTOR (1 TO 4.99 ACRES)

N NO STORMWATER PERMIT REQUIRED (<1 ACRE)

APPROVED BY: \_\_\_\_\_

P S & E DATE: 02/23/2017

APPROVED: \_\_\_\_\_  
DEPUTY EXECUTIVE DIRECTOR / CHIEF ENGINEER

EXECUTIVE DIRECTOR \_\_\_\_\_



001 00 AMPM DGNF LLENAM MISSISSIPPI DEPARTMENT OF TRANSPORTATION

DESCRIPTION OF SHEET

WKG. SH.  
NO. NO.

TITLE SHEET (1)			1
DETAILED INDEX & GENERAL NOTES (1)			
DETAILED INDEX & GENERAL NOTES	DI-1		2
TYPICAL SECTION SHEETS (2)			
TYPICAL OVERLAY SECTION FOR SR 47	TS-1		3
TYPICAL OVERLAY SECTION FOR SR 47	TS-2		4
QUANTITY SHEETS (1)			
SUMMARY OF QUANTITIES	SQ-1		5
SPECIAL DESIGN SHEETS (6)			
DETAIL OF CONSTRUCTION SIGNING	CS-1		6
DETAIL OF CONSTRUCTION SIGNING	CS-2		7
DETAIL OF CONSTRUCTION SIGNING	CS-3		8
DETAIL OF MILLING AT BRIDGES	DM-1		9
SIGNING OF TWO-WAY TRAFFIC FOR NO PASSING ZONES	TC-1		10
2-WAY CLEAR RAISED PAVEMENT MARKERS PLACED ON SIDE ROADS	CRPMSR-2		11
HIGHWAY SIGN AND BARRICADE DETAILS	SDTCP-10		12
STANDARD DRAWINGS - ROADWAY SHEETS (4)			
PAVEMENT MARKING DETAILS FOR 2 & 4-LANE DIVIDED ROADWAYS	12-01-99	PM-1	6120
TRAFFIC CONTROL PLAN WITH FLAGGER (ONE-LANE CLOSURE OF TWO-WAY TRAFFIC)		TCP-1	6250
TRAFFIC CONTROL PLAN MOBILE OPERATIONS MULTILANE ROADS AND TWO-LANE ROADS	12-01-99	TCP-11	6260
TEMPORARY STRIPING FOR TRAFFIC CONTROL FOR 2-LANE AND 4-LANE DIVIDED HIGHWAYS	12-01-99	TCP-15	6264

GENERAL NOTES

- (1) THE LOCATION AND SPACING OF SIGNS, SHOWN ON THE TRAFFIC CONTROL PLANS, ARE APPROXIMATE AND MAY BE ADJUSTED AS NECESSARY TO FIT FIELD CONDITIONS.
- (2) MAXIMUM LANE CLOSURE ALLOWED IS 1 MILES. A MINIMUM INTERVAL OF 1 MILES IS REQUIRED BETWEEN WORK ZONE LANE CLOSURES SET IN ADJACENT LANES. A MINIMUM INTERVAL OF 3 MILES IS REQUIRED BETWEEN WORK ZONE LANE CLOSURES LOCATED IN THE SAME LANE.
- (3) FLUORESCENT ORANGE SHEETING SHALL BE USED ON ALL CONSTRUCTION AND TRAFFIC CONTROL SIGNS EXCEPT FOR THOSE DESIGNATED ON THE PLANS TO BE BLACK LEGEND AND BORDER ON WHITE BACKGROUND.
- (4) ALL TRAFFIC CONTROL DEVICES ON THIS PROJECT SHALL COMPLY WITH PART VI OF THE MUTCD (LATEST EDITION).
- (5) BIDDER ARE ADVISED THAT HARD COPIES OF ANY ADDENDA FOR THIS PROJECT WILL NO LONGER BE MAILED. ALL ADDENDA FOR THIS PROJECT WILL BE POSTED TO WWW.MDOT.MS.GOV UNDER THE PROPOSAL ADDENDA COLUMN. IT IS THE BIDDERS RESPONSIBILITY TO CHECK AND SEE IF ANY ADDENDA HAVE BEEN POSTED FOR THIS PROJECT. PLEASE CONTACT CONTRACT ADMINISTRATION DIVISION AT 601-359-7700 FOR ANY QUESTIONS REGARDING ELECTRONIC ADDENDA.

ROADWAY DESIGN DIVISION, CLAY COUNTY SECTION  
MISSISSIPPI DEPARTMENT OF TRANSPORTATION

PS & E PLANS-DATE...02/23/17		
FMS CON. # 306064/301000		
REVISIONS		
DATE	SHEET NO.	BY

MISSISSIPPI DEPARTMENT OF TRANSPORTATION	
<b>DETAILED INDEX</b>	
<b>PROJECT NO. MP-1047-13(003)</b>	
<b>COUNTY : CLAY</b>	
WORKING NUMBER	DI-1
FILENAME:	SHEET NUMBER
DESIGN TEAM _____	2
CHECKED _____	DATE _____