

STATE	PROJECT NUMBER	SHEET NO.
MISSISSIPPI	MP-1178-73(007)	1

**GENERAL INDEX**

INCLUDED THIS PROJECT	BEGIN WITH SHEET
<input checked="" type="checkbox"/> ROADWAY .....	1
<input type="checkbox"/> PERMANENT SIGNS .....	1001
<input type="checkbox"/> TRAFFIC SIGNALS .....	2001
<input type="checkbox"/> ITS COMPONENTS .....	3001
<input type="checkbox"/> LIGHTING .....	4001
<input type="checkbox"/> (RESERVED) .....	5001
<input type="checkbox"/> ROADWAY STANDARD DWGS ..	6001
<input type="checkbox"/> BRIDGE STANDARD DWGS .....	7001
<input type="checkbox"/> BRIDGE .....	8001
<input type="checkbox"/> CROSS SECTIONS .....	9001

STATE OF MISSISSIPPI

MISSISSIPPI DEPARTMENT OF TRANSPORTATION

# PLAN AND PROFILE OF PROPOSED STATE HIGHWAY

## STATE PROJECT NO. MP-1178-73(007)

SR 178 FROM BENTON COUNTY LINE FMS. CONST. NO. 306067/301000  
TO NEW ALBANY CITY LIMITS  
UNION COUNTY

**SCALES**

PLAN	1 IN. = 100 FT.
PROFILE {	HOR. 1 IN. = 100 FT.
	VERT. 1 IN. = 10 FT.
LAYOUT	1 IN. = FT.

**BRIDGE STRUCTURES REQ'D.**

**BOX BRIDGES REQ'D.**

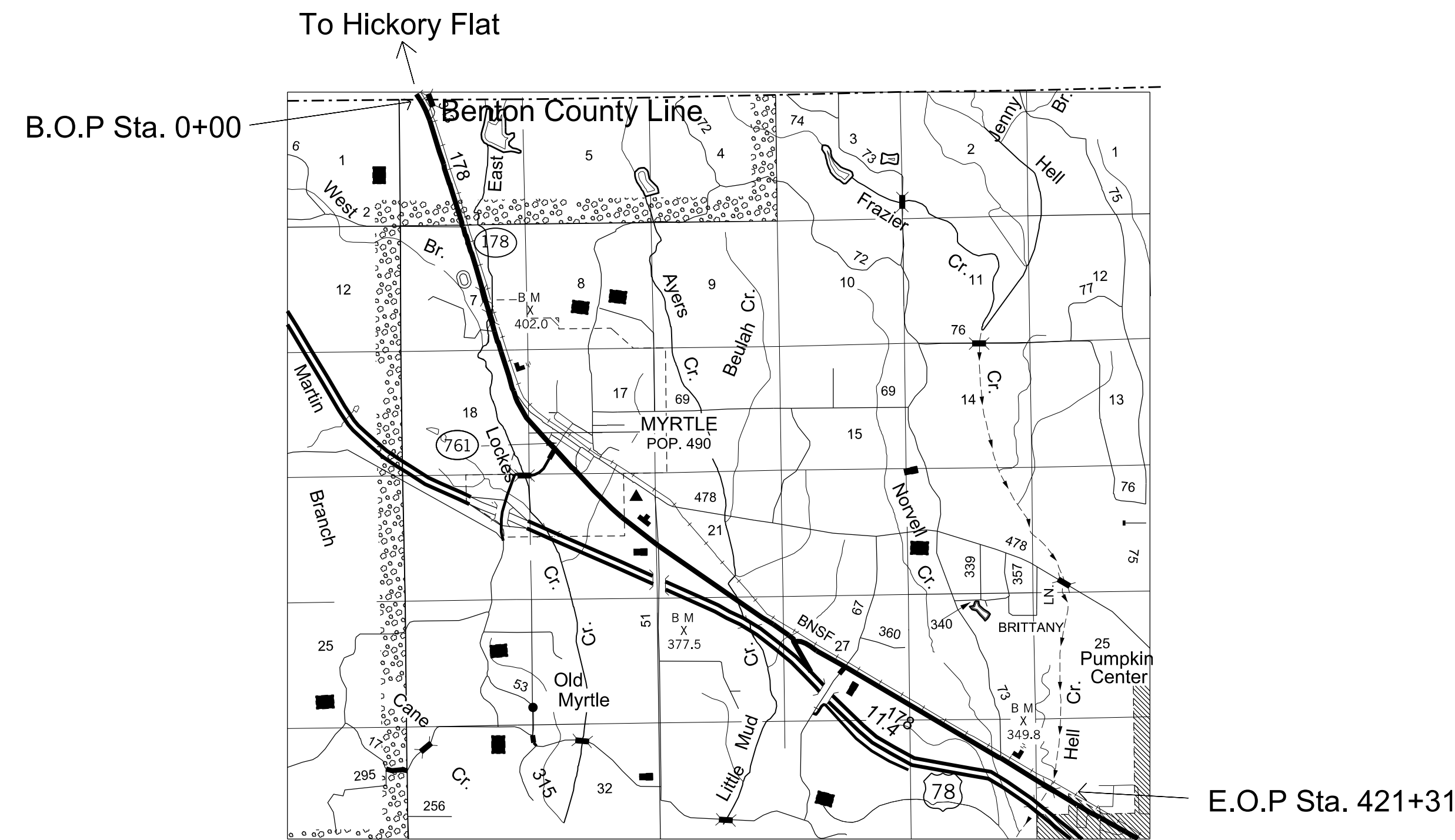
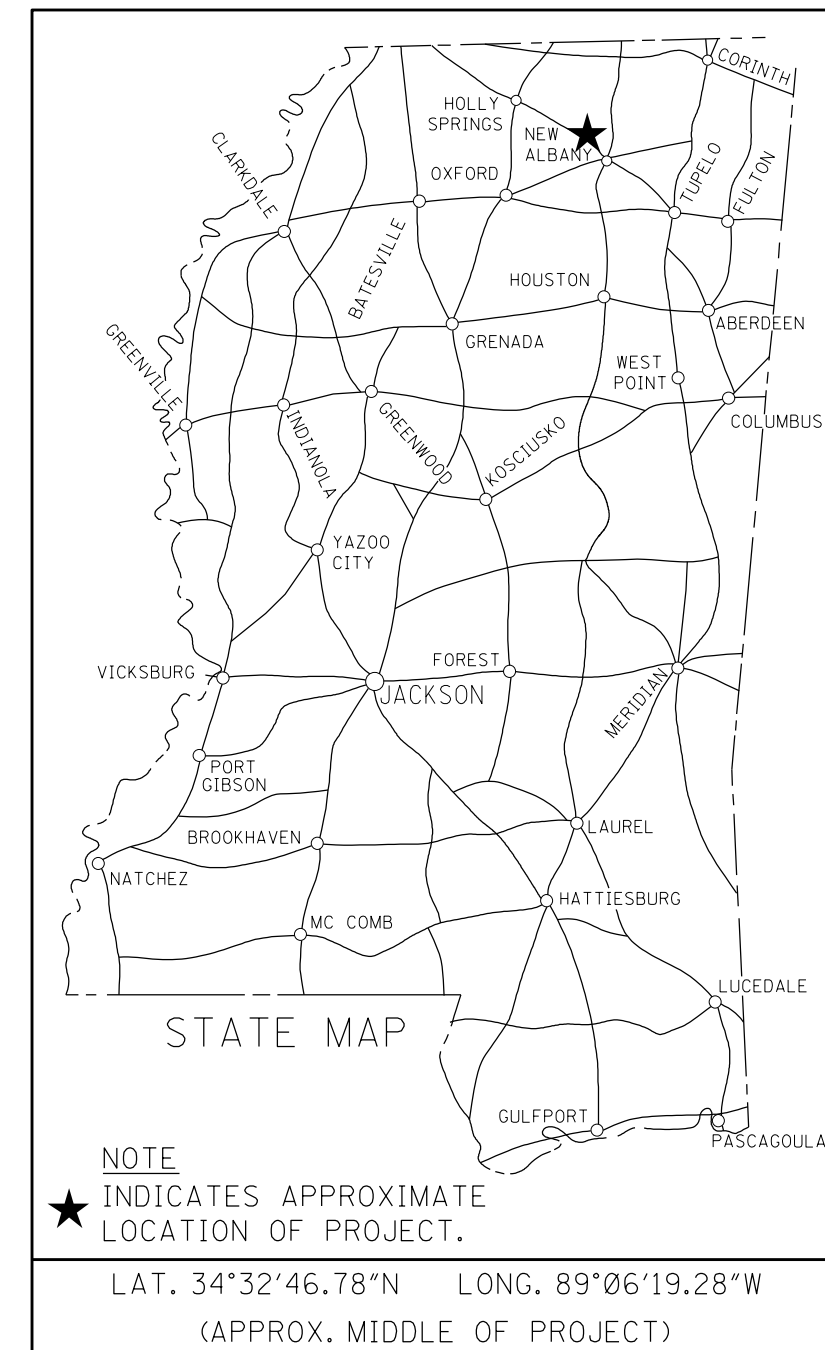

<b>DESIGN CONTROL</b>	
MPH = V (SPEED DESIGN)	
ADT ( ) = : ADT ( ) =	
DHW = : D = % T = %	
<b>PERMITS ACQUIRED BY MDOT</b>	
WETLANDS AND WATERS PERMITS (NECESSARY FOR ULTIMATE IMPROVEMENTS ONLY):	
	WATERS WETLANDS
NATIONWIDE #14	<input type="checkbox"/> <input type="checkbox"/>
NATIONWIDE (OTHER)*	<input type="checkbox"/> <input type="checkbox"/>
GENERAL*	<input type="checkbox"/> <input type="checkbox"/>
INDIVIDUAL (404)*	<input type="checkbox"/> <input type="checkbox"/>
* ACQUISITION OF PERMITS FOR TEMPORARY IMPACTS DURING CONSTRUCTION ARE THE RESPONSIBILITY OF THE CONTRACTOR	
<b>STORMWATER PERMIT</b> <input checked="" type="checkbox"/>	
Y	REQUIRED, CNOI SUBMITTED BY MDOT (DISTURBED AREA = 5 ACRES)
S	REQUIRED, CNOI TO BE SUBMITTED BY CONTRACTOR (1 TO 4.99 ACRES)
N	NO STORMWATER PERMIT REQUIRED (<1 ACRE)
APPROVED BY: _____	

**GPS CONTROL NOTES**

HORIZONTAL DATUM: NAD MS ZONE (US SURVEY FEET)  
HORIZONTAL MONUMENT NORTH EAST

VERTICAL DATUM: NAVD (US SURVEY FEET)  
VERTICAL MONUMENT ELEVATION

ALL AZIMUTHS AND DISTANCES ARE GRID VALUES, US SURVEY FEET  
CONVERSION VALUES PROJECT AVERAGE

GROUND TO GRID (COMBINED) FACTOR  
GRID TO GEODETIC AZIMUTH

**EQUATIONS**

**EXCEPTIONS**

**LENGTH DATA**

LENGTH OF ROADWAY	42,131 FT.	7.979 MI.
LENGTH OF BRIDGES	0 FT.	0 MI.
LENGTH OF PROJECT (NET)		7.979 MI.
LENGTH OF EXCEPTIONS	0 FT.	0 MI.
LENGTH OF PROJECT (GROSS)		7.979 MI.

P S & E DATE: 03/20/2017

APPROVED: \_\_\_\_\_

DEPUTY EXECUTIVE DIRECTOR / CHIEF ENGINEER

EXECUTIVE DIRECTOR



TITLE DIVISION  
MISSISSIPPI DEPARTMENT OF TRANSPORTATION

2016-01-28 3:37 BRV-TITLE.DGN

