

STATE	PROJECT NUMBER	SHEET NO.
MISSISSIPPI	MP-1004-59(011)	1

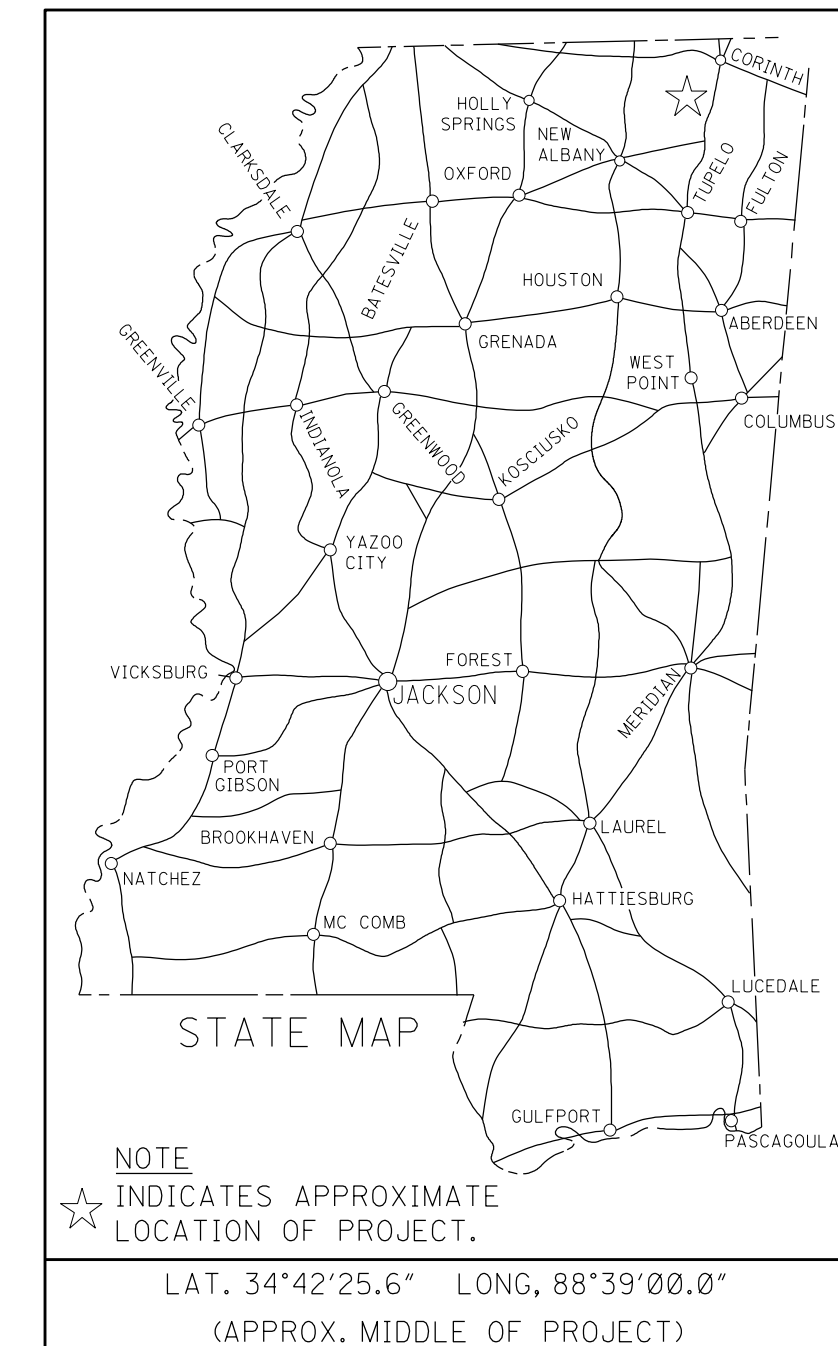

GENERAL INDEX

INCLUDED THIS PROJECT	BEGIN WITH SHEET
<input checked="" type="checkbox"/> ROADWAY	1
<input type="checkbox"/> PERMANENT SIGNS	1001
<input type="checkbox"/> TRAFFIC SIGNALS	2001
<input type="checkbox"/> ITS COMPONENTS	3001
<input type="checkbox"/> LIGHTING	4001
<input type="checkbox"/> (RESERVED)	5001
<input checked="" type="checkbox"/> ROADWAY STANDARD DWGS ..	6001
<input type="checkbox"/> BRIDGE STANDARD DWGS	7001
<input type="checkbox"/> BRIDGE	8001
<input type="checkbox"/> CROSS SECTIONS	9001

STATE OF MISSISSIPPI

MISSISSIPPI DEPARTMENT OF TRANSPORTATION

PLAN AND PROFILE OF PROPOSED STATE HIGHWAY
STATE PROJECT NO. MP-1004-59(011)

FMS CON: 306068/301000

SR 4 FROM TIPPDAH COUNTY LINE TO U.S. HWY. 45
PRENTISS COUNTY

SCALES

PLAN	1 IN. = 100 FT.
PROFILE {	HOR. 1 IN. = 100 FT.
	VERT. 1 IN. = 10 FT.
LAYOUT	1 IN. = FT.

BRIDGE STRUCTURES REQ'D.

BOX BRIDGES REQ'D.

EXCEPTIONS

BOP 10 + 00

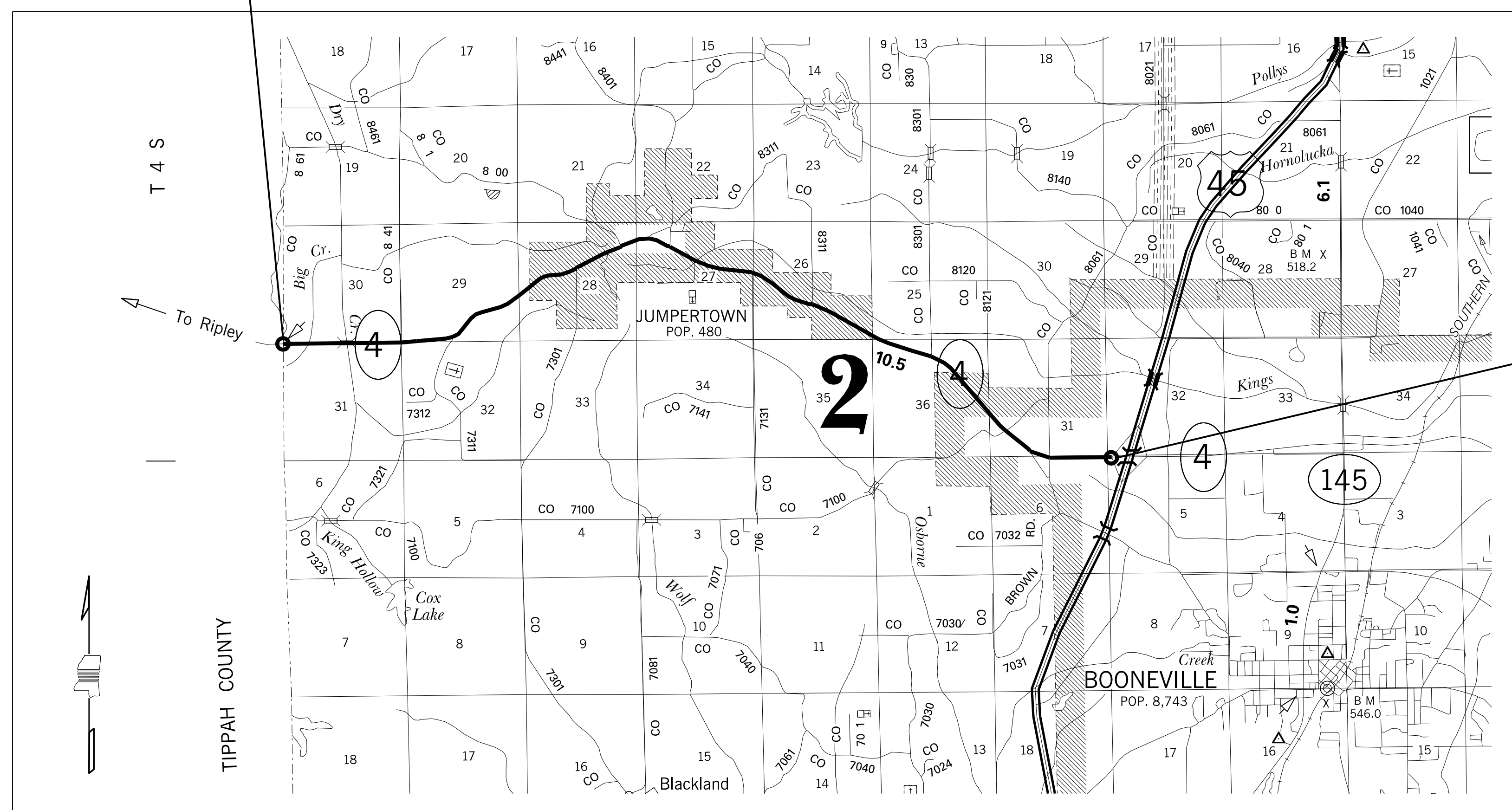

EOP 422 + 90

CONVENTIONAL SYMBOLS

COUNTY LINE	-----
TOWN CORPORATION LINE	-----
SECTION LINE	-----
EXISTING ROAD OR TRAVELED WAY	-----
PROPOSED ROAD OR TRAVELED WAY	-----
RAILROAD	-----
SURVEY LINE	-----
BRIDGES	-----

LENGTH DATA

LENGTH OF ROADWAY	41,290 FT.	7.82 MI.
LENGTH OF BRIDGES	182 FT.	0.03 MI.
LENGTH OF PROJECT (NET)		7.79 MI.
LENGTH OF EXCEPTIONS	0 FT.	0.00 MI.
LENGTH OF PROJECT (GROSS)		7.79 MI.

DESIGN CONTROL

MPH = V (SPEED DESIGN)
ADT () = : ADT () =
DHV = : D = % T = %

PERMITS ACQUIRED BY MDOT

WETLANDS AND WATERS PERMITS (NECESSARY FOR ULTIMATE IMPROVEMENTS ONLY):		
	WATERS	WETLANDS
NATIONWIDE #14	<input type="checkbox"/>	<input type="checkbox"/>
NATIONWIDE (OTHER)*	<input type="checkbox"/>	<input type="checkbox"/>
GENERAL*	<input type="checkbox"/>	<input type="checkbox"/>
INDIVIDUAL (404)*	<input type="checkbox"/>	<input type="checkbox"/>
* ACQUISITION OF PERMITS FOR TEMPORARY IMPACTS DURING CONSTRUCTION ARE THE RESPONSIBILITY OF THE CONTRACTOR		
STORMWATER PERMIT	<input checked="" type="checkbox"/>	
Y	REQUIRED, SCNOI SUBMITTED BY MDOT (DISTURBED AREA = 5 ACRES)	
S	REQUIRED, SCNOI TO BE SUBMITTED BY CONTRACTOR (1 TO 4.99 ACRES)	
N	NO STORMWATER PERMIT REQUIRED (<1 ACRE)	
APPROVED BY: _____		

P S & E DATE: 03 /20 /2017

APPROVED:
DEPUTY EXECUTIVE DIRECTOR / CHIEF ENGINEER
EXECUTIVE DIRECTOR



MMDDYY 00:00 BGRFLENAME ROADWAY TITLE DIVISION MISSISSIPPI DEPARTMENT OF TRANSPORTATION

1st O.REV.

STATE	PROJECT NO.
MISS.	MP-1004-59(011)

DESCRIPTION OF SHEET	REVISION DATE	WKG. NO.	SH. NO.
TITLE SHEET			1
DETAILED INDEX & GENERAL NOTES		DI-1	2
TYPICAL OVERLAY SECTION - LEVEL AND OVERLAY, STA. 10+00 - 422+90		TS-1	3
TYPICAL OVERLAY SECTION - MILLING OF BRIDGE ENDS, B.O.P., E.O.P. & CHANNELIZED INTERSECTION		TS-2	4
SUMMARY OF QUANTITIES		SQ-1	5
ESTIMATED QUANTITIES - FAILED AREAS		EQ-1	6
DETAIL OF CONSTRUCTION SIGNING		DSC-1	7
DETAIL OF CONSTRUCTION SIGNING		DSC-2	8
DETAIL OF CONSTRUCTION SIGNING		DSC-3	9
SPECIAL DESIGN SHEETS (3)			
2-LANE, 2-WAY CLEAR RAISED PAVEMENT MARKERS PLACED ON SIDE ROADS		CRMSR-2	10
RUMBLE STRIPES, 2-LANE HIGHWAYS (ASPH. LANES, VAR. ASPH. SHLD)		RS-1V	11
HIGHWAY SIGN AND BARRICADE DETAILS FOR CONSTRUCTION PROJECTS		SDTCP-10	12
STANDARD DRAWINGS - ROADWAY SHEETS (5)			
PAVEMENT MARKING DETAILS FOR 2-LANE AND 4-LANE DIVEDDED HIGHWAYS		PM-1	6120
TRAFFIC CONTROL PLAN WITH FLAGGER (ONE-LANE CLOSURE OF TWO-WAY TRAFFIC)		TCP-1	6250
TRAFFIC CONTROL PLAN MOBILE OPERATIONS MULTILANE ROADS AND TWO LANE ROADS		TCP-11	6260
TRAFFIC CONTROL PLAN UNEVEN PAVEMENT DETAILS		TCP-14	6263
TEMPORARY STRIPPING FOR 2-LANE AND 4-LANE DIVEDDED HIGHWAYS		TCP-15	6264

GENERAL NOTES:

- (A) FLUORESENT ORANGE SHEETING SHALL BE USED ON ALL CONSTRUCTION AND TRAFFIC CONTROL SIGNS EXCEPT FOR THOSE DESIGNATED ON THE PLANS TO BE BLACK LEGEND AND BORDER ON THE WHITE BACKGROUND.
- (B) THE LOCATION AND SPACING OF SIGNS, SHOWN ON THE TRAFFIC CONTROL PLANS, ARE APPROXIMATE AND MAY BE ADJUSTED AS NECESSARY TO FIT FIELD CONDITIONS.
- (C) ALL TRAFFIC CONTROL DEVICES ON THIS PROJECT SHALL COMPLY WITH PART VI OF THE MUTCD (LATEST EDITION).
- (D) WHERE MILLING IS REQUIRED, THE CONTRACTOR SHALL PROVIDE OUTLETS IN THE EXISTING SHOULDERS AT SUFFICIENT INTERVALS TO PREVENT POOLING OR STANDING WATER ON THE MILLED SURFACE, THE COST OF WHICH SHALL BE ABSORBED IN OTHER ITEMS BID.
- (E) TEMPORARY STRIPING SHALL CONFORM TO FINISHED STRIPE SPECIFICATIONS FOR ALIGNMENT, NEATNESS, AND STRAIGHTNESS.
- (F) ALL ADDENDA TO THESE PLANS WILL BE POSTED TO WWW.MDOT.MS.GOV UNDER THE PROPOSAL ADDENDA COLUMN. BIDDERS ARE ADVISED THAT HARD COPIES OF ANY ADDENDA FOR THIS PROJECT WILL NOT BE MAILED. IT IS THE BIDDER'S RESPONSIBILITY TO CHECK AND SEE IF ANY ADDENDA HAVE BEEN POSTED FOR THIS PROJECT. PLEASE CONTACT CONTRACT ADMINISTRATION DIVISION AT 601-359-7700 FOR ANY QUESTIONS REGARDING ELECTRONIC ADDENDA.
- (G) WHERE A PAPER JOINT IS REQUIRED, A TAPER SHALL BE PLACED AT (3) THREE HORIZONTAL FEET PER EACH (1) ONE VERTICAL INCH.

4/21/2017 2:22:33 PM 06068-HWY4- PRENTISS.DGN PLAN DIVISION MISSISSIPPI DEPARTMENT OF TRANSPORTATION

PS & E PLANS-DATE: 03/20/17		
FMS CON. # 306068/301000		
REVISIONS		
DATE	SHEET NO.	BY
4/21/17	5	DSP
4/21/17	5	DSP

REVISION	MISSISSIPPI DEPARTMENT OF TRANSPORTATION	
	DETAILED INDEX	
	PROJ. NO. : MP-1004-59(011)	WORKING NUMBER
	COUNTY: PRENTISS	DI-1
	FILENAME:	SHEET NUMBER
DESIGN TEAM	CHECKED	DATE
		2