

STATE	PROJECT NUMBER	SHEET NO.
MISSISSIPPI	MP-1025-48(011)	1

GENERAL INDEX

INCLUDED THIS PROJECT	BEGIN WITH SHEET
<input checked="" type="checkbox"/> ROADWAY	1
<input type="checkbox"/> PERMANENT SIGNS	1001
<input type="checkbox"/> TRAFFIC SIGNALS	2001
<input type="checkbox"/> ITS COMPONENTS	3001
<input type="checkbox"/> LIGHTING	4001
<input type="checkbox"/> (RESERVED)	5001
<input type="checkbox"/> ROADWAY STANDARD DWGS	6001
<input type="checkbox"/> BOX CULVERT STD. DRAWINGS (LRFD)	7001
<input type="checkbox"/> BOX CULVERT STD. DRAWINGS (STD. SPEC.)	7501
<input type="checkbox"/> BRIDGE	8001
<input type="checkbox"/> CROSS SECTIONS	9001

BRIDGE STRUCTURES REQ'D.

BOX BRIDGES REQ'D.

STA. 10+00

E.O.P. 68+82

B.O.P. 58+88

STA. 678+10

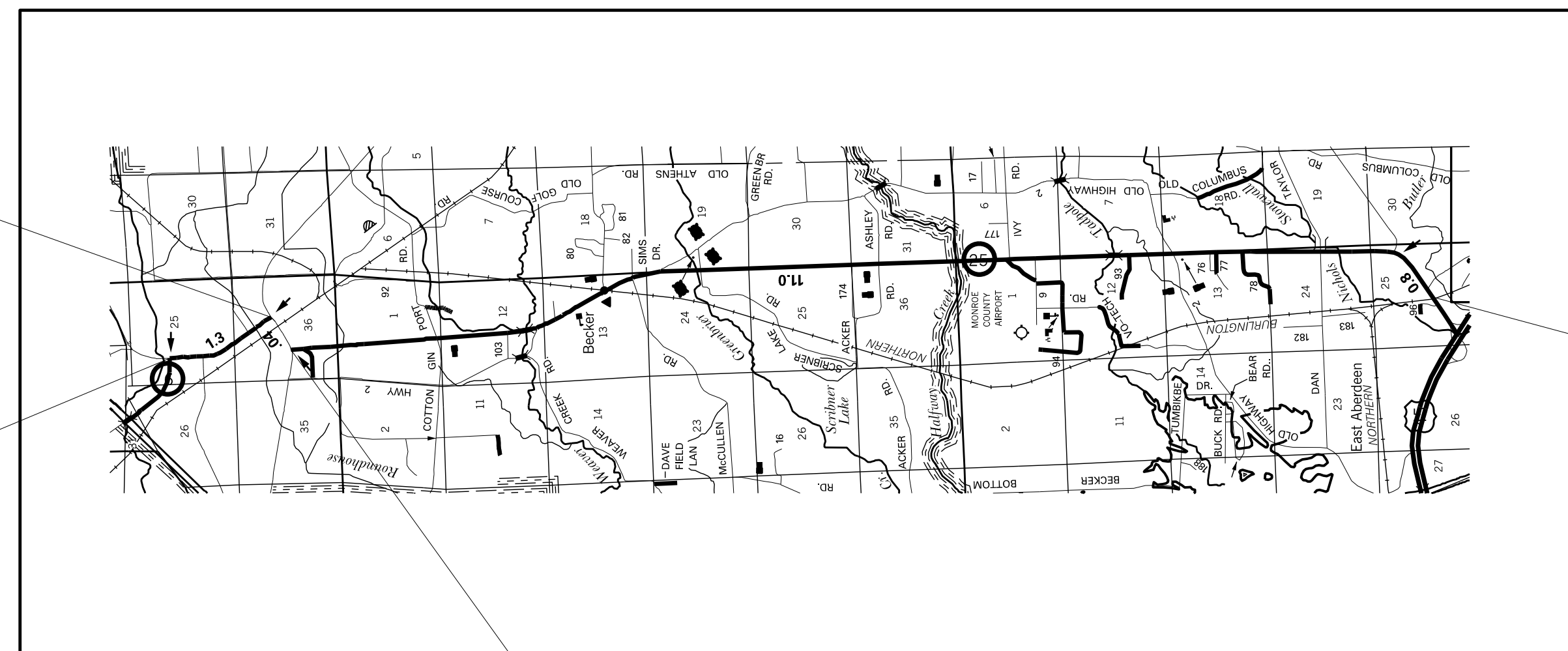

STATE OF MISSISSIPPI

MISSISSIPPI DEPARTMENT OF TRANSPORTATION

PLAN AND PROFILE OF PROPOSED STATE HIGHWAY 25 STATE PROJECT NO. MP-1025-48(011)

SR 25 FROM US 45 SOUTH OF ABERDEEN TO SR 6 IN AMORY MONROE CO

FMS. CONST. NO. 306071 / 301000 302000 303000

SCALES

PLAN	1 IN. = 100 FT.
PROFILE {	HOR. 1 IN. = 100 FT.
	VERT. 1 IN. = 10 FT.
LAYOUT	1 IN. = FT.

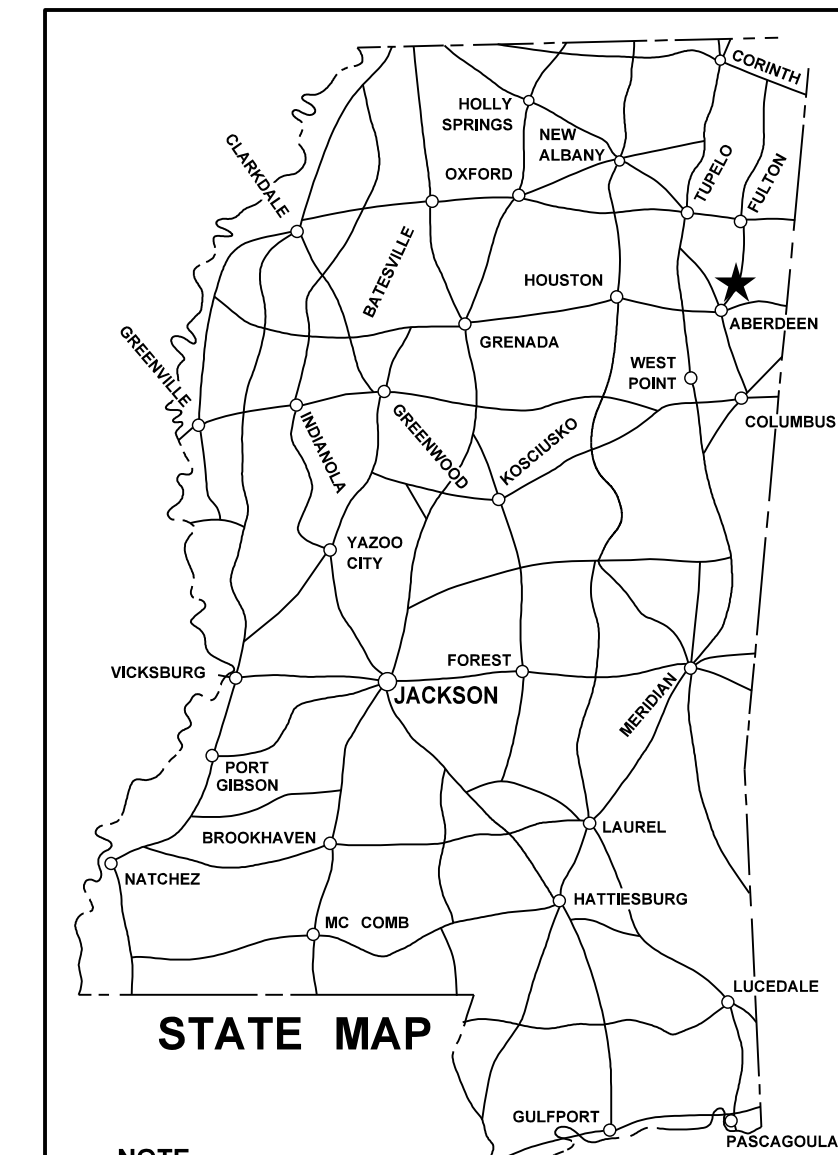

NOTE
★ INDICATES APPROXIMATE LOCATION OF PROJECT.
LAT. 33° 54' 45" N LONG. 88° 28' 43" W
(APPROX. MIDDLE OF PROJECT)

DESIGN CONTROL

MPH = V (SPEED DESIGN)

ADT () = : ADT () =

DHV = : D = % T = %

PERMITS ACQUIRED BY MDOT

WETLANDS AND WATERS PERMITS (NECESSARY FOR ULTIMATE IMPROVEMENTS ONLY):

	WATERS	WETLANDS
NATIONWIDE #14	<input type="checkbox"/>	<input type="checkbox"/>
NATIONWIDE (OTHER)*	<input type="checkbox"/>	<input type="checkbox"/>
GENERAL*	<input type="checkbox"/>	<input type="checkbox"/>
INDIVIDUAL (404)*	<input type="checkbox"/>	<input type="checkbox"/>

* ACQUISITION OF PERMITS FOR TEMPORARY IMPACTS DURING CONSTRUCTION ARE THE RESPONSIBILITY OF THE CONTRACTOR

STORMWATER PERMIT

Y REQUIRED, CNOI SUBMITTED BY MDOT (DISTURBED AREA = 5 ACRES)

S REQUIRED, CNOI TO BE SUBMITTED BY CONTRACTOR (1 TO 4.99 ACRES)

N NO STORMWATER PERMIT REQUIRED (<1 ACRE)

APPROVED BY: _____

CONVENTIONAL SYMBOLS

COUNTY LINE	-----
TOWN CORPORATION LINE	-----
SECTION LINE	--- § --- § --- § ---
EXISTING ROAD OR TRAVELED WAY	-----
PROPOSED ROAD OR TRAVELED WAY	-----
RAILROAD	-----
SURVEY LINE	-----
BRIDGES	-----

EQUATIONS

LENGTH DATA

LENGTH OF ROADWAY	70567 FT.	13.36 MI.
LENGTH OF BRIDGES	380 FT.	.07 MI.
LENGTH OF PROJECT (NET)	70947 FT.	13.44 MI.
LENGTH OF EXCEPTIONS	0 FT.	0 MI.
LENGTH OF PROJECT (GROSS)	70947 FT.	13.44 MI.

EXCEPTIONS

P S & E DATE: 2/24/2017

APPROVED: _____
DEPUTY EXECUTIVE DIRECTOR / CHIEF ENGINEER
EXECUTIVE DIRECTOR _____



2/24/2017 11:28 AM HWY 25 SOUTH PLANS TITLE DIVISION MISSISSIPPI DEPARTMENT OF TRANSPORTATION

