

SECTION 905 -- PROPOSAL (CONTINUED)

I (We) hereby certify by digital signature and electronic submission via Bid Express of the Section 905 proposal below, that all certifications, disclosures and affidavits incorporated herein are deemed to be duly executed in the aggregate, fully enforceable and binding upon delivery of the bid proposal. I (We) further acknowledge that this certification shall not extend to the bid bond or alternate security which must be separately executed for the benefit of the Commission. This signature does not cure deficiencies in any required certifications, disclosures and/or affidavits. I (We) also acknowledge the right of the Commission to require full and final execution on any certification, disclosure or affidavit contained in the proposal at the Commission's election upon award. Failure to so execute at the Commission's request within the time allowed in the Standard Specifications for execution of all contract documents will result in forfeiture of the bid bond or alternate security.

Bidder acknowledges receipt of and has added to and made a part of the proposal and contract documents the following addendum (addenda):

ADDENDUM NO. 1 DATED 5/22/2017 ADDENDUM NO. DATED
 ADDENDUM NO. 2 DATED 5/23/2017 ADDENDUM NO. DATED

Number	Description
1	Postponed to June 1, 2017 Letting, Amendment EBS Download Required.
2	Revised Table of Contents; Revised NTB No. 104; Added SP No. 907-619-3; Revised Bid Items; Amendment EBS Download Required.

TOTAL ADDENDA: 2
 (Must agree with total addenda issued prior to opening of bids)

Respectfully Submitted,
 DATE _____

 Contractor
 BY _____
 Signature
 TITLE _____
 ADDRESS _____
 CITY, STATE, ZIP _____
 PHONE _____
 FAX _____
 E-MAIL _____

(To be filled in if a corporation)

Our corporation is chartered under the Laws of the State of _____ and the names, titles and business addresses of the executives are as follows:

_____	President	Address
_____	Secretary	Address
_____	Treasurer	Address

The following is my (our) itemized proposal.

MP-6011-55(022)/ 306147301000
 Pearl River County(ies)

**MISSISSIPPI DEPARTMENT OF TRANSPORTATION
TABLE OF CONTENTS**

PROJECT: MP-6011-55(022)/306147301 - Pearl River

Section 901 - Advertisement

Section 904 - Notice to Bidders

- #1 Governing Specification
- #3 Final Cleanup
- #9 Federal Bridge Formula
- #12 MASH Compliant Devices
- #13 Safety Edge
- #16 Standard Drawings
- #103 Contract Time
- #104 Scope of work
- #113 Tack Coat

Section 907 - Special Provisions

- 907-618-3 Additional Signing Requirements, w/Supplement
- 907-619-3 Temporary Portable Rumble Stripe

Section 905 - Proposal, Proposal Bid Items, Combination Bid Proposal

State Board of Contractors Requirement

State Certification Regarding Non-Collusion, Debarment and Suspensions

Section 902 - Contract Form

Section 903 - Contract Bond Forms

Progress Schedule

(REVISIONS TO THE ABOVE WILL BE INDICATED ON THE SECOND SHEET
OF SECTION 905 AS ADDENDA)

05/23/2017 12:05 PM

MISSISSIPPI DEPARTMENT OF TRANSPORTATION

SECTION 904 - NOTICE TO BIDDERS NO. 104

CODE: (SP)

DATE: 03/22/2017

SUBJECT: Scope of Work

PROJECT: MP-6011-55(022) / 306147301 - Pearl River County

The contract documents do not include an official set of construction plans but may, by reference, include some Standard Drawings when so specified in a Notice to Bidders entitled "Standard Drawings". All other references to plans in the contract documents and Standard Specifications for Road and Bridge Construction are to be disregarded.

Work on the project shall consist of the following:

OVERLAY U. S. HIGHWAY 11
FROM SOUTH APPLE DRIVE TO MILLARD - 6.6 MILES

(A) Prior to the overlay, centerline alignment shall be determined by the Contractor by measuring the existing roadway at 500-foot intervals in tangent sections, and 100-foot intervals in horizontal curves.

(B) Cold mill a 100-foot transition at the BOP, through the two box culvert locations, a 100-foot transition at the EOP, local roads to ROW as directed by the Project Engineer, and any other areas designated by the Project Engineer to ensure smooth transition of new overlay with existing grade. (See Typical Drawings).

(C) One area has been identified for base repair. It is located as follows:

<u>Approximate Location</u>	<u>Lane</u>	<u>Size</u>	<u>Area (sf)</u>
169+75	Left and Right	26' x 30'	780

This failed area shall be repaired by full depth removal and backfilling with asphalt 19-mm, ST, asphalt (estimated 40 tons).

(D) Widening of the roadway will be required at the Cemetery Road intersection. The widening will be both north and south of the intersection approximately 300 feet in each direction and 12 feet wide. This will allow for the addition of left turn lanes as shown in the attached drawings.

(E) Prior to placement of the asphalt, all raised pavement markers throughout the project shall be removed (cost absorbed). Overlay Highway 11 and all side roads to State ROW with 1" of 9.5-mm, MT, asphalt. A ¾" leveling lift of 9.5-mm, MT, leveling asphalt shall be required on the mainline from BOP to EOP or as directed by the Project Engineer. Publicly maintained roads or streets shall be surfaced to the existing ROW; privately owned entrances shall be surfaced a distance of 10 feet and variable from edge of pavement. Any site grading at local

roads or drives will not be measured for separate payment but will be considered an absorbed item. Cross slopes shall be increased where practical with contract quantities in an effort to achieve a uniform cross slope of 2%.

It is estimated that 5,850 tons of 9.5-mm, MT, asphalt will be used for the mainline and 350 tons of 9.5-mm, MT, asphalt will be used for local roads and driveways.

(F) The Mean Roughness Index (MRI) shall be used to determine the pavement smoothness.

(G) Sawing and sealing of transverse joints will be required in the surface asphalt. The Contractor will be responsible to locate/mark these joints prior to construction.

(H) Temporary and permanent striping shall be placed where existing stripes are located and shall conform to finished stripe specifications for alignment, neatness, reflectivity, and straightness. When the centerline or turn lane stripe is removed during milling operations, temporary stripe shall be placed prior to opening the roadway to traffic. All permanent pavement markings on asphalt are to be hot thermoplastic. Edge lines will be placed so as to maintain the original lane width.

(I) Raised pavement markers will be placed at 80-foot intervals in tangents and 40-foot intervals in curves along the centerline of roadway.

(J) Raise the existing shoulders to match the new pavement with Size 825B Crushed Stone Base. Placement of the shoulder material(s) on the finished surface course shall not be permitted. The material(s) shall be bladed, rolled, and compacted to a finished slope of 4% where practical.

(K) It shall be the responsibility of the Contractor to protect existing structures such as pipes, inlets, aprons, bridges, etc. from damage which might occur during construction. The Contractor shall replace or repair, as directed by the Project Engineer, any structures damaged during the life of the contract. No payment will be made for the replacement or repair of damaged items.

(L) Incidental work such as removing vegetation, shaping and compaction of shoulder, removing excess asphalt material, project clean-up, and other incidental work necessary to complete the project will not be measured for separate payment, but will be included in other bid items.

(M) If pavement section marking tape is encountered on this project, it shall be located prior to overlaying and placed back in the same location after paving operations have ceased. The section marking shall be 8-inch high performance cold plastic detail stripe and shall be four feet (4') in length. The marking shall be centered across the centerline stripe. The cost of this item shall be absorbed in other bid items.

(N) All Construction signing as well as Plastic Traffic Drums and Barricades are included in the bid for Pay Item 618-A, Maintenance of Traffic. Fluorescent orange sheeting shall be used on all construction and traffic control signs except for R4-1 and R4-2 signs which shall be black legend and border on white background. The Contractor shall erect and maintain construction

signing, and provide all signs and traffic handling devices in accordance with Manual Uniform Traffic Control Devices (MUTCD).

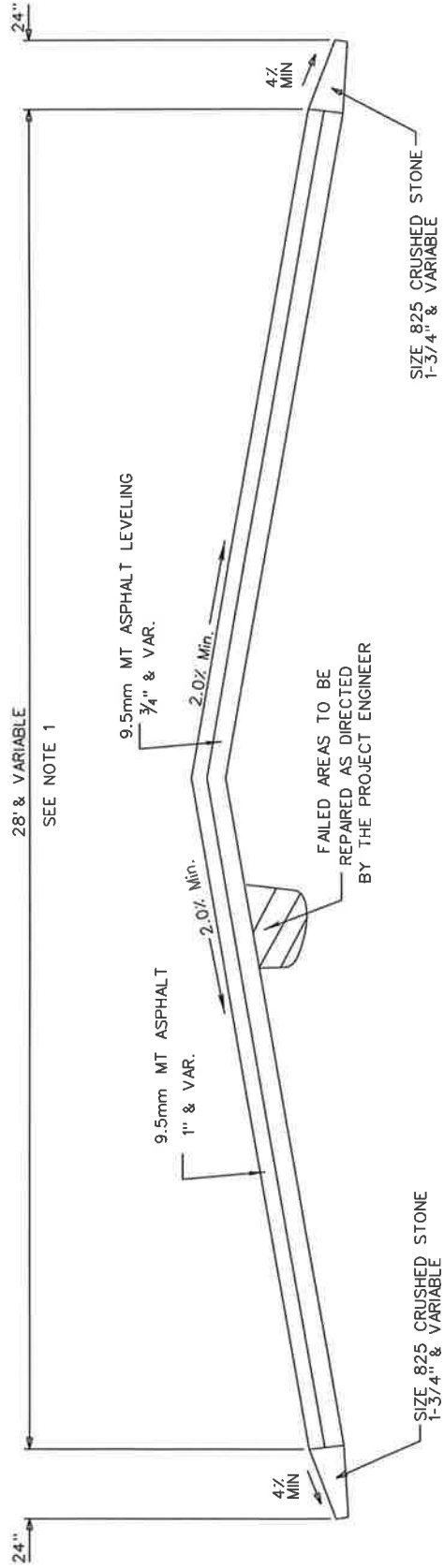

NOTES:

- (1) TRUE CENTERLINE PAVEMENT ALIGNMENT SHALL BE DETERMINED BY THE CONTRACTOR BY MEASURING THE EXISTING ROADWAY AT 500ft. INTERVALS IN TANGENT SECTIONS, AND 100ft. INTERVALS IN HORIZONTAL CURVES.

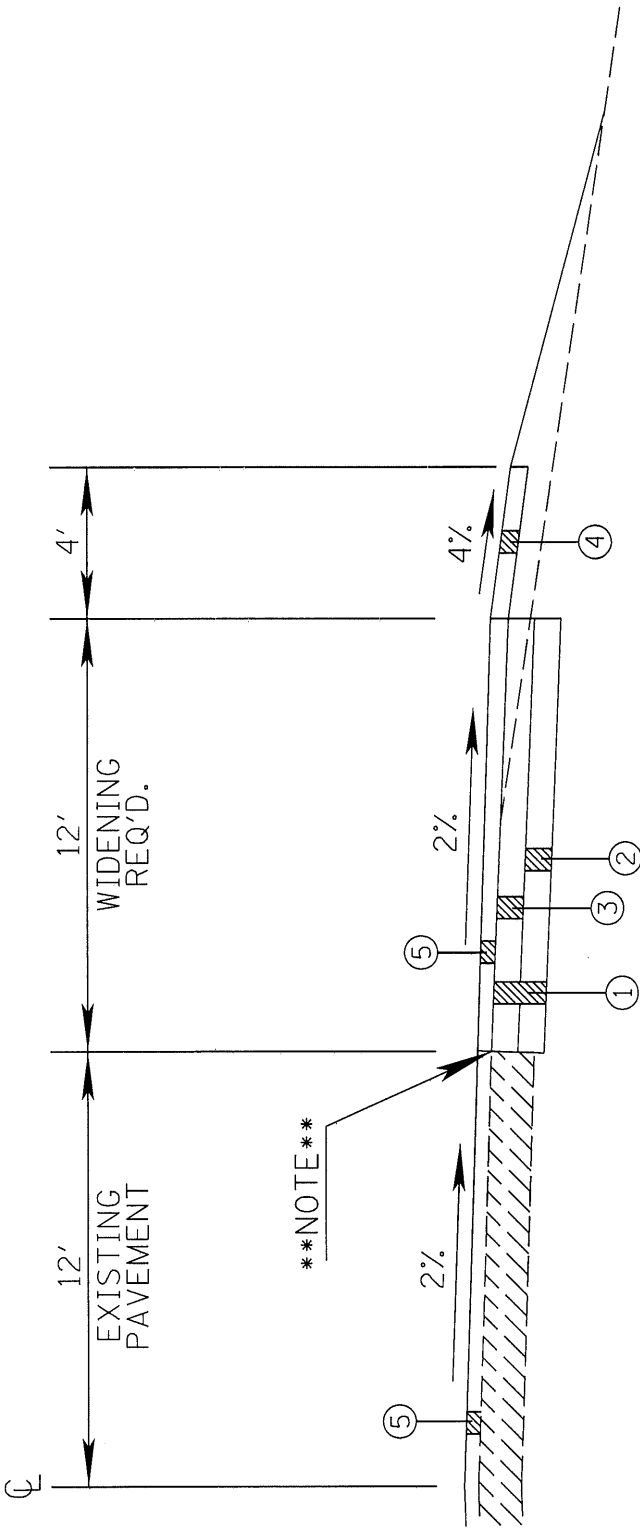

NOTE

- ① 12" DEPTH UNDERCUT REQ'D MATERIAL FROM UNDERCUT TO BE USED FOR WIDENED SHOULDER (ABSORBED ITEM)
- ② 6" DEPTH CRUSHED STONE BASE REQ'D
- ③ 6" DEPTH ASPHALT REQ'D 2@3" (MT), 19mm MIX
- ④ 1 3/4" DEPTH CRUSHED STONE BASE REQ'D
- ⑤ LEVELING AND OVERLAY WITH MAINLINE

NOTE

THE EXISTING PAVEMENT EDGE SHALL BE CUT TO A SMOOTH AND NEAR VERTICAL FACE WITH AN APPROVED CUTTING DEVICE. (NOT TO BE MEASURED FOR SEPARATE PAY)

TYPICAL FOR WIDENING

TYPICAL MILLING DIAGRAM

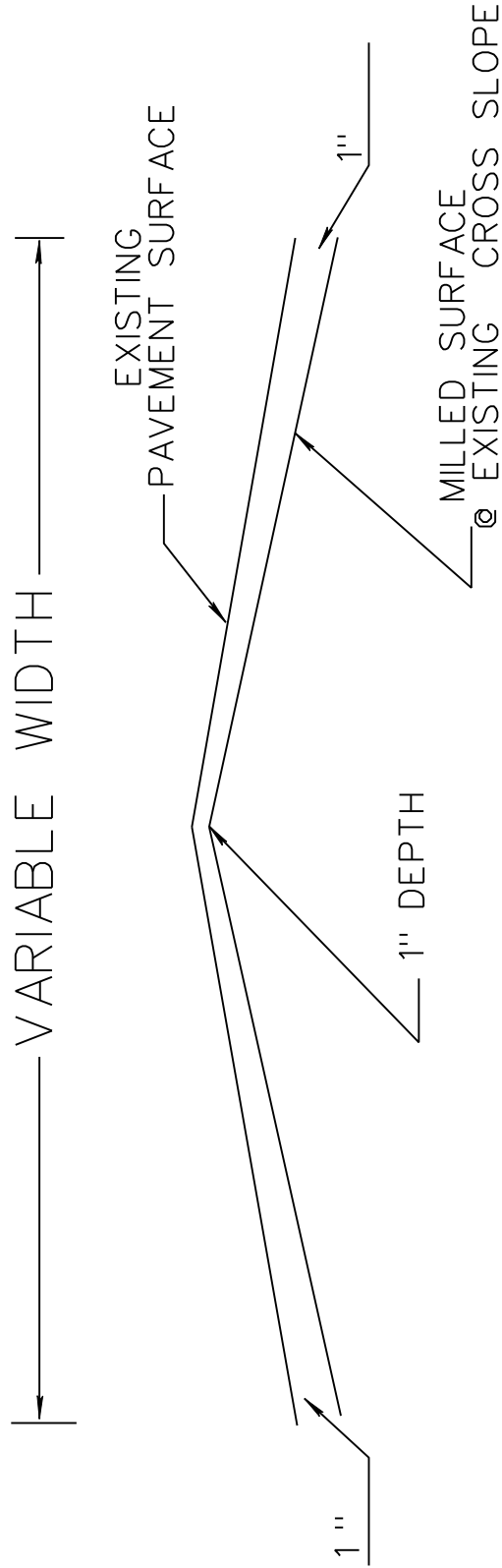

PRIVATE DRIVEWAY DETAIL

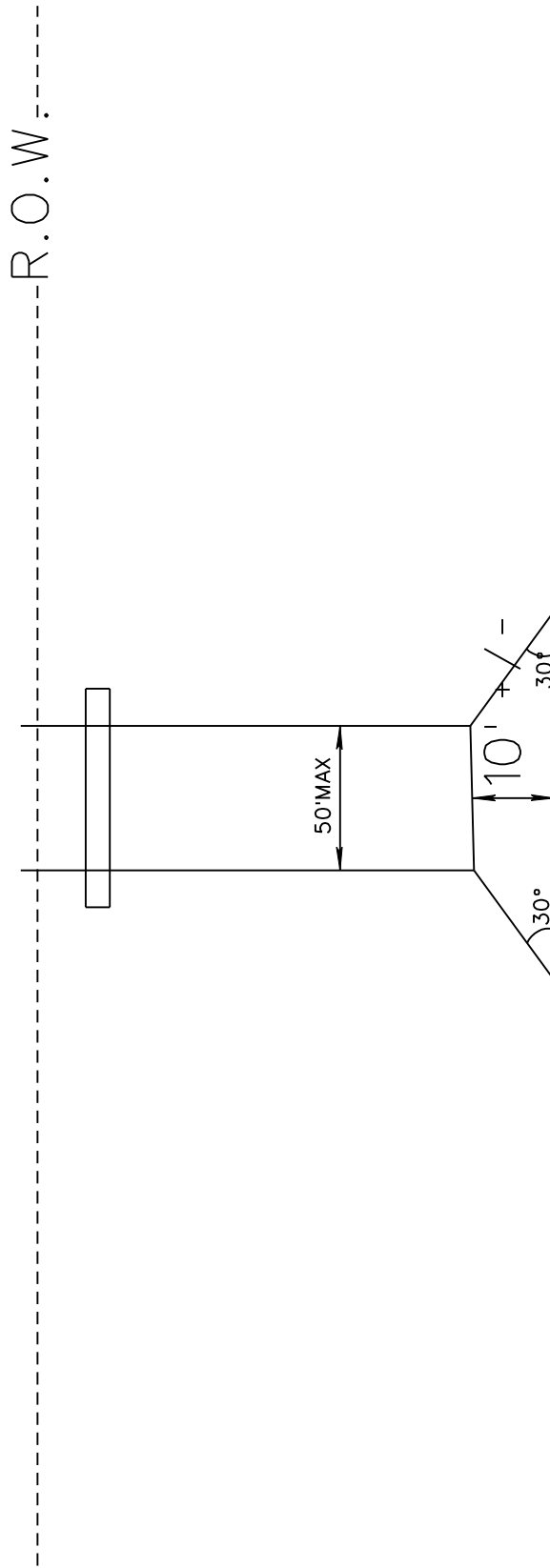

-----R.O.W.-----
-----C/L OF ROADWAY-----

TYPICAL FOR PAVED TAPER AT LOCAL ROADS

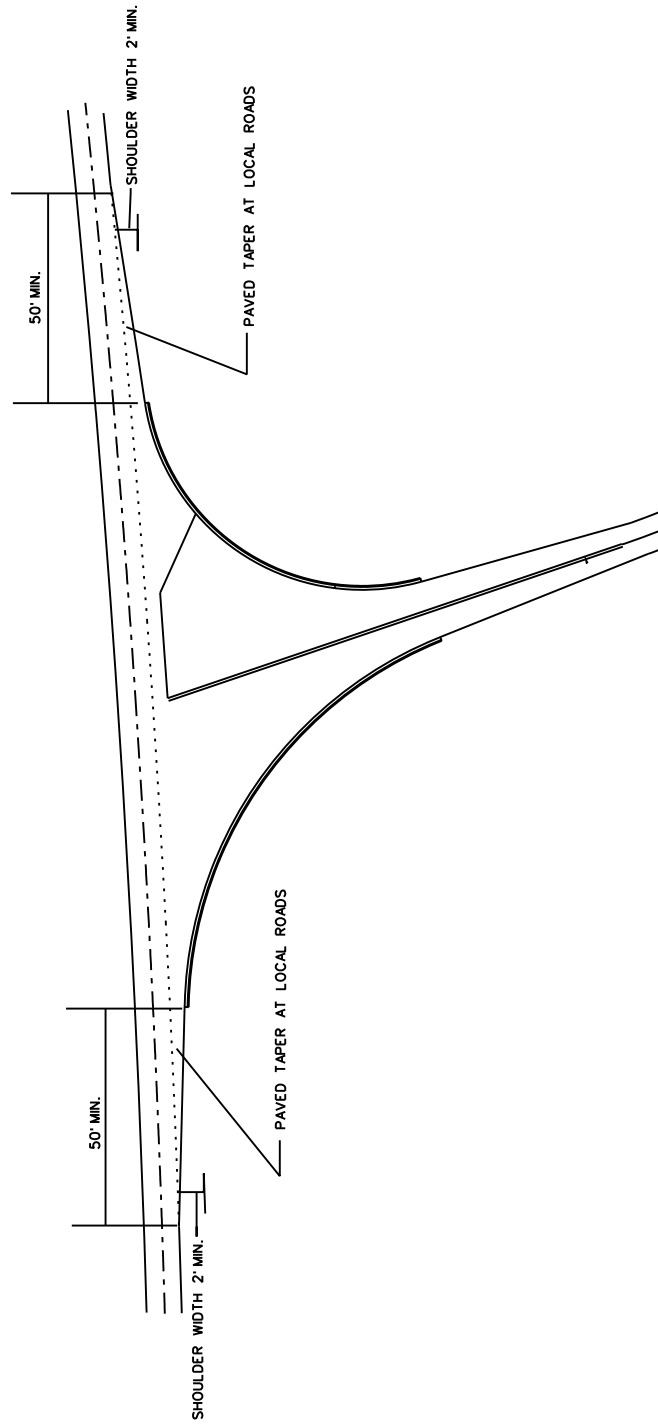

TYPICAL STRIPING AT RAILROAD CROSSING

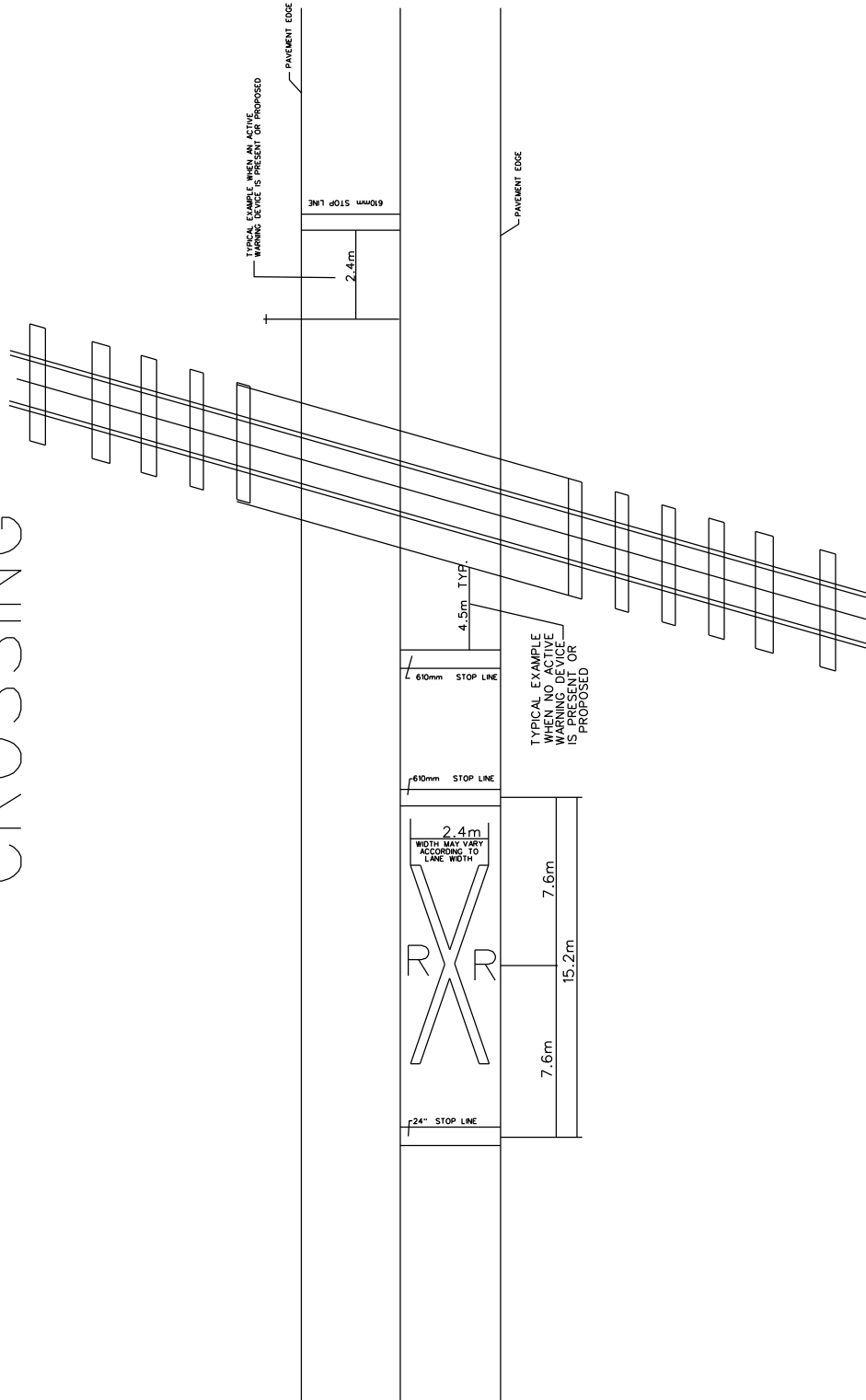

TYPICAL STRIPING AT RAILROAD CROSSING

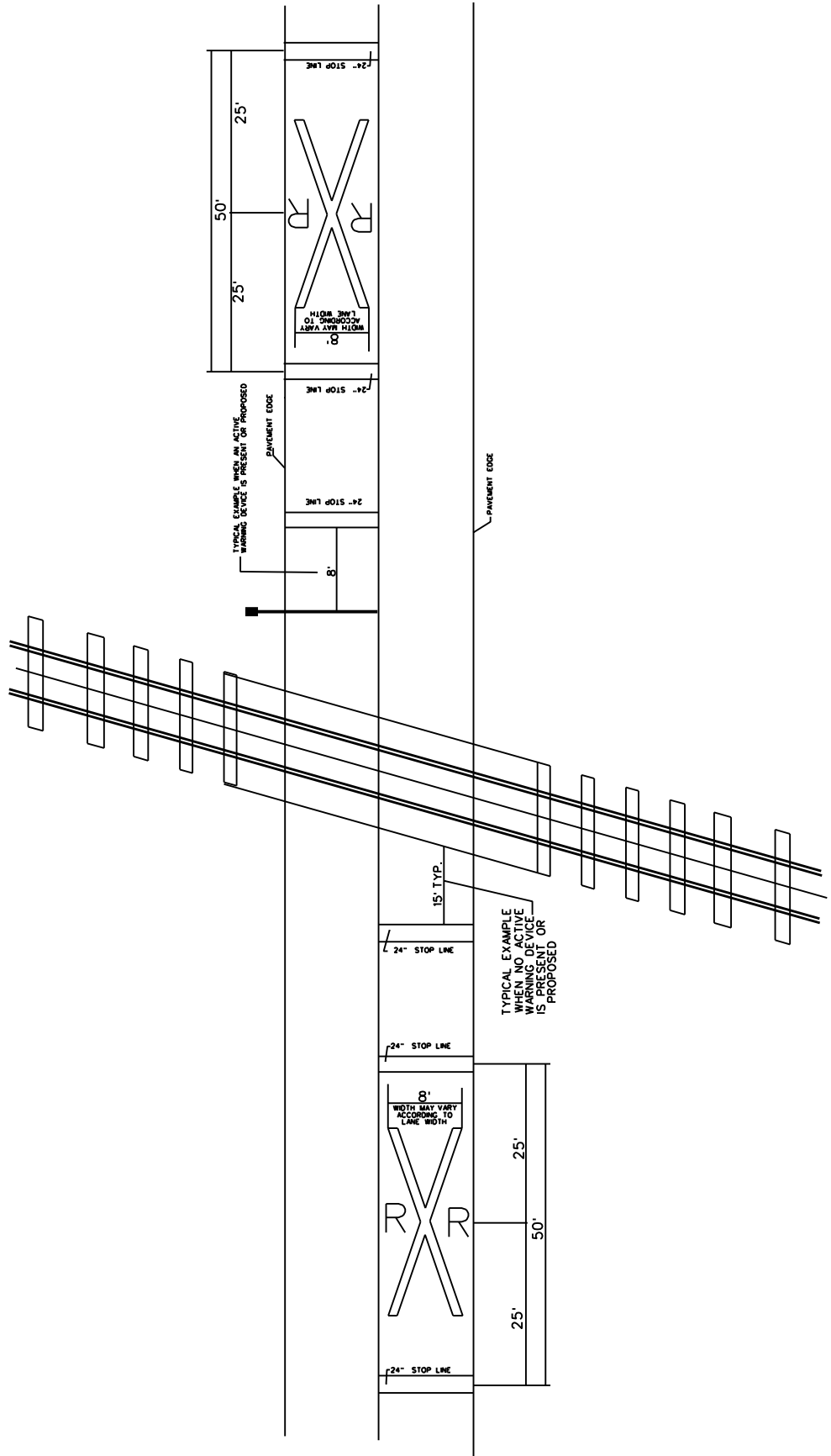

- GENERAL NOTES
1. GROUND-IN RUMBLE STRIPS SHALL BE OMITTED ACROSS PRINCIPAL INTERSECTING ROADWAYS OR OTHER INTERRUPTIONS IN NORMAL SHOULDER WIDTH AS DIRECTED BY THE ENGINEER
 2. GROUND-IN RUMBLE STRIPS SHALL BE APPLIED TO MAINLINE ONLY.

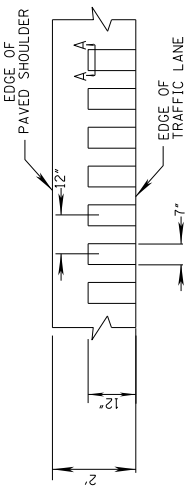

DETAIL "A"

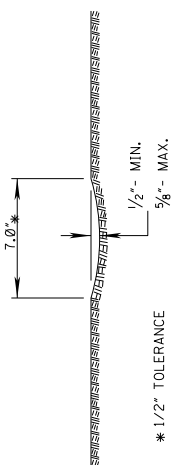

SECTION "A-A"

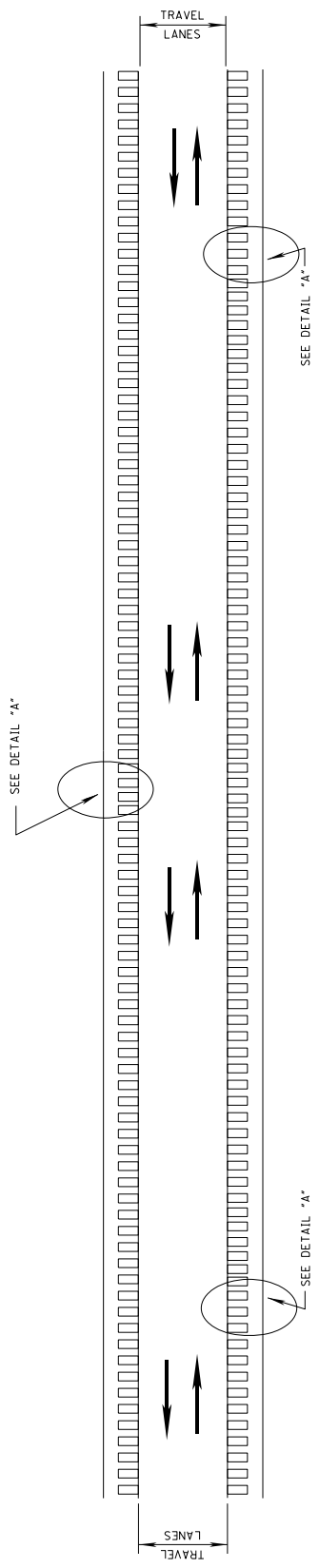

PLAN
NOT TO SCALE
DETAIL OF
RUMBLE STRIPS
(GROUND-IN)

MISSISSIPPI DEPARTMENT OF TRANSPORTATION	
TYPICAL SECTION	
RUMBLE STRIPS (GROUND-IN)	
WORKING NUMBER	RS
FILE NAME	DESIGN TEAM
DATE	CREATED
BY	REVISION

STATE	PROJECT NO.
MISS.	UPDATE

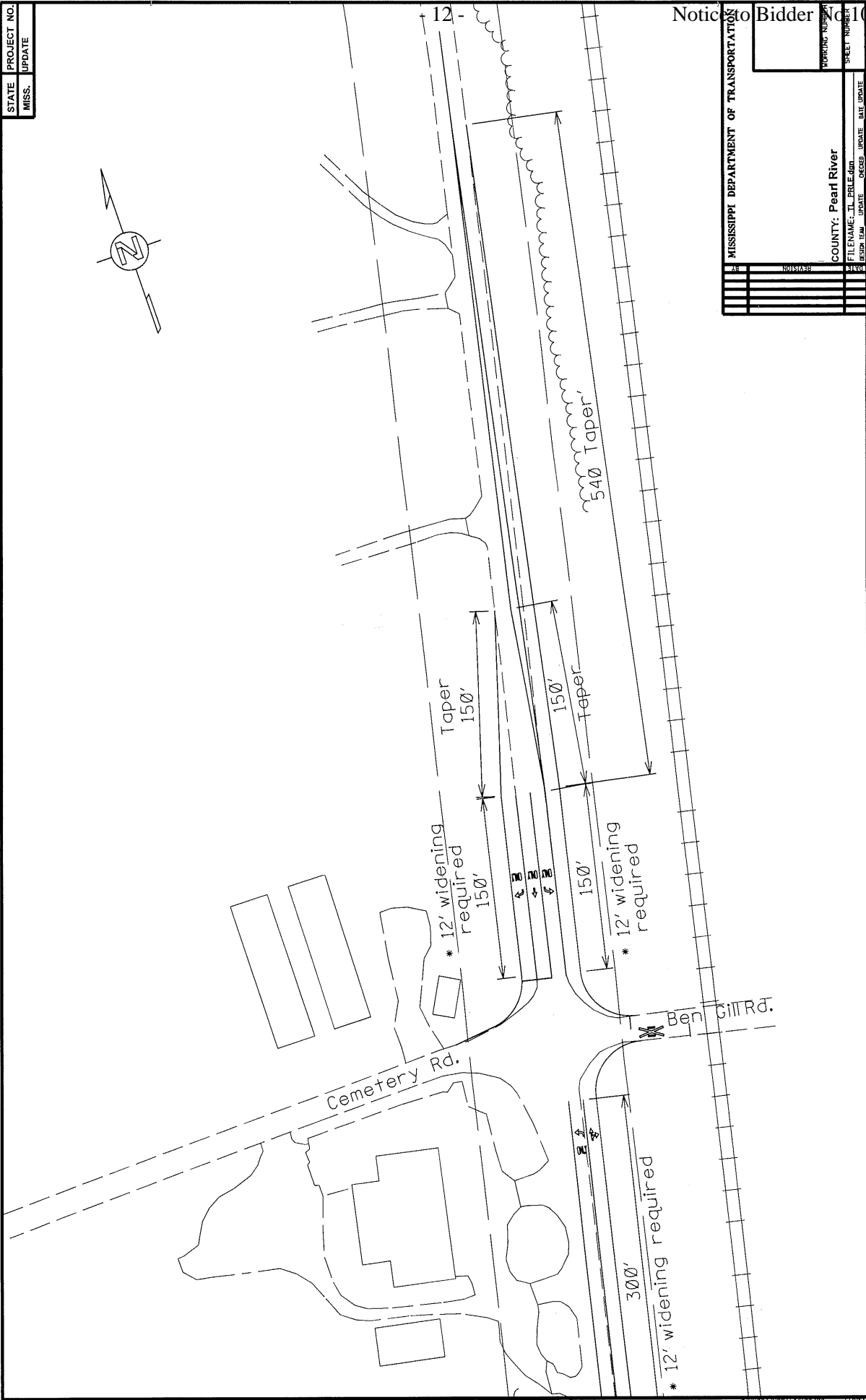
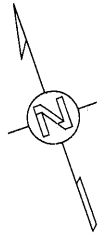

MISSISSIPPI DEPARTMENT OF TRANSPORTATION	
WORKING NUMBER	SHEET NUMBER
COUNTY: Pearl River	
FILENAME: JL_PRL104.dwg	
ESDP: JFW	UPDATE: CRES
DATE: 10/10/03	DATE: 10/10/03

STATE PROJECT NO.
MISS.

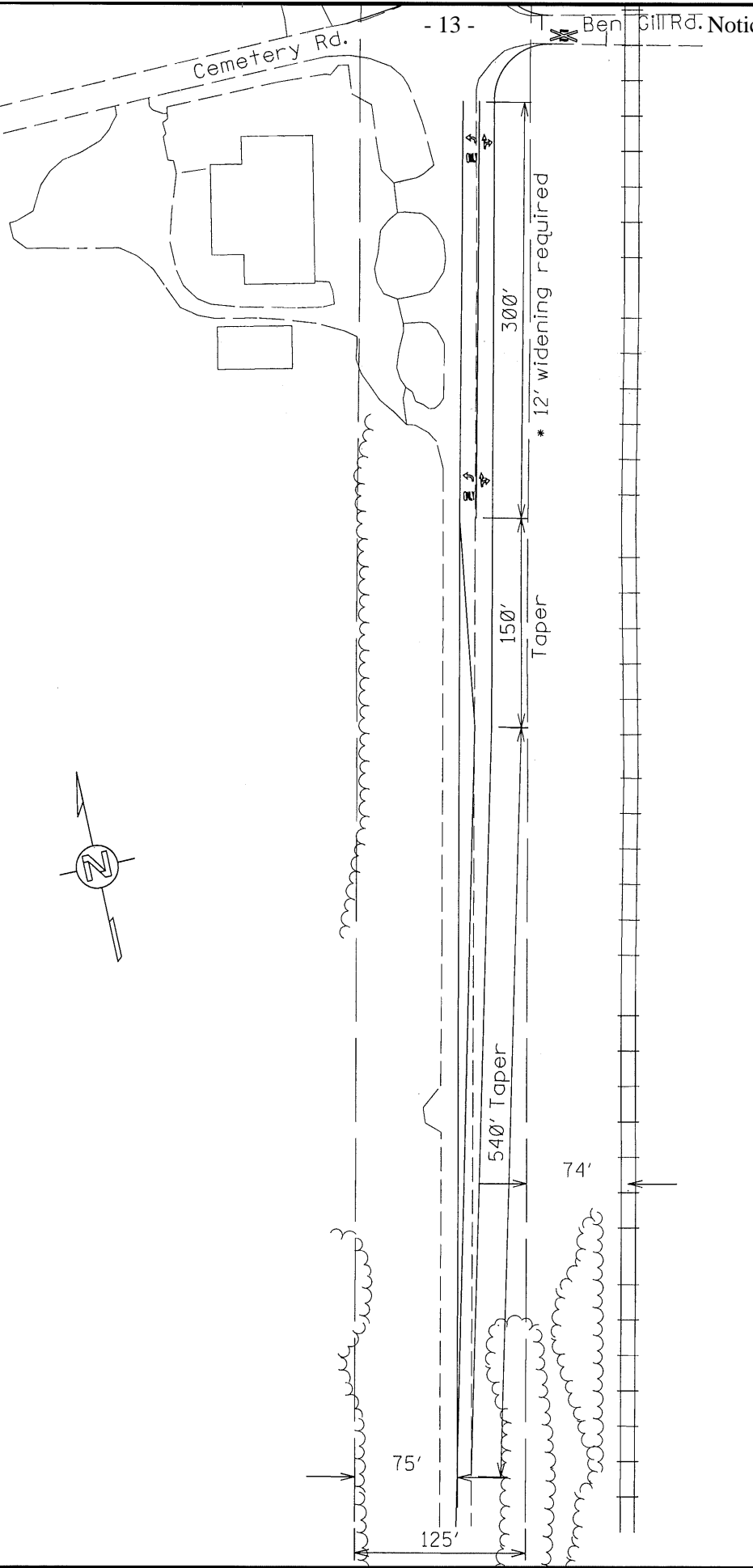

- 13 -

Ben City Rd. Notice to Bidder No. 04 -- Cont'd

MISSISSIPPI DEPARTMENT OF TRANSPORTATION	
WORKING NUMBER	
SHEET NUMBER	
COUNTY: Pearl River	
FILENAME: I.L.PRL.EJOB	
DESIGN TEAM	
DATE	
UPDATE	
DATE	
UPDATE	

TYPICAL STRIPING FOR SIMPLE INTERSECTION AT LOCAL ROADS

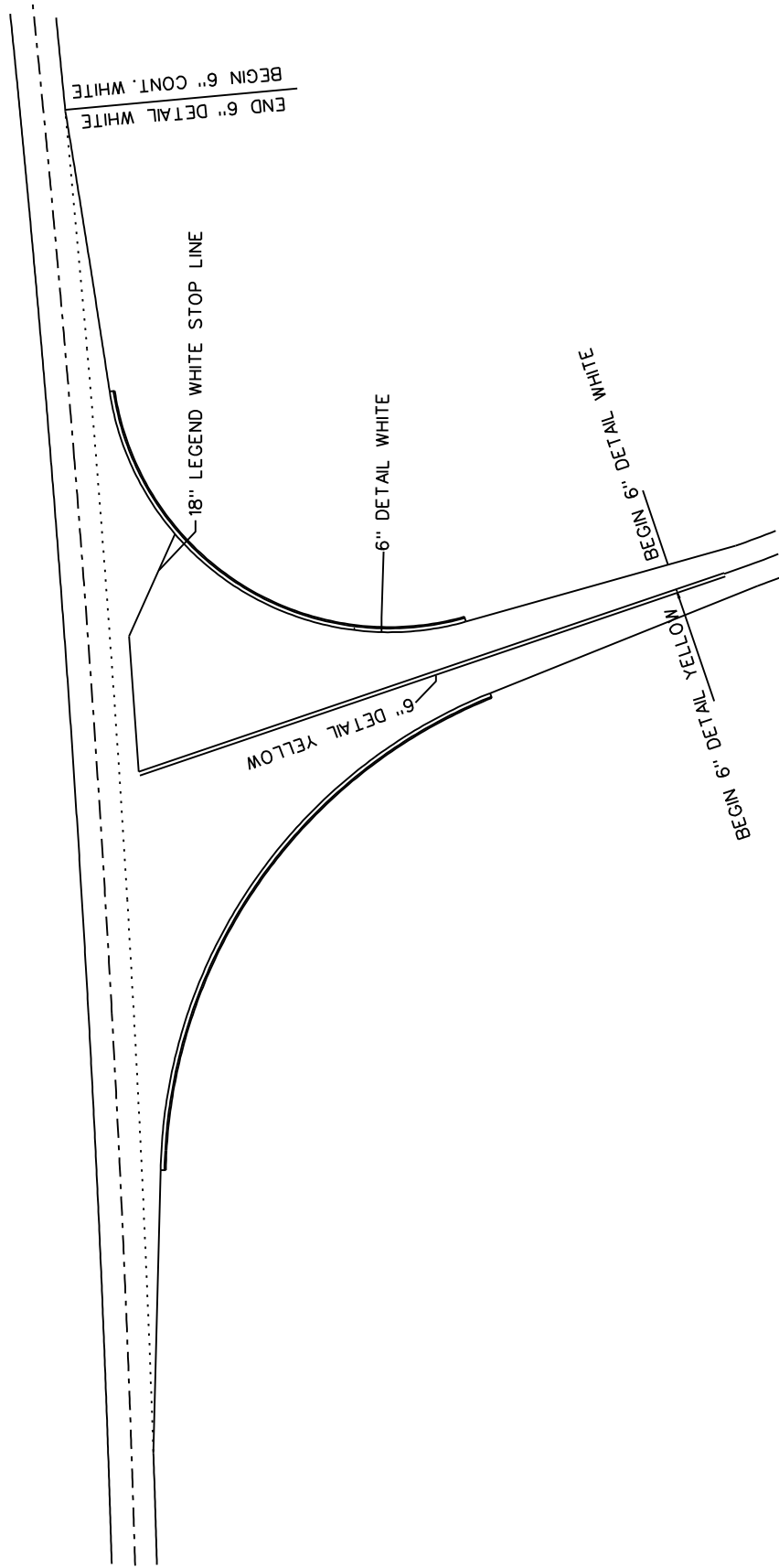

STATE	PROJECT NO.
MISS.	

TYPICAL FOR RAISED PAVEMENT MARKERS PLACED ON SIDE ROAD RADIUS

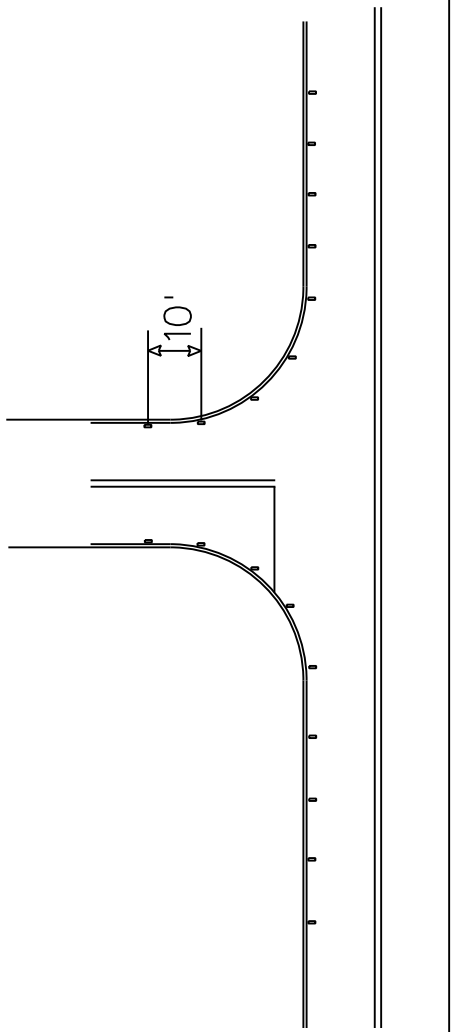

NOTE 1. MARKERS SHALL BE PLACED EVERY 10 FEET.

NOTE 2. MARKERS SHALL BE VISIBLE FROM THE TRAVELING MOTORIST ON STATE DESIGNATED HIGHWAYS.

NOTE 3. MARKERS SHALL BE HIGH PERFORMANCE TWO WAY CLEAR.

NOTE 4. 5 MARKERS SHALL BE PLACED ALONG MAINLINE EDGE STRIPE.

NOTE 5. MARKERS FOR COUNTY RD. SHALL BEGIN AT RADIUS AND CONTINUE DOWN EDGE STRIPE A DISTANCE OF 40 FEET.

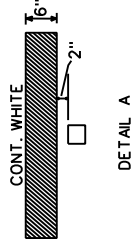

DETAIL A

MISSISSIPPI DEPARTMENT OF TRANSPORTATION	
2-LANE	
RAISED PAVEMENT MARKERS	
PLACED ON SIDE ROADS	
DATE	DATE
FILE NAME:	FILE NAME:
DRAWN BY:	DRAWN BY:
CHECKED BY:	CHECKED BY:
DESIGNED BY:	DESIGNED BY:
PROJECT NO.:	PROJECT NO.:
SHEET NUMBER:	SHEET NUMBER:
TOTAL SHEETS:	TOTAL SHEETS:

08/28/2011 10:41:11 AM

MISSISSIPPI DEPARTMENT OF TRANSPORTATION

SPECIAL PROVISION NO. 907-619-3

CODE: (SP)

DATE: 01/17/2017

SUBJECT: Temporary Portable Rumble Strips

Section 619, Traffic Control for Construction Zones, of the 2017 Edition of the Mississippi Standard Specifications for Road and Bridge Construction is hereby amended as follows.

907-619.02--Materials. After Subsection 619.02.15 on page 472, add the following.

907-619.02.16--Temporary Portable Rumble Strips. Temporary portable rumble strips shall be made of engineered polymers and may be composed of interlocking segments or may have a hinge at the midpoint. The rumble strips shall consist of the following:

- capable of being installed without adhesives or bolts,
- have a minimum weight of 100 pounds,
- have a minimum overall length of 11 feet,
- have a minimum width of 12 inches, and
- have a maximum height of 3/4 inch.

Temporary portable rumble strips shall be installed in accordance with the attached details, or as directed by the Engineer.

907-619.03--Construction Requirements. After Subsection 619.03.11 on page 476, add the following.

907-619.03.16--Temporary Portable Rumble Strips. Temporary portable rumble strips shall be placed at locations shown on the traffic control plans, attached drawing, or as directed by the Engineer. The rumble strips shall be removed when lane closures are removed, relocated when lane closures are relocated, or as directed by the Engineer.

Prior to placement of the rumble strips, the roadway shall be cleaned to be free of dust, sand, and other materials that may cause slippage. The minimum roadway temperature at the time of installation shall be in accordance with manufacturer recommendations.

A minimum of three (3) temporary portable rumble strips shall be arranged in an array. The spacing of temporary portable rumble strips in each array shall be on 10-foot centers. Two arrays of three (3) strips each shall be used in the lane. The rumble strips shall be regularly monitored and maintained to ensure they stay in place under traffic.

907-619.04--Method of Measurement. At the end of Subsection 619.04 on page 478, add the following.

Temporary Portable Rumble Strips will be measured for payment by the linear foot only when a pay item for temporary portable rumble strips is included in the contract. Otherwise, temporary portable rumble strips will be included in the cost of pay item 907-618, Maintenance of Traffic. The quantity of temporary portable rumble strips will be the length of rumble strips approved by the Engineer to be in-place on the project at any one time.

907-619.05--Basis of Payment. After the fifth paragraph of Subsection 619.05 on page 478, add the following.

Temporary Portable Rumble Strips measured as prescribed above, will be paid for at the contract unit price per linear foot, which price shall be full compensation for cleaning the roadway surface, installing the rumble strips, maintenance and repair of the strips, cleaning and resetting of the strips, removal and replacement, and for all labor, equipment, tools, and incidentals necessary to complete the work.

After the last pay item listed on page 480, add the following.

907-619-B: Temporary Portable Rumble Strips - per linear foot

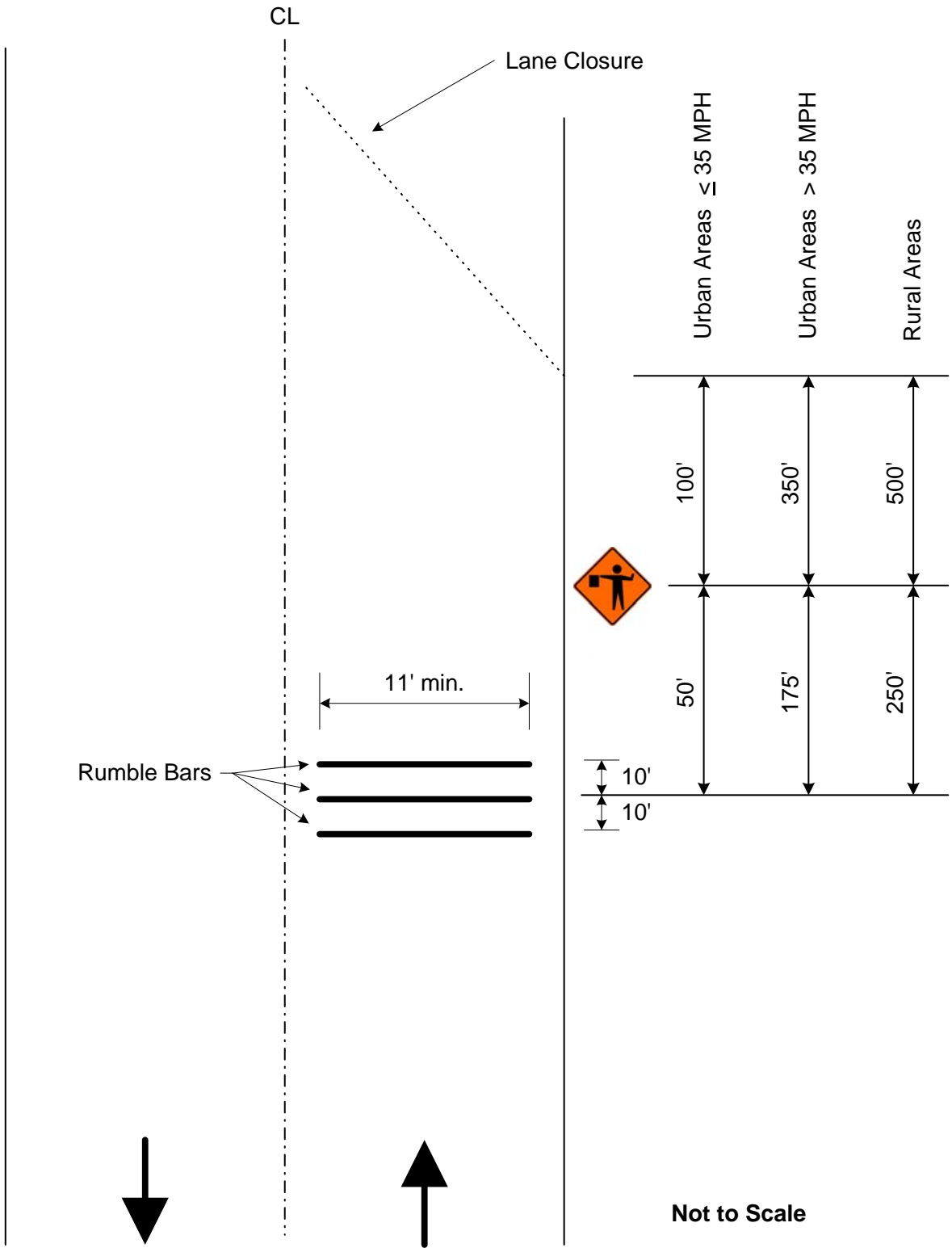

Detail of Temporary Portable Rumble Strips

Overlay approximately 7 miles of US 11 from South Apple Dr. to Millard, known as State Project No. MP-6011-55(022) / 306147301 in Pearl River County.

Line No.	Item Code	Adj Code	Quantity	Units	Description [Fixed Unit Price]
Roadway Items					
0010	202-B188		90	Square Yard	Removal of Pavement, All Types and Depths
0020	304-F003	(GT)	2,000	Ton	Size 825B Crushed Stone Base
0030	403-A006	(BA1)	650	Ton	19-mm, ST, Asphalt Pavement
0040	403-A014	(BA1)	6,200	Ton	9.5-mm, MT, Asphalt Pavement
0050	403-B011	(BA1)	4,000	Ton	9.5-mm, MT, Asphalt Pavement, Leveling
0060	406-A002		2,600	Square Yard	Cold Milling of Bituminous Pavement, All Depths
0070	407-A001	(A2)	8,700	Gallon	Asphalt for Tack Coat
0080	413-E001		23,200	Linear Feet	Sawing and Sealing Transverse Joints in Asphalt Pavement
0090	423-A001		13	Mile	Rumble Strips, Ground In
0100	618-A001		1	Lump Sum	Maintenance of Traffic
0110	618-B001		1	Square Feet	Additional Construction Signs [\$10.00]
0120	619-A1001		26	Mile	Temporary Traffic Stripe, Continuous White
0130	619-A2001		17	Mile	Temporary Traffic Stripe, Continuous Yellow
0140	619-A4002		8	Mile	Temporary Traffic Stripe, Skip Yellow
0150	620-A001		1	Lump Sum	Mobilization
0160	626-B004		4	Mile	6" Thermoplastic Traffic Stripe, Continuous White
0170	626-C002		13	Mile	6" Thermoplastic Double Drop Edge Stripe, Continuous White
0180	626-E004		9	Mile	6" Thermoplastic Traffic Stripe, Continuous Yellow
0190	626-G002		2,000	Linear Feet	Thermoplastic Detail Stripe, White
0200	626-H004		495	Square Feet	Thermoplastic Legend, White
0210	626-H005		1,250	Linear Feet	Thermoplastic Legend, White
0220	627-J001		240	Each	Two-Way Clear Reflective High Performance Raised Markers
0230	627-K001		30	Each	Red-Clear Reflective High Performance Raised Markers
0240	627-L001		525	Each	Two-Way Yellow Reflective High Performance Raised Markers
0242	907-619-B001		66	Linear Feet	Temporary Portable Rumble Strips