

SECTION 905 -- PROPOSAL (CONTINUED)

I (We) hereby certify by digital signature and electronic submission via Bid Express of the Section 905 proposal below, that all certifications, disclosures and affidavits incorporated herein are deemed to be duly executed in the aggregate, fully enforceable and binding upon delivery of the bid proposal. I (We) further acknowledge that this certification shall not extend to the bid bond or alternate security which must be separately executed for the benefit of the Commission. This signature does not cure deficiencies in any required certifications, disclosures and/or affidavits. I (We) also acknowledge the right of the Commission to require full and final execution on any certification, disclosure or affidavit contained in the proposal at the Commission's election upon award. Failure to so execute at the Commission's request within the time allowed in the Standard Specifications for execution of all contract documents will result in forfeiture of the bid bond or alternate security.

Bidder acknowledges receipt of and has added to and made a part of the proposal and contract documents the following addendum (addenda):

ADDENDUM NO. 1 DATED 6/21/2017 ADDENDUM NO. DATED
 ADDENDUM NO. DATED ADDENDUM NO. DATED

| Number | Description |
|--------|--|
| 1 | Revised Table of Contents; Revised NTB No. 138; Added NTB No. 241; Revised SP No. 907-107-1; Revised Bid Items; Revised or added Plan Sheet Nos. 2, 84, & 86; Amendment EBS Download Required. |

TOTAL ADDENDA: 1
 (Must agree with total addenda issued prior to opening of bids)

Respectfully Submitted,

DATE _____

 Contractor

BY _____
 Signature

TITLE _____

ADDRESS _____

CITY, STATE, ZIP _____

PHONE _____

FAX _____

E-MAIL _____

(To be filled in if a corporation)

Our corporation is chartered under the Laws of the State of _____ and the names, titles and business addresses of the executives are as follows:

 President Address

 Secretary Address

 Treasurer Address

The following is my (our) itemized proposal.

HSIP-0055-04(099)/ 107037301000

Desoto County(ies)

**MISSISSIPPI DEPARTMENT OF TRANSPORTATION
TABLE OF CONTENTS**

PROJECT: HSIP-0055-04(099)/107037301 - Desoto

Section 901 - Advertisement

Section 904 - Notice to Bidders

| | |
|------|---|
| #1 | Governing Specification |
| #2 | Status of ROW, w/ Attachments |
| #3 | Final Cleanup |
| #6 | Storm Water Discharge Associated with Construction Activity (>5 Acres) |
| #7 | Disadvantaged Business Enterprise In Federal-Aid Highway Construction, w/ Supplement |
| #9 | Federal Bridge Formula |
| #10 | DUNS Requirement for Federal Funded Projects |
| #11 | Additional Erosion Control Requirements |
| #12 | MASH Compliant Devices |
| #113 | Tack Coat |
| #136 | Contract Time |
| #137 | Specialty Items |
| #138 | Lane Closure Restrictions |
| #139 | Trench Curb |
| #140 | Plant Mix Soil Cement |
| #141 | Traffic Signal Conduit |
| #177 | Equipment Cabinet Modifications |
| #178 | Traffic Management Center (TMC) Modifications |
| #241 | Pay Item Correction |
| 906 | Required Federal Contract Provisions -- FHWA 1273, w/Supplements |

Section 907 - Special Provisions

| | |
|-----------|--|
| 907-103-1 | Award and Execution of Contract |
| 907-107-1 | Contractor's Erosion Control Plan |
| 907-626-2 | Thermoplastic Route Markers |
| 907-639-1 | Confirmation Light and Rotating Beacon |
| 907-650-1 | On-Street Video Equipment |
| 907-661-1 | Fiber Optic Cable (OSP) |
| 907-663-1 | Networking Equipment |
| 907-683-2 | Renovation of Roadway Lighting System |

Section 905 - Proposal, Proposal Bid Items, Combination Bid Proposal

Certification of Performance - Prior Federal-Aid Contracts

Certification Regarding Non-Collusion, Debarment and Suspension

SAM.GOV Registration and DUNS Number

Section 902 - Contract Form

Section 903 - Contract Bond Forms

Form -- OCR-485

PROJECT: HSIP-0055-04(099)/107037301 - Desoto

(REVISIONS TO THE ABOVE WILL BE INDICATED ON THE SECOND SHEET
OF SECTION 905 AS ADDENDA)

06/21/2017 03:39 PM

MISSISSIPPI DEPARTMENT OF TRANSPORTATION

SECTION 904 - NOTICE TO BIDDERS NO. 138

CODE: (SP)

DATE: 06/07/2017

SUBJECT: Lane Closure Restrictions

PROJECT: HSIP-055-04(099) / 107037301 – Desoto County

Construction activities that impact the flow of traffic will not be allowed during the following peak traffic times Monday through Saturday, as Sunday work will not be permitted without consent of the District Engineer:

| Road Name | Direction | Hours of Restriction |
|---|-----------|----------------------|
| HWY 302 | EB | 6:30 AM to 6:00 PM |
| | WB | 6:30 AM to 6:00 PM |
| I-55 Off Ramp/SE (Including Free Flow Right Turn)* | NB | 6:30 AM to 10:00 PM |
| I-55 Off Ramp/SW (Including Free Flow Right Turn)* | SB | 6:30 AM to 10:00 PM |

*No work impacting the free flow right turn ramps on the Southeast or Northwest off ramps shall be performed during the Hours of Restriction for the respective ramp as shown in the above table.

Should stopping traffic to install overhead structures be necessary the Engineer shall be given at least 48 hours notice and a uniformed law enforcement officer with vehicle and blue lights shall be present.

No exceptions to the above requirements will be allowed unless specifically allowed by the Engineer. Also, construction activities will be conducted as per section 108.04 of the 2017 Standard Specifications. If any of the work restrictions listed above are violated, no excuses will be accepted by the Department and the Contractor will be charged a fee of \$600.00 for each full or partial five minute period until the roadway is back in compliance with the work restrictions listed above.

For the purposes of this contract, official time shall be the announced time available at the Southaven area telephone number (662) 895-5527.

MISSISSIPPI DEPARTMENT OF TRANSPORTATION

SECTION 904 - NOTICE TO BIDDERS NO. 241

CODE: (SP)

DATE: 6/21/2017

SUBJECT: Pay Item Correction

PROJECT: HSIP-0055-04(099) / 107037301 – Desoto County

The Bidder's attention is called to the Summary of Quantities in the Contract Plans. Pay Item 202-B240, Removal of Traffic Stripe, was inadvertently omitted from the plans. The bid sheets in the proposal are correct.

MISSISSIPPI DEPARTMENT OF TRANSPORTATION

SPECIAL PROVISION NO. 907-107-1

CODE: (SP)

DATE: 06/13/2017

SUBJECT: Contractor's Erosion Control Plan

Section 107, Legal Relations and Responsibility to Public, of the 2017 Edition of the Mississippi Standard Specifications for Road and Bridge Construction is hereby amended as follows.

907-107.22.1--Contractor's Erosion Control Plan (ECP). Delete the example Narrative in Subsection 107.22.1 on page 65, and substitute the following.

Intersection Improvements on I-55 NB & SB Exit Ramp at Hwy 302, known as Federal Aid Project No. HSIP-0055-04(099) / 107037301 in Desoto County.

| Line No. | Item Code | Adj Code | Quantity | Units | Description [Fixed Unit Price] |
|----------------------|-----------|----------|----------|-----------------|--|
| Roadway Items | | | | | |
| 0010 | 201-A001 | | 1 | Lump Sum | Clearing and Grubbing |
| 0020 | 202-B007 | | 688 | Square Yard | Removal of Asphalt Pavement, All Depths |
| 0030 | 202-B059 | | 4,194 | Square Yard | Removal of Concrete Median & Island Pavement, All Depths |
| 0040 | 202-B088 | | 2,209 | Linear Feet | Removal of Curb & Gutter, All Types |
| 0050 | 202-B165 | | 6 | Each | Removal of Inlets, All Sizes |
| 0060 | 202-B179 | | 9 | Each | Removal of Low Mast Lighting Foundation |
| 0070 | 202-B185 | | 4 | Each | Removal of Overhead Sign Including Panels, Truss, Supports & Footing |
| 0080 | 202-B191 | | 1,020 | Linear Feet | Removal of Pipe, 8" And Above |
| 0082 | 202-B240 | | 13,000 | Linear Feet | Removal of Traffic Stripe |
| 0090 | 202-B251 | | 205 | Linear Feet | Removal of Underground Electric Wire |
| 0100 | 203-A002 | (E) | 1,281 | Cubic Yard | Unclassified Excavation, LVM, AH |
| 0110 | 203-EX040 | (E) | 1,490 | Cubic Yard | Borrow Excavation, AH, LVM, Class B9 |
| 0120 | 203-G002 | (E) | 1,221 | Cubic Yard | Excess Excavation, LVM, AH |
| 0130 | 206-A001 | (S) | 677 | Cubic Yard | Structure Excavation |
| 0140 | 209-A005 | | 2,058 | Square Yard | Geotextile Stabilization, Type V, Non-Woven |
| 0150 | 211-B001 | (E) | 2,493 | Cubic Yard | Topsoil for Slope Treatment, Contractor Furnished |
| 0160 | 213-C001 | | 2 | Ton | Superphosphate |
| 0170 | 216-A001 | | 5,086 | Square Yard | Solid Sodding |
| 0180 | 217-A001 | | 268 | Square Yard | Ditch Liner |
| 0190 | 219-A001 | | 102 | Thousand Gallon | Watering [\$20.00] |
| 0200 | 220-A001 | | 2 | Acre | Insect Pest Control [\$30.00] |
| 0210 | 221-A001 | (S) | 16 | Cubic Yard | Concrete Paved Ditch |
| 0220 | 223-A001 | | 5 | Acre | Mowing [\$50.00] |
| 0230 | 225-A001 | | 5 | Acre | Grassing |
| 0240 | 225-B001 | | 2 | Ton | Agricultural Limestone |
| 0250 | 225-C001 | | 9 | Ton | Mulch, Vegetative Mulch |
| 0260 | 226-A001 | | 2 | Acre | Temporary Grassing |
| 0270 | 234-A001 | | 1,334 | Linear Feet | Temporary Silt Fence |
| 0280 | 234-D001 | | 6 | Each | Inlet Siltation Guard |
| 0290 | 235-A001 | | 12 | Each | Temporary Erosion Checks |
| 0300 | 237-A001 | | 220 | Linear Feet | Wattles, 12" |
| 0310 | 237-A002 | | 48 | Linear Feet | Wattles, 20" |
| 0320 | 245-A001 | | 48 | Linear Feet | Silt Dike |

| Line No. | Item Code | Adj Code | Quantity | Units | Description [Fixed Unit Price] |
|----------|-----------|----------|----------|-------------|--|
| 0330 | 246-A002 | | 103 | Each | Sandbags |
| 0340 | 246-B001 | | 24 | Each | Rockbags |
| 0350 | 304-B002 | (GT) | 2,040 | Ton | Granular Material, Class 3, Group D |
| 0360 | 308-A001 | | 67 | Ton | Cement |
| 0370 | 308-B004 | | 1,839 | Ton | Soil-Cement-Water Mixing, Central Plant, Base |
| 0380 | 308-S001 | (A3) | 1,970 | Gallon | Bituminous Curing Seal |
| 0390 | 403-A004 | (BA1) | 1,143 | Ton | 19-mm, HT, Asphalt Pavement |
| 0400 | 403-A006 | (BA1) | 1,143 | Ton | 19-mm, ST, Asphalt Pavement |
| 0410 | 403-D001 | (BA1) | 762 | Ton | 12.5-mm, HT, Asphalt Pavement, Polymer Modified |
| 0420 | 403-D007 | (BA1) | 3,334 | Ton | 9.5-mm, HT, Asphalt Pavement, Polymer Modified |
| 0430 | 406-A002 | | 33,491 | Square Yard | Cold Milling of Bituminous Pavement, All Depths |
| 0440 | 407-A001 | (A2) | 12,250 | Gallon | Asphalt for Tack Coat |
| 0450 | 503-C010 | | 6,200 | Linear Feet | Saw Cut, Full Depth |
| 0460 | 601-A001 | (S) | 3 | Cubic Yard | Class "B" Structural Concrete |
| 0470 | 601-B001 | (S) | 60 | Cubic Yard | Class "B" Structural Concrete, Minor Structures |
| 0480 | 602-A001 | (S) | 7,108 | Pounds | Reinforcing Steel |
| 0490 | 603-CA011 | (S) | 1,024 | Linear Feet | 18" Reinforced Concrete Pipe, Class III |
| 0500 | 603-CA026 | (S) | 424 | Linear Feet | 24" Reinforced Concrete Pipe, Class III |
| 0510 | 603-CB004 | (S) | 1 | Each | 24" Reinforced Concrete End Section |
| 0520 | 604-A001 | | 488 | Pounds | Castings |
| 0530 | 604-B001 | | 400 | Pounds | Gratings |
| 0540 | 606-B003 | | 550 | Linear Feet | Guard Rail, Class A, Type 1, 'W' Beam, Metal Post |
| 0550 | 606-C003 | | 1 | Each | Guard Rail, Cable Anchor, Type 1 |
| 0560 | 606-E007 | | 1 | Each | Guard Rail, Terminal End Section, Non-Flared |
| 0570 | 609-B003 | (S) | 2,466 | Linear Feet | Concrete Curb, Special Design Type 2 Slotted Curb, Trenched |
| 0580 | 609-B003 | (S) | 192 | Linear Feet | Concrete Curb, Special Design Type 3A Slotted Curb, Trenched |
| 0590 | 609-B004 | (S) | 2,556 | Linear Feet | Concrete Curb, Special Design Doweled Type 2 Slotted Curb |
| 0600 | 609-B004 | (S) | 545 | Linear Feet | Concrete Curb, Special Design Doweled Type 3A Slotted Curb |
| 0610 | 609-D003 | (S) | 1,165 | Linear Feet | Combination Concrete Curb and Gutter Type 2 |
| 0620 | 609-D008 | (S) | 5,111 | Linear Feet | Combination Concrete Curb and Gutter Type 3A |
| 0630 | 616-A001 | (S) | 8 | Square Yard | Concrete Median and/or Island Pavement, 10-inch |
| 0640 | 616-A004 | (S) | 461 | Square Yard | Concrete Median and/or Island Pavement, 4-inch |
| 0650 | 618-A001 | | 1 | Lump Sum | Maintenance of Traffic |

| Line No. | Item Code | Adj Code | Quantity | Units | Description [Fixed Unit Price] |
|----------|-----------|----------|----------|-------------|---|
| 0660 | 619-A1003 | | 38,436 | Linear Feet | Temporary Traffic Stripe, Continuous White, Paint |
| 0670 | 619-A2003 | | 29,169 | Linear Feet | Temporary Traffic Stripe, Continuous Yellow, Paint |
| 0680 | 619-A3004 | | 42,310 | Linear Feet | Temporary Traffic Stripe, Skip White, Paint |
| 0690 | 619-A5002 | | 937 | Linear Feet | Temporary Traffic Stripe, Detail, Paint |
| 0700 | 619-A6003 | | 1,413 | Square Feet | Temporary Traffic Stripe, Legend, Paint |
| 0710 | 619-A6004 | | 2,283 | Linear Feet | Temporary Traffic Stripe, Legend, Paint |
| 0720 | 619-C6001 | | 1,547 | Each | Red-Clear Reflective High Performance Raised Marker |
| 0730 | 619-D1001 | | 116 | Square Feet | Standard Roadside Construction Signs, Less than 10 Square Feet |
| 0740 | 619-D2001 | | 84 | Square Feet | Standard Roadside Construction Signs, 10 Square Feet or More |
| 0750 | 619-D3001 | | 5 | Each | Remove and Reset Signs, All Sizes |
| 0760 | 619-E1001 | | 4 | Each | Flashing Arrow Panel, Type C |
| 0770 | 619-E3001 | | 4 | Each | Changeable Message Sign |
| 0780 | 619-F1001 | | 742 | Linear Feet | Concrete Median Barrier, Precast |
| 0790 | 619-F2001 | | 742 | Linear Feet | Remove and Reset Concrete Median Barrier, Precast |
| 0800 | 619-G4001 | | 48 | Linear Feet | Barricades, Type III, Double Faced |
| 0810 | 619-G5001 | | 173 | Each | Free Standing Plastic Drums |
| 0820 | 619-G7001 | | 4 | Each | Warning Lights, Type "B" |
| 0830 | 619-H1001 | | 1 | Lump Sum | Traffic Signals |
| 0840 | 620-A001 | | 1 | Lump Sum | Mobilization |
| 0850 | 626-A002 | | 12,239 | Linear Feet | 6" Thermoplastic Double Drop Traffic Stripe, Skip White |
| 0860 | 626-C001 | | 7,568 | Linear Feet | 6" Thermoplastic Double Drop Edge Stripe, Continuous White |
| 0870 | 626-F002 | | 7,833 | Linear Feet | 6" Thermoplastic Double Drop Edge Stripe, Continuous Yellow |
| 0880 | 626-G004 | | 11,062 | Linear Feet | Thermoplastic Double Drop Detail Stripe, White |
| 0890 | 626-G005 | | 2,565 | Linear Feet | Thermoplastic Double Drop Detail Stripe, Yellow |
| 0900 | 626-H004 | | 1,288 | Square Feet | Thermoplastic Legend, White |
| 0910 | 626-H005 | | 1,504 | Linear Feet | Thermoplastic Legend, White |
| 0920 | 627-K001 | | 679 | Each | Red-Clear Reflective High Performance Raised Markers |
| 0930 | 627-L001 | | 66 | Each | Two-Way Yellow Reflective High Performance Raised Markers |
| 0940 | 630-A001 | | 64 | Square Feet | Standard Roadside Signs, Sheet Aluminum, 0.080" Thickness |
| 0950 | 630-A003 | | 108 | Square Feet | Standard Roadside Signs, Sheet Aluminum, 0.125" Thickness |
| 0960 | 630-A004 | | 99 | Square Feet | Standard Roadside Signs, Sheet Aluminum, 0.125" Thickness, Overhead Mounted |
| 0970 | 630-B002 | | 56 | Square Feet | Interstate Directional Signs, Bolted Extruded Aluminum Panels, Ground Mounted |
| 0980 | 630-B003 | | 2,587 | Square Feet | Interstate Directional Signs, Bolted Extruded Aluminum Panels, Overhead Mounted |

| Line No. | Item Code | Adj Code | Quantity | Units | Description [Fixed Unit Price] |
|----------|-----------|----------|----------|-------------|---|
| 0990 | 630-C002 | | 26 | Linear Feet | Steel U-Section Posts, 2.0 lb/ft |
| 1000 | 630-D008 | | 35 | Linear Feet | Structural Steel Beams, W6 x 9 |
| 1010 | 630-E002 | | 29 | Pounds | Structural Steel Angles & Bars, 3" x 3" x 1/4" Angles |
| 1020 | 630-E004 | | 168 | Pounds | Structural Steel Angles & Bars, 7/16" x 2 1/2" Flat Bar |
| 1030 | 630-F006 | | 23 | Each | Delineators, Guard Rail, White |
| 1040 | 630-F010 | | 67 | Each | Delineators, Post Mounted, Double White |
| 1050 | 630-F011 | | 58 | Each | Delineators, Post Mounted, Double Yellow |
| 1060 | 630-F012 | | 13 | Each | Delineators, Post Mounted, Single White |
| 1070 | 630-F013 | | 2 | Each | Delineators, Post Mounted, Single Yellow |
| 1080 | 630-I003 | | 1 | Lump Sum | Metal Overhead Sign Supports, Assembly No. 1, Contractor Designed |
| 1090 | 630-I015 | | 1 | Lump Sum | Metal Overhead Sign Supports, Assembly No. 2, Contractor Designed |
| 1100 | 630-I022 | | 1 | Lump Sum | Metal Overhead Sign Supports, Assembly No. 4, Contractor Designed |
| 1110 | 630-I024 | | 1 | Lump Sum | Metal Overhead Sign Supports, Assembly No. 5, Contractor Designed |
| 1120 | 630-I025 | | 1 | Lump Sum | Metal Overhead Sign Supports, Assembly No. 6, Contractor Designed |
| 1130 | 630-K001 | | 56 | Linear Feet | Welded & Seamless Steel Pipe Posts, 3 1/2" |
| 1140 | 630-K002 | | 38 | Linear Feet | Welded & Seamless Steel Pipe Posts, 3" |
| 1150 | 630-K003 | | 28 | Linear Feet | Welded & Seamless Steel Pipe Posts, 4" |
| 1160 | 632-A010 | | 1 | Each | Solid State Traffic Cabinet Assembly, Type IV Cabinet, Type 1 Controller |
| 1170 | 632-B010 | | 1 | Each | Remove and Replace Existing Traffic Signal Cabinet Assembly, Type IV Cabinet, Type 1 Controller |
| 1180 | 632-C001 | | 1 | Each | Modify Existing Traffic Signal Cabinet Assembly |
| 1190 | 633-A001 | | 2 | Each | Uninterruptable Power Supply |
| 1200 | 634-A003 | | 1 | Each | Traffic Signal Equipment Pole, Type 1, 35' Shaft |
| 1210 | 634-A022 | | 2 | Each | Traffic Signal Equipment Pole, Type II, 17' Shaft, 60' Arm |
| 1220 | 634-A023 | | 2 | Each | Traffic Signal Equipment Pole, Type II, 17' Shaft, 65' Arm |
| 1230 | 634-A024 | | 2 | Each | Traffic Signal Equipment Pole, Type II, 17' Shaft, 70' Arm |
| 1240 | 634-C005 | | 14 | Cubic Yard | Pole Foundations, Class "B" Concrete |
| 1250 | 635-A059 | | 15 | Each | Traffic Signal Head, Type 1 |
| 1260 | 635-A061 | | 3 | Each | Traffic Signal Head, Type 2 |
| 1270 | 635-A063 | | 3 | Each | Traffic Signal Head, Type 2R |
| 1280 | 635-A073 | | 6 | Each | Traffic Signal Head, Type 4 |
| 1290 | 635-A079 | | 1 | Each | Traffic Signal Head, Type 7R |
| 1300 | 636-B018 | | 1,865 | Linear Feet | Electric Cable, Underground in Conduit, IMSA 20-1, AWG 14, 8 Conductor |
| 1310 | 637-A008 | | 3 | Each | Pull Box Enclosure, Type 2, Tier 15 |

| Line No. | Item Code | Adj Code | Quantity | Units | Description [Fixed Unit Price] |
|----------|--------------|----------|----------|-------------|--|
| 1320 | 637-A010 | | 2 | Each | Pull Box Enclosure, Type 3, Tier 15 |
| 1330 | 637-A012 | | 1 | Each | Pull Box Enclosure, Type 4, Tier 15 |
| 1340 | 637-A014 | | 1 | Each | Pull Box Enclosure, Type 5, Tier 15 |
| 1350 | 637-C028 | | 260 | Linear Feet | Traffic Signal Conduit, Underground, Type 4, 2" |
| 1360 | 637-C030 | | 490 | Linear Feet | Traffic Signal Conduit, Underground, Type 4, 3" |
| 1370 | 637-D003 | | 635 | Linear Feet | Traffic Signal Conduit, Underground Drilled or Jacked, Rolled Pipe, 3" |
| 1380 | 637-I001 | | 60 | Linear Feet | Traffic Signal Conduit Bank, Underground, Drilled or Jacked, Rolled Pipe, 2 @ 2" |
| 1390 | 637-I002 | | 460 | Linear Feet | Traffic Signal Conduit Bank, Underground, Drilled or Jacked, Rolled Pipe, 2" |
| 1400 | 639-B001 | | 7 | Each | Optical Detector |
| 1410 | 639-E001 | | 1,615 | Linear Feet | Optical Detector Cable |
| 1420 | 641-A002 | | 4 | Each | Signal Stop Bar Radar Detection, 1 Sensor, Type 2 |
| 1430 | 641-B002 | | 6 | Each | Signal Advanced Radar Detection, 1 Sensor, Type 2 |
| 1440 | 641-D001 | | 2,000 | Linear Feet | Radar Detection Communication Cable |
| 1450 | 647-A001 | | 1 | Lump Sum | Removal of Existing Traffic Signal Equipment |
| 1460 | 653-A002 | | 15 | Square Feet | Traffic Sign, Type III |
| 1470 | 653-B003 | | 45 | Square Feet | Street Name Sign, Type III |
| 1480 | 660-A003 | | 1 | Each | Equipment Cabinet, Type B |
| 1490 | 682-A028 | | 1,745 | Linear Feet | Underground Branch Circuit, AWG 4, 3 Conductor |
| 1500 | 682-A034 | | 205 | Linear Feet | Underground Branch Circuit, AWG 6, 3 Conductor |
| 1510 | 682-B025 | | 445 | Linear Feet | Underground Branch Circuit, Jacked or Bored, AWG 4, 3 Conductor |
| 1520 | 682-B032 | | 170 | Linear Feet | Underground Branch Circuit, Jacked or Bored, AWG 6, 3 Conductor |
| 1530 | 682-D004 | | 3 | Each | Underground Pull Box With Concrete Pad |
| 1540 | 682-E003 | | 9 | Each | Underground Junction Box With Concrete Pad |
| 1550 | 684-A003 | | 11 | Cubic Yard | Pole Foundation, 24" Diameter |
| 1560 | 686-A001 | | 9 | Each | Relocation of Existing Lighting Assemblies |
| 1570 | 699-A001 | | 1 | Lump Sum | Roadway Construction Stakes |
| 1580 | 907-626-H002 | | 18 | Each | Thermoplastic Legend, Interstate Shield |
| 1590 | 907-639-G001 | | 4 | Each | Confirmation Light |
| 1600 | 907-639-H001 | | 4 | Each | Rotating Beacon |
| 1610 | 907-650-A002 | | 4 | Each | On Street Video Equipment, Fixed Type |
| 1620 | 907-650-A003 | | 1 | Each | On Street Video Equipment, PTZ Type |
| 1630 | 907-661-B002 | | 315 | Linear Feet | Fiber Optic Drop Cable, 12 SM |
| 1640 | 907-663-A001 | | 2 | Each | Network Switch, Type A |

| Line No. | Item Code | Adj Code | Quantity | Units | Description [Fixed Unit Price] |
|------------------------------------|------------------|-----------------|-----------------|--------------|--|
| 1650 | 907-663-D001 | | 250 | Linear Feet | Category 6 Cable, Installed in Conduit |
| 1660 | 907-683-H1002 | | 20 | Each | Renovation of Low Mast Lighting Assembly, Type 40-1-10-255 |
| ALTERNATE GROUP AA NUMBER 1 | | | | | |
| 1670 | 304-F001 | (GT) | 3,246 | Ton | 3/4" and Down Crushed Stone Base |
| ALTERNATE GROUP AA NUMBER 2 | | | | | |
| 1680 | 304-F002 | (GT) | 3,246 | Ton | Size 610 Crushed Stone Base |
| ALTERNATE GROUP AA NUMBER 3 | | | | | |
| 1690 | 304-F003 | (GT) | 3,246 | Ton | Size 825B Crushed Stone Base |

DESCRIPTION OF SHEET

WKG. SH. NO.

DESCRIPTION OF SHEET

WKG. SH. NO.

| | |
|-------|-----------------|
| STATE | PROJECT NO. |
| MISS. | HSIP 0855-04899 |
| | SH. NO. |
| | WKG. NO. |

ROADWAY

TITLE SHEET (1)

DETAILED INDEX & GENERAL NOTES (L)

DETAILED INDEX (ROADWAY)

GENERAL NOTES

JOURNAL SECTION SHEETS (L)

TYPICAL SECTIONS - SR 302 / GOODMAN RD WEST OF I-68

TYPICAL SECTIONS - SR 302 / GOODMAN RD EAST OF I-68 & I-68 OFF RAMP

QUANTITIES SHEETS (L)

SUMMARY OF QUANTITIES

SUMMARY OF QUANTITIES

SUMMARY OF QUANTITIES

SUMMARY OF QUANTITIES

ESTIMATED QUANTITIES

ESTIMATED QUANTITIES

ESTIMATED QUANTITIES

ESTIMATED QUANTITIES

ESTIMATED QUANTITIES

ESTIMATED QUANTITIES

ESTIMATED QUANTITIES

ESTIMATED QUANTITIES

ESTIMATED QUANTITIES

ESTIMATED QUANTITIES

ESTIMATED QUANTITIES

PLAN AND PROFILE SHEETS (L)

SR 302 / GOODMAN RD LEFT - B.O.P. TO STA. 458+00

SR 302 / GOODMAN RD RIGHT - B.O.P. TO STA. 458+00

SR 302 / GOODMAN RD LEFT - 458+00 TO E.O.P.

SR 302 / GOODMAN RD @ I-68 RAMP - STA. 670+26 TO STA. 615+28

SR 302 / GOODMAN RD @ N.W. RAMP - STA. 614+26 TO STA. 623+50

EROSION CONTROL PLAN SHEETS (L)

EROSION CONTROL PLAN - SR 302 LEFT - B.O.P. TO STA. 458+00

EROSION CONTROL PLAN - SR 302 RIGHT - B.O.P. TO STA. 458+00

EROSION CONTROL PLAN - SR 302 LEFT - 458+00 TO E.O.P.

EROSION CONTROL PLAN - SR 302 RIGHT - 458+00 TO E.O.P.

EROSION CONTROL PLAN - SR 302 @ I-68 RAMP - STA. 670+26 TO STA. 615+28

EROSION CONTROL PLAN - SR 302 @ N.W. RAMP - STA. 614+26 TO STA. 623+50

CONSTRUCTION SIGNING SHEETS (L)

CONSTRUCTION SIGNING

TRAFFIC CONTROL SHEETS (L)

TRAFFIC CONTROL PLAN - CONSTRUCTION PHASING NOTES

TRAFFIC CONTROL PLAN - PHASE 1A - CONSTRUCTION TYPICAL SECTIONS

TRAFFIC CONTROL PLAN - PHASE 1B & 1C - CONSTRUCTION TYPICAL SECTIONS

TRAFFIC CONTROL PLAN - PHASE 1A - CONSTRUCTION TYPICAL SECTIONS

TRAFFIC CONTROL PLAN - PHASE 1B - CONSTRUCTION TYPICAL SECTIONS

TRAFFIC CONTROL PLAN - PHASE 1C - CONSTRUCTION TYPICAL SECTIONS

TRAFFIC CONTROL PLAN - PHASE 1A - SE RAMP SOUTH OF SR 302

TRAFFIC CONTROL PLAN - PHASE 1B - SE RAMP SOUTH OF SR 302

TRAFFIC CONTROL PLAN - PHASE 1C - SE RAMP SOUTH OF SR 302

TRAFFIC CONTROL PLAN - PHASE 1A - SE RAMP SOUTH OF SR 302

TRAFFIC CONTROL PLAN - PHASE 1B - SE RAMP SOUTH OF SR 302

TRAFFIC CONTROL PLAN - PHASE 1C - SE RAMP SOUTH OF SR 302

TRAFFIC CONTROL PLAN - PHASE 1A - SR 302 STA. 458+00 TO STA. 458+00

TRAFFIC CONTROL PLAN - PHASE 1B - SR 302 STA. 458+00 TO STA. 458+00

TRAFFIC CONTROL PLAN - PHASE 1C - SR 302 STA. 458+00 TO STA. 458+00

TRAFFIC CONTROL PLAN - PHASE 1A - SR 302 STA. 458+00 TO STA. 458+00

TRAFFIC CONTROL PLAN - PHASE 1B - SR 302 STA. 458+00 TO STA. 458+00

TRAFFIC CONTROL PLAN - PHASE 1C - SR 302 STA. 458+00 TO STA. 458+00

TRAFFIC CONTROL PLAN - PHASE 1A - SR 302 STA. 458+00 TO STA. 458+00

TRAFFIC CONTROL PLAN - PHASE 1B - SR 302 STA. 458+00 TO STA. 458+00

TRAFFIC CONTROL PLAN - PHASE 1C - SR 302 STA. 458+00 TO STA. 458+00

TRAFFIC CONTROL PLAN - PHASE 1A - SR 302 STA. 458+00 TO STA. 458+00

TRAFFIC CONTROL PLAN - PHASE 1B - SR 302 STA. 458+00 TO STA. 458+00

TRAFFIC CONTROL PLAN - PHASE 1C - SR 302 STA. 458+00 TO STA. 458+00

TRAFFIC CONTROL PLAN - PHASE 1A - SR 302 STA. 458+00 TO STA. 458+00

TRAFFIC CONTROL PLAN - PHASE 1B - SR 302 STA. 458+00 TO STA. 458+00

TRAFFIC CONTROL PLAN - PHASE 1C - SR 302 STA. 458+00 TO STA. 458+00

TEMPORARY SIGNAL LAYOUT DETAILS SR 302 / I-68 SB - PHASES 1A, 1B, 1C, & 2

TEMPORARY SIGNAL LAYOUT DETAILS SR 302 / I-68 NB - PHASES 1A, 1B, 1C, & 2

TEMPORARY SIGNAL LAYOUT DETAILS SR 302 / SOUTHCRST - PHASES 1A, 1B, 1C, & 2

TEMPORARY SIGNAL LAYOUT DETAILS SR 302 / SOUTHCRST - PHASES 2, 3A, & 3B

FORM GRABBLE (L)

SR302 AT I-68 NORTHWEST RAMP INTERSECTION

SR302 AT I-68 SOUTHWEST RAMP INTERSECTION

DETAIL OF INTERSECTION SHEETS (L)

DETAIL OF INTERSECTION - S.R. 302 / GOODMAN RD. AT INTERSECTION SUUS

DETAIL OF INTERSECTION - S.R. 302 / GOODMAN RD. AT SOUTHWEST RAMP

DETAIL OF INTERSECTION - S.R. 302 / GOODMAN RD. AT I-68 OVERPASS

DETAIL OF INTERSECTION - S.R. 302 / GOODMAN RD. AT NORTHBOUND RAMP

DETAIL OF INTERSECTION - S.R. 302 / GOODMAN RD. AT SOUTHWEST PARKWAY

| | |
|--------|----|
| TC-88 | 37 |
| TC-89 | 38 |
| TC-90 | 39 |
| TC-91 | 40 |
| TC-92 | 41 |
| TC-93 | 42 |
| TC-94 | 43 |
| TC-95 | 44 |
| TC-96 | 45 |
| TC-97 | 46 |
| TC-98 | 47 |
| TC-99 | 48 |
| TC-100 | 49 |
| TC-101 | 50 |
| TC-102 | 51 |
| TC-103 | 52 |
| TC-104 | 53 |
| TC-105 | 54 |
| TC-106 | 55 |
| TC-107 | 56 |
| TC-108 | 57 |
| TC-109 | 58 |
| TC-110 | 59 |
| TC-111 | 60 |
| TC-112 | 61 |
| TC-113 | 62 |
| TC-114 | 63 |
| TC-115 | 64 |
| TC-116 | 65 |
| TC-117 | 66 |
| TC-118 | 67 |
| TC-119 | 68 |
| TC-120 | 69 |
| TC-121 | 70 |
| FO-1 | 71 |
| FO-2 | 72 |
| IS-1 | 73 |
| IS-2 | 74 |
| IS-3 | 75 |
| IS-4 | 76 |
| IS-5 | 77 |



DATE: 06/15/2011

| | |
|---------|--------------------|
| DATE | BY |
| 7/27/11 | J. K. B. JR., M.J. |
| DATE | BY |
| 6/15/12 | M.B. |

MISSISSIPPI DEPARTMENT OF TRANSPORTATION
DETAILED INDEX

PROJECT NO. HSIP-0855-04(099)
DESOTO COUNTY

FILENAME: DLDGN
SHEET NUMBER: D-1
SHEET NUMBER: 2

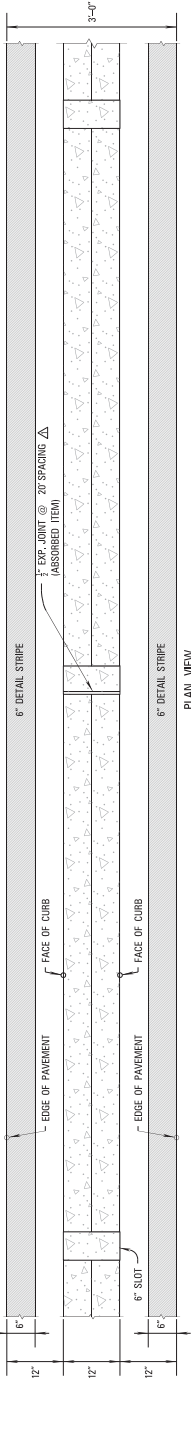

SPECIAL DESIGN TYPE 2 TRENCHED SLOTTED CURB

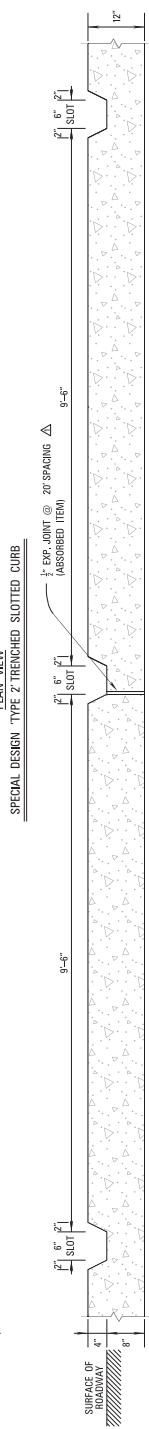

SPECIAL DESIGN TYPE 2 TRENCHED SLOTTED CURB

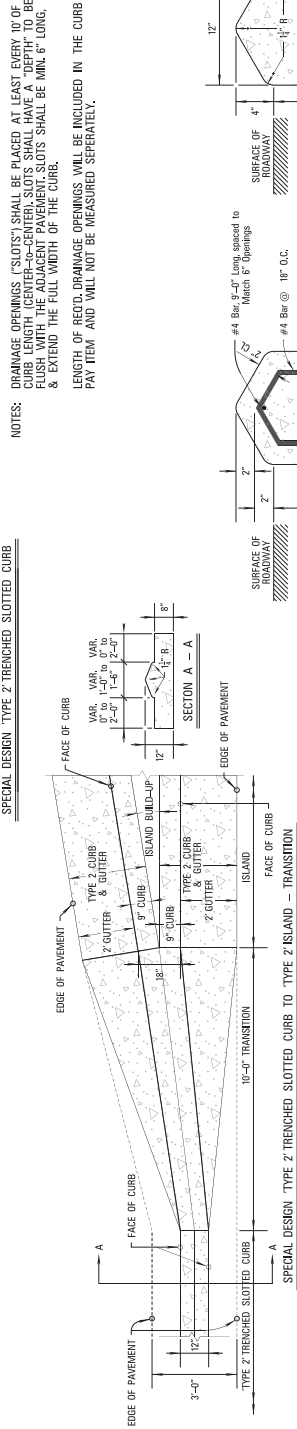

SPECIAL DESIGN TYPE 2 TRENCHED SLOTTED CURB TO TYPE 2 ISLAND - TRANSITION

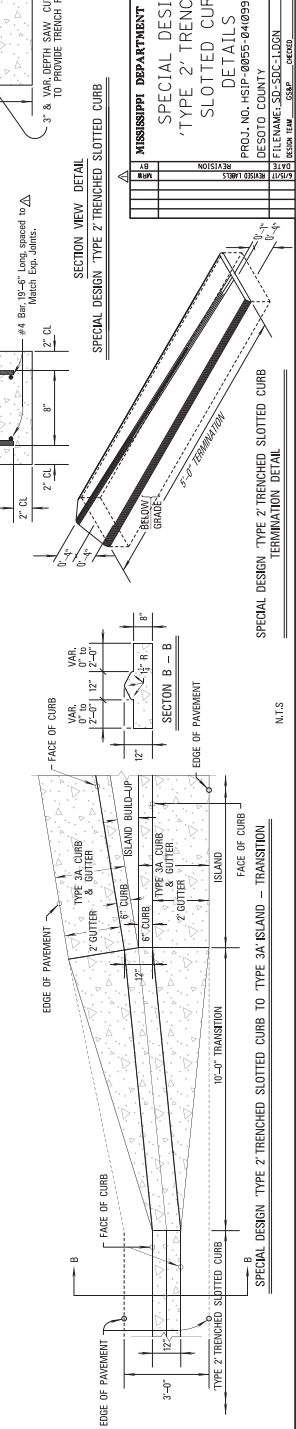

SPECIAL DESIGN TYPE 2 TRENCHED SLOTTED CURB TO TYPE 3A ISLAND - TRANSITION

NOTES: DRAINAGE OPENINGS ("SLOTS") SHALL BE PLACED AT LEAST EVERY 10' OF CURB LENGTH (CENTER-TO-CENTER). SLOTS SHALL HAVE A "DEPTH" TO BE FLUSH WITH THE ADJACENT PAVEMENT. SLOTS SHALL BE MIN. 6" LONG, & EXTEND THE FULL WIDTH OF THE CURB.
LENGTH OF RECD. DRAINAGE OPENINGS WILL BE INCLUDED IN THE CURB PAY ITEM AND WILL NOT BE MEASURED SEPARATELY.

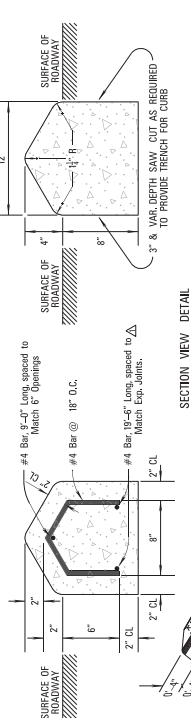

SPECIAL DESIGN TYPE 2 TRENCHED SLOTTED CURB

| NO. | REVISION | DATE |
|-----|----------------------|------------|
| 1 | ISSUED FOR BIDDING | 08/14/2018 |
| 2 | REVISED PER COMMENTS | 08/14/2018 |
| 3 | REVISED PER COMMENTS | 08/14/2018 |
| 4 | REVISED PER COMMENTS | 08/14/2018 |
| 5 | REVISED PER COMMENTS | 08/14/2018 |

MISSISSIPPI DEPARTMENT OF TRANSPORTATION
SPECIAL DESIGN
TYPE 2 TRENCHED
SLOTTED CURB
DETAILS
PROJ. NO. HSP-085-04(099)
DESOLO COUNTY
FILENAME: SD-SDC-LOGN
SHEET NUMBER 84



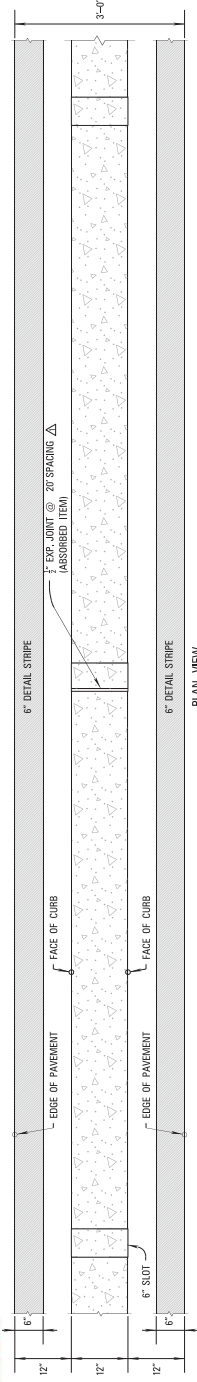

PLAN VIEW SPECIAL DESIGN TYPE 3A TRENCHED SLOTTED CURB

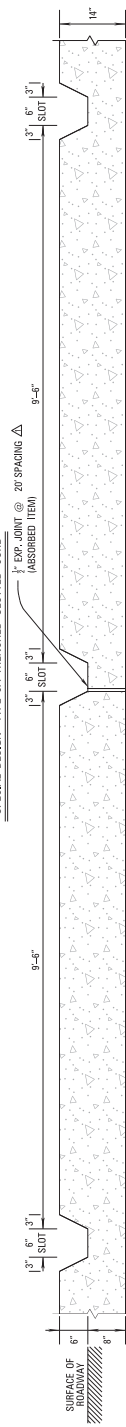

ELEVATION VIEW SPECIAL DESIGN TYPE 3A TRENCHED SLOTTED CURB

SPECIAL DESIGN TYPE 3A TRENCHED SLOTTED CURB

NOTES: DRAINAGE OPENINGS ("SLOTS") SHALL BE PLACED AT LEAST EVERY 10' OF CURB LENGTH (CENTER-TO-CENTER). SLOTS SHALL HAVE A "DEPTH" TO BE FLUSH WITH THE ADJACENT PAVEMENT. SLOTS SHALL BE MIN. 6" LONG, & EXTEND THE FULL WIDTH OF THE CURB.

LENGTH OF RECD. DRAINAGE OPENINGS WILL BE INCLUDED IN THE CURB PAY ITEM AND WILL NOT BE MEASURED SEPARATELY.

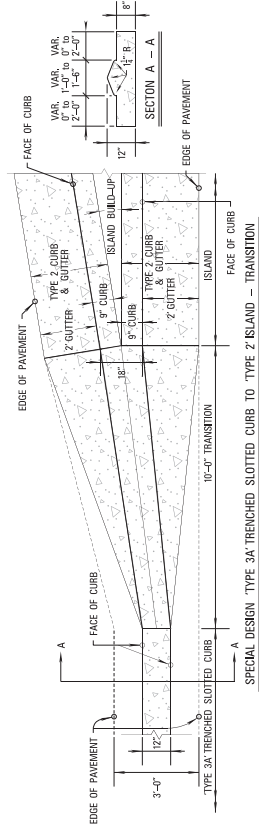

SECTION VIEW DETAIL SPECIAL DESIGN TYPE 3A TRENCHED SLOTTED CURB

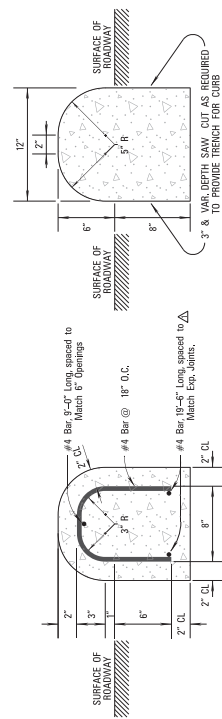

SECTION VIEW DETAIL SPECIAL DESIGN TYPE 3A TRENCHED SLOTTED CURB