

STATE	PROJECT NUMBER	SHEET NO.
MISSISSIPPI	HSIP-055-04(099)	1

GENERAL INDEX

INCLUDED THIS PROJECT	BEGIN WITH SHEET
<input checked="" type="checkbox"/> ROADWAY	1
<input checked="" type="checkbox"/> PERMANENT SIGNS	1001
<input checked="" type="checkbox"/> TRAFFIC SIGNALS	2001
<input type="checkbox"/> ITS COMPONENTS	3001
<input checked="" type="checkbox"/> LIGHTING	4001
<input type="checkbox"/> (RESERVED)	5001
<input checked="" type="checkbox"/> ROADWAY STANDARD DWGS ..	6001
<input type="checkbox"/> BRIDGE STANDARD DWGS	7001
<input type="checkbox"/> BRIDGE	8001
<input checked="" type="checkbox"/> CROSS SECTIONS	9001

STATE OF MISSISSIPPI

MISSISSIPPI DEPARTMENT OF TRANSPORTATION

PLAN AND PROFILE OF PROPOSED STATE HIGHWAY FEDERAL AID PROJECT NO. HSIP-0055-04(099)

SAFETY IMPROVEMENTS ALONG GOODMAN ROAD FROM INTERSTATE BOULEVARD AND GOODMAN ROAD INTERSECTION TO SOUTHCREST PARKWAY AND GOODMAN ROAD

**INTERSECTION
DESOTO COUNTY**

FMS. CONST. NO. 107037/301000

**BRIDGE STRUCTURES REQ'D.
NONE**

**BEGIN CONSTRUCTION
STA. 432 + 50
(GOODMAN RD. STATIONING)**

SCALES
PLAN 1 IN. = 100 FT.
PROFILE { HOR. 1 IN. = 100 FT.
VERT. 1 IN. = 10 FT.
LAYOUT 1 IN. = 1000 FT.

**END CONSTRUCTION
STA. 460 + 00
(GOODMAN RD. STATIONING)**

**BOX BRIDGES REQ'D.
NONE**

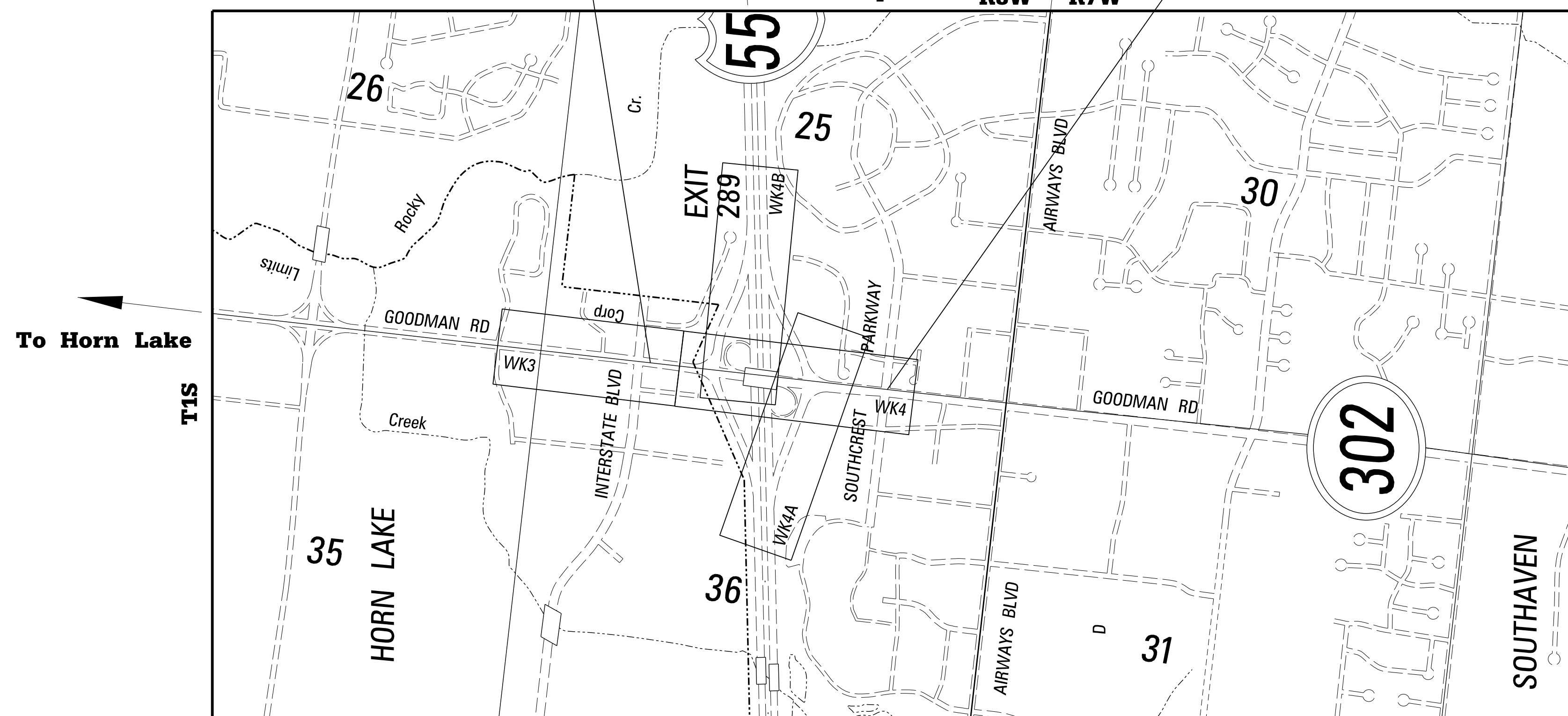

**EQUATIONS
NONE**

**EXCEPTIONS
NONE**

LENGTH DATA

LENGTH OF ROADWAY	2412.68	FT.	0.46	MI.
LENGTH OF BRIDGES	337.32	FT.	0.06	MI.
LENGTH OF PROJECT (NET)			0.52	MI.
LENGTH OF EXCEPTIONS	0	FT.	0.00	MI.
LENGTH OF PROJECT (GROSS)			0.52	MI.

CONVENTIONAL SYMBOLS

- COUNTY LINE
- TOWN CORPORATION LINE
- SECTION LINE
- EXISTING ROAD OR TRAVELED WAY - - - - -
- PROPOSED ROAD OR TRAVELED WAY _____
- RAILROAD
- SURVEY LINE
- BRIDGES

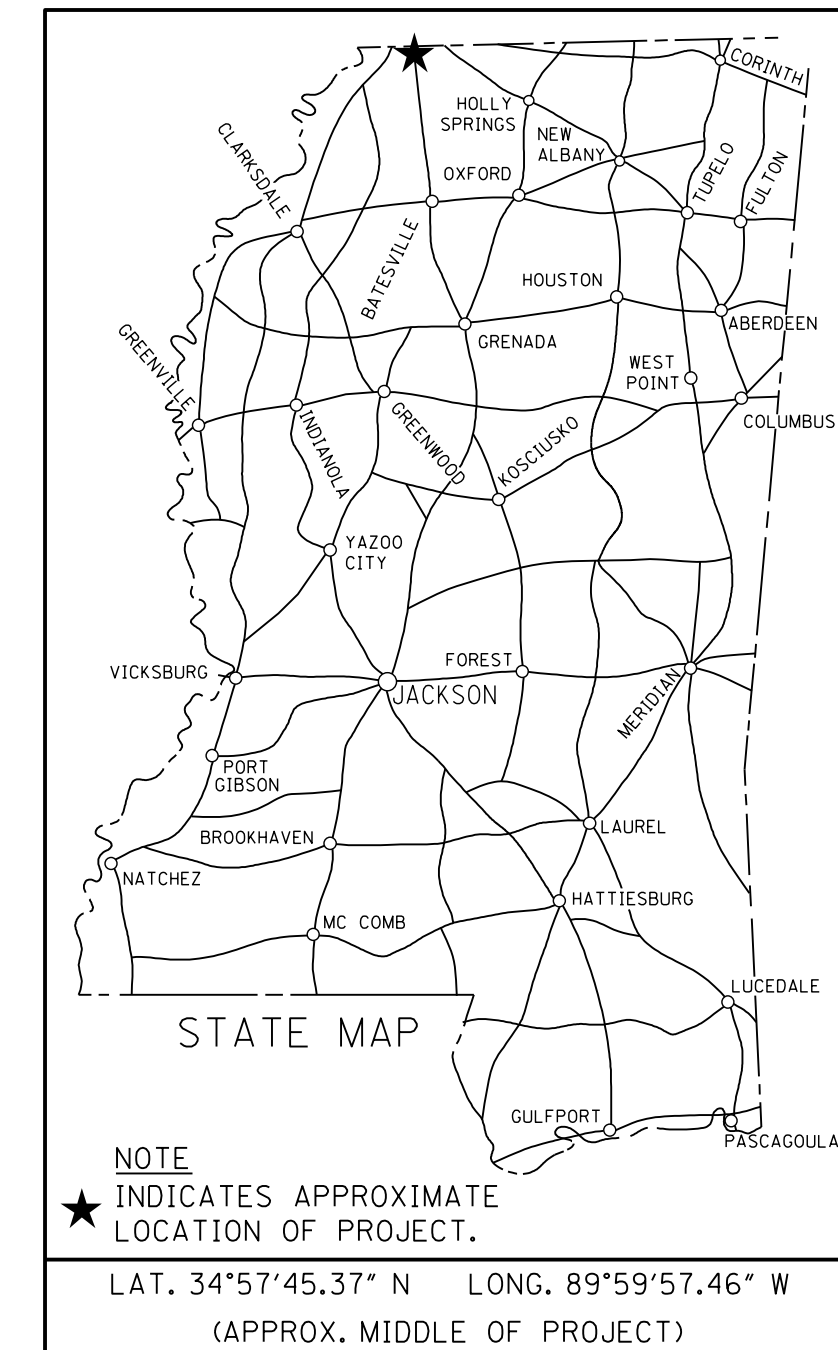

NOTE
★ INDICATES APPROXIMATE LOCATION OF PROJECT.
LAT. 34°57'45.37" N LONG. 89°59'57.46" W
(APPROX. MIDDLE OF PROJECT)

DESIGN CONTROL

45 MPH = V (SPEED DESIGN)

ADT (2015) = 40,000 : ADT () = _____

DHV = _____ : D = _____ % T = _____ %

PERMITS ACQUIRED BY MDOT

WETLANDS AND WATERS PERMITS (NECESSARY FOR ULTIMATE IMPROVEMENTS ONLY):

	WATERS	WETLANDS
NATIONWIDE #14	<input type="checkbox"/>	<input type="checkbox"/>
NATIONWIDE (OTHER)*	<input type="checkbox"/>	<input type="checkbox"/>
GENERAL*	<input type="checkbox"/>	<input type="checkbox"/>
INDIVIDUAL (404)*	<input type="checkbox"/>	<input type="checkbox"/>

* ACQUISITION OF PERMITS FOR TEMPORARY IMPACTS DURING CONSTRUCTION ARE THE RESPONSIBILITY OF THE CONTRACTOR

STORMWATER PERMIT

Y REQUIRED, SC01 SUBMITTED BY MDOT (DISTURBED AREA = 5 ACRES)

S REQUIRED, SC01 TO BE SUBMITTED BY CONTRACTOR (1 TO 4.99 ACRES)

N NO STORMWATER PERMIT REQUIRED (<1 ACRE)

APPROVED BY: _____

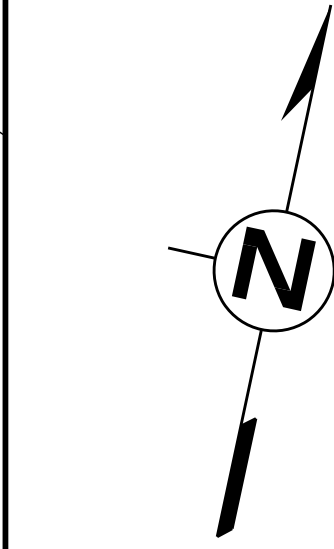

To Memphis R8W R7W

To Horn Lake T1S

To Southaven T1S

To Jackson R8W R7W

DATE: 04/13/2017
(SIGNALS ONLY)

DATE: 04/13/2017
(LIGHTING ONLY)

P S & E DATE: 4 /13 /17

APPROVED: _____

DEPUTY EXECUTIVE DIRECTOR / CHIEF ENGINEER

EXECUTIVE DIRECTOR

MDOT
MISSISSIPPI DEPARTMENT OF TRANSPORTATION

4/13/2017 1:18 PM TLE.DGN

1st O.REV.

STATE	PROJECT NO.
MISS.	HSIP-0055-04(099)

DESCRIPTION OF SHEET

WKG. NO. SH. NO.

DESCRIPTION OF SHEET

WKG. NO. SH. NO.

ROADWAY

TITLE SHEET (1)

TITLE 1

DETAILED INDEX & GENERAL NOTES (3)

DETAIL INDEX (ROADWAY)
 DETAIL INDEX (ROADWAY)
 GENERAL NOTES

DI-1 2
 DI-2 3
 GN-1 4

TYPICAL SECTION SHEETS (2)

TYPICAL SECTIONS - SR 302 / GOODMAN RD WEST OF I-55
 TYPICAL SECTIONS - SR 302 / GOODMAN RD EAST OF I-55 & I-55 OFF RAMP

TS-1 5
 TS-2 6

QUANTITY SHEETS (17)

SUMMARY OF QUANTITIES
 SUMMARY OF QUANTITIES
 SUMMARY OF QUANTITIES
 SUMMARY OF QUANTITIES
 SUMMARY OF QUANTITIES
 ESTIMATED QUANTITIES - REMOVAL ITEMS
 ESTIMATED QUANTITIES - EARTHWORKS
 ESTIMATED QUANTITIES - EROSION CONTROL
 ESTIMATED QUANTITIES - DRAINAGE STRUCTURES
 ESTIMATED QUANTITIES - JUNCTION BOXES
 ESTIMATED QUANTITIES - COMBINATION CURB & GUTTER, GUARDRAIL, AND DELINEATORS
 ESTIMATED QUANTITIES - PAVEMENT MARKINGS
 ESTIMATED QUANTITIES - STANDARD SIGNS & ASSEMBLIES
 ESTIMATED QUANTITIES - TRAFFIC CONTROL ITEMS
 ESTIMATED QUANTITIES - TRAFFIC CONTROL SIGNS
 ESTIMATED QUANTITIES - SIGNALS
 ESTIMATED QUANTITIES - LIGHTING

SQ-1 7
 SQ-2 8
 SQ-3 9
 SQ-4 10
 SQ-5 11
 EQ-1 12
 EQ-2 13
 EQ-3 14
 EQ-4 15
 EQ-5 16
 EQ-6 17
 EQ-7 18
 EQ-8 19
 EQ-9 20
 EQ-10 21
 EQ-11 22
 ELQ-1 23

PLAN AND PROFILE SHEETS (6)

SR-302 / GOODMAN RD. LEFT - B.O.P. TO STA. 435+00
 SR-302 / GOODMAN RD. RIGHT - B.O.P. TO STA. 435+00
 SR-302 / GOODMAN RD. LEFT - 435+00 TO E.O.P.
 SR-302 / GOODMAN RD. RIGHT - 435+00 TO E.O.P.
 SR-302 / GOODMAN RD. @ S.E. RAMP - STA. 607+45 TO STA. 615+98
 SR-302 / GOODMAN RD. @ N.W. RAMP - STA. 616+26 TO STA. 623+50

3LT 24
 3RT 25
 4LT 26
 4RT 27
 4A 28
 4B 29

EROSION CONTROL PLAN SHEETS (6)

EROSION CONTROL PLAN - SR-302 LEFT - B.O.P. TO STA. 435+00
 EROSION CONTROL PLAN - SR-302 RIGHT - B.O.P. TO STA. 435+00
 EROSION CONTROL PLAN - SR-302 LEFT - 435+00 TO E.O.P.
 EROSION CONTROL PLAN - SR-302 RIGHT - 435+00 TO E.O.P.
 EROSION CONTROL PLAN - SR-302 @ S.E. RAMP - STA. 607+45 TO STA. 615+98
 EROSION CONTROL PLAN - SR-302 @ N.W. RAMP - STA. 616+26 TO STA. 623+50

ECP-3LT 30
 ECP-3RT 31
 ECP-4LT 32
 ECP-4RT 33
 ECP-4A 34
 ECP-4B 35

CONSTRUCTION SIGNING SHEETS (1)

CONSTRUCTION SIGNING

CS-1 36

TRAFFIC CONTROL SHEETS (34)

TRAFFIC CONTROL PLAN - CONSTRUCTION PHASING NOTES
 TRAFFIC CONTROL PLAN - GENERAL NOTES
 TRAFFIC CONTROL PLAN - PHASE 1A CONSTRUCTION TYPICAL SECTIONS
 TRAFFIC CONTROL PLAN - PHASES 1B & 1C CONSTRUCTION TYPICAL SECTIONS
 TRAFFIC CONTROL PLAN - PHASES 1C, 2, & 3A CONSTRUCTION TYPICAL SECTIONS
 TRAFFIC CONTROL PLAN - PHASES 3B & 4 CONSTRUCTION TYPICAL SECTIONS
 TRAFFIC CONTROL PLAN - PHASE 1A - SR 302 STA. 438+00 TO STA. 454+00
 TRAFFIC CONTROL PLAN - PHASE 1A - SE RAMP SOUTH OF SR 302
 TRAFFIC CONTROL PLAN - PHASE 1A - NW RAMP NORTH OF SR 302
 TRAFFIC CONTROL PLAN - PHASE 1B - SR 302 STA. 438+00 TO STA. 454+00
 TRAFFIC CONTROL PLAN - PHASE 1B - SR 302 STA. 454+00 TO STA. 469+00
 TRAFFIC CONTROL PLAN - PHASE 1B - SE RAMP SOUTH OF SR 302
 TRAFFIC CONTROL PLAN - PHASE 1B - NW RAMP NORTH OF SR 302
 TRAFFIC CONTROL PLAN - PHASE 1C - SR 302 STA. 438+00 TO STA. 454+00
 TRAFFIC CONTROL PLAN - PHASE 1C - SR 302 STA. 454+00 TO STA. 469+00
 TRAFFIC CONTROL PLAN - PHASE 1C - SE RAMP SOUTH OF SR 302
 TRAFFIC CONTROL PLAN - PHASE 2 - SR 302 STA. 423+00 TO STA. 438+00
 TRAFFIC CONTROL PLAN - PHASE 2 - SR 302 STA. 438+00 TO STA. 454+00
 TRAFFIC CONTROL PLAN - PHASE 2 - SR 302 STA. 454+00 TO STA. 469+00
 TRAFFIC CONTROL PLAN - PHASE 3A - SR 302 STA. 423+00 TO STA. 438+00
 TRAFFIC CONTROL PLAN - PHASE 3A - SR 302 STA. 438+00 TO STA. 454+00
 TRAFFIC CONTROL PLAN - PHASE 3A - SR 302 STA. 454+00 TO STA. 469+00
 TRAFFIC CONTROL PLAN - PHASE 3B - SR 302 STA. 423+00 TO STA. 438+00
 TRAFFIC CONTROL PLAN - PHASE 3B - SR 302 STA. 438+00 TO STA. 454+00
 TRAFFIC CONTROL PLAN - PHASE 3B - SR 302 STA. 454+00 TO STA. 469+00
 TRAFFIC CONTROL PLAN - PHASE 4 - SR 302 STA. 423+00 TO STA. 438+00
 TRAFFIC CONTROL PLAN - PHASE 4 - SR 302 STA. 438+00 TO STA. 454+00
 TRAFFIC CONTROL PLAN - PHASE 4 - SR 302 STA. 454+00 TO STA. 469+00
 TEMPORARY SIGNAL LAYOUT DETAILS SR 302 / I-55 SB - PHASES 1A, 1B, 1C, & 2
 TEMPORARY SIGNAL LAYOUT DETAILS SR 302 / I-55 SB - PHASES 2, 3A, & 3B
 TEMPORARY SIGNAL LAYOUT DETAILS SR 302 / I-55 NB - PHASES 1A, 1B, 1C, & 2
 TEMPORARY SIGNAL LAYOUT DETAILS SR 302 / I-55 NB - PHASES 2, 3A, & 3B
 TEMPORARY SIGNAL LAYOUT DETAILS SR 302 / SOUTHCREST - PHASES 1A, 1B, 1C, & 2
 TEMPORARY SIGNAL LAYOUT DETAILS SR 302 / SOUTHCREST - PHASES 2, 3A, & 3B

TC-GN1 37
 TC-GN2 38
 TC-TS1 39
 TC-TS2 40
 TC-TS3 41
 TC-TS4 42
 TC-1 43
 TC-2 44
 TC-3 45
 TC-4 46
 TC-5 47
 TC-6 48
 TC-7 49
 TC-8 50
 TC-9 51
 TC-10 52
 TC-11 53
 TC-12 54
 TC-13 55
 TC-14 56
 TC-15 57
 TC-16 58
 TC-17 59
 TC-18 60
 TC-19 61
 TC-20 62
 TC-21 63
 TC-22 64
 TC-SIG1A 65
 TC-SIG1B 66
 TC-SIG2A 67
 TC-SIG2B 68
 TC-SIG3A 69
 TC-SIG3B 70

FORM GRADES (2)

SR302 AT I-55 NORTHWEST RAMP INTERSECTION
 SR302 AT I-55 SOUTHEAST RAMP INTERSECTION

FG-1 71
 FG-2 72

DETAIL OF INTERSECTION SHEETS (5)

DETAIL OF INTERSECTION - S.R. 302 / GOODMAN RD. AT INTERSTATE BLVD.
 DETAIL OF INTERSECTION - S.R. 302 / GOODMAN RD. AT SOUTHBOUND RAMP
 DETAIL OF INTERSECTION - S.R. 302 / GOODMAN RD. AT I-55 OVERPASS
 DETAIL OF INTERSECTION - S.R. 302 / GOODMAN RD. AT NORTHBOUND RAMP
 DETAIL OF INTERSECTION - S.R. 302 / GOODMAN RD. AT SOUTHCREST PARKWAY

ID-1 73
 ID-2 74
 ID-3 75
 ID-4 76
 ID-5 77

5/23/2017 4:21 PM DI.DGN



PS & E PLANS-DATE 4/13/17		
FMS CON. *107037/301000		
REVISIONS		
DATE	SHEET NO.	BY
5/22/17	7, 8, 9, 10, 11, 19, 22,	MSJ
	37, 1008, 2001, 2002	
	2003	

REVISION	MISSISSIPPI DEPARTMENT OF TRANSPORTATION	
	DETAILED INDEX	
DATE	PROJ. NO. HSIP-0055-04(099)	
	DESOTO COUNTY	
DESIGN TEAM	WORKING NUMBER	
	DI-1	
FILENAME: DI.DGN		SHEET NUMBER
DATE		2

STATE	PROJECT NO.
MISS.	HSIP-0055-04(099)

GENERAL NOTES

- (1) THE LOCATION AND SPACING OF SIGNS, SHOWN ON THE TRAFFIC CONTROL PLANS, ARE APPROXIMATE AND MAY BE ADJUSTED AS NECESSARY TO FIT FIELD CONDITIONS.
- (2) ALL TRAFFIC CONTROL DEVICES ON THIS PROJECT SHALL COMPLY WITH PART VI OF THE MUTCD (LATEST EDITION).
- (3) ALL PLASTIC DRUMS SHALL HAVE A BALLASTING COLLAR MADE FROM RECYCLED TRUCK TIRES OR OTHER SUITABLE MATERIAL.
- (4) 25% SHRINKAGE FACTOR USED IN THE EARTHWORK CALCULATIONS IS FOR DESIGN ESTIMATING PURPOSES ONLY.
- (5) THE CONTRACTOR SHALL BE RESPONSIBLE FOR PROTECTING EXISTING STRUCTURES SUCH AS, BUT NOT LIMITED TO, PIPES, INLETS, APRONS, AND BRIDGES FROM DAMAGE WHICH MIGHT OCCUR DURING CONSTRUCTION. THE CONTRACTOR SHALL REPLACE OR REPAIR, AS DIRECTED BY THE ENGINEER, ANY STRUCTURES DAMAGED DURING THE LIFE OF THE CONTRACT. NO PAYMENT WILL BE MADE FOR REPLACEMENT OR REPAIR OF DAMAGED ITEMS.
- (6) ALL PIPE JOINTS ARE TO BE WRAPPED IN 24-INCH WIDE TYPE V GEOTEXTILE FABRIC. ALL PICKUP HOLES SHALL BE PLUGGED WITH PLASTIC INSERTS AND BITUMINOUS SEALER TO THE SATISFACTION OF THE ENGINEER (NOT A SEPARATE PAY ITEM).
- (7) VOIDS CREATED BY THE REMOVAL OF, BUT NOT LIMITED TO, POSTS, CONCRETE ANCHORS, AND FOOTINGS SHALL BE BACKFILLED AND TAMPED IN ACCORDANCE WITH SECTION 203 OF THE MISSISSIPPI STANDARD SPECIFICATIONS FOR ROAD AND BRIDGE CONSTRUCTION, THE COST OF WHICH WILL BE ABSORBED IN OTHER ITEMS BID.
- (8) UTILITIES ON THE DRAWINGS ARE SHOWN IN THEIR ORIGINAL LOCATION BASED UPON THE BEST INFORMATION AVAILABLE TO THE ENGINEER. UTILITIES THAT WERE FOUND TO BE IN CONFLICT WITH CONSTRUCTION HAVE BEEN RELOCATED. PERMITS ARE ON FILE WITH THE DEPARTMENT SHOWING THE APPROXIMATE LOCATION OF UTILITIES RELOCATED WITHIN THE RIGHT-OF-WAY. THE ENGINEER CAN NOT AND DOES NOT WARRANT THAT THIS INFORMATION IS COMPLETE OR ACCURATE. THE CONTRACTOR MUST COORDINATE DIRECTLY WITH THE INVOLVED UTILITY OWNERS TO HAVE UNDERGROUND UTILITY LINES FIELD LOCATED IN ADVANCE OF CONSTRUCTION.
- (9) WORK ON STRUCTURES FOR THIS PROJECT REQUIRES EXCAVATION IN THE IMMEDIATE VICINITY OF TRAFFIC AND ADJACENT PROPERTIES. THEREFORE, THE RISK OF A FAILURE OCCURRING DURING EXCAVATION REQUIRES THAT EXTREME CAUTION BE EXERCISED. THE CONTRACTOR SHALL BE RESPONSIBLE FOR PLACING WHAT BRACING, SHORING, OR GROUND SUPPORT SYSTEM THAT IS DEEMED NECESSARY TO PREVENT A FAILURE AND PROTECT THE PERSONS WORKING NEAR THE EXCAVATION, THE PUBLIC THAT MAY BE ABOVE THE EXCAVATION OR ANY STRUCTURES ADJACENT TO THE EXCAVATION. ALL COSTS FOR DESIGNING, DRAWING, AND CONSTRUCTING THE FACILITY SHALL BE INCLUDED IN THE PRICE BID FOR CONTRACT ITEMS.
- (10) SOME WORK IS REQUIRED OUTSIDE THE PROJECT LIMITS. NO ADDITIONAL COMPENSATION WILL BE MADE FOR SUCH WORK EXCEPT AS PROVIDED BY SPECIFIC PAY ITEMS INCLUDED IN THE PLANS.
- (11) WIRE FENCE BACKING WILL BE REQUIRED FOR ALL SILT FENCE. (SEE WK. NO. ECD-3)
- (12) FOR LIST OF PUBLIC UTILITIES, SEE WORKING NO. 3LT & 3RT
- (13) ALL POST LENGTHS FOR SIGNS SHALL BE VERIFIED IN THE FIELD PRIOR TO FABRICATION.
- (14) FLUORESCENT ORANGE SHEETING SHALL BE USED ON ALL CONSTRUCTION AND TRAFFIC CONTROL SIGNS EXCEPT FOR THOSE DESIGNATED ON THE PLANS TO BE BLACK LEGEND AND BORDER ON WHITE BACKGROUND.
- (15) VEGETATIVE MATERIAL WILL BE REMOVED PRIOR TO PLACEMENT OF GRANULAR MATERIAL. THE COST OF WHICH SHALL BE ABSORBED IN OTHER BID ITEMS.
- (16) THE CONTRACTOR SHALL REPAIR ANY DAMAGE TO THE SURFACE TREATED SHOULDER THAT MIGHT OCCUR DURING CONSTRUCTION. ANY REPAIR TO SHOULDER WILL BE IN ACCORDANCE WITH SECTION 410 OF THE MISSISSIPPI STANDARD SPECIFICATIONS FOR ROAD AND BRIDGE CONSTRUCTION. NO PAYMENT WILL BE MADE FOR REPAIR OF DAMAGED SHOULDER.
- (17) THE CONTRACTOR SHALL COORDINATE WITH THE CONTRACTOR FROM ADJACENT PROJECT(S) IN IMPLEMENTING THE TRAFFIC CONTROL PLAN AS DIRECTED BY THE ENGINEER. ALL CONFLICTING SIGNS SHALL BE COVERED OR REMOVED AS DIRECTED BY THE ENGINEER.
- (18) THE CONTRACTOR SHALL COVER ANY TEMPORARY TRAFFIC CONTROL SIGNS SHOWN IN THE TRAFFIC CONTROL PLAN THAT DO NOT APPLY TO THE CURRENT PHASE
- (19) REMOVAL OF RAISED PAVEMENT MARKERS THAT ARE IN CONFLICT WITH REQUIRED CONSTRUCTION IS NOT CONSIDERED A SEPARATE PAY ITEM. COST TO BE ABSORBED IN OTHER ITEMS BID.
- (20) REMOVAL OF OBJECT MARKERS IS NOT CONSIDERED A SEPARATE PAY ITEM, AND SHALL BE ABSORBED IN OTHER ITEMS BID.
- (21) WHERE MILLING IS REQUIRED, THE CONTRACTOR SHALL PROVIDE OUTLETS IN THE EXISTING SHOULDERS AT SUFFICIENT INTERVALS TO PREVENT POOLING OR STANDING WATER ON THE MILLED SURFACE, THE COST OF WHICH SHALL BE ABSORBED IN OTHER ITEMS BID.

GENERAL NOTES (CONTINUED)

- OF THE CONTRACTOR TO ENSURE THAT SILT DOES NOT LEAVE THE RIGHT OF WAY OR CONTAMINATE WATERS OF THE U. S. DURING CONSTRUCTION. THE CONTRACTOR SHALL SUBMIT AN EROSION CONTROL PLAN PRIOR TO COMMENCEMENT OF WORK AND MAINTAIN THE PLAN DURING CONSTRUCTION. ANY ADDITIONAL SILT BASINS NOT SHOWN IN THE PLANS SHALL BE INCLUDED IN THE CONTRACTOR'S EROSION CONTROL PLAN PRIOR TO SUBMITTING FOR APPROVAL.
- (23) PRIOR TO EARTHWORK OPERATIONS, THE EXISTING TOP 4" TOPSOIL IS TO BE STRIPPED AND STOCKPILED. AFTER THE GRADING OPERATIONS ARE COMPLETED, SAID TOPSOIL SHALL BE PLACED ON ALL AREAS THAT ARE NOT TO BE PAVED OR OTHERWISE PROTECTED, IN ACCORDANCE WITH SECTION 211 OF THE SPECIFICATIONS, OR THE VEGETATION SCHEDULE (SEE WK. SH. VS-1). EXISTING TOPSOIL AND ALL COSTS ASSOCIATED WITH STRIPPING, HAULING, STOCKPILING, AND PLACEMENT OF THE EXISTING TOPSOIL IS TO BE ABSORBED IN OTHER EARTHWORK ITEMS.
 - (24) THE CONTRACTOR IS RESPONSIBLE FOR FIELD-VERIFICATION OF EXISTING GRADES AND MAKING ADJUSTMENTS AS NECESSARY WITH THE APPROVAL OF THE PROJECT ENGINEER.
 - (25) TEMPORARY STRIPING SHALL CONFORM TO FINISHED STRIPE SPECIFICATIONS FOR ALIGNMENT, NEATNESS, AND STRAIGHTNESS.
 - (26) ALL ITEMS OF WORK ASSOCIATED WITH THE INSTALLATION OF A CONSTRUCTION ENTRANCE SHALL BE ABSORBED IN OTHER ITEMS OF WORK.
 - (27) ERECTION DATES ARE TO BE LEGIBLY WRITTEN IN BOLD, BLACK MARKINGS ON THE BACK OF ALL PERMANENT SIGNS WITH A PERMANENT MARKING STICK THAT IS WATERPROOF, FADE RESISTANT, AND MARKS ON WET OR DRY SURFACES.
 - (28) IF COLORS ARE USED ON PLAN/PROFILE SHEETS, THEY ARE INTENDED TO VISUALLY EASE THE LOCATION OF ELEMENTS FOR USERS OF THESE DRAWINGS. ALTHOUGH THE INTENT IS TO CATEGORIZE EVERYTHING AS EITHER EXISTING OR PROPOSED, IT IS THE END USER'S RESPONSIBILITY TO ENSURE ALL ELEMENTS ARE INTERPRETED CORRECTLY REGARDLESS OF COLOR.
 - (29) ALL ADDENDA TO THESE PLANS WILL BE POSTED TO WWW.MDOT.MS.GOV UNDER THE PROPOSAL ADDENDA COLUMN. BIDDERS ARE ADVISED THAT HARD COPIES OF ANY ADDENDA FOR THIS PROJECT WILL NOT BE MAILED. IT IS THE BIDDER'S RESPONSIBILITY TO CHECK AND SEE IF ANY ADDENDA HAVE BEEN POSTED FOR THIS PROJECT.
 - (30) CURB AND GUTTER VERTICAL DIMENSIONS SHOWN IN THE DETAIL DRAWINGS ARE FOR A CURB IN THE "CATCH" CONFIGURATION AND SHALL BE CONSIDERED TO BE MINIMUM DIMENSIONS. THE DIMENSIONS MAY BE MODIFIED AS NECESSARY FOR "SPILL" CURB AND GUTTER, BUT SHALL NOT BE LESS THAN THE MINIMUM SHOWN.
 - (31) THE COST FOR REMOVAL OF ALL HEADWALLS AND WINGWALLS (PIPES, BOX CULVERTS, BOX BRIDGES) SHALL BE ABSORBED IN OTHER ITEMS BID.
 - (32) BIDDERS BE ADVISED, THIS SET OF PLANS IS IMPLEMENTING PAY ITEMS FROM THE 2017 STANDARD SPECIFICATIONS AND IS UTILIZING THE CURRENT 1998 VERSION OF THE ROADWAY DESIGN STANDARD DRAWINGS, SPECIAL DESIGN SHEETS, AND TRAFFIC SIGNAL DETAIL SHEETS. IF ANY DISCREPANCIES ARE FOUND BETWEEN THE REFERENCE TO PAY ITEMS IN THE DRAWINGS AND THE 2017 PAY ITEMS, THEN IT WILL BE UNDERSTOOD THAT THE 2017 PAY ITEMS WILL BE USED AND PAID FOR AS IS LISTED IN THE SUMMARY QUANTITIES.

4/11/2017 2:25 PM GN-1.DGN

MISSISSIPPI DEPARTMENT OF TRANSPORTATION	
GENERAL NOTES	
PROJ. NO. HSIP-0055-04(099) DESOTO COUNTY	
WORKING NUMBER GN-1	
FILENAME: GN-1.DGN SHEET NUMBER 4	
DESIGN TEAM GS&P	CHECKED DATE

