

1st O.REV.

GENERAL INDEX

INCLUDED THIS PROJECT	BEGIN WITH SHEET
<input checked="" type="checkbox"/> ROADWAY .....	1
<input type="checkbox"/> PERMANENT SIGNS .....	1001
<input type="checkbox"/> TRAFFIC SIGNALS .....	2001
<input type="checkbox"/> ITS COMPONENTS .....	3001
<input type="checkbox"/> LIGHTING .....	4001
<input type="checkbox"/> (RESERVED) .....	5001
<input checked="" type="checkbox"/> ROADWAY STANDARD DWGS .....	6001
<input type="checkbox"/> BOX CULVERT STD. DRAWINGS (LRFD) ....	7001
<input type="checkbox"/> BOX CULVERT STD. DRAWINGS (STD. SPEC.)	7501
<input type="checkbox"/> BRIDGE .....	8001
<input type="checkbox"/> CROSS SECTIONS .....	9001

BRIDGE STRUCTURES REQ'D.

NONE

BOX BRIDGES REQ'D.

NONE

CONVENTIONAL SYMBOLS

COUNTY LINE .....	
TOWN CORPORATION LINE .....	
SECTION LINE .....	
EXISTING ROAD OR TRAVELED WAY .....	
PROPOSED ROAD OR TRAVELED WAY .....	
RAILROAD .....	
SURVEY LINE .....	
BRIDGES .....	

LENGTH OF ROADWAY	28,888,730 FT.	5.282 MI.
LENGTH OF BRIDGES	310,000 FT.	0.059 MI.
LENGTH OF PROJECT (NET)	28,198,730 FT.	5.341 MI.
LENGTH OF EXCEPTIONS	0.000 FT.	0.000 MI.
LENGTH OF PROJECT (GROSS)	28,198,730 FT.	5.341 MI.

LENGTH OF ROADWAY	28,288,730 FT.	5.358 MI.
LENGTH OF BRIDGES	329,000 FT.	0.062 MI.
LENGTH OF PROJECT (NET)	28,617,730 FT.	5.420 MI.
LENGTH OF EXCEPTIONS	0.000 FT.	0.000 MI.
LENGTH OF PROJECT (GROSS)	28,617,730 FT.	5.420 MI.

STATE OF MISSISSIPPI  
MISSISSIPPI DEPARTMENT OF TRANSPORTATION  
PLAN AND PROFILE OF PROPOSED  
STATE HIGHWAY  
FEDERAL AID PROJECT NO. STP-0008-02(115)

US 49  
D'LO TO RANKIN COUNTY LINE  
SIMPSON COUNTY

FMS. CONST. NO. 107727/301000

E.O.P. STA. 1432+80.00

E.O.P. STA. 1435+80.00

B.O.P. STA. 1153+00.00

B.O.P. STA. 1154+00.00

LEFT LANE EQUATIONS

STA. 1284 + 64.63 = STA. 1284 + 55.90 = + 8.73

RIGHT LANE EQUATIONS

STA. 1284 + 64.63 = STA. 1284 + 55.90 = + 8.73

LEFT LANE LENGTH DATA

RIGHT LANE LENGTH DATA

SCALES

PLAN	1 IN. = 100 FT.
PROFILE {	HOR. 1 IN. = 100 FT.
VERT.	1 IN. = 10 FT.
LAYOUT	1 IN. = 2,404 FT.

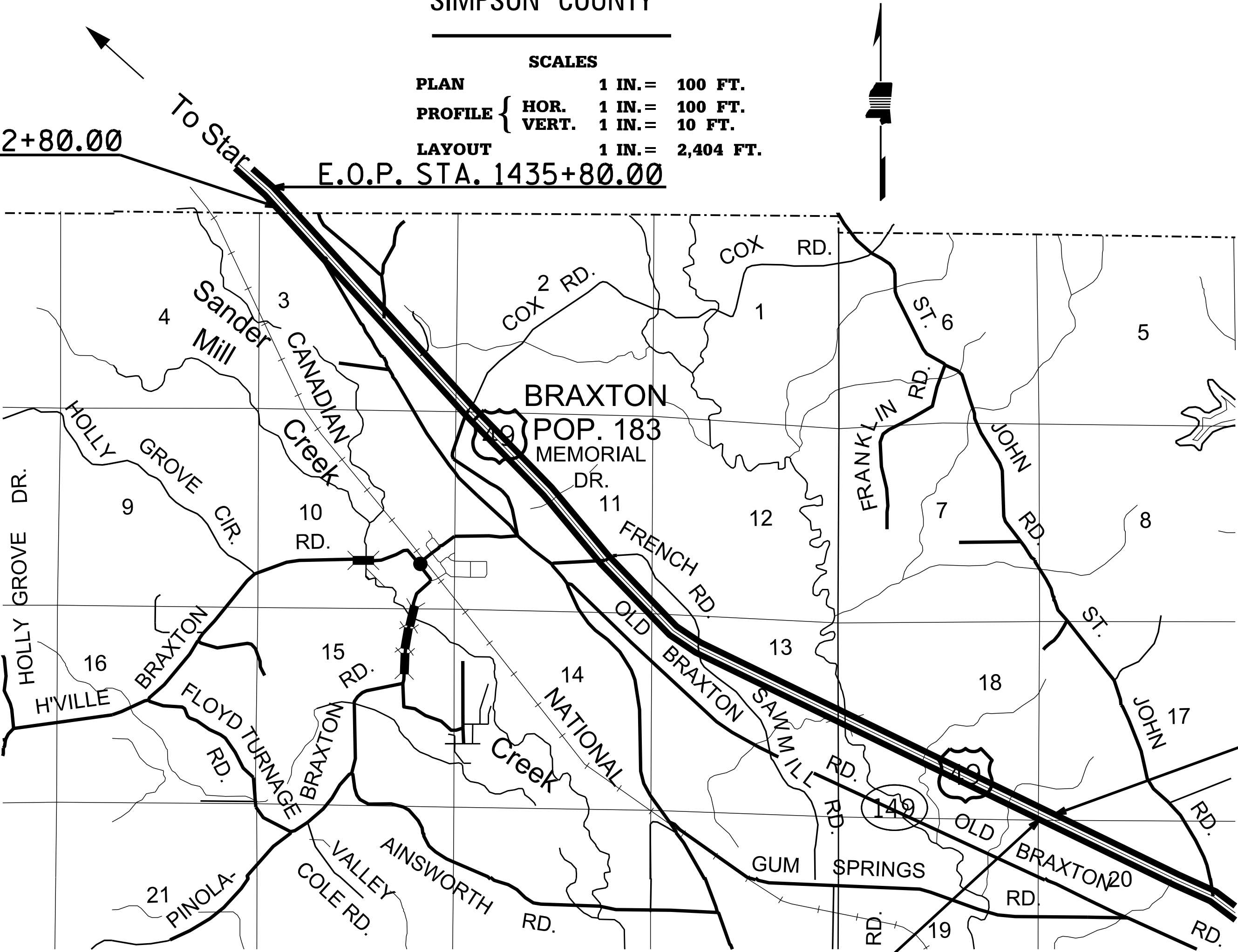

STATE	PROJECT NUMBER	SHEET NO.
MISSISSIPPI	STP-0008-02(115)	1

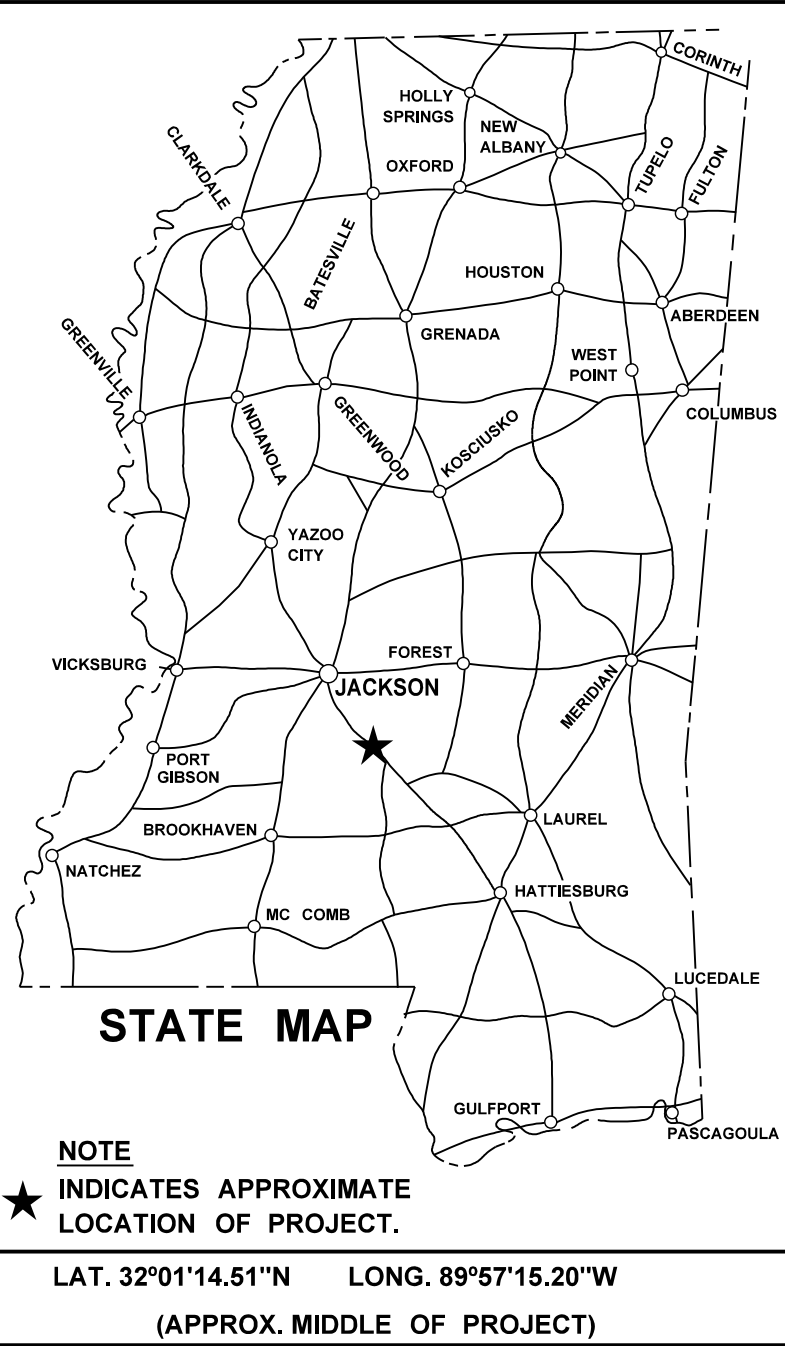

DESIGN CONTROL

MPH = V (SPEED DESIGN)
ADT ( ) = : ADT ( ) =
DHV = : D = % T = %

PERMITS ACQUIRED BY MDOT

WETLANDS AND WATERS PERMITS	
NATIONWIDE #14	<input checked="" type="checkbox"/>
NATIONWIDE (OTHER)*	<input checked="" type="checkbox"/>
GENERAL*	<input checked="" type="checkbox"/>
INDIVIDUAL (404)*	<input checked="" type="checkbox"/>
STORMWATER PERMIT <input checked="" type="checkbox"/>	
Y	REQUIRED, CNOI SUBMITTED BY MDOT (DISTURBED AREA=5 ACRES)
S	REQUIRED, CNOI TO BE SUBMITTED BY CONTRACTOR (1 TO 4.99 ACRES)
N	NO STORMWATER PERMIT REQUIRED (<1 ACRE)
APPROVED BY: _____	

P S & E DATE: 01 /24 /18
APPROVED:
DEPUTY EXECUTIVE DIRECTOR / CHIEF ENGINEER
EXECUTIVE DIRECTOR
MDOT MISSISSIPPI DEPARTMENT OF TRANSPORTATION



STATE	PROJECT NO.
MISS.	NH-0015-01(133)

DESCRIPTION OF SHEET

WKG.  
NO.      SH.  
NO.

TITLE AND LAYOUT SHEET (1)

1

DETAILED INDEX (1)  
GENERAL NOTES (1)

DI-1  
GN-1

2  
3

TYPICAL SECTION SHEETS (1)  
TYPICAL SECTION - US 49 MAINLINE

TS-1

4

QUANTITY SHEETS (5)  
SUMMARY OF ESTIMATED QUANTITIES  
SUMMARY OF ESTIMATED QUANTITIES  
ESTIMATED QUANTITY FOR MILLING, ASPHALT, AND GRANULAR MATERIAL (NORTHBOUND)  
ESTIMATED QUANTITY FOR MILLING, ASPHALT, AND GRANULAR MATERIAL (SOUTHBOUND)  
ESTIMATED QUANTITY FOR TRAFFIC CONTROL SIGNING

SQ-1  
SQ-2  
EQ-1  
EQ-2  
TCPQ-1

5  
6  
7  
8  
9

PLAN & PROFILE SHEETS (10)  
STA. 1150+00 TO STA. 1176+00  
STA. 1176+00 TO STA. 1206+00  
STA. 1206+00 TO STA. 1236+00  
STA. 1236+00 TO STA. 1266+00  
STA. 1266+00 TO STA. 1295+00  
STA. 1295+00 TO STA. 1325+00  
STA. 1325+00 TO STA. 1355+00  
STA. 1355+00 TO STA. 1385+00  
STA. 1385+00 TO STA. 1415+00  
STA. 1415+00 TO STA. 1433+63.75

WK3  
WK4  
WK5  
WK6  
WK7  
WK8  
WK9  
WK10  
WK11  
WK12

10  
11  
12  
13  
14  
15  
16  
17  
18  
19

SPECIAL DESIGN SHEETS (3)  
DETAIL OF CONSTRUCTION SIGNING - US 49  
TYPICAL PAVEMENT MARKING DETAIL FOR MEDIAN CROSSOVER  
GUARDRAIL TYPICAL INSTALLATION AT BRIDGE APPROACHES FOR DIVIDED HIGHWAYS

DCS-1  
SDX0-1  
GR-4-MOD

20  
21  
22

STANDARD DRAWINGS (14)  
PAVEMENT MARKING DETAILS FOR 2-LANE AND 4-LANE DIVIDED HIGHWAYS  
2-WAY RAISED PAVEMENT MARKERS AT INTERSECTING ROADS (4-LANE)  
RUMBLE STRIPES 4-LANE HIGHWAYS (ASPHALT LANES, 2FT. OR WIDER ASPHALT SHOULDERS)  
GUARDRAIL: "W" BEAM (WOOD POSTS)  
GUARDRAIL: "W" BEAM (STEEL POSTS)  
TYPICAL CROSSOVER DELINEATION  
TRAFFIC CONTROL PLAN FOR POSTED SPEED LIMIT OF 65 OR 70 MPH (INTERSTATE AND OTHER 4-LANE DIVIDED HIGHWAYS) (MEDIAN LANE OR OUTSIDE LANE CLOSURE) (EXTENDED PERIOD)  
TRAFFIC CONTROL PLAN FOR POSTED SPEED LIMIT OF 65 OR 70 MPH (INTERSTATE AND OTHER 4-LANE DIVIDED HIGHWAYS) (MEDIAN LANE OR OUTSIDE LANE CLOSURE) (WORK DAY ONLY)  
HIGHWAY SIGN AND BARRICADE DETAIL FOR CONSTRUCTION PROJECTS  
TRAFFIC CONTROL PLAN FOR MOBILE OPERATIONS MULTILANE ROADS AND TWO-LANE ROADS  
TRAFFIC CONTROL PLANS UNEVEN PAVEMENT DETAILS  
TEMPORARY STRIPING FOR TRAFFIC CONTROL 2-LANE AND 4-LANE DIVIDED HIGHWAYS  
TRAFFIC CONTROL DETAILS DRUM PLACEMENT AND SHOULDER CLOSURE  
RURAL DRIVEWAYS

PM-1  
PM-12  
RS-2  
GR-1  
GR-1B  
SN-8B  
TCP-4  
TCP-5  
TCP-8  
TCP-9  
TCP-12  
TCP-13  
TCP-16  
RD-1

6051  
6062  
6065  
6201  
6203  
6316  
6354  
6355  
6358  
6359  
6362  
6363  
6366  
6403

TOTAL SHEETS (36)

DISTRICT 7

PS & E PLANS-DATE 01/24/2018		
FMS CON. # 107727/301000		
REVISIONS		
DATE	SHEET NO.	BY
2/14/18	3, 4, 5	K.C.
2/16/18	1	RCG

MISSISSIPPI DEPARTMENT OF TRANSPORTATION

DETAILED INDEX

PROJ. NO.: NH-0015-01(133)  
COUNTY: Franklin

FILENAME: \_(02)index.dgn  
DESIGN TEAM \_\_\_\_\_ CHECKED \_\_\_\_\_ DATE \_\_\_\_\_



WORKING NUMBER  
**DI-1**  
SHEET NUMBER  
**2**



1st O.REV.

PLAN DIVISION  
ROADWAY  
MISSISSIPPI DEPARTMENT OF TRANSPORTATION

2/15/2018 2:18 PM (03) GEN NOTES.dgn

GENERAL NOTES

1

THE LOCATION AND SPACING OF SIGNS AS SHOWN ON THE TRAFFIC CONTROL PLANS ARE APPROXIMATE AND MAY BE ADJUSTED AS NECESSARY TO FIT FIELD CONDITIONS.

2

ALL TRAFFIC CONTROL DEVICES ON THIS PROJECT SHALL COMPLY WITH PART VI OF THE MUTCD (LATEST EDITION).

3

FLUORESCENT ORANGE SHEETING SHALL BE USED ON ALL CONSTRUCTION AND TRAFFIC CONTROL SIGNS EXCEPT FOR THOSE DESIGNATED ON THE PLANS TO BE BLACK LEGEND AND BORDER ON WHITE BACKGROUND.

4

ALL PLASTIC DRUMS SHALL HAVE A BALLASTING COLLAR MADE FROM RECYCLED TRUCK TIRES OR SUITABLE MATERIAL.

5

ALL SIGNS AND DELINEATORS THAT CONFLICT WITH THE CONSTRUCTION OF THIS PROJECT SHALL BE REMOVED AND RESET BY THE CONTRACTOR; COST TO BE ABSORBED IN OTHER PAY ITEMS.

6

THE GRASS ON EXISTING SHOULDERS SHALL BE REMOVED PRIOR TO THE PLACEMENT OF SHOULDER MATERIAL BY LIGHTLY BLADING OR CLOSELY MOWING; COST TO BE ABSORBED IN OTHER PAY ITEMS.

7

WHERE MILLING OF THE ROADWAY IS REQUIRED, THE CONTRACTOR SHALL PROVIDE OUTLETS IN THE EXISTING SHOULDER AT SUFFICIENT INTERVALS TO PREVENT POOLING OR STANDING WATER ON MILLED SURFACE; COST TO BE ABSORBED IN OTHER PAY ITEMS.

8

IT SHALL BE THE RESPONSIBILITY OF THE CONTRACTOR TO PROTECT EXISTING STRUCTURES SUCH AS PIPES, INLETS, APRONS, BRIDGES, ETC., FROM DAMAGE WHICH MIGHT OCCUR DURING CONSTRUCTION. THE CONTRACTOR SHALL REPLACE OR REPAIR, AS DIRECTED BY THE ENGINEER, ANY STRUCTURES DAMAGED DURING THE LIFE OF THE CONTRACT. NO PAYMENT WILL BE MADE FOR REPLACEMENT OR REPAIR OF DAMAGED ITEMS.

9

THE CONTRACTOR SHALL REMOVE EXISTING PAVEMENT MARKERS PRIOR TO PLACING ASPHALT; COST TO BE ABSORBED IN OTHER PAY ITEMS.

10

TEMPORARY STRIPING IS REQUIRED AFTER MILLING, PRELIMINARY LEVELING, AND OVERLAYING OPERATIONS; WEATHER PERMITTED OR PRIOR TO OPENING THE AREA TO TRAFFIC; TEMPORARY STRIPING SHALL BE PLACED IN THE SAME LOCATIONS AND LAYOUT AS PERMANENT STRIPE.

11

ALL ASPHALT AND CONCRETE CURBS ALONG RAMPS, LOCAL ROADS, ETC. FROM B.O.P. TO E.O.P. SHALL BE PAINTED (TWO APPLICATIONS) WITH WHITE TRAFFIC PAINT AND TRAFFIC BEADS PER DCIS-1; COST TO BE ABSORBED IN OTHER PAY ITEMS.

12

IF THE ASPHALT CURB ALONG THE LOCAL ROAD IS SEVERELY DAMAGED, THE ENTIRE ASPHALT CURB WILL BE REMOVED AS DIRECTED BY THE ENGINEER; COST TO BE ABSORBED IN OTHER PAY ITEMS.

13

ALL LOCAL ROADS TO BE PAVED TO THE R.O.W. LIMITS OR AS DIRECTED.

14

VOIDS CREATED BY THE REMOVAL OF POSTS, CONCRETE ANCHORS, FOOTINGS, ETC. SHALL BE BACKFILLED AND TAMPED IN ACCORDANCE WITH SECTION 203 OF THE MISSISSIPPI STANDARD SPECIFICATIONS FOR ROAD AND BRIDGE CONSTRUCTION.

15

ALL RAMPS AND DRIVEWAYS TO BE PAVED TO THE SHOULDER LINE, MINIMUM, OR FURTHER, AS DIRECTED WITHIN THE LIMITS OF THE R.O.W.

16

GRANULAR MATERIAL WILL NOT BE ALLOWED TO BE PLACED DIRECTLY ON THE SURFACE LIFT OF ASPHALT, BUT MUST BE PLACED DIRECTLY ON THE SHOULDER OR A ROAD WIDENER MACHINE USED AND APPROVED BY THE PROJECT ENGINEER.

17

BIDDERS ARE ADVISED THAT HARD COPIES OF ANY ADDENDA FOR THIS PROJECT WILL NO LONGER BE MAILED. ALL ADDENDA FOR THIS PROJECT WILL BE POSTED TO [www.mdot.ms.gov](http://www.mdot.ms.gov) UNDER THE PROPOSAL ADDENDA COLUMN. IT IS THE BIDDER'S RESPONSIBILITY TO CHECK AND SEE IF ANY ADDENDA HAVE BEEN POSTED FOR THIS PROJECT. PLEASE CONTACT CONTRACT ADMINISTRATION DIVISION AT 601-359-7700 FOR ANY QUESTIONS REGARDING ELECTRONIC ADDENDA.

18

STORAGE OF FLAMMABLE MATERIAL WILL NOT BE ALLOWED UNDER ANY BRIDGE STRUCTURE.

19

INSTALLATION DATES SHALL BE CLEARLY WRITTEN IN BOLD BLACK MARKINGS ON THE BACK BOTTOM HALF OF ALL SIGNS WITH A PERMANENT MARKING STICK THAT IS WATERPROOF, FADE RESSISTANT AND MARKS ON WET OR DRY SURFACES.

20

ALL POST, PIPE, AND I-BEAM LENGTHS IN THESE PLANS ARE ESTIMATES. POST LENGTHS FOR ALL SIGNS SHALL BE VERIFIED IN THE FIELD BY THE CONTRACTOR PRIOR TO FABRICATION.

21

ALL EXISTING SIGNS WHICH ARE TO BE REMOVED AS A PART OF THIS PROJECT THAT ARE NOT IN CONFLICT WITH CONSTRUCTION SHALL REMAIN IN PLACE UNTIL NEW SIGNS ARE INSTALLED UNLESS NOTED OR DIRECTED ORTHERWISE BY THE PROJECT ENGINEER. ROADWAY SIGNS THAT ARE IN CONFLICT WITH CONSTRUCTION SHALL BE REMOVED AND RELOCATED BY THE CONTRACTOR AS DIRECTED BY THE ENGINEER, THE COST OF WHICH SHALL BE ABSORBED IN OTHER ITEMS BID.

22

ALL EXISTING SIGNS AND SUPORTS REMOVED UNDER THIS PROJECT SHALL BECOME THE PROPERTY OF THE CONTRACTOR AND ARE NOT A SEPARATE PAY ITEM WITH THE EXCEPTION OF THE GUIDE SIGN 0.0625" OVERLAY PANELS WHICH SHALL BECOME THE PROPERTY OF MDOT. CONTRACTOR SHALL ARRANGE WITH THE PROJECT ENGINEER A SUITABLE TIME FOR PICK-UP BY MDOT. MDOT RESERVES THE REGHT TO REFUSE ANY MATERIAL THAT IS DAMAGED OR UNSUITABLE FOR REFURBISHMENT.

23

DIRECT – APPLIED LEGEND, BORDERM AND/OR SHIELDS ARE TO BE USED ON ALL GUIDE SIGNS. DIGITALLY PRODUCED SIGN COPY, SHIELDS, LEGENDS, SYSMBOLS, OR IMAGES WILL NOT BE ALLOWED WITHOUT WRITTEN APPROVAL FROM MDOT'S PROJECT ENGINEER.

24

AFTER THE PERMANENT SIGNS AHVE BEEN INSTALLED, THE CONTRACTOR SHALL SUBMIT TO THE PROJECT ENGINEER A DIGITAL COPY OF A MICROSOFT EXCEL SPREADSHEET WITH THE FOLLOWING INVENTORY DATA CAPTURED FOR EACH SIGN: LOCATION OF SIGN (LATITUDE – LONGITUED GPS COORDINATES), MUTCD SIGN CODE, SIZE, BACKGROUND AND LEGEND COLORS, SUPPORT TYPE (POST, PIPE, SQUARE POST, OR I-BEAM), NUMBER OF SUPPORT, DATE OF INSTALLATION, SIGN FACE DIRECTION, ROUTE NAME OR NUMBER, DIRECTION OF VEHICLE TRAVEL, AND LEGEND O SIGN IF APPLICABLE. EACH SIGN SHALL BE ASSIGNED UNIQUE ID NUMBER AND A DIGITAL PHOTO OF EACH SIGN SHALL BE SUBMITTED IN BITMAP FORMAT. THE PHOTO FILENAME SHALL CORRESPOND WITH THE UNIQUE ID NUMBER.

25

ASPHALT WILL BE REQUIRED UNDER ALL GUARDRAILS AS SHOWN ON GR-4-MOD.

26

LANE CLOSURES SHALL NOT EXCEED (3) MILES IN LENGTH.

27

THE SAW AND SEAL OF TRAVERSE JOINTS ARE NOT CONTINUOUS THROUGH THE PROJECT BUT ARE VARIOUS LOCATIONS THROUGHOUT THE PROJECT.

MISSISSIPPI DEPARTMENT OF TRANSPORTATION

GENERAL NOTES

PROJ. NO.: STP-0008-02(115)  
COUNTY: SIMPSON

FILENAME: (03)Gen\_Notes.dgn  
DESIGN TEAM \_\_\_\_\_ CHECKED \_\_\_\_\_ DATE \_\_\_\_\_

MISSISSIPPI DEPARTMENT OF TRANSPORTATION

WORKING NUMBER  
GN-1

SHEET NUMBER  
3