

**SECTION 905 -- PROPOSAL (CONTINUED)**

I (We) hereby certify by digital signature and electronic submission via Bid Express of the Section 905 proposal below, that all certifications, disclosures and affidavits incorporated herein are deemed to be duly executed in the aggregate, fully enforceable and binding upon delivery of the bid proposal. I (We) further acknowledge that this certification shall not extend to the bid bond or alternate security which must be separately executed for the benefit of the Commission. This signature does not cure deficiencies in any required certifications, disclosures and/or affidavits. I (We) also acknowledge the right of the Commission to require full and final execution on any certification, disclosure or affidavit contained in the proposal at the Commission's election upon award. Failure to so execute at the Commission's request within the time allowed in the Standard Specifications for execution of all contract documents will result in forfeiture of the bid bond or alternate security.

Bidder acknowledges receipt of and has added to and made a part of the proposal and contract documents the following addendum (addenda):

ADDENDUM NO. <u>  1  </u>	DATED <u>  4/2/2018  </u>	ADDENDUM NO. <u>      </u>	DATED <u>      </u>
ADDENDUM NO. <u>      </u>	DATED <u>      </u>	ADDENDUM NO. <u>      </u>	DATED <u>      </u>
ADDENDUM NO. <u>      </u>	DATED <u>      </u>	ADDENDUM NO. <u>      </u>	DATED <u>      </u>

Number	Description
1	Revised Bid Items; Revised or Added Plan Sheet Nos. 2,4,9, & 23; Amendment EBS Download Required.

TOTAL ADDENDA:   1    
 (Must agree with total addenda issued prior to opening of bids)

Respectfully Submitted,

DATE \_\_\_\_\_

\_\_\_\_\_  
 Contractor

BY \_\_\_\_\_  
 Signature

TITLE \_\_\_\_\_

ADDRESS \_\_\_\_\_

CITY, STATE, ZIP \_\_\_\_\_

PHONE \_\_\_\_\_

FAX \_\_\_\_\_

E-MAIL \_\_\_\_\_

(To be filled in if a corporation)

Our corporation is chartered under the Laws of the State of \_\_\_\_\_ and the names, titles and business addresses of the executives are as follows:

\_\_\_\_\_  
 President Address

\_\_\_\_\_  
 Secretary Address

\_\_\_\_\_  
 Treasurer Address

The following is my (our) itemized proposal.

BR-0006-01(091)/ 106111301000

Bolivar County(ies)

Revised 01/26/2016

Bridge Replacement on SR 32 (Bridge No. 7.1), known as Federal Aid Project No. BR-0006-01(091) / 106111301 in Bolivar County.

Line No.	Item Code	Adj Code	Quantity	Units	Description [Fixed Unit Price]
<b>Roadway Items</b>					
0010	201-A001		1	Lump Sum	Clearing and Grubbing
0020	202-A001		1	Lump Sum	Removal of Obstructions
0030	202-B007		29	Square Yard	Removal of Asphalt Pavement, All Depths
0040	202-B191		4	Linear Feet	Removal of Pipe, 8" And Above
0050	202-B215		8	Each	Removal of Sign Including Post & Footing
0060	203-G002	(E)	714	Cubic Yard	Excess Excavation, LVM, AH
0070	206-A001	(S)	12	Cubic Yard	Structure Excavation
0080	209-A005		7,926	Square Yard	Geotextile Stabilization, Type V, Non-Woven
0090	213-C001		1	Ton	Superphosphate
0100	216-A001		455	Square Yard	Solid Sodding
0110	217-A001		100	Square Yard	Ditch Liner
0120	219-A001		10	Thousand Gallon	Watering [\$20.00]
0130	220-A001		1	Acre	Insect Pest Control [\$30.00]
0140	221-A001	(S)	3	Cubic Yard	Concrete Paved Ditch
0150	229-A001		500	Square Yard	Erosion Mat
0160	234-A001		1,900	Linear Feet	Temporary Silt Fence
0170	235-A001		150	Each	Temporary Erosion Checks
0180	237-A002		150	Linear Feet	Wattles, 20"
0190	239-A001		60	Linear Feet	Temporary Slope Drains
0200	245-A001		150	Linear Feet	Silt Dike
0210	246-B002		150	Linear Feet	Rockbags
0220	249-A001		150	Ton	Riprap for Erosion Control
0230	403-A003	(BA1)	382	Ton	12.5-mm, ST, Asphalt Pavement
0240	403-A006	(BA1)	473	Ton	19-mm, ST, Asphalt Pavement
0250	403-A015	(BA1)	368	Ton	9.5-mm, ST, Asphalt Pavement
0260	407-A001	(A2)	354	Gallon	Asphalt for Tack Coat
0270	413-E001		68	Linear Feet	Sawing and Sealing Transverse Joints in Asphalt Pavement
0280	502-A001	(C)	160	Square Yard	Reinforced Cement Concrete Bridge End Pavement
0290	503-C010		40	Linear Feet	Saw Cut, Full Depth
0300	601-B001	(S)	1	Cubic Yard	Class "B" Structural Concrete, Minor Structures
0310	603-CA011	(S)	24	Linear Feet	18" Reinforced Concrete Pipe, Class III
0320	603-CB003	(S)	2	Each	18" Reinforced Concrete End Section
0330	605-AA001	(S)	42	Square Yard	Geotextile for Subsurface Drainage, Type III

Line No.	Item Code	Adj Code	Quantity	Units	Description [Fixed Unit Price]
0340	605-O002	(S)	74	Linear Feet	4" Perforated Sewer Pipe for Underdrains, SDR 23.5
0350	605-P002	(S)	35	Linear Feet	4" Non-perforated Sewer Pipe for Underdrains, SDR 23.5
0360	605-W001	(GY)	3	Cubic Yard	Filter Material for Combination Storm Drain and/or Underdrains, Type A, FM
0370	606-B001		150	Linear Feet	Guard Rail, Class A, Type 1
0380	606-D022		2	Each	Guard Rail, Bridge End Section, Type I
0390	606-E007		2	Each	Guard Rail, Terminal End Section, Non-Flared
0400	612-B001		20	Cubic Yard	Flowable Fill, Non-Excavatable
0410	615-A002	(S)	40	Linear Feet	Concrete Bridge End Barrier, 33.5"
0420	618-A001		1	Lump Sum	Maintenance of Traffic
0430	618-B001		1	Square Feet	Additional Construction Signs [\$10.00]
0440	619-A1002		2,497	Linear Feet	Temporary Traffic Stripe, Continuous White
0450	619-A4001		1,315	Linear Feet	Temporary Traffic Stripe, Skip Yellow
0460	619-A5001		464	Linear Feet	Temporary Traffic Stripe, Detail
0470	619-A6002		165	Linear Feet	Temporary Traffic Stripe, Legend
0480	620-A001		1	Lump Sum	Mobilization
0490	626-C003		2,497	Linear Feet	6" Thermoplastic Edge Stripe, Continuous White
0500	626-D004		1,315	Linear Feet	6" Thermoplastic Traffic Stripe, Skip Yellow
0510	626-G002		278	Linear Feet	Thermoplastic Detail Stripe, White
0520	626-G003		186	Linear Feet	Thermoplastic Detail Stripe, Yellow
0530	626-H005		165	Linear Feet	Thermoplastic Legend, White
0540	627-J001		31	Each	Two-Way Clear Reflective High Performance Raised Markers
0550	627-L001		33	Each	Two-Way Yellow Reflective High Performance Raised Markers
0560	629-A004		2	Each	Vehicular Impact Attenuator, 60 MPH
0570	630-A003		22	Square Feet	Standard Roadside Signs, Sheet Aluminum, 0.125" Thickness
0580	630-C003		59	Linear Feet	Steel U-Section Posts, 3.0 lb/ft
0590	630-F006		10	Each	Delineators, Guard Rail, White
0600	630-G007		8	Each	Type 3 Object Markers, OM-3R, Post Mounted
0610	699-A001		1	Lump Sum	Roadway Construction Stakes
0620	907-832-PP003		706	Square Yard	Concrete Mat
<b>ALTERNATE GROUP AA NUMBER 1</b>					
0630	304-F001	(GT)	5,800	Ton	3/4" and Down Crushed Stone Base
<b>ALTERNATE GROUP AA NUMBER 2</b>					
0640	304-F002	(GT)	5,800	Ton	Size 610 Crushed Stone Base
<b>ALTERNATE GROUP AA NUMBER 3</b>					

Line No.	Item Code	Adj Code	Quantity	Units	Description [Fixed Unit Price]
0650	304-F003	(GT)	5,800	Ton	Size 825B Crushed Stone Base
<b>ALTERNATE GROUP BB NUMBER 1</b>					
0660	605-W002	(GY)	64	Cubic Yard	Filter Material for Combination Storm Drain and/or Underdrains, Type B, FM
<b>ALTERNATE GROUP BB NUMBER 2</b>					
0670	605-W003	(GY)	64	Cubic Yard	Filter Material for Combination Storm Drain and/or Underdrains, Type C, FM
<b>ALTERNATE GROUP CC NUMBER 1</b>					
0680	907-624-B002		170	Linear Feet	6" Inverted Profile Thermoplastic Traffic Stripe, Continuous White
0690	907-624-C001		85	Linear Feet	6" Inverted Profile Thermoplastic Traffic Stripe, Skip Yellow
<b>ALTERNATE GROUP CC NUMBER 2</b>					
0700	628-H001		170	Linear Feet	6" High Performance Cold Plastic Traffic Stripe, Continuous White
0710	628-I002		85	Linear Feet	6" High Performance Cold Plastic Traffic Stripe, Skip Yellow
<b>Bridge Items</b>					
0720	501-K001		284	Square Yard	Transverse Grooving
0730	803-B001		1	Each	Conventional Static Pile Load Test [\$5,000.00]
0740	803-C002	(S)	1,925	Linear Feet	14" x 14" Prestressed Concrete Piling
0750	803-I002	(S)	1	Each	PDA Test Pile, Concrete Pile
0760	803-J001	(S)	2	Each	Pile Restrike
0770	804-A001	(S)	59	Cubic Yard	Bridge Concrete, Class AA
0780	804-A004	(S)	88	Cubic Yard	Bridge Concrete, Class BD
0790	804-C166	(S)	330	Linear Feet	85' Prestressed Concrete Beam, Type 36" FIB
0800	805-A001	(S)	28,206	Pounds	Reinforcement
0810	813-A002	(S)	170	Linear Feet	Concrete Railing, 32"

**ADDENDUM**

STATE	PROJECT NO.
MISS.	BR-0006-01(091)

WKG. NO. \_\_\_\_\_ SH. NO. \_\_\_\_\_

DESCRIPTION OF SHEET

DESCRIPTION OF SHEET

TITLE SHEET (1)	1	WKG. NO.	SH. NO.
<u>DETAILED INDEX &amp; GENERAL NOTES (4)</u>			
DETAILED INDEX	DI-1		6009
DETAILED INDEX	DI-2		6051
GENERAL NOTES	GN-1		6061
GENERAL NOTES	GN-2		6101
<u>TYPICAL SECTION SHEETS (3)</u>			
TYPICAL SECTIONS - MAINLINE S.R. 32	TS-1		6102
TYPICAL SECTIONS - LOCAL ROAD & BRIDGE END PAVEMENT	TS-2		6103
TYPICAL SECTIONS - MISCELLANEOUS	TS-3		6104
<u>QUANTITY SHEETS (6)</u>			
SUMMARY OF QUANTITIES	SQ-1		6105
SUMMARY OF QUANTITIES	SQ-2		6106
ESTIMATED QUANTITIES - DRAINAGE STRUCTURES, BRIDGE END PAVEMENT, GUARDRAIL	EQ-1		6107
ESTIMATED QUANTITIES - EARTHWORK, RAMPS, PERMANENT SIGNS	EQ-2		6108
ESTIMATED QUANTITIES - PAVEMENT MARKINGS, PERMANENT EROSION CONTROL	EQ-3		6109
ESTIMATED QUANTITIES - REMOVAL ITEMS	EQ-4		6110
<u>PLAN &amp; PROFILE SHEETS (3)</u>			
STA. TO STA. S.R. 32	3		6111
STA. TO STA. - LOCAL ROAD	3A		6112
STA. TO STA. - DITCH	3B		6113
<u>INTERSECTION DETAIL SHEETS (1)</u>			
INTERSECTION DETAIL STA. 77+44	ID-1		6114
<u>PAVEMENT MARKING SHEETS (2)</u>			
PAVEMENT MARKING DETAIL	PMD-1		6115
PAVEMENT MARKING DETAIL	PMD-2		6116
<u>SPECIAL DESIGN SHEETS (5)</u>			
BRIDGE END PAVEMENT WITH RAIL, OVERLAY, AND SLEEPER SLAB (NEW CONSTRUCTION)	SDBE-1		6201
VEGETATION SCHEDULE	VS-1		6202
STA. TO STA. S.R. 32	ECP3		6203
STA. TO STA. - LOCAL ROAD	ECP3A		6210
STA. TO STA. - DITCH	ECP3B		6211
<u>PERMANENT SIGNING SHEETS (1)</u>			
PERMANENT SIGNING PLAN	PSP-1		6215
			6218
			6221
			6125
			6126
			6131
			6201
			6202
			6203
			6210
			6211
			6215
			6218
			6221
			6125
			6126
			6131
			6201
			6202
			6203
			6210
			6211
			6215
			6218
			6221
			6125
			6126
			6131
			6201
			6202
			6203
			6210
			6211
			6215
			6218
			6221
			6125
			6126
			6131
			6201
			6202
			6203
			6210
			6211
			6215
			6218
			6221
			6125
			6126
			6131
			6201
			6202
			6203
			6210
			6211
			6215
			6218
			6221

MISSISSIPPI DEPARTMENT OF TRANSPORTATION

**DETAILED INDEX**

PROJ. NO.: BR-0006-01(091)  
 COUNTY: BOLIVAR

WORKING NUMBER: DI-1  
 SHEET NUMBER: 2

DATE: \_\_\_\_\_ FILENAME: INDEX.DGN  
 DESIGN TEAM: NEEL-SCHAFFER CHECKED: \_\_\_\_\_

NEEL-SCHAFFER

PS & E PLANS-DATE: 2-6-2018		
FMS CON. # 106111/301000		
REVISIONS		
DATE	SHEET NO.	BY
3-16-2019	6,7,23,24,25	DDM
3-30-2014	4,9,23	DDM

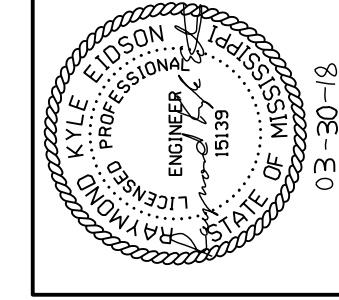



STATE	PROJECT NO.
MISS.	BR-0006-01(091)

GENERAL NOTES

GENERAL NOTES (CONT.)

- (1) THE LOCATION AND SPACING OF SIGNS, SHOWN ON THE TRAFFIC CONTROL PLANS, ARE APPROXIMATE AND MAY BE ADJUSTED AS NECESSARY TO FIT FIELD CONDITIONS.
- (2) ALL TRAFFIC CONTROL DEVICES ON THIS PROJECT SHALL COMPLY WITH PART VI OF THE **MUTCD** (LATEST EDITION).
- (3) ALL PLASTIC DRUMS SHALL HAVE A BALLASTING COLLAR MADE FROM RECYCLED TRUCK TIRES OR OTHER SUITABLE MATERIAL.
- (4) 25% SHRINKAGE FACTOR USED IN THE EARTHWORK CALCULATIONS IS FOR DESIGN ESTIMATING PURPOSES ONLY.
- (5) THE CONTRACTOR SHALL BE RESPONSIBLE FOR PROTECTING EXISTING STRUCTURES SUCH AS, BUT NOT LIMITED TO, PIPES, INLETS, APRONS, AND BRIDGES FROM DAMAGE WHICH MIGHT OCCUR DURING CONSTRUCTION. THE CONTRACTOR SHALL REPLACE OR REPAIR, AS DIRECTED BY THE ENGINEER, ANY STRUCTURES DAMAGED DURING THE LIFE OF THE CONTRACT. NO PAYMENT WILL BE MADE FOR REPLACEMENT OR REPAIR OF DAMAGED ITEMS.
- (6) ALL PIPE JOINTS ARE TO BE WRAPPED IN 24-INCH WIDE TYPE V GEOTEXTILE FABRIC. ALL PICKUP HOLES SHALL BE PLUGGED AND COVERED WITH TYPE V GEOTEXTILE FABRIC, THE COST OF WHICH SHALL BE ABSORBED IN OTHER ITEMS BID.
- (7) VOIDS CREATED BY THE REMOVAL OF, BUT NOT LIMITED TO, POSTS, CONCRETE ANCHORS, AND FOOTINGS SHALL BE BACKFILLED AND TAMPED IN ACCORDANCE WITH SECTION 203 OF **THE MISSISSIPPI STANDARD SPECIFICATIONS FOR ROAD AND BRIDGE CONSTRUCTION**, THE COST OF WHICH WILL BE ABSORBED IN OTHER ITEMS BID.
- (8) UTILITIES ON THE DRAWINGS ARE SHOWN IN THEIR ORIGINAL LOCATION BASED UPON THE BEST INFORMATION AVAILABLE TO THE ENGINEER. UTILITIES THAT WERE FOUND TO BE IN CONFLICT WITH CONSTRUCTION HAVE BEEN RELOCATED. PERMITS ARE ON FILE WITH THE DEPARTMENT SHOWING THE APPROXIMATE LOCATION OF UTILITIES RELOCATED WITHIN THE RIGHT-OF-WAY. THE ENGINEER CAN NOT AND DOES NOT WARRANT THAT THIS INFORMATION IS COMPLETE OR ACCURATE. THE CONTRACTOR MUST COORDINATE DIRECTLY WITH THE INVOLVED UTILITY OWNERS TO HAVE UNDERGROUND UTILITY LINES FIELD LOCATED IN ADVANCE OF CONSTRUCTION.
- (9) WORK ON STRUCTURES FOR THIS PROJECT REQUIRES EXCAVATION IN THE IMMEDIATE VICINITY OF TRAFFIC AND ADJACENT PROPERTIES. THEREFORE, THE RISK OF A FAILURE OCCURRING DURING EXCAVATION REQUIRES THAT EXTREME CAUTION BE EXERCISED. THE CONTRACTOR SHALL BE RESPONSIBLE FOR PLACING WHAT BRACING, SHORING, OR GROUND SUPPORT SYSTEM THAT IS DEEMED NECESSARY TO PREVENT A FAILURE AND PROTECT THE PERSONS WORKING NEAR THE EXCAVATION, THE PUBLIC THAT MAY BE ABOVE THE EXCAVATION, OR ANY STRUCTURES ADJACENT TO THE EXCAVATION. ALL COSTS FOR DESIGNING, DRAWING, AND CONSTRUCTING THE FACILITY SHALL BE INCLUDED IN THE PRICE BID FOR CONTRACT ITEMS.
- (10) SOME WORK IS REQUIRED OUTSIDE THE PROJECT LIMITS. NO ADDITIONAL COMPENSATION WILL BE MADE FOR SUCH WORK EXCEPT AS PROVIDED BY SPECIFIC PAY ITEMS INCLUDED IN THE PLANS.
- (11) WIRE FENCE BACKING WILL BE REQUIRED FOR ALL SILT FENCE. (SEE WK. NO. ECD-3)
- (12) FOR LIST OF PUBLIC UTILITIES, SEE WORKING NO. 3.
- (13) FLUORESCENT ORANGE SHEETING SHALL BE USED ON ALL CONSTRUCTION AND TRAFFIC CONTROL SIGNS EXCEPT FOR THOSE DESIGNATED ON THE PLANS TO BE BLACK LEGEND AND BORDER ON WHITE BACKGROUND.
- (14) VEGETATIVE MATERIAL WILL BE REMOVED PRIOR TO PLACEMENT OF CRUSHED STONE. THE COST OF WHICH SHALL BE ABSORBED IN OTHER ITEMS BID.

- (15) ALL DIMENSIONS AND SPACINGS FOR BRIDGE RAIL CONNECTORS SHALL BE VERIFIED IN THE FIELD BY THE CONTRACTOR PRIOR TO FABRICATION.
- (16) THE CONTRACTOR SHALL COVER ANY TEMPORARY TRAFFIC CONTROL SIGNS SHOWN IN THE TRAFFIC CONTROL PLAN THAT DO NOT APPLY TO THE CURRENT PHASE.
- (17) REMOVAL OF RAISED PAVEMENT MARKERS THAT ARE IN CONFLICT WITH REQUIRED CONSTRUCTION IS NOT CONSIDERED A SEPARATE PAY ITEM. COST TO BE ABSORBED IN OTHER ITEMS BID.
- (18) THE EROSION CONTROL PLAN SHEETS PROVIDED IN THE PLAN SET HAVE BEEN APPROVED AND ARE AVAILABLE FOR USE BY THE CONTRACTOR. THE STORMWATER POLLUTION PREVENTION PLAN (SWPPP) HAS ALSO BEEN APPROVED AND IS AVAILABLE FOR USE BY THE CONTRACTOR. A COPY OF THE SWPPP IS AVAILABLE THROUGH THE OFFICE ENGINEER PRIOR TO BIDDING. THE CONTRACTOR WILL BE THE NPDES PERMIT HOLDER FOR THIS PROJECT. TEMPORARY EROSION AND SEDIMENT CONTROL BMP'S INCLUDING SEDIMENT BARRIERS, DITCH CHECKS, AND SILT FENCE MAY BE REQUIRED IN ADDITION TO THOSE ON THE EROSION AND SEDIMENT CONTROL PLAN SHEETS, AS DIRECTED BY THE ENGINEER.
- (19) THE CONTRACTOR IS RESPONSIBLE FOR FIELD-VERIFICATION OF EXISTING GRADES AND MAKING ADJUSTMENTS AS NECESSARY WITH THE APPROVAL OF THE PROJECT ENGINEER.
- (20) TEMPORARY STRIPING SHALL CONFORM TO FINISHED STRIPE SPECIFICATIONS FOR ALIGNMENT, NEATNESS, AND STRAIGHTNESS.
- (21) ALL ITEMS OF WORK ASSOCIATED WITH THE INSTALLATION OF CONSTRUCTION ENTRANCES SHALL BE ABSORBED IN OTHER ITEMS OF WORK.
- (22) IF COLORS ARE USED ON PLAN/PROFILE SHEETS, THEY ARE INTENDED TO VISUALLY EASE THE LOCATION OF ELEMENTS FOR USERS OF THESE DRAWINGS. ALTHOUGH THE INTENT IS TO CATEGORIZE EVERYTHING AS EITHER EXISTING OR PROPOSED, IT IS THE END USER'S RESPONSIBILITY TO ENSURE ALL ELEMENTS ARE INTERPRETED CORRECTLY, REGARDLESS OF COLOR.
- (23) SEE BRIDGE PLANS FOR DETAILED INDEX SHEET(S), ESTIMATED AND SUMMARY OF QUANTITY SHEETS, AND EROSION CONTROL SHEETS.
- (24) ALL ADDENDA TO THESE PLANS WILL BE POSTED TO WWW.MDOT.MS.GOV UNDER THE PROPOSAL ADDENDA COLUMN. BIDDERS ARE ADVISED THAT HARD COPIES OF ANY ADDENDA FOR THIS PROJECT WILL NOT BE MAILED. IT IS THE BIDDER'S RESPONSIBILITY TO CHECK AND SEE IF ANY ADDENDA HAVE BEEN POSTED FOR THIS PROJECT.
- (25) THE COST FOR REMOVAL OF ALL HEADWALLS AND WINGWALLS (PIPES, BOX CULVERTS, BOX BRIDGES) SHALL BE ABSORBED IN OTHER ITEMS BID.
- (26) THE BRIDGE DECKS SHALL BE GROOVED AND ALL BRIDGE JOINTS SHALL BE SEALED PRIOR TO OPENING THE BRIDGES TO TRAFFIC.

3/30/18	REVISION	BY	DATE

**MISSISSIPPI DEPARTMENT OF TRANSPORTATION**

## GENERAL NOTES

PROJ. NO.: BR-0006-01(091)  
COUNTY: BOLIVAR

WORKING NUMBER  
**GN-1**  
SHEET NUMBER  
**4**

FILENAME: GN-1.DGN  
DESIGN: TEAMMEL-SCHAFFER CHECKED: \_\_\_\_\_ DATE: \_\_\_\_\_



**ADDENDUM**

STATE	MISS	PROJECT NO.	BR-0006-01(091)
-------	------	-------------	-----------------

<b>SUMMARY OF QUANTITIES (SHEET 1)</b>				
PAY ITEM NO.	PAY ITEM	UNIT	BOLIVAR : 106111-301000	
			Prelim	Final
201-A001	Clearing and Grubbing	LS	1	
202-A001	Removal of Obstructions	LS	1	
202-B007	Removal of Asphalt Pavement, All Depths	SY	29	
202-B191	Removal of Pipe, 8" And Above	LF	4	
202-B215	Removal of Sign Including Post & Footing	EA	8	
203-G002	Excess Excavation, LVM, AH	CY	714	
206-A001	Structure Excavation	CY	12	
209-A005	Geotextile Stabilization, Type V, Non-Woven	SY	7,926	
213-C001	Superphosphate	TON	1	
216-A001	Solid Sodding	SY	455	
217-A001	Ditch Liner	SY	100	
219-A001	Watering	KGAL	10	
220-A001	Insect Pest Control	ACRE	1	
221-A001	Concrete Paved Ditch	CY	3	
229-A001	Erosion Mat	SY	500	
234-A001	Temporary Silt Fence	LF	1,900	
235-A001	Temporary Erosion Checks	EA	150	
237-A002	Wattles, 20"	LF	150	
239-A001	Temporary Slope Drains	LF	60	
245-A001	Silt Dike	LF	150	
246-B002	Rockbags	LF	150	
249-A001	Riprap for Erosion Control	TON	150	
304-F001	3/4" and Down Crushed Stone Base	TON	5,800	
	OR			
304-F002	Size 610 Crushed Stone Base	TON	5,800	
	OR			
304-F003	Size 825B Crushed Stone Base	TON	5,800	
403-A003	12.5-mm, ST, Asphalt Pavement	TON	382	
403-A006	19-mm, ST, Asphalt Pavement	TON	473	
403-A015	9.5-mm, ST, Asphalt Pavement	TON	368	
407-A001	Asphalt for Tack Coat	GAL	354	
413-E001	Sawing and Sealing Transverse Joints in Asphalt Pavement	LF	68	
502-A001	Reinforced Cement Concrete Bridge End Pavement	SY	160	
503-C010	Saw Cut, Full Depth	LF	40	
601-B001	Class "B" Structural Concrete, Minor Structures	CY	1	
603-CA011	18" Reinforced Concrete Pipe, Class III	LF	24	
603-CB003	18" Reinforced Concrete End Section	EA	2	
605-AA001	Geotextile for Subsurface Drainage, Type III	SY	42	
605-O002	4" Perforated Sewer Pipe for Underdrains, SDR 23.5	LF	74	
605-P002	4" Non-perforated Sewer Pipe for Underdrains, SDR 23.5	LF	35	
605-W001	Filter Material for Combination Storm Drain and/or Underdrains, Type A, FM	CY	3	

- ① BRIDGE NO. 7.1 STA. 78+16.50 - STA. 78+91.50 (SPANS: 3@25')(CONCRETE DECK, TIMBER PILE) SEE GENERAL NOTES FOR ADDITIONAL REQUIREMENTS ESTIMATED QUANTITY, TO BE USED AS DIRECTED BY THE ENGINEER
- ② INCLUDES 2 CU. YDS. FOR PAVED FLUMES AND 1 CU. YD. FOR EDGE DRAIN OUTLET
- ③ FOR SOLID SOD
- ④ INCLUDES 20% INCREASE FROM CALCULATED QUANTITY
- ⑤ FOR PAVED FLUMES AND DITCH TREATMENT

DM	REVISION	DATE

**MISSISSIPPI DEPARTMENT OF TRANSPORTATION**  
**SUMMARY OF QUANTITIES**

Proj No: BR-0006-01(091)  
County: BOLIVAR

Design Team: Bolivar Br  
Checked: \_\_\_\_\_ Date: \_\_\_\_\_

Working Number: SQ-1  
Sheet Number: 9

**ADDENDUM**

FMS CON: 106111/301000

▲ REVISED EROSION CONTROL BLOCK  
 ▲ ADDED EROSION CONTROL ON SHEET

STATE PROJECT NO.  
 MISS. BR-0006-01(091)

REVISIONS

NO.	DATE	BY
1	5/16/18	DMV
2	5/30/18	DMV

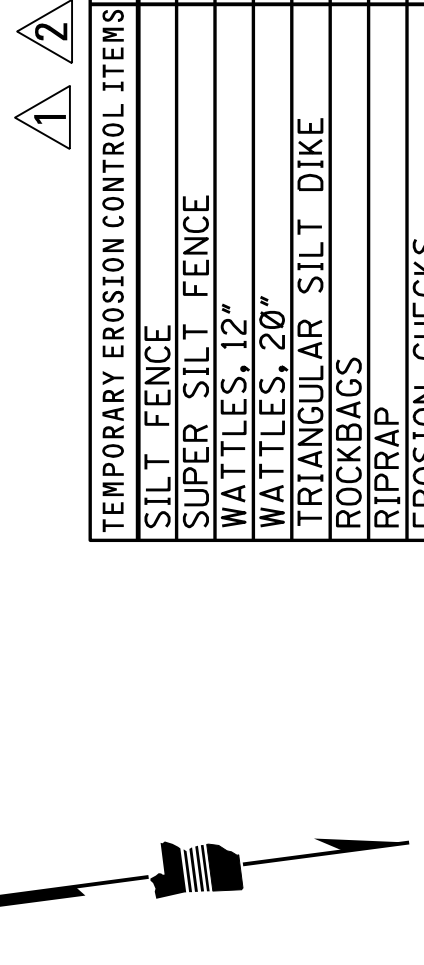
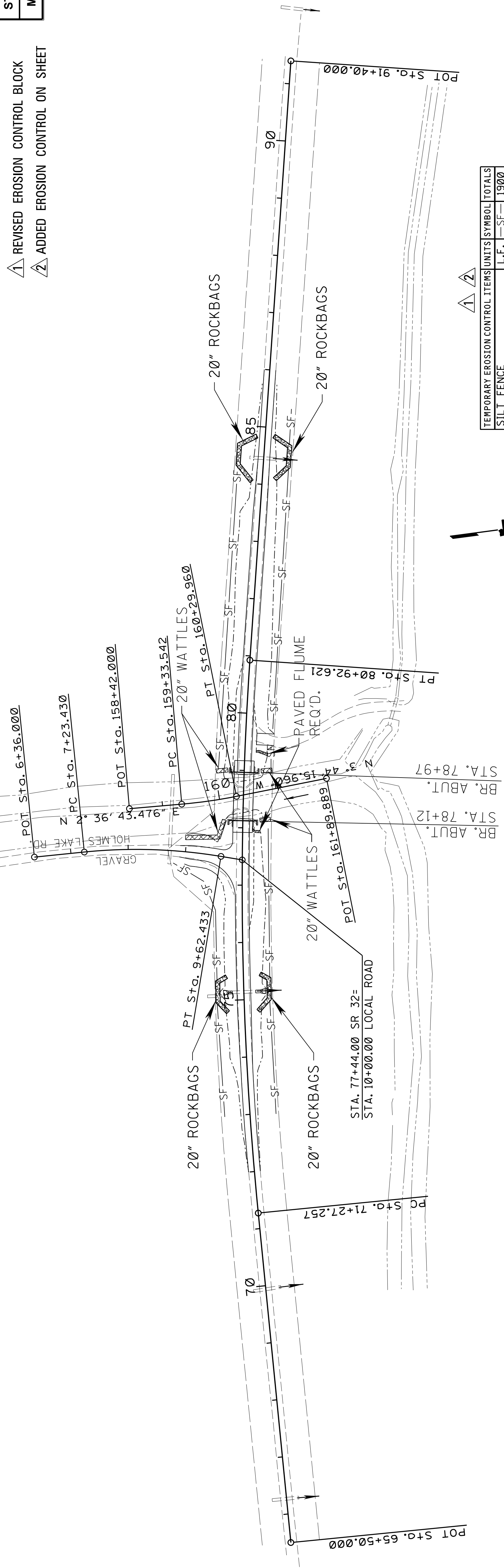

TEMPORARY EROSION CONTROL ITEMS	UNITS	SYMBOL	TOTALS
SILT FENCE	L.F.	SF	1900
SUPER SILT FENCE	L.F.	SSF	
WATTLES, 12"	L.F.	W	150
WATTLES, 20"	L.F.	W	150
TRIANGULAR SILT DIKE	L.F.	SD	150
ROCKBAGS	L.F.	R	150
RIPPRAP	TON	PR	
EROSION CHECKS	BALE	EC	
TYPE D SILT BASINS	EACH	EB	

BR. NO. 71  
 STA. 75+13  
 8 - 18" RCP REQ'D. LT. STA. 78+12  
 16 - 18" RCP REQ'D. RT. BRIDGE REQ'D.  
 2 - 18" FE-1 REQ'D. SPANS: 1@85'  
 2 - 18" PC-1 REQ'D. D.A. = 12.8 SQ. MI.  
 REMOVE 4" PIPE LT.  
 U.S. FL = 148.00  
 D.S. FL = 146.70

Station	Proposed Channel Shape (Elevation)	Ground Profile (Elevation)	Grade (%)
152.06			
151.94			
151.87			
151.82			
151.75			
151.68			
151.74			
151.81			
151.84			
151.84			
152.06			
152.12			
152.16			
152.25			
152.34			
152.44			
152.50			
152.45			
152.40			
152.46			
152.49			
152.49			
152.47			
152.49			
152.49			
152.47			
152.49			
152.47			
152.49			
152.49			
152.47			
152.58			
152.67			
134.19			
152.71			
152.71			
152.82			
152.61			
152.51			
152.39			
152.22			
152.01			
151.80			
151.59			
151.36			
151.07			
150.84			
150.65			
150.51			
150.46			
150.51			
150.51			
150.62			
150.78			
150.98			
151.27			
151.68			
151.97			
152.18			
152.50			
152.85			
153.04			

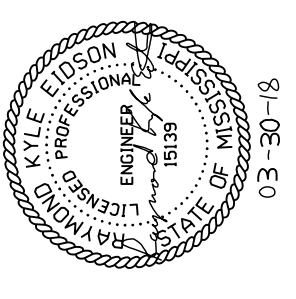

DESIGN TEAM: NEEL-SCHAFFER

FILENAME: WK3.DGN

COUNTY: BOLIVAR

PROJECT NO.: BR-0006-01(091)

SHEET ID: S.R. 32

23