

STATE	PROJECT NUMBER	SHEET NO.
MISSISSIPPI	STP-0389-00(001)	1

GENERAL INDEX

INCLUDED THIS PROJECT	BEGIN WITH SHEET
<input checked="" type="checkbox"/> ROADWAY	1
<input type="checkbox"/> PERMANENT SIGNS	1001
<input type="checkbox"/> TRAFFIC SIGNALS	2001
<input type="checkbox"/> ITS COMPONENTS	3001
<input type="checkbox"/> LIGHTING	4001
<input type="checkbox"/> (RESERVED)	5001
<input checked="" type="checkbox"/> ROADWAY STANDARD DWGS	6001
<input type="checkbox"/> BOX CULVERT STD. DRAWINGS (LRFD)	7001
<input type="checkbox"/> BOX CULVERT STD. DRAWINGS (STD. SPEC.)	7501
<input type="checkbox"/> BRIDGE	8001
<input checked="" type="checkbox"/> CROSS SECTIONS	9001

STATE OF MISSISSIPPI

MISSISSIPPI DEPARTMENT OF TRANSPORTATION

PLAN AND PROFILE OF PROPOSED STATE HIGHWAY FEDERAL PROJECT NO. STP-0389-00(001)

SR 43 SLIDE REPAIR SIMPSON COUNTY

FMS. CONST. NO. 107370 / 301000

SCALES

PLAN	1 IN. = 100 FT.
PROFILE	HOR. 1 IN. = 100 FT.
	VERT. 1 IN. = 10 FT.
LAYOUT	1 IN. = 2123 FT.

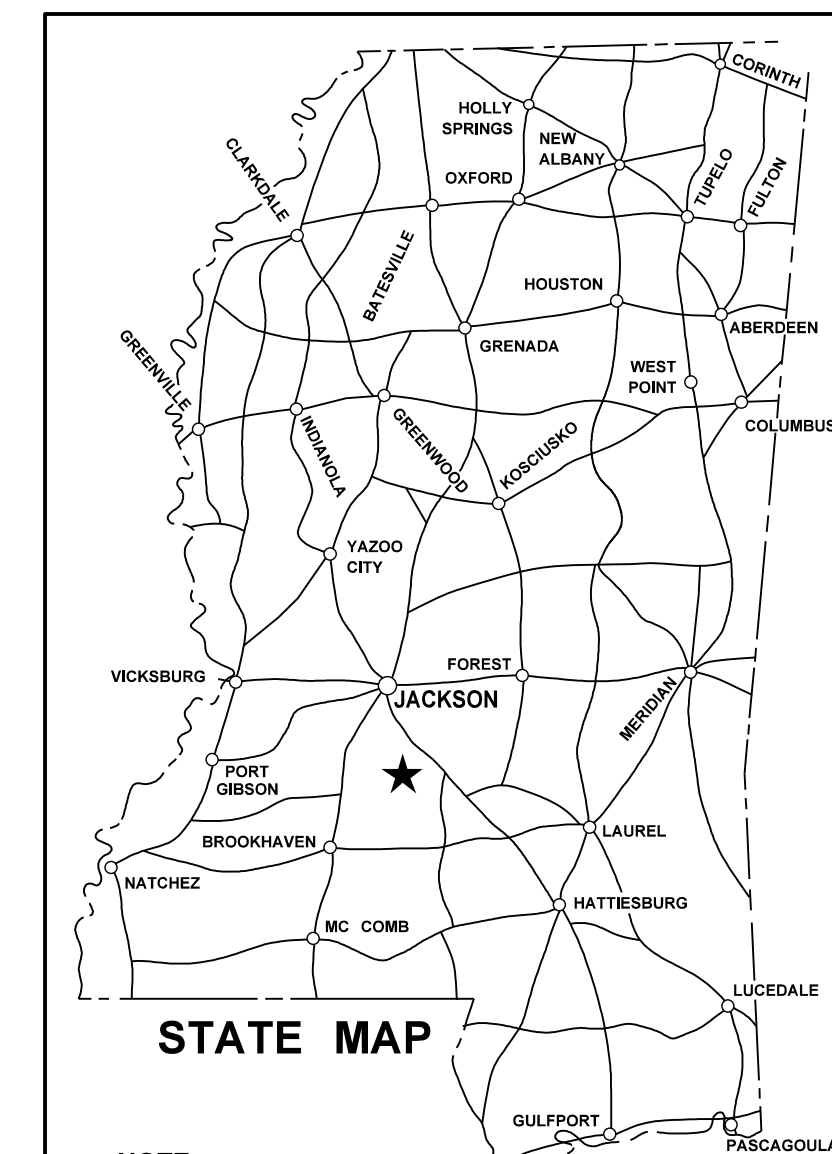

NOTE
★ INDICATES APPROXIMATE LOCATION OF PROJECT.
LAT. 31°51'24.46"N LONG. 89°57'20.66"W
(APPROX. MIDDLE OF PROJECT)

BRIDGE STRUCTURES REQ'D.
NONE

BOX BRIDGES REQ'D.
NONE

B.O.P STA. 483 + 00

E.O.P. STA. 492 + 00

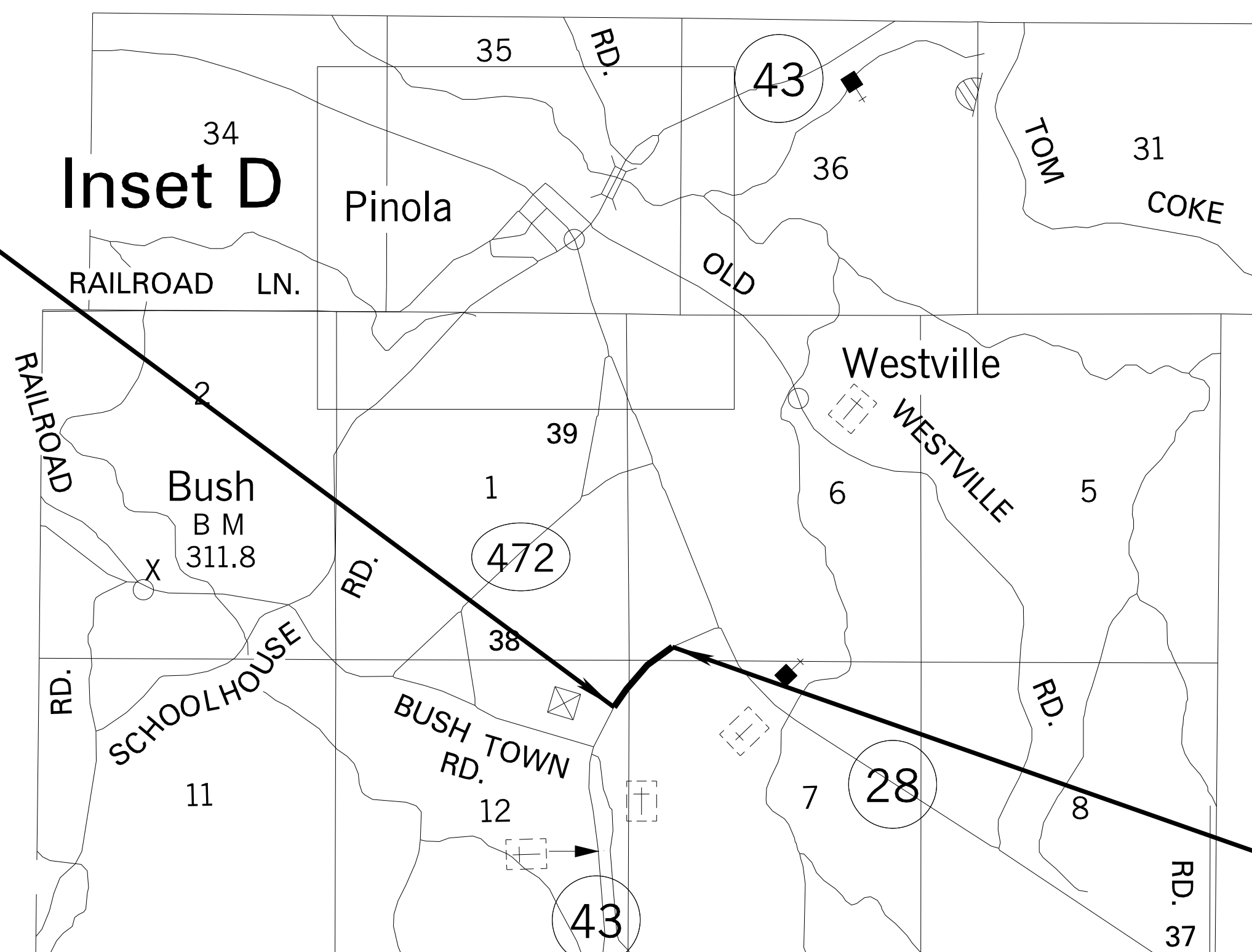

EQUATIONS
NONE

EXCEPTIONS
NONE

LENGTH DATA

LENGTH OF ROADWAY	900.00 FT.	0.170 MI.
LENGTH OF BRIDGES	0.00 FT.	0.000 MI.
LENGTH OF PROJECT (NET)	900.00 FT.	0.170 MI.
LENGTH OF EXCEPTIONS	0.00 FT.	0.000 MI.
LENGTH OF PROJECT (GROSS)	900.00 FT.	0.170 MI.

CONVENTIONAL SYMBOLS

COUNTY LINE	-----
TOWN CORPORATION LINE	-----
SECTION LINE	-----
EXISTING ROAD OR TRAVELED WAY	-----
PROPOSED ROAD OR TRAVELED WAY	-----
RAILROAD	-----
SURVEY LINE	-----
BRIDGES	-----

DESIGN CONTROL

55 MPH = V (SPEED DESIGN)
ADT (2022) = 1400 : ADT (2042) = 1800
DHV = 220 : D = 60 % T = 16 %

PERMITS ACQUIRED BY MDOT

WETLANDS AND WATERS PERMITS		
	WATERS	WETLANDS
NATIONWIDE #14	<input type="checkbox"/>	<input type="checkbox"/>
NATIONWIDE (OTHER)*	<input type="checkbox"/>	<input type="checkbox"/>
GENERAL*	<input type="checkbox"/>	<input type="checkbox"/>
INDIVIDUAL (404)*	<input type="checkbox"/>	<input type="checkbox"/>
STORMWATER PERMIT <input checked="" type="checkbox"/>		
Y	REQUIRED, CNOI SUBMITTED BY MDOT (DISTURBED AREA = 5 ACRES)	
S	REQUIRED, SCNOI TO BE SUBMITTED BY CONTRACTOR (1 TO 4.99 ACRES)	
N	NO STORMWATER PERMIT REQUIRED (<1 ACRE)	
APPROVED BY: _____		

P S & E DATE: 3-21-2018

APPROVED:
DEPUTY EXECUTIVE DIRECTOR / CHIEF ENGINEER
EXECUTIVE DIRECTOR



3/21/2018 1:34:45 (01) SRV-TITLE-001.DGN

1st O.REV.

STATE	PROJECT NO.
MISS.	STP-0389-00(001)

DESCRIPTION OF SHEET	WKG. NO.	SH. NO.	DESCRIPTION OF SHEET	WKG. NO.	SH. NO.
TITLE SHEET (1)		1	STANDARD DRAWINGS - ROADWAY SHEETS (43)		
DETAILED INDEX & GENERAL NOTES (2)			PAVEMENT MARKING DETAILS FOR 2-LANE & 4-LANE DIVIDED ROADWAYS	PM-1	6051
DETAILED INDEX	DI-1	2	TYPICAL TEMPORARY EROSION SEDIMENT CONTROL/SEDIMENT CONTROL APPLICATIONS	ECD-1	6101
GENERAL NOTES	GN-1	3	DETAILS OF SEDIMENT BARRIER APPLICATIONS	ECD-2	6102
			DETAILS OF SILT FENCE INSTALLATION	ECD-3	6103
TYPICAL SECTION SHEETS (1)			DITCH CHECK STRUCTURES, TYPICAL APPLICATIONS AND DETAILS	ECD-4	6104
TYPICAL SECTION - MAINLINE NEW CONSTRUCTION & MILLING & OVERLAY	TS-1	4	TEMPORARY EROSION, SEDIMENT, AND WATER POLLUTION CONTROL MEASURES (SILT FENCE AND HAY BALE DITCH CHECKS)	ECD-5	6105
			DETAILS OF EROSION CONTROL WATTLE DITCH CHECK	ECD-6	6106
			DETAILS OF EROSION CONTROL SILT DIKE DITCH CHECK	ECD-7	6107
			ROCK DITCH CHECK	ECD-8	6108
			ROCK FILTER DAM	ECD-9	6109
			ROCK DITCH CHECK WITH SLUMP EXCAVATION AND ROCK FILTER DAM	ECD-10	6110
			TYPICAL APPLICATIONS AND DETAILS FOR INLET CONSTRUCTION	ECD-11	6111
			INLET PROTECTION DETAILS FOR SEDIMENT CONTROL STONE ON GRADES AND SAGS	ECD-12	6112
QUANTITY SHEETS (4)			INLET PROTECTION DETAILS OF WATTLES	ECD-13	6113
SUMMARY OF QUANTITIES	SQ-1	5	INLET PROTECTION DETAILS OF MANUFACTURED INLET PROTECTION DEVICE	ECD-14	6114
SUMMARY OF QUANTITIES	SQ-2	6	INLET PROTECTION DETAILS OF SANDBAGS	ECD-15	6115
ESTIMATED QUANTITIES - REMOVAL ITEMS, DRAINAGE ITEMS & TRAFFIC CONTROL ITEMS	EQ-1	7	STABILIZED CONSTRUCTION ENTRANCE	ECD-16	6116
ESTIMATED QUANTITIES FOR TRAFFIC CONTROL SIGNS	EQ-2	8	TEMPORARY CULVERT STREAM CROSSING	ECD-17	6117
			TEMPORARY STREAM DIVERSION	ECD-18	6118
			TEMPORARY STREAM DIVERSION (BOX EXTENSION)	ECD-19	6119
PLAN & PROFILE SHEETS (1)			FLOATING TURBIDITY CURTAIN	ECD-20	6120
STA. 483+50 TO STA. 489+50	3	9	DETAILS OF EROSION CONTROL SANDBAG DITCH CHECK	ECD-21	6121
			SEDIMENT RETENTION BARRIER	ECD-22	6122
			DETAILS OF TYPICAL DITCH TREATMENTS	DT-1	6123
SPECIAL DESIGN SHEETS - ROADWAY AND GEOTECH DRAWINGS (20)			TYPICAL TEMPORARY EROSION CONTROL MEASURES (SLOPE DRAIN AND TYPE A SILT BASIN)	BAS-A	6125
CONSTRUCTION SEQUENCE STA. 483+50 TO 489+50	SC-1	10	TYPICAL TEMPORARY EROSION CONTROL MEASURES (TYPE B SILT BASIN)	BAS-B	6126
EXCAVATION TYPICAL SECTION STA. 483+50 TO 489+50	SC-3	11	GUARDRAIL: "W" BEAM (WOOD POSTS)	GR-1	6201
FINISHED GRADE TYPICAL SECTION STA. 483+50 TO 489+50	SC-4	12	GUARDRAIL: THRIE BEAM (WOOD POSTS)	GR-1A	6202
EXCAVATION PLAN AND PROFILE STA. 483+50 TO 489+50	SC-5	13	GUARDRAIL: "W" BEAM (STEEL POSTS)	GR-1B	6203
FINISHED GRADE PLAN AND PROFILE STA. 483+50 TO 489+50	SC-6	14	GUARDRAIL: MISCELLANEOUS HARDWARE	GR-HW	6221
SURFACE DRAINAGE & EARTHWORK DETAILS STA. 483+50 TO 489+50	SC-7	15	CONCRETE MEDIAN BARRIER (PRECAST) (32")	CMB-3	6226
SURFACE DRAINAGE & EARTHWORK DETAILS STA. 483+50 TO 489+50	SC-8	16	HIGHWAY SIGN AND BARRICADE DETAILS FOR CONSTRUCTION PROJECTS	TCP-8	6358
GENERALIZED SOIL PROFILE (1 OF 2) STA. 483+50 TO 489+50	SC-17	17	RIGHT-OF-WAY MARKER	RW-1	6401
GENERALIZED SOIL PROFILE (2 OF 2) STA. 483+50 TO 489+50	SC-18	18	RURAL DRIVEWAYS	RD-1	6403
BORING LOGS (1 OF 2) STA. 483+50 TO 489+50	SC-19	19	TYPICAL GRADING TRANSITION BETWEEN CUTS & FILLS	GT-1	6404
BORING LOGS (1 OF 2) STA. 483+50 TO 489+50	SC-20	20	MISCELLANEOUS DETAIL SHEET 1, STACKED PIPE JOINT	MDS-1	6425
VEGETATION SCHEDULE	VS-1	21	2, EXCAVATION AT GRADE POINTS.		
SURVEY CONTROL DATA SHEET	SRV-1	22	PIPE CULVERT INSTALLATION	PI-1	6501
DRIVEWAY DETAIL SHEET	DDS-1	23	CONCRETE PIPE COLLAR	PC-1	6503
TRAFFIC CONTROL - DETAIL OF CONSTRUCTION SIGNING	DCS-1	24	DROP INLET AND GRATE DETAIL FOR PIPE AND BOX CULVERTS	B-9	6527
TRAFFIC CONTROL - DETOUR DETAIL	DET-1	25	STORM SEWER STRUCTURE, PRECAST MANHOLE	MH-1	6528
TRAFFIC CONTROL - DETOUR DETAIL	DET-2	26	FLARED END SECTION FOR CONCRETE PIPE	FE-1	6530
TRAFFIC CONTROL - DETOUR DETAIL	DET-3	27	DETAILS OF NORMAL UNDERDRAIN AND STROM DRAIN USED AS UNDERDRAIN	UD-1	6533
EROSION CONTROL PLAN	ECP-3	28	NORMAL UNDERDRAIN TYPE II	UD-2	6534
GUARDRAIL: TYPICAL INSTALLATION FOR ROADSIDE HAZZARDS ON 2-LANE, 2-WAY HIGHWAYS	GR-4C-MOD	29			

CROSS SECTIONS (17)

MAINLINE (S.R. 43) - STA. 483+00.00 TO STA. 492+00.00

9001-9017

TOTAL SHEETS = 89

GILLIAM

PS & E PLANS-DATE: 3/21/18		
FMS CON. # 107370/301000		
REVISIONS		
DATE	SHEET NO.	BY
4-9-18	3,4,5,6,7,19,20,21	RCG
4-13-18	19,20	RCG

REVISION	MISSISSIPPI DEPARTMENT OF TRANSPORTATION
	DETAIL INDEX
	S.R. 43
	PROJ. NO.: STP-0389-00(001)
DATE	WORKING NUMBER
DESIGN TEAM GILLIAM	DI-1
CHECKED	SHEET NUMBER
DATE 3/21/18	2



4/13/2018 08:16:57 (02) RWD-DI.DGN MISSISSIPPI DEPARTMENT OF TRANSPORTATION

1st O.REV.

STATE	PROJECT NO.
MISS.	STP-0389-00(001)

GENERAL NOTES

- (1) THE LOCATION AND SPACING OF SIGNS, SHOWN ON THE TRAFFIC CONTROL PLANS, ARE APPROXIMATE AND MAY BE ADJUSTED AS NECESSARY TO FIT FIELD CONDITIONS.
- (2) ALL TRAFFIC CONTROL DEVICES ON THIS PROJECT SHALL COMPLY WITH PART VI OF THE MUTCD (LATEST EDITION).
- (3) ALL PLASTIC DRUMS SHALL HAVE A BALLASTING COLLAR MADE FROM RECYCLED TRUCK TIRES OR OTHER SUITABLE MATERIAL.
- (4) 25% SHRINKAGE FACTOR USED IN THE EARTHWORK CALCULATIONS IS FOR DESIGN ESTIMATING PURPOSES ONLY.
- (5) THE CONTRACTOR SHALL BE RESPONSIBLE FOR PROTECTING EXISTING STRUCTURES SUCH AS, BUT NOT LIMITED TO, PIPES, INLETS, APRONS, AND BRIDGES FROM DAMAGE WHICH MIGHT OCCUR DURING CONSTRUCTION. THE CONTRACTOR SHALL REPLACE OR REPAIR, AS DIRECTED BY THE ENGINEER, ANY STRUCTURES DAMAGED DURING THE LIFE OF THE CONTRACT. NO PAYMENT WILL BE MADE FOR REPLACEMENT OR REPAIR OF DAMAGED ITEMS.
- (6) ALL PIPE JOINTS ARE TO BE WRAPPED IN 24-INCH WIDE TYPE V GEOTEXTILE FABRIC. ALL PICKUP HOLES SHALL BE PLUGGED AND COVERED WITH TYPE V GEOTEXTILE FABRIC, THE COST OF WHICH SHALL BE ABSORBED IN OTHER ITEMS BID.
- (7) UTILITIES ON THE DRAWINGS ARE SHOWN IN THEIR ORIGINAL LOCATION BASED UPON THE BEST INFORMATION AVAILABLE TO THE ENGINEER. UTILITIES THAT WERE FOUND TO BE IN CONFLICT WITH CONSTRUCTION HAVE BEEN RELOCATED. PERMITS ARE ON FILE WITH THE DEPARTMENT SHOWING THE APPROXIMATE LOCATION OF UTILITIES RELOCATED WITHIN THE RIGHT-OF-WAY. THE ENGINEER CAN NOT AND DOES NOT WARRANT THAT THIS INFORMATION IS COMPLETE OR ACCURATE. THE CONTRACTOR MUST COORDINATE DIRECTLY WITH THE INVOLVED UTILITY OWNERS TO HAVE UNDERGROUND UTILITY LINES FIELD LOCATED IN ADVANCE OF CONSTRUCTION.
- (8) WORK ON STRUCTURES FOR THIS PROJECT REQUIRES EXCAVATION IN THE IMMEDIATE VICINITY OF TRAFFIC AND ADJACENT PROPERTIES. THEREFORE, THE RISK OF A FAILURE OCCURRING DURING EXCAVATION REQUIRES THAT EXTREME CAUTION BE EXERCISED. THE CONTRACTOR SHALL BE RESPONSIBLE FOR PLACING WHAT BRACING, SHORING, OR GROUND SUPPORT SYSTEM THAT IS DEEMED NECESSARY TO PREVENT A FAILURE AND PROTECT THE PERSONS WORKING NEAR THE EXCAVATION, THE PUBLIC THAT MAY BE ABOVE THE EXCAVATION, OR ANY STRUCTURES ADJACENT TO THE EXCAVATION. ALL COSTS FOR DESIGNING, DRAWING, AND CONSTRUCTING THE FACILITY SHALL BE INCLUDED IN THE PRICE BID FOR CONTRACT ITEMS.
- (9) WIRE FENCE BACKING WILL BE REQUIRED FOR ALL SILT FENCE. (SEE WK. NO. ECD-3)
- (10) FOR LIST OF PUBLIC UTILITIES, SEE WORKING NO. 3.
- (11) FLUORESCENT ORANGE SHEETING SHALL BE USED ON ALL CONSTRUCTION AND TRAFFIC CONTROL SIGNS EXCEPT FOR THOSE DESIGNATED ON THE PLANS TO BE BLACK LEGEND AND BORDER ON WHITE BACKGROUND.
- (12) THE COST OF ANY COLLARS REQUIRED TO CONNECT CONCRETE FLARED END SECTIONS TO NON-CONCRETE PIPE SECTIONS SHALL BE ABSORBED IN THE COST FOR NON-CONCRETE PIPE.
- (13) THE CONTRACTOR SHALL COVER ANY TEMPORARY TRAFFIC CONTROL SIGNS SHOWN IN THE TRAFFIC CONTROL PLAN THAT DO NOT APPLY TO THE CURRENT PHASE.
- (14) THE EROSION CONTROL DEVICES REFERENCED IN THESE PLANS ARE A MINIMUM REQUIREMENT. IT IS THE RESPONSIBILITY OF THE CONTRACTOR TO ENSURE THAT SILT DOES NOT LEAVE THE RIGHT OF WAY OR CONTAMINATE WATERS OF THE U. S. DURING CONSTRUCTION. THE CONTRACTOR SHALL SUBMIT AN EROSION CONTROL PLAN PRIOR TO COMMENCEMENT OF WORK AND MAINTAIN THE PLAN DURING CONSTRUCTION. ANY ADDITIONAL SILT BASINS NOT SHOWN IN THE PLANS SHALL BE INCLUDED IN THE CONTRACTOR'S EROSION CONTROL PLAN PRIOR TO SUBMITTING FOR APPROVAL.
- (15) ALL ITEMS OF WORK ASSOCIATED WITH THE INSTALLATION OF A CONSTRUCTION ENTRANCE SHALL BE ABSORBED IN OTHER ITEMS OF WORK.
- (16) IF COLORS ARE USED ON PLAN/PROFILE SHEETS, THEY ARE INTENDED TO VISUALLY EASE THE LOCATION OF ELEMENTS FOR USERS OF THESE DRAWINGS. ALTHOUGH THE INTENT IS TO CATEGORIZE EVERYTHING AS EITHER EXISTING OR PROPOSED, IT IS THE END USER'S RESPONSIBILITY TO ENSURE ALL ELEMENTS ARE INTERPRETED CORRECTLY, REGARDLESS OF COLOR.
- (17) ALL ADDENDA TO THESE PLANS WILL BE POSTED TO WWW.MDOT.MS.GOV UNDER THE PROPOSAL ADDENDA COLUMN. BIDDERS ARE ADVISED THAT HARD COPIES OF ANY ADDENDA FOR THIS PROJECT WILL NOT BE MAILED. IT IS THE BIDDER'S RESPONSIBILITY TO CHECK AND SEE IF ANY ADDENDA HAVE BEEN POSTED FOR THIS PROJECT.
- (18) THE COST FOR REMOVAL OF ALL HEADWALLS AND WINGWALLS (PIPES, BOX CULVERTS, BOX BRIDGES) SHALL BE ABSORBED IN OTHER ITEMS BID.
- (19) THE CONTRACTOR SHALL BE RESPONSIBLE FOR MAINTAINING AND RELOCATING MAIL BOXES AS NECESSARY TO MAINTAIN CONTINUOUS MAIL SERVICE THROUGHOUT THE LIFE OF THE PROJECT, THE COST OF WHICH SHALL BE ABSORBED IN OTHER ITEMS BID.
- (20) STORAGE OF FLAMMABLE MATERIALS WILL NOT BE ALLOWED UNDER ANY BRIDGE STRUCTURES.
- (21) INSTALLATION DATES SHALL BE CLEARLY WRITTEN IN BOLD BLACK MARKINGS ON THE BACK BOTTOM HALF OF ALL SIGNS WITH A PERMANENT MARKING STICK THAT IS WATERPROOF, FADE RESISTANT AND MARKS ON WET OR DRY SURFACES.
- (22) ALL POST, PIPE, AND I-BEAM LENGTHS IN THESE PLANS ARE ESTIMATES. POST LENGTHS FOR ALL SIGNS SHALL BE VERIFIED IN THE FIELD BY THE CONTRACTOR PRIOR TO FABRICATION.
- (23) ALL EXISTING SIGNS WHICH ARE TO BE REMOVED AS A PART OF THIS PROJECT THAT ARE NOT IN CONFLICT WITH CONSTRUCTION SHALL REMAIN IN PLACE UNTIL NEW SIGNS ARE INSTALLED UNLESS NOTED OR DIRECTED OTHERWISE BY THE PROJECT ENGINEER. ROADWAY SIGNS THAT ARE IN CONFLICT WITH CONSTRUCTION SHALL BE REMOVED AND RELOCATED BY THE CONTRACTOR AS DIRECTED BY THE ENGINEER, THE COST OF WHICH SHALL BE ABSORBED IN OTHER ITEMS BID.
- (24) ALL EXISTING SIGNS AND SUPPORTS REMOVED UNDER THIS PROJECT SHALL BECOME THE PROPERTY OF THE CONTRACTOR AND ARE NOT A SEPARATE PAY ITEM.
- (25) DIRECT-APPLIED LEGEND, BORDER, AND/OR SHIELDS ARE TO BE USED ON ALL GUIDE SIGNS. DIGITALLY PRODUCED SIGN COPY, SHIELDS, LEGEND, SYMBOLS, OR IMAGES WILL NOT BE ALLOWED WITHOUT WRITTEN APPROVAL FROM MDOT'S PROJECT ENGINEER.
- (26) AFTER THE PERMANENT SIGNS HAVE BEEN INSTALLED, THE CONTRACTOR SHALL SUBMIT TO THE PROJECT ENGINEER A DIGITAL COPY OF A MICROSOFT EXCEL SPREADSHEET WITH THE FOLLOWING INVENTORY DATA CAPTURED FOR EACH SIGN: LOCATION OF SIGN (LATITUDE-LONGITUDE GPS COORDINATES), MUTCD SIGN CODE, SIZE, BACKGROUND AND LEGEND COLORS, SUPPORT TYPE (POST, PIPE, SQUARE POST, OR I-BEAM), NUMBER OF SUPPORTS, DATE OF INSTALLATION, SIGN FACE DIRECTION, ROUTE NAME OR NUMBER, DIRECTION OF VEHICLE TRAVEL, AND LEGEND ON SIGN IF APPLICABLE. EACH SIGN SHALL BE ASSIGNED A UNIQUE ID NUMBER AND A DIGITAL PHOTO OF EACH SIGN SHALL BE SUBMITTED IN BITMAP FORMAT. THE PHOTO FILENAME SHALL CORRESPOND WITH THE UNIQUE ID NUMBER.
- (27) THE CONTRACTOR SHALL BE RESPONSIBLE FOR PROVIDING ACCESS TO THE PROPERTY OWNER AT STATION 485+50 THROUGHOUT THE PROJECT'S DURATION. THE COST OF PROVIDING THIS ACCESS WILL BE ABSORBED IN OTHER ITEMS BID.
- (28) ASPHALT WILL BE REQUIRED UNDER ALL GUARDRAIL AS SHOWN ON GR-4C-MOD.
- (29) THE THICKNESS OF ASPHALT FROM STATION 484+00 TO STATION 489+50 VARIES BETWEEN 10 INCHES AND 36 INCHES. THE REMOVAL OF ASPHALT WILL BE PAID BY PAY ITEM 202-B007 (REMOVAL OF ASPHALT PAVEMENT, ALL DEPTHS).
- (30) GRANULAR MATERIAL WILL NOT BE ALLOWED TO BE PLACED DIRECTLY ON THE SURFACE LIFT OF ASPHALT, BUT IT MUST BE PLACED DIRECTLY ON THE GRAVEL SHOULDER OR BY A ROAD WIDENER MACHINE USED AND APPROVED BY THE PROJECT ENGINEER.
- (31) WHERE MILLING IS REQUIRED, THE CONTRACTOR SHALL PROVIDE OUTLETS IN THE EXISTING SHOULDERS AT SUFFICIENT INTERVALS TO PREVENT POOLING OR STANDING WATER ON THE MILLED SURFACE, THE COST OF WHICH SHALL BE ABSORBED IN OTHER ITEMS BID.
- (32) TEMPORARY STRIPING SHALL CONFORM TO FINISHED STRIPE SPECIFICATIONS FOR ALIGNMENT, NEATNESS, AND STRAIGHTNESS.



4/19/2018 08:02:57 (03) RWD-GN.DGN

RCG BY		MISSISSIPPI DEPARTMENT OF TRANSPORTATION	
REVISION		GENERAL NOTES	
DATE		S.R. 43	
4-9-18		PROJ. NO.: STP-0389-00(001)	
REMOVED NOTE		COUNTY: SIMPSON	
DATE		WORKING NUMBER	
4-9-18		GN-1	
FILENAME: RWD-GN		SHEET NUMBER	
DESIGN TEAM GILLIAM		3	
CHECKED		DATE 3/21/18	

