

STATE	PROJECT NUMBER	SHEET NO.
MISSISSIPPI	MP-1006-48(006)	1

**GENERAL INDEX**

INCLUDED THIS PROJECT	BEGIN WITH SHEET
<input checked="" type="checkbox"/> ROADWAY .....	1
<input type="checkbox"/> PERMANENT SIGNS .....	1001
<input type="checkbox"/> TRAFFIC SIGNALS .....	2001
<input type="checkbox"/> ITS COMPONENTS .....	3001
<input type="checkbox"/> LIGHTING .....	4001
<input type="checkbox"/> (RESERVED) .....	5001
<input checked="" type="checkbox"/> ROADWAY STANDARD DWGS .....	6001
<input type="checkbox"/> BOX CULVERT STD. DRAWINGS (LRFD) .....	7001
<input type="checkbox"/> BOX CULVERT STD. DRAWINGS (STD. SPEC.) .....	7501
<input type="checkbox"/> BRIDGE .....	8001
<input type="checkbox"/> CROSS SECTIONS .....	9001

**BRIDGE STRUCTURES REQ'D.**  
**NONE**

**BOX BRIDGES REQ'D.**  
**NONE**

**B.O.P. 10+00**

**E.O.P. 553+20**

**STATE OF MISSISSIPPI**

**MISSISSIPPI DEPARTMENT OF TRANSPORTATION**

**PLAN AND PROFILE OF PROPOSED STATE HIGHWAY STATE PROJECT NO. MP-1006-48(006)**

**SR 6 FROM SR 145 IN NETTLETON TO SR 25 IN AMORY MONROE CO**

**FMS CON. NO. 306454/301000**

**SCALES**

PLAN	1 IN. = 100 FT.
PROFILE	HOR. 1 IN. = 100 FT.
	VERT. 1 IN. = 10 FT.
LAYOUT	1 IN. = 500 FT.

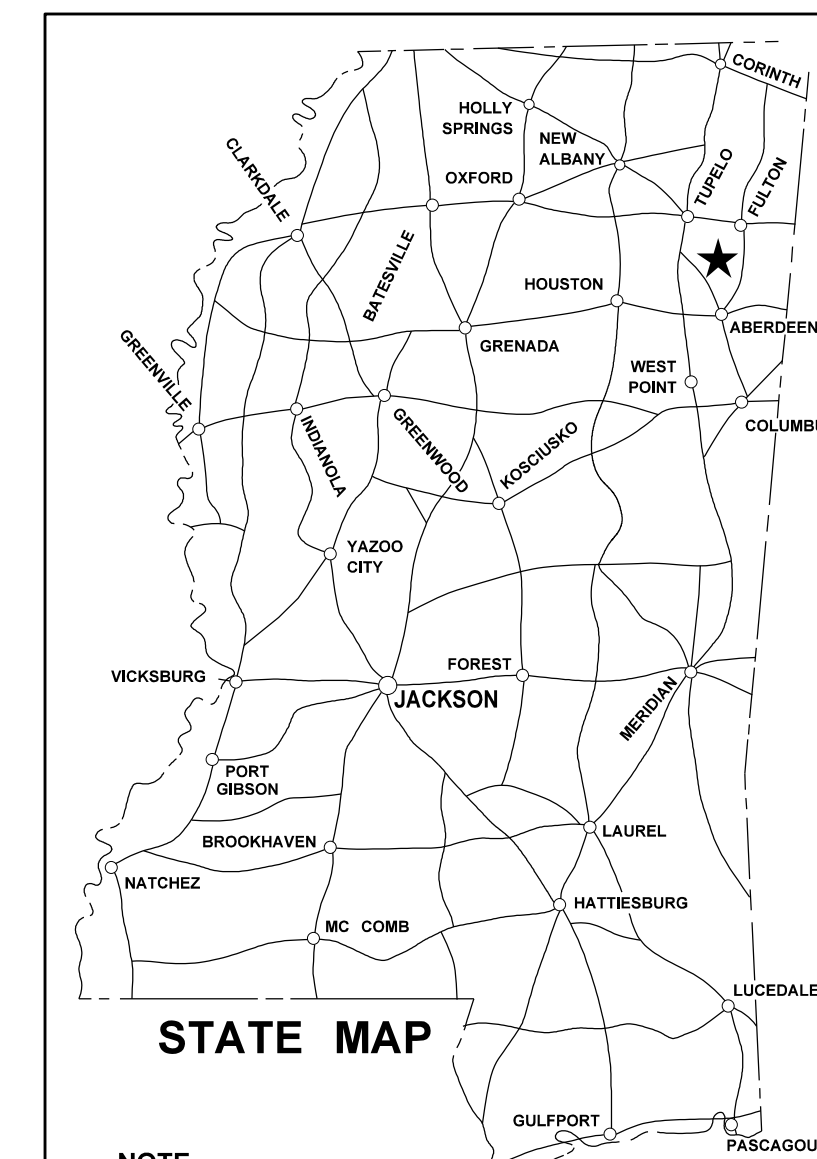
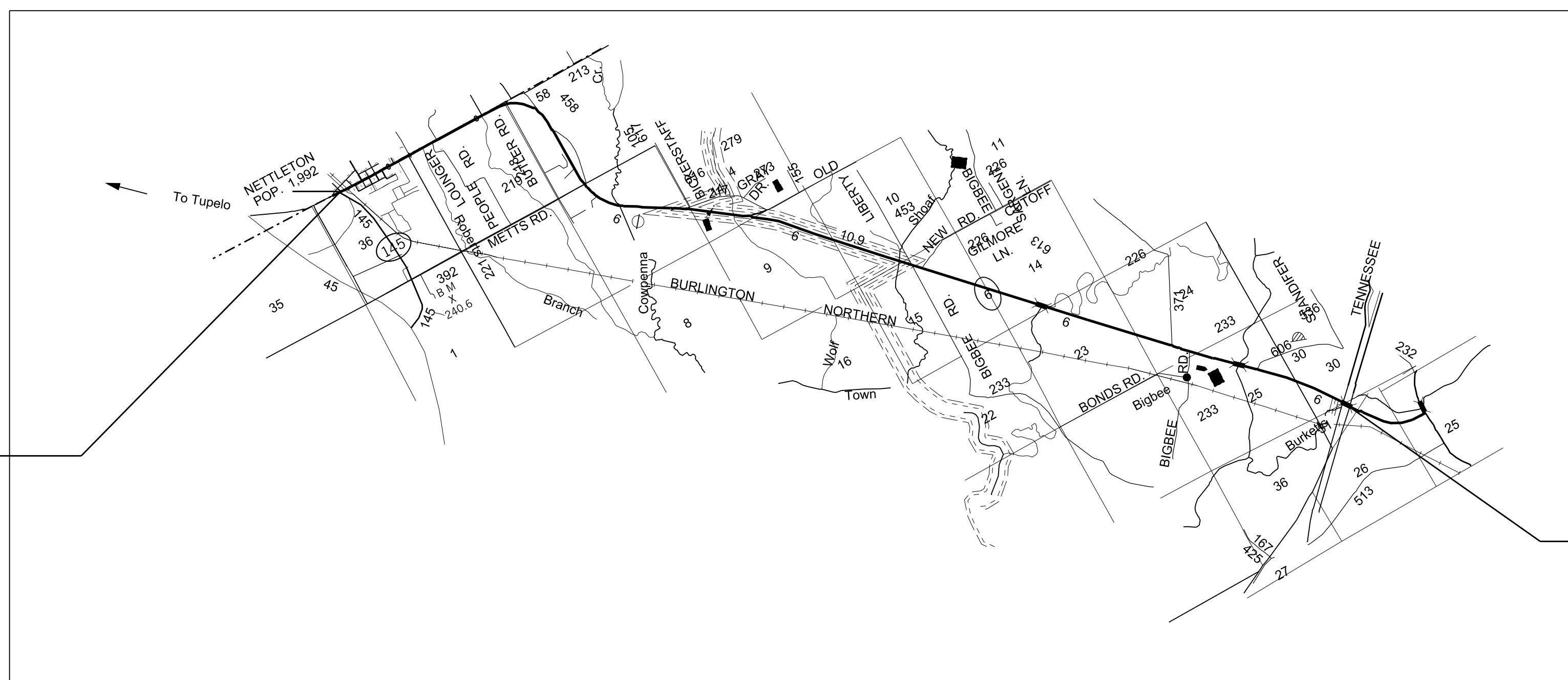

**STATE MAP**

NOTE  
★ INDICATES APPROXIMATE LOCATION OF PROJECT.

LAT. 34° 03' 13" N  
LONG. 88° 33' 45" W  
(APPROX. MIDDLE OF PROJECT)

**DESIGN CONTROL**

MPH = V (SPEED DESIGN)

ADT ( ) = : ADT ( ) =

DHV = : D = % T = %

**PERMITS ACQUIRED BY MDOT**

WETLANDS AND WATERS PERMITS		
	WATERS	WETLANDS
NATIONWIDE #14	<input checked="" type="checkbox"/> N	<input type="checkbox"/> N
NATIONWIDE (OTHER)*	<input checked="" type="checkbox"/> N	<input type="checkbox"/> N
GENERAL*	<input checked="" type="checkbox"/> N	<input type="checkbox"/> N
INDIVIDUAL (404)*	<input checked="" type="checkbox"/> N	<input type="checkbox"/> N
<b>STORMWATER PERMIT</b> <input checked="" type="checkbox"/> N		
Y	REQUIRED, CNOI SUBMITTED BY MDOT (DISTURBED AREA = 5 ACRES)	
S	REQUIRED, SCNOI TO BE SUBMITTED BY CONTRACTOR (1 TO 4.99 ACRES)	
N	NO STORMWATER PERMIT REQUIRED (<1 ACRE)	
APPROVED BY: _____		

**CONVENTIONAL SYMBOLS**

COUNTY LINE .....	-----
TOWN CORPORATION LINE .....	-----
SECTION LINE .....	-----
EXISTING ROAD OR TRAVELED WAY .....	-----
PROPOSED ROAD OR TRAVELED WAY .....	-----
RAILROAD .....	-----
SURVEY LINE .....	-----
BRIDGES .....	-----

**EQUATIONS**

**NONE**

**EXCEPTIONS**

**NONE**

**LENGTH DATA**

LENGTH OF ROADWAY	51921 FT.	9.84 MI.
LENGTH OF BRIDGES	2399 FT.	.45 MI.
LENGTH OF PROJECT (NET)	54320 FT.	10.29 MI.
LENGTH OF EXCEPTIONS	0 FT.	0 MI.
LENGTH OF PROJECT (GROSS)	54320 FT.	10.29 MI.

P S & E DATE: 3/16/2018

APPROVED: \_\_\_\_\_  
DEPUTY EXECUTIVE DIRECTOR / CHIEF ENGINEER

EXECUTIVE DIRECTOR \_\_\_\_\_



MMDDYY 00:00 AMPM DGNFILENAME TITLE DIVISION MISSISSIPPI DEPARTMENT OF TRANSPORTATION

