



SM No. CMP5013610031

PROPOSAL AND CONTRACT DOCUMENTS

FOR THE CONSTRUCTION OF

11

Mill & Overlay approximately 3 miles of SR 13 from the Simpson County Line to SR 18, known as State Project No. MP-5013-61(003) / 306440301 in Rankin County.

Project Completion: 33 Working Days

(STATE DELEGATED)

NOTICE

**BIDDERS MUST COMPLETE AN ONLINE REQUEST
FOR PERMISSION TO BID THIS PROJECT.**

Electronic addendum updates will be posted on www.gomdot.com

SECTION 900

OF THE CURRENT 2017 STANDARD SPECIFICATIONS FOR ROAD AND BRIDGE CONSTRUCTION JACKSON, MISSISSIPPI

**MISSISSIPPI DEPARTMENT OF TRANSPORTATION
TABLE OF CONTENTS**

PROJECT: MP-5013-61(003)/306440301 - Rankin

Section 901 - Advertisement

Section 904 - Notice to Bidders

#1	Governing Specification
#3	Final Cleanup
#9	Federal Bridge Formula
#12	MASH Compliant Devices
#113	Tack Coat
#296	Reduced Speed Limit Signs
#401	Standard Drawings
#445	Mississippi Agent and Qualified Nonresident Agent
#516	Errata and Modifications to the 2017 Standard Specifications
#996	Contract Time
#997	Scope of Work
#998	Temporary Construction Signs

Section 907 - Special Provisions

907-102-2	Bidding Requirements and Conditions
907-103-2	Award and Execution of Contract
907-619-6	Temporary Portable Rumble Strips

Section 905 - Proposal, Proposal Bid Items, Combination Bid Proposal

State Board of Contractors Requirement

State Certification Regarding Non-Collusion, Debarment and Suspensions

Section 902 - Contract Form

Section 903 - Contract Bond Forms

Progress Schedule

(REVISIONS TO THE ABOVE WILL BE INDICATED ON THE SECOND SHEET
OF SECTION 905 AS ADDENDA)

06/27/2018 08:40 AM

MISSISSIPPI DEPARTMENT OF TRANSPORTATION

SECTION 901 - ADVERTISEMENT

Electronic bids will be received by the Mississippi Transportation Commission at 10:00 o'clock A.M., Tuesday, July 24, 2018, from the Bid Express Service and shortly thereafter publicly read on the Sixth Floor for:

Mill & Overlay approximately 3 miles of SR 13 from the Simpson County Line to SR 18, known as State Project No. MP-5013-61(003) / 306440301 in Rankin County.

The attention of bidders is directed to the predetermined minimum wage rate set by the U. S. Department of Labor under the Fair Labor Standards Act.

The Mississippi Department of Transportation hereby notifies all bidders that it will affirmatively insure that in any contract entered into pursuant to this advertisement, disadvantaged business enterprises will be afforded full opportunity to submit bids in response to this invitation and will not be discriminated against on the grounds of race, color, sex, age, disability, religion or national origin in consideration for an award.

The specifications are on file in the offices of the Mississippi Department of Transportation.

Contractors may request permission to bid online at <http://shopmdot.ms.gov> at no cost. Upon approval, Contractors shall be eligible to submit a bid using Bid Express at <http://bidx.com>. Specimen proposals may be viewed and downloaded online at no cost at <http://mdot.ms.gov> or purchased online at <http://shopmdot.ms.gov> at a cost of Ten Dollars (\$10.00) per proposal plus a small convenience fee. Cash or checks will not be accepted as payment.

Bid bond, signed or countersigned by a Mississippi Agent or Qualified Nonresident Agent, with Power of Attorney attached, a Cashier's check or Certified Check for five (5%) percent of bid, payable to STATE OF MISSISSIPPI, must accompany each proposal.

The attention of bidders is directed to the provisions of Subsection 102.07 pertaining to irregular proposals and rejection of bids.

MELINDA L. MCGRATH
EXECUTIVE DIRECTOR

MISSISSIPPI DEPARTMENT OF TRANSPORTATION

SECTION 904 - NOTICE TO BIDDERS NO. 1

CODE: (IS)

DATE: 03/01/2017

SUBJECT: Governing Specifications

The current (2017) Edition of the Standard Specifications for Road and Bridge Construction adopted by the Mississippi Transportation Commission is made a part hereof fully and completely as if it were attached hereto, except where superseded by special provisions, or amended by revisions of the Specifications contained within this proposal. Copies of the specification book may be purchased from the MDOT Construction Division, or online at shopmdot/default.aspx?StoreIndex=1.

A reference in any contract document to controlling requirements in another portion of the contract documents shall be understood to apply equally to any revision or amendment thereof included in the contract.

In the event the plans or proposal contain references to the 2004 Edition of the Standard Specifications for Road and Bridge Construction, it is to be understood that such references shall mean the comparable provisions of the 2017 Edition of the Standard Specifications.

MISSISSIPPI DEPARTMENT OF TRANSPORTATION

SECTION 904 - NOTICE TO BIDDERS NO. 3

CODE: (SP)

DATE: 01/17/2017

SUBJECT: Final Clean-Up

Immediately prior to final inspection for release of maintenance, the Contractor shall pick up, load, transport and properly dispose of all litter from the entire highway right-of-way that is within the termini of the project.

Litter shall include, but not be limited to, solid wastes such as glass, paper products, tires, wood products, metal, synthetic materials and other miscellaneous debris.

Litter removal is considered incidental to other items of work and will not be measured for separate payment.

MISSISSIPPI DEPARTMENT OF TRANSPORTATION

SECTION 904 - NOTICE TO BIDDERS NO. 9

CODE: (IS)

DATE: 03/01/2017

SUBJECT: Federal Bridge Formula

Bidders are hereby advised that the latest revision of Federal Highway Administration Publication No. FHWA-HOP-06-105, **BRIDGE FORMULA WEIGHTS**, dated August 2006, is made a part of this contract when applicable.

Prior to the preconstruction conference, the Contractor shall advise the Engineer, in writing, what materials, if any, will be delivered to the jobsite via Interstate route(s).

Copies of the **BRIDGE FORMULA WEIGHTS** publication may be obtained by contacting:

Federal Highway Administration
400 7th Street, SW
Washington, DC 20590
(202) 366-2212

or

http://www.ops.fhwa.dot.gov/Freight/publications/brdg_frm_wghts/bridge_formula_all_rev.pdf

An on line **BRIDGE FORMULA WEIGHTS CALCULATOR** is available at

http://ops.fhwa.dot.gov/freight/sw/brdgcalc/calc_page.htm

MISSISSIPPI DEPARTMENT OF TRANSPORTATION

SECTION 904 - NOTICE TO BIDDERS NO. 12

CODE: (IS)

DATE: 03/01/2017

SUBJECT: MASH Compliant Devices

Bidders are hereby advised that the Standard Specifications may require certain traffic control and permanent safety hardware devices to meet the requirements of the Manual for Assessing Safety Hardware (MASH). However, devices meeting the requirements of NCHRP Report 350 will be allowed until the mandatory effective date for MASH compliance. The following table shows the effective dates for MASH compliant devices.

Device	Effective Date for MASH Compliance
W-beam barriers, cast-in-place concrete barriers	December 31, 2017
W-beam terminals	June 30, 2018
Cable barriers, cable barrier terminals, crash cushions	December 31, 2018
Bridge rails, transitions, all other longitudinal barriers including portable barriers installed permanently, all other terminals, sign supports, all other breakaway hardware	December 31, 2019

Temporary work zone devices, including portable barriers manufactured after December 31, 2019, must have been successfully tested to the 2016 Edition of MASH. Such devices manufactured on or before this date and successfully tested to NCHRP Report 350 or the 2009 Edition of MASH may continue to be used throughout their normal service lives.

MISSISSIPPI DEPARTMENT OF TRANSPORTATION

SECTION 904 - NOTICE TO BIDDERS NO. 113

CODE: (SP)

DATE: 04/18/2017

SUBJECT: Tack Coat

Bidders are advised that in addition to the products listed on the Department's APL as referenced in Subsection 401.03.1.2 on page 256, the Contractor may use one of the following as a tack coat.

- CSS-1
- CSS-1h
- SS-1
- SS-1h

MISSISSIPPI DEPARTMENT OF TRANSPORTATION

SECTION 904 - NOTICE TO BIDDERS NO. 296

CODE: (SP)

DATE: 07/25/2017

SUBJECT: Reduced Speed Limit Signs

Bidders are advised that when the plans or contract documents require the speed limit on a project to be reduced, the Contractor shall begin work within 48 hours of installing the reduced speed limit signs. Should the Contractor not start work or have no plans to start work within 48 hours of installing the signs, the reduced speed limit signs shall be covered and existing speed limit signs uncovered.

MISSISSIPPI DEPARTMENT OF TRANSPORTATION

SECTION 904 – NOTICE TO BIDDERS NO. 401

CODE: (SP)

DATE: **09/12/2017**

SUBJECT: Standard Drawings

Standard Drawings attached hereto shall govern appropriate items of required work.

Larger copies of Standard Drawings may be purchased from:

MDOT Plans Print Shop
MDOT Shop Complex, Building C, Room 114
2567 North West Street
P.O. Box 1850
Jackson, MS 39215-1850
Telephone: (601) 359-7460
or FAX: (601) 359-7461
or e-mail: plans@mdot.state.ms.us

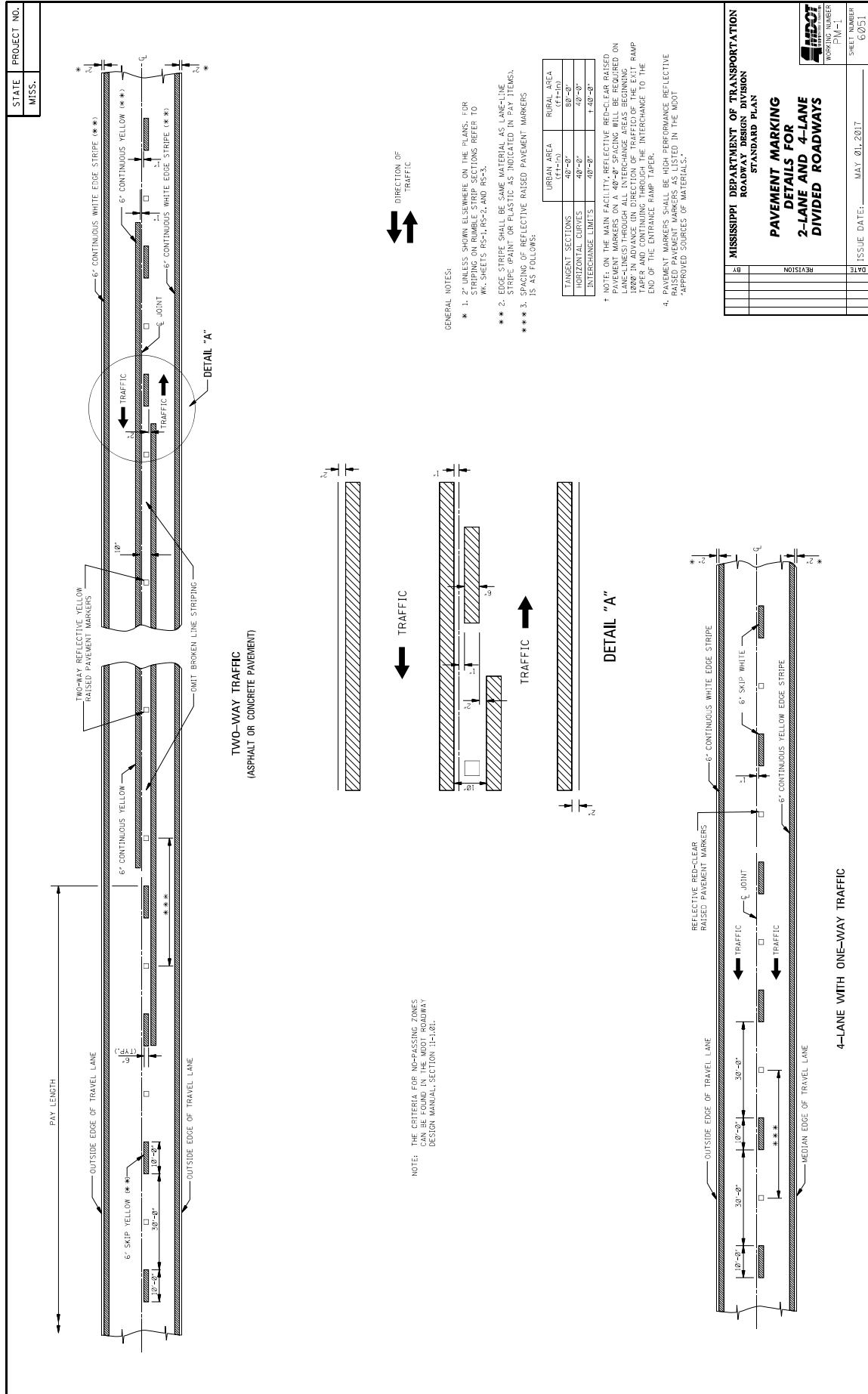





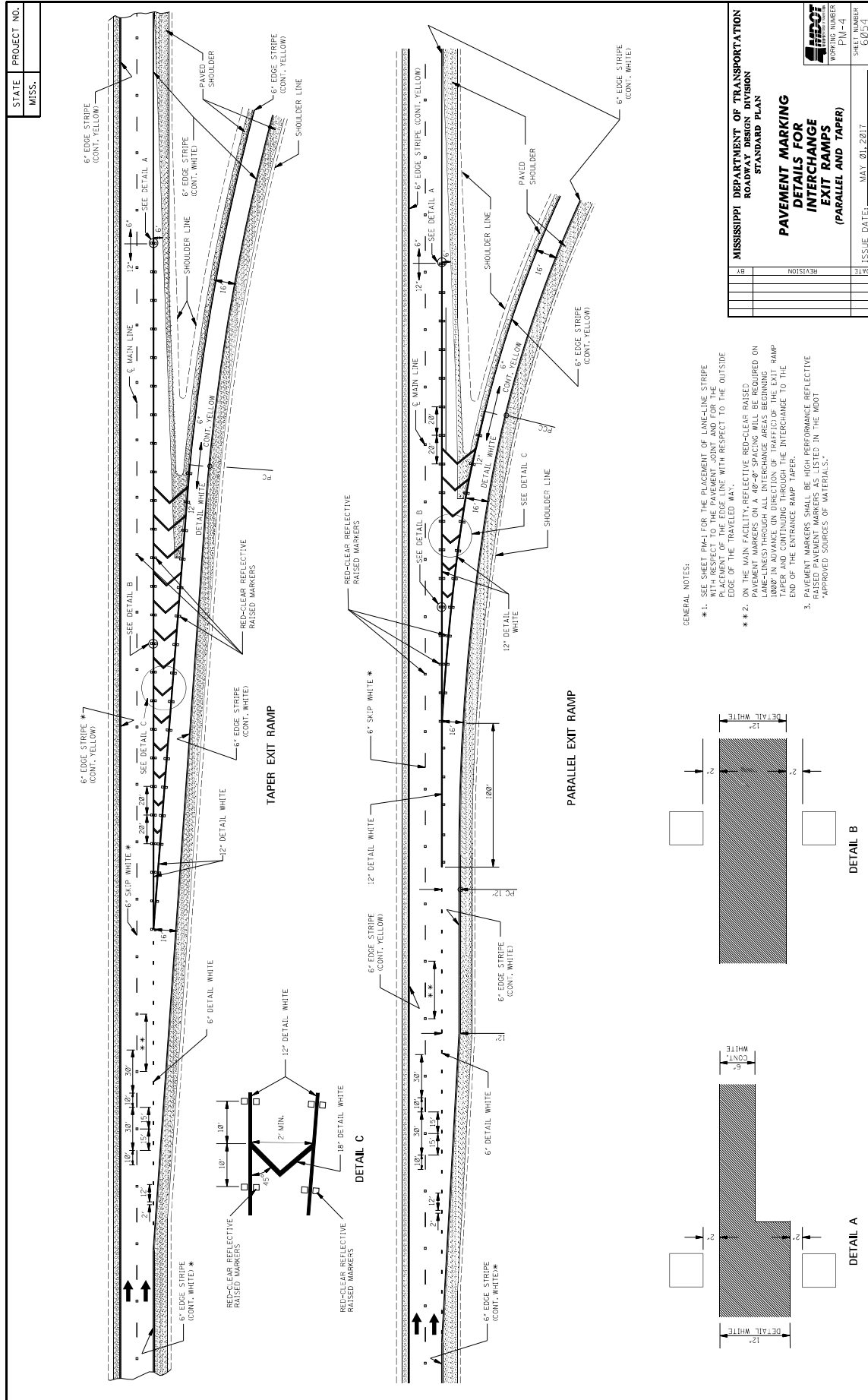

STATE MISS.	PROJECT NO.		
----------------	-------------	--	--

STOP

RIGHT

AHEAD

SCHOOL

EXIT

YIELD

TWO WAY TRAFFIC

SIGNAL

PAVE

GENERAL NOTES:

- TWO HORIZONTAL GAPS (CAUSED BY TEMPLATE CONNECTIONS OF 1/2" LESS) ARE EXTENDING FROM ALL WIDTH OF LETTERING. THE LETTERS ARE BEING PRINTED IN ALL CAPS.
- FOR OTHER DETAILS SEE THE MANUAL ON UNIFORM TRAFFIC CONTROL DEVICES.
- PAY QUANTITIES FOR PAVEMENT MARKING LEGENDS ARE AS FOLLOWS:

LEGEND	AREA (sq. ft.)
STOP	24.6
RIGHT	28.6
LEFT	19.5
TURN	23.5
AHEAD	32.3
YIELD	28.8
EXIT	18.5
SIGNAL	32.5
SCHOOL	35.5

**MISSISSIPPI DEPARTMENT OF TRANSPORTATION
ROADWAY DESIGN DIVISION
STANDARD PLAN**

**PAVEMENT MARKING
LEGEND DETAILS**

ISSUE DATE: MAY 01, 2017

SHEET NUMBER: PM-5

PROJECT NUMBER: 6055

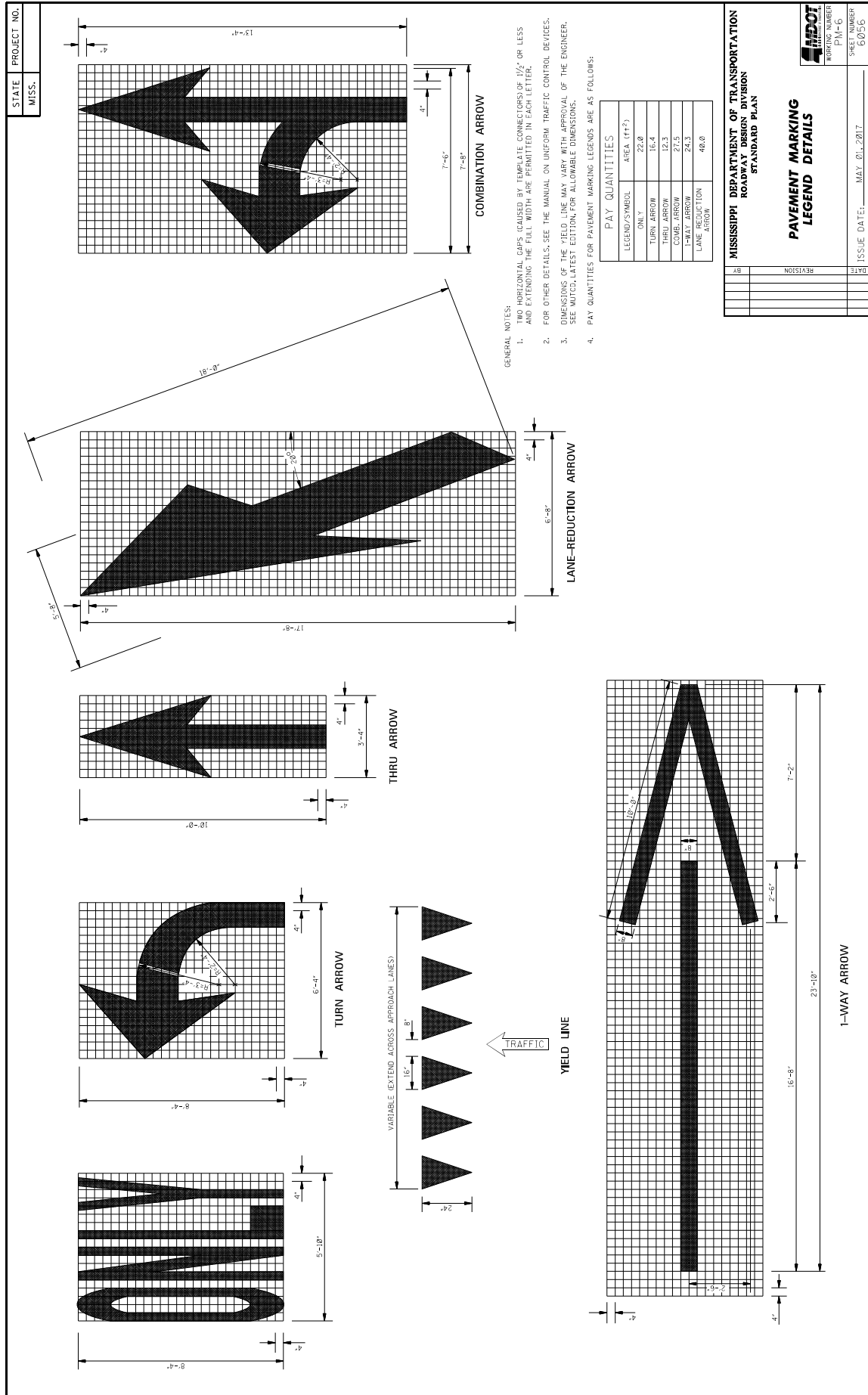













22

STATE PROJECT NO.
MISS.

MOBILE OPERATIONS ON TWO-LANE ROAD

WORK VEHICLE

SHADOW VEHICLE

TRUCK-MOUNTED FLASHING ARROW PANEL

TRUCK-MOUNTED ATTENUATOR

OPTIONAL SIGN FOR SHORT DURATION OPERATION

USE SIGN SHADE AND LEGEND APPROPRIATE TO TYPE OF WORK

MOBILE OPERATIONS ON MULTILANE ROAD

WORK VEHICLE

SHADOW VEHICLE 1

SHADOW VEHICLE 2

TRUCK-MOUNTED FLASHING ARROW PANELS

TRUCK-MOUNTED ATTENUATOR

LEFT LANE CLOSED AHEAD

NOTE: USE OF CHANGEABLE MESSAGE SIGN IS OPTIONAL

MOBILE OPERATIONS ON TWO-LANE ROAD

NOTES FOR TWO-LANE OPERATION:

- WHERE PRACTICAL AND WHEN NEEDED, THE WORK AND SHADOW VEHICLES SHOULD PULL OVER PERIODICALLY TO ALLOW TRAFFIC TO PASS. IF THIS CAN NOT BE DONE FREQUENTLY AS AN ALTERNATIVE, A "DO NOT PASS" SIGN MAY BE PLACED ON THE REAR OF THE VEHICLE BLOCKING THE LANE.
- THE DISTANCE BETWEEN THE WORK AND SHADOW VEHICLES MAY VARY ACCORDING TO TERRAIN, PAINT DRYING TIME, AND OTHER FACTORS. SHADOW VEHICLES ARE USED TO WARN TRAFFIC OF THE OPERATION AHEAD. WHENEVER ADEQUATE WARNING DISTANCE CANNOT BE MAINTAINED, SHADOW VEHICLES SHOULD BE USED TO MAINTAIN THE MINIMUM DISTANCE AND PROCEED AT THE SAME SPEED AS THE WORK VEHICLE. THE SHADOW VEHICLE SHOULD SLOW DOWN IN ADVANCE OF VERTICAL OR HORIZONTAL CURVES THAT RESTRICT SIGHT DISTANCE.
- ADDITIONAL SHADOW VEHICLES TO WARN AND REDUCE THE SPEED OF ONCOMING OR OPPOSING TRAFFIC MAY BE USED. POLICE PATROL CARS MAY BE USED FOR THIS PURPOSE.
- A TRUCK-MOUNTED ATTENUATOR (TMA) SHOULD BE USED ON THE SHADOW VEHICLE AND MAY BE USED ON THE WORK VEHICLE.
- THE WORK VEHICLE SHALL BE EQUIPPED WITH BEACONS, AND THE SHADOW VEHICLE SHALL BE EQUIPPED WITH BEACONS, FLASHING LIGHTS, AND WORK LIGHTS MOUNTED ON THE REAR, ADJACENT TO THE SIGN, SHADOW, AND WORK VEHICLES SHALL DISPLAY FLASHING OR ROTATING BEACONS BOTH FORWARD AND TO THE REAR.
- VEHICLE-MOUNTED SIGNS SHOULD BE MOUNTED WITH THE BOTTOM OF THE SIGN LOCATED AT A MINIMUM HEIGHT OF 48" ABOVE THE PAVEMENT AND SHALL NOT BE OBSCURED BY EQUIPMENT OR SUPPLIES. SIGN LEGENDS SHALL BE COVERED OR TURNED FROM VIEW WHEN WORK IS NOT IN PROGRESS.
- ARROW BOARD TO BE USED IN CAUTION MODE.
- ALL TRAFFIC CONTROL ITEMS SHOWN ON THIS SHEET WILL NOT BE MEASURED FOR SEPARATE PAYMENT. THIS WORK IS TO BE INCLUDED IN THE PRICE BID FOR MAINTENANCE OF TRAFFIC.

MOBILE OPERATIONS ON MULTILANE ROAD

NOTES FOR MULTILANE LANE OPERATION:

- VEHICLES USED FOR THESE OPERATIONS SHOULD BE MADE HIGHLY VISIBLE WITH APPROPRIATE EQUIPMENT, SUCH AS FLASHING LIGHTS, ROTATING BEACONS, FLAGS, SIGNS, OR ARROW PANELS.
- SHADOW VEHICLE 2 SHOULD BE EQUIPPED WITH AN ARROW PANEL AND TRUCK MOUNTED ATTENUATOR (TMA) AN APPROPRIATE LANE CLOSURE SIGN SHOULD BE PLACED ON SHADOW VEHICLE 2 SO AS NOT TO OBSCURE THE ARROW PANEL.
- SHADOW VEHICLE 1 SHOULD BE EQUIPPED WITH AN ARROW PANEL AND TRUCK-MOUNTED ATTENUATOR (TMA).
- SHADOW VEHICLE 2 SHOULD TRAVEL AT A VARYING DISTANCE FROM THE WORK OPERATION SO AS TO PROVIDE ADEQUATE SIGHT DISTANCE FOR TRAFFIC APPROACHING FROM THE REAR.
- WHEN ADEQUATE SHOULDER WIDTH IS NOT AVAILABLE, SHADOW VEHICLE 2 SHOULD BE ELIMINATED.
- ON HIGH-SPEED ROADWAYS, A THIRD SHADOW VEHICLE SHOULD BE USED (I.e., VEHICLE 3 ON THE SHOULDER (IF PRACTICAL), VEHICLE 2 IN THE CLOSED LANE, AND VEHICLE 1 IN THE CLOSED LANE).
- ARROW PANELS SHALL BE AS A MINIMUM TYPE B, 60" X 30" IN ACCORDANCE WITH THE CRITERIA PRESENTED IN THE MUTCD.
- WORK SHOULD NORMALLY BE DONE DURING OFF-PEAK HOURS.
- VEHICLE-MOUNTED SIGNS SHOULD BE MOUNTED WITH THE BOTTOM OF THE SIGN LOCATED AT A MINIMUM HEIGHT OF 48" ABOVE THE PAVEMENT AND SHALL NOT BE OBSCURED BY EQUIPMENT OR SUPPLIES. SIGN LEGENDS SHALL BE COVERED OR TURNED FROM VIEW WHEN WORK IS NOT IN PROGRESS.
- ALL TRAFFIC CONTROL ITEMS SHOWN ON THIS SHEET WILL NOT BE MEASURED FOR SEPARATE PAYMENT. THIS WORK IS TO BE INCLUDED IN THE PRICE BID FOR MAINTENANCE OF TRAFFIC.

MISSISSIPPI DEPARTMENT OF TRANSPORTATION
ROADWAY DESIGN DIVISION
STANDARD PLAN

TRAFFIC CONTROL PLAN
MOBILE OPERATIONS
MULTILANE ROADS
TWO-LANE ROADS

REVISION	DATE
1	
2	
3	
4	
5	
6	
7	
8	
9	
10	

WORKING NUMBER	SHEET NUMBER
TCP-49	6339

ISSUE DATE	DATE
MAY 01, 2017	





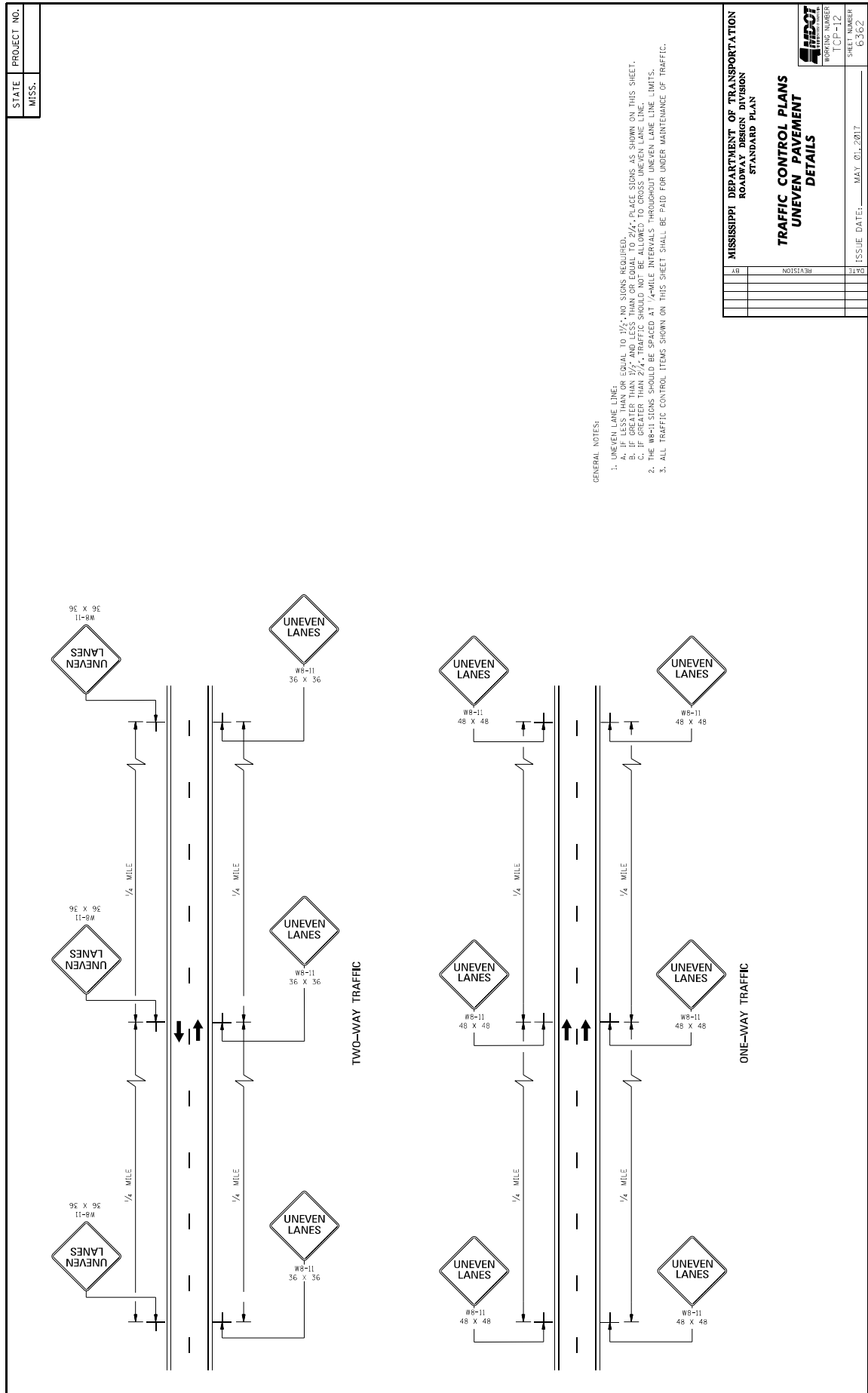

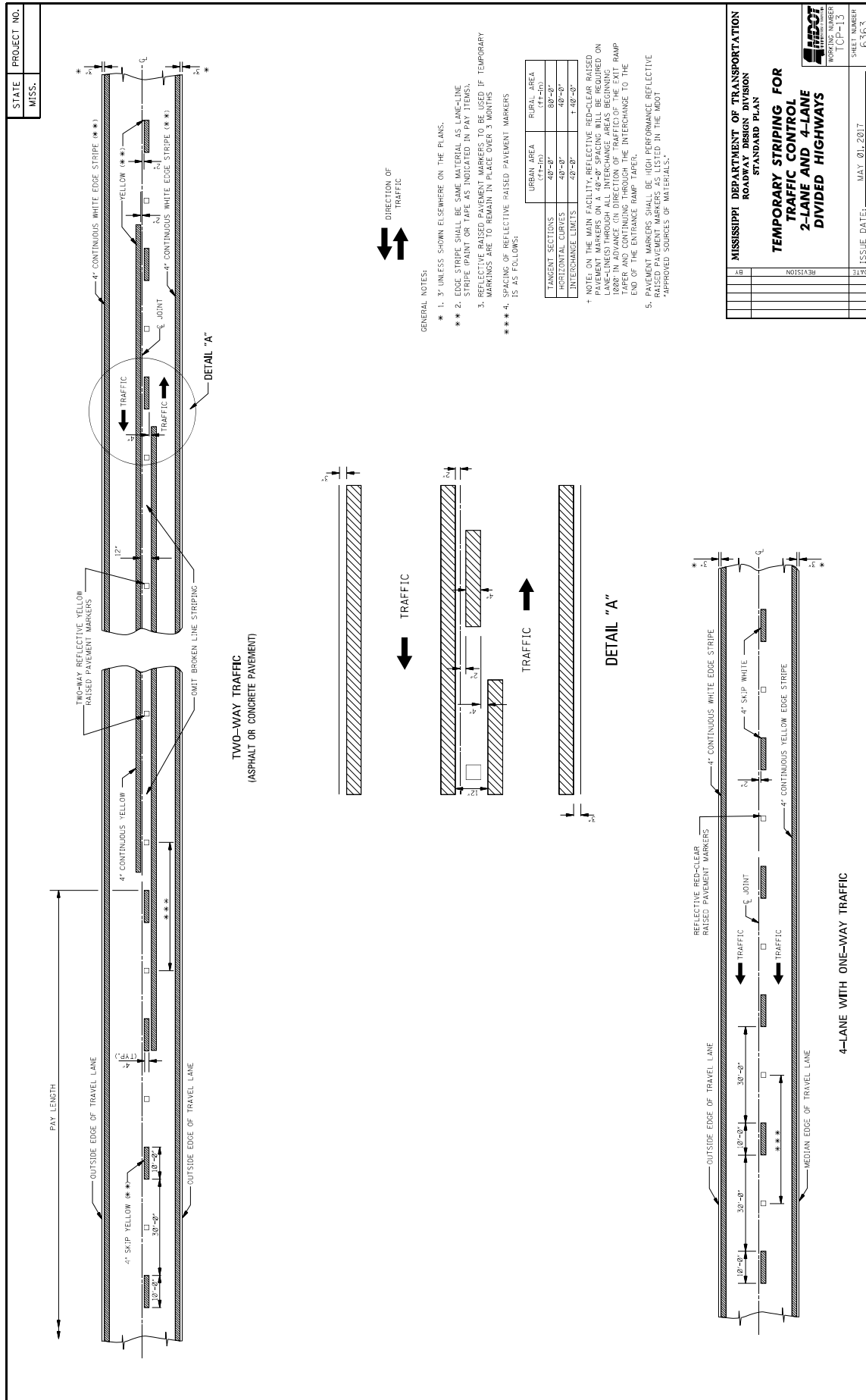

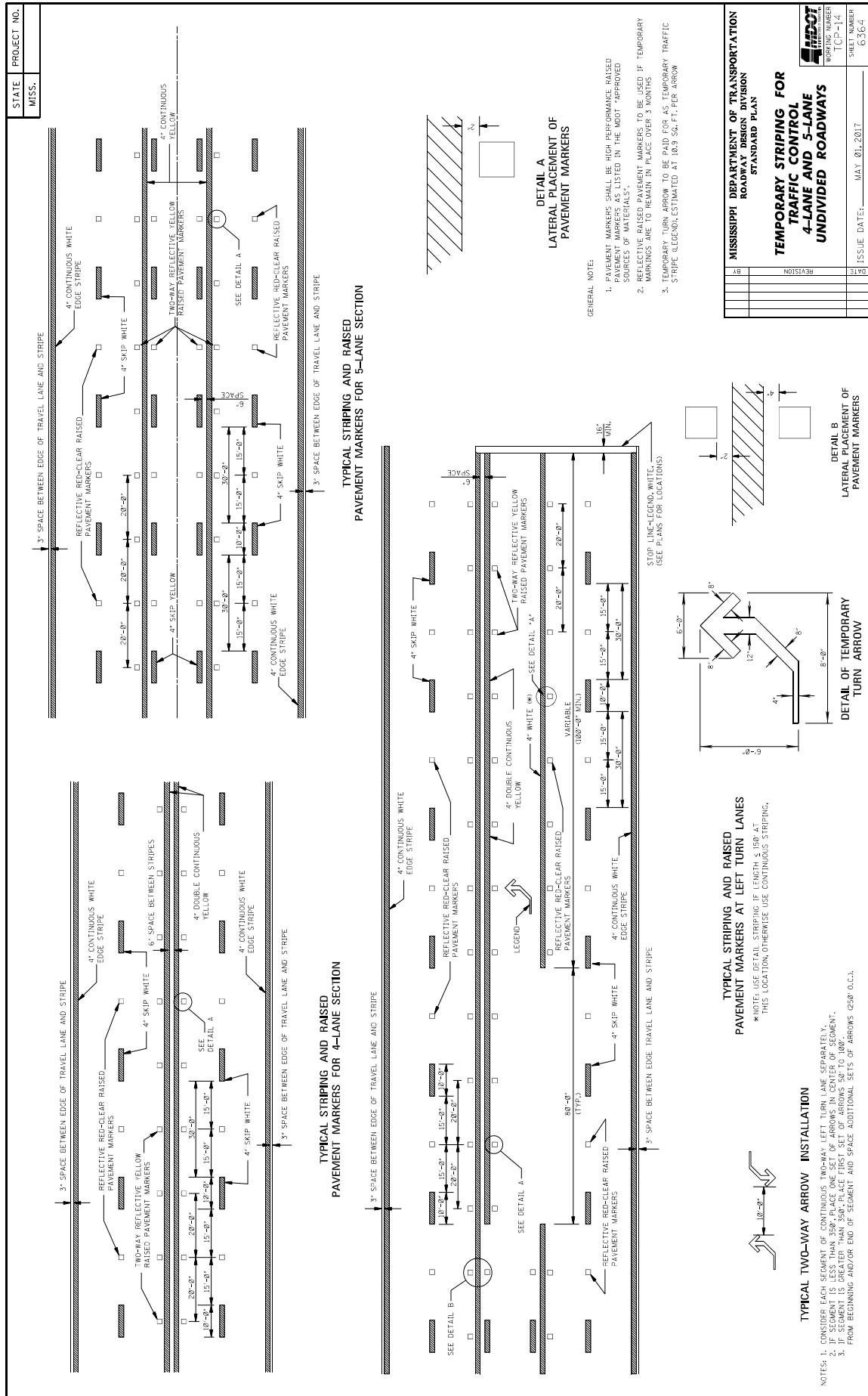

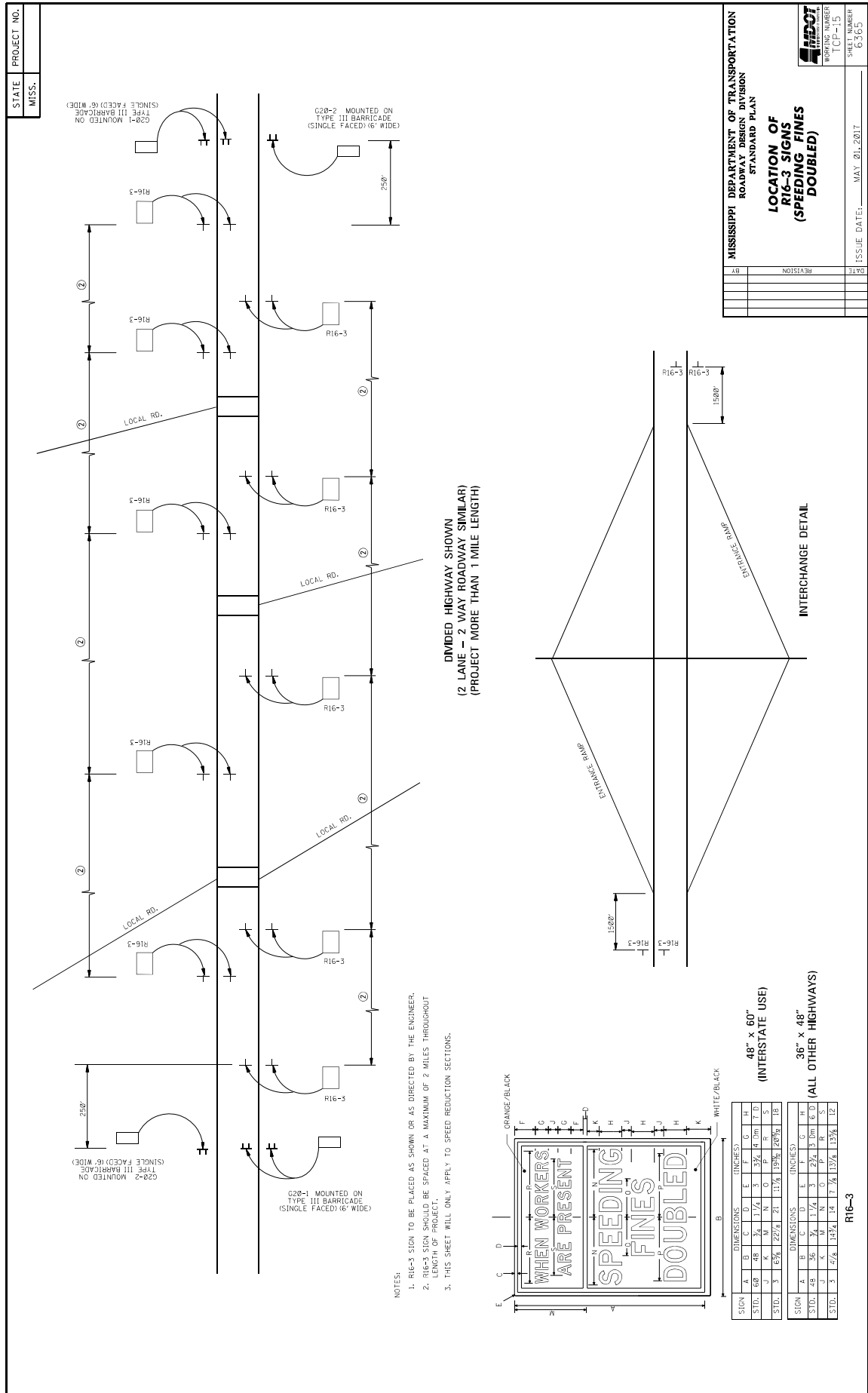

[illegible]

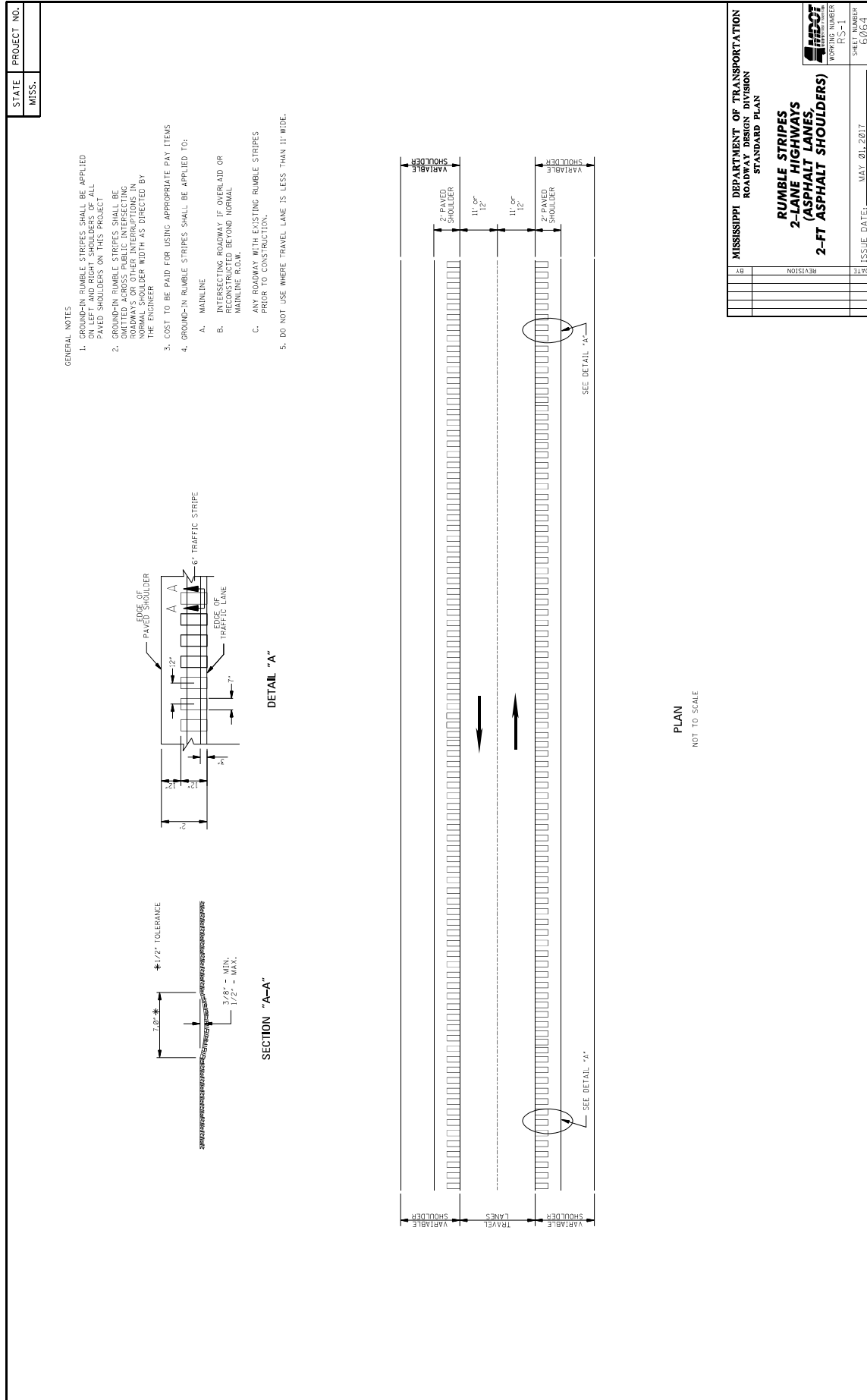

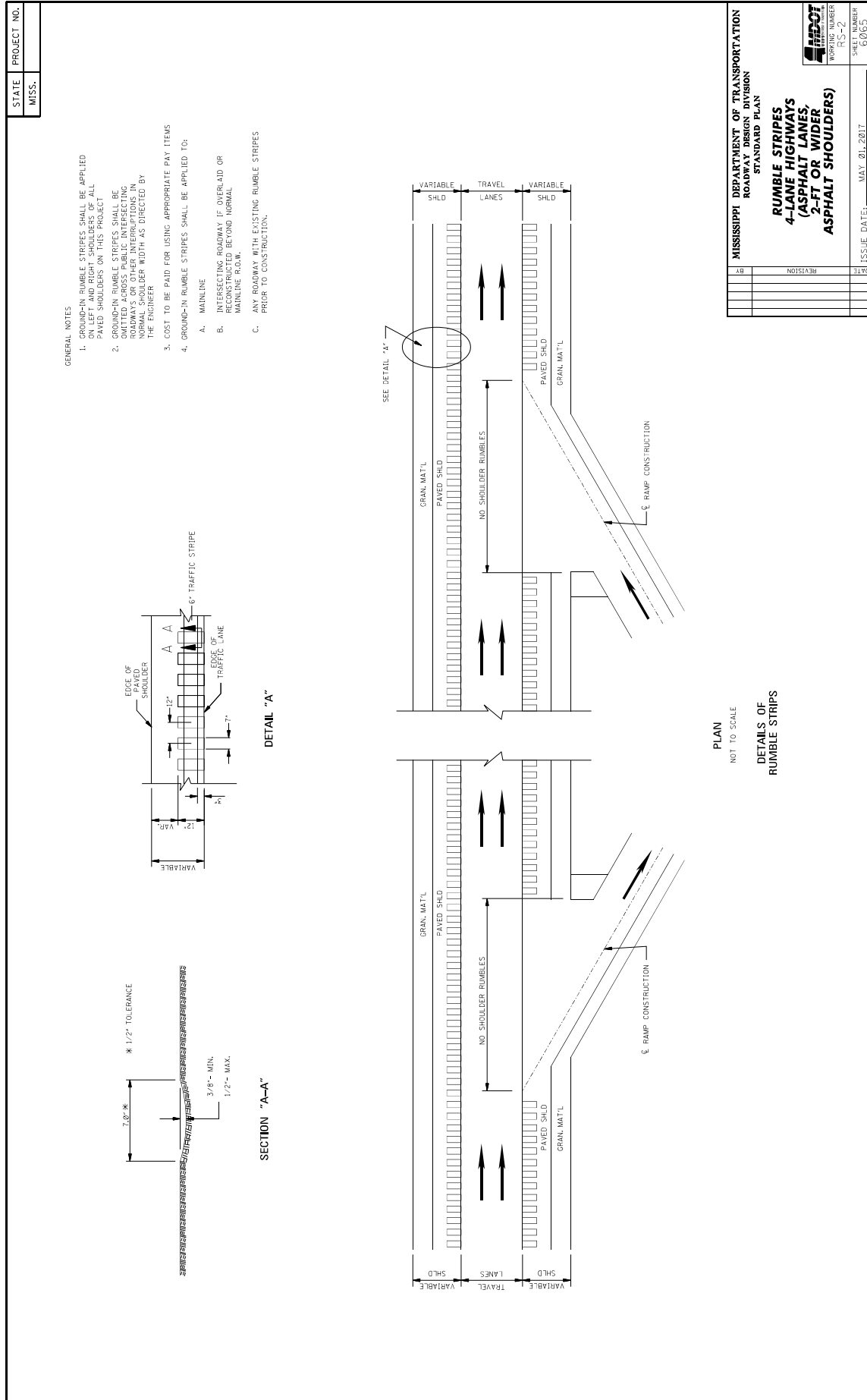

SECTION A-A
MEDIAN SHOULDER WITHOUT O.G.F.C.
THIS TYPICAL SECTION APPLIES TO THE LEFT HALF OF THE PLAN VIEW BELOW

SECTION B-B
OUTSIDE SHOULDER WITHOUT O.G.F.C.
THIS TYPICAL SECTION APPLIES TO THE LEFT HALF OF THE PLAN VIEW BELOW

SECTION C-C
MEDIAN SHOULDER WITH O.G.F.C.
THIS TYPICAL SECTION APPLIES TO THE RIGHT HALF OF THE PLAN VIEW BELOW

SECTION D-D
OUTSIDE SHOULDER WITH O.G.F.C.
THIS TYPICAL SECTION APPLIES TO THE RIGHT HALF OF THE PLAN VIEW BELOW

SECTION E-E
CONCRETE LANES WITH ASPHALT SHOULDERS (NO O.G.F.C.)
THIS TYPICAL SECTION APPLIES TO THE RIGHT HALF OF THE PLAN VIEW BELOW

PLAN

18 FT. OR AS SHOWN ON PLANS
12" RUMBLE
2"
6" TRAFFIC STRIPE
EDGE OF 12" LANE
4 FT.
OR AS SHOWN ON PLANS
12" RUMBLE
2"
6" TRAFFIC STRIPE
EDGE OF 12" LANE
10 FT. OR AS SHOWN ON PLANS
12" RUMBLE
24"
2"
6" TRAFFIC STRIPE
O.G.F.C.
ASPHALT SHOULDER
O.G.F.C.
ASPHALT SHOULDER
O.G.F.C.
CONCRETE LANES WITH ASPHALT SHOULDERS (NO O.G.F.C.)
NO RUMBLE ACROSS EXIT RAMP
NO RUMBLE ACROSS ENTRANCE RAMP
RAMP CONSTRUCTION

GENERAL NOTES

- GROUND-IN RUMBLE STRIPS SHALL BE APPLIED TO ALL SHOULDER STRIPS AND ALL PAVED SHOULDERS ON THIS PROJECT.
- GROUND-IN RUMBLE STRIPS SHALL BE OMITTED ACROSS PUBLIC INTERSECTING ROADWAYS OR OTHER INTERSECTIONS IN THE SHOULDER WIDTH AS DIRECTED BY THE ENGINEER.
- COST TO BE PAID FOR USING APPROPRIATE PAY ITEMS.
- GROUND-IN RUMBLE STRIPS SHALL BE APPLIED TO:
 - MAINLINE
 - INTERSECTING ROADWAY IF OVERLAID OR RECONSTRUCTED BEYOND NORMAL MAINLINE R.O.W.
 - ANY ROADWAY WITH EXISTING RUMBLE STRIPS PRIOR TO CONSTRUCTION.

★ 1/2" TOLERANCE

7.0" ★

3/8" MIN. 1/2" MAX.

MISS.		STATE	PROJECT NO.
DATE		DATE	DATE
REVISION		REVISION	REVISION
DATE		DATE	DATE
ISSUE DATE		ISSUE DATE	ISSUE DATE

MISSISSIPPI DEPARTMENT OF TRANSPORTATION
ROADWAY CONSTRUCTION DIVISION
STANDARD PLAN

**RUMBLE STRIP
DETAIL FOR OGFC OR
CONCRETE ROADWAY
WITH ASPHALT SHOULDERS**

PROJ. NO. 10000000
SHEET NUMBER 6066
MAY 21, 2017

MISSISSIPPI DEPARTMENT OF TRANSPORTATION

SECTION 904 - NOTICE TO BIDDERS NO. 445

CODE: (SP)

DATE: 10/10/2017

SUBJECT: Mississippi Agent or Qualified Nonresident Agent

Bidders are hereby advised of the requirements of Subsections 102.08, 103.05.2, and 107.14.2.1 of the *2017 Standard Specifications for Road and Bridge Construction* as it refers to bonding agents. Proposal guaranties, bonds, and liability insurance policies must be signed by a **Mississippi Agent or Qualified Nonresident Agent.**

MISSISSIPPI DEPARTMENT OF TRANSPORTATION

SECTION 904 - NOTICE TO BIDDERS NO. 516

CODE: (IS)

DATE: 11/28/2017

SUBJECT: Errata and Modifications to the 2017 Standard Specifications

<u>Page</u>	<u>Subsection</u>	<u>Change</u>
16	102.06	In the seventh full paragraph, change “Engineer” to “Director.”
33	105.05.1	In the sixth sentence, change “Contract Administration Engineer” to “Contract Administration Director.”
34	105.05.2.1	In subparagraph 2, change “SWPPP, ECP” to “SWPPP and the ECP”
35	105.05.2.2	In subparagraphs 2, add “ and” to the end of the sentence. In subparagraph 3, remove “, and” and add “.”.
90	109.04.2	In the last paragraph of subparagraph (a), place a period “.” at the end of the sentence.
93	109.04.2	In the last paragraph of subparagraph (g), place a period “.” at the end of the sentence. Also, in the first paragraph of subparagraph (h), place a period “.” at the end of the sentence.
97	109.07	Under ADJUSTMENT CODE, subparagraph (A1), change “HMA mixture” to “Asphalt mixtures.”
98	109.11	In the third sentence, change “Engineer” to “Director.”
219	308.04	In the last sentence of the last paragraph, change “Contractor’s decision” to “Engineer’s decision.”
300	405.02.5.9	In the first sentence of the second paragraph, change “Hot Mix Asphalt” to “Asphalt Mixtures.”
502	630.01.1	In the first paragraph, change “ <u>AASHTO</u> ” to “AASHTO’s <u>LRFD</u> ”.
636	646.05	Change “each” to “per each” for the pay item units of payment.
640	656.02.6.2	In item 7), change “down stream” to “downstream”.
688	630.03.2	Change the subsection number from “630.03.2” to “680.03.2.”

- | | | |
|-----|---------------|---|
| 725 | 702.08.3 | In the second sentence of the first paragraph, change “hot-mix” to “asphalt.” |
| 954 | 804.02.13.1.6 | In the definition for “M” in the % Reduction formulas, change “paragraph 7.3” to “paragraph 5.3.” |

MISSISSIPPI DEPARTMENT OF TRANSPORTATION

SECTION 904 - NOTICE TO BIDDERS NO. 996

CODE: (SP)

DATE: 06/14/2018

SUBJECT: Contract Time

PROJECT: MP-5013-61(003) / 306440301 -- Rankin County

The completion of work to be performed by the Contractor for this project will not be a specified date but shall be when all allowable working days are assessed, or any extension thereto as provided in Subsection 108.06. It is anticipated that the Notice of Award will be issued no later than **August 14, 2018** and the date for Notice to Proceed / Beginning of Contract Time will be **September 13, 2018**.

Should the Contractor request a Notice to Proceed earlier than **September 13, 2018** and it is agreeable with the Department for an early Notice to Proceed, the requested date will become the new Notice to Proceed date.

33 Working Days have been allowed for the completion of work on this project.

MISSISSIPPI DEPARTMENT OF TRANSPORTATION

SECTION 904 - NOTICE TO BIDDERS NO. 997

CODE: (SP)

DATE: 03/05/2018

SUBJECT: Scope of Work

PROJECT: MP-5013-61(003) / 306440301 -- Rankin County

The contract documents do not include an official set of construction plans but may, by reference, include some Standard Drawings when so specified in a Notice to Bidders entitled, "Standard Drawings". All other references to plans in the contract documents and Standard Specifications for Road and Bridge Construction are to be disregarded.

MILL AND OVERLAY SR 13 FROM RANKIN/SIMPSON COUNTY LINE TO SR 18 IN PUCKETT IN RANKIN COUNTY

Work on the project shall consist of milling and overlaying approximately 2.7 miles of existing asphalt pavement, repairing failed areas, placing rumble strips and replacing guard rail on SR 13 in Rankin County beginning at the Simpson County Line (BOP station 10+00) and ending at SR 18 in Puckett in Rankin County (154+30).

Station 10+00 (BOP) – 154+30

Work in this area shall consist of repairing failed areas full depth and leveling with 12.5-mm, MT, asphalt, milling the existing pavement to a depth of 1.5" on the existing 2% slope (if the slope is not 2%, the slope will be corrected by milling), and placing 2" of 12.5-mm, MT, asphalt pavement, as per the attached details and typical sections. All local roads shall be milled to a depth of 1.5" and inlayed with 2" of 12.5-mm, MT, asphalt pavement.

Guardrails are to be replaced. (See General Notes) Rumble strips will be placed from station 10+00 (BOP) and end at station 137+77.

General Notes

Prior to milling and paving operations, failed areas in the existing pavement shall be removed and backfilled with 12.5-mm, MT, Leveling, asphalt as per the attached typical sections and details. Any granular base deemed unsuitable by the Engineer shall be removed as directed and backfilled with 12.5-mm, MT, Leveling, asphalt. Payment for the excavation of the granular base will be made using the 203-G: Excess Excavation pay item. A list of the failed areas is shown in the attached table. Pavement repairs shall be completed as a continuous operation in order to minimize the traffic impact. Lane closures shall be in place until the failed area has been completely repaired.

Milling operations shall be in accordance with the contract documents and the Standard Specifications. Transitions will be used for local roads. Milling of driveway pads shall be

conducted in a manner to prevent gouging or otherwise affecting the roadway pavement structure and slope. Traffic will be allowed to drive on milled surfaces for no more than seven (7) days.

The Reclaimed Asphalt Pavement (RAP) material removed by the milling operations shall become the property of the Contractor with the exception of 10,000 tons or 50% of the total anticipated quantity, whichever is less. The reclaimed material shall be delivered to the MDOT Whitfield Maintenance Yard, 3769 Hwy 468, Pearl, MS 39208. The Contractor is responsible for coordinating the delivery of the RAP material with MDOT maintenance personnel. Sufficient advance notice shall be given to ensure the MDOT maintenance is equipped to handle the delivery. The Contractor shall be responsible for providing the equipment and operator to neatly stockpile the milled asphalt.

Temporary pavement joints (paper joints) will be used at the end of each day's paving/milling operations. Temporary pavement joints shall be a minimum of three (3) paper-widths long and shall be adequately maintained.

Publicly maintained roads and streets shall be milled and paved to the existing right-of-way or as directed by the Engineer. Privately owned entrances shall be paved to the shoulder line per the included typical drawing. Pads shall be shaped horizontally and vertically to prevent excessive drop-offs. Granular material (crushed stone) shall be placed around the pads to prevent shoulder drop-offs as directed and shall be placed in a timely manner. Drop-offs exceeding 2.5" shall be corrected within two (2) calendar days of the placement of the pad. Stabilizer aggregate shall be used as directed by the Engineer.

It shall be the responsibility of the Contractor to protect existing structures such as pipes, inlets, aprons, bridges, etc. from damage which might occur during construction. The Contractor shall replace or repair, as directed by the Engineer, any structures damaged during the life of the contract. No payment will be made for replacement or repair of damaged items.

Any signs that are in conflict with construction of this project shall be removed and relocated by the Contractor as directed by the Engineer, the cost of which is to be absorbed in other items bid.

The Contractor shall erect and maintain construction signing and provide all signs and traffic control devices necessary to safely maintain traffic around and through the work areas in accordance with the Traffic Control Plan and the MUTCD. The cost is to be included in the price bid for Pay Item No. 618-A, Maintenance of Traffic. Fluorescent orange sheeting shall be used on all construction and traffic control signs except those designated in the plans to be black legend and border on white background. Standard roadside construction signs and barricades will be paid for using the appropriate pay items.

Roadside construction signs, barrels, etc. shall be placed in accordance with the attached drawings or as directed by the Engineer. W20-1 signs shall be placed on all public road approaches as shown or as directed.

Incidental work such as removing vegetation, shaping and compacting shoulders, removing and resetting signs and/or mailboxes, removing excess asphalt material, project clean-up, and other

items of incidental work necessary to complete the project will not be measured for separate payment and will be considered included in the prices of items bid.

The Contractor shall on a daily basis, remove all debris from within the roadway and a 30-foot clear zone which, in the opinion of the Engineer, is a hazard to the traveling public. This activity shall begin with the beginning of work or the beginning of the contract time, whichever comes first. No direct payment will be made for the debris removal; the cost is to be included in the prices of items bid. Failure of the Contractor to remove the debris as prescribed herein shall be just cause for withholding the monthly progress estimate payment or suspending active operations until the debris is satisfactorily removed by the Contractor.

Where applicable, the existing shoulders are to be raised to match the new pavement elevation by placing variable depth granular material (crushed stone).

Placement of the granular material (crushed stone) on the finished asphalt course shall not be permitted. The existing shoulder shall be scarified to allow incorporation of the new shoulder material. The material shall be bladed, rolled, and compacted to a finished slope of four percent (4%). Placement of this material shall be performed to provide a uniform and compacted shoulder with a minimum depth and width of material placed. Shoulders with adequate shoulder material in place shall be bladed to a slope of four percent (4%). The cost of blading will be an absorbed item and is to be included in the price of other items bid.

The Standard Specifications allow for multiple material alternatives to be used for crushed stone. However, for the purpose of this project the Contractor shall choose one of those alternatives and use it throughout the project. No substitutions will be allowed without permission from the Engineer.

Removal of the existing shoulder material shall be coincidental with the milling/overlaying operation to prevent the possible ponding of water. No payment will be made for blading or removal of the existing shoulder material. Any material excavated from the existing shoulder shall be used to raise the existing shoulder to match the new pavement elevation and any surplus material shall be spread along the edge of the shoulders, fore slopes, or other adjacent areas as directed by the Engineer and will be an absorbed item. Material which cannot be placed in adjacent areas and deemed to be excess excavation by the Engineer shall be removed under pay item no. 203-G: Excess Excavation. Shoulders will be pulled up at the end of each days paving operation.

Removal of existing raised pavement markers is to be included in the prices for other items bid.

Guardrails are to be replaced. The locations and quantities are listed in the attached table. Pay Item 202-B158: Removal of Guard Rail, Including Rail, Posts & Terminal Ends, shall consist of; removal of bridge end section, w-beam, terminal end section, posts, and all other appurtenances. All guardrail removed is to be replaced the same day and prior to reopening the adjacent lane of traffic. Voids created by the removal of posts, concrete anchors, footings, etc. shall be backfilled and tamped in accordance with Section 203 of the Standard Specifications. Object markers at the bridge approaches are also to be replaced. Removal of object markers shall be absorbed.

Asphalt is to be extended under the guard rail and two feet (2') behind guard rail post as per the attached detail. The area to be paved shall be bladed to accommodate 3" of 12.5-mm, MT, asphalt. The excavated material shall be retained and used to raise the existing shoulder to match the new pavement elevation. The cost of blading will be an absorbed item and is not to be included in the price of pay items bid. Material which cannot be placed and blended in adjacent areas and deemed to be excess excavation by the Engineer shall be removed under pay item no. 203-G: Excess Excavation.

Temporary traffic stripe will be required immediately after the required overlay/milling operation and prior to opening area to traffic. Temporary stripe is to be placed in the same location and configuration as the permanent stripe.

All permanent striping, except that classified as Legend Stripe, will be thermoplastic, 90-mil double drop. Legend Stripe shall be 120-mil thickness as required by the Standard Specifications. Rumble strips will be placed throughout the project limits in accordance with the attached details. Edge lines will be placed to accommodate the lane widths shown on the attached applicable typical sections unless prevented by field conditions.

Rankin/Simpson County Line to Highway 18 in Puckett

STA. 154+30

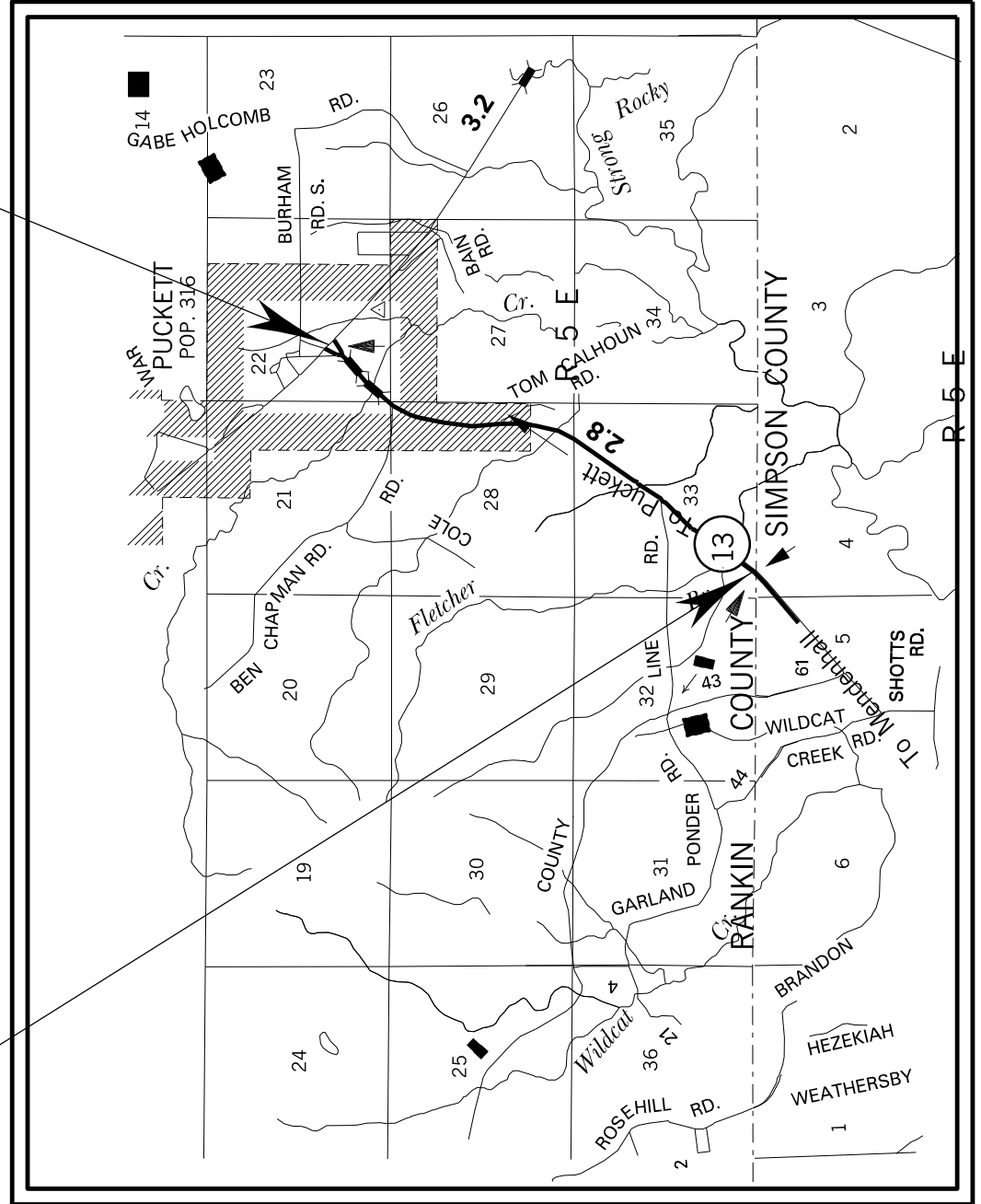

RANKIN COUNTY
HIGHWAY 13
10+00 TO 137+77

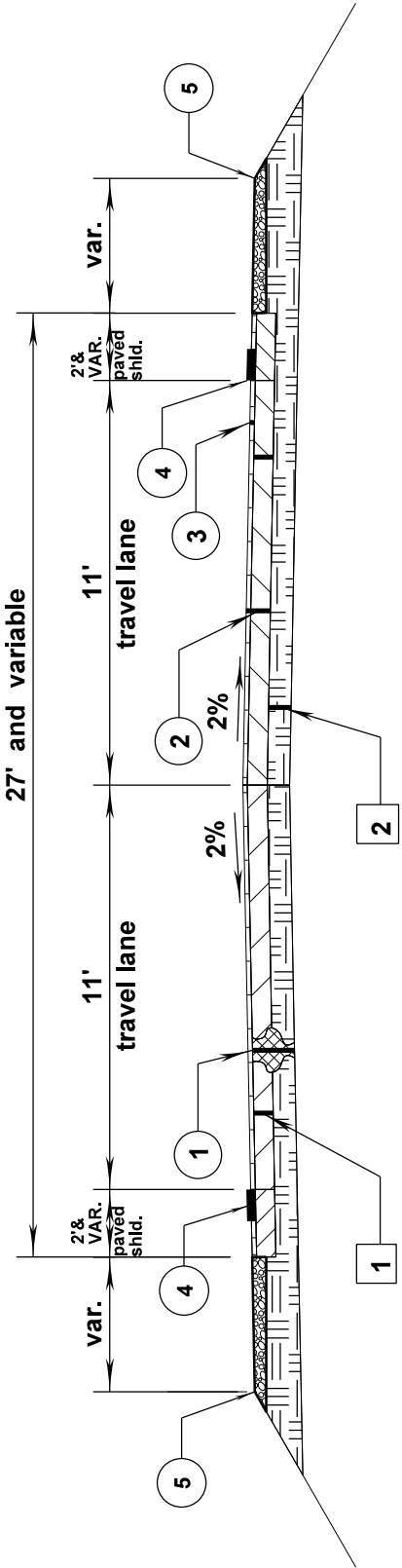

1 - EXISTING PAVEMENT IS 8"-10" VAR.
2 - 8" OF GRANULAR MATERIAL

1 REPAIR FAILED AREAS FULL DEPTH WITH 12.5MM LEVELING MIX, MT
2 MILL 1 1/2" OF EXISTING ASPHALT PAVEMENT
3 OVERLAY WITH 2" OF 12.5MM MIX, MT.
4 PLACE RUMBLE STRIPS FROM BOP TO PUCKETT CITY LIMITS.
5 PLACE GRANULAR MATERIAL (CRUSHED STONE)
TO BRING SHOULDERS TO GRADE AFTER OVERLAY.

**RANKIN COUNTY
HIGHWAY 13
STATION 137+77 TO 154+30**

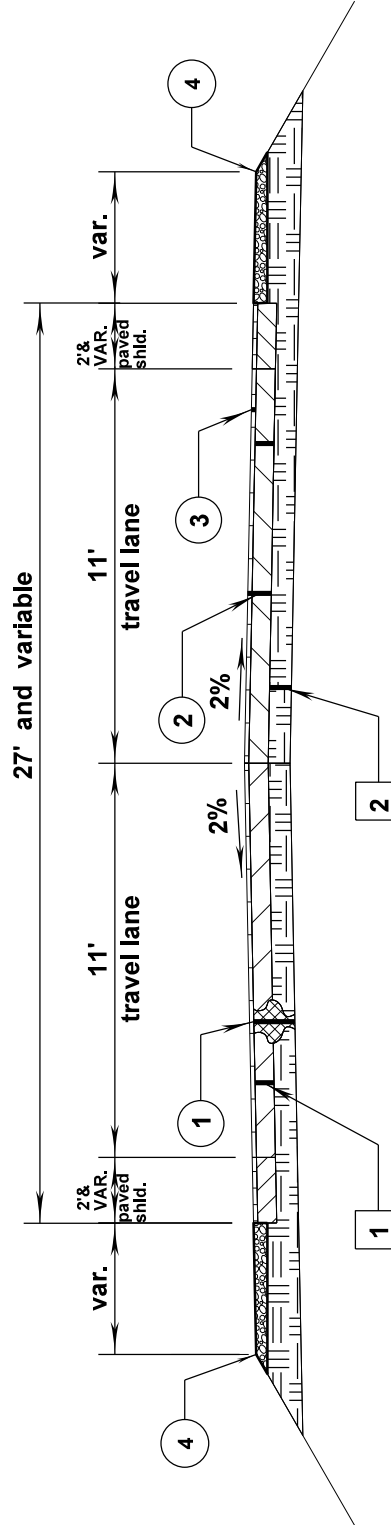

- 1 -** EXISTING PAVEMENT IS 8"-10" VAR.
- 2 -** 8" OF GRANULAR MATERIAL

- ①** REPAIR FAILED AREAS FULL DEPTH WITH 12.5MM LEVELING MIX, MT.
- ②** MILL 1½" OF EXISTING ASPHALT PAVEMENT
- ③** OVERLAY WITH 2" OF 12.5MM MIX, MT.
- ④** PLACE GRANULAR MATERIAL (CRUSHED STONE) TO BRING SHOULDERS TO GRADE AFTER OVERLAY.

GUARD RAIL QUANTITIES 306440/301000													
STATION	GUARDRAIL			TERMINAL END SECTION	Cable Anchor TYPE I (EA)	BRIDGE END SECTION				DELINEATORS		REMOVAL ITEMS	REMARKS
	(W-BEAM) (LF)	TRANS. SECT. (EA)	THRIE BEAM (LF)			TYPE "A" (EA)	TYPE "C" (EA)	TYPE "D" Modified (EA)	SPECIAL SECTIONS SPECIAL DESIGN BRIDGE CONNECTOR	WHITE	YELLOW		
137+77	137.5			1		1			1	6		200	RIGHT
137+77	37.5			1		1			1	4		100	LEFT
138+96	37.5			1		1			1	4		100	RIGHT
138+96	137.5			1		1			1	6		200	LEFT
144+75	137.5			1		1			1	6		200	RIGHT
144+75	37.5			1		1			1	4		100	LEFT
145+65	37.5			1		1			1	4		100	RIGHT
145+65	137.5			1		1			1	6		200	LEFT
TOTAL =	700	0	0	8	0	8	0	0	8	40	0	1200	
	LF.	EA.	LF.	EA.	EA.	EA.	EA.	EA.	EA.	EA.	EA.	LF.	

* ALL TERMINAL END SECTIONS ARE 37.5'

* REMOVAL OF ALL GUARDRAIL (BRIDGE END SECTIONS, W-BEAM, TYPE-I CABLE ANCHORAGE, TERMINAL END SECTIONS, ETC.) WILL BE PAID UNDER PAY ITEM 202-B REMOVAL OF GUARD RAIL.

* REMOVAL OF GUARDRAIL DELINEATORS ARE CONSIDERED INCIDENTAL TO THE REMOVAL OF GUARDRAIL AND WILL NOT BE MEASURED AS A SEPARATE PAY ITEM.

* REMOVAL OF OBJECT MARKERS WILL NOT BE MEASURED AS A SEPARATE PAY ITEM AS SHALL BE ABSORBED IN OTHER ITEMS

306440/301000							
STATION	LOCATION	Width-1 (FT)	Width-2 (FT)	Length (FT)	Total (SF)	Total (Tons)	Remarks
10+44	LT	32	40	4	144.000	1.804	
10+75	RT	36	40	5	190.000	2.380	
16+24	LT	16	26	4	84.000	1.052	
22+33	LT	12	20	4	64.000	0.802	
28+12	RT	18	32	5	125.000	1.566	
28+87	LT	16	24	5	100.000	1.253	
29+53	LT	14	22	5	90.000	1.127	
30+47	RT	28	52	5	200.000	2.505	
32+73	LT	22	30	5	130.000	1.628	
35+00	RT	56	70	5	315.000	3.945	
35+00	LT	26	40	5	165.000	2.067	
40+70	RT	20	32	5	130.000	1.628	
40+73	LT	18	28	5	115.000	1.440	
42+77	RT	20	30	5	125.000	1.566	
43+53	RT	36	44	5	200.000	2.505	
45+80	RT	30	36	5	165.000	2.067	
48+10	RT	30	36	5	165.000	2.067	
48+72	LT	18	26	5	110.000	1.378	
54+77	RT	26	36	5	155.000	1.941	
59+25	LT	20	26	5	115.000	1.440	
59+97	RT	20	26	5	115.000	1.440	
66+50	RT	10	16	5	65.000	0.814	
66+50	LT	20	26	4	92.000	1.152	
72+18	RT	22	28	4	100.000	1.253	
72+24	LT	20	24	5	110.000	1.378	
76+82	LT	20	30	5	125.000	1.566	
81+84	LT	22	30	5	130.000	1.628	
93+10	LT	20	24	5	110.000	1.378	
98+57	LT	12	20	5	80.000	1.002	
103+05	LT	26	30	5	140.000	1.754	

STATION	LOCATION	Width-1 (FT)	Width-2 (FT)	Length (FT)	Total (SF)	Total (Tons)	Remarks
104+64	RT	16	22	5	95.000	1.190	
105+20	LT	20	26	5	115.000	1.440	
106+66	LT	22	36	5	145.000	1.816	
114+40	RT	30	36	5	165.000	2.067	
114+65	LT	24	32	5	140.000	1.754	
116+24	LT	20	24	5	110.000	1.378	
119+15	RT	16	24	5	100.000	1.253	
119+27	LT	12	16	5	70.000	0.877	
120+17	LT	12	20	5	80.000	1.002	
120+34	RT	18	28	5	115.000	1.440	
123+17	RT	16	20	5	90.000	1.127	
125+00	LT	12	14	5	65.000	0.814	
129+18	LT	18	24	5	105.000	1.315	
129+30	RT	18	24	5	105.000	1.315	
133+80	LT	14	20	5	85.000	1.065	
135+45	LT	16	28	5	110.000	1.378	
141+26	LT	18	24	5	105.000	1.315	
148+10	RT	18	24	5	105.000	1.315	
149+17	LT	12	20	5	80.000	1.002	
150+00	LT	12	20	5	80.000	1.002	
150+40	RT	14	20	5	85.000	1.065	
				TOTAL	6104.000	76.453	

RANKIN COUNTY
HIGHWAY 13

Failed Areas 306440/301000								
STATION	STATION	LANE	WIDTH (FT)	LENGTH (FT)	AREA (SF)*	Removal of Asphalt (SY)	12.5MM, MT LEVELING (Tons)	Excess Excavation, LVM, AH (CY)
66+45	68+25	RT	14	180	2520.0	280.000	189.00	93.33
68+25	71+50	RT	7	325	2275.0	252.778	170.63	84.26
75+30	73+70	LT	14	160	2240.0	248.889	168.00	82.96
89+00	88+00	LT	28	100	2800.0	311.111	210.00	103.70
109+00	110+00	RT	14	100	1400.0	155.556	105.00	51.85
108+00	110+00	LT	14	200	2800.0	311.111	210.00	103.70
				TOTAL	14035.0	1559.444	1052.63	519.815

RANKIN COUNTY
HIGHWAY 13

619-D2001 Standard Roadside Construction Signs (10 Sq. Ft. or More) 306440/301000						
STATION	LOCATION	DESCRIPTION	QUANTITY	UNIT	REMARKS	
159+30	LT	G20-1 (Road Work Next 3 Miles)	10	SF	500' North Of EOP	
	LT	W20-1	16	SF	500' EAST OF SR 13/18	
	RT	W20-1	16	SF	500' WEST OF SR 13/18	
	RT	W20-1	16	SF	500' WEST OF LILA ST/SR 13	
	RT	W20-1	16	SF	500' WEST OF COLE RD/ SR 13	
	LT	W20-1	16	SF	500' EAST OF CALHOUN RD/SR 13	
	RT	W20-1	16	SF	500' WEST OF COUNTY LINE RD/SR 13	
	LT	W20-1	16	SF	500' EAST OF LUCILLE DR/SR 13	
5+00	RT	G20-1 (Road Work Next 3 Miles)	10	SF	500' South of BOP	
		Total	132	SF		

RANKIN COUNTY
HIGHWAY 13

619-D1001 Standard Roadside Construction Signs (Less than 10 Sq. Ft.) 306440/301000					
Station	Location	Description	Quantity	Unit	Remarks
5+00	LT	G20-2	8	SF	500' South of BOP
10+00	LT	W14-3	5.56	SF	
10+00	RT	R4-1	5	SF	
17+50	RT	R4-1	5	SF	
25+00	RT	R4-1	5	SF	
32+50	RT	R4-1	5	SF	
40+00	RT	R4-1	5	SF	
47+50	RT	R4-1	5	SF	
55+00	RT	R4-1	5	SF	MOVED TO 55+35
62+50	RT	R4-1	5	SF	
70+00	RT	R4-1	5	SF	
77+50	RT	R4-1	5	SF	
85+00	RT	R4-1	5	SF	
92+50	RT	R4-1	5	SF	
100+00	RT	R4-1	5	SF	MOVED TO 100+25
107+50	RT	R4-1	5	SF	
115+00	RT	R4-1	5	SF	
122+50	RT	R4-1	5	SF	
130+00	RT	R4-1	5	SF	
137+50	RT	R4-1	5	SF	
145+00	RT	R4-1	5	SF	MOVED TO 146+00
152+50	RT	R4-1	5	SF	
159+30	RT	G20-2	8	SF	500' north of EOP

RANKIN COUNTY
HIGHWAY 13

619-D1001 Standard Roadside Construction Signs (Less than 10 Sq. Ft.) 306440/301000					
Station	Location	Description	Quantity	Unit	Remarks
154+30	RT	W14-3	5.56	SF	
154+30	LT	R4-1	5	SF	
151+37	LT	R4-2	5	SF	
140+50	LT	R4-1	5	SF	
140+50	RT	W14-3	5.56	SF	
133+00	LT	R4-1	5	SF	
125+50	LT	R4-1	5	SF	
118+00	LT	R4-1	5	SF	
110+50	LT	R4-1	5	SF	
103+00	LT	R4-1	5	SF	
95+50	LT	R4-1	5	SF	
88+00	LT	R4-1	5	SF	
80+50	LT	R4-1	5	SF	
73+00	LT	R4-1	5	SF	
65+50	LT	R4-1	5	SF	
58+00	LT	W14-3	5.56	SF	
50+50	LT	R4-1	5	SF	
43+00	LT	R4-1	5	SF	
35+50	LT	R4-1	5	SF	
28+00	LT	R4-1	5	SF	
20+50	LT	R4-1	5	SF	
13+00	LT	R4-1	5	SF	

RANKIN COUNTY
HIGHWAY 13

619-D1001 Standard Roadside Construction Signs (Less than 10 Sq. Ft.) 306440/301000					
Station	Location	Description	Quantity	Unit	Remarks
TOTAL			233.24	SF	

RANKIN COUNTY
HIGHWAY 13

619-D1001 Standard Roadside Construction Signs (Less than 10 Sq. Ft.) 306440/301000				
Station	Location	Description	Quantity	Unit
619-G4005 Barricades, Type III, Double Faced 306440/301000				
Location	Station	Quantity	Unit	Description
LT	500' South of BOP	6	LF	Mounted on G20-1
RT	500' South of BOP	6	LF	Mounted on G20-2A
RT	500' North of EOP	6	LF	Mounted on G20-1
LT	500' North of EOP	6	LF	Mounted on G20-2A
		TOTAL	24	LF

RANKKIN COUNTY
HIGHWAY 13

CONSTRUCTION SIGNING DETAIL

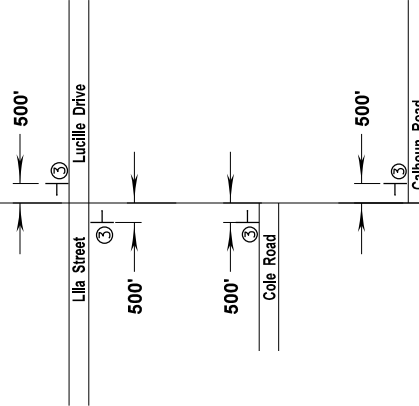
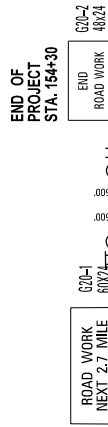
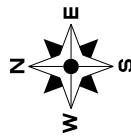

SIGN LEGEND	
NUMBER	DESCRIPTION
①	ROAD WORK NEXT MILES G20-1 60/24
②	END ROAD WORK G20-2 48/24
③	ROAD WORK AHEAD W14-1 24/33
④	DO NOT PASS R4-1 24/33
⑤	PASS WITH CARE R4-2 24/33

TRAFFIC CONTROL SIGNS REQUIRED

- 2 - G20-1 "ROAD WORK NEXT MILE"
- 2 - G20-2 "END ROAD WORK"
- 5 - W20-1 "ROAD WORK AHEAD"
- 38 - R4-1 "DO NOT PASS"
- 1 - R4-2 "PASS WITH CARE"
- 4 - W14-3 "NO PASSING ZONE"

NOTES:

ONE (1) W20-1 "ROAD WORK AHEAD" SIGN IS REQUIRED AT EACH LOCAL ROAD, STREET, OR HIGHWAY ENTERING THE PROJECT.

G20-1 AND G20-2 SIGNS MOUNTED ON TYPE III DOUBLE FACED BARRICADE.

R4-1 "DO NOT PASS", R4-2 "PASS WITH CARE", AND W14-3 "NO PASSING ZONE" signs are required in accordance with Subsection 618.03.3 and as specified in the MUTCD. If No Passing zones are 1000 ft or more, install additional "DO NOT PASS" signs on maximum spacing of 750 ft.

FIELD CONDITIONS MAY REQUIRE SOME SIGNS ON THIS DETAIL TO BE ADJUSTED.

THE ABOVE SHOWN ITEMS WILL BE PAID UNDER THE APPROPRIATE PAY ITEMS.

RANKIN COUNTY
HIGHWAY 13

Rankin/Smith County Line to Highway 13 in Puckett

TYPICAL MILLING DETAIL FOR NON-CHANNELIZED
COUNTY ROADS

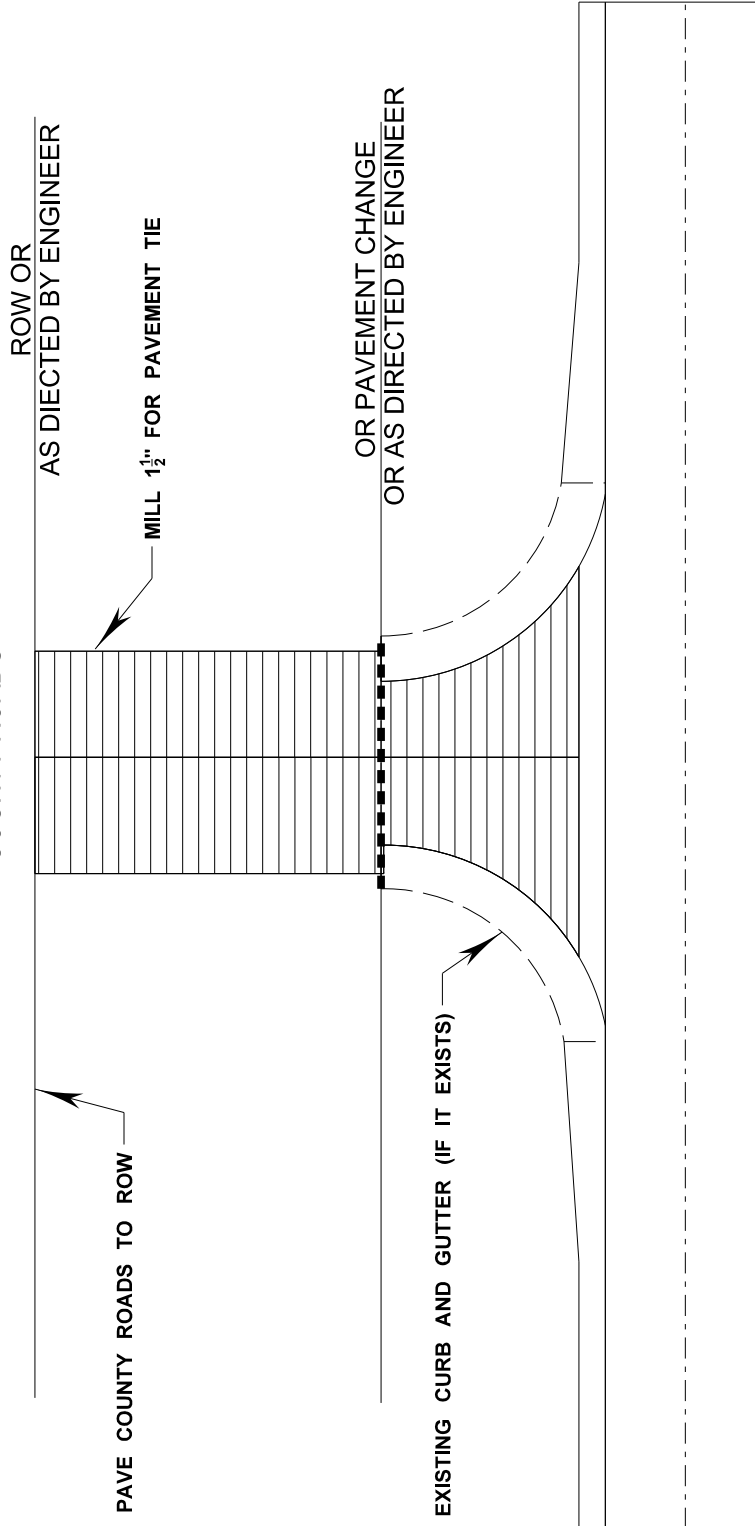

LOCATIONS OF COUNTY ROADS

County Line Road
Tom Calhoun Road
Calhoun Circle
Cole Road
Lila Street
Lucille Drive

 =MILLING AREA

MP-5013-61(003) 306440/301000
RANKIN COUNTY

PAVEMENT REPAIR DETAIL

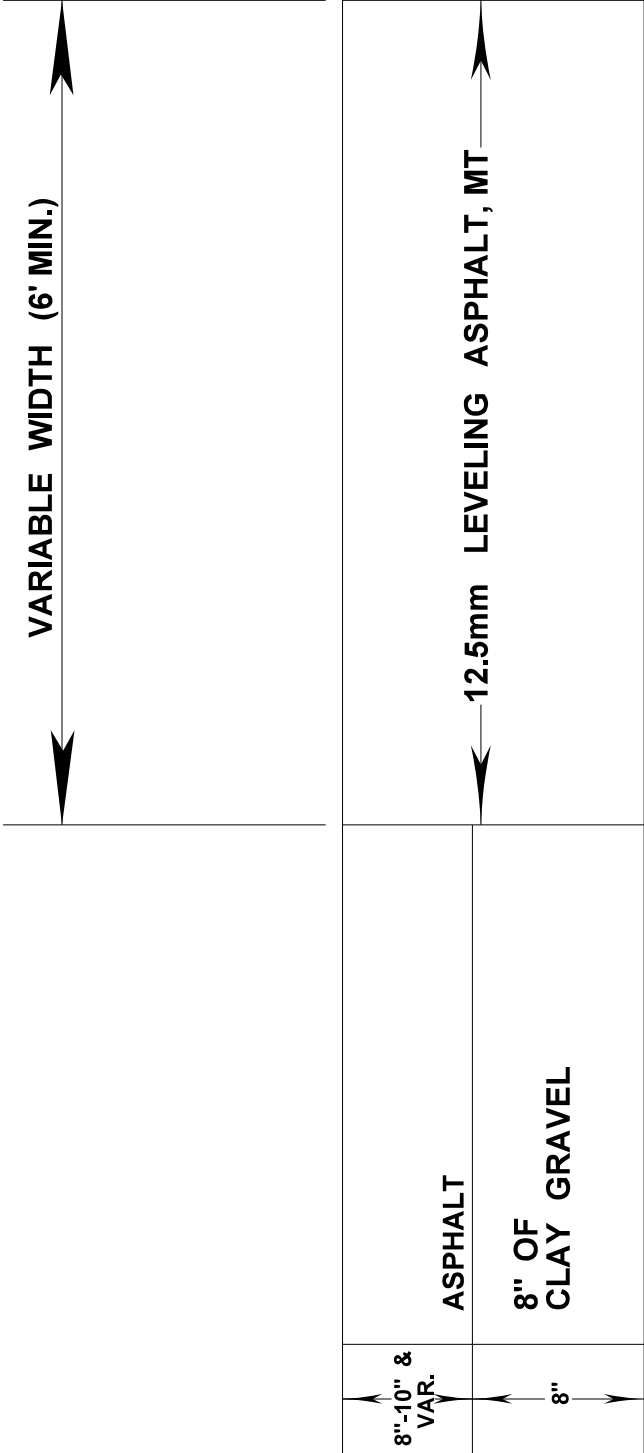

***Remove any damaged subgrade and replace with 12.5mm asphalt as directed by the engineer.**

RANKIN COUNTY
HIGHWAY 13

TYPICAL DETAIL OF ADDITIONAL SHOULDER PAVING
REQUIRED AT GUARDRAIL LOCATIONS

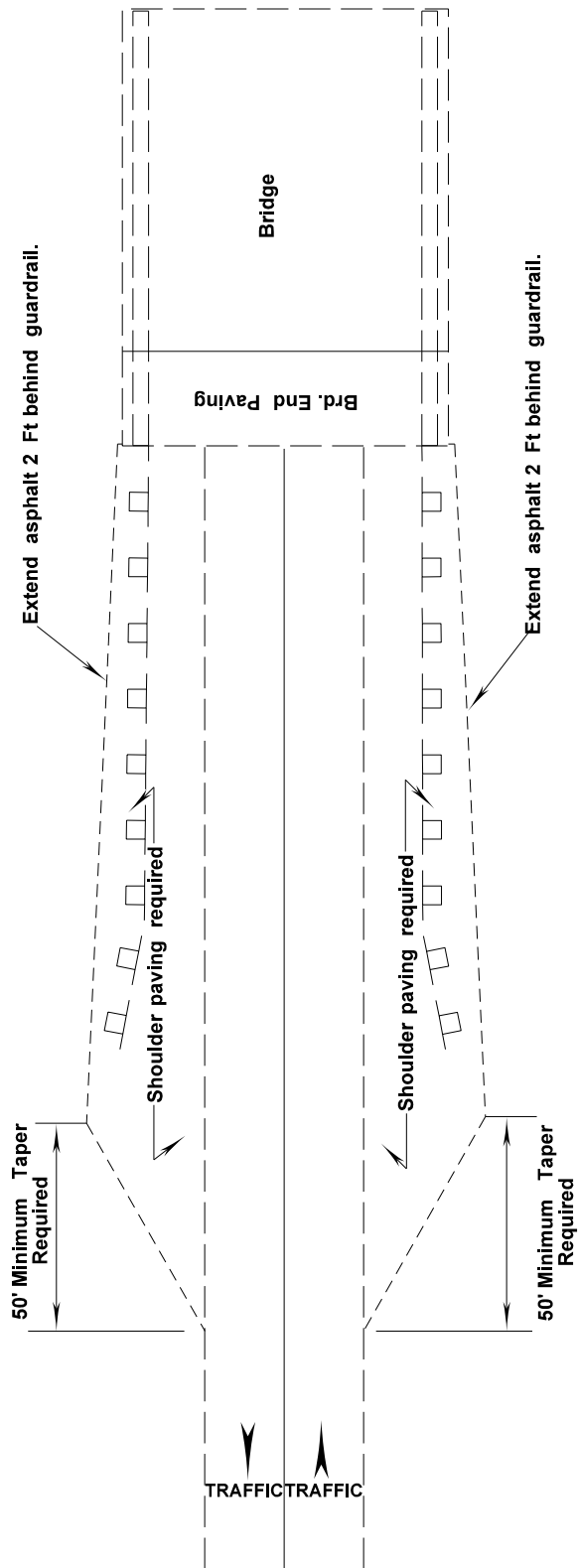

*Asphalt Thickness
See scope of work for additional details

**RANKIN COUNTY
HIGHWAY 13**

**Rankin/Simpson County Line to Highway 13 in Puckett
DRIVEWAY PAD DETAIL**

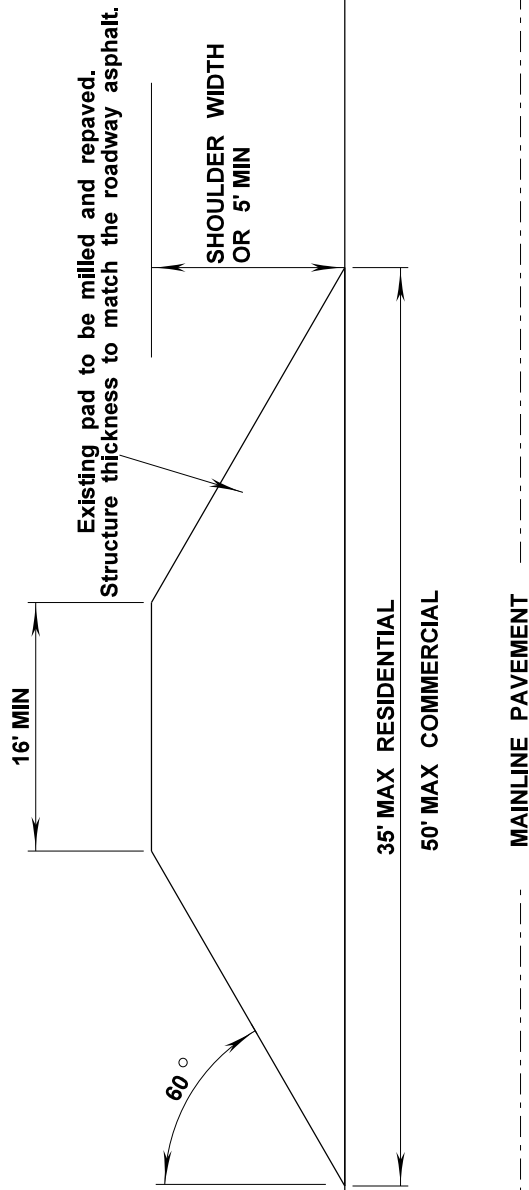

NOTE:

THE ASPHALT ON THE EXISTING DRIVEWAY/RAMP PADS ARE TO REMAIN IN THEIR CURRENT SIZE AND LOCATION AND MILLED/OVERLAID. IF, IN THE OPINION OF THE ENGINEER, A PAD SHOULD BE MODIFIED OR REPLACED, PAYMENT WILL BE MADE FOR THE WORK USING THE APPROPRIATE PAY ITEMS. GRANULAR MATERIAL AND/OR STABILIZER AGGREGATE SHOULD BE PLACED AROUND THE PADS AS REQUIRED.

RANKIN COUNTY HIGHWAY 13

DETAIL SAFETY EDGE

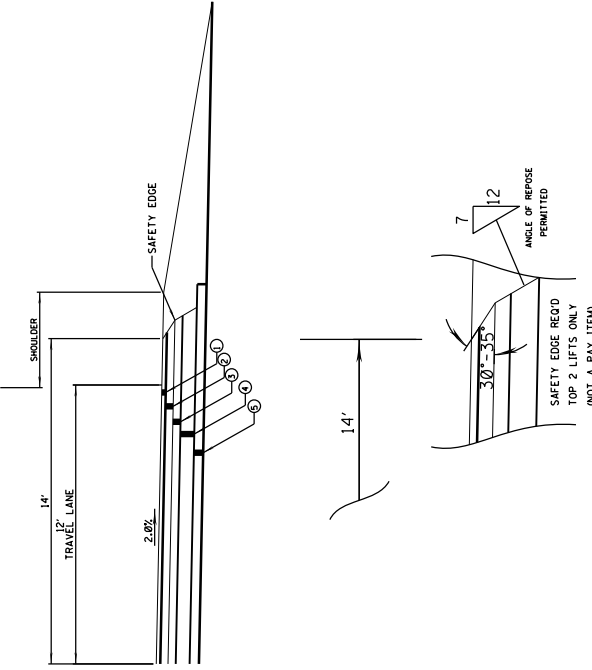
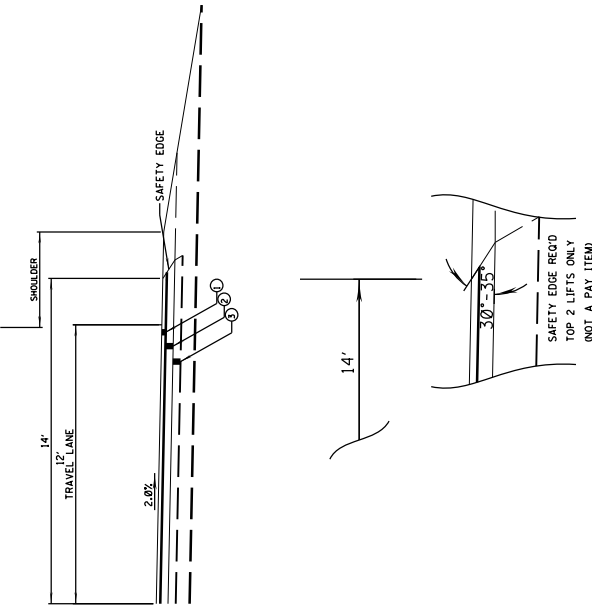
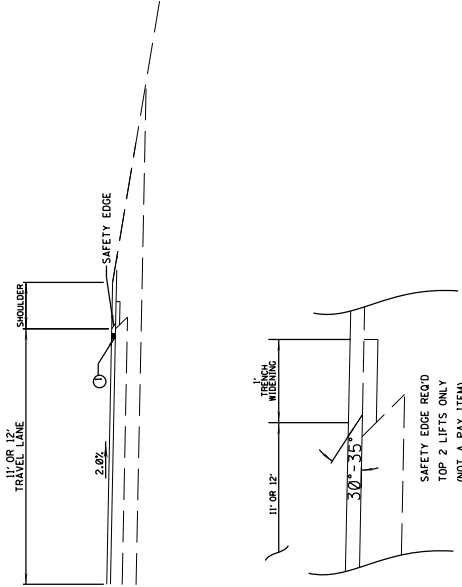
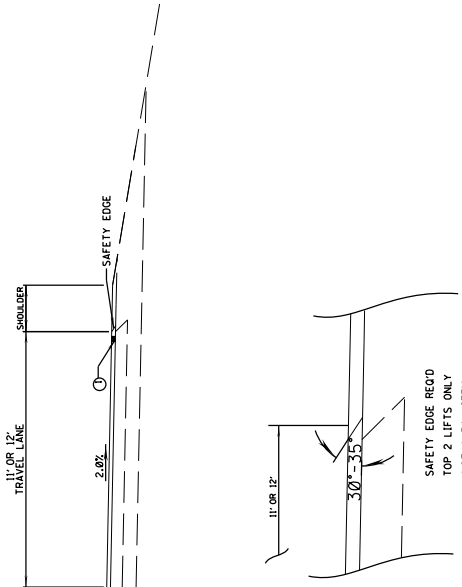
 <p>SAFETY EDGE REQ'D TOP 2 LIFTS ONLY (NOT A PAY ITEM)</p>	 <p>SAFETY EDGE REQ'D TOP 2 LIFTS ONLY (NOT A PAY ITEM)</p>
<p>NEW CONSTRUCTION</p>  <p>SAFETY EDGE REQ'D TOP 2 LIFTS ONLY (NOT A PAY ITEM)</p>	<p>OVERLAY 14' PAVEMENT</p>  <p>SAFETY EDGE REQ'D TOP 2 LIFTS ONLY (NOT A PAY ITEM)</p>
<p>OVERLAY 11' OR 12' WITH TRENCH WIDENING</p>	<p>OVERLAY 11' OR 12' WITHOUT TRENCH WIDENING</p>

RANKIN COUNTY HIGHWAY 13

From Rankin/Simpson County Line to SR13 in Puckett

RUMBLE STRIPES 2-LANE HIGHWAYS (ASPH. LANES, 2-FT ASPH. SHLD)

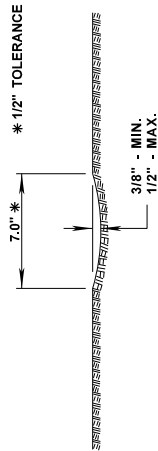
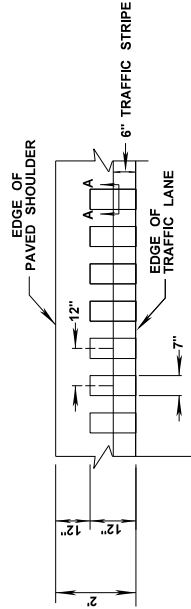

SECTION "A-A"

DETAIL "A"

GENERAL NOTES

1. GROUND-IN RUMBLE STRIPES SHALL BE APPLIED ON LEFT AND RIGHT SHOULDERS OF ALL PAVED SHOULDERS ON THIS PROJECT
2. GROUND-IN RUMBLE STRIPES SHALL BE OMITTED ACROSS PRINCIPAL INTERSECTING ROADWAYS OR OTHER INTERRUPTIONS IN NORMAL SHOULDER WIDTH AS DIRECTED BY THE ENGINEER
3. COST TO BE PAID FOR USING APPROPRIATE PAY ITEMS
4. GROUND-IN RUMBLE STRIPES SHALL BE APPLIED TO MAINLINE ONLY.
5. DO NOT USE WHERE TRAVEL LANE IS LESS THAN 11' WIDE.

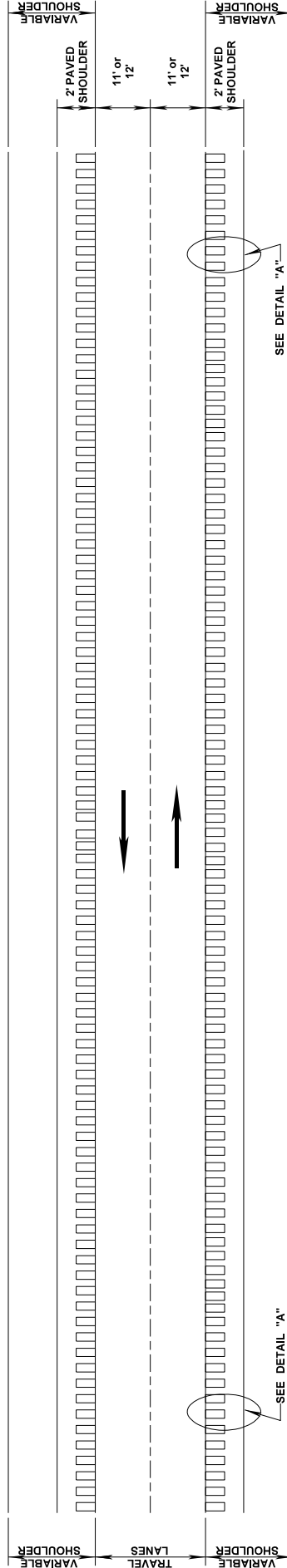

NOT TO SCALE

PLAN

**RANKIN COUNTY - 306440/301000
HIGHWAY 13
SPECIAL DESIGN
BRIDGE-GUARD RAIL CONNECTOR**

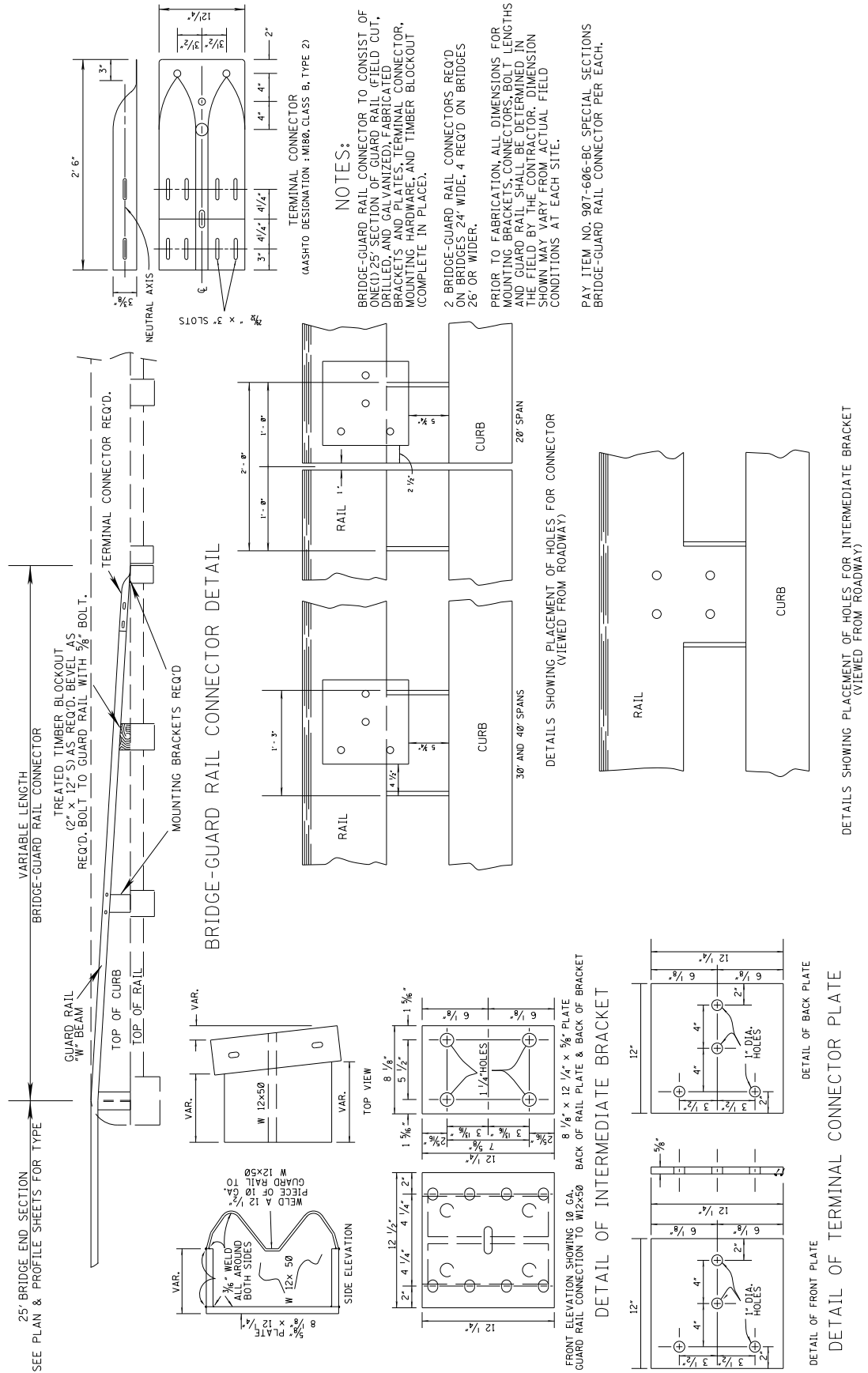

[illegible]

**RANKIN COUNTY
HIGHWAY 13**

**From Rankin/Simpson County Line to SR13 in Puckett
STRIPE DETAIL - COUNTY ROADS**

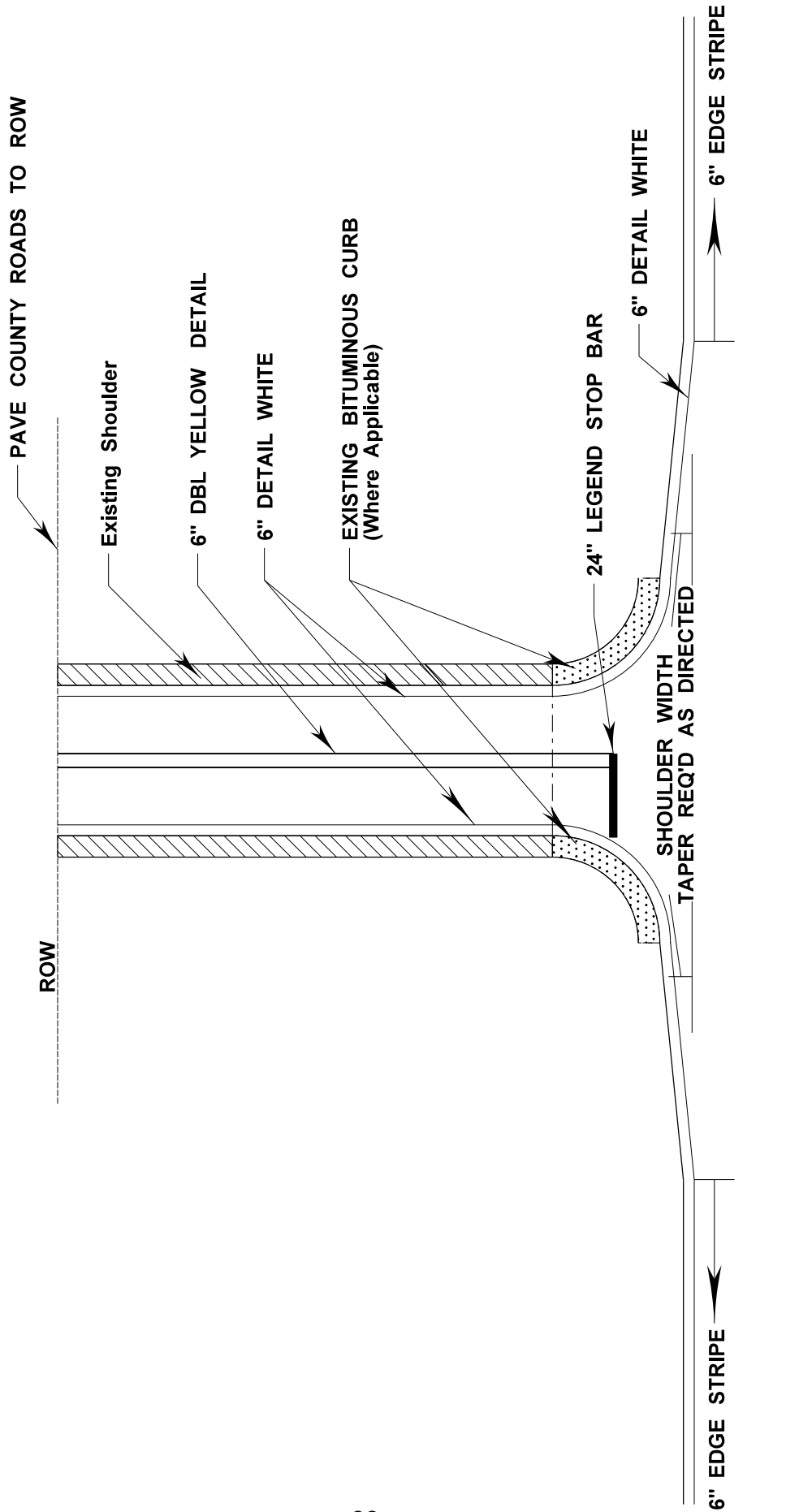

**TYPICAL FOR RAISED PAVEMENT MARKERS
PLACED ON SIDE ROAD RADIUS**

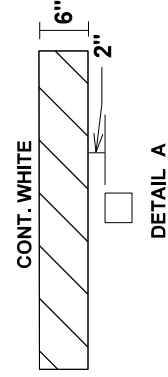
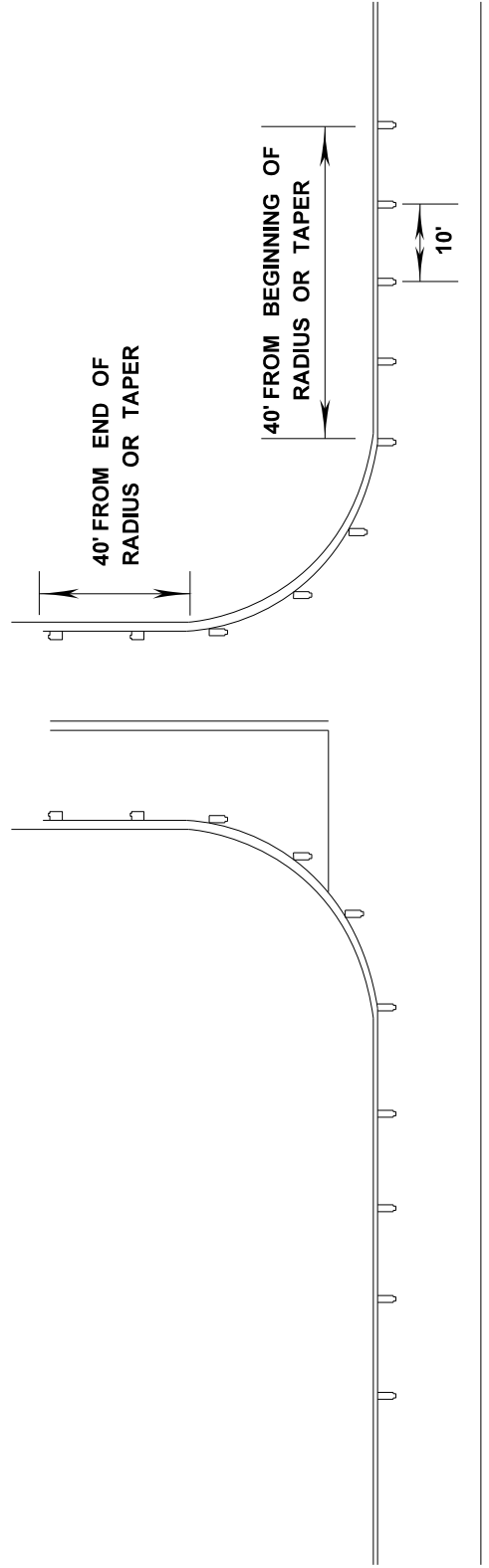

- NOTE 1. MARKERS SHALL BE PLACED EVERY 10 FEET.
- NOTE 2. MARKERS SHALL BE VISIBLE FROM THE TRAVELING MOTORIST ON STATE DESIGNATED HIGHWAYS.
- NOTE 3. MARKERS SHALL BE HIGH PERFORMANCE TWO WAY CLEAR.
- NOTE 4. FIVE (5) MARKERS SHALL BE PLACED ALONG MAINLINE EDGE STRIPE.
- NOTE 5. MARKERS FOR COUNTY ROADS SHALL CONTINUE DOWN THE EDGE STRIPE A DISTANCE OF 40 FEET.

MISSISSIPPI DEPARTMENT OF TRANSPORTATION

SECTION 904 - NOTICE TO BIDDERS NO.998

CODE: (SP)

DATE: 06/21/2018

SUBJECT: Temporary Construction Signs

PROJECT: MP-5013-61(003) / 306440301 -- Rankin County

Bidders are hereby advised of the following regarding the Temporary Construction Signs required:

Should the Bidders elect to install Temporary Construction Signs by first driving short u-channel sections and then bolting the longer, correct height u-channel sections to them, the Bidders are advised that these short sections shall be a minimum of five (5) feet from the ground level when driven and the splice must consist of a minimum of eighteen (18) inches of overlap with a total of four (4) bolts. Bidders are also advised that it is mandatory that these short sections be removed at the completion of the project.

MISSISSIPPI DEPARTMENT OF TRANSPORTATION

SPECIAL PROVISION NO. 907-102-2

CODE: (IS)

DATE: 11/22/2017

SUBJECT: Bidding Requirements and Conditions

Section 102, Bidding Requirements and Conditions, of the 2017 Edition of the Mississippi Standard Specifications for Road and Bridge Construction is hereby amended as follows.

907-102.01--Prequalification of Bidders. Delete the last sentence of the third paragraph of Subsection 102.01 on page 13, and substitute the following.

The Bidder's Certificate of Responsibility number must be on file with the Department's Contract Administration Division prior to request for permission to bid.

907-102.02--Contents of Proposal Forms. Delete the fourth paragraph in Subsection 102.02 on page 13, and substitute the following.

Prospective bidders must complete an online request for permission to be eligible to bid a project. Upon approval, the bidder will be authorized to submit a bid electronically using Bid Express at <http://bidx.com>.

MISSISSIPPI DEPARTMENT OF TRANSPORTATION

SPECIAL PROVISION NO. 907-103-2

CODE: (SP)

DATE: 06/22/2017

SUBJECT: Award and Execution of Contract

Section 103, Award and Execution of Contract, of the 2017 Edition of the Mississippi Standard Specifications for Road and Bridge Construction is hereby amended as follows.

907-103.01--Consideration of Proposal. Delete the second and third paragraphs of Subsection 103.01 on page 19, and substitute the following.

907-103.01.1--For Projects Constructed Without Federal Funds. Resident Contractors actually domiciled in Mississippi are to be granted preference over nonresidents in awarding of Contracts financed 100% with State funds.

In consideration of proposals that are equal to or in excess of \$50,000 and financed 100% with State funds, a nonresident bidder domiciled in a state having laws granting preference to local Contractors will be considered for such contracts on the same basis as the nonresident bidder's state awards contracts to Mississippi Contractors bidding under similar circumstances. When a nonresident Contractor submits a bid equal to or in excess of \$50,000 on a contract financed 100% with State funds, a copy of the current laws from the state of domicile and an explanation thereof pertaining to treatment of nonresident Contractors shall be attached. If no preferential treatment is provided for Contractors in the state of domicile and contracts are awarded to the lowest responsible bidder, a statement to this effect shall be attached. Should the attachment not accompany the bid when submitted, the Contractor shall have 10 days following the opening of the bids to furnish the required information to the Contract Administration Director for attachment to the bid. Failure to provide the attachment within 10 days will result in the nonresident Contractor's bid being rejected and not considered for award. As used herein, the term "resident Contractor" includes a nonresident person, firm or corporation that has been qualified to do business in this State and has maintained a permanent full-time office in the State of Mississippi for two years prior to the submission of the bid, and the subsidiaries and affiliates of such a person, firm or corporation.

MISSISSIPPI DEPARTMENT OF TRANSPORTATION

SPECIAL PROVISION NO. 907-619-6

CODE: (SP)

DATE: 03/21/2018

SUBJECT: Temporary Portable Rumble Strips

Section 619, Traffic Control for Construction Zones, of the 2017 Edition of the Mississippi Standard Specifications for Road and Bridge Construction is hereby amended as follows.

907-619.02--Materials. After Subsection 619.02.15 on page 472, add the following.

907-619.02.16--Temporary Portable Rumble Strips. Temporary portable rumble strips shall be RoadQuake manufactured by PSS and meet the following requirements:

- capable of being installed without adhesives or bolts,
- have a minimum weight of 100 pounds,
- have a minimum overall length of 11 feet,
- have a minimum width of 12 inches, and
- have a maximum height of 3/4 inch.

Temporary portable rumble strips shall be installed in accordance with the attached details, or as directed by the Engineer.

907-619.03--Construction Requirements. After Subsection 619.03.11 on page 476, add the following.

907-619.03.16--Temporary Portable Rumble Strips. Temporary portable rumble strips shall be placed at locations shown on the traffic control plans, attached drawing, or as directed by the Engineer. The rumble strips shall be removed when lane closures are removed, relocated when lane closures are relocated, or as directed by the Engineer.

Prior to placement of the rumble strips, the roadway shall be cleaned to be free of dust, sand, and other materials that may cause slippage. The minimum roadway temperature at the time of installation shall be in accordance with manufacturer recommendations.

A minimum of three (3) temporary portable rumble strips shall be arranged in an array. The spacing of temporary portable rumble strips in each array shall be on 15-foot centers. One array of three (3) strips shall be used in each lane. The rumble strips shall be regularly monitored and maintained to ensure they stay in place under traffic.

907-619.04--Method of Measurement. At the end of Subsection 619.04 on page 478, add the following.

Temporary Portable Rumble Strips will be measured for payment by the linear foot only when a pay item for temporary portable rumble strips is included in the contract. Otherwise, temporary portable rumble strips will be included in the cost of pay item 618-A, Maintenance of Traffic. The quantity of temporary portable rumble strips will be the length of rumble strips approved by the Engineer to be in-place on the project at any one time.

907-619.05--Basis of Payment. After the fifth paragraph of Subsection 619.05 on page 478, add the following.

Temporary Portable Rumble Strips measured as prescribed above, will be paid for at the contract unit price per linear foot, which price shall be full compensation for cleaning the roadway surface, installing the rumble strips, maintenance and repair of the strips, cleaning and resetting of the strips, removal and replacement, and for all labor, equipment, tools, and incidentals necessary to complete the work.

After the last pay item listed on page 480, add the following.

907-619-B: Temporary Portable Rumble Strips - per linear foot

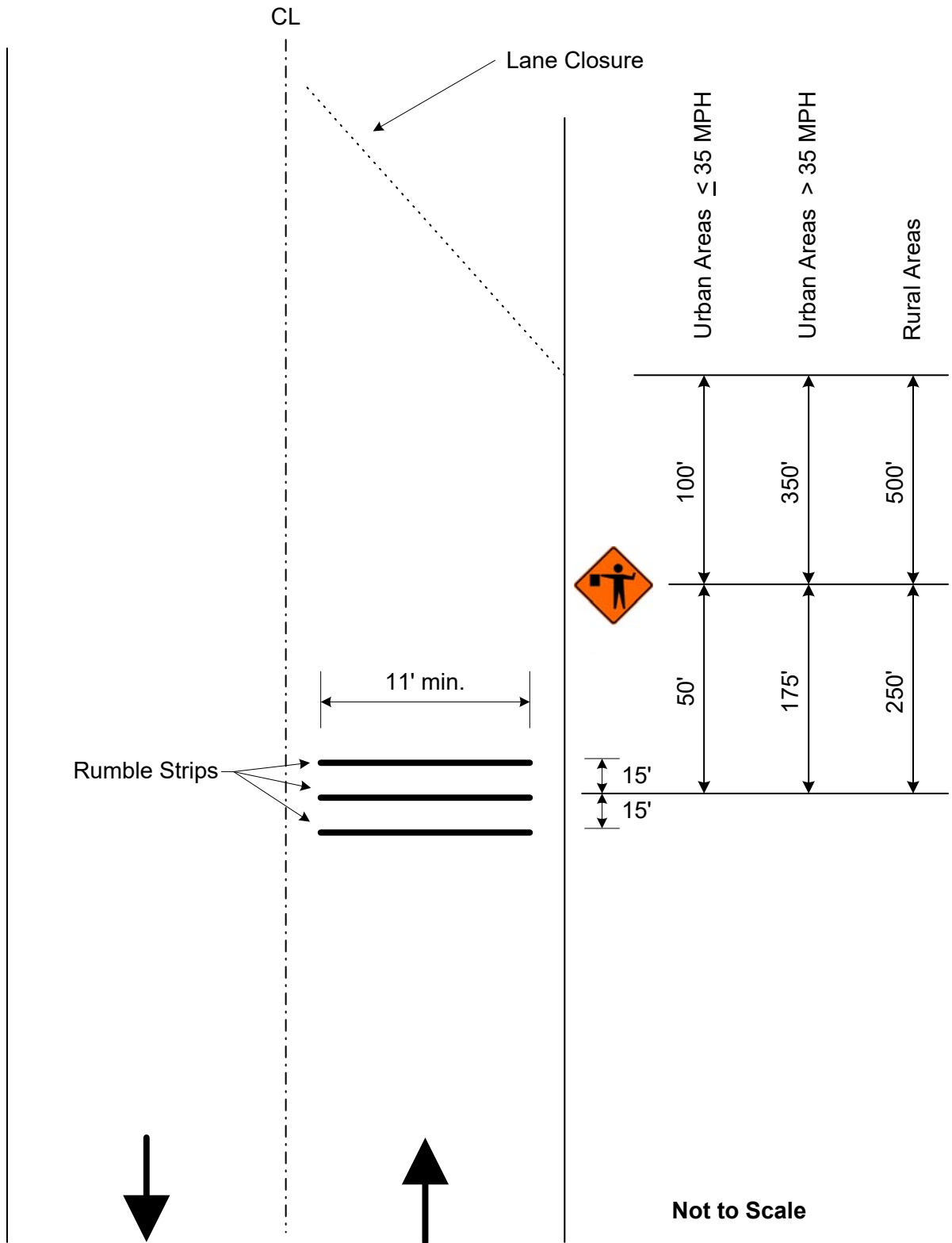

Detail of Temporary Portable Rumble Strips

SECTION 905 - PROPOSAL

Date _____

Mississippi Transportation Commission
Jackson, Mississippi

Sirs: The following proposal is made on behalf of _____
_____ of _____

for constructing the following designated project(s) within the time(s) hereinafter specified.

The plans are composed of drawings and blue prints on file in the offices of the Mississippi Department of Transportation, Jackson, Mississippi.

The Specifications are the current Standard Specifications of the Mississippi Department of Transportation approved by the Federal Highway Administration, except where superseded or amended by the plans, Special Provisions and Notice(s) to Bidders attached hereto and made a part thereof.

I (We) certify that I (we) possess a copy of said Standard and any Supplemental Specifications.

Evidence of my (our) authority to submit the Proposal is hereby furnished. The proposal is made without collusion on the part of any person, firm or corporation. I (We) certify that I (we) have carefully examined the Plans, the Specifications, including the Special Provisions and Notice(s) to Bidders, herein, and have personally examined the site of the work. On the basis of the Specifications, Special Provisions, Notice(s) to Bidders, and Plans, I (we) propose to furnish all necessary machinery, tools, apparatus and other means of construction and do all the work and furnish all the materials in the manner specified. I (We) understand that the quantities mentioned herein are approximate only and are subject to either increase or decrease, and hereby propose to perform any increased or decreased quantities of work at the unit prices bid, in accordance with the above.

I (We) acknowledge that this proposal will be found irregular and/or non-responsive unless a certified check, cashier's check, or Proposal Guaranty Bond in the amount as required in the Advertisement (or, by law) is submitted electronically with the proposal or is delivered to the Contract Administration Engineer prior to the bid opening time specified in the advertisement.

INSTRUCTION TO BIDDERS: Alternate and Optional Items on Bid Schedule.

1. Two or more items entered opposite a single unit quantity WITHOUT DEFINITE DESIGNATION AS "ALTERNATE ITEMS" are considered as "OPTIONAL ITEMS". Bidders may or may not indicate on bids the Optional Item proposed to be furnished or performed WITHOUT PREJUDICE IN REGARD TO IRREGULARITY OF BIDS.
2. Items classified on the bid schedule as "ALTERNATE ITEMS" and/or "ALTERNATE TYPES OF CONSTRUCTION" must be preselected and indicated on bids. However, "Alternate Types of Construction" may include Optional Items to be treated as set out in Paragraph 1, above.
3. Optional items not preselected and indicated on the bid schedule MUST be designated in accordance with Subsection 102.06 prior to or at the time of execution of the contract.
4. Optional and Alternate items designated must be used throughout the project.

I (We) further propose to perform all "force account or extra work" that may be required of me (us) on the basis provided in the Specifications and to give such work my (our) personal attention in order to see that it is economically performed.

I (We) further propose to execute the attached contract agreement (Section 902) as soon as the work is awarded to me (us), and to begin and complete the work within the time limit(s) provided for in the Specifications and Advertisement. I (We) also propose to execute the attached contract bond (Section 903) in an amount not less than one hundred (100) percent of the total of my (our) part, but also to guarantee the excellence of both workmanship and materials until the work is finally accepted.

I (We) shall submit electronically with our proposal or deliver prior to the bid opening time a certified check, cashier's check or bid bond for **five percent (5%) of total bid** and hereby agree that in case of my (our) failure to execute the contract and furnish bond within Ten (10) days after notice of award, the amount of this check (bid bond) will be forfeited to the State of Mississippi as liquidated damages arising out of my (our) failure to execute the contract as proposed. It is understood that in case I am (we are) not awarded the work, the check will be returned as provided in the Specifications.

SECTION 905 -- PROPOSAL (CONTINUED)

I (We) hereby certify by digital signature and electronic submission via Bid Express of the Section 905 proposal below, that all certifications, disclosures and affidavits incorporated herein are deemed to be duly executed in the aggregate, fully enforceable and binding upon delivery of the bid proposal. I (We) further acknowledge that this certification shall not extend to the bid bond or alternate security which must be separately executed for the benefit of the Commission. This signature does not cure deficiencies in any required certifications, disclosures and/or affidavits. I (We) also acknowledge the right of the Commission to require full and final execution on any certification, disclosure or affidavit contained in the proposal at the Commission's election upon award. Failure to so execute at the Commission's request within the time allowed in the Standard Specifications for execution of all contract documents will result in forfeiture of the bid bond or alternate security.

Respectfully Submitted,

DATE _____

Contractor

BY _____
Signature

TITLE _____

ADDRESS _____

CITY, STATE, ZIP _____

PHONE _____

FAX _____

E-MAIL _____

(To be filled in if a corporation)

Our corporation is chartered under the Laws of the State of _____ and the names, titles and business addresses of the executives are as follows:

President

Address

Secretary

Address

Treasurer

Address

The following is my (our) itemized proposal.

Mill & Overlay approximately 3 miles of SR 13 from the Simpson County Line to SR 18, known as State Project No. MP-5013-61(003) / 306440301 in Rankin County.

Line no.	Item Code	Adj Code	Quantity	Units	Description[Fixed Unit Price]
Roadway Items					
0010	202-B009		1,560	Square Yard	Removal of Asphalt Pavement, Failed Areas
0020	202-B158		1,200	Linear Feet	Removal of Guard Rail, Including Rails, Posts and Terminal Ends
0030	203-G002	(E)	520	Cubic Yard	Excess Excavation, LVM, AH
0040	304-D002	(GT)	1,268	Ton	Granular Material, Crushed Stone
0050	305-B002	(GY)	100	Cubic Yard	Size I Stabilizer Aggregate, Coarse
0060	403-A002	(BA1)	5,262	Ton	12.5-mm, MT, Asphalt Pavement
0070	403-B002	(BA1)	1,054	Ton	12.5-mm, MT, Asphalt Pavement, Leveling
0080	406-D001		45,140	Square Yard	Fine Milling of Bituminous Pavement, All Depths
0090	407-A001	(A2)	3,250	Gallon	Asphalt for Tack Coat
0100	423-A001		5	Mile	Rumble Strips, Ground In
0110	606-B003		700	Linear Feet	Guard Rail, Class A, Type 1, 'W' Beam, Metal Post
0120	606-D005		8	Each	Guard Rail, Bridge End Section, Type A
0130	606-E007		8	Each	Guard Rail, Terminal End Section, Non-Flared
0140	606-G003		8	Each	Special Sections, Special Design Bridge Connector
0150	618-A001		1	Lump Sum	Maintenance of Traffic
0160	619-A1001		17	Mile	Temporary Traffic Stripe, Continuous White
0170	619-A2001		16	Mile	Temporary Traffic Stripe, Continuous Yellow
0180	619-A4002		1	Mile	Temporary Traffic Stripe, Skip Yellow
0190	619-A5001		623	Linear Feet	Temporary Traffic Stripe, Detail
0200	619-A6002		480	Linear Feet	Temporary Traffic Stripe, Legend
0210	619-D1001		234	Square Feet	Standard Roadside Construction Signs, Less than 10 Square Feet
0220	619-D2001		132	Square Feet	Standard Roadside Construction Signs, 10 Square Feet or More
0230	619-F3001		40	Each	Delineators, Guard Rail, White
0240	619-G4001		24	Linear Feet	Barricades, Type III, Double Faced
0250	620-A001		1	Lump Sum	Mobilization
0260	626-C002		6	Mile	6" Thermoplastic Double Drop Edge Stripe, Continuous White
0270	626-D001		1	Mile	6" Thermoplastic Double Drop Traffic Stripe, Skip Yellow
0280	626-E001		6	Mile	6" Thermoplastic Double Drop Traffic Stripe, Continuous Yellow
0290	626-G004		377	Linear Feet	Thermoplastic Double Drop Detail Stripe, White
0300	626-G005		126	Linear Feet	Thermoplastic Double Drop Detail Stripe, Yellow
0310	626-H002		240	Linear Feet	Thermoplastic Double Drop Legend, White
0320	627-J001		80	Each	Two-Way Clear Reflective High Performance Raised Markers
0330	627-L001		348	Each	Two-Way Yellow Reflective High Performance Raised Markers
0340	630-G004		8	Each	Type 3 Object Markers, OM-3R or OM-3L

Line no.	Item Code	Adj Code	Quantity	Units	Description Fixed Unit Price
0350	907-619-B001		66	Linear Feet	Temporary Portable Rumble Strips

For Informational Purposes Only

SECTION 905 - COMBINATION BID PROPOSAL (Continued)

CONDITIONS FOR COMBINATION BID

If a bidder elects to submit a combined bid for two or more of the contracts listed for this month's letting, the bidder must complete and execute these sheets of the proposal in each of the individual proposals to constitute a combination bid. In addition to this requirement, each individual contract shall be completed, executed and submitted in the usual specified manner.

Failure to execute this Combination Bid Proposal in each of the contracts combined will be just cause for each proposal to be received and evaluated as a separate bid.

It is understood that the Mississippi Transportation Commission not only reserves the right to reject any and all proposals, but also the right to award contracts upon the basis of lowest separate bids or combination bids most advantageous to the State.

It is further understood and agreed that the Combination Bid Proposal is for comparison of bids only and that each contract shall operate in every respect as a separate contract in accordance with its proposal and contract documents.

I (We) agree to complete each contract on or before its specified completion date.

COMBINATION BID PROPOSAL

This proposal is tendered as one part of a Combination Bid Proposal utilizing option ____* of Subsection 102.11 on the following contracts:

* Option to be shown as either (a), (b), or (c).

	<u>Project No.</u>	<u>County</u>	<u>Project No.</u>	<u>County</u>
1.	_____	_____	6.	_____
2.	_____	_____	7.	_____
3.	_____	_____	8.	_____
4.	_____	_____	9.	_____
5.	_____	_____	10.	_____

(a) If Combination A has been selected, your Combination Bid is complete.

(b) If Combination B has been selected, then complete the following page.

SECTION 905 - COMBINATION BID PROPOSAL (Continued)

Project Number	Pay Item Number	Unit	Unit Price Reduction	Total Item Reduction	Total Contract Reduction
1. _____	_____ _____ _____	_____ _____ _____	_____ _____ _____	_____ _____ _____	_____
2. _____	_____ _____ _____	_____ _____ _____	_____ _____ _____	_____ _____ _____	_____
3. _____	_____ _____ _____	_____ _____ _____	_____ _____ _____	_____ _____ _____	_____
4. _____	_____ _____ _____	_____ _____ _____	_____ _____ _____	_____ _____ _____	_____
5. _____	_____ _____ _____	_____ _____ _____	_____ _____ _____	_____ _____ _____	_____
6. _____	_____ _____ _____	_____ _____ _____	_____ _____ _____	_____ _____ _____	_____
7. _____	_____ _____ _____	_____ _____ _____	_____ _____ _____	_____ _____ _____	_____
8. _____	_____ _____ _____	_____ _____ _____	_____ _____ _____	_____ _____ _____	_____

SECTION 905 - COMBINATION BID PROPOSAL (Continued)

Project Number	Pay Item Number	Unit	Unit Price Reduction	Total Item Reduction	Total Contract Reduction
9. _____ _____	_____ _____	_____ _____	_____ _____	_____ _____	
10. _____ _____	_____ _____	_____ _____	_____ _____	_____ _____	

(c) If Combination C has been selected, then initial and complete ONE of the following.

- _____ I (We) desire to be awarded work not to exceed a total monetary value of \$ _____.

_____ I (We) desire to be awarded work not to exceed _____ number of contracts.

TO: EXECUTIVE DIRECTOR, MISSISSIPPI DEPARTMENT OF TRANSPORTATION
JACKSON, MISSISSIPPI

CERTIFICATE

If awarded this contract, I (we) contemplate that portions of the contract will be sublet. I (we) certify that those subcontracts which are equal to or in excess of fifty thousand dollars (\$50,000.00) will be in accordance with regulations promulgated and adopted by the Mississippi State Board of Contractors on September 8, 2011.

I (we) agree that this notification of intent DOES NOT constitute APPROVAL of the subcontracts.

_____ (Individual or Firm)	_____ (Address)
_____ (Individual or Firm)	_____ (Address)
_____ (Individual or Firm)	_____ (Address)
_____ (Individual or Firm)	_____ (Address)

NOTE: Failure to complete the above DOES NOT preclude subsequent subcontracts. Subsequent subcontracts, if any, equal to or in excess of fifty thousand dollars (\$50,000.00) will be in accordance with regulations promulgated and adopted by the Mississippi State Board of Contractors on September 8, 2011.

Contractor _____

MISSISSIPPI DEPARTMENT OF TRANSPORTATION
CERTIFICATION

I, _____,
(Name of person signing bid)

individually, and in my capacity as _____ of
(Title of person signing bid)

(Name of Firm, partnership, or Corporation)

do hereby certify under penalty of perjury under the laws of the United States and the State of Mississippi

that _____, Bidder
(Name of Firm, Partnership, or Corporation)

on Project No. **MP-5013-61(003)/ 306440301000**

in **Rankin** _____ County(ies), Mississippi, has not either directly or indirectly entered into any agreement, participated in any collusion; or otherwise taken any action in restraint of free competitive bidding in connection with this contract; nor have any of its corporate officers or principal owners.

Except as noted hereafter, it is further certified that said legal entity and its corporate officers, principal owners, managers, auditors and others in a position of administering federal funds are not currently under suspension, debarment, voluntary exclusion or determination of ineligibility; nor have a debarment pending; nor been suspended, debarred, voluntarily excluded or determined ineligible within the past three years by the Mississippi Transportation Commission, the State of Mississippi, any other State or a federal agency; nor been indicted, convicted or had a civil judgment rendered by a court of competent jurisdiction in any matter involving fraud or official misconduct within the past three years.

Do exceptions exist and are made a part thereof? Yes / No

Any exceptions shall address to whom it applies, initiating agency and dates of such action.

Note: Exceptions will not necessarily result in denial of award but will be considered in determining bidder responsibility. Providing false information may result in criminal prosecution or administrative sanctions.

All of the foregoing is true and correct.

(1/2016 S)

SECTION 902

CONTRACT FOR MP-5013-61(003)/ 306440301000

LOCATED IN THE COUNTY(IES) OF Rankin

STATE OF MISSISSIPPI,
COUNTY OF HINDS

This contract entered into by and between the Mississippi Transportation Commission on one hand, and the undersigned contractor, on the other witnesseth;

That, in consideration of the payment by the Mississippi Transportation Commission of the prices set out in the proposal hereto attached, to the undersigned contractor, such payment to be made in the manner and at the time of times specified in the specifications and the special provisions, if any, the undersigned contractor hereby agrees to accept the prices stated in the proposal in full compensation for the furnishing of all materials and equipment and the executing of all the work contemplated in this contract.

It is understood and agreed that the advertising according to law, the Advertisement, the instructions to bidders, the proposal for the contract, the specifications, the revisions of the specifications, the special provisions, and also the plans for the work herein contemplated, said plans showing more particularly the details of the work to be done, shall be held to be, and are hereby made a part of this contract by specific reference thereto and with like effect as if each and all of said instruments had been set out fully herein in words and figures.

It is further agreed that for the same consideration the undersigned contractor shall be responsible for all loss or damage arising out of the nature of the work aforesaid; or from the action of the elements and unforeseen obstructions or difficulties which may be encountered in the prosecution of the same and for all risks of every description connected with the work, exceptions being those specifically set out in the contract; and for faithfully completing the whole work in good and workmanlike manner according to the approved Plans, Specifications, Special Provisions, Notice(s) to Bidders and requirements of the Mississippi Department of Transportation.

It is further agreed that the work shall be done under the direct supervision and to the complete satisfaction of the Executive Director of the Mississippi Department of Transportation, or his authorized representatives, and when Federal Funds are involved subject to inspection at all times and approval by the Federal Highway Administration, or its agents as the case may be, or the agents of any other Agency whose funds are involved in accordance with those Acts of the Legislature of the State of Mississippi approved by the Governor and such rules and regulations issued pursuant thereto by the Mississippi Transportation Commission and the authorized Federal Agencies.

The Contractor agrees that all labor as outlined in the Special Provisions may be secured from list furnished by

It is agreed and understood that each and every provision of law and clause required by law to be inserted in this contract shall be deemed to be inserted herein and this contract shall be read and enforced as though it were included herein, and, if through mere mistake or otherwise any such provision is not inserted, then upon the application of either party hereto, the contract shall forthwith be physically amended to make such insertion.

The Contractor agrees that he has read each and every clause of this Contract, and fully understands the meaning of same and that he will comply with all the terms, covenants and agreements therein set forth.

Witness our signatures this the ____ day of _____, _____.

Contractor(s)

By _____

Title _____

Signed and sealed in the presence of:
(names and addresses of witnesses)

MISSISSIPPI TRANSPORTATION COMMISSION

By _____

Executive Director

Secretary to the Commission

Award authorized by the Mississippi Transportation Commission in session on the ____ day of _____, _____, Minute Book No. _____, Page No. _____.

Revised 8/06/2003

SECTION 903
PERFORMANCE AND PAYMENT BOND

CONTRACT BOND FOR: MP-5013-61(003)/ 306440301000

LOCATED IN THE COUNTY(IES) OF: Rankin

STATE OF MISSISSIPPI,
COUNTY OF HINDS

Know all men by these presents: that we, _____
_____, (Contractor)
_____, Principal, a _____

residing at _____ in the State of _____

and _____
_____, (Surety)

residing at _____ in the State of _____,

authorized to do business in the State of Mississippi, under the laws thereof, as surety, effective as of the contract date

shown below, are held and firmly bound unto the State of Mississippi in the sum of _____

(\$ _____) Dollars, lawful money of the United States of America, to be paid to it for which
payment well and truly to be made, we bind ourselves, our heirs, administrators, successors, or assigns jointly and
severally by these presents.

The conditions of this bond are such, that whereas the said _____

principal, has (have) entered into a contract with the Mississippi Transportation Commission, bearing the date of
_____ day of _____ A.D. _____ hereto annexed, for the construction of certain projects(s) in
the State of Mississippi as mentioned in said contract in accordance with the Contract Documents therefor, on file in the
offices of the Mississippi Department of Transportation, Jackson, Mississippi.

Now therefore, if the above bounden _____
_____ in all things shall stand to and abide by and well and truly observe, do keep and perform all and
singular the terms, covenants, conditions, guarantees and agreements in said contract, contained on his (their) part to be
observed, done, kept and performed and each of them, at the time and in the manner and form and furnish all of the
material and equipment specified in said contract in strict accordance with the terms of said contract which said plans,
specifications and special provisions are included in and form a part of said contract and shall maintain the said work
contemplated until its final completion and acceptance as specified in Subsection 109.11 of the approved specifications,
and save harmless said Mississippi Transportation Commission from any loss or damage arising out of or occasioned by
the negligence, wrongful or criminal act, overcharge, fraud, or any other loss or damage whatsoever, on the part of said
principal (s), his (their) agents, servants, or employees in the performance of said work or in any manner connected
therewith, and shall be liable and responsible in a civil action instituted by the State at the instance of the Mississippi
Transportation Commission or any officer of the State authorized in such cases, for double any amount in money or
property, the State may lose or be overcharged or otherwise defrauded of, by reason of wrongful or criminal act, if any, of
the Contractor(s), his (their) agents or employees, and shall promptly pay the said agents, servants and employees and all
persons furnishing labor, material, equipment or supplies therefor, including premiums incurred, for Surety Bonds,
Liability Insurance, and Workmen's Compensation Insurance; with the additional obligation that such Contractor shall
promptly make payment of all taxes, licenses, assessments, contributions, damages,

any liquidated damages which may arise prior to any termination of said principal's contract, any liquidated damages which may arise after termination of the said principal's contract due to default on the part of said principal, penalties and interest thereon, when and as the same may be due this state, or any county, municipality, board, department, commission or political subdivision: in the course of the performance of said work and in accordance with Sections 31-5-51 et seq. Mississippi Code of 1972, and other State statutes applicable thereto, and shall carry out to the letter and to the satisfaction of the Executive Director of the Mississippi Department of Transportation, all, each and every one of the stipulations, obligations, conditions, covenants and agreements and terms of said contract in accordance with the terms thereof and all of the expense and cost and attorney's fee that may be incurred in the enforcement of the performance of said contract, or in the enforcement of the conditions and obligations of this bond, then this obligation shall be null and void, otherwise to be and remain in full force and virtue.

_____ (Contractors) Principal	_____ Surety
By _____	By _____ (Signature) Attorney in Fact
	Address _____ _____ _____
Title _____ (Contractor's Seal)	_____ (Printed) MS Agent
	_____ (Signature) MS Agent
	Address _____ _____ _____ (Surety Seal)
	_____ Mississippi Insurance ID Number



BID BOND

KNOW ALL MEN BY THESE PRESENTS, that we _____
Contractor

Address

City, State ZIP

As principal, hereinafter called the Principal, and _____
Surety

a corporation duly organized under the laws of the state of _____

as Surety, hereinafter called the Surety, are held and firmly bound unto **State of Mississippi, Jackson, Mississippi**

As Obligee, hereinafter called Obligee, in the sum of **Five Per Cent (5%) of Amount Bid**

Dollars(\$ _____)

for the payment of which sum will and truly to be made, the said Principal and said Surety, bind ourselves, our heirs, executors, administrators, successors and assigns, jointly and severally, firmly by these presents.

WHEREAS, the Principal has submitted a bid for **Mill & Overlay approximately 3 miles of SR 13 from the Simpson County Line to SR 18, known as State Project No. MP-5013-61(003) / 306440301 in Rankin County.**

NOW THEREFORE, the condition of this obligation is such that if the aforesaid Principal shall be awarded the contract, the said Principal will, within the time required, enter into a formal contract and give a good and sufficient bond to secure the performance of the terms and conditions of the contract, then this obligation to be void; otherwise the Principal and Surety will pay unto the Obligee the difference in money between the amount of the bid of the said Principal and the amount for which the Obligee legally contracts with another party to perform the work if the latter amount be in excess of the former, but in no event shall liability hereunder exceed the penal sum hereof.

Signed and sealed this _____ day of _____, 20____

(Witness)

(Witness)

(Principal) (Seal)

By: _____
(Name) (Title)

(Surety) (Seal)

By: _____
(Attorney-in-Fact)

(MS Agent)

Mississippi Insurance ID Number

[illegible]

NOTE: THE ANTICIPATED WORKING DAYS SHOWN ON THIS SCHEDULE ARE FOR INFORMATIONAL PURPOSES ONLY. THE ACTUAL WORKING DAY TOTAL AS ASSESSED BY THE PROJECT ENGINEER ON FORM CSD-765 SHALL GOVERN.