

## SECTION 905 -- PROPOSAL (CONTINUED)

I (We) hereby certify by digital signature and electronic submission via Bid Express of the Section 905 proposal below, that all certifications, disclosures and affidavits incorporated herein are deemed to be duly executed in the aggregate, fully enforceable and binding upon delivery of the bid proposal. I (We) further acknowledge that this certification shall not extend to the bid bond or alternate security which must be separately executed for the benefit of the Commission. This signature does not cure deficiencies in any required certifications, disclosures and/or affidavits. I (We) also acknowledge the right of the Commission to require full and final execution on any certification, disclosure or affidavit contained in the proposal at the Commission's election upon award. Failure to so execute at the Commission's request within the time allowed in the Standard Specifications for execution of all contract documents will result in forfeiture of the bid bond or alternate security.

Bidder acknowledges receipt of and has added to and made a part of the proposal and contract documents the following addendum (addenda):

ADDENDUM NO.	<u>1</u>	DATED	<u>8/20/2018</u>	ADDENDUM NO.	_____	DATED	_____
ADDENDUM NO.	_____	DATED	_____	ADDENDUM NO.	_____	DATED	_____
ADDENDUM NO.	_____	DATED	_____	ADDENDUM NO.	_____	DATED	_____

Number

Description

- 1 Revised NTB Nos. 2, & 1002; Revised Bid Items; Revised or Added Plan Sheet Nos. 2,10-11, & 40; Amendment EBS Download Required.

TOTAL ADDENDA: 1

(Must agree with total addenda issued prior to opening of bids)

Respectfully Submitted,

DATE \_\_\_\_\_

Contractor

BY \_\_\_\_\_

Signature

TITLE \_\_\_\_\_

ADDRESS \_\_\_\_\_

CITY, STATE, ZIP \_\_\_\_\_

PHONE \_\_\_\_\_

FAX \_\_\_\_\_

E-MAIL \_\_\_\_\_

(To be filled in if a corporation)

Our corporation is chartered under the Laws of the State of \_\_\_\_\_ and the names, titles and business addresses of the executives are as follows:

President

Address

Secretary

Address

Treasurer

Address

The following is my (our) itemized proposal.

HSIP-0015-01(121)/ 106699301000

Lincoln County(ies)

Revised 01/26/2016

# **MISSISSIPPI DEPARTMENT OF TRANSPORTATION**

## **SECTION 904 - NOTICE TO BIDDERS NO. 2**

**CODE: (IS)**

**DATE: 03/01/2017**

**SUBJECT: Status of Right-of-Way**

Although it is desirable to have acquired all rights-of-way and completed all railroad agreements, utility adjustments and work to be performed by others prior to receiving bids, sometimes it is not considered to be in the public interest to wait until each and every such clearance has been obtained. The bidder is hereby advised of possible unacquired rights-of-way, relocates, railroad agreements and utilities adjustments which have not been completed.

The status of right-of-way acquisition, utility adjustments, encroachments, potentially contaminated sites, railroad facilities, improvements, and asbestos contamination are set forth in the following attachments.

In the event right of entry is not available to ALL parcels of right-of-way and/or all work that is to be accomplished by others on the date set forth in the contract for the Notice to Proceed is not complete, the Department will issue a restricted Notice to Proceed.

**STATUS OF RIGHT-OF-WAY**

HSIP-0015-01(021)

106699-301000

Lincoln County

August 20, 2018

All rights of way and legal rights of entry have been acquired, **except**:

None.

ASBESTOS CONTAMINATION STATUS OF BUILDINGS  
TO BE REMOVED BY THE CONTRACTOR  
HSIP-0015-01(121)  
106699-301000  
Lincoln County  
May 30, 2018

Reference is made to notices to bidders entitled "Asbestos National Emission Standards for Hazardous Air Pollutants (NESHAP)" and "Removal of Obstructions".

The following pertinent information is furnished concerning asbestos containing materials (ACMs), if any, found in buildings to be removed by the Contractor.

There are no buildings in the contract to be removed.



STATUS OF POTENTIALLY CONTAMINATED SITES

HSIP-0015-01(121)

106699-301000

Lincoln County

May 30, 2018

This project has been inspected and there was no visible indication of potentially contaminated sites within the proposed right of way.

# MISSISSIPPI DEPARTMENT OF TRANSPORTATION

## *Inter-Departmental Memorandum*

TO: Ms. Trudi Loflin  
Right-of-Way Division (84-01)

DATE: 8/20/2018

FROM: Gregory L. Wilkinson *GLW*  
District Seven Preconstruction (17-01)

SUBJECT OR PROJECT NO: HSIP-0015-01(021)/106699301000

INFORMATION COPY TO:

COUNTY: Lincoln

Preconstruction File  
Central File  
District Seven (Mr. White & Mr. Morris)  
District Seven (Ms. Brock)  
Construction Division (Ms. Lamey)

1. **STATUS OF RIGHT OF WAY:** All ROW necessary for construction has been acquired.
2. **RIGHT OF WAY CLEARANCE:** There are no encroachments.
3. **STATUS OF AFFECTED RAILROAD OPERATING FACILITIES:** None affected.
4. **STATUS OF REQUIRED UTILITY RELOCATIONS:** All known utilities in conflict with construction have been relocated.
5. **STATUS OF CONSTRUCTION AGREEMENT:** A construction agreement with the County has been executed dated July 17, 2017.

If any other information is required, please advise.

Improvements to be included in Notice to Bidders to be removed by the Construction Contractor

FMS Construction Project No: 106699-301000

FMS ROW Project No: 106699-201000

External ROW No: HSIP-0015-01(121)

Parcel No:

Station No:

Property Owner:

Description/Pictures:

**NA**

# MISSISSIPPI DEPARTMENT OF TRANSPORTATION

SECTION 904 - NOTICE TO BIDDERS NO. 1002

DATE: 08/20/2018

SUBJECT: Specialty Items

PROJECT: HSIP-0015-01(121)/106699301 - LINCOLN

Pursuant to the provisions of Section 108, the following work items are hereby designated as "Specialty Items" for this contract. Bidders are reminded that these items must be subcontracted in order to be considered as specialty items.

## CATEGORY: CURBING, SIDEWALKS, GUTTERS

---

Line No	Pay Item	Description
0450	609-D001	Combination Concrete Curb and Gutter Type 1
0460	609-D002	Combination Concrete Curb and Gutter Type 1 Modified
0470	609-D003	Combination Concrete Curb and Gutter Type 2
0480	609-D004	Combination Concrete Curb and Gutter Type 2 Modified

## CATEGORY: EROSION CONTROL

---

Line No	Pay Item	Description
0150	216-A001	Solid Sodding
0160	217-A001	Ditch Liner
0170	219-A001	Watering
0180	221-A001	Concrete Paved Ditch
0190	224-A001	Soil Reinforcing Mat
0200	226-A001	Temporary Grassing
0210	234-A001	Temporary Silt Fence
0220	234-D001	Inlet Siltation Guard
0230	234-E001	Reset Inlet Siltation Guard
0240	237-A002	Wattles, 20"
0250	245-A001	Silt Dike
0260	246-B001	Rockbags
0270	249-A001	Riprap for Erosion Control

## CATEGORY: MISCELLANEOUS/ SPECIALTY WORK ITEMS

---

Line No	Pay Item	Description
0340	423-A001	Rumble Strips, Ground In

## CATEGORY: PAVEMENT STRIPING AND MARKING

---

Line No	Pay Item	Description
0710	626-A003	6" Thermoplastic Traffic Stripe, Skip White
0720	626-C001	6" Thermoplastic Double Drop Edge Stripe, Continuous White
0730	626-E003	6" Thermoplastic Traffic Stripe, Continuous Yellow
0740	626-F002	6" Thermoplastic Double Drop Edge Stripe, Continuous Yellow

#### CATEGORY: PAVEMENT STRIPING AND MARKING

---

Line No	Pay Item	Description
0750	626-G002	Thermoplastic Detail Stripe, White
0760	626-G003	Thermoplastic Detail Stripe, Yellow
0770	626-H004	Thermoplastic Legend, White
0780	626-H005	Thermoplastic Legend, White
0790	627-J001	Two-Way Clear Reflective High Performance Raised Markers
0800	627-K001	Red-Clear Reflective High Performance Raised Markers
0810	627-L001	Two-Way Yellow Reflective High Performance Raised Markers

#### CATEGORY: SURVEY AND STAKING

---

Line No	Pay Item	Description
1010	699-A001	Roadway Construction Stakes

#### CATEGORY: TRAFFIC CONTROL - PERMANENT

---

Line No	Pay Item	Description
0820	630-A001	Standard Roadside Signs, Sheet Aluminum, 0.080" Thickness
0830	630-A003	Standard Roadside Signs, Sheet Aluminum, 0.125" Thickness
0840	630-B002	Interstate Directional Signs, Bolted Extruded Aluminum Panels, Ground Mounted
0850	630-C002	Steel U-Section Posts, 2.0 lb/ft
0860	630-C003	Steel U-Section Posts, 3.0 lb/ft
0870	630-D007	Structural Steel Beams, W6 x 15
0880	630-D008	Structural Steel Beams, W6 x 9
0890	630-E001	Structural Steel Angles & Bars, 3 1/2" x 3 1/2" x 1/4" Angles
0900	630-E002	Structural Steel Angles & Bars, 3" x 3" x 1/4" Angles
0910	630-E004	Structural Steel Angles & Bars, 7/16" x 2 1/2" Flat Bar
0920	630-F011	Delineators, Post Mounted, Double Yellow
0930	630-F013	Delineators, Post Mounted, Single Yellow
0940	630-K001	Welded & Seamless Steel Pipe Posts, 3 1/2"
0950	630-K002	Welded & Seamless Steel Pipe Posts, 3"
0960	630-K003	Welded & Seamless Steel Pipe Posts, 4"
0970	635-A059	Traffic Signal Head, Type 1
0980	635-A065	Traffic Signal Head, Type 2 FYA
0990	635-A073	Traffic Signal Head, Type 4
1000	638-A006	Flasher Assembly, Prepare To Stop
1040	907-632-A007	Solid State Traffic Cabinet Assembly, Type III Cabinet, Type 1 Controller
1050	907-632-J001	Power Service Pedestal
1060	907-634-A104	Traffic Signal Equipment Pole, Type II, 22' Shaft, 25' Arm
1070	907-634-A117	Traffic Signal Equipment Pole, Type II, 22' Shaft, 90' Arm
1080	907-634-A118	Traffic Signal Equipment Pole, Type II, 22' Shaft, 95' Arm
1090	907-634-C001	Pole Foundations, Class "B" Concrete
1100	907-636-B013	Electric Cable, Underground in Conduit, IMSA 20-1, AWG 14, 4 Conductor
1110	907-636-B016	Electric Cable, Underground in Conduit, IMSA 20-1, AWG 14, 8 Conductor

CATEGORY: TRAFFIC CONTROL - PERMANENT

---

Line No	Pay Item	Description
1120	907-636-B028	Electric Cable, Underground in Conduit, IMSA 20-1, AWG 8, 3 Conductor
1130	907-636-D005	Electric Cable, Aerial Supported in Conduit, IMSA 20-1, AWG 14, 4 Conductor
1140	907-636-D008	Electric Cable, Aerial Supported in Conduit, IMSA 20-1, AWG 14, 8 Conductor
1150	907-636-D014	Electric Cable, Aerial Supported in Conduit, IMSA 20-1, AWG 8, 3 Conductor
1160	907-637-A002	Pullbox Enclosure, Type 2
1170	907-637-A003	Pullbox Enclosure, Type 3
1180	907-637-C028	Traffic Signal Conduit, Underground, Type 4, 2"
1190	907-637-C030	Traffic Signal Conduit, Underground, Type 4, 3"
1200	907-637-D003	Traffic Signal Conduit, Underground Drilled or Jacked, Rolled Pipe, 3"
1210	907-641-A002	Signal Stop Bar Radar Vehicle Detection Sensor, Type 2
1220	907-641-B002	Signal Advanced Radar Vehicle Detection Sensor, Type 2
1230	907-641-D001	Radar Vehicle Detection Cable
1240	907-653-B001	Street Name Sign
1250	907-663-C001	Cellular Modem

CATEGORY: TRAFFIC CONTROL - TEMPORARY

---

Line No	Pay Item	Description
0550	619-A1002	Temporary Traffic Stripe, Continuous White
0560	619-A2002	Temporary Traffic Stripe, Continuous Yellow
0570	619-A3002	Temporary Traffic Stripe, Skip White
0580	619-A5001	Temporary Traffic Stripe, Detail
0590	619-A6002	Temporary Traffic Stripe, Legend
0600	619-D1001	Standard Roadside Construction Signs, Less than 10 Square Feet
0610	619-D2001	Standard Roadside Construction Signs, 10 Square Feet or More
0620	619-E1001	Flashing Arrow Panel, Type C
0630	619-F1001	Concrete Median Barrier, Precast
0640	619-F2001	Remove and Reset Concrete Median Barrier, Precast
0650	619-G4001	Barricades, Type III, Double Faced
0660	619-G4005	Barricades, Type III, Single Faced
0670	619-G4006	Barricades, Type III, Single Faced, Permanent
0680	619-G5001	Free Standing Plastic Drums
0690	619-G7001	Warning Lights, Type "B"
0692	619-J1001	Impact Attenuator, 40 MPH
0694	619-J3001	Remove and Reset Impact Attenuator

Intersection Improvements on US 84 at Auburn Road, known as Federal Aid Project No. HSIP-0015-01(121) / 106699301 in Lincoln County.

Line No.	Item Code	Adj Code	Quantity	Units	Description [Fixed Unit Price]
Roadway Items					
0010	201-A001		1	Lump Sum	Clearing and Grubbing
0020	201-B001		1	Acre	Clearing and Grubbing
0030	202-B007		9,514	Square Yard	Removal of Asphalt Pavement, All Depths
0040	202-B050		753	Linear Feet	Removal of Concrete Combination Curb & Gutter
0050	202-B052		1,493	Square Yard	Removal of Concrete Driveways, All Depths
0060	202-B059		237	Square Yard	Removal of Concrete Median & Island Pavement, All Depths
0070	202-B063		17	Square Yard	Removal of Concrete Paved Ditch
0080	202-B165		3	Each	Removal of Inlets, All Sizes
0090	202-B191		60	Linear Feet	Removal of Pipe, 8" And Above
0100	202-B215		18	Each	Removal of Sign Including Post & Footing
0110	203-A001	(E)	6,121	Cubic Yard	Unclassified Excavation, FM, AH
0120	203-EX020	(E)	3,080	Cubic Yard	Borrow Excavation, AH, FME, Class B9
0130	206-A001	(S)	328	Cubic Yard	Structure Excavation
0140	209-A005		34,824	Square Yard	Geotextile Stabilization, Type V, Non-Woven
0150	216-A001		11,664	Square Yard	Solid Sodding
0160	217-A001		249	Square Yard	Ditch Liner
0170	219-A001		243	Thousand Gallon	Watering [\$20.00]
0180	221-A001	(S)	25	Cubic Yard	Concrete Paved Ditch
0190	224-A001		84	Square Yard	Soil Reinforcing Mat
0200	226-A001		3	Acre	Temporary Grassing
0210	234-A001		5,000	Linear Feet	Temporary Silt Fence
0220	234-D001		2	Each	Inlet Siltation Guard
0230	234-E001		2	Each	Reset Inlet Siltation Guard
0240	237-A002		487	Linear Feet	Wattles, 20"
0250	245-A001		100	Linear Feet	Silt Dike
0260	246-B001		600	Each	Rockbags
0270	249-A001		100	Ton	Riprap for Erosion Control
0280	304-A007	(GY)	1,358	Cubic Yard	Granular Material, LVM, Class 6, Group C
0290	403-A005	(BA1)	5,471	Ton	19-mm, MT, Asphalt Pavement
0300	403-A014	(BA1)	2,511	Ton	9.5-mm, MT, Asphalt Pavement
0310	403-B005	(BA1)	124	Ton	19-mm, MT, Asphalt Pavement, Leveling
0320	406-D001		14,392	Square Yard	Fine Milling of Bituminous Pavement, All Depths
0330	407-A001	(A2)	2,264	Gallon	Asphalt for Tack Coat

Line No.	Item Code	Adj Code	Quantity	Units	Description [Fixed Unit Price]
0340	423-A001		1	Mile	Rumble Strips, Ground In
0350	503-C010		1,083	Linear Feet	Saw Cut, Full Depth
0360	601-B001	(S)	20	Cubic Yard	Class "B" Structural Concrete, Minor Structures
0370	602-A001	(S)	1,697	Pounds	Reinforcing Steel
0380	603-ALT003	(S)	256	Linear Feet	18" Type A Alternate Pipe
0390	603-CA011	(S)	808	Linear Feet	18" Reinforced Concrete Pipe, Class III
0400	603-CA026	(S)	72	Linear Feet	24" Reinforced Concrete Pipe, Class III
0410	603-CB003	(S)	3	Each	18" Reinforced Concrete End Section
0420	603-CE008	(S)	56	Linear Feet	29" x 18" Concrete Arch Pipe, Class A III
0430	604-A001		244	Pounds	Castings
0440	604-B001		827	Pounds	Gratings
0450	609-D001	(S)	118	Linear Feet	Combination Concrete Curb and Gutter Type 1
0460	609-D002	(S)	492	Linear Feet	Combination Concrete Curb and Gutter Type 1 Modified
0470	609-D003	(S)	518	Linear Feet	Combination Concrete Curb and Gutter Type 2
0480	609-D004	(S)	803	Linear Feet	Combination Concrete Curb and Gutter Type 2 Modified
0490	614-B005	(S)	1,182	Square Yard	Concrete Driveway, With Reinforcement, 9-inch Thickness
0500	616-A001	(S)	189	Square Yard	Concrete Median and/or Island Pavement, 10-inch
0510	616-A004	(S)	440	Square Yard	Concrete Median and/or Island Pavement, 4-inch
0520	617-A001		20	Each	Right-of-Way Marker
0530	617-B001		25	Each	Permanent Easement Marker
0540	618-A001		1	Lump Sum	Maintenance of Traffic
0550	619-A1002		11,888	Linear Feet	Temporary Traffic Stripe, Continuous White
0560	619-A2002		10,872	Linear Feet	Temporary Traffic Stripe, Continuous Yellow
0570	619-A3002		3,621	Linear Feet	Temporary Traffic Stripe, Skip White
0580	619-A5001		8,726	Linear Feet	Temporary Traffic Stripe, Detail
0590	619-A6002		848	Linear Feet	Temporary Traffic Stripe, Legend
0600	619-D1001		80	Square Feet	Standard Roadside Construction Signs, Less than 10 Square Feet
0610	619-D2001		1,024	Square Feet	Standard Roadside Construction Signs, 10 Square Feet or More
0620	619-E1001		2	Each	Flashing Arrow Panel, Type C
0630	619-F1001		800	Linear Feet	Concrete Median Barrier, Precast
0640	619-F2001		450	Linear Feet	Remove and Reset Concrete Median Barrier, Precast
0650	619-G4001		18	Linear Feet	Barricades, Type III, Double Faced
0660	619-G4005		192	Linear Feet	Barricades, Type III, Single Faced



Line No.	Item Code	Adj Code	Quantity	Units	Description [Fixed Unit Price]
0670	619-G4006		24	Linear Feet	Barricades, Type III, Single Faced, Permanent
0680	619-G5001		82	Each	Free Standing Plastic Drums
0690	619-G7001		8	Each	Warning Lights, Type "B"
0692	619-J1001		2	Each	Impact Attenuator, 40 MPH
0694	619-J3001		4	Each	Remove and Reset Impact Attenuator
0700	620-A001		1	Lump Sum	Mobilization
0710	626-A003		3,621	Linear Feet	6" Thermoplastic Traffic Stripe, Skip White
0720	626-C001		6,688	Linear Feet	6" Thermoplastic Double Drop Edge Stripe, Continuous White
0730	626-E003		4,106	Linear Feet	6" Thermoplastic Traffic Stripe, Continuous Yellow
0740	626-F002		1,566	Linear Feet	6" Thermoplastic Double Drop Edge Stripe, Continuous Yellow
0750	626-G002		13,320	Linear Feet	Thermoplastic Detail Stripe, White
0760	626-G003		3,279	Linear Feet	Thermoplastic Detail Stripe, Yellow
0770	626-H004		193	Square Feet	Thermoplastic Legend, White
0780	626-H005		848	Linear Feet	Thermoplastic Legend, White
0790	627-J001		80	Each	Two-Way Clear Reflective High Performance Raised Markers
0800	627-K001		314	Each	Red-Clear Reflective High Performance Raised Markers
0810	627-L001		138	Each	Two-Way Yellow Reflective High Performance Raised Markers
0820	630-A001		186	Square Feet	Standard Roadside Signs, Sheet Aluminum, 0.080" Thickness
0830	630-A003		198	Square Feet	Standard Roadside Signs, Sheet Aluminum, 0.125" Thickness
0840	630-B002		56	Square Feet	Interstate Directional Signs, Bolted Extruded Aluminum Panels, Ground Mounted
0850	630-C002		44	Linear Feet	Steel U-Section Posts, 2.0 lb/ft
0860	630-C003		341	Linear Feet	Steel U-Section Posts, 3.0 lb/ft
0870	630-D007		34	Linear Feet	Structural Steel Beams, W6 x 15
0880	630-D008		32	Linear Feet	Structural Steel Beams, W6 x 9
0890	630-E001		43	Pounds	Structural Steel Angles & Bars, 3 1/2" x 3 1/2" x 1/4" Angles
0900	630-E002		34	Pounds	Structural Steel Angles & Bars, 3" x 3" x 1/4" Angles
0910	630-E004		265	Pounds	Structural Steel Angles & Bars, 7/16" x 2 1/2" Flat Bar
0920	630-F011		1	Each	Delineators, Post Mounted, Double Yellow
0930	630-F013		6	Each	Delineators, Post Mounted, Single Yellow
0940	630-K001		15	Linear Feet	Welded & Seamless Steel Pipe Posts, 3 1/2"
0950	630-K002		73	Linear Feet	Welded & Seamless Steel Pipe Posts, 3"
0960	630-K003		170	Linear Feet	Welded & Seamless Steel Pipe Posts, 4"
0970	635-A059		4	Each	Traffic Signal Head, Type 1

Line No.	Item Code	Adj Code	Quantity	Units	Description [Fixed Unit Price]
0980	635-A065		2	Each	Traffic Signal Head, Type 2 FYA
0990	635-A073		2	Each	Traffic Signal Head, Type 4
1000	638-A006		4	Each	Flasher Assembly, Prepare To Stop
1010	699-A001		1	Lump Sum	Roadway Construction Stakes
1020	815-A007	(S)	40	Ton	Loose Riprap, Size 300
1030	815-E001	(S)	55	Square Yard	Geotextile under Riprap
1040	907-632-A007		1	Each	Solid State Traffic Cabinet Assembly, Type III Cabinet, Type 1 Controller
1050	907-632-J001		1	Each	Power Service Pedestal
1060	907-634-A104		1	Each	Traffic Signal Equipment Pole, Type II, 22' Shaft, 25' Arm
1070	907-634-A117		1	Each	Traffic Signal Equipment Pole, Type II, 22' Shaft, 90' Arm
1080	907-634-A118		1	Each	Traffic Signal Equipment Pole, Type II, 22' Shaft, 95' Arm
1090	907-634-C001		12	Cubic Yard	Pole Foundations, Class "B" Concrete
1100	907-636-B013		2,264	Linear Feet	Electric Cable, Underground in Conduit, IMSA 20-1, AWG 14, 4 Conductor
1110	907-636-B016		674	Linear Feet	Electric Cable, Underground in Conduit, IMSA 20-1, AWG 14, 8 Conductor
1120	907-636-B028		140	Linear Feet	Electric Cable, Underground in Conduit, IMSA 20-1, AWG 8, 3 Conductor
1130	907-636-D005		64	Linear Feet	Electric Cable, Aerial Supported in Conduit, IMSA 20-1, AWG 14, 4 Conductor
1140	907-636-D008		140	Linear Feet	Electric Cable, Aerial Supported in Conduit, IMSA 20-1, AWG 14, 8 Conductor
1150	907-636-D014		276	Linear Feet	Electric Cable, Aerial Supported in Conduit, IMSA 20-1, AWG 8, 3 Conductor
1160	907-637-A002		9	Each	Pullbox Enclosure, Type 2
1170	907-637-A003		2	Each	Pullbox Enclosure, Type 3
1180	907-637-C028		1,820	Linear Feet	Traffic Signal Conduit, Underground, Type 4, 2"
1190	907-637-C030		93	Linear Feet	Traffic Signal Conduit, Underground, Type 4, 3"
1200	907-637-D003		416	Linear Feet	Traffic Signal Conduit, Underground Drilled or Jacked, Rolled Pipe, 3"
1210	907-641-A002		3	Each	Signal Stop Bar Radar Vehicle Detection Sensor, Type 2
1220	907-641-B002		2	Each	Signal Advanced Radar Vehicle Detection Sensor, Type 2
1230	907-641-D001		1,146	Linear Feet	Radar Vehicle Detection Cable
1240	907-653-B001		25	Square Feet	Street Name Sign
1250	907-663-C001		1	Each	Cellular Modem
ALTERNATE GROUP AA NUMBER 1					
1260	304-F001	(GT)	12,100	Ton	3/4" and Down Crushed Stone Base
ALTERNATE GROUP AA NUMBER 2					
1270	304-F002	(GT)	12,100	Ton	Size 610 Crushed Stone Base
ALTERNATE GROUP AA NUMBER 3					

Line No.	Item Code	Adj Code	Quantity	Units	Description [Fixed Unit Price]
1280	304-F003	(GT)	12,100	Ton	Size 825B Crushed Stone Base







ADDENDUM

STATE	PROJECT NO.
MISS	HSIP-0015-01(121)

① INCLUDES 72 LF FOR SIDE DRAINS

SUMMARY OF QUANTITIES (SHEET 2)				
PAY ITEM NO.	PAY ITEM	UNIT	LINCOLN : 106699-301000	
			Prelim	Final
603-CA026	24" Reinforced Concrete Pipe, Class III	LF	72	①
603-CB003	18" Reinforced Concrete End Section	EA	3	
603-CE008	29" x 18" Concrete Arch Pipe, Class A III	LF	56	
604-A001	Castings	LBS	244	
604-B001	Gratings	LBS	827	
609-D001	Combination Concrete Curb and Gutter Type 1	LF	118	
609-D002	Combination Concrete Curb and Gutter Type 1 Modified	LF	492	
609-D003	Combination Concrete Curb and Gutter Type 2	LF	518	
609-D004	Combination Concrete Curb and Gutter Type 2 Modified	LF	803	
614-B005	Concrete Driveway, With Reinforcement, 9-inch Thickness	SY	1,182	②
616-A001	Concrete Median and/or Island Pavement, 10-inch	SY	189	
616-A004	Concrete Median and/or Island Pavement, 4-inch	SY	440	
617-A001	Right-of-Way Marker	EA	20	①
617-B001	Permanent Easement Marker	EA	25	①
618-A001	Maintenance of Traffic	LS	1	
619-A1002	Temporary Traffic Stripe, Continuous White	LF	11,888	①
619-A2002	Temporary Traffic Stripe, Continuous Yellow	LF	10,872	①
619-A3002	Temporary Traffic Stripe, Skip White	LF	3,621	
619-A5001	Temporary Traffic Stripe, Detail	LF	8,726	
619-A6002	Temporary Traffic Stripe, Legend	LF	848	①
619-D1001	Standard Roadside Construction Signs, Less than 10 Square Feet	SF	80	
619-D2001	Standard Roadside Construction Signs, 10 Square Feet or More	SF	1,024	
619-E1001	Flashing Arrow Panel, Type C	EA	2	
619-F1001	Concrete Median Barrier, Precast	LF	800	
619-F2001	Remove and Reset Concrete Median Barrier, Precast	LF	450	
619-G4001	Barricades, Type III, Double Faced	LF	18	
619-G4005	Barricades, Type III, Single Faced	LF	192	
619-G4006	Barricades, Type III, Single Faced, Permanent	LF	24	
619-G5001	Free Standing Plastic Drums	EA	82	
619-G7001	Warning Lights, Type "B"	EA	8	
619-J1001	Impact Attenuator, 40 MPH	EA	2	③
619-J3001	Remove and Reset Impact Attenuator	EA	4	③
620-A001	Mobilization	LS	1	
626-A003	6" Thermoplastic Traffic Stripe, Skip White	LF	3,621	
626-C001	6" Thermoplastic Double Drop Edge Stripe, Continuous White	LF	6,688	
626-E003	6" Thermoplastic Traffic Stripe, Continuous Yellow	LF	4,106	
626-F002	6" Thermoplastic Double Drop Edge Stripe, Continuous Yellow	LF	1,566	
626-G002	Thermoplastic Detail Stripe, White	LF	13,320	①
626-G003	Thermoplastic Detail Stripe, Yellow	LF	3,279	①
626-H004	Thermoplastic Legend, White	SF	193	
626-H005	Thermoplastic Legend, White	LF	848	①
627-J001	Two-Way Clear Reflective High Performance Raised Markers	EA	80	
627-K001	Red-Clear Reflective High Performance Raised Markers	EA	314	
627-L001	Two-Way Yellow Reflective High Performance Raised Markers	EA	138	

△

△

△

WB	REVISED QUANTITIES & PAY ITEMS	07/24/2018	MISSISSIPPI DEPARTMENT OF TRANSPORTATION SUMMARY OF QUANTITIES		
RG	REVISED PAY ITEM	08/07/2018	Proj No: HSIP-0015-01(121) County: LINCOLN		
RG	ADDED PAY ITEMS	08/15/2018	FILENAME : SQS_SH.DGN Design Team Garver Checked TMB Date JUL18		
By	Revision		Working Number SQ-2		
			Sheet Number 10		





ADDENDUM

STATE	PROJECT NO.
MISS	HSIP-0015-01(121)

SUMMARY OF QUANTITIES (SHEET 3)				
PAY ITEM NO.	PAY ITEM	UNIT	LINCOLN : 106699-301000	
			Prelim	Final
630-A001	Standard Roadside Signs, Sheet Aluminum, 0.080" Thickness	SF	186	
630-A003	Standard Roadside Signs, Sheet Aluminum, 0.125" Thickness	SF	198	
630-B002	Interstate Directional Signs, Bolted Extruded Aluminum Panels, Ground Mounted	SF	56	
630-C002	Steel U-Section Posts, 2.0 lb/ft	LF	44	
630-C003	Steel U-Section Posts, 3.0 lb/ft	LF	341	
630-D007	Structural Steel Beams, W6 x 15	LF	34	
630-D008	Structural Steel Beams, W6 x 9	LF	32	
630-E001	Structural Steel Angles & Bars, 3 1/2" x 3 1/2" x 3 1/2" x 1/4" Angles	LBS	43	
630-E002	Structural Steel Angles & Bars, 3" x 3" x 3" x 1/4" Angles	LBS	34	
630-E004	Structural Steel Angles & Bars, 7/16" x 2 1/2" Flat Bar	LBS	265	
630-F011	Delineators, Post Mounted, Double Yellow	EA	1	
630-F013	Delineators, Post Mounted, Single Yellow	EA	6	
630-K001	Welded & Seamless Steel Pipe Posts, 3 1/2"	LF	15	
630-K002	Welded & Seamless Steel Pipe Posts, 3"	LF	73	
630-K003	Welded & Seamless Steel Pipe Posts, 4"	LF	170	
907-632-A007	Solid State Traffic Cabinet Assembly, Type III Cabinet, Type 1 Controller	EA	1	
907-632-J001	Power Service Pedestal	EA	1	
907-634-A104	Traffic Signal Equipment Pole, Type II, 22' Shaft, 25' Arm	EA	1	
907-634-A117	Traffic Signal Equipment Pole, Type II, 22' Shaft, 90' Arm	EA	1	
907-634-A118	Traffic Signal Equipment Pole, Type II, 22' Shaft, 95' Arm	EA	1	
907-634-C001	Pole Foundations, Class "B" Concrete	CY	12	
635-A059	Traffic Signal Head, Type 1	EA	4	
635-A065	Traffic Signal Head, Type 2 FYA	EA	2	
635-A073	Traffic Signal Head, Type 4	EA	2	
907-636-B013	Electric Cable, Underground in Conduit, IMSA 20-1, AWG 14, 4 Conductor	LF	2,264	
907-636-B016	Electric Cable, Underground in Conduit, IMSA 20-1, AWG 14, 8 Conductor	LF	674	
907-636-B028	Electric Cable, Underground in Conduit, IMSA 20-1, AWG 8, 3 Conductor	LF	140	
907-636-D005	Electric Cable, Aerial Supported in Conduit, IMSA 20-1, AWG 14, 4 Conductor	LF	64	
907-636-D008	Electric Cable, Aerial Supported in Conduit, IMSA 20-1, AWG 14, 8 Conductor	LF	140	
907-636-D014	Electric Cable, Aerial Supported in Conduit, IMSA 20-1, AWG 8, 3 Conductor	LF	276	
907-637-A002	Pullbox Enclosure, Type 2	EA	9	
907-637-A003	Pullbox Enclosure, Type 3	EA	2	
907-637-C028	Traffic Signal Conduit, Underground, Type 4, 2"	LF	1,820	
907-637-C030	Traffic Signal Conduit, Underground, Type 4, 3"	LF	93	
907-637-D003	Traffic Signal Conduit, Underground Drilled or Jacked, Rolled Pipe, 3"	LF	416	
638-A006	Flasher Assembly, Prepare To Stop	EA	4	
907-641-A002	Signal Stop Bar Radar Vehicle Detection Sensor, Type 2	EA	3	
907-641-B002	Signal Advanced Radar Vehicle Detection Sensor, Type 2	EA	2	
907-641-D001	Radar Vehicle Detection Cable	LF	1,146	
907-653-B001	Street Name Sign	SF	25	
907-663-C001	Cellular Modem	EA	1	
699-A001	Roadway Construction Stakes	LS	1	
815-A007	Loose Riprap, Size 300	TON	40	
815-E001	Geotextile under Riprap	SY	55	

- ①
- DESIGN WIND SPEED FOR TRAFFIC SIGNAL EQUIPMENT POLES SHALL BE 100 MPH. POLES SHALL BE POWDER COATED BLACK.
- ②
- TRAFFIC SIGNAL HEADS SHALL HAVE RETRO-REFLECTIVE TYPE III, 2" YELLOW REFLECTIVE BORDER ON THE BACKPLATES. SEE TSD-2 FOR DETAILS.
- ③
- TRAFFIC SIGNAL CONTROLLER AND RADAR DETECTION SENSORS SHALL PROVIDE DYNAMIC ALL RED EXTENSION (DARE) COLLISION AVOIDANCE FUNCTIONALITY ON US 84. INCLUDES ALL EQUIPMENT, LABOR, AND OTHER INCIDENTAL MATERIALS TO PROVIDE A COMPLETE AND FUNCTIONAL DARE SYSTEM.
- ④
- CELLULAR MODEM TO BE FURNISHED BY MDOT AND INSTALLED BY THE CONTRACTOR. THE CONTRACTOR SHALL INTEGRATE THE SIGNAL INTO MDOT'S CENTRAL MANAGEMENT SIGNAL SYSTEM.



WB	By	MISSISSIPPI DEPARTMENT OF TRANSPORTATION SUMMARY OF QUANTITIES	
REVISIONS	Revision	Proj No: HSIP-0015-01(121) County: LINCOLN	
REVISED QUANTITIES & PAY ITEMS	Working Number	SQ-3	
07/24/2018	Date	FILENAME : SQS_SH.DGN Design Team Garver	Sheet Number 11
		Checked TMB	Date Jul 18



STATE	PROJECT NO.
MISS.	HSIP-0015-01(121)

TRAFFIC CONTROL ITEMS		
DESCRIPTION	UNIT	TOTAL
FLASHING ARROW PANEL, TYPE C	EA	2
FREE STANDING PLASTIC DRUMS	EA	82
CONCRETE MEDIAN BARRIER, PRECAST	LF	75
BARRICADES, TYPE III, SINGLE FACED	LF	144
WARNING LIGHTS, TYPE "B"	EA	4
CONSTRUCTION SIGNS	SF	283.5
IMPACT ATTENUATOR, 40 MPH	UNIT	2
TEMPORARY TRAFFIC STRIPE, CONT WHITE	LF	1400
TEMPORARY TRAFFIC STRIPE, CONT YELLOW	LF	1400

CONSTRUCTION SIGNS				
DESCRIPTION	MUTCD. NO.	SIZE	SQ. FT.	QUANTITY
STOP	R1-1	48" OCTAGON	13.25	6
ROAD CLOSED	R11-2	48" X 30"	10	6
PAVEMENT WIDTH TRANSITION - LEFT LANE ENDS	W4-2L	48" X 48"	16	4
ADVANCE LEFT LANE CLOSED	W20-5L	48" X 48"	16	4
LOW SHOULDER	W8-9	48" X 48"	16	1
			TOTAL	21
				283.5

W4-2L  
48x48

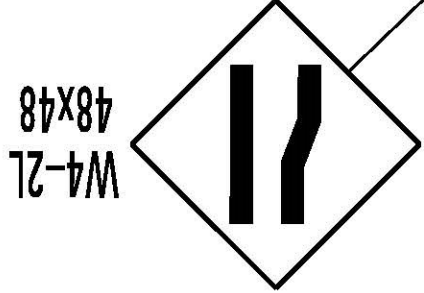

W4-2L  
48x48

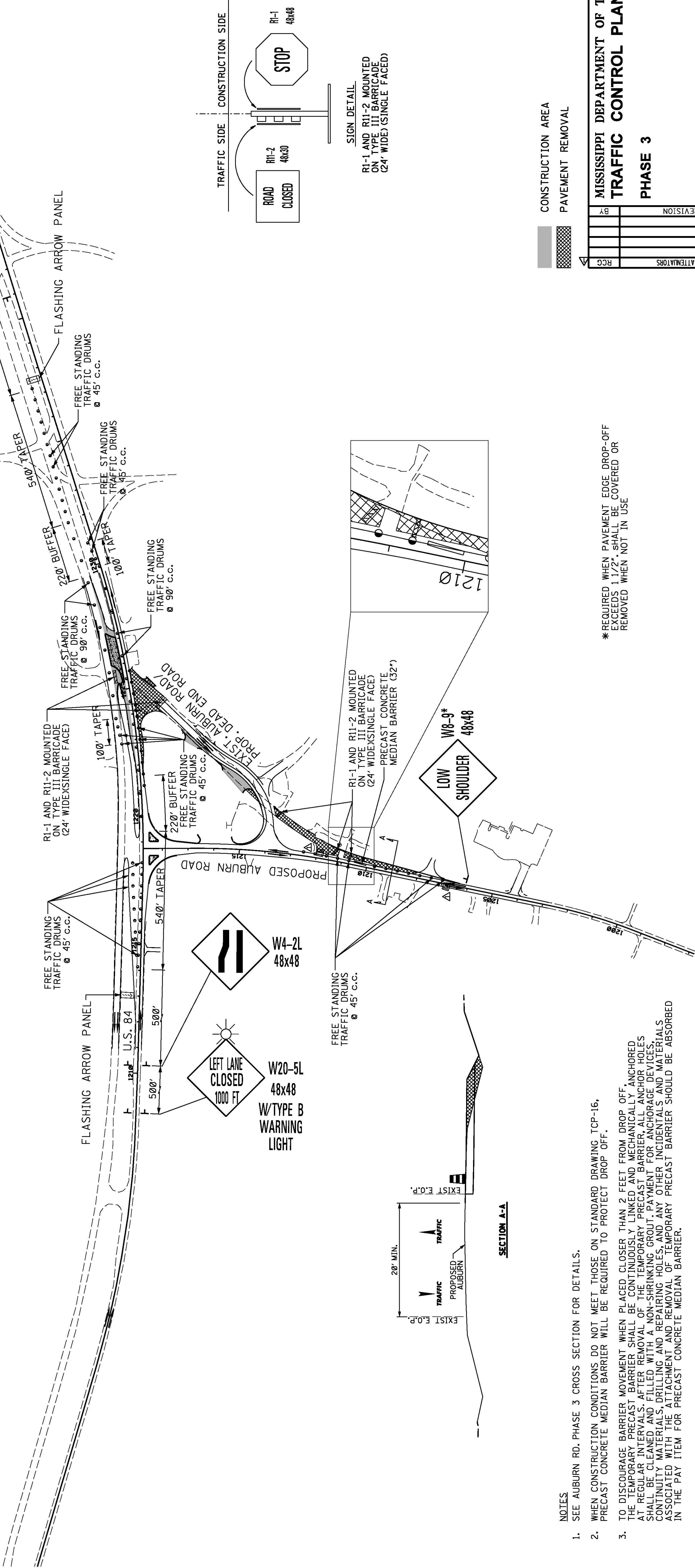
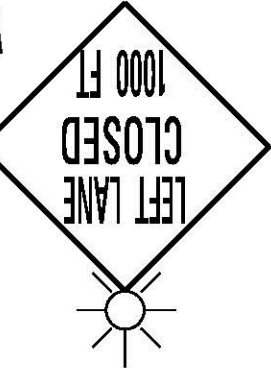

PLAN  
ROADWAY DESIGN DIVISION  
MISSISSIPPI DEPARTMENT OF TRANSPORTATION

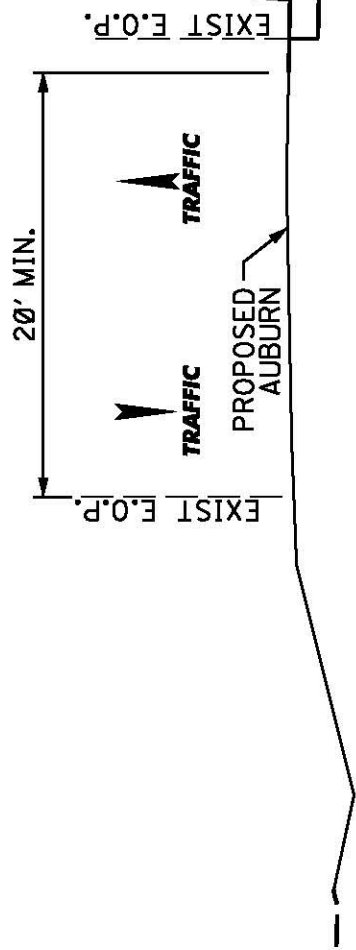

SECTION A-A

NOTES

- SEE AUBURN RD. PHASE 3 CROSS SECTION FOR DETAILS.
- WHEN CONSTRUCTION CONDITIONS DO NOT MEET THOSE ON STANDARD DRAWING TCP-16, PRECAST CONCRETE MEDIAN BARRIER WILL BE REQUIRED TO PROTECT DROP OFF.
- TO DISCOURAGE BARRIER MOVEMENT WHEN PLACED CLOSER THAN 2 FEET FROM DROP OFF, THE TEMPORARY PRECAST BARRIER SHALL BE CONTINUOUSLY LINKED AND MECHANICALLY ANCHORED AT REGULAR INTERVALS. AFTER REMOVAL OF THE TEMPORARY PRECAST BARRIER, ALL ANCHOR HOLES SHALL BE CLEANED AND FILLED WITH A NON-SHRINKING GROUT. PAYMENT FOR ANCHORAGE DEVICES, CONTINUITY MATERIALS, DRILLING AND REPAIRING HOLES, AND ANY OTHER INCIDENTALS AND MATERIALS ASSOCIATED WITH THE ATTACHMENT AND REMOVAL OF TEMPORARY PRECAST BARRIER SHOULD BE ABSORBED IN THE PAY ITEM FOR PRECAST CONCRETE MEDIAN BARRIER.

CONSTRUCTION AREA  
PAVEMENT REMOVAL

MISSISSIPPI DEPARTMENT OF TRANSPORTATION

TRAFFIC CONTROL PLAN

PHASE 3

REVISION

BY

DATE

DESIGN TEAM

DRAWN

IMPACT ATTENUATORS

COUNTY: LINCOLN

PROJ. NUM.: HSIP-0015-01(121)

FILENAME: TC-3.DGN

WORKING NUMBER

TC-3

SHEET NUMBER

40

DATE

DESIGN TEAM

CHECKED

TWB

DATE MAY 2018