

STATE	PROJECT NUMBER	SHEET NO.
MISSISSIPPI	BR-9999-06(028)	1

GENERAL INDEX

INCLUDED THIS PROJECT	BEGIN WITH SHEET
<input checked="" type="checkbox"/> ROADWAY	1
<input type="checkbox"/> PERMANENT SIGNS	1001
<input type="checkbox"/> TRAFFIC SIGNALS	2001
<input type="checkbox"/> ITS COMPONENTS	3001
<input type="checkbox"/> LIGHTING	4001
<input type="checkbox"/> (RESERVED)	5001
<input checked="" type="checkbox"/> ROADWAY STANDARD DWGS	6001
<input type="checkbox"/> BOX CULVERT STD. DRAWINGS (LRFD)	7001
<input type="checkbox"/> BOX CULVERT STD. DRAWINGS (STD. SPEC.)	7501
<input checked="" type="checkbox"/> BRIDGE	8001
<input checked="" type="checkbox"/> CROSS SECTIONS	9001

EXISTING BRIDGE STRUCTURES

STA 9 + 00.00 (AIRPORT DRIVE)
 STA. 453 + 83.45 (INTERSTATE 59)
 BR NO. 92.5
 1@40'-0", 2@60'-0", 1@40'-0"
 LENGTH ALONG C 200 FT.

BOX BRIDGES REQ'D.

NONE

CONVENTIONAL SYMBOLS

COUNTY LINE	
TOWN CORPORATION LINE	
SECTION LINE	
EXISTING ROAD OR TRAVELED WAY	
PROPOSED ROAD OR TRAVELED WAY	
RAILROAD	
SURVEY LINE	
BRIDGES	

	LENGTH OF ROADWAY	LENGTH OF BRIDGES	LENGTH OF PROJECT (NET)	LENGTH OF EXCEPTIONS	LENGTH OF PROJECT (GROSS)
	1.140.00 FT.	200.00 FT.	1.340.00 MI.	0 FT.	1.340.00
	0.216 MI.	0.038 MI.	0.254 MI.	0 MI.	0.254 MI.

STATE OF MISSISSIPPI

MISSISSIPPI DEPARTMENT OF TRANSPORTATION

PLAN AND PROFILE OF PROPOSED STATE HIGHWAY FEDERAL AID PROJECT NO. BR-9999-06(028)

BRIDGE TO BE RAISED
 AIRPORT DRIVE OVER INTERSTATE 59
 IN JONES COUNTY

FMS CON. NO. 107598 / 301000

SCALES

PLAN	1 IN. = 100 FT.
PROFILE {	HOR. 1 IN. = 100 FT.
	VERT. 1 IN. = 10 FT.
LAYOUT	1 IN. = 1,000 FT.

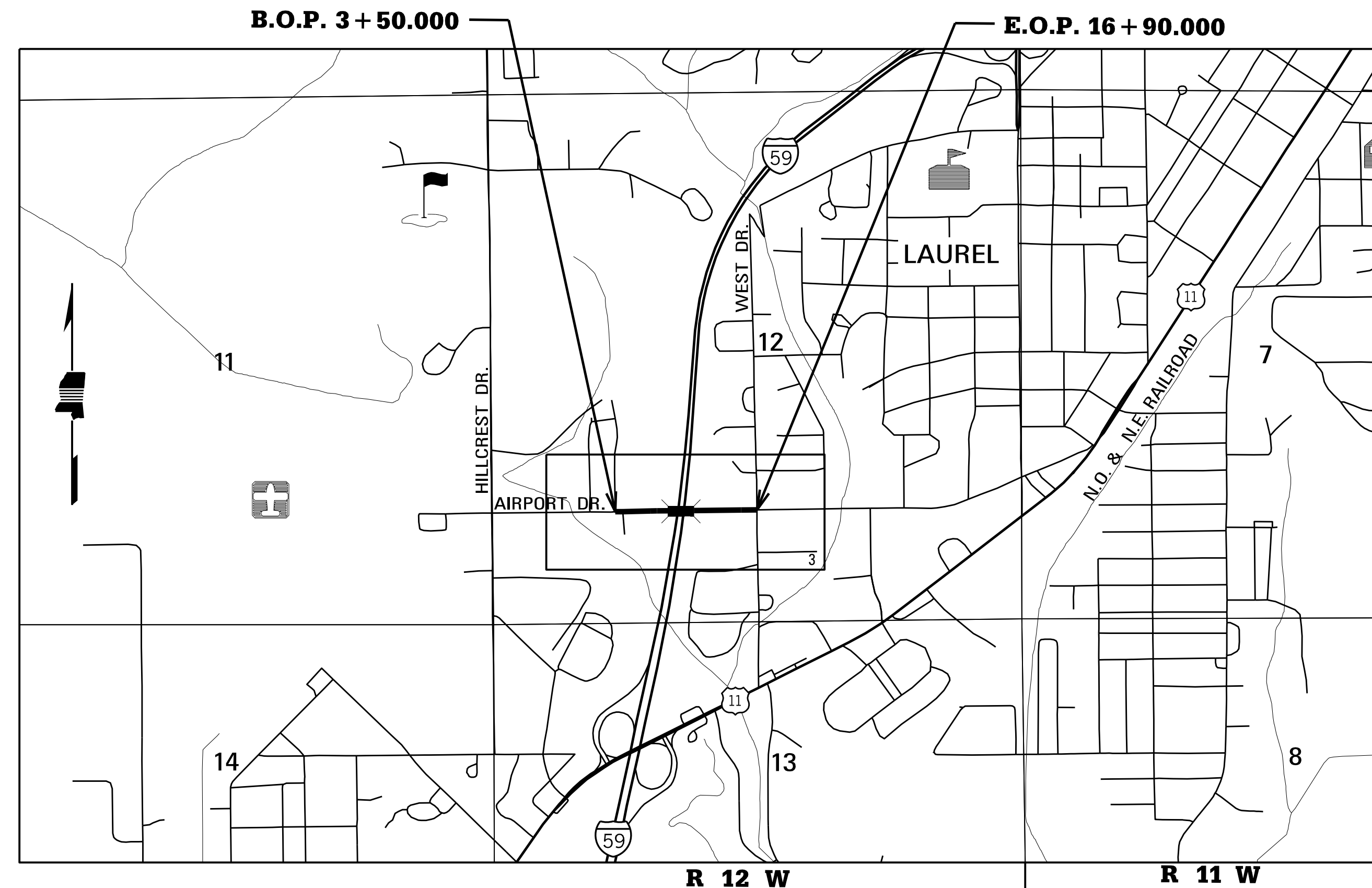

EQUATIONS

NONE

EXCEPTIONS

NONE

LENGTH DATA

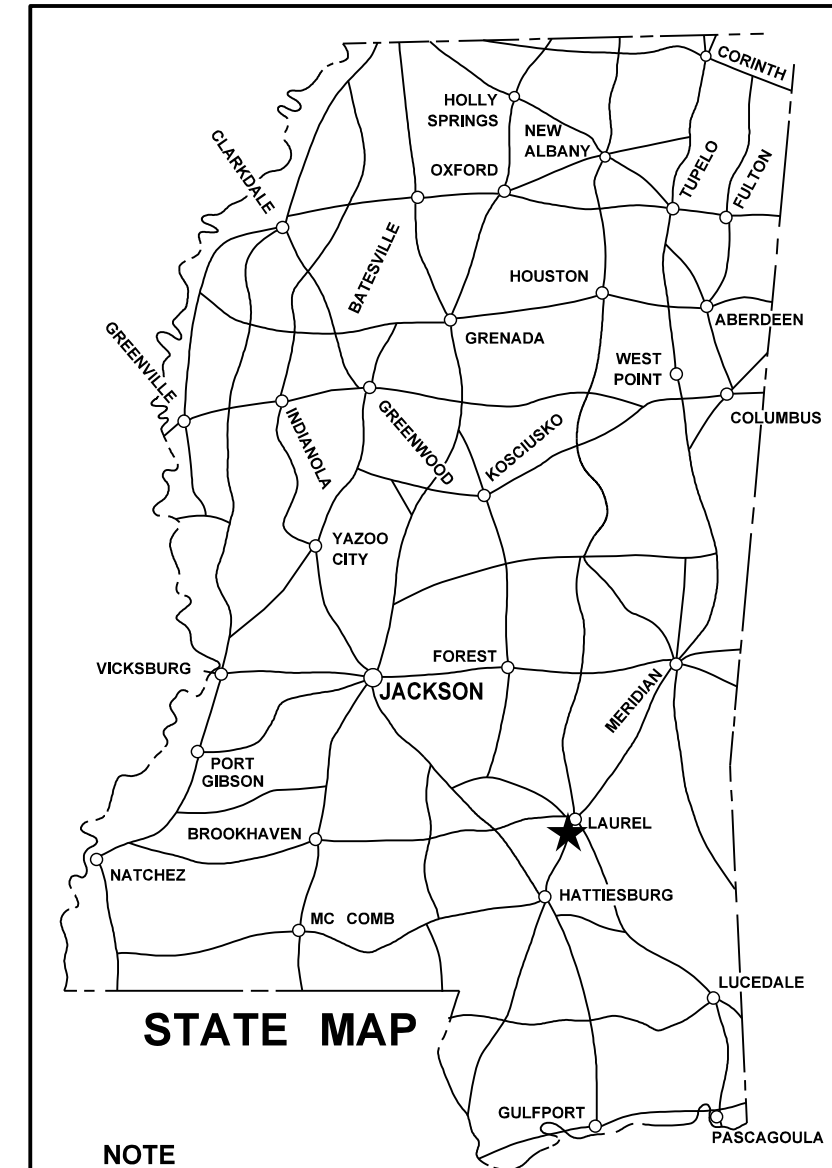

DESIGN CONTROL

40 MPH = V (SPEED DESIGN)

ADT (2016) = 1,500 ; ADT () = _____
 DHV = _____ ; D = _____ % T = _____ %

PERMITS ACQUIRED BY MDT

WETLANDS AND WATERS PERMITS		
	WATERS	WETLANDS
NATIONWIDE #14	<input type="checkbox"/>	<input type="checkbox"/>
NATIONWIDE (OTHER)*	<input type="checkbox"/>	<input type="checkbox"/>
GENERAL*	<input type="checkbox"/>	<input type="checkbox"/>
INDIVIDUAL (404)*	<input type="checkbox"/>	<input type="checkbox"/>

STORMWATER PERMIT

Y REQUIRED, CNOI SUBMITTED BY MDT (DISTURBED AREA = 5 ACRES)
 S REQUIRED, SCNOI TO BE SUBMITTED BY CONTRACTOR (1 TO 4.99 ACRES)
 N NO STORMWATER PERMIT REQUIRED (<1 ACRE)

APPROVED BY: _____

9/24/2018 1:04:29 AM T1 TITLE.DGN



ROADWAY DESIGN

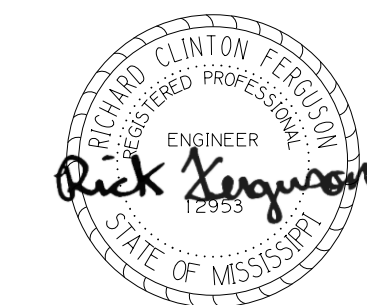

BRIDGE DESIGN

P S & E DATE: 08 / 07 / 2018

APPROVED: _____
 DEPUTY EXECUTIVE DIRECTOR / CHIEF ENGINEER

EXECUTIVE DIRECTOR



1st O.REV.

STATE	PROJECT NO.
MISS.	BR-9999-06(028)

DESCRIPTION OF SHEET	WKG. NO.	SH. NO.	DESCRIPTION OF SHEET	WKG. NO.	SH. NO.
TITLE SHEET		1			
DETAILED INDEX & GENERAL NOTES (2)					
DETAILED INDEX	DI-1	2			
GENERAL NOTES	GN-1	3			
TYPICAL SECTION SHEETS (1)					
TYPICAL SECTION - LOCAL ROAD - INTERSTATE 59	TS-1	4			
QUANTITY SHEETS (4)					
SUMMARY OF QUANTITIES	SQ-1	5			
ESTIMATED QUANTITIES	EQ-1	6			
ESTIMATED QUANTITIES	EQ-2	7			
ESTIMATED QUANTITIES	EQ-3	8			
PLAN AND PROFILE SHEETS (1)					
AIRPORT DR AT I-59	3	9			
TRAFFIC CONTROL PLAN (5)					
TRAFFIC CONTROL - AIRPORT DRIVE	TC1-1	10			
TRAFFIC CONTROL - I-59 LEFT LANE CLOSURE	TC2-1	11			
TRAFFIC CONTROL - I-59 RIGHT LANE CLOSURE	TC3-1	12			
CONSTRUCTION SIGNING - AIRPORT DRIVE	CS-1	13			
CONSTRUCTION SIGNING - INTERSTATE 59	CS-2	14			
PAVEMENT MARKING DETAIL SHEETS (1)					
PAVEMENT MARKINGS - AIRPORT DRIVE	PMD-1	15			
SPECIAL DESIGN SHEETS (3)					
BRIDGE-GUARD RAIL CONNECTOR	BGRC-1	16			
GPS CONTROL NOTES	RWC-1	17			
TYPICAL PARALLEL INSTALLATION AT BRIDGE APPROACHES FOR TWO-LANE HIGHWAYS	SDGR-4	18			
STANDARD DRAWINGS (12)					
PAVEMENT MARKING DETAILS FOR 2-LANE AND 4-LANE DIVIDED ROADWAYS	PM-1	6051			
RUMBLE STRIP DETAIL FOR OGFC OR CONCRETE ROADWAY WITH ASPHALT SHOULDERS	RS-3	6066			
FENCE: CHAIN LINK CLASS I	CL-1	6184			
GUARDRAIL: "W" BEAM (STEEL BEAM)	GR-1B	6203			
GUARDRAIL: MISCELLANEOUS HARDWARE	GR-HW	6221			
TYPICAL INSTALLATION AND DETAILS OF DELINEATORS AND DISTANCE REFERENCE SIGNS	SN-8	6314			
TYPICAL GUARDRAIL DELINEATION	SN-8C	6317			
SIGNING DETAILS FOR BRIDGE APPROACHES	SN-9	6318			
TRAFFIC CONTROL PLAN FOR POSTED SPEED LIMIT OF 65 OR 70 MPH (INTERSTATES AND OTHER 4-LANE DIVIDED HIGHWAYS; (MEDIAN LANE OR OUTSIDE LANE CLOSURE) (EXTENDED PERIOD)	TCP-4	6354			
TRAFFIC CONTROL PLAN FOR POSTED SPEED LIMIT OF 65 OR 70 MPH (INTERSTATES AND OTHER 4-LANE DIVIDED HIGHWAYS; (MEDIAN LANE OR OUTSIDE LANE CLOSURE) (WORK DAY ONLY)	TCP-5	6355			
SHORT DURATION CLOSING OF DIVIDED HIGHWAYS	TCP-7	6357			
HIGHWAY SIGN AND BARRICADE DETAILS FOR CONSTRUCTION PROJECTS	TCP-8	6358			
CROSS SECTIONS (6)					
AIRPORT DRIVE		9001-9006			
TOTAL EXCLUDING BRIDGE SHEETS =				36	

BRIDGE SHEETS
NOTE: SEE SHEET DI-BR FOR DETAILS

PS & E PLANS- 08/07/2018			REVISION	BY	DATE	MISSISSIPPI DEPARTMENT OF TRANSPORTATION	
FMS CON. 107598/301000						DETAILED INDEX	
REVISIONS			WORKING NUMBER		DI-1		
DATE	SHEET NO.	BY	SHEET NUMBER		2		
9/4/18	5,7,8,9,13,16	MJW	FILENAME: DI.DGN		DESIGN TEAM PICKERING CHECKED DATE 08/07/18		

9/24/2018 1:04:06 AM DI.DGN

GENERAL NOTES

GENERAL NOTES (CONT.)

STATE	PROJECT NO.
MISS.	BR-9999-06(028)

- (1) THE LOCATION AND SPACING OF SIGNS, SHOWN ON THE TRAFFIC CONTROL PLANS, ARE APPROXIMATE AND MAY BE ADJUSTED AS NECESSARY TO FIT FIELD CONDITIONS.
- (2) ALL TRAFFIC CONTROL DEVICES ON THIS PROJECT SHALL COMPLY WITH PART VI OF THE **MUTCD** (LATEST EDITION).
- (3) THE CONTRACTOR SHALL BE RESPONSIBLE FOR PROTECTING EXISTING STRUCTURES SUCH AS, BUT NOT LIMITED TO, PIPES, INLETS, APRONS, AND BRIDGES FROM DAMAGE WHICH MIGHT OCCUR DURING CONSTRUCTION. THE CONTRACTOR SHALL REPLACE OR REPAIR, AS DIRECTED BY THE ENGINEER, ANY STRUCTURES DAMAGED DURING THE LIFE OF THE CONTRACT. NO PAYMENT WILL BE MADE FOR REPLACEMENT OR REPAIR OF DAMAGED ITEMS.
- (4) UTILITIES ON THE DRAWINGS ARE SHOWN IN THEIR ORIGINAL LOCATION BASED UPON THE BEST INFORMATION AVAILABLE TO THE ENGINEER. UTILITIES THAT WERE FOUND TO BE IN CONFLICT WITH CONSTRUCTION HAVE BEEN RELOCATED. PERMITS ARE ON FILE WITH THE DEPARTMENT SHOWING THE APPROXIMATE LOCATION OF UTILITIES RELOCATED WITHIN THE RIGHT-OF-WAY. THE ENGINEER CAN NOT AND DOES NOT WARRANT THAT THIS INFORMATION IS COMPLETE OR ACCURATE. THE CONTRACTOR MUST COORDINATE DIRECTLY WITH THE INVOLVED UTILITY OWNERS TO HAVE UNDERGROUND UTILITY LINES FIELD LOCATED IN ADVANCE OF CONSTRUCTION.
- (5) SOME WORK IS REQUIRED OUTSIDE THE PROJECT LIMITS. NO ADDITIONAL COMPENSATION WILL BE MADE FOR SUCH WORK EXCEPT AS PROVIDED BY SPECIFIC PAY ITEMS INCLUDED IN THE PLANS.
- (6) LIST OF PUBLIC UTILITIES
 - A. CITY OF LAUREL (601) 579-3980
 - B. CENTERPOINT ENERGY LAUREL (601) 371-5417
 - C. MS POWER CO PINE BELT (601) 297-1720
 - D. COMCAST CABLE OF LAUREL (601) 579-3980
 - E. GULF SOUTH PIPELINE PETAL - BOARDWALK (601) 270-8055
 - F. UNDERGROUND FIBER OPTIC - INLINE 1 (251) 583-1936
 - G. A T & T DISTRIBUTION (601) 765-0180
 - H. INDUSTRIAL GAS COMPANY (818) 322-7266
- (7) FLUORESCENT ORANGE SHEETING SHALL BE USED ON ALL CONSTRUCTION AND TRAFFIC CONTROL SIGNS EXCEPT FOR THOSE DESIGNATED ON THE PLANS TO BE BLACK LEGEND AND BORDER ON WHITE BACKGROUND.
- (8) VEGETATIVE MATERIAL WILL BE REMOVED PRIOR TO PLACEMENT OF CRUSHED STONE. THE COST OF WHICH SHALL BE ABSORBED IN OTHER ITEMS BID.
- (9) THE CONTRACTOR SHALL REPAIR ANY DAMAGE TO THE SURFACE TREATED SHOULDER THAT MIGHT OCCUR DURING CONSTRUCTION. ANY REPAIR TO SHOULDER WILL BE IN ACCORDANCE WITH SECTION 410 OF **THE MISSISSIPPI STANDARD SPECIFICATIONS FOR ROAD AND BRIDGE CONSTRUCTION**. NO PAYMENT WILL BE MADE FOR REPAIR OF DAMAGED SHOULDER.
- (10) THE CONTRACTOR SHALL COORDINATE WITH THE CONTRACTOR FROM ADJACENT PROJECT(S) IN IMPLEMENTING THE TRAFFIC CONTROL PLAN AS DIRECTED BY THE ENGINEER. ALL CONFLICTING SIGNS SHALL BE COVERED OR REMOVED AS DIRECTED BY THE ENGINEER.
- (11) THE CONTRACTOR SHALL COVER ANY TEMPORARY TRAFFIC CONTROL SIGNS SHOWN IN THE TRAFFIC CONTROL PLAN THAT DO NOT APPLY TO THE CURRENT PHASE.
- (12) THE CONTRACTOR IS RESPONSIBLE FOR FIELD-VERIFICATION OF EXISTING GRADES AND MAKING ADJUSTMENTS AS NECESSARY WITH THE APPROVAL OF THE PROJECT ENGINEER.
- (13) ALL ITEMS OF WORK ASSOCIATED WITH THE INSTALLATION OF A CONSTRUCTION ENTRANCE SHALL BE ABSORBED IN OTHER ITEMS OF WORK.

- (14) IF COLORS ARE USED ON PLAN/PROFILE SHEETS, THEY ARE INTENDED TO VISUALLY EASE THE LOCATION OF ELEMENTS FOR USERS OF THESE DRAWINGS. ALTHOUGH THE INTENT IS TO CATEGORIZE EVERYTHING AS EITHER EXISTING OR PROPOSED, IT IS THE END USER'S RESPONSIBILITY TO ENSURE ALL ELEMENTS ARE INTERPRETED CORRECTLY, REGARDLESS OF COLOR.
- (15) SEE BRIDGE PLANS FOR DETAILED INDEX SHEET(S), ESTIMATED QUANTITY SHEETS, AND SUMMARY OF QUANTITY SHEETS.
- (16) ALL ADDENDA TO THESE PLANS WILL BE POSTED TO WWW.MDOT.MS.GOV UNDER THE PROPOSAL ADDENDA COLUMN. BIDDERS ARE ADVISED THAT HARD COPIES OF ANY ADDENDA FOR THIS PROJECT WILL NOT BE MAILED. IT IS THE BIDDER'S RESPONSIBILITY TO CHECK AND SEE IF ANY ADDENDA HAVE BEEN POSTED FOR THIS PROJECT.
- (17) STORAGE OF FLAMMABLE MATERIALS WILL NOT BE ALLOWED UNDER ANY BRIDGE STRUCTURES.
- (18) INSTALLATION DATES SHALL BE CLEARLY WRITTEN IN BOLD BLACK MARKINGS ON THE BACK BOTTOM HALF OF ALL SIGNS WITH A PERMANENT MARKING STICK THAT IS WATERPROOF, FADE RESISTANT AND MARKS ON WET OR DRY SURFACES.
- (19) ALL POST, PIPE, AND I-BEAM LENGTHS IN THESE PLANS ARE ESTIMATES. POST LENGTHS FOR ALL SIGNS SHALL BE VERIFIED IN THE FIELD BY THE CONTRACTOR PRIOR TO FABRICATION.
- (20) ALL EXISTING SIGNS WHICH ARE TO BE REMOVED AS A PART OF THIS PROJECT THAT ARE NOT IN CONFLICT WITH CONSTRUCTION SHALL REMAIN IN PLACE UNTIL NEW SIGNS ARE INSTALLED UNLESS NOTED OR DIRECTED OTHERWISE BY THE PROJECT ENGINEER.
- (21) ALL EXISTING SIGNS AND SUPPORTS REMOVED UNDER THIS PROJECT SHALL BECOME THE PROPERTY OF THE CONTRACTOR AND ARE NOT A SEPARATE PAY ITEM.
- (22) DIRECT-APPLIED LEGEND, BORDER, AND/OR SHIELDS ARE TO BE USED ON ALL GUIDE SIGNS. DIGITALLY PRODUCED SIGN COPY, SHIELDS, LEGEND, SYMBOLS, OR IMAGES WILL NOT BE ALLOWED WITHOUT WRITTEN APPROVAL FROM MDOT'S PROJECT ENGINEER.
- (23) AFTER THE PERMANENT SIGNS HAVE BEEN INSTALLED, THE CONTRACTOR SHALL SUBMIT TO THE PROJECT ENGINEER A DIGITAL COPY OF A MICROSOFT EXCEL SPREADSHEET WITH THE FOLLOWING INVENTORY DATA CAPTURED FOR EACH SIGN: LOCATION OF SIGN (LATITUDE-LONGITUDE GPS COORDINATES), **MUTCD** SIGN CODE, SIZE, BACKGROUND AND LEGEND COLORS, SUPPORT TYPE (POST, PIPE, SQUARE POST, OR I-BEAM), NUMBER OF SUPPORTS, DATE OF INSTALLATION, SIGN FACE DIRECTION, ROUTE NAME OR NUMBER, DIRECTION OF VEHICLE TRAVEL, AND LEGEND ON SIGN IF APPLICABLE. EACH SIGN SHALL BE ASSIGNED A UNIQUE ID NUMBER AND A DIGITAL PHOTO OF EACH SIGN SHALL BE SUBMITTED IN BITMAP FORMAT. THE PHOTO FILENAME SHALL CORRESPOND WITH THE UNIQUE ID NUMBER.

9/24/2018 1:01:06 AM GNL.DGN

		MISSISSIPPI DEPARTMENT OF TRANSPORTATION	
		GENERAL NOTES	
		COUNTY: JONES	
		PROJ. NO.: BR-9999-06(028)	
		WORKING NUMBER GN-1	
		SHEET NUMBER 3	
REVISION	BY	DATE	
		FILENAME: GN.DGN	
		DESIGN TEAM PICKERING CHECKED DATE 08/07/18	

