

STATE OF MISSISSIPPI

MISSISSIPPI DEPARTMENT OF TRANSPORTATION

PLAN AND PROFILE OF PROPOSED STATE HIGHWAY FEDERAL AID PROJECT NO. BR-0020-01(249)

I-20 Over Lynch Creek Bridge
HINDS COUNTY

FMS CON. NO. 107884/ 301000

R.O.W. FMS	/
PLANS STAGE	DATE PRINTED
<input type="checkbox"/> CONCEPTUAL	
<input type="checkbox"/> PRE-R.O.W.	
<input type="checkbox"/> FIELD INSPECTION	
<input type="checkbox"/> R.O.W. PLANS TO SMD	
<input type="checkbox"/> FINAL R.O.W.	
<input type="checkbox"/> R.O.W. REVISION	
<input type="checkbox"/> OFFICE REVIEW	

STATE	PROJECT NUMBER	SHEET NO.
MISSISSIPPI	BR-0020-01(249)	1

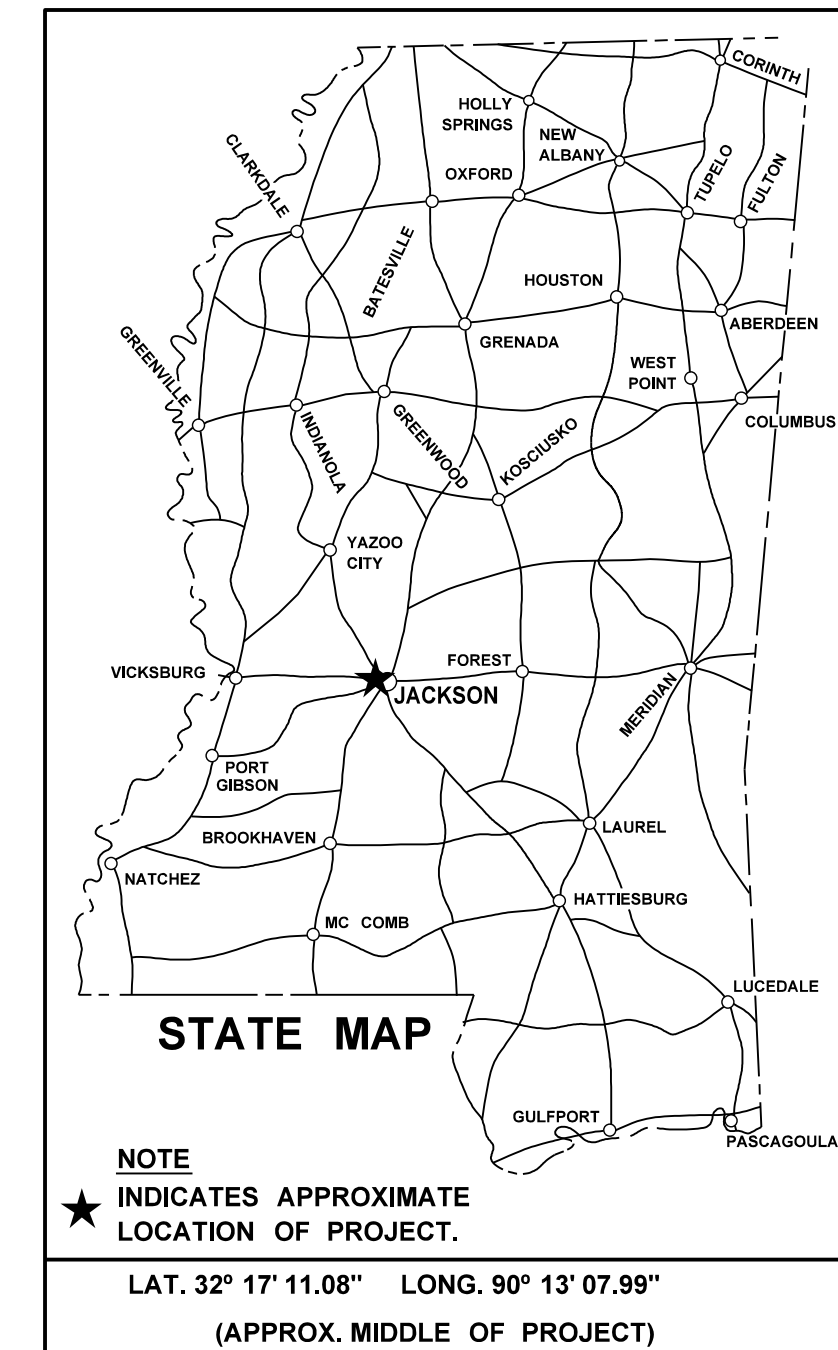

GENERAL INDEX

INCLUDED THIS PROJECT	BEGIN WITH SHEET
<input checked="" type="checkbox"/> ROADWAY	1
<input type="checkbox"/> PERMANENT SIGNS	1001
<input type="checkbox"/> TRAFFIC SIGNALS	2001
<input type="checkbox"/> ITS COMPONENTS	3001
<input type="checkbox"/> LIGHTING	4001
<input type="checkbox"/> (RESERVED)	5001
<input checked="" type="checkbox"/> ROADWAY STANDARD DWGS	6001
<input type="checkbox"/> BOX CULVERT STD. DRAWINGS (LRFD)	7001
<input type="checkbox"/> BOX CULVERT STD. DRAWINGS (STD. SPEC.)	7501
<input checked="" type="checkbox"/> BRIDGE	8001
<input type="checkbox"/> CROSS SECTIONS	9001

SCALES

PLAN	1 IN. = 100 FT.
PROFILE	HOR. 1 IN. = 100 FT.
	VERT. 1 IN. = 10 FT.
LAYOUT	1 IN. = 1800 FT.

BRIDGE STRUCTURES REQ'D.

BOX BRIDGES REQ'D.

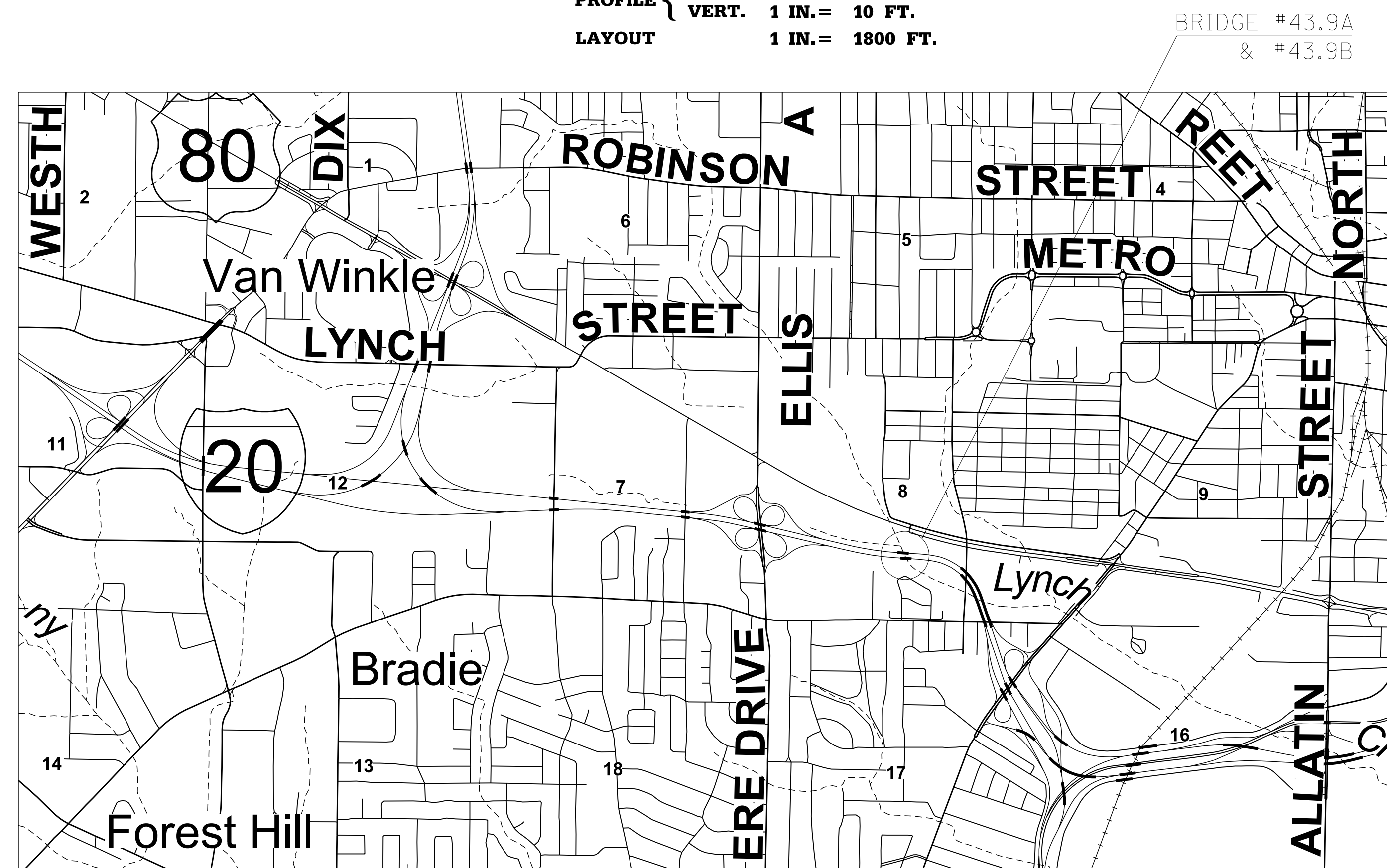

DESIGN CONTROL

MPH = V (SPEED DESIGN)

ADT () = : ADT () =

DHV = : D = % T = %

PERMITS ACQUIRED BY MDOT

WETLANDS AND WATERS PERMITS		
	WATERS	WETLANDS
NATIONWIDE #14	<input checked="" type="checkbox"/>	<input checked="" type="checkbox"/>
NATIONWIDE (OTHER)*	<input checked="" type="checkbox"/>	<input checked="" type="checkbox"/>
GENERAL*	<input checked="" type="checkbox"/>	<input checked="" type="checkbox"/>
INDIVIDUAL (404)*	<input checked="" type="checkbox"/>	<input checked="" type="checkbox"/>
STORMWATER PERMIT <input checked="" type="checkbox"/>		
Y	REQUIRED, CNOI SUBMITTED BY MDOT (DISTURBED AREA = 5 ACRES)	
S	REQUIRED, SCNOI TO BE SUBMITTED BY CONTRACTOR (1 TO 4.99 ACRES)	
N	NO STORMWATER PERMIT REQUIRED (<1 ACRE)	
APPROVED BY: _____		

CONVENTIONAL SYMBOLS

- COUNTY LINE -----
- TOWN CORPORATION LINE -----
- SECTION LINE -----
- EXISTING ROAD OR TRAVELED WAY -----
- PROPOSED ROAD OR TRAVELED WAY -----
- RAILROAD -----
- SURVEY LINE -----
- BRIDGES -----

EQUATIONS

LENGTH DATA

LENGTH OF ROADWAY	FT.	MI.
LENGTH OF BRIDGES	FT.	MI.
LENGTH OF PROJECT (NET)	MI.	
LENGTH OF EXCEPTIONS	FT.	MI.
LENGTH OF PROJECT (GROSS)	MI.	

EXCEPTIONS

PRELIMINARY
NOT FOR
CONSTRUCTION

P S & E DATE: 6 / 5 / 2019

APPROVED: _____

DEPUTY EXECUTIVE DIRECTOR / CHIEF ENGINEER

EXECUTIVE DIRECTOR

7/17/2019 5:01 PM TITLE.DGN

STATE	PROJECT NO.
MISS.	BR-0020-01(249)

DETAILED INDEX

DESCRIPTION OF SHEET	WKG. NO.	SH. NO.					
<u>TITLE SHEET (1)</u>		1	WESTBOUND CLOSURE PLAN CMS LOCATIONS	CMS-7	16	<u>AS-BUILT PLANS (2)</u>	
<u>DETAILED INDEX & GENERAL NOTES (2)</u>			WSTBOUND CLOSURE PLAN	CMS-8	17	NH-0020-01(168) I-20 VIDEO CAMERA AND FIBER OPTIC CABLE ELLIS AVE. TO TERRY RD.	ITS-1 36
DETAILED INDEX	DI-1	2	DETAILED CONSTRUCTION SIGNING	DCS-1	18		
GENERAL NOTES	GN-1	3	I-20 CLOSURE PLAN LAW ENFORCEMENT REQUIREMENTS	LAW-1	19	I-20-1(74)34 / 51-0020-074-11&12 PLAN SHEET PS-3, I-20 VALLEY STREET BRIDGE	PS-3 45
<u>QUANTITY SHEETS (4)</u>						<u>STANDARD DRAWINGS - ROADWAY SHEETS (11)</u>	
SUMMARY OF QUANTITIES	SQ-1	4	EASTBOUND CLOSURE PLAN EASTBOUND I-20 CLOSURE	TC-0A	20	PAVEMENT MARKING DETAILS FOR 2-LANE AND 4-LANE DIVIDED ROADWAYS	PM-1 6051
ESTIMATED QUANTITIES FOR TRAFFIC CONTROL SIGNS EASTBOUND CLOSURE	TCP-EQ-1	5	WESTBOUND CLOSURE PLAN WESTBOUND I-20 CLOSURE	TC-0B	21	TYPICAL TEMPORARY EROSION/ SEDIMENT CONTROL APPLICATIONS	ECD-1 6101
ESTIMATED QUANTITIES FOR TRAFFIC CONTROL SIGNS WESTBOUND CLOSURE	TCP-EQ-2	6	EASTBOUND CLOSURE PLAN I-20 @ ELLIS AVE.	TC-1	22	DETAILS OF SEDIMENT BARRIER APPLICATIONS	ECD-2 6102
ESTIMATED QUANTITIES TRAFFIC CONTROL ITEMS	TCP-EQ-3	7	EASTBOUND CLOSURE PLAN I-20 @ ELLIS AVE.	TC-2	23	DETAILS OF SILT FENCE INSTALLATION	ECD-3 6103
<u>SPECIAL DESIGN SHEETS (24)</u>						DITCH CHECK STRUCTURES, TYPICAL APPLICATIONS AND DETAILS	ECD-4 6104
DMS LOCATIONS AND MESSAGES EASTBOUND	DMS-1	8	EASTBOUND LANE CLOSURE HWY. 80 & ELLIS AVE.	TC-4	25	4-LANE: MEDIAN LANE OR OUTSIDE LANE CLOSURE (WORK DAY ONLY)	TCP-2 6352
DMS LOCATIONS AND MESSAGES WESTBOUND	DMS-2	9	EASTBOUND CLOSURE PLAN DETOUR ON STATE STREET	TC-5	26	4-LANE: MEDIAN LANE OR OUTSIDE LANE CLOSURE (EXTENDED PERIOD)	TCP-3 6353
EASTBOUND CLOSURE PLAN CMS LOCATIONS	CMS-1	10	EASTBOUND CLOSURE PLAN DETOUR ON STATE STREET	TC-6	27	HIGHWAY SIGN AND BARRICADE DETAILS FOR CONSTRUCTION PROJECTS	TCP-8 6358
EASTBOUND CLOSURE PLAN CMS LOCATIONS	CMS-2	11	WESTBOUND CLOSURE PLAN I-20 @ TERRY ROAD	TC-7	28	DETAILS OF OUTSIDE LANE CLOSURE AT EXIT AND ENTRANCE RAMP	TCP-10 6360
EASTBOUND CLOSURE PLAN CMS LOCATIONS	CMS-3	12	WESTBOUND CLOSURE PLAN 55 NORTH APPROACH	TC-8	29	LOCATION OF R16-3 SIGNS (SPEEDING FINES DOUBLED)	TCP-15 6365
EASTBOUND CLOSURE PLAN CMS LOCATIONS	CMS-4	13	WESTBOUND CLOSURE PLAN COUNTY LINE ROAD	TC-9	30	TRAFFIC CONTROL DETAILS DRUM PLACEMENT AND SHOULDER CLOSURE	TCP-16 6366
WESTBOUND CLOSURE PLAN CMS LOCATIONS	CMS-5	14	WESTBOUND CLOSURE PLAN LANE DROP ON HWY. 80	TC-10	31		
WESTBOUND CLOSURE PLAN CMS LOCATIONS	CMS-6	15					

7/17/2019 5:01 PM DI.DGN

PS & E PLANS-DATE: 6/5/2019		
FMS CON. * 107884/301000		
REVISIONS		
DATE	SHEET NO.	BY

REVISION	MISSISSIPPI DEPARTMENT OF TRANSPORTATION	
	DETAILED INDEX	
DATE	PROJ. NO.: BR-0020-01(249) COUNTY: HINDS	
	FILENAME: DI.dgn DESIGN TEAM: E. GREEN CHECKED: DATE:	
PRELIMINARY		NOT FOR CONSTRUCTION
WORKING NUMBER		
DI-1		SHEET NUMBER
2		2

STATE	PROJECT NO.
MISS.	BR-0020-01(249)

GENERAL NOTES

- (1) THE LOCATION AND SPACING OF SIGNS, SHOWN ON THE TRAFFIC CONTROL PLANS, ARE APPROXIMATE AND MAY BE ADJUSTED AS NECESSARY TO FIT FIELD CONDITIONS.
- (2) ALL TRAFFIC CONTROL DEVICES ON THIS PROJECT SHALL COMPLY WITH PART VI OF THE *MUTCD* (LATEST EDITION).
- (3) ALL PLASTIC DRUMS SHALL HAVE A BALLASTING COLLAR MADE FROM RECYCLED TRUCK TIRES OR OTHER SUITABLE MATERIAL.
- (4) THE CONTRACTOR SHALL BE RESPONSIBLE FOR PROTECTING EXISTING STRUCTURES SUCH AS, BUT NOT LIMITED TO, PIPES, INLETS, APRONS, AND BRIDGES FROM DAMAGE WHICH MIGHT OCCUR DURING CONSTRUCTION. THE CONTRACTOR SHALL REPLACE OR REPAIR, AS DIRECTED BY THE ENGINEER, ANY STRUCTURES DAMAGED DURING THE LIFE OF THE CONTRACT. NO PAYMENT WILL BE MADE FOR REPLACEMENT OR REPAIR OF DAMAGED ITEMS.
- (5) WORK ON STRUCTURES FOR THIS PROJECT REQUIRES EXCAVATION IN THE IMMEDIATE VICINITY OF TRAFFIC AND ADJACENT PROPERTIES. THEREFORE, THE RISK OF A FAILURE OCCURRING DURING EXCAVATION REQUIRES THAT EXTREME CAUTION BE EXERCISED. THE CONTRACTOR SHALL BE RESPONSIBLE FOR PLACING WHAT BRACING, SHORING, OR GROUND SUPPORT SYSTEM THAT IS DEEMED NECESSARY TO PREVENT A FAILURE AND PROTECT THE PERSONS WORKING NEAR THE EXCAVATION, THE PUBLIC THAT MAY BE ABOVE THE EXCAVATION, OR ANY STRUCTURES ADJACENT TO THE EXCAVATION. ALL COSTS FOR DESIGNING, DRAWING, AND CONSTRUCTING THE FACILITY SHALL BE INCLUDED IN THE PRICE BID FOR CONTRACT ITEMS.
- (6) WIRE FENCE BACKING WILL BE REQUIRED FOR ALL SILT FENCE. (SEE WK. NO. ECD-3)
- (7) FLUORESCENT ORANGE SHEETING SHALL BE USED ON ALL CONSTRUCTION AND TRAFFIC CONTROL SIGNS EXCEPT FOR THOSE DESIGNATED ON THE PLANS TO BE BLACK LEGEND AND BORDER ON WHITE BACKGROUND.
- (8) THE CONTRACTOR SHALL COORDINATE WITH THE CONTRACTOR FROM ADJACENT PROJECT(S) IN IMPLEMENTING THE TRAFFIC CONTROL PLAN AS DIRECTED BY THE ENGINEER. ALL CONFLICTING SIGNS SHALL BE COVERED OR REMOVED AS DIRECTED BY THE ENGINEER. THE COST OF THIS WORK IS TO BE ABSORBED IN OTHER WORK ITEMS.
- (9) THE CONTRACTOR SHALL COVER ANY TEMPORARY TRAFFIC CONTROL SIGNS SHOWN IN THE TRAFFIC CONTROL PLAN THAT DO NOT APPLY TO THE CURRENT PHASE.
- (10) REMOVAL OF RAISED PAVEMENT MARKERS THAT ARE IN CONFLICT WITH REQUIRED CONSTRUCTION IS NOT CONSIDERED A SEPARATE PAY ITEM. COST TO BE ABSORBED IN OTHER ITEMS BID.
- (11) TEMPORARY STRIPING SHALL CONFORM TO FINISHED STRIPE SPECIFICATIONS FOR ALIGNMENT, NEATNESS, AND STRAIGHTNESS.
- (12) ALL ITEMS OF WORK ASSOCIATED WITH THE INSTALLATION OF A CONSTRUCTION ENTRANCE SHALL BE ABSORBED IN OTHER ITEMS OF WORK.
- (13) SEE BRIDGE PLANS FOR DETAILED INDEX SHEET(S), ESTIMATED AND SUMMARY OF QUANTITY SHEETS, AND EROSION CONTROL SHEETS.
- (14) ALL ADDENDA TO THESE PLANS WILL BE POSTED TO WWW.MDOT.MS.GOV UNDER THE PROPOSAL ADDENDA COLUMN. BIDDERS ARE ADVISED THAT HARD COPIES OF ANY ADDENDA FOR THIS PROJECT WILL NOT BE MAILED. IT IS THE BIDDER'S RESPONSIBILITY TO CHECK AND SEE IF ANY ADDENDA HAVE BEEN POSTED FOR THIS PROJECT.
- (15) STORAGE OF FLAMMABLE MATERIALS WILL NOT BE ALLOWED UNDER ANY BRIDGE STRUCTURES.
- (16) THE CONTRACTOR IS ADVISED THAT MDOT UNDERGROUND POWER AND MDOT UNDERGROUND FIBER OPTIC LINES ARE PRESENT IN THE MEDIAN BETWEEN THE EASTBOUND AND WESTBOUND BRIDGES. THE AS-BUILT PLANS FOR THE RELATED PROJECTS ARE AVAILABLE AT THE CONTRACTOR'S REQUEST. PORTIONS OF THE AS-BUILT PLANS ARE INCLUDED HEREIN FOR REFERENCE. THE CONTRACTOR SHALL CONDUCT WORK IN A MANNER SO AS TO AVOID INTERRUPTION OF THESE LINES. THE CONTRACTOR SHALL ALSO REFERENCE THE APPLICABLE NOTICE-TO-BIDDERS INCLUDED IN THE CONTRACT.
- (17) THE CONTRACTOR IS ADVISED THAT ACCESS ROADS AND OTHER SITE DISTURBANCE MAY BE REQUIRED FOR ACCESS TO THE BRIDGE SITE AND TO COMPLETE THE WORK BENEATH THE BRIDGES. THE CONTRACTOR MAY PERFORM MINOR CLEARING AND GRUBBING, GRADING, DITCHING, STABILIZATION, ETC. AT LOCATIONS APPROVED BY THE PROJECT ENGINEER. PROPER EROSION CONTROL MEASURES SHALL BE USED TO PREVENT SILTATION OF ADJACENT PROPERTIES AND THE WATERS OF THE STATE AND/OR WATERS OF THE U.S. THE CONTRACTOR SHALL PLACE AND MAINTAIN SILT FENCE AS REQUIRED TO PROTECT EXISTING WATERWAYS AND ADJACENT PROPERTIES. UPON COMPLETION OF THE PROJECT, THE DISTURBED AREAS SHALL BE GRASSED. NO PAYMENT WILL BE MADE FOR INCIDENTAL WORK NECESSARY FOR ACCESS (INCLUDING SUPPLEMENTARY EROSION CONTROL DEVICES, GRASSING, AND NECESSARY PERMITS).
- (18) THE CONTRACTOR IS ADVISED THAT EASTBOUND WORK IS TO BE COMPLETED BEFORE WESTBOUND OPERATIONS WILL BEGIN.
- (19) THE CONTRACTOR SHALL PLACE A MINIMUM OF TWO PLASTIC DRUMS IN ADVANCE OF ALL CHANGEABLE MESSAGE SIGNS AS WELL AS ONE BESIDE EACH CHANGEABLE MESSAGE SIGN AS LONG AS IT IS IN USE.
- (20) A CHANGEABLE MESSAGE SIGN SHALL BE PLACED ON EITHER END OF EACH BRIDGE SEVEN (7) DAYS PRIOR TO WORK BEGINNING ON THAT BRIDGE TO GIVE ADVANCED WARNING TO LOCAL TRAFFIC. CONTRACTOR SHALL COORDINATE WITH PROJECT ENGINEER FOR APPROPRIATE DISPLAY MESSAGE FOR THESE CHANGEABLE MESSAGE SIGNS.

7/18/2019 4:08 PM GN.DGN

					BY	MISSISSIPPI DEPARTMENT OF TRANSPORTATION							
						GENERAL NOTES							
					REVISION	PROJ. NO.: BR-0020-01(249) COUNTY: HINDS							
										<table border="1"> <tr> <td colspan="2">PRELIMINARY</td> </tr> <tr> <td colspan="2">NOT FOR</td> </tr> <tr> <td colspan="2">CONSTRUCTION</td> </tr> <tr> <td>WORKING NUMBER</td> <td>GN-1</td> </tr> <tr> <td>SHEET NUMBER</td> <td>3</td> </tr> </table>			
PRELIMINARY													
NOT FOR													
CONSTRUCTION													
WORKING NUMBER	GN-1												
SHEET NUMBER	3												
					DATE	FILENAME: GN.dgn							
					DESIGN TEAM	E. GREEN							
					CHECKED	DATE							