

STATE	PROJECT NUMBER	SHEET NO.
MISSISSIPPI	MP-1278-48(015)	1

GENERAL INDEX

INCLUDED THIS PROJECT	BEGIN WITH SHEET
<input checked="" type="checkbox"/> ROADWAY	1
<input type="checkbox"/> PERMANENT SIGNS	1001
<input type="checkbox"/> TRAFFIC SIGNALS	2001
<input type="checkbox"/> ITS COMPONENTS	3001
<input type="checkbox"/> LIGHTING	4001
<input type="checkbox"/> (RESERVED)	5001
<input checked="" type="checkbox"/> ROADWAY STANDARD DWGS	6001
<input type="checkbox"/> BOX CULVERT STD. DRAWINGS (LRFD)	7001
<input type="checkbox"/> BOX CULVERT STD. DRAWINGS (STD. SPEC.)	7501
<input type="checkbox"/> BRIDGE	8001
<input type="checkbox"/> CROSS SECTIONS	9001

BRIDGE STRUCTURES REQ'D.
NONE

BOX BRIDGES REQ'D.
NONE
B.O.P. 803+50

STATE OF MISSISSIPPI
MISSISSIPPI DEPARTMENT OF TRANSPORTATION

PLAN AND PROFILE OF PROPOSED STATE HIGHWAY

STATE PROJECT NO. MP-1278-48(015)

**US HWY 278 OVERLAY FROM AMORY TO SR 8
MONROE CO**

FMS CON. NO. 306970/301000

SCALES

PLAN	1 IN. = 100 FT.
PROFILE	HOR. 1 IN. = 100 FT.
	VERT. 1 IN. = 10 FT.
LAYOUT	1 IN. = FT.

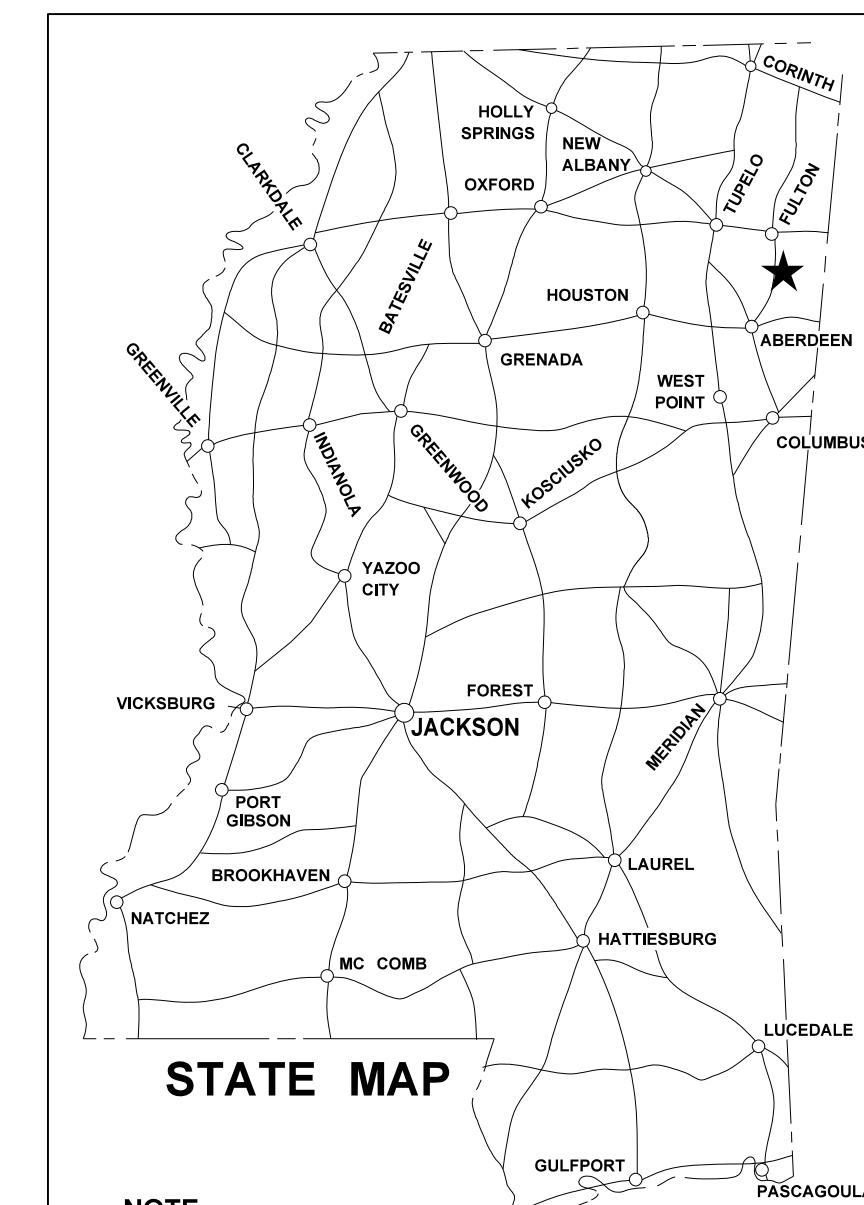
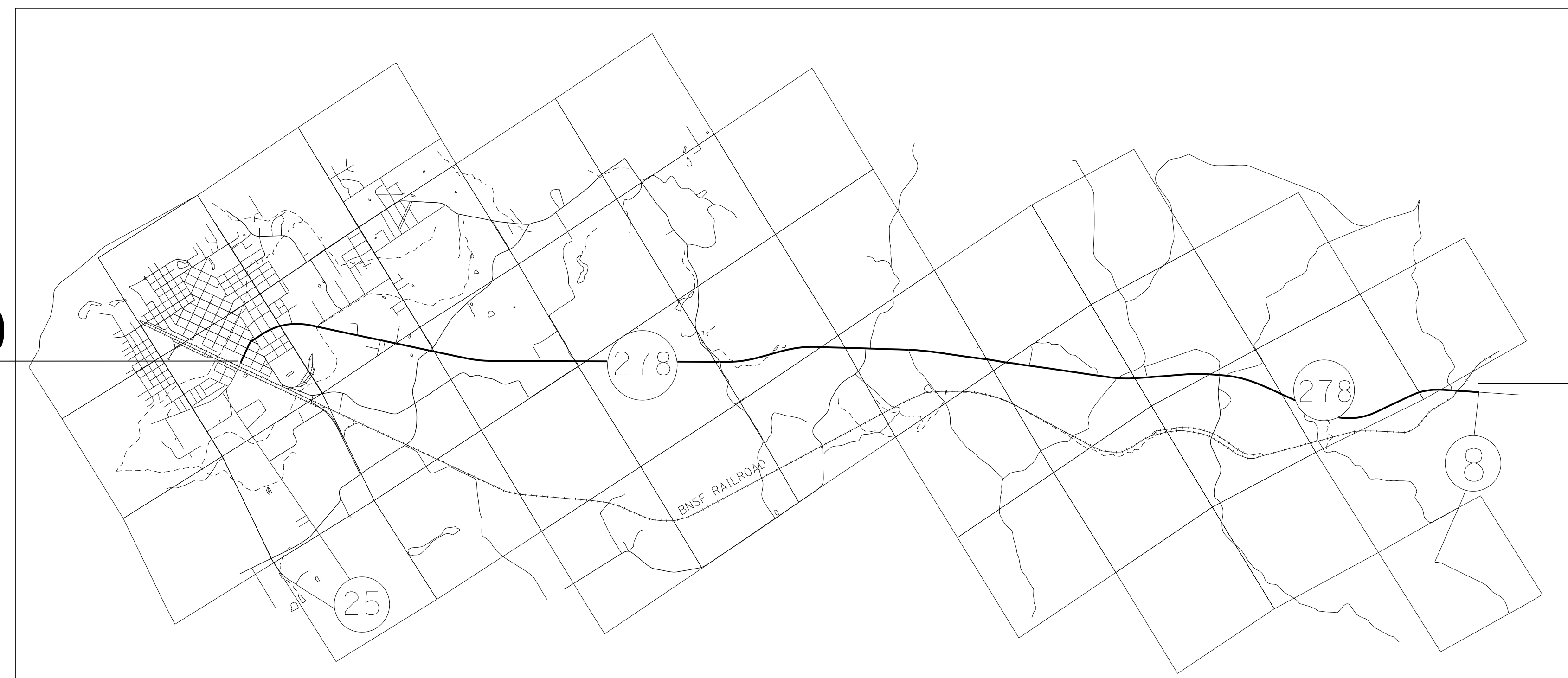

NOTE
★ INDICATES APPROXIMATE LOCATION OF PROJECT.
LAT. 33° 56' 900" N
LONG. 88° 25' 365" W
(APPROX. MIDDLE OF PROJECT)

DESIGN CONTROL

MPH = V (SPEED DESIGN)

ADT () = : ADT () =

DHV = : D = % T = %

PERMITS ACQUIRED BY MDOT

WETLANDS AND WATERS PERMITS		
	WATERS	WETLANDS
NATIONWIDE #14	N	N
NATIONWIDE (OTHER)*	N	N
GENERAL*	N	N
INDIVIDUAL (404)*	N	N
STORMWATER PERMIT <input checked="" type="checkbox"/>		
Y	REQUIRED CNOI SUBMITTED BY MDOT (DISTURBED AREA = 5 ACRES)	
S	REQUIRED SCNOI TO BE SUBMITTED BY CONTRACTOR (1 TO 4.99 ACRES)	
N	NO STORMWATER PERMIT REQUIRED (<1 ACRE)	
APPROVED BY: _____		

E.O.P. 1384+30

CONVENTIONAL SYMBOLS

COUNTY LINE	-----
TOWN CORPORATION LINE	-----
SECTION LINE	-----
EXISTING ROAD OR TRAVELED WAY	-----
PROPOSED ROAD OR TRAVELED WAY	-----
RAILROAD	-----
SURVEY LINE	-----
BRIDGES	-----

EQUATIONS

NONE

EXCEPTIONS

NONE

LENGTH DATA

LENGTH OF ROADWAY	57375 FT.	10.865 MI.
LENGTH OF BRIDGES	705 FT.	.135 MI.
LENGTH OF PROJECT (NET)	58080 FT.	11.00 MI.
LENGTH OF EXCEPTIONS	0 FT.	0 MI.
LENGTH OF PROJECT (GROSS)	58080 FT.	11.00 MI.

P S & E DATE: 03-12-2020

APPROVED: _____
DEPUTY EXECUTIVE DIRECTOR / CHIEF ENGINEER

EXECUTIVE DIRECTOR _____



001 00 AMPM DGNF LLENAM MISSISSIPPI DEPARTMENT OF TRANSPORTATION

