

**SECTION 905 -- PROPOSAL (CONTINUED)**

I (We) hereby certify by digital signature and electronic submission via Bid Express of the Section 905 proposal below, that all certifications, disclosures and affidavits incorporated herein are deemed to be duly executed in the aggregate, fully enforceable and binding upon delivery of the bid proposal. I (We) further acknowledge that this certification shall not extend to the bid bond or alternate security which must be separately executed for the benefit of the Commission. This signature does not cure deficiencies in any required certifications, disclosures and/or affidavits. I (We) also acknowledge the right of the Commission to require full and final execution on any certification, disclosure or affidavit contained in the proposal at the Commission's election upon award. Failure to so execute at the Commission's request within the time allowed in the Standard Specifications for execution of all contract documents will result in forfeiture of the bid bond or alternate security.

Bidder acknowledges receipt of and has added to and made a part of the proposal and contract documents the following addendum (addenda):

ADDENDUM NO. <u>  1  </u>	DATED <u>  9/9/2020  </u>	ADDENDUM NO. _____	DATED _____
ADDENDUM NO. _____	DATED _____	ADDENDUM NO. _____	DATED _____
ADDENDUM NO. _____	DATED _____	ADDENDUM NO. _____	DATED _____

Number	Description
1	Revised or Added Plan Sheet Nos. 1-3, 16, 37 & 39; Amendment EBSx Download Required.

TOTAL ADDENDA:   1    
(Must agree with total addenda issued prior to opening of bids)

Respectfully Submitted,

DATE \_\_\_\_\_

\_\_\_\_\_  
Contractor

BY \_\_\_\_\_  
Signature

TITLE \_\_\_\_\_

ADDRESS \_\_\_\_\_

CITY, STATE, ZIP \_\_\_\_\_

PHONE \_\_\_\_\_

FAX \_\_\_\_\_

E-MAIL \_\_\_\_\_

(To be filled in if a corporation)

Our corporation is chartered under the Laws of the State of \_\_\_\_\_ and the names, titles and business addresses of the executives are as follows:

_____ President	_____ Address
_____ Secretary	_____ Address
_____ Treasurer	_____ Address

The following is my (our) itemized proposal.

BR-9999-01(249)/ 106092301000

Tishomingo County(ies)

Revised 01/26/2016

**GENERAL INDEX**

INCLUDED THIS PROJECT	BEGIN WITH SHEET
<input checked="" type="checkbox"/> ROADWAY	1
<input type="checkbox"/> PERMANENT SIGNS	1001
<input type="checkbox"/> TRAFFIC SIGNALS	2001
<input type="checkbox"/> ITS COMPONENTS	3001
<input type="checkbox"/> LIGHTING	4001
<input type="checkbox"/> (RESERVED)	5001
<input checked="" type="checkbox"/> ROADWAY STANDARD DWGS	6001
<input type="checkbox"/> BRIDGE STANDARD DWGS	7001
<input checked="" type="checkbox"/> BRIDGE	8001
<input checked="" type="checkbox"/> CROSS SECTIONS	9001

**BRIDGE STRUCTURES REQ'D.**

- (A) BR. NO. 0.9  
STA. 891+80.701 - STA. 894+53.299  
SPANS REQ'D. 1@80', 1@110', 1@80'  
30° RT. FWD. SKEW  
270'-0" ALONG CENTERLINE
- (B) BR. NO. 2.3  
STA. 362+26 - STA. 365+59.323  
SPANS REQ'D. 1@110', 1@110', 1@110'  
30° RT. FWD. SKEW  
330'-0" ALONG CENTERLINE

**BOX BRIDGES REQ'D.**

NONE

STATE OF MISSISSIPPI

MISSISSIPPI DEPARTMENT OF TRANSPORTATION

**PLAN AND PROFILE OF PROPOSED  
STATE HIGHWAY  
FEDERAL AID PROJECT NO. BR-9999-01(249)**

**SR 172 BRIDGE REPLACEMENT  
TISHOMINGO COUNTY**

**FMS: 106092301000**

**SCALES**

PLAN	1 IN. = 100 FT.
PROFILE	1 IN. = 100 FT.
HOR.	1 IN. = 10 FT.
VERT.	1 IN. = 10 FT.
LAYOUT	1 IN. = 3000 FT.

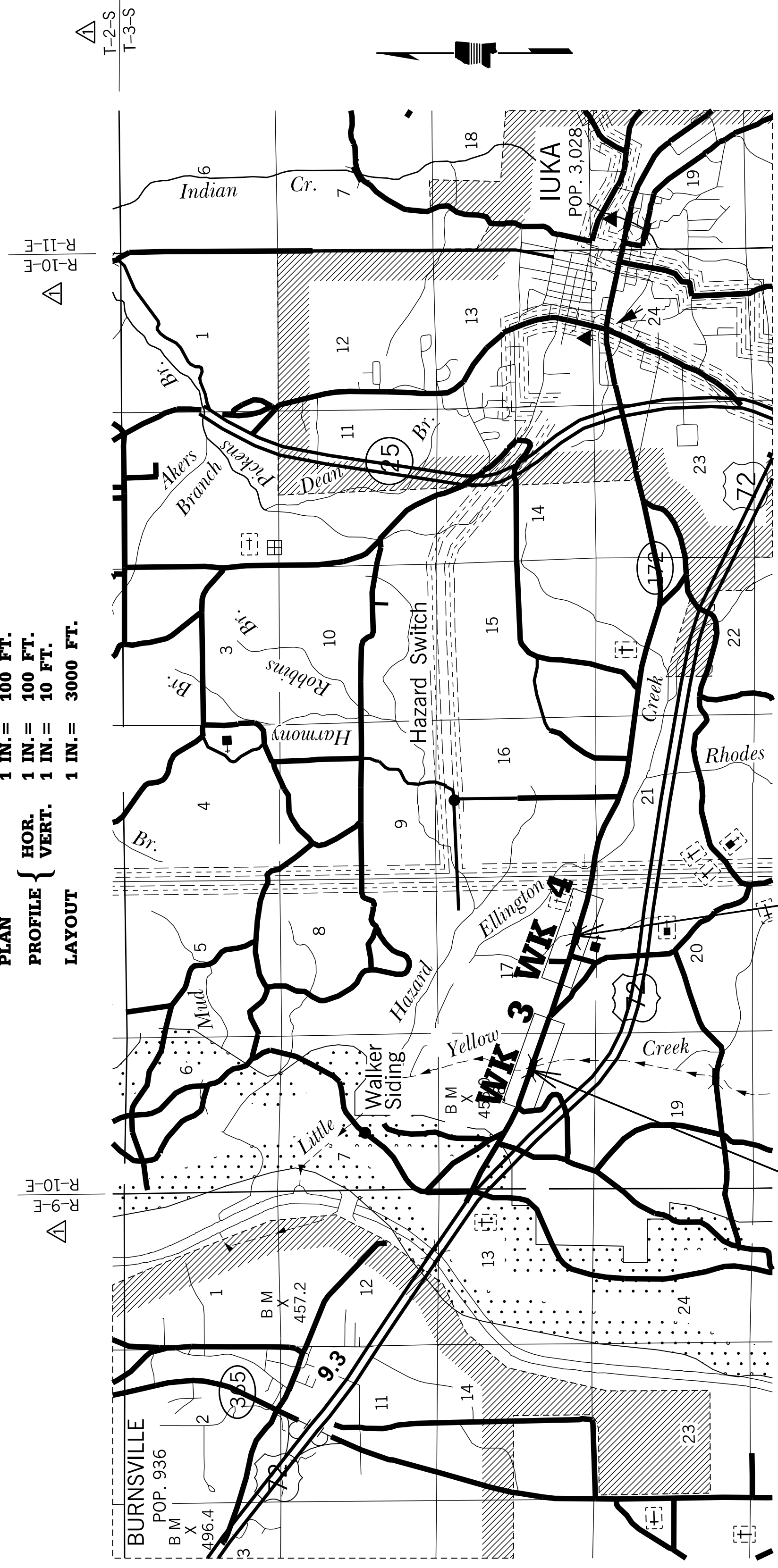

(A) **SITE 1**

**BR. #0.9**

B.O.P. STA. 886+80 - E.O.P. STA. 900+00

**EQUATIONS**

STA. 366 + 85.700 BK = 366 + 86.700 AH - 1.000'

(B) **SITE 2**

**BR. #2.3**

B.O.P. STA. 354+80 - E.O.P. STA. 370+80

**EXCEPTIONS**

**LENGTH DATA**

	SITE 1 BR. #0.9		SITE 2 BR. #2.3	
LENGTH OF ROADWAY	1247.40 FT.	0.236 MI.	1496.35 FT.	0.283 MI.
LENGTH OF BRIDGES	272.59 FT.	0.052 MI.	332.64 FT.	0.063 MI.
LENGTH OF PROJECT (NET)	1519.99 FT.	0.288 MI.	1828.99 FT.	0.346 MI.
LENGTH OF EXCEPTIONS	0.00 FT.	0.000 MI.	0.00 FT.	0.000 MI.
LENGTH OF PROJECT (GROSS)	1519.99 FT.	0.288 MI.	1828.99 FT.	0.346 MI.

STATE	PROJECT NUMBER	SHEET NO.
MISSISSIPPI	BR-9999-01(249)	1

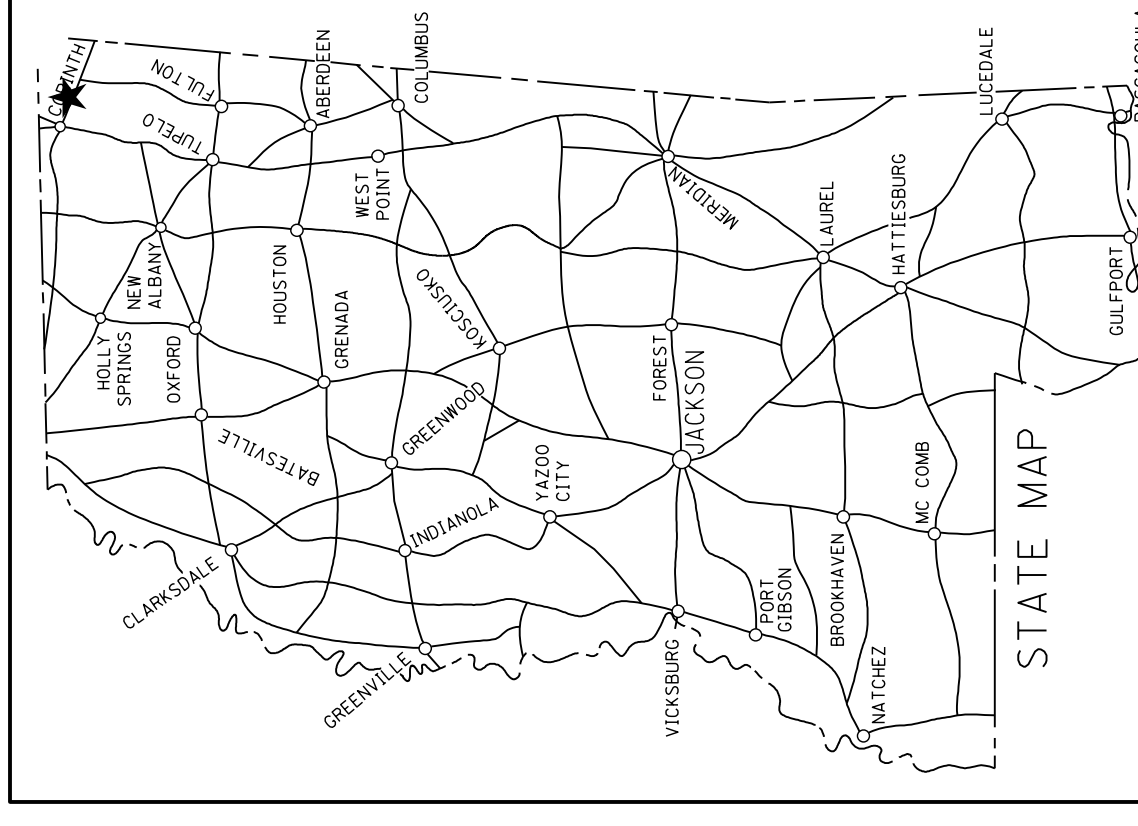

NOTE  
★ INDICATES APPROXIMATE LOCATION OF PROJECT.  
LAT. 34°48'51" LONG. 88°16'04"  
(APPROX. MIDDLE OF PROJECT)

<b>DESIGN CONTROL</b>	55 MPH = V (SPEED DESIGN)
ADT (1700) = 2028 ; ADT (1999) = 2038	
DHV = 240 ; D = 60 % ; T = 13 %	
<b>PERMITS ACQUIRED BY MDTOT</b>	
WETLANDS AND WATERS PERMITS (NECESSARY FOR ULTIMATE IMPROVEMENTS ONLY):	
WATERS	<input checked="" type="checkbox"/> Y <input type="checkbox"/> N
WETLANDS	<input type="checkbox"/> Y <input checked="" type="checkbox"/> N
NATIONWIDE #14	<input type="checkbox"/> Y <input checked="" type="checkbox"/> N
NATIONWIDE (OTHER)*	<input type="checkbox"/> Y <input checked="" type="checkbox"/> N
GENERAL*	<input type="checkbox"/> Y <input checked="" type="checkbox"/> N
INDIVIDUAL (404)*	<input type="checkbox"/> Y <input checked="" type="checkbox"/> N
* ACQUISITION OF PERMITS FOR TEMPORARY IMPACTS DURING CONSTRUCTION ARE THE RESPONSIBILITY OF THE CONTRACTOR	
STORMWATER PERMIT	<input checked="" type="checkbox"/> S <input type="checkbox"/> N
REQUIRED CNOI SUBMITTED BY MDTOT (DISTURBED AREA=5 ACRES)	<input type="checkbox"/> Y <input checked="" type="checkbox"/> N
REQUIRED SCNOI TO BE SUBMITTED BY CONTRACTOR (1 TO 4.59 ACRES)	<input type="checkbox"/> Y <input checked="" type="checkbox"/> N
NO STORMWATER PERMIT REQUIRED (<1 ACRE)	<input type="checkbox"/> Y <input checked="" type="checkbox"/> N
APPROVED BY:	

APPROVED:	P S & E DATE: 5-04-20
DEPUTY EXECUTIVE DIRECTOR / CHIEF ENGINEER	
EXECUTIVE DIRECTOR	
<b>MDOT</b> MISSISSIPPI DEPARTMENT OF TRANSPORTATION	



**ADDENDUM**

DESCRIPTION OF SHEET

WKG. NO. SH. NO.

TITLE SHEET (1)		1
DETAILED INDEX & GENERAL NOTES (3)		
DETAILED INDEX	DI-1	2
DETAILED INDEX	DI-2	3
GENERAL NOTES	GN-1	4
TYPICAL SECTION SHEETS (2)		
TYPICAL SECTION - HWY. 172	TS-1	5
TYPICAL SECTION - SCHOOL DRIVE	TS-2	6
QUANTITY SHEETS (4)		
SUMMARY OF QUANTITIES	SQ-1	7
SUMMARY OF QUANTITIES	SQ-2	8
SUMMARY OF QUANTITIES	SQ-3	9
SUMMARY OF QUANTITIES	SQ-4	10
ESTIMATED QUANTITIES (9)		
ESTIMATED QUANTITIES - REMOVAL ITEMS	EQ-1	11
ESTIMATED QUANTITIES - DRAINAGE STRUCTURES	EQ-2	12
ESTIMATED QUANTITIES - DRIVEWAYS, C&G, & SIDE DRAINS REQ'D.	EQ-3	13
ESTIMATED QUANTITIES - JUNCTION BOXES, GUARDRAIL, & EARTHWORK REQ'D.	EQ-4	14
ESTIMATED QUANTITIES - BRIDGE END PAV'T. & EROSION CONTROL REQ'D.	EQ-5	15
ESTIMATED QUANTITIES - PAVEMENT MARKINGS REQ'D.	EQ-6	16
ESTIMATED QUANTITIES - TRAFFIC CONTROL SIGNS REQ'D.	EQ-7	17
ESTIMATED QUANTITIES - STANDARD ROADSIDE SIGNS	SRS-1	18
ESTIMATED QUANTITIES - STANDARD ROADSIDE SIGNS	SRS-2	19
PLAN & PROFILE SHEETS (3)		
HWY. 172 - SITE 1	WK-3	20
HWY. 172 SITE 2	WK-4	21
SCHOOL DRIVE	WK-4A	22
SPECIAL DESIGN SHEETS (17) <sup>Δ</sup> <sub>Δ</sub>		
VEGETATION SCHEDULE	VS-1	23
DETOUR PLAN - DETOUR SIGNING AT BRIDGES	DET-1	24
DETOUR PLAN - DETOUR SIGNING AT BRIGDES	DET-2	25
DETOUR PLAN - DETOUR SIGNING AT BRIGDES	DET-3	26
DETOUR PLAN - OFFSITE DETOURS	ODET-1	27
DETOUR PLAN - OFFSITE DETOURS	ODET-2	28
DETOUR PLAN - OFFSITE DETOURS	ODET-3	29
PERMANENT PAVEMENT MARKINGS	PMD-1	30
PERMANENT PAVEMENT MARKINGS	PMD-2	31
INTERSECTION DETAIL - SCHOOL DRIVE	ID-1	32
PRELIMINARY EROSION CONTROL PLAN	ECP-3	33
PRELIMINARY EROSION CONTROL PLAN	ECP-4	34
RIPRAPRIAN BUFFER - LITTLE YELLOW CREEK	ECP-RB-3	35
RIPRAPRIAN BUFFER - ELLINGTON BRANCH	ECP-RB-4	36
<sup>Δ</sup> RIGHT OF WAY MARKERS	RWMS-1	37
<sup>Δ</sup> MISCELLANEOUS DETAIL SHEET	MDS-1	38
<sup>Δ</sup> EASEMENT COORDINATE SHEET	ESMT-1	39

DESCRIPTION OF SHEET

WKG. NO. SH. NO.

STANDARD DRAWINGS - ROADWAY SHEETS (68)		
BRIDGE END PAVEMENT WITH RAIL, OVERLAY, AND SLEEPER SLAB (NEW CONSTRUCTION)	BE-1	6007
43.5" BRIDGE END PAVEMENT RAIL	BER-2	6010
CONCRETE ISLAND PAVEMENT DETAILS	CIP-1	6011
PAVEMENT MARKING DETAILS FOR 2-LANE & 4-LANE DIVIDED ROADWAYS	PM-1	6051
PAVEMENT MARKING DETAILS FOR 3-LANE, 4-LANE & 5-LANE UNDIVIDED ROADWAYS	PM-2	6052
PAVEMENT MARKING LEGEND DETAILS	PM-6	6056
2-WAY RAISED PAVEMENT MARKERS AT INTERSECTING ROADS (2-LANE)	PM-11	6061
RUMBLE STRIPES 2-LANE HIGHWAYS (ASPHALT LANES, 2-FT ASPHALT SHOULDERS)	RS-1	6064
TYPICAL TEMPORARY EROSION CONTROL/SEDIMENT CONTROL APPLICATIONS	ECD-1	6101
DETAILS OF SEDIMENT BARRIER APPLICATIONS	ECD-2	6102
DETAILS OF SILT FENCE INSTALLATION	ECD-3	6103
DITCH CHECK STRUCTURES, STYPICAL APPLICATIONS AND DETAILS	ECD-4	6104
TEMPORARY EROSION, SEDIMENT, AND WATER POLLUTION CONTROL MEASURES		
(SILT FENCE AND HAY BALE DITCH CHECKS)	ECD-5	6105
DETAILS OF EROSION CONTROL/WATTLE DITCH CHECK	ECD-6	6106
DETAILS OF EROSION CONTROL/SILT DIKE DITCH CHECK	ECD-7	6107
ROCK DITCH CHECK	ECD-8	6108
ROCK FILTER DAM	ECD-9	6109
ROCK DITCH CHECK WITH SUMP EXCAVATION AND ROCK FILTER DAM	ECD-10	6110
TYPICAL APPLICATIONS AND DETAILS FOR INLET CONSTRUCTION	ECD-11	6111
INLET PROTECTION DETAILS FOR SEDIMENT CONTROL STONE ON GRADES AND SAGS	ECD-12	6112
INLET PROTECTION DETAILS OF WATTLES	ECD-13	6113
INLET PROTECTION DETAILS OF MANUFACTURED INLET PROTECTION DEVICE	ECD-14	6114
INLET PROTECTION DETAILS OF SANDBAGS	ECD-15	6115
STABILIZED CONSTRUCTION ENTRANCE	ECD-16	6116
DETAILS OF EROSION CONTROL SANDBAG DITCH CHECK	ECD-21	6121
SEDIMENT RETENTION BARRIER	ECD-22	6122
DETAILS OF TYPICAL DITCH TREATMENTS	DT-1	6123
TYPICAL TEMPORARY EROSION CONTROL MEASURES (TYPE D SILT BASIN)		
(135 CU. YDS. CAPACITY PER ACRE OF DRAINAGE)	BAS-D	6129
GUARDRAIL: "W" BEAM (WOOD POSTS)	GR-1	6201
GUARDRAIL: THRIE BEAM (WOOD POSTS)	GR-1A	6202
GUARDRAIL: "W" BEAM (STEEL POSTS)	GR-1B	6203
GUARDRAIL: BRIDGE END SECTION - TYPE 1 (WOOD POSTS).(NEW CONSTRUCTION)	GR-2F	6210
GUARDRAIL: BRIDGE END SECTION - TYPE 1 (STEEL POSTS).(NEW CONSTRUCTION)	GR-2G	6211
GUARDRAIL: TYPE 1 CABLE ANCHORAGE (FOUNDATION TUBE)	GR-3	6212
GUARDRAIL: TYPE 1 CABLE ANCHORAGE (CONCRETE FOOTING)	GR-3A	6213
GUARDRAIL: TYPICAL INSTALLATION AT BRIDGE APPROACHES		
FOR 2-LANE, 2-WAY HIGHWAY	GR-4A	6215
GUARDRAIL: RUB RAIL HARDWARE	GR-RR	6218
GUARDRAIL: MISCELLANEOUS HARDWARE	GR-HW	6221

PS & E PLANS-DATE 5/04/20		
FMS CON. # 106092/301000		
REVISIONS		
DATE	SHEET NO.	BY
7/08/2002	3, 9, 36 & 38	TAD
8/21/2007		TAD
8/28/2001	2, 3, 16, 37 & 39	TAD

BY	
TAD	
REVISION	
REVISION NAME & ADDED SHEET	
8/28/20	
DATE	
FILENAME: DI-HWY172.DGN	
DESIGN TEAM	DOVER
CHECKED	DATE
UPDATE	DATE

**DETAILED INDEX**

MISSISSIPPI DEPARTMENT OF TRANSPORTATION

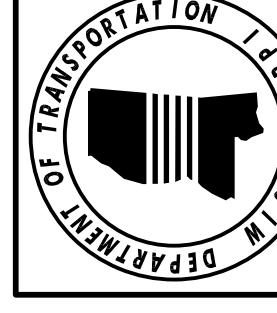

PROJ. NO.: BR-9999-01(249)  
COUNTY: TISHOMINGO

WORKING NUMBER	DI-1
SHEET NUMBER	2





ADDENDUM

SUMMARY OF PAVEMENT MARKINGS

Table with columns: WK. SH. NO., STATION TO STATION, PAINT (CONTINUOUS, DETAIL, SKIP), THERMOPLASTIC (LEGEND, EDGE, DETAIL, SKIP), TAPE (CONTINUOUS, DETAIL, SKIP), MARKERS (YELLOW, RED, CLEAR), REMARKS.

SUMMARY OF TRAFFIC CONTROL ITEMS REQUIRED

Table with columns: WORKING NUMBER, PHASE OF CONST., TEMPORARY (PAINT OR TAPE, STRIPE), TRAFFIC (TRAFFIC, BARRICADES, WARNING LIGHTS, CONTROL), ITEMS (TRAFFIC, CONTROL), REQUIRED (TRAFFIC, CONTROL), REMARKS.

MISSISSIPPI DEPARTMENT OF TRANSPORTATION ESTIMATED QUANTITIES PAVEMENT MARKINGS PROJ. NO.: BR-9999-01(249) COUNTY: TISHOMINGO



