

1st O.REV.

GENERAL INDEX

INCLUDED THIS PROJECT	BEGIN WITH SHEET
<input checked="" type="checkbox"/> ROADWAY	1
<input type="checkbox"/> PERMANENT SIGNS	1001
<input type="checkbox"/> TRAFFIC SIGNALS	2001
<input type="checkbox"/> ITS COMPONENTS	3001
<input type="checkbox"/> LIGHTING	4001
<input type="checkbox"/> (RESERVED)	5001
<input checked="" type="checkbox"/> ROADWAY STANDARD DWGS	6001
<input type="checkbox"/> BOX CULVERT STD. DRAWINGS (LRFD)	7001
<input type="checkbox"/> BOX CULVERT STD. DRAWINGS (STD. SPEC.)	7501
<input type="checkbox"/> BRIDGE	8001
<input type="checkbox"/> CROSS SECTIONS	9001

BRIDGE STRUCTURES REQ'D.
NONE

BOX BRIDGES REQ'D.
NONE

B.O.P STA. 36 + 65

STATE OF MISSISSIPPI
MISSISSIPPI DEPARTMENT OF TRANSPORTATION

PLAN AND PROFILE OF PROPOSED STATE HIGHWAY

STATE PROJECT NO. SP-1006-41(012)

SR 6 FROM SR 178 TO NETTLETON

FMS CON. NO. 108568 /301000

LEE COUNTY

SCALES

PLAN	1 IN. = 100 FT.
PROFILE	HOR. 1 IN. = 100 FT.
	VERT. 1 IN. = 10 FT.
LAYOUT	1 IN. = FT.

E.O.P STA. 759 + 50

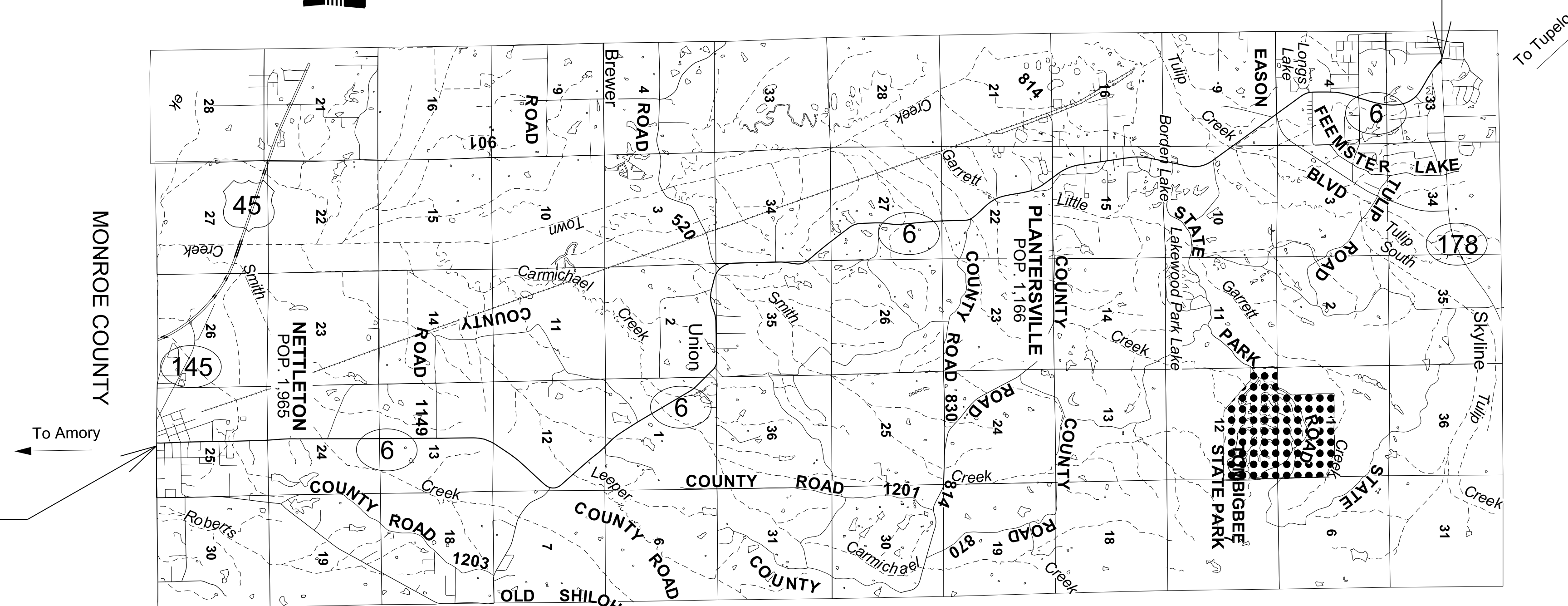

STATE	PROJECT NUMBER	SHEET NO.
MISSISSIPPI	SP-1006-41(012)	1

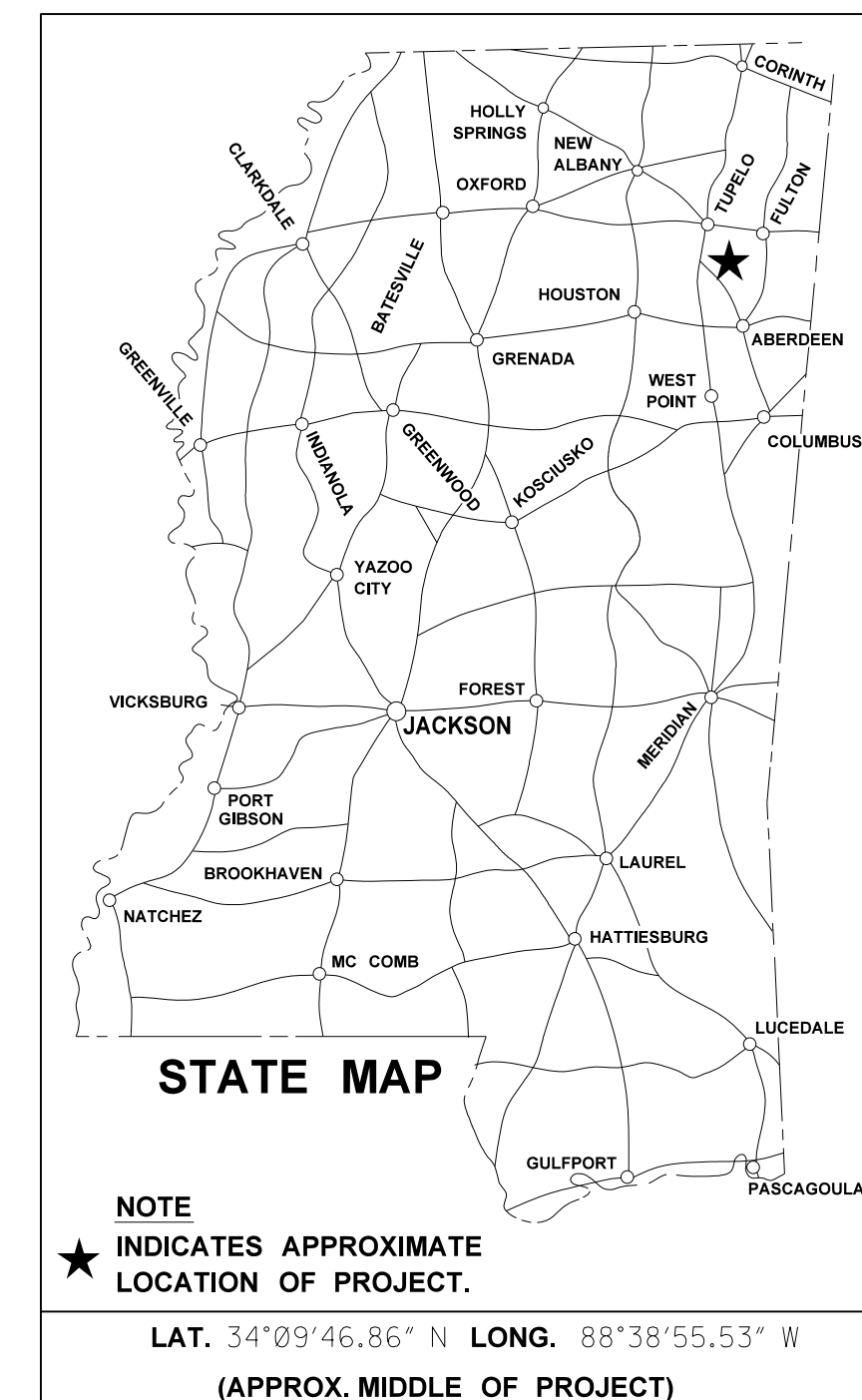

DESIGN CONTROL

MPH = V (SPEED DESIGN)

ADT () = : ADT () =

DHV = : D = % T = %

PERMITS ACQUIRED BY MDOT

WETLANDS AND WATERS PERMITS		
	WATERS	WETLANDS
NATIONWIDE #14	N	N
NATIONWIDE (OTHER)*	N	N
GENERAL*	N	N
INDIVIDUAL (404)*	N	N
STORMWATER PERMIT N		
Y	REQUIRED CNOI SUBMITTED BY MDOT (DISTURBED AREA = 5 ACRES)	
S	REQUIRED SCNOI TO BE SUBMITTED BY CONTRACTOR (1 TO 4.99 ACRES)	
N	NO STORMWATER PERMIT REQUIRED (<1 ACRE)	
APPROVED BY:		

CONVENTIONAL SYMBOLS

COUNTY LINE	-----
TOWN CORPORATION LINE	-----
SECTION LINE	-----
EXISTING ROAD OR TRAVELED WAY	-----
PROPOSED ROAD OR TRAVELED WAY	-----
RAILROAD	-----
SURVEY LINE	-----
BRIDGES	-----

EQUATIONS

NONE

EXCEPTIONS

NONE

LENGTH DATA

LENGTH OF ROADWAY	72095 FT.	13.65 MI.
LENGTH OF BRIDGES	190 FT.	.04 MI.
LENGTH OF PROJECT (NET)		13.69 MI.
LENGTH OF EXCEPTIONS	0 FT.	0 MI.
LENGTH OF PROJECT (GROSS)		13.69 MI.

P S & E DATE: 02 /20 /20

APPROVED:	
DEPUTY EXECUTIVE DIRECTOR / CHIEF ENGINEER	
EXECUTIVE DIRECTOR	



1st O.REV.

DESCRIPTION OF SHEET

WKG. NO. SH. NO.

TITLE SHEET (1)			1
DETAILED INDEX & GENERAL NOTES (1)			
DETAILED INDEX & GENERAL NOTES	DI-1		2
TYPICAL SECTION SHEETS (2)			
TYPICAL OVERLAY SECTION FOR HWY 6	TS-1		3
TYPICAL DIGOUT SECTION FOR HWY 6	TS-2		4
QUANTITY SHEETS (2)			
SUMMARY OF QUANTITIES	SQ-1		5
SUMMARY OF QUANTITIES	SQ-2		6
SPECIAL DESIGN SHEETS (10) 			
DETAIL OF CONSTRUCTION SIGNING	CS-1		7
DETAIL OF CONSTRUCTION SIGNING	CS-2		8
DETAIL OF CONSTRUCTION SIGNING	CS-3		9
DETAIL OF CONSTRUCTION SIGNING	CS-4		10
DETAIL OF CONSTRUCTION SIGNING	CS-5		11
SIGNING OF TWO-WAY TRAFFIC FOR NO PASSING ZONES	TC-1		12
DETAIL OF MILLING TRANSITIONS	DM-1		13
DETAIL OF LOOP ASSEMBLY	LA-1		14
DETAIL OF LOOP ASSEMBLY	LA-2		15
STOP SIGN RUMBLES	SDSSR-1		16
STANDARD DRAWINGS - ROADWAY SHEETS (11)			
PAVEMENT MARKING DETAILS FOR 2 AND 4-LANE DIVIDED ROADWAYS	08-01-17	PM-1	6051
PAVEMENT MARKING DETAILS FOR 3-LANE 4-LANE AND 5-LANE UNDIVIDED ROADWAYS	08-01-17	PM-2	6052
PAVEMENT MARKING LEGEND DETAILS	08-01-17	PM-6	6056
2-WAY RAISED PAVEMENT MARKERS AT INTERSECTING ROADS (2-LANE)	08-01-17	PM-11	6061
TRAFFIC CONTROL PLAN WITH FLAGGER (ONE-LANE CLOSURE OF TWO-WAY TRAFFIC)	08-01-17	TCP-1	6351
TRAFFIC CONTROL PLAN FOR POSTED SPEED LIMIT LESS THAN 65 MPH	08-01-17	TCP-2	6352
HIGHWAY SIGN AND BARRICADE DETAILS FOR CONSTRUCTION PROJECTS	08-01-17	TCP-8	6358
TRAFFIC CONTROL PLAN MOBILE OPERATIONS MULTILANE ROADS AND TWO-LANE ROADS	08-01-17	TCP-9	6359
TRAFFIC CONTROL PLANS UNEVEN PAVEMENT DETAILS	08-01-17	TCP-12	6362
TEMPORARY STRIPING FOR TRAFFIC CONTROL 2-LANE AND 4-LANE DIVIDED HIGHWAYS	08-01-17	TCP-13	6363
HEADWALLS FOR CONCRETE PIPE 2:1 SLOPE -0° -15° SKEW	08-01-17	HW-2100	6571

GENERAL NOTES

- (1) THE LOCATION AND SPACING OF SIGNS, SHOWN ON THE TRAFFIC CONTROL PLANS, ARE APPROXIMATE AND MAY BE ADJUSTED AS NECESSARY TO FIT FIELD CONDITIONS.
- (2) MAXIMUM LANE CLOSURE ALLOWED IS 1 MILE. A MINIMUM DISTANCE OF 3 MILES IS REQUIRED FOR CLOSURES IN ADJACENT LANES. A MINIMUM OF 2 MILES IS REQUIRED FOR CLOSURES IN THE SAME LANE.
- (3) FLUORESCENT ORANGE SHEETING SHALL BE USED ON ALL CONSTRUCTION AND TRAFFIC CONTROL SIGNS EXCEPT FOR THOSE DESIGNATED ON THE PLANS TO BE BLACK LEGEND AND BORDER ON WHITE BACKGROUND.
- (4) ALL TRAFFIC CONTROL DEVICES ON THIS PROJECT SHALL COMPLY WITH PART VI OF THE MUTCD (LATEST EDITION).
- (5) BIDDERS ARE ADVISED THAT HARD COPIES OF ANY ADDENDA FOR THIS PROJECT WILL NO LONGER BE MAILED. ALL ADDENDA FOR THIS PROJECT WILL BE POSTED TO WWW.MDOT.MS.GOV UNDER THE PROPOSAL ADDENDA COLUMN. IT IS THE BIDDERS RESPONSIBILITY TO CHECK AND SEE IF ANY ADDENDA HAVE BEEN POSTED FOR THIS PROJECT. PLEASE CONTACT CONTRACT ADMINISTRATION DIVISION AT 601-359-7700 FOR ANY QUESTIONS REGARDING ELECTRONIC ADDENDA.
-  (6) ANY REFERENCE TO PROJECT NUMBER MP-1006-41(012) AND 306956/301000 IS TO UNDERSTOOD THAT SP-1006-41(012) AND 108568/301000 IS THE CORRECT NUMBER.

ROADWAY DESIGN DIVISION C.A.D.D. SECTION MISSISSIPPI DEPARTMENT OF TRANSPORTATION

 TOTAL NUMBER OF SHEETS (27)

PS & E PLANS-DATE...02/20/20		
FMS CON. # 108568/301000		
REVISIONS		
DATE	SHEET NO.	BY
05/15/20	2,5,6,13	TRG
07/21/20	1,2	TRG
08/19/20	2,5,16	TRG

<table border="1"> <tr> <td>ADDED STOP SIGN RUMBLES</td> <td>TRG</td> </tr> <tr> <td>ADDED GENERAL NOTE</td> <td>TRG</td> </tr> <tr> <td>ADDED REVISIONS</td> <td>TRG</td> </tr> <tr> <td>REVISION</td> <td>BY</td> </tr> <tr> <td>DATE</td> <td> </td> </tr> </table>	ADDED STOP SIGN RUMBLES	TRG	ADDED GENERAL NOTE	TRG	ADDED REVISIONS	TRG	REVISION	BY	DATE		<p>MISSISSIPPI DEPARTMENT OF TRANSPORTATION</p> <p>DETAILED INDEX</p> <p>PROJECT NO. MP-1006-41(012) COUNTY : LEE</p> <p>WORKING NUMBER DI-1</p> <p>SHEET NUMBER 2</p>
ADDED STOP SIGN RUMBLES	TRG										
ADDED GENERAL NOTE	TRG										
ADDED REVISIONS	TRG										
REVISION	BY										
DATE											
<table border="1"> <tr> <td>DESIGN TEAM</td> <td>CHECKED</td> <td>DATE</td> </tr> </table>	DESIGN TEAM	CHECKED	DATE	<p>FILENAME: _____</p>							
DESIGN TEAM	CHECKED	DATE									