

1st O.REV.

GENERAL INDEX

INCLUDED THIS PROJECT	BEGIN WITH SHEET
<input checked="" type="checkbox"/> ROADWAY	1
<input checked="" type="checkbox"/> PERMANENT SIGNS	1001
<input type="checkbox"/> TRAFFIC SIGNALS	2001
<input type="checkbox"/> ITS COMPONENTS	3001
<input type="checkbox"/> LIGHTING	4001
<input type="checkbox"/> (RESERVED)	5001
<input checked="" type="checkbox"/> ROADWAY STANDARD DWGS	6001
<input type="checkbox"/> BRIDGE STANDARD DWGS	7001
<input checked="" type="checkbox"/> BRIDGE	8001
<input checked="" type="checkbox"/> CROSS SECTIONS	9001

STATE OF MISSISSIPPI  
MISSISSIPPI DEPARTMENT OF TRANSPORTATION

PLAN AND PROFILE OF PROPOSED  
STATE HIGHWAY  
FEDERAL PROJECT NO. BR-0026-01(079)

SR 19 BRIDGE REPLACEMENTS  
(BRIDGES No. 57.6)  
NESHOPA COUNTY

FMS R.O.W.# 106114-202000  
FMS CON# 106114-302000

BRIDGE STRUCTURES REQ'D.

NONE

BOX BRIDGES REQ'D.

- (A) Box Bridge No. 57.6 (Kentawka Canal Trib)  
Sta. 851+66.61  
DBL 14'x12' Box Culvert  
Skew = 0°  
Total Length Along C = 29.5'

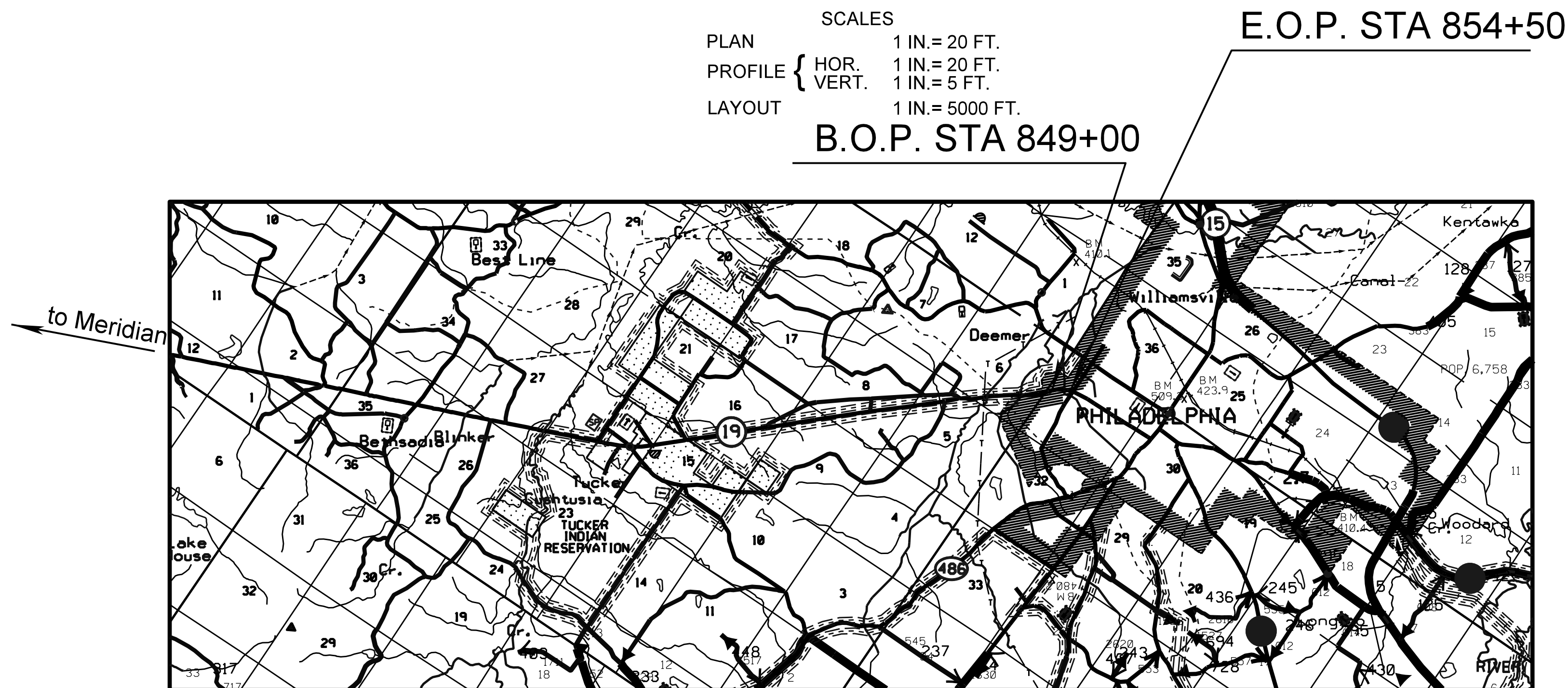

STATE	PROJECT NUMBER	SHEET NO.
MISSISSIPPI	BR-0026-01(079)	1

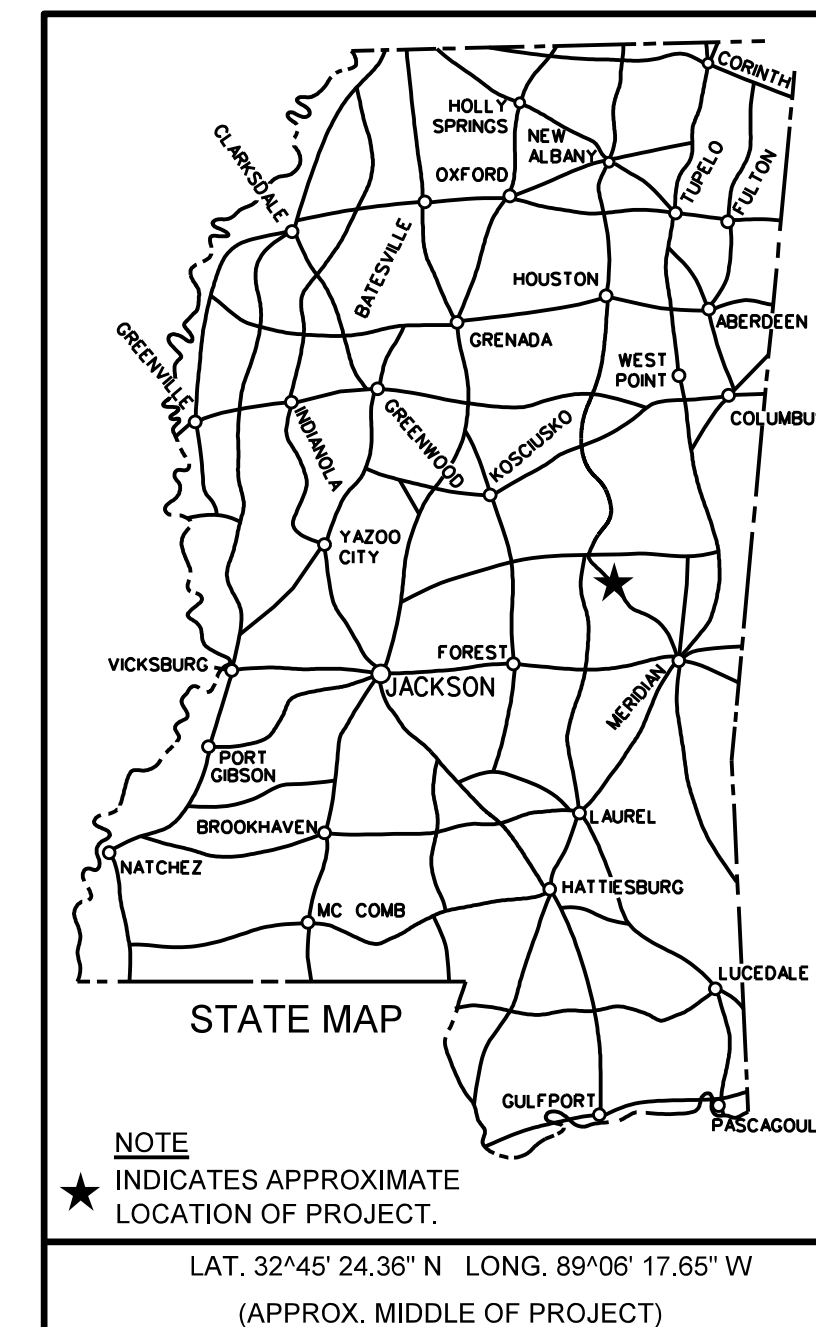

SCALES

PLAN	1 IN. = 20 FT.
PROFILE	HOR. 1 IN. = 20 FT.
	VERT. 1 IN. = 5 FT.
LAYOUT	1 IN. = 5000 FT.

DESIGN CONTROL

45 MPH = V (SPEED DESIGN)

ADT (2018) = 9100 : ADT(2038) = 12000

DHV = 1200 : D = 55% T = 9%

PERMITS ACQUIRED BY MDOT

WETLANDS AND WATERS PERMITS		
	WATERS	WETLANDS
NATIONWIDE #14	<input type="checkbox"/>	<input type="checkbox"/>
NATIONWIDE (OTHER)*	<input checked="" type="checkbox"/>	<input type="checkbox"/>
GENERAL*	<input type="checkbox"/>	<input type="checkbox"/>
INDIVIDUAL (404)*	<input type="checkbox"/>	<input type="checkbox"/>
STORMWATER PERMIT <input checked="" type="checkbox"/>		
Y	REQUIRED, SCNOI TO BE SUBMITTED BY MDOT (DISTURBED AREAS ACRES)	
S	REQUIRED, SCNOI TO BE SUBMITTED BY CONTRACTOR (1 TO 4.99 ACRES)	
N	NO STORMWATER PERMIT REQUIRED (<1 ACRE)	
APPROVED BY: _____		

EQUATIONS

NONE

EXCEPTIONS

NONE

LENGTH DATA

LENGTH OF ROADWAY	520.5	FT.	0.10	MI.
LENGTH OF BRIDGES	29.5	FT.	0.01	MI.
LENGTH OF PROJECT (NET)			0.11	MI.
LENGTH OF EXCEPTIONS		FT.		MI.
LENGTH OF PROJECT (GROSS)			0.11	MI.

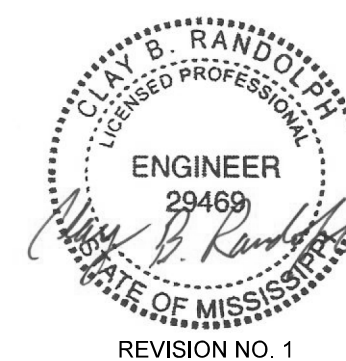

REVISION NO. 1  
12/16/2020

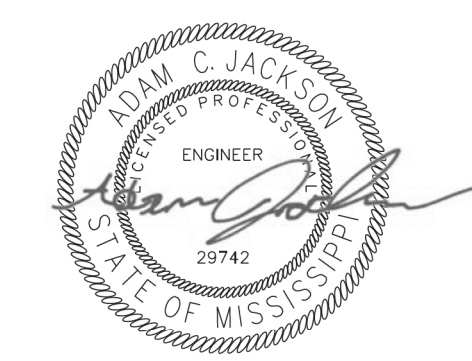

11/14/2019

P S & E DATE:

APPROVED:	_____
DEPUTY EXECUTIVE DIRECTOR / CHIEF ENGINEER	_____
EXECUTIVE DIRECTOR	_____

MDOT  
MISSISSIPPI DEPARTMENT OF TRANSPORTATION

STATE	PROJECT NO.
MISS.	BR-0026-01(079)

DESCRIPTION OF SHEET

WKG. SH.  
NO. NO.

DESCRIPTION OF SHEET

WKG. SH.  
NO. NO.

TITLE SHEET (1)

1

STANDARD DRAWINGS (33)

DETAILED INDEX & GENERAL NOTES (3)

DETAILED INDEX  
GENERAL NOTES  
GENERAL NOTES

DI-1 2  
GN-1 3  
GN-2 4

PAVEMENT MARKING DETAIL FOR 2-LANE AND 4-LANE DIVIDED ROADWAYS  
PAVEMENT MARKING DETAIL FOR 3-LANE, 4-LANE, AND 5-LANE UNDIVIDED ROADWAYS  
2-WAY RAISED PAVEMENT MARKERS AT INTERSECTING ROADS (2-LANE)

PM-1 6051  
PM-2 6052  
PM-11 6061

TYPICAL SECTION SHEETS (2)

TYPICAL SECTION - NEW CONSTRUCTION/WIDENING & OVERLAY  
TYPICAL SECTION - NEW CONSTRUCTION OVER BOX

TS-1 5  
TS-2 6

TYPICAL TEMPORARY EROSION CONTROL/SEDIMENT CONTROL APPLICATIONS  
DETAILS OF SEDIMENT BARRIER APPLICATIONS  
DETAILS OF SILT FENCE INSTALLATION  
DITCH CHECK STRUCTURES, TYPICAL APPLICATIONS AND DETAILS  
TEMPORARY EROSION, SEDIMENT, AND WATER POLLUTION CONTROL MEASURES

ECD-1 6101  
ECD-2 6102  
ECD-3 6103  
ECD-4 6104  
ECD-5 6105

QUANTITY SHEETS (9)

SUMMARY OF QUANTITIES  
SUMMARY OF QUANTITIES  
ESTIMATED QUANTITIES - SUMMARY OF REMOVAL ITEMS  
ESTIMATED QUANTITIES - SUMMARY OF DRAINAGE STRUCTURES REQUIRED  
ESTIMATED QUANTITIES - SUMMARY OF TRAFFIC CONTROL ITEMS & PERMANENT PAVEMENT MARKINGS  
ESTIMATED QUANTITIES - EARTHWORK  
ESTIMATED QUANTITIES - DRIVEWAYS AND RAMPS  
ESTIMATED QUANTITIES - STANDARD ROADSIDE SIGN ASSEMBLIES REQUIRED  
ESTIMATED QUANTITIES - TRAFFIC CONTROL ITEMS

SQ-1 7  
SQ-2 8  
EQ-1 9  
EQ-3 10  
EQ-4 11  
EQ-5 12  
EQ-6 13  
EQ-8 14  
TCP-Q 15

DETAILS OF EROSION CONTROL WATTLE DITCH CHECK  
DETAILS OF EROSION CONTROL SILT DIKE DITCH CHECK  
ROCK DITCH CHECK  
ROCK FILTER DAM  
ROCK DITCH CHECK WITH SUMP EXCAVATION AND ROCK FILTER DAM  
TYPICAL APPLICATIONS AND DETAILS FOR INLET CONSTRUCTION  
INLET PROTECTION DETAILS FOR SEDIMENT CONTROL STONE ON GRADES AND SAGS  
INLET PROTECTION DETAILS OF WATTLES  
INLET PROTECTION DETAILS OF MANUFACTURED INLET PROTECTION DEVICE  
INLET PROTECTION DETAILS OF SANDBAGS  
STABILIZED CONSTRUCTION ENTRANCE  
TEMPORARY STREAM DIVERSION  
TEMPORARY STREAM DIVERSION (BOX EXTENSION)  
FLOATING TURBIDITY CURTAIN  
DETAILS OF EROSION CONTROL SANDBAG DITCH CHECK  
SEDIMENT RETENTION BARRIER

ECD-6 6106  
ECD-7 6107  
ECD-8 6108  
ECD-9 6109  
ECD-10 6110  
ECD-11 6111  
ECD-12 6112  
ECD-13 6113  
ECD-14 6114  
ECD-15 6115  
ECD-16 6116  
ECD-18 6118  
ECD-19 6119  
ECD-20 6120  
ECD-21 6121  
ECD-22 6122

PLAN & PROFILE SHEETS (1)

PLAN - PROFILE SHEET

3 16

TRAFFIC CONTROL PLAN WITH FLAGGER (ONE LANE CLOSURE OF TWO WAY TRAFFIC)  
HIGHWAY SIGN AND BARRICADE DETAILS FOR CONSTRUCTION PROJECTS  
TRAFFIC CONTROL PLANS UNEVEN PAVEMENT DETAILS

TCP-1 6351  
TCP-8 6358  
TCP-12 6362

SPECIAL DESIGN SHEETS (14)

EROSION CONTROL SHEET  
TRAFFIC CONTROL PLAN - ROUTE OVERVIEW  
TRAFFIC CONTROL PLAN - S.R. 19 PROJECT SITE  
TRAFFIC CONTROL PLAN - S.R. 19 AT 491 & 4304/4306  
TRAFFIC CONTROL PLAN - S.R. 19 NORTH/SOUTH AT 492  
TRAFFIC CONTROL PLAN - 492 EAST/WEST AT 505/507 & 15  
TRAFFIC CONTROL PLAN - 15 NORTH/SOUTH AT 248 & 21/16  
TRAFFIC CONTROL PLAN - S.R. 19 NORTH/SOUTH DOWNTOWN PHILADELPHIA  
TRAFFIC CONTROL PLAN - S.R. 19 NORTH/SOUTH AT 608  
TRAFFIC CONTROL PLAN - ROAD CLOSURE DETOUR PLAN INTERSECTING STREETS  
PAVEMENT MARKING DETAIL

ECP-3 17  
TC-1 18  
TC-2 19  
TC-3 20  
TC-4 21  
TC-5 22  
TC-6 23  
TC-7 24  
TC-8 25  
TC-9 26  
PMD-1 27

DRIVEWAYS, CURB & GUTTER, & SIDEWALK  
MISCELLANEOUS DETAIL SHEET FOR STACKED PIPE JOINTS AND EXCAVATION AT GRADE POINTS  
PIPE CULVERT INSTALLATION  
BRANCH CONNECTIONS  
TYPE I MEDIAN INLET (24" PIPE AND UNDER)  
STORM SEWER INLET TYPE SS-2

SD-1 6419  
MDS-1 6425  
PI-1 6051  
BC-1 6507  
MI-1 6508  
SS-2 6524

VEGETATION SCHEDULE

VS-1 28

TOTAL SHEETS (NOT INCLUDING BRIDGE SHEETS) = (68)

RIGHT-OF-WAY MARKER  
RIGHT-OF-WAY MARKER COORDINATES

RW-1 29  
RWC-1 30

PERMANENT SIGNING PLANS (2)

PERMANENT SIGNING PLAN  
SIGNING REMOVAL PLAN

PSP-1 1001  
SRP-1 1002

PS & E PLANS - DATE (11/13/2019)		
REVISIONS		
DATE	SHEET NO.	BY
12/16/20	1	AH

MISSISSIPPI DEPARTMENT OF TRANSPORTATION	
DETAIL INDEX	
PROJECT NO: BR-0026-01(079) COUNTY : NESHOPA	
WORKING NUMBER DI-1	SHEET NUMBER 2
FILENAME: 02_D1.DGN	DESIGN TEAM: BKI CHECKED: DATE:

001: 02 AMPH.DGN FILENAME: ROADWAY PLAN DIVISION MISSISSIPPI DEPARTMENT OF TRANSPORTATION

STATE	PROJECT NO.
MISS.	BR-0026-01(079)

**GENERAL NOTES**

- (1) THE LOCATION AND SPACING OF SIGNS, SHOWN ON THE TRAFFIC CONTROL PLANS, ARE APPROXIMATE AND MAY BE ADJUSTED AS NECESSARY TO FIT FIELD CONDITIONS.
- (2) ALL TRAFFIC CONTROL DEVICES ON THIS PROJECT SHALL COMPLY WITH PART VI OF THE **MUTCD** (LATEST EDITION).
- (3) ALL PLASTIC DRUMS SHALL HAVE A BALLASTING COLLAR MADE FROM RECYCLED TRUCK TIRES OR OTHER SUITABLE MATERIAL.
- (4) 35% SHRINKAGE FACTOR USED IN THE EARTHWORK CALCULATIONS IS FOR DESIGN ESTIMATING PURPOSES ONLY.
- (5) THE CONTRACTOR SHALL BE RESPONSIBLE FOR PROTECTING EXISTING STRUCTURES SUCH AS, BUT NOT LIMITED TO, PIPES, INLETS, APRONS, AND BRIDGES FROM DAMAGE WHICH MIGHT OCCUR DURING CONSTRUCTION. THE CONTRACTOR SHALL REPLACE OR REPAIR, AS DIRECTED BY THE ENGINEER, ANY STRUCTURES DAMAGED DURING THE LIFE OF THE CONTRACT. NO PAYMENT WILL BE MADE FOR REPLACEMENT OR REPAIR OF DAMAGED ITEMS.
- (6) ALL PIPE JOINTS ARE TO BE WRAPPED IN 24-INCH WIDE TYPE V GEOTEXTILE FABRIC. ALL PICKUP HOLES SHALL BE PLUGGED AND COVERED WITH TYPE V GEOTEXTILE FABRIC, THE COST OF WHICH SHALL BE ABSORBED IN OTHER ITEMS BID.
- (7) VOIDS CREATED BY THE REMOVAL OF, BUT NOT LIMITED TO, POSTS, CONCRETE ANCHORS, AND FOOTINGS SHALL BE BACKFILLED AND TAMPED IN ACCORDANCE WITH SECTION 203 OF **THE MISSISSIPPI STANDARD SPECIFICATIONS FOR ROAD AND BRIDGE CONSTRUCTION**, THE COST OF WHICH WILL BE ABSORBED IN OTHER ITEMS BID.
- (8) UTILITIES ON THE DRAWINGS ARE SHOWN IN THEIR ORIGINAL LOCATION BASED UPON THE BEST INFORMATION AVAILABLE TO THE ENGINEER. UTILITIES THAT WERE FOUND TO BE IN CONFLICT WITH CONSTRUCTION HAVE BEEN RELOCATED. PERMITS ARE ON FILE WITH THE DEPARTMENT SHOWING THE APPROXIMATE LOCATION OF UTILITIES RELOCATED WITHIN THE RIGHT-OF-WAY. THE ENGINEER CAN NOT AND DOES NOT WARRANT THAT THIS INFORMATION IS COMPLETE OR ACCURATE. THE CONTRACTOR MUST COORDINATE DIRECTLY WITH THE INVOLVED UTILITY OWNERS TO HAVE UNDERGROUND UTILITY LINES FIELD LOCATED IN ADVANCE OF CONSTRUCTION.
- (9) WORK ON STRUCTURES FOR THIS PROJECT REQUIRES EXCAVATION IN THE IMMEDIATE VICINITY OF TRAFFIC AND ADJACENT PROPERTIES. THEREFORE, THE RISK OF A FAILURE OCCURRING DURING EXCAVATION REQUIRES THAT EXTREME CAUTION BE EXERCISED. THE CONTRACTOR SHALL BE RESPONSIBLE FOR PLACING WHAT BRACING, SHORING, OR GROUND SUPPORT SYSTEM THAT IS DEEMED NECESSARY TO PREVENT A FAILURE AND PROTECT THE PERSONS WORKING NEAR THE EXCAVATION, THE PUBLIC THAT MAY BE ABOVE THE EXCAVATION, OR ANY STRUCTURES ADJACENT TO THE EXCAVATION. ALL COSTS FOR DESIGNING, DRAWING, AND CONSTRUCTING THE FACILITY SHALL BE INCLUDED IN THE PRICE BID FOR CONTRACT ITEMS.
- (10) WIRE FENCE BACKING WILL BE REQUIRED FOR ALL SILT FENCE. (SEE WK. NO. ECD-3)
- (11) FULL COLLARS ARE TO BE USED AT ALL BOX CULVERT EXTENSIONS AND AT ALL BOX CULVERT CONSTRUCTION JOINTS. (SEE WK. NO. ICJ-1 FOR DETAILS)
- (12) FOR LIST OF PUBLIC UTILITIES, SEE WORKING NO. 3.
- (13) FLUORESCENT ORANGE SHEETING SHALL BE USED ON ALL CONSTRUCTION AND TRAFFIC CONTROL SIGNS EXCEPT FOR THOSE DESIGNATED ON THE PLANS TO BE BLACK LEGEND AND BORDER ON WHITE BACKGROUND.
- (14) THE CONTRACTOR SHALL COORDINATE WITH THE CONTRACTOR FROM ADJACENT PROJECT(S) IN IMPLEMENTING THE TRAFFIC CONTROL PLAN AS DIRECTED BY THE ENGINEER. ALL CONFLICTING SIGNS SHALL BE COVERED OR REMOVED AS DIRECTED BY THE ENGINEER.
- (15) THE CONTRACTOR SHALL COVER OR REMOVE ANY TEMPORARY TRAFFIC CONTROL SIGNS SHOWN IN THE TRAFFIC CONTROL PLAN THAT NOT APPLY TO THE CURRENT PHASE.
- (16) ROADWAY SIGNS THAT ARE IN CONFLICT WITH CONSTRUCTION OF THIS PROJECT SHALL BE REMOVED AND RELOCATED BY THE CONTRACTOR AS DIRECTED BY THE ENGINEER, THE COST OF WHICH SHALL BE ABSORBED IN OTHER ITEMS BID.

- (17) REMOVAL OF RAISED PAVEMENT MARKERS THAT ARE IN CONFLICT WITH REQUIRED CONSTRUCTION IS NOT CONSIDERED A SEPARATE PAY ITEM. COST TO BE ABSORBED IN OTHER ITEMS BID.
- (18) REMOVAL OF OBJECT MARKERS IS NOT CONSIDERED A SEPARATE PAY ITEM, AND SHALL BE ABSORBED IN OTHER ITEMS BID.
- (19) WHERE MILLING IS REQUIRED, THE CONTRACTOR SHALL PROVIDE OUTLETS IN THE EXISTING SHOULDERS AT SUFFICIENT INTERVALS TO PREVENT POOLING OR STANDING WATER ON THE MILLED SURFACE, THE COST OF WHICH SHALL BE ABSORBED IN OTHER ITEMS BID.
- (20) THE EROSION CONTROL DEVICES REFERENCED IN THESE PLANS ARE A MINIMUM REQUIREMENT. IT IS THE RESPONSIBILITY OF THE CONTRACTOR TO ENSURE THAT SILT DOES NOT LEAVE THE RIGHT OF WAY OR CONTAMINATE WATERS OF THE U. S. DURING CONSTRUCTION. THE CONTRACTOR SHALL SUBMIT AN EROSION CONTROL PLAN PRIOR TO COMMENCEMENT OF WORK AND MAINTAIN THE PLAN DURING CONSTRUCTION. ANY ADDITIONAL SILT BASINS NOT SHOWN IN THE PLANS SHALL BE INCLUDED IN THE CONTRACTOR'S EROSION CONTROL PLAN PRIOR TO SUBMITTING FOR APPROVAL.
- (21) PRIOR TO EARTHWORK OPERATIONS, THE EXISTING TOP 4" TOPSOIL IS TO BE STRIPPED AND STOCKPILED. AFTER THE GRADING OPERATIONS ARE COMPLETED, SAID TOPSOIL SHALL BE PLACED ON ALL AREAS THAT ARE NOT TO BE PAVED OR OTHERWISE PROTECTED, IN ACCORDANCE WITH SECTION 211 OF THE SPECIFICATIONS, OR THE VEGETATION SCHEDULE (SEE WK. SH. VS-1). EXISTING TOPSOIL AND ALL COSTS ASSOCIATED WITH STRIPPING, HAULING, STOCKPILING, AND PLACEMENT OF THE EXISTING TOPSOIL IS TO BE ABSORBED IN OTHER EARTHWORK ITEMS.
- (22) THE CONTRACTOR IS RESPONSIBLE FOR FIELD-VERIFICATION OF EXISTING GRADES AND MAKING ADJUSTMENTS AS NECESSARY WITH THE APPROVAL OF THE PROJECT ENGINEER.
- (23) TEMPORARY STRIPING SHALL CONFORM TO FINISHED STRIPE SPECIFICATIONS FOR ALIGNMENT, NEATNESS, AND STRAIGHTNESS.
- (24) IF COLORS ARE USED ON PLAN/PROFILE SHEETS, THEY ARE INTENDED TO VISUALLY EASE THE LOCATION OF ELEMENTS FOR USERS OF THESE DRAWINGS. ALTHOUGH THE INTENT IS TO CATEGORIZE EVERYTHING AS EITHER EXISTING OR PROPOSED, IT IS THE END USER'S RESPONSIBILITY TO ENSURE ALL ELEMENTS ARE INTERPRETED CORRECTLY, REGARDLESS OF COLOR.
- (25) ALL ADDENDA TO THESE PLANS WILL BE POSTED TO [WWW.MDOT.MS.GOV](http://WWW.MDOT.MS.GOV) UNDER THE PROPOSAL ADDENDA COLUMN. BIDDERS ARE ADVISED THAT HARD COPIES OF ANY ADDENDA FOR THIS PROJECT WILL NOT BE MAILED. IT IS THE BIDDER'S RESPONSIBILITY TO CHECK AND SEE IF ANY ADDENDA HAVE BEEN POSTED FOR THIS PROJECT.
- (26) THE COST FOR REMOVAL OF ALL HEADWALLS AND WINGWALLS (PIPES, BOX CULVERTS, BOX BRIDGES) SHALL BE ABSORBED IN OTHER ITEMS BID.
- (27) STORAGE OF FLAMMABLE MATERIALS WILL NOT BE ALLOWED UNDER ANY BRIDGE STRUCTURES.
- (28) INSTALLATION DATES SHALL BE CLEARLY WRITTEN IN BOLD BLACK MARKINGS ON THE BACK BOTTOM HALF OF ALL SIGNS WITH A PERMANENT MARKING STICK THAT IS WATERPROOF, FADE RESISTANT AND MARKS ON WET OR DRY SURFACES.
- (29) ALL POST, PIPE, AND I-BEAM LENGTHS IN THESE PLANS ARE ESTIMATES. POST LENGTHS FOR ALL SIGNS SHALL BE VERIFIED IN THE FIELD BY THE CONTRACTOR PRIOR TO FABRICATION.

11/14/2019 5:45 PM 03\_GN.DGN

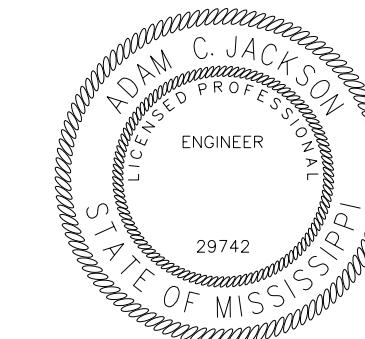

MISSISSIPPI DEPARTMENT OF TRANSPORTATION	
<b>GENERAL NOTES</b>	
PROJECT NO. <b>BR-0026-01(079)</b> COUNTY : <b>NESHOBA</b>	
WORKING NUMBER GN-1	SHEET NUMBER 3
FILENAME: 03_GN.DGN	DESIGN TEAM BKI CHECKED DATE

STATE	PROJECT NO.
MISS.	BR-0026-01(079)

**GENERAL NOTES (CONT.)**

- (30) ALL EXISTING SIGNS WHICH ARE TO BE REMOVED AS A PART OF THIS PROJECT THAT ARE NOT IN CONFLICT WITH CONSTRUCTION SHALL REMAIN IN PLACE UNTIL NEW SIGNS ARE INSTALLED UNLESS NOTED OR DIRECTED OTHERWISE BY THE PROJECT ENGINEER. ROADWAY SIGNS THAT ARE IN CONFLICT WITH CONSTRUCTION SHALL BE REMOVED AND RELOCATED BY THE CONTRACTOR AS DIRECTED BY THE ENGINEER, THE COST OF WHICH SHALL BE ABSORBED IN OTHER ITEMS BID.
  
- (31) DIRECT-APPLIED LEGEND, BORDER, AND/OR SHIELDS ARE TO BE USED ON ALL GUIDE SIGNS. DIGITALLY PRODUCED SIGN COPY, SHIELDS, LEGEND, SYMBOLS, OR IMAGES WILL NOT BE ALLOWED WITHOUT WRITTEN APPROVAL FROM MDOT'S PROJECT ENGINEER.
  
- (32) AFTER THE PERMANENT SIGNS HAVE BEEN INSTALLED, THE CONTRACTOR SHALL SUBMIT TO THE PROJECT ENGINEER A DIGITAL COPY OF A MICROSOFT EXCEL SPREADSHEET WITH THE FOLLOWING INVENTORY DATA CAPTURED FOR EACH SIGN: LOCATION OF SIGN (LATITUDE-LONGITUDE GPS COORDINATES), **MUTCD** SIGN CODE, SIZE, BACKGROUND AND LEGEND COLORS, SUPPORT TYPE (POST, PIPE, SQUARE POST, OR I-BEAM), NUMBER OF SUPPORTS, DATE OF INSTALLATION, SIGN FACE DIRECTION, ROUTE NAME OR NUMBER, DIRECTION OF VEHICLE TRAVEL, AND LEGEND ON SIGN IF APPLICABLE. EACH SIGN SHALL BE ASSIGNED A UNIQUE ID NUMBER AND A DIGITAL PHOTO OF EACH SIGN SHALL BE SUBMITTED IN BITMAP FORMAT. THE PHOTO FILENAME SHALL CORRESPOND WITH THE UNIQUE ID NUMBER.
  
- (33) IT IS THE RESPONSIBILITY OF THE CONTRACTOR TO CONDUCT OPERATIONS IN A MANNER NOT TO DISTURB THE EXISTING MONITORING WELL.

11/14/2019 5:46 PM 03\_GN.DGN PLAN DIVISION MISSISSIPPI DEPARTMENT OF TRANSPORTATION

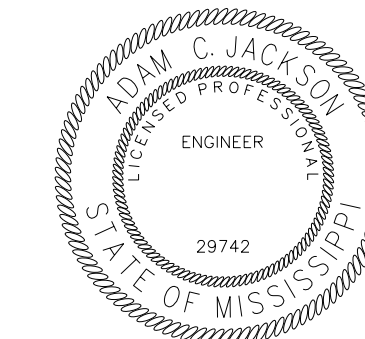

MISSISSIPPI DEPARTMENT OF TRANSPORTATION	
<b>GENERAL NOTES</b>	
PROJECT NO. BR-0026-01(079) COUNTY : NESHOPA	
WORKING NUMBER GN-2	SHEET NUMBER 4
FILENAME: 03_GN.DGN	DATE
DESIGN TEAM	BKI CHECKED DATE