

STATE	PROJECT NUMBER	SHEET NO.
MISSISSIPPI	NH-0022-04(065)	1

GENERAL INDEX

INCLUDED THIS PROJECT	BEGIN WITH SHEET
<input type="checkbox"/> ROADWAY	1
<input type="checkbox"/> PERMANENT SIGNS	1001
<input type="checkbox"/> TRAFFIC SIGNALS	2001
<input type="checkbox"/> ITS COMPONENTS	3001
<input type="checkbox"/> LIGHTING	4001
<input type="checkbox"/> (RESERVED)	5001
<input type="checkbox"/> ROADWAY STANDARD DWGS	6001
<input type="checkbox"/> BOX CULVERT STD. DRAWINGS (LRFD)	7001
<input type="checkbox"/> BOX CULVERT STD. DRAWINGS (STD. SPEC.)	7501
<input type="checkbox"/> BRIDGE	8001
<input type="checkbox"/> CROSS SECTIONS	9001

BRIDGE STRUCTURES REQ'D.

BOX BRIDGES REQ'D.

STATE OF MISSISSIPPI

MISSISSIPPI DEPARTMENT OF TRANSPORTATION

PLAN AND PROFILE OF PROPOSED STATE HIGHWAY FEDERAL AID PROJECT NO. NH-0022-04(065)

SR 15 FM PONTOTOC CL TO N OF CENTRAL AVE

FMS CON. NO. 108147 / 301000

SCALES

PLAN	1 IN. = 100 FT.
PROFILE	HOR. 1 IN. = 100 FT.
	VERT. 1 IN. = 10 FT.
LAYOUT	1 IN. = FT.

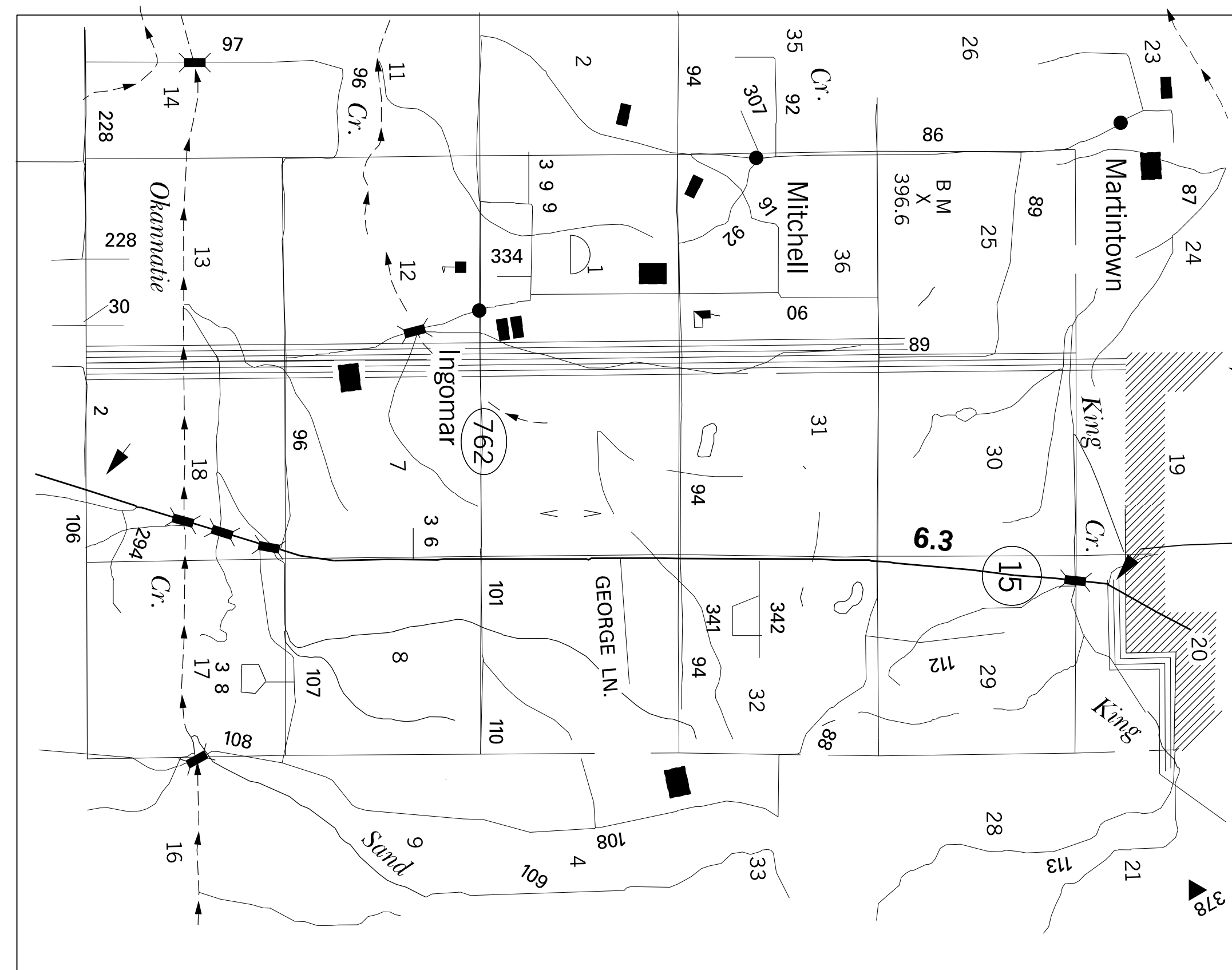
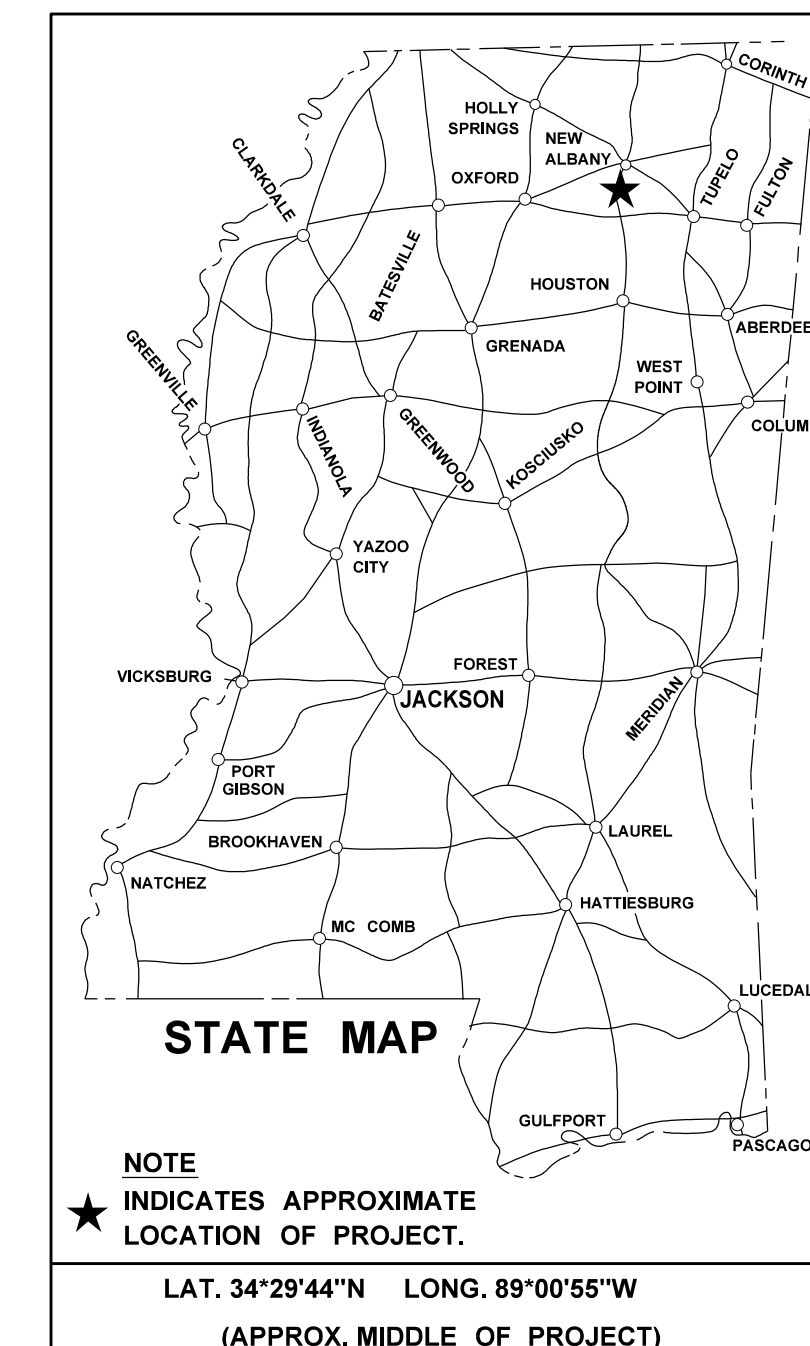

EQUATIONS

EXCEPTIONS

LENGTH DATA

LENGTH OF ROADWAY	27,952	FT.	5.294	MI.
LENGTH OF BRIDGES	617	FT.	0.117	MI.
LENGTH OF PROJECT (NET)			5.294	MI.
LENGTH OF EXCEPTIONS	0	FT.	0	MI.
LENGTH OF PROJECT (GROSS)			5.294	MI.

CONVENTIONAL SYMBOLS

COUNTY LINE	-----
TOWN CORPORATION LINE	-----
SECTION LINE	-----
EXISTING ROAD OR TRAVELED WAY	-----
PROPOSED ROAD OR TRAVELED WAY	-----
RAILROAD	-----
SURVEY LINE	-----
BRIDGES	-----

DESIGN CONTROL

MPH = V (SPEED DESIGN)
ADT () = : ADT () =
DHV = : D = % T = %

PERMITS ACQUIRED BY MDOT

WETLANDS AND WATERS PERMITS		
	WATERS	WETLANDS
NATIONWIDE #14	<input checked="" type="checkbox"/> N	<input checked="" type="checkbox"/> N
NATIONWIDE (OTHER)*	<input checked="" type="checkbox"/> N	<input checked="" type="checkbox"/> N
GENERAL*	<input checked="" type="checkbox"/> N	<input checked="" type="checkbox"/> N
INDIVIDUAL (404)*	<input checked="" type="checkbox"/> N	<input checked="" type="checkbox"/> N
STORMWATER PERMIT <input checked="" type="checkbox"/> N		
Y	REQUIRED, CNOI SUBMITTED BY MDOT (DISTURBED AREA = 5 ACRES)	
S	REQUIRED, SCNOI TO BE SUBMITTED BY CONTRACTOR (1 TO 4.99 ACRES)	
N	NO STORMWATER PERMIT REQUIRED (<1 ACRE)	
APPROVED BY: _____		

P S & E DATE: 7/01/19

APPROVED: _____
 DEPUTY EXECUTIVE DIRECTOR / CHIEF ENGINEER

 EXECUTIVE DIRECTOR



11/17/2020 11:53 AM SRV-TITLE-1

