

## SECTION 905 -- PROPOSAL (CONTINUED)

I (We) hereby certify by digital signature and electronic submission via Bid Express of the Section 905 proposal below, that all certifications, disclosures and affidavits incorporated herein are deemed to be duly executed in the aggregate, fully enforceable and binding upon delivery of the bid proposal. I (We) further acknowledge that this certification shall not extend to the bid bond or alternate security which must be separately executed for the benefit of the Commission. This signature does not cure deficiencies in any required certifications, disclosures and/or affidavits. I (We) also acknowledge the right of the Commission to require full and final execution on any certification, disclosure or affidavit contained in the proposal at the Commission's election upon award. Failure to so execute at the Commission's request within the time allowed in the Standard Specifications for execution of all contract documents will result in forfeiture of the bid bond or alternate security.

Bidder acknowledges receipt of and has added to and made a part of the proposal and contract documents the following addendum (addenda):

ADDENDUM NO.	<u>1</u>	DATED	<u>1/15/2021</u>	ADDENDUM NO.	<u>4</u>	DATED	<u>1/22/2021</u>
ADDENDUM NO.	<u>2</u>	DATED	<u>1/19/2021</u>	ADDENDUM NO.	<u>5</u>	DATED	<u>2/16/2021</u>
ADDENDUM NO.	<u>3</u>	DATED	<u>1/21/2021</u>	ADDENDUM NO.		DATED	

Number

Description

- 1 Revised/Added Plan Sheet Nos. 1-2, 4-12, 8001-8002, 8004, and 8010-8011; Added Notice To Bidders No. 2968; Revised Table of Contents; Revised Bid Sheets; Revised Progress Schedule; Amendment EBSx Download Required.
- 2 Revised Wage Rates; Added Special Provision 907-845-2; Amendment EBSx Download Required.
- 3 Revised Notice To Bidders 2965; Revised Progress Schedule; Amendment EBSx Download Required.
- 4 Postponed to February 23, 2021 Letting.
- 5 Revised Advertisement; Revised Table of Contents; Revised NTB 2965; Added NTB 2969; SP 907-109-2 Replaces SP 907-109-1; Revised Plan Sheet Nos. 8001-8002 and 8011-8012; Revised Bid Items; Revised Progress Schedule; EBSx Amendment Download Required.

TOTAL ADDENDA: 5

(Must agree with total addenda issued prior to opening of bids)

Respectfully Submitted,

DATE \_\_\_\_\_

Contractor

BY \_\_\_\_\_

Signature

TITLE \_\_\_\_\_

ADDRESS \_\_\_\_\_

CITY, STATE, ZIP \_\_\_\_\_

PHONE \_\_\_\_\_

FAX \_\_\_\_\_

E-MAIL \_\_\_\_\_

(To be filled in if a corporation)

Our corporation is chartered under the Laws of the State of \_\_\_\_\_ and the names, titles and business addresses of the executives are as follows:

President

Address

Secretary

Address

Treasurer

Address

The following is my (our) itemized proposal.

NHPP-0055-04(110) / 108458301

Panola County(ies)

Revised 01/26/2016

**MISSISSIPPI DEPARTMENT OF TRANSPORTATION**  
**TABLE OF CONTENTS**

**PROJECT: NHPP-0055-04(110)/108458301 - Panola**

Section 901 - Advertisement

Section 904 - Notice to Bidders

#1	Governing Specification
#2	Status of ROW, w/ Attachments
#3	Final Cleanup
#9	Federal Bridge Formula
#113	Tack Coat
#296	Reduced Speed Limit Signs
#445	Mississippi Agent or Qualified Nonresident Agent
#480	Bridge Repair Permits (Nationwide Permit No. 3)
#516	Errata and Modifications to the 2017 Standard Specifications
#977	DUNS Requirement For Federal Funded Projects
#1225	Early Notice to Proceed
#1226	Material Storage Under Bridges
#1241	Fuel and Material Adjustments
#1963	Guardrail Pads
#2206	MASH Compliant Devices
#2273	Mississippi Special Fuel Tax Law
#2611	Disadvantaged Business Enterprise In Federal-Aid Highway Construction, w/ Supplement
#2782	DBE Pre-Bid Meeting
#2954	Reflective Sheeting for Signs
#2965	Contract Time
#2966	Specialty Items
#2968	Plan Corrections
#2969	Plan Note Correction
906	Required Federal Contract Provisions -- FHWA 1273, w/Supplements

Section 907 - Special Provisions

907-102-2	Bidding Requirements and Conditions
907-108-4	Subletting of Contract
907-109-2	Measurement and Payment
907-202-3	Removal of Bridge Deck
907-420-4	Undersealing
907-619-5	Traffic Control for Construction Zones
907-701-2	Hydraulic Cement
907-702-4	Bituminous Materials
907-703-1	Gradation
907-705-1	Stone Riprap
907-707-2	Joint Material
907-711-2	Plain Steel Wire
907-713-1	Waterproofing Admixture

**PROJECT: NHPP-0055-04(110)/108458301 - Panola**

907-720-2	Acceptance Procedure for Glass Beads
907-721-2	Materials for Signs
907-804-10	Bridge Deck Overlay
907-823-7	Preformed Joint Seal

Section 905 - Proposal, Proposal Bid Items, Combination Bid Proposal

Certification of Performance - Prior Federal-Aid Contracts

Certification Regarding Non-Collusion, Debarment and Suspension

SAM.GOV Registration and DUNS Number

Section 902 - Contract Form

Section 903 - Contract Bond Forms

Form -- OCR-485

Progress Schedule

(REVISIONS TO THE ABOVE WILL BE INDICATED ON THE SECOND SHEET  
OF SECTION 905 AS ADDENDA)

02/16/2021 04:02 PM

# MISSISSIPPI DEPARTMENT OF TRANSPORTATION

## SECTION 901 - ADVERTISEMENT

Electronic bids will be received by the Mississippi Transportation Commission at 10:00 o'clock A.M., Tuesday, February 23, 2021, from the Bid Express Service and shortly thereafter publicly read on the Sixth Floor for:

Bridge Repair on I-55 over Long Creek (Bridge Nos. 237.7A & 237.7B), known as Federal Aid Project No. NHPP-0055-04(110) / 108458301 in Panola County.

The attention of bidders is directed to the Contract Provisions governing selection and employment of labor. Minimum wage rates have been predetermined by the Secretary of Labor and are subject to Public Law 87-581, Work Hours Act of 1962, as set forth in the Contract Provisions.

The Mississippi Department of Transportation hereby notifies all bidders that it will affirmatively insure that in any contract entered into pursuant to this advertisement, disadvantaged business enterprises will be afforded full opportunity to submit bids in response to this invitation and will not be discriminated against on the grounds of race, color, sex, age, disability, religion or national origin in consideration for an award.

**The award of this contract will be contingent upon the Contractor satisfying the DBE requirements.**

Contractors may request permission to bid online at <http://shopmdot.ms.gov> at no cost. Upon approval, Contractors shall be eligible to submit a bid using Bid Express at <http://bidx.com>. Specimen proposals may be viewed and downloaded online at no cost at <http://mdot.ms.gov> or purchased online at <http://shopmdot.ms.gov> at a cost of Ten Dollars (\$10.00) per proposal plus a small convenience fee. Cash or checks will not be accepted as payment.

Plans must be purchased online at <https://shopmdot.ms.gov>. Costs of plans will be on a per sheet basis plus a small convenience fee. If you have any questions, you can contact the MDOT Plans Print Shop at (601) 359-7460, or e-mail at [plans@mdot.state.ms.us](mailto:plans@mdot.state.ms.us). Plans will be shipped upon receipt of payment. Cash or checks will not be accepted as payment.

Bid bond, signed or countersigned by a Mississippi Agent or Qualified Nonresident Agent, with Power of Attorney attached, a Cashier's check or Certified Check for five (5%) percent of bid, payable to STATE OF MISSISSIPPI, must accompany each proposal.

The attention of bidders is directed to the provisions of Subsection 102.07 pertaining to irregular proposals and rejection of bids.

MELINDA L. MCGRATH  
EXECUTIVE DIRECTOR

## MISSISSIPPI DEPARTMENT OF TRANSPORTATION

SECTION 904 - NOTICE TO BIDDERS NO. 2965

CODE: (SP)

DATE: 02/16/2021

SUBJECT: Contract Time

PROJECT: NHPP-0055-04(110) / 108458301 – Panola County

The completion of work to be performed by the Contractor for this project will not be a specified date but shall be when all allowable working days are assessed, or any extension thereto as provided in Subsection 108.06. It is anticipated that the Notice of Award will be issued no later than **March 9, 2021** and the date for Notice to Proceed / Beginning of Contract Time will be **June 10, 2021**.

Should the Contractor request a Notice to Proceed earlier than **June 10, 2021** and it is agreeable with the Department for an early Notice to Proceed, the requested date will become the new Notice to Proceed date. Regardless of whether or not an early Notice to Proceed is granted, contract time will start at the original Notice to Proceed date.

All requests for an early Notice to Proceed shall be sent to the Project Engineer who will forward it to the Contract Administration Division.

**183** Working Days have been allowed for the completion of work on this project.

# **MISSISSIPPI DEPARTMENT OF TRANSPORTATION**

**SECTION 904 - NOTICE TO BIDDERS NO. 2969**

**CODE: (SP)**

**DATE: 02/16/2020**

**SUBJECT: Plan Note Correction**

**PROJECT: NHPP-0055-04(110) / 108458301 – Panola County**

The Bidder's attention is called to the second sentence in the first paragraph on Sheet 8002, under the section titled "Abrasive Blasting and Painting" of the plans.

"The square footage of 8,000 sq. ft. given for this item is for informational purposes only and is approximate and will not be measured for payment." This is in error. The sentence should read: "The square footage of 25,000 sq. ft. given for this item is for informational purposes only and is approximate and will not be measured for payment."

## MISSISSIPPI DEPARTMENT OF TRANSPORTATION

| SPECIAL PROVISION NO. 907-109-2

CODE: (SP)

| DATE: 01/20/2021

SUBJECT: Measurement and Payment

Section 109, Measurement and Payment, of the 2017 Edition of the Mississippi Standard Specifications for Road and Bridge Construction is hereby amended as follows.

**907-109.01--Measurement of Quantities.** Delete the sixth full paragraph of Subsection 109.01 on page 88, and substitute the following.

If appropriate based on the specific circumstances of the project, the Contractor may request that material specified to be measured by the cubic yard or ton be converted to the other measure. The Contractor must submit this request to the Engineer. The Engineer will provide an approval or denial in writing. The decision is in the sole discretion of the Engineer. If approved, factors for this conversion will be determined by the District Materials Engineer and agreed to by the Contractor. The conversion of the materials along with the conversion factor will be incorporated into the Contract by supplemental agreement. The supplemental agreement must be executed before such method of measurement is used.

**907-109.06--Partial Payment.**

**907-109.06.2--Advancement on Materials.** Delete the next to last paragraph of Subsection 109.06.2 on page 95, and substitute the following.

Materials for which an advanced payment has been allowed must be paid for by the Contractor within 30 days of the estimate on which the advanced payment was first allowed and proof of said payment must be verified by the supplier. If proof of payment is not furnished within the allowable 30 days, the advanced payment will be deducted on subsequent current estimates until such time that proof of payment is furnished.









MISSISSIPPI DEPARTMENT OF TRANSPORTATION  
BRIDGE DIVISION

1. Bridge concrete mat shall be used for erosion and scour prevention for the slopes and locations shown in the plans. Bridge concrete mats shall be one of the following:

2. The mat shall be visually inspected and approved by the Project Engineer prior to use. Once approved by the Engineer, the mat may be incorporated into the work.
3. Bridge concrete mats shall be installed in accordance with the plans and manufacturer's guidelines including any underlayment. The anchor system shall be sufficient to anchor the mat to the ground surface. The installation area shall be graded to a level, smooth surface to avoid water concentration and to create an appropriate base for the concrete mat. Seed and fertilizer shall be placed on the prepared surface prior to the installation of the Bridge Concrete Mat.
4. Bridge Concrete Mat installed directly under the bridge deck shall be open cell filled with crushed limestone for ease during future bridge inspection.
5. A representative from the Bridge Concrete Mat manufacturer shall be present for sufficient time to assure that the contractor is properly schooled in the installation.
6. Bridge Concrete Mat will be paid for at the contract unit price per square yard, which price shall be full compensation for all labor, materials, tools, equipment, underlayment, anchor system, concrete and all incidentals necessary to complete the work. Seed and fertilizer will be measured and paid under their appropriate pay items.
7. All obstructions, vegetation, and irregularities in the embankment shall be graded and restored to the slope grading specified by the original plans, and shall be considered an absorbed item.

Geotextile fabric is required under all riprap. All riprap and geotextile fabric shown on the bridge plans are included in the bridge quantities.



— Bridge concrete mat shall be placed along the full length of the end bent.

1. Remove debris obstruction from channel, specifically steel and concrete debris. The only riprap to be removed is scattered riprap fallen into the channel from north bank failure. This will be considered an absorbed item. Scattered riprap along south bank shall remain in place.
2. Reshape and armor the north bank to a 2:1 slope overlapping the top of bank by 3'-0".
3. Install riprap where top of riprap is flush with natural bed elevation extending 150'-0" upstream from downstream terminus. Survey.
4. Fill scour voids and place riprap around Pier A for both bridges and Pier B for Bridge B. Filled geotextile bags may be used for underwater placement of fill material. Riprap shall be installed flush with adjacent, natural ground elevations.
4. Install a key trench along the upstream and downstream terminus of channel riprap. See KEY TRENCH detail on this sheet.
5. After underscoring voids at end bent caps, install concrete mat as shown on this sheet.

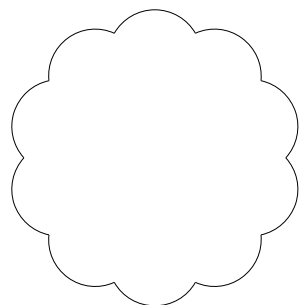

~ Obstruction removal area

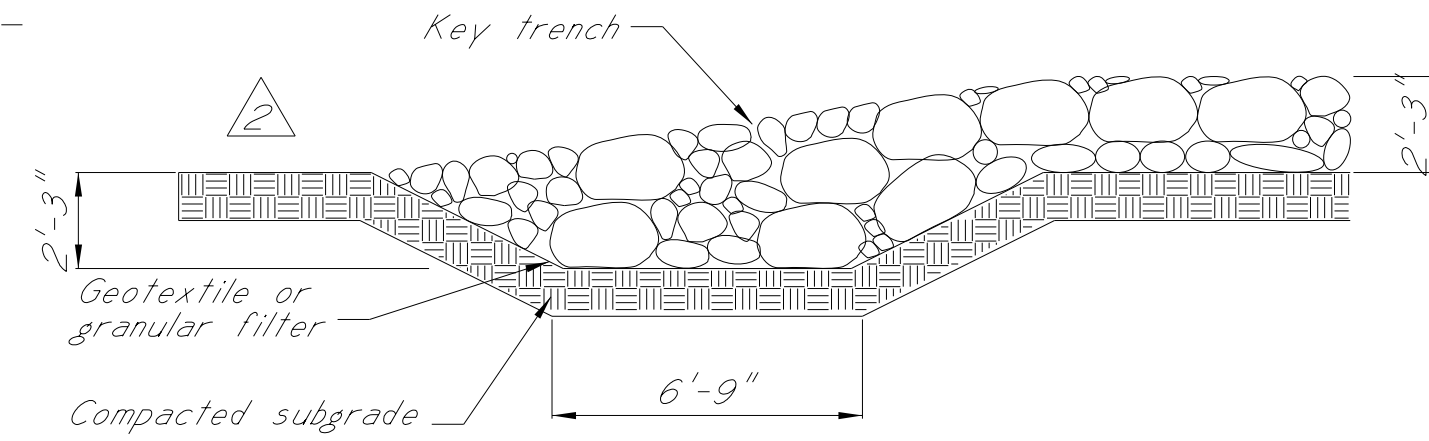

*Revetment riprap showing key trench at upstream and downstream termination*



Showing limits of riprap placement

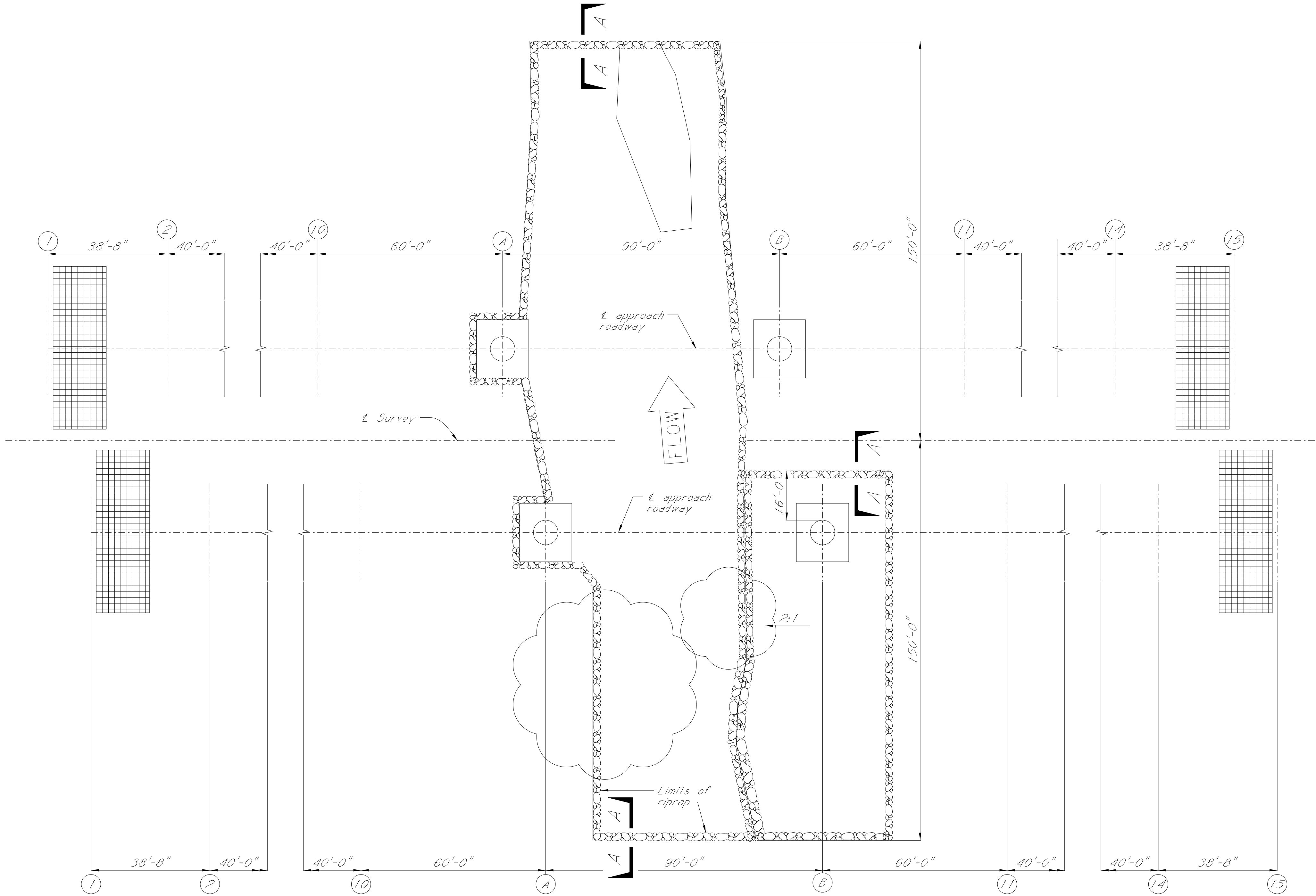

- NOTE:
- No dirt can be pushed into the creek.
  - If a platform for working is needed, then riprap may be used.
  - Minimize disturbance to existing banks.

EROSION CONTROL PLAN  
Showing limits of erosion control measures

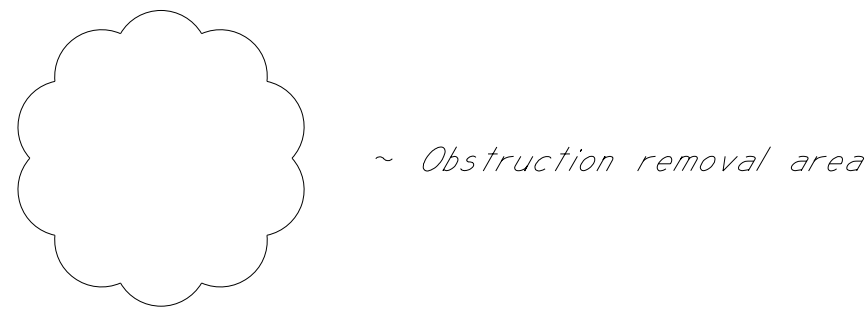

~ Obstruction removal area

2/11/2021	Added riprap				BY	MISSISSIPPI DEPARTMENT OF TRANSPORTATION	
						BRIDGE AT STA. 255+02.00	
						BRIDGE AT STA. 255+16.00	
						BRIDGE EROSION CONTROL	
						FMS: 108458 / 301000	
						COUNTY: PANOLA	
						PROJECT NUMBER: NHPP-0055-04(110)	
						WORKING NUMBER	
						11 OF 11	
						SHEET NUMBER	
						8012	



Bridge Repair on I-55 over Long Creek (Bridge Nos. 237.7A & 237.7B), known as Federal Aid Project No. NHPP-0055-04(110) / 108458301 in Panola County.

Line No.	Item Code	Adj Code	Quantity	Units	Description [Fixed Unit Price]
<b>Roadway Items</b>					
0010	202-B241		1	Mile	Removal of Traffic Stripe
0022	403-D007	(BA1)	103	Ton	9.5-mm, HT, Asphalt Pavement, Polymer Modified
0028	406-D001		623	Square Yard	Fine Milling of Bituminous Pavement, All Depths
0030	407-A001	(A2)	65	Gallon	Asphalt for Tack Coat
0040	501-E001		112	Linear Feet	Expansion Joints, Without Dowels
0050	606-B002		100	Linear Feet	Guard Rail, Class A, Type 1, 'W' Beam
0060	606-D005		2	Each	Guard Rail, Bridge End Section, Type A
0070	606-E005		2	Each	Guard Rail, Terminal End Section, Flared
0090	618-A001		1	Lump Sum	Maintenance of Traffic
0100	619-A1006		1	Mile	Temporary Traffic Stripe, Continuous White, Type 1 Tape
0110	619-A2005		1	Mile	Temporary Traffic Stripe, Continuous Yellow, Type 1 Tape
0120	619-A3007		1	Mile	Temporary Traffic Stripe, Skip White, Type 1 or 2 Tape
0130	619-C6001		20	Each	Red-Clear Reflective High Performance Raised Marker
0138	619-F1001		1,836	Linear Feet	Concrete Median Barrier, Precast
0140	619-F2001		1,836	Linear Feet	Remove and Reset Concrete Median Barrier, Precast
0150	619-F3001		7	Each	Delineators, Guard Rail, White
0160	619-F3002		7	Each	Delineators, Guard Rail, Yellow
0170	620-A001		1	Lump Sum	Mobilization
0180	626-A001		1	Mile	6" Thermoplastic Double Drop Traffic Stripe, Skip White
0190	626-C002		1	Mile	6" Thermoplastic Double Drop Edge Stripe, Continuous White
0200	626-F001		1	Mile	6" Thermoplastic Double Drop Edge Stripe, Continuous Yellow
0220	699-A001		1	Lump Sum	Roadway Construction Stakes
0222	907-619-E3001		3	Each	Changeable Message Sign
<b>Bridge Items</b>					
0228	202-A001		1	Lump Sum	Removal of Obstructions
0230	815-A007	(S)	4,742	Ton	Loose Riprap, Size 300
0240	815-E001	(S)	2,810	Square Yard	Geotextile under Riprap
0250	907-420-A001		1,000	Pounds	Undersealing
0270	907-202-B001		4,368	Square Yard	Removal of Bridge Deck, Hydrodemolition
0280	907-804-O001	(S)	316	Cubic Yard	Bridge Deck Overlay Concrete
0282	907-808-A003	(S)	224	Linear Feet	Joint Repair Without Epoxy
0290	907-823-A001		638	Linear Feet	Preformed Joint Seal, Type I

Line No.	Item Code	Adj Code	Quantity	Units	Description [Fixed Unit Price]
0300	907-823-A002		116	Linear Feet	Preformed Joint Seal, Type II
0310	907-824-PP003		316	Square Feet	Bridge Repair, EPOXY REPAIR, PER PLANS
0320	907-824-PP003		3,180	Square Feet	Bridge Repair, Removal of Bridge Deck Per Plans
0330	907-824-PP006		20	Each	Bridge Repair, BEARING PLATE REPLACEMENT & BEARING RESET, PER PLANS
0340	907-824-PP006		240	Each	Bridge Repair, BEARING REPLACEMENT, PER PLANS
0350	907-824-PP006		4	Each	Bridge Repair, END DIAPHRAGM REPLACEMENT, PER PLANS
0360	907-824-PP006		3	Each	Bridge Repair, INTERMEDIATE DIAPHRAGM REPLACEMENT, PER PLANS
0370	907-824-PP006		8	Each	Bridge Repair, MIDSPAN DIAPHRAGM REPLACEMENT, PER PLANS
0380	907-832-PP003		456	Square Yard	Concrete Mat PER PLANS
0390	907-845-A001	(S)	1	Lump Sum	Coating Existing Structural Steel



[illegible]

NOTE: THE ANTICIPATED WORKING DAYS SHOWN ON THIS SCHEDULE ARE FOR INFORMATIONAL PURPOSES ONLY. THE ACTUAL WORKING DAY TOTAL AS ASSESSED BY THE PROJECT ENGINEER ON FORM CSD-765 SHALL GOVERN.