

GENERAL INDEX

INCLUDED THIS PROJECT	BEGIN WITH SHEET
<input checked="" type="checkbox"/> ROADWAY	1
<input checked="" type="checkbox"/> PERMANENT SIGNS	1001
<input checked="" type="checkbox"/> TRAFFIC SIGNALS	2001
<input type="checkbox"/> ITS COMPONENTS	3001
<input type="checkbox"/> LIGHTING	4001
<input type="checkbox"/> (RESERVED)	5001
<input checked="" type="checkbox"/> ROADWAY STANDARD DWGS	6001
<input type="checkbox"/> BOX CULVERT STD. DRAWINGS (LRFD)	7001
<input type="checkbox"/> BOX CULVERT STD. DRAWINGS (STD. SPEC.)	7501
<input type="checkbox"/> BRIDGE	8001
<input type="checkbox"/> CROSS SECTIONS	9001

BRIDGE STRUCTURES REQ'D.

NONE

BOX BRIDGES REQ'D.

NONE

CONVENTIONAL SYMBOLS

COUNTY LINE	-----
TOWN CORPORATION LINE	-----
SECTION LINE	-----
EXISTING ROAD OR TRAVELED WAY	-----
PROPOSED ROAD OR TRAVELED WAY	-----
RAILROAD	-----
SURVEY LINE	-----
BRIDGES	-----

LENGTH OF ROADWAY	43,075.500 FT.	8.158 MI.
LENGTH OF BRIDGES	90.500 FT.	0.017 MI.
LENGTH OF PROJECT (NET)		8.175 MI.
LENGTH OF EXCEPTIONS	2,400.000 FT.	0.449 MI.
LENGTH OF PROJECT (GROSS)		7.726 MI.

EQUATIONS

STA. 1253 + 89.875 BK	=	1254 + 70.040 AH	(-80.165)
STA. 1356 + 37.843 BK	=	1356 + 28.032 AH	(+9.811)
STA. 1387 + 94.087 BK	=	1388 + 10.280 AH	(-16.193)
TOTAL = -86.547			

LENGTH DATA

STATE OF MISSISSIPPI

MISSISSIPPI DEPARTMENT OF TRANSPORTATION

PLAN AND PROFILE OF PROPOSED
STATE HIGHWAY
FEDERAL AID PROJECT NO. STP-0008-02(116)
HSIP-0008-02(120)

US 49
SEMINARY NORTH TO U.S. 84 BYPASS FMS CON. NO. 107731/301000
COVINGTON COUNTY 107731/301100

SCALES		
PLAN	1 IN. =	100 FT.
PROFILE {	HOR.	1 IN. = 100 FT.
	VERT.	1 IN. = 10 FT.
LAYOUT	1 IN. =	7,992.455 FT.

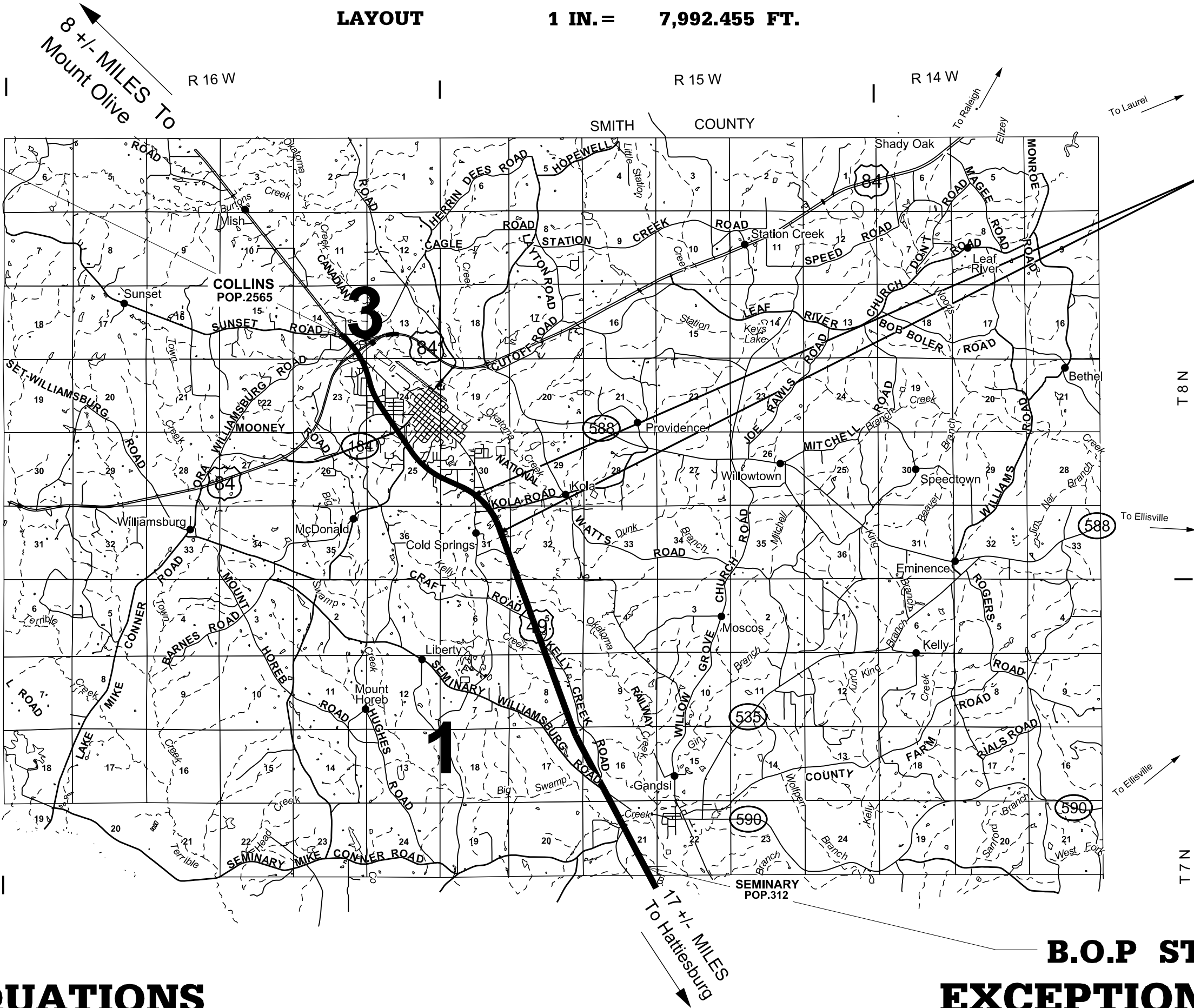

OMITTED SECTION

B.O.P STA. 970 + 00
EXCEPTIONS

1212 + 00 TO 1236 + 00
(OMITTED SECTION)

STATE	PROJECT NUMBER	SHEET NO.
MISSISSIPPI	STP-0008-02(116) HSIP-0008-02(120)	1

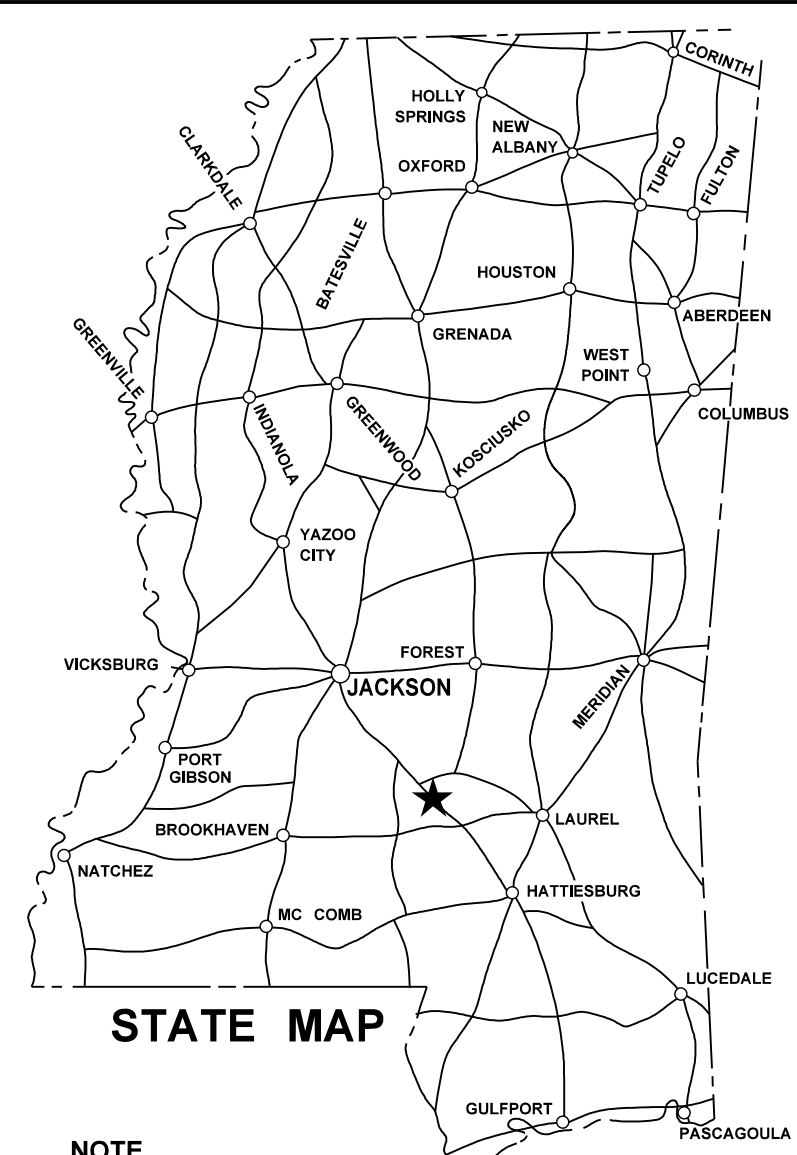

NOTE
★ INDICATES APPROXIMATE
LOCATION OF PROJECT.

LAT. 31°35'28.36" N LONG. 89°31'37.72" W
(APPROX. MIDDLE OF PROJECT)

DESIGN CONTROL		
_____ MPH =	V (SPEED DESIGN)	
ADT (____) = _____;	ADT (____) = _____;	
DHV = _____;	D = _____ %	T = _____ %
PERMITS ACQUIRED BY MDOT		
WETLANDS AND WATERS PERMITS		
NATIONWIDE #14	<input checked="" type="checkbox"/> N	<input checked="" type="checkbox"/> N
NATIONWIDE (OTHER)*	<input checked="" type="checkbox"/> N	<input checked="" type="checkbox"/> N
GENERAL*	<input checked="" type="checkbox"/> N	<input checked="" type="checkbox"/> N
INDIVIDUAL (404)*	<input checked="" type="checkbox"/> N	<input checked="" type="checkbox"/> N
STORMWATER PERMIT		<input checked="" type="checkbox"/> N
Y	REQUIRED, CNOI SUBMITTED BY MDOT (DISTURBED AREA=5 ACRES)	
S	REQUIRED, SCNOI TO BE SUBMITTED BY CONTRACTOR (1 TO 4.99 ACRES)	
N	NO STORMWATER PERMIT REQUIRED (<1 ACRE)	
APPROVED BY: _____		

P S & E DATE: 01/12/21

APPROVED:

DEPUTY EXECUTIVE DIRECTOR / CHIEF ENGINEER

EXECUTIVE DIRECTOR



GENERAL NOTES

- 1

THE LOCATION AND SPACING OF SIGNS, SHOWN ON THE TRAFFIC CONTROL PLANS, ARE APPROXIMATE AND MAY BE ADJUSTED AS NECESSARY TO FIT FIELD CONDITIONS.
- 2

ALL TRAFFIC CONTROL DEVICES ON THIS PROJECT SHALL COMPLY WITH PART VI OF THE MUTCD (LATEST EDITION).
- 3

ALL PLASTIC DRUMS SHALL HAVE A BALLASTING COLLAR MADE FROM RECYCLED TRUCK TIRES OR OTHER SUITABLE MATERIAL.
- 4

THE CONTRACTOR SHALL BE RESPONSIBLE FOR PROTECTING EXISTING STRUCTURES SUCH AS, BUT NOT LIMITED TO, PIPES, INLETS, APRONS, AND BRIDGES FROM DAMAGE WHICH MIGHT OCCUR DURING CONSTRUCTION. THE CONTRACTOR SHALL REPLACE OR REPAIR, AS DIRECTED BY THE ENGINEER, ANY STRUCTURES DAMAGED DURING THE LIFE OF THE CONTRACT. NO PAYMENT WILL BE MADE FOR REPLACEMENT OR REPAIR OF DAMAGED ITEMS.
- 5

FLUORESCENT ORANGE SHEETING SHALL BE USED ON ALL CONSTRUCTION AND TRAFFIC CONTROL SIGNS EXCEPT FOR THOSE DESIGNATED ON THE PLANS TO BE BLACK LEGEND AND BORDER ON WHITE BACKGROUND.
- 6

VEGETATIVE MATERIAL WILL BE REMOVED PRIOR TO PLACEMENT OF CRUSHED STONE. THE COST OF WHICH SHALL BE ABSORBED IN OTHER ITEMS BID.
- 7

THE CONTRACTOR SHALL COVER ANY TEMPORARY TRAFFIC CONTROL SIGNS SHOWN IN THE TRAFFIC CONTROL PLAN THAT DO NOT APPLY TO THE CURRENT PHASE.
- 8

REMOVAL OF RAISED PAVEMENT MARKERS THAT ARE IN CONFLICT WITH REQUIRED CONSTRUCTION IS NOT CONSIDERED A SEPARATE PAY ITEM. COST TO BE ABSORBED IN OTHER ITEMS BID.
- 9

WHERE MILLING IS REQUIRED, THE CONTRACTOR SHALL PROVIDE OUTLETS IN THE EXISTING SHOULDERS AT SUFFICIENT INTERVALS TO PREVENT POOLING OR STANDING WATER ON THE MILLED SURFACE, THE COST OF WHICH SHALL BE ABSORBED IN OTHER ITEMS BID.
- 10

TEMPORARY STRIPING SHALL CONFORM TO FINISHED STRIPE SPECIFICATIONS FOR ALIGNMENT, NEATNESS, AND STRAIGHTNESS.
- 11

ALL ADDENDA TO THESE PLANS WILL BE POSTED TO WWW.MDOT.MS.GOV UNDER THE PROPOSAL ADDENDA COLUMN. BIDDERS ARE ADVISED THAT HARD COPIES OF ANY ADDENDA FOR THIS PROJECT WILL NOT BE MAILED. IT IS THE BIDDER'S RESPONSIBILITY TO CHECK AND SEE IF ANY ADDENDA HAVE BEEN POSTED FOR THIS PROJECT.
- 12

STORAGE OF FLAMMABLE MATERIALS WILL NOT BE ALLOWED UNDER ANY BRIDGE STRUCTURES WITHOUT WRITTEN APPROVAL FROM THE PROJECT ENGINEER. SEE NOTICE TO BIDDERS ENTITLED "MATERIAL STORAGE UNDER BRIDGES" FOR MORE INFORMATION.
- 13

INSTALLATION DATES SHALL BE CLEARLY WRITTEN IN BOLD BLACK MARKINGS ON THE BACK BOTTOM HALF OF ALL SIGNS WITH A PERMANENT MARKING STICK THAT IS WATERPROOF, FADE RESISTANT AND MARKS ON WET OR DRY SURFACES.
- 14

ALL POST, PIPE, AND I-BEAM LENGTHS IN THESE PLANS ARE ESTIMATES. POST LENGTHS FOR ALL SIGNS SHALL BE VERIFIED IN THE FIELD BY THE CONTRACTOR PRIOR TO FABRICATION.
- 15

ALL EXISTING SIGNS WHICH ARE TO BE REMOVED AS A PART OF THIS PROJECT THAT ARE NOT IN CONFLICT WITH CONSTRUCTION SHALL REMAIN IN PLACE UNTIL NEW SIGNS ARE INSTALLED UNLESS NOTED OR DIRECTED OTHERWISE BY THE PROJECT ENGINEER. ROADWAY SIGNS THAT ARE IN CONFLICT WITH CONSTRUCTION SHALL BE REMOVED AND RELOCATED BY THE CONTRACTOR AS DIRECTED BY THE ENGINEER, THE COST OF WHICH SHALL BE ABSORBED IN OTHER ITEMS BID.
- 16

DIRECT-APPLIED LEGEND, BORDER, AND/OR SHIELDS ARE TO BE USED ON ALL GUIDE SIGNS. DIGITALLY PRODUCED SIGN COPY, SHIELDS, LEGEND, SYMBOLS, OR IMAGES WILL NOT BE ALLOWED WITHOUT WRITTEN APPROVAL FROM MDOT'S PROJECT ENGINEER.
- 17

AFTER THE PERMANENT SIGNS HAVE BEEN INSTALLED, THE CONTRACTOR SHALL SUBMIT TO THE PROJECT ENGINEER A DIGITAL COPY OF A MICROSOFT EXCEL SPREADSHEET WITH THE FOLLOWING INVENTORY DATA CAPTURED FOR EACH SIGN: LOCATION OF SIGN (LATITUDE-LONGITUDE GPS COORDINATES), MUTCD SIGN CODE, SIZE, BACKGROUND AND LEGEND COLORS, SUPPORT TYPE (POST, PIPE, SQUARE POST, OR I-BEAM), NUMBER OF SUPPORTS, DATE OF INSTALLATION, SIGN FACE DIRECTION, ROUTE NAME OR NUMBER, DIRECTION OF VEHICLE TRAVEL, AND LEGEND ON SIGN IF APPLICABLE. EACH SIGN SHALL BE ASSIGNED A UNIQUE ID NUMBER AND A DIGITAL PHOTO OF EACH SIGN SHALL BE SUBMITTED IN BITMAP FORMAT. THE PHOTO FILENAME SHALL CORRESPOND WITH THE UNIQUE ID NUMBER.
- 18

ALL PERMANENT SIGNS SHALL CONFORM TO THE LATEST EDITION OF THE MANUAL ON UNIFORM TRAFFIC CONTROL DEVICES.
- 19

ALL SIGN LOCATIONS SHALL BE APPROVED BY THE PROJECT ENGINEER PRIOR TO INSTALLATION.
- 20

THE RETROREFLECTIVE SIGN SHEETING ON PERMANENT GROUND-MOUNTED SIGNS SHALL BE AS FOLLOWS: BROWN BACKGROUND SHEETING ON GUIDE SIGNS SHALL BE MINIMUM TYPE VIII; GREEN AND BLUE BACKGROUND SHEETING ON GUIDE SIGNS SHALL BE MINIMUM TYPE IX; ALL WHITE, YELLOW, FLUORESCENT YELLOW AND FLUORESCENT YELLOW/GREEN SHEETING SHALL BE TYPE XI. ALL SIGN SHEETING ON OVERHEAD SIGNS SHALL BE TYPE XI.
- 21

THE RETROREFLECTIVE SIGN SHEETING ON RIGID, TEMPORARY TRAFFIC CONTROL (ORANGE) SIGNS SHALL BE MINIMUM TYPE IX.
- 22

ALL EXISTING SIGNS AND SUPPORTS REMOVED UNDER THIS PROJECT SHALL BECOME THE PROPERTY OF THE CONTRACTOR AND ARE NOT A SEPARATE PAY ITEM.
- 23

ALL SIDE ROAD, STOP SIGN MOUNTED STREET NAME SIGNS TO BE SALVAGED AND STORED AT THE DIRECTION OF THE PROJECT ENGINEER FOR DELIVERY TO THE CITY (NOT A SEPARATE PAY ITEM).
- 24

ALL SIGNS AND DELINEATORS THAT CONFLICT WITH THE CONSTRUCTION OF THIS PROJECT SHALL BE REMOVED AND RESET BY THE CONTRACTOR; COST TO BE ABSORBED IN OTHER PAY ITEMS.

GENERAL NOTES (CONT.)

- 25

TEMPORARY STRIPING SHALL BE REQUIRED AFTER MILLING AND OVERLAYING OPERATIONS; TEMPORARY STRIPING SHALL BE PLACED IN THE SAME LOCATIONS AND LAYOUT AS PERMANENT STRIPE. ALL CENTERLINE, LANE LINES, EDGE LINES, AND NO-PASSING STRIPES THAT HAVE BEEN REMOVED DURING THE DAY'S OPERATIONS SHALL BE REPLACED WITH TEMPORARY STRIPE BEFORE WORK IS DISCONTINUED FOR THE DAY OR AS SOON THEREAFTER AS WEATHER CONDITIONS WILL PERMIT, EXCEPT THAT:
(1) REPLACEMENT OF NO-PASSING STRIPES MAY BE DELAYED FOR A PERIOD NOT TO EXCEED THREE (3) DAYS FOR A TWO OR THREE LANE ROAD
(2) TEMPORARY EDGE LINES ON PROJECTS REQUIRING SHOULDERS CONSTRUCTED OF GRANULAR MATERIAL MAY BE DELAYED FOR A PERIOD NOT TO EXCEED THREE (3) DAYS.
- 26

ALL ASPHALT AND CONCRETE CURBS ALONG RAMPS, LOCAL ROADS, ETC. FROM B.O.P. TO E.O.P. SHALL BE PAINTED (TWO APPLICATIONS) WITH WHITE TRAFFIC PAINT AND TRAFFIC BEADS ; COST TO BE ABSORBED IN OTHER PAY ITEMS.
- 27

IF THE ASPHALT CURB ALONG THE LOCAL ROAD IS SEVERELY DAMAGED, THE ENTIRE ASPHALT CURB WILL BE REMOVED AS DIRECTED BY THE ENGINEER; COST TO BE ABSORBED IN OTHER PAY ITEMS.
- 28

ALL LOCAL ROADS SHALL BE PAVED TO THE R.O.W. LIMITS OR AS DIRECTED BY THE ENGINEER.
- 29

CRUSHED STONE WILL NOT BE ALLOWED TO BE PLACED DIRECTLY ON THE SURFACE LIFT OF ASPHALT, BUT MUST BE PLACED DIRECTLY ON THE GRAVEL SHOULDER OR A ROAD WIDENER MACHINE USED AND APPROVED BY THE PROJECT ENGINEER.
- 30

ALL RAMPS AND/OR DRIVEWAY PADS SHALL BE PAVED TO THE SHOULDER LINE, MINIMUM OR FURTHER, AS DIRECTED BY THE ENGINEER WITHIN THE R.O.W. LIMITS.
- 31

FOR ASPHALT PAVING, HT, 9.5 MM MIXTURE, POLYMER MODIFIED WILL BE USED FOR THE MAINLINE OVERLAY AND ST, 9.5 MM MIXTURE WILL BE USED FOR SHOULDERS, CROSSTOPS, LOCAL ROADS, AND DRIVEWAY PADS.
- 32

THE SAWCUT JOINTS SHALL BE DIRECTLY OVER THE PCC PAVEMENT JOINT AND SHALL BE ACCURATELY LOCATED BY THE METHOD EMPLOYING PINS AND STRINGLINE. THE PINS SHALL BE ACCURATELY LOCATED PRIOR TO PAVING. DETAILS OF THE CONTRACTOR'S METHOD FOR LOCATING THE SAWCUTS SHALL BE SUBJECT TO THE APPROVAL OF THE ENGINEER. THE ENTIRE SAWING AND SEALING OPERATION SHALL BE COMPLETED WITHIN SEVEN (7) DAYS AFTER THE PLACEMENT OF THE FINAL WEARING COURSE.
- 33

THE PROJECT OPERATIONS SHALL BE COMPLETED IN THE FOLLOWING ORDER:
1. FINE MILLING
2. ASPHALT PAVING
3. TEMPORARY STRIPING
4. CRUSH STONE ON THE SHOULDERS OPERATIONS
5. RUMBLE STRIPS
6. FOG SEAL THE SHOULDERS
7. PERMANENT STRIPING
- 34

ALL PIPE JOINTS ARE TO BE WRAPPED IN 24-INCH WIDE GEOTEXTILE FABRIC. ALL PICKUP HOLES SHALL BE PLUGGED AND COVERED WITH TYPE V GEOTEXTILE FABRIC, THE COST OF WHICH SHALL BE ABSORBED IN OTHER ITEMS BID.
- 35

VOIDS CREATED BY THE REMOVAL OF, BUT NOT LIMITED TO, POSTS, CONCRETE ANCHORS, AND FOOTINGS SHALL BE BACK FILLED AND TAMPED IN ACCORDANCE WITH SECTION 203 OF THE MISSISSIPPI STANDARD SPECIFICATIONS FOR ROAD AND BRIDGE CONSTRUCTION, THE COST SHALL BE ABSORBED IN OTHER ITEMS BID.

				BY	MISSISSIPPI DEPARTMENT OF TRANSPORTATION	
					GENERAL NOTES	
				REVISION	PROJ. NO.: STP-0008-02(116) HSIP-0008-02(120) COUNTY: COVINGTON	
				DATE	FILE NAME: _____ DESIGN TEAM _____ CHECKED _____ DATE _____	
					<div><div><div>MISSISSIPPI DEPARTMENT OF TRANSPORTATION</div><div>WORKING NUMBER GN-1</div><div>SHEET NUMBER 3</div></div></div>	

STATE	PROJECT NO.
MISS.	STP-0008-02(116) HSIP-0008-02(120)

GENERAL NOTES

- 36) WIRE FENCE BACKINGS WILL BE REQUIRED FOR ALL SILT FENCE. (SEE WK. NO. ECD-3)
- 37) FLORESCENT ORANGE SHEETING SHALL BE USED ON ALL CONSTRUCTION AND TRAFFIC CONTROL SIGNS EXCEPT FOR THIS DESIGNATED ON THE PLANS TO BE BLACK LEGEND AND BORDER ON WHITE BACKGROUND.
- 38) VEGETATIVE MATERIAL SHALL BE REMOVED PRIOR TO PLACEMENT OF GRANULAR MATERIAL. COST OF WHICH SHALL BE ABSORBED IN OTHER ITEMS BID.
- 39) THE CONTRACTOR SHALL REPAIR ANY DAMAGE TO THE SURFACE TREATED SHOULDER THAT MIGHT OCCUR DURING CONSTRUCTION. ANY REPAIR TO SHOULDER WILL BE IN ACCORDANCE WITH SECTION 410 OF THE MISSISSIPPI STANDARD SPECIFICATIONS FOR ROAD AND BRIDGE CONSTRUCTION. NO PAYMENT WILL BE MADE FOR REPAIR OF DAMAGED SHOULDER.
- 40) THE EROSION CONTROL DEVICES REFERENCED IN THESE PLANS ARE A MINIMUM REQUIREMENT. IT IS THE RESPONSIBILITY OF THE CONTRACTOR TO ENSURE THAT SILT DOES NOT LEAVE THE RIGHT OF WAY OR CONTAMINATE WATERS OF THE U.S. DURING CONSTRUCTION. THE CONTRACTOR SHALL SUBMIT AN EROSION CONTROL PLAN PRIOR TO COMMENCEMENT OF WORK AND MAINTAIN THE PLAN DURING CONSTRUCTION. ANY ADDITIONAL SILT BASINS NOT SHOWN IN THE PLANS SHALL BE INCLUDED IN THE CONTRACTOR'S EROSION CONTROL PLAN PRIOR TO SUBMITTING FOR APPROVAL.
- 41) THE CONTRACTOR IS RESPONSIBLE FOR FIELD -VERIFICATION OF EXISTING GRADES AND MAKING ADJUSTMENTS AS NECESSARY WITH THE APPROVAL OF THE PROJECT ENGINEER.
- 42) CURB AND GUTTER VERTICAL DIMENSIONS SHOWN IN THE DETAIL DRAWINGS ARE FOR A CURB IN THE "CATCH" CONFIGURATION AND HALL BE CONSIDERED TO BE MINIMUM DIMENSIONS. THE DIMENSIONS MAY BE MODIFIED AS NECESSARY FOR "SPILL" CURB AND GUTTER, BUT SHALL NOT BE LESS THAN THE DIMENSIONS SHOWN.
- 43) CLOSURE OF THE INTERSECTIONS AT STA. 1243+00 (COLD SPRINGS RD.), 1267+23 (SHONNA AVE.), 1299+50 (S. 4TH STREET), AND STA. 1341+20 (MAGNOLIA AVE.) SHALL BE LIMITED TO 14 CALENDAR DAYS.
- 44) ASPHALT MILLING / PAVING OPERATIONS
A. STA. 970+00 (BOP) TO STA. 991+00 - MILL AND OVERLAY THE ENTIRE ROADWAY, SHOULDERS, S.R. 589 INTERSECTION, S.R. 590 INTERSECTION, AND CROSS OVERS.
B. STA. 991+00 - STA. 1023+00 - MILL AND OVERLAY THE ENTIRE ROADWAY (30' NB & SB) ONLY. FOG SEAL THE NB OUTSIDE SHOULDER.
C. STA. 1023+00 - STA. 1212+00 - MILL AND OVERLAY THE ENTIRE ROADWAY (30' NB & SB) ONLY. FOG SEAL THE NB OUTSIDE SHOULDER.
D. STA. 1212+00 - STA. 1236+00 - OMITTED SECTION
E. STA. 1236+00 - STA. 1367+50 - MILL AND OVERLAY THE ENTIRE ROADWAY (30' NB & SB), MEDIAN CROSSOVERS, AND MEDIAN LEFT TURN LANES. FOG SEAL THE NB & SB OUTSIDE SHOULDERS.
F. STA. 1367+50 - STA. 1401+66 (EOP) - MILL AND OVERLAY THE ENTIRE ROADWAY, SHOULDERS, LOCAL ROADS, US 84 RAMPS/LOOPS INDICATED ON THE PLANS, AND CROSSOVERS.

GENERAL NOTES (CONT.)

1/12/2021 1:28 PM (703) GENERAL NOTES (SG)_DGN PLAN DIVISION ROADWAY MISSISSIPPI DEPARTMENT OF TRANSPORTATION

					BY	MISSISSIPPI DEPARTMENT OF TRANSPORTATION	
					REVISION	GENERAL NOTES	
					DATE	PROJ. NO.: STP-0008-02(116) HSIP-0008-02(120) COUNTY: COVINGTON	
					FILE NAME:	WORKING NUMBER GN-2	
					DESIGN TEAM	CHECKED	DATE
						SHEET NUMBER 4	

