

STATE	PROJECT NUMBER	SHEET NO.
MISSISSIPPI	SP-0050-01(040)	1

GENERAL INDEX

INCLUDED THIS PROJECT	BEGIN WITH SHEET
<input checked="" type="checkbox"/> ROADWAY	1
<input type="checkbox"/> PERMANENT SIGNS	1001
<input type="checkbox"/> TRAFFIC SIGNALS	2001
<input type="checkbox"/> ITS COMPONENTS	3001
<input type="checkbox"/> LIGHTING	4001
<input type="checkbox"/> (RESERVED)	5001
<input checked="" type="checkbox"/> ROADWAY STANDARD DWGS	6001
<input type="checkbox"/> BOX CULVERT STD. DRAWINGS (LRFD)	7001
<input type="checkbox"/> BOX CULVERT STD. DRAWINGS (STD. SPEC.)	7501
<input type="checkbox"/> BRIDGE	8001
<input type="checkbox"/> CROSS SECTIONS	9001

STATE OF MISSISSIPPI

MISSISSIPPI DEPARTMENT OF TRANSPORTATION

PLAN AND PROFILE OF PROPOSED STATE HIGHWAY
STATE PROJECT NO. SP-0050-01(040)

SR 9 FM CALHOUN CL TO OWEN BEND DRIVE
PONTOTOC COUNTY

FMS CON. NO. 108653 / 301000

BRIDGE STRUCTURES REQ'D.
NONE

BOX BRIDGES REQ'D.
NONE

SCALES

PLAN	1 IN. = 100 FT.
PROFILE	HOR. 1 IN. = 100 FT.
	VERT. 1 IN. = 10 FT.
LAYOUT	1 IN. = FT.

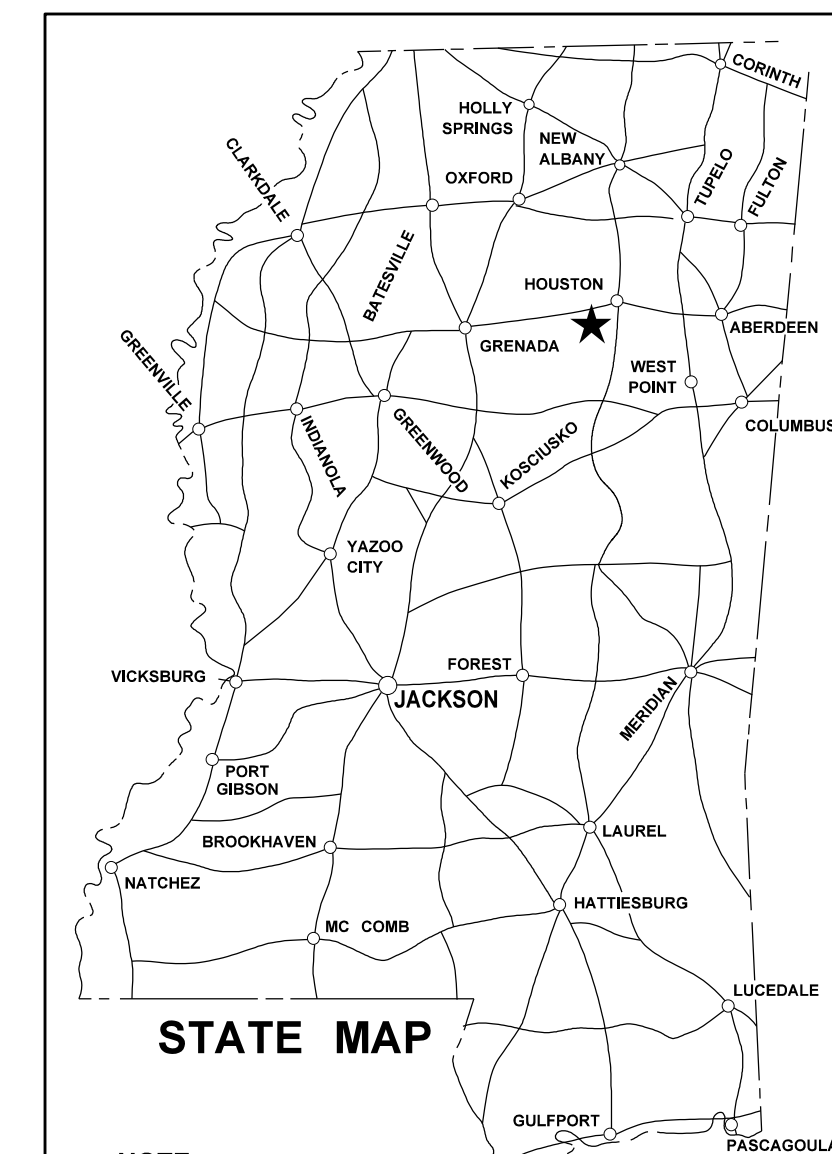

NOTE
 * INDICATES APPROXIMATE LOCATION OF PROJECT.
 LAT. 34°12' 38.76" LONG. -89°08' 17.58"
 (APPROX. MIDDLE OF PROJECT)

DESIGN CONTROL

MPH = V (SPEED DESIGN)

ADT () = : ADT () =

DHW = : D = % T = %

PERMITS ACQUIRED BY MDOT

WETLANDS AND WATERS PERMITS		
	WATERS	WETLANDS
NATIONWIDE #14	<input checked="" type="checkbox"/>	<input checked="" type="checkbox"/>
NATIONWIDE (OTHER)*	<input checked="" type="checkbox"/>	<input checked="" type="checkbox"/>
GENERAL*	<input checked="" type="checkbox"/>	<input checked="" type="checkbox"/>
INDIVIDUAL (404)*	<input checked="" type="checkbox"/>	<input checked="" type="checkbox"/>
STORMWATER PERMIT <input checked="" type="checkbox"/>		
Y	REQUIRED, CNOI SUBMITTED BY MDOT (DISTURBED AREA = 5 ACRES)	
S	REQUIRED, SCNOI TO BE SUBMITTED BY CONTRACTOR (1 TO 4.99 ACRES)	
N	NO STORMWATER PERMIT REQUIRED (<1 ACRE)	
APPROVED BY: _____		

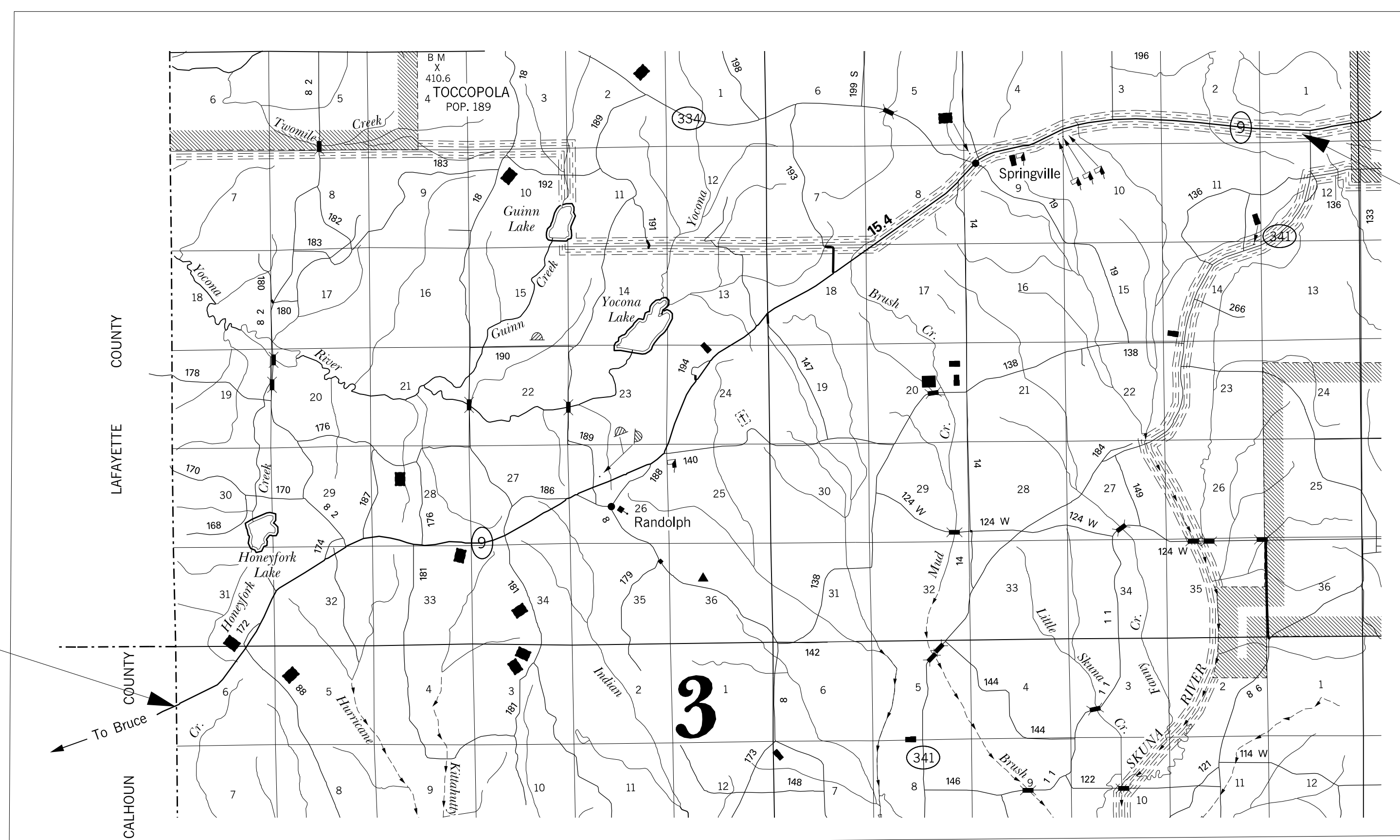

B.O.P. 6+50

CONVENTIONAL SYMBOLS

COUNTY LINE	-----
TOWN CORPORATION LINE	-----
SECTION LINE	-----
EXISTING ROAD OR TRAVELED WAY	-----
PROPOSED ROAD OR TRAVELED WAY	-----
RAILROAD	-----
SURVEY LINE	-----
BRIDGES	-----

LENGTH DATA

LENGTH OF ROADWAY	70,887	FT.	13.426	MI.
LENGTH OF BRIDGES	0	FT.	0	MI.
LENGTH OF PROJECT (NET)			13.426	MI.
LENGTH OF EXCEPTIONS	0	FT.	0	MI.
LENGTH OF PROJECT (GROSS)			13.426	MI.

EQUATIONS
NONE

EXCEPTIONS
NONE

P S & E DATE: 3/24/2021

APPROVED: _____
 DEPUTY EXECUTIVE DIRECTOR / CHIEF ENGINEER

 EXECUTIVE DIRECTOR



3/11/2021 11:02 AM TITLE SHEET

DIGOUTS	
LEFT LANE	RIGHT LANE
20+50 (55' X 8')	39+00 (15' X 8')
42+00 (15' X 8')	293+00 (125' X 12')
439+75 (150' X 6')	300+85 (25' X 6')
473+10 (80' X 10')	303+20 (40' X 6')
483+00 (245' X 8')	509+50 (15' X 6')
535+50 (85' X 6')	536+40 (100' X 6')
550+00 (200' X 10')	560+00 (75' X 10')
	562+00 (75' X 10')
	564+00 (75' X 10')
	618+50 (75' X 8')

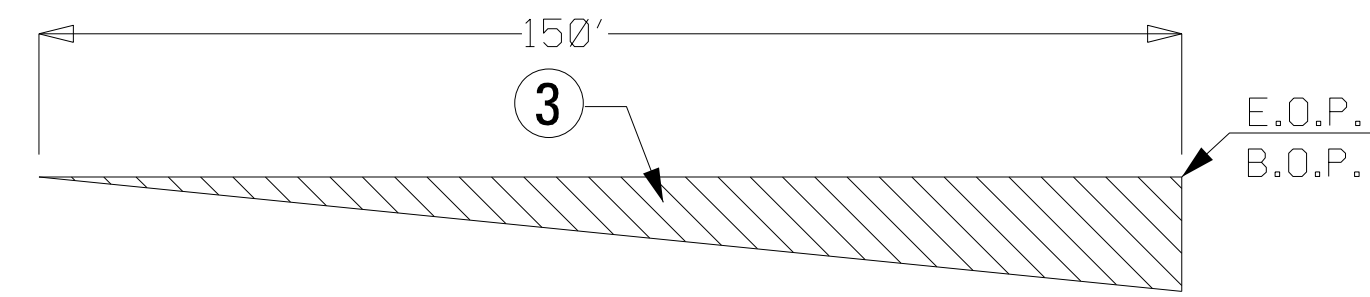

TYPICAL MILLING DETAIL

B.O.P. STATION 6+50 TO 10+00
E.O.P. STATION 715+37

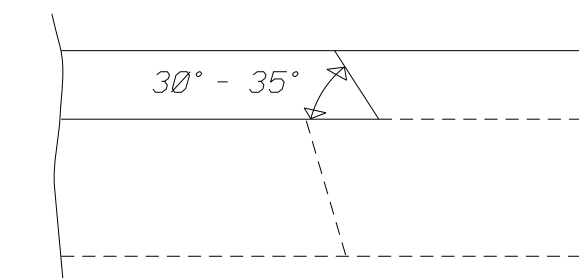

SAFETY EDGE REQUIRED
(NOT A PAY ITEM)

SAFETY EDGE DETAIL

- ① REMOVE AND UNDERCUT FAILED AREAS AS DIRECTED BY THE ENGINEER. REMOVAL OF ASPHALT PAVEMENT TO BE PAID FOR UNDER PAY ITEM 202-B007. UNDERCUT TO A DEPTH OF 3 FT BELOW FINISHED GRADE. BACKFILL WITH CRUSHED STONE TO A DEPTH OF 1 FT BELOW FINISHED GRADE. REMOVAL OF UNDERCUT MATERIAL TO BE PAID FOR UNDER PAY ITEM NO. 203-G001, EXCESS EXCAVATION (FM) (AH). BACKFILL WITH 9.5 MM, ST, ASPHALT PAVEMENT PAY ITEM NO. 403-A015 TO A MAXIMUM DEPTH OF 1 FT.
- ② SCRUB SEAL PAY ITEM NO. 907-414-A001. TEMPORARY RAISED MARKERS REQUIRED IN ACCORDANCE WITH MUTCD THE COST OF WHICH SHALL BE ABSORBED IN THE SCRUB SEAL ITEM.
- ③ 1½" & VAR. FINE MILLING OF BITUMINOUS PAVEMENT. PAY ITEM NO. 406-D001.
- ④ PRELIMINARY PATCHING AND LEVELING REQUIRED AS DIRECTED BY ENGINEER.
- ⑤ 1½" & VAR. 9.5 MM, ST ASPHALT PAVEMENT, PAY ITEM NO. 304-A015.
- ⑥ GRANULAR MATERIAL (CL. 3 GP. C) REQUIRED ON SHOULDER AS DIRECTED BY THE ENGINEER. PAY ITEM NO. 304-A002.
- ⑦ RUMBLE STRIPE

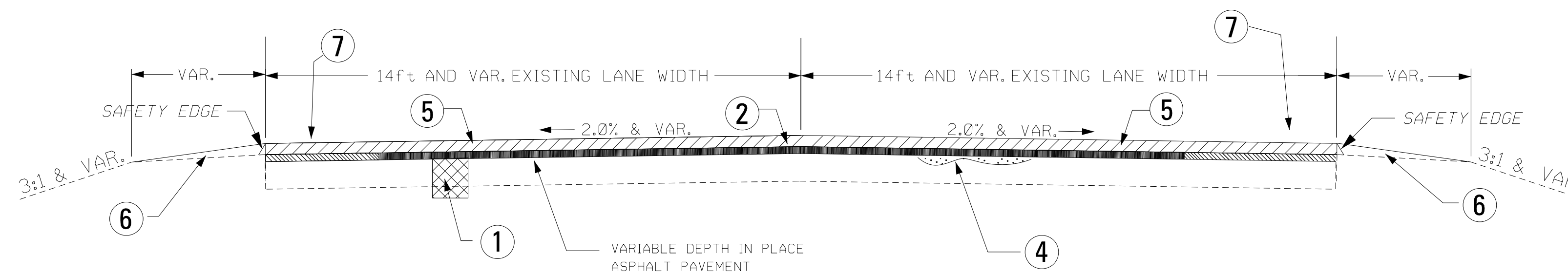

TYPICAL SECTION 2-LANE

STA. 6+50 TO STA. 715+37

GENERAL NOTES

ALL HIGH JOINTS TO BE CLIPPED AS DIRECTED BY THE ENGINEER (NOT A PAY ITEM).

PRIOR TO PLACING ANY BITUMINOUS PAVEMENT AND FINE MILLING, THE EXISTING SHOULDERS ARE TO BE BLADED FOR A MINIMUM OF 1' BEYOND THE EDGE OF THE EXISTING PAVEMENT TO REMOVE VEGETATION AND EXCESS SHOULDER MATERIAL (NOT A PAY ITEM).

EXISTING RAISED PAVEMENT MARKERS TO BE REMOVED PRIOR TO PLACEMENT OF SCRUB SEAL AND ASPHALT PAVEMENT. (NOT A PAY ITEM).

TEMPORARY TRANSVERSE JOINTS SHALL BE INSTALLED PRIOR TO LEAVING THE PROJECT EACH DAY WITH A MINIMUM LENGTH OF 3" FOR EACH 1" OF THICKNESS.

WHERE TREE ROOTS ARE ENCOUNTERED IN DIGOUTS, SOIL STERILIZATION PELLETS WILL BE REQUIRED PRIOR TO BACKFILLING THE AREA (NOT A PAY ITEM).

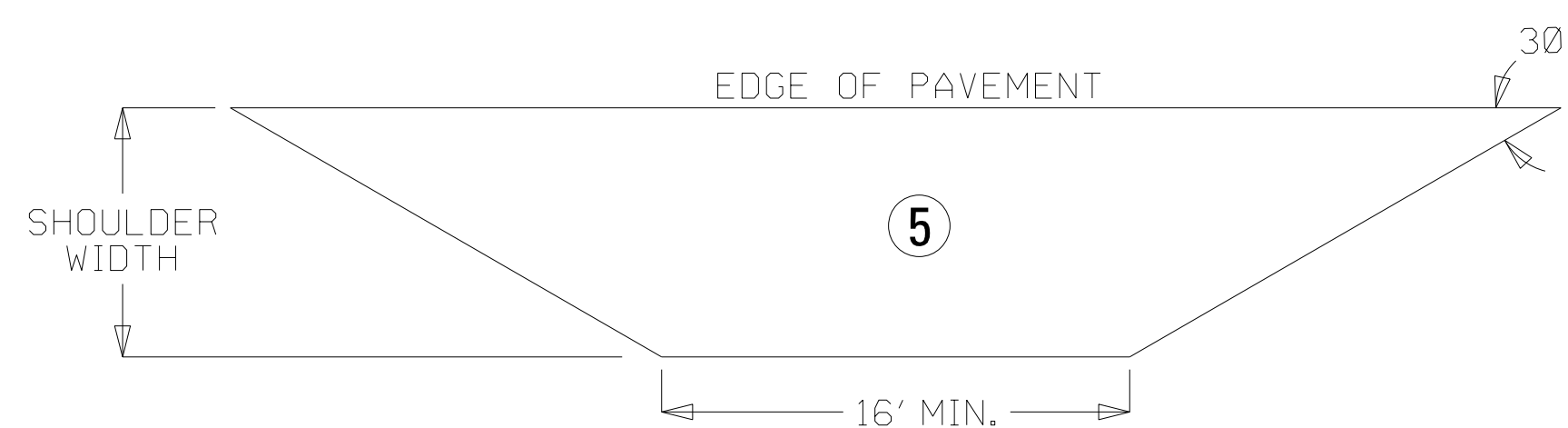

DETAIL OF RAMP APRON

IN AREAS WITH CONCRETE ISLANDS, PAVE TO THE BACK OF THE ISLAND.

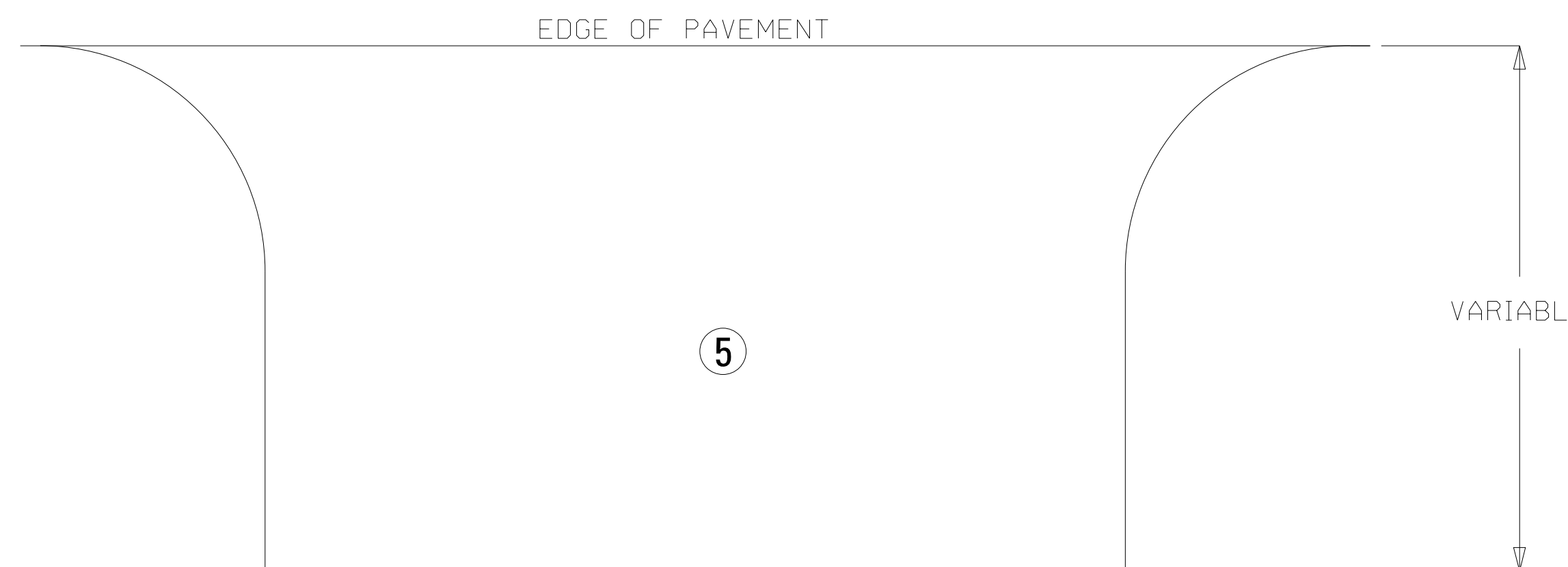

DETAIL FOR LOCAL ROAD TURNOUTS

BY		MISSISSIPPI DEPARTMENT OF TRANSPORTATION	
REVISION		TYPICAL SECTION MILLING & OVERLAY	
DATE		PROJECT NO.: SP-0050-01(040) COUNTY: PONTOTOC	
DESIGN TEAM		SCALE: NTS	
CHECKED		WORKING NUMBER TS-1	
DATE		SHEET NUMBER 3	

