

STATE	PROJECT NUMBER	SHEET NO.
MISSISSIPPI	SP-0051-04(010)	1

GENERAL INDEX

INCLUDED THIS PROJECT	BEGIN WITH SHEET
<input checked="" type="checkbox"/> ROADWAY	1
<input type="checkbox"/> PERMANENT SIGNS	1001
<input type="checkbox"/> TRAFFIC SIGNALS	2001
<input type="checkbox"/> ITS COMPONENTS	3001
<input type="checkbox"/> LIGHTING	4001
<input type="checkbox"/> (RESERVED)	5001
<input checked="" type="checkbox"/> ROADWAY STANDARD DWGS	6001
<input type="checkbox"/> BOX CULVERT STD. DRAWINGS (LRFD)	7001
<input type="checkbox"/> BOX CULVERT STD. DRAWINGS (STD. SPEC.)	7501
<input type="checkbox"/> BRIDGE	8001
<input type="checkbox"/> CROSS SECTIONS	9001

STATE OF MISSISSIPPI
MISSISSIPPI DEPARTMENT OF TRANSPORTATION

PLAN AND PROFILE OF PROPOSED STATE HIGHWAY
STATE PROJECT NO. SP-0051-04(010)

SR 32 FROM SR 15 TO SR 245
CHICKASAW COUNTY

FMS CON. NO. 108198 / 301000

BRIDGE STRUCTURES REQ'D.

3

BOX BRIDGES REQ'D.

NONE

SCALES

PLAN 1 IN. = 100 FT.
PROFILE { **HOR.** 1 IN. = 100 FT.
 VERT. 1 IN. = 10 FT.
LAYOUT 1 IN. = FT.

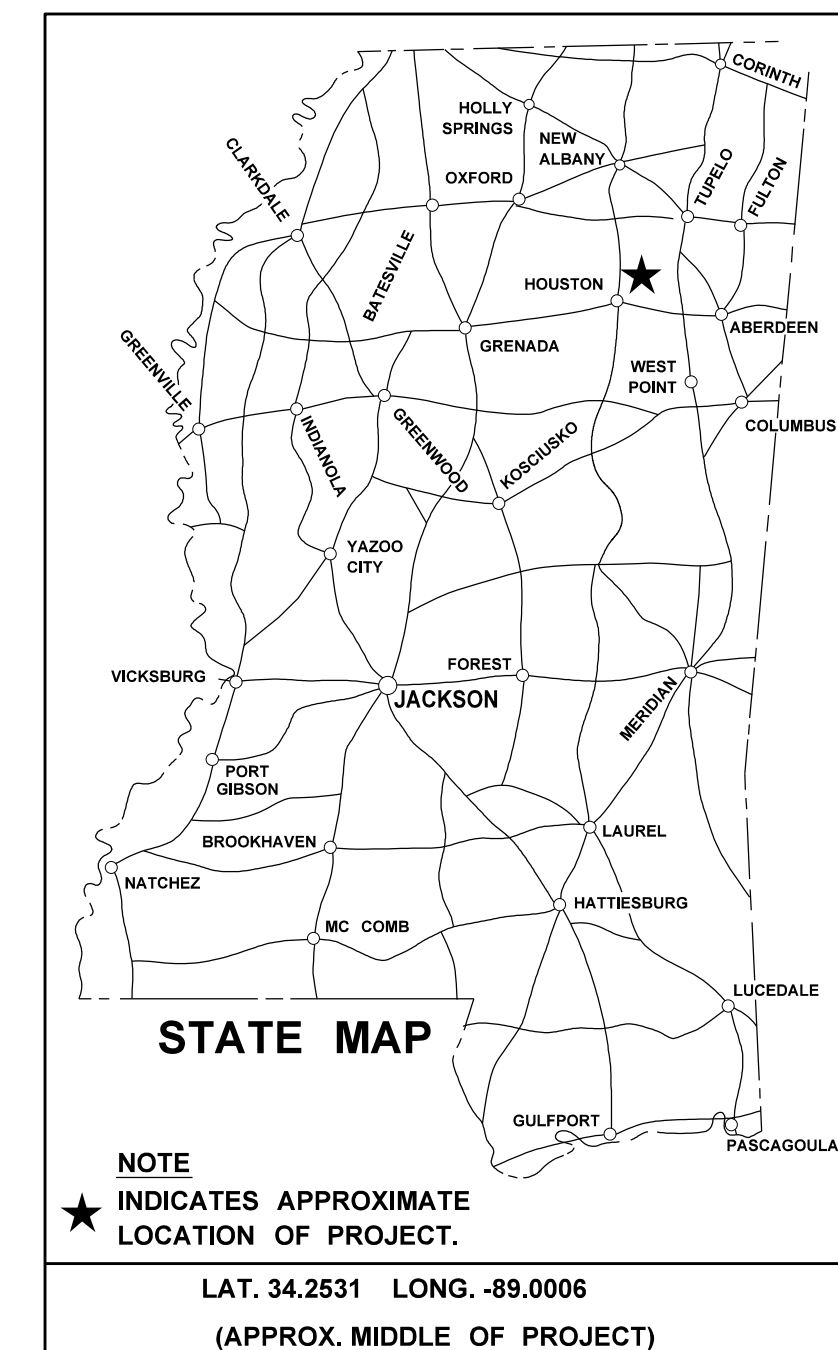

DESIGN CONTROL		
MPH = V (SPEED DESIGN)		
ADT () = :	ADT () = :	
DHV = :	D = %	T = %
PERMITS ACQUIRED BY MDOT		
WETLANDS AND WATERS PERMITS		
	WATERS	WETLANDS
NATIONWIDE #14	<input checked="" type="checkbox"/>	<input checked="" type="checkbox"/>
NATIONWIDE (OTHER)*	<input checked="" type="checkbox"/>	<input checked="" type="checkbox"/>
GENERAL*	<input checked="" type="checkbox"/>	<input checked="" type="checkbox"/>
INDIVIDUAL (404)*	<input checked="" type="checkbox"/>	<input checked="" type="checkbox"/>
STORMWATER PERMIT <input checked="" type="checkbox"/>		
Y	REQUIRED, (CND) SUBMITTED BY MDOT (DISTURBED AREA = 5 ACRES)	
S	REQUIRED, (SCN) TO BE SUBMITTED BY CONTRACTOR (1 TO 4.99 ACRES)	
N	NO STORMWATER PERMIT REQUIRED (<1 ACRE)	
APPROVED BY: _____		

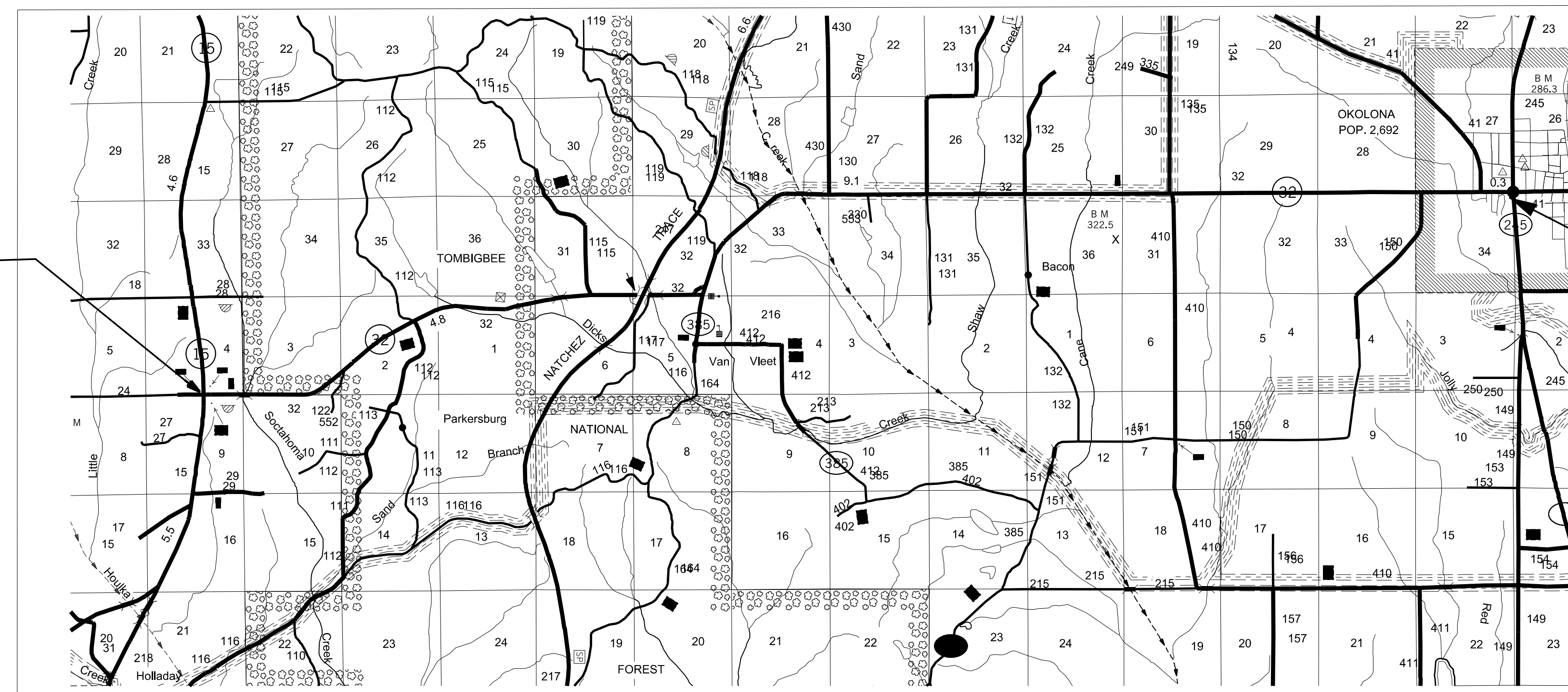

B.O.P. 10+00

E.O.P. 154+50

CONVENTIONAL SYMBOLS

COUNTY LINE	-----
TOWN CORPORATION LINE	-----
SECTION LINE	-----
EXISTING ROAD OR TRAVELED WAY	-----
PROPOSED ROAD OR TRAVELED WAY	-----
RAILROAD	-----
SURVEY LINE	-----
BRIDGES	-----

LENGTH DATA

LENGTH OF ROADWAY	73,136	FT.	13.852	MI.
LENGTH OF BRIDGES	714	FT.	0.135	MI.
LENGTH OF PROJECT (NET)			13.987	MI.
LENGTH OF EXCEPTIONS	0	FT.	0	MI.
LENGTH OF PROJECT (GROSS)			13.987	MI.

EQUATIONS
NONE

EXCEPTIONS
NONE

P S & E DATE: 3/24/2021

APPROVED: _____
DEPUTY EXECUTIVE DIRECTOR / CHIEF ENGINEER

EXECUTIVE DIRECTOR



3/15/2021 9:06 AM TITLE SHEET MISSISSIPPI DEPARTMENT OF TRANSPORTATION

DIGOUTS	
LEFT LANE	RIGHT LANE
STA 207+00 (50X14)	STA. 100+40 (60X14)
STA 274+00 (80X14)	STA 102+00 (70X14)
STA 324+00 (40X14)	STA 207+00 (50X14)
STA. 333+40 (160X14)	STA 274+00 (80X14)
STA. 520+50 (50X14)	STA. 315+00 (75X14)
STA. 542+00 (100X14)	STA. 520+50 (50X14)
STA. 560+00 (60X14)	STA. 542+00 (100X14)
STA. 718+60 (60X14)	STA. 560+00 (60X14)
	STA. 718+60 (60X14)

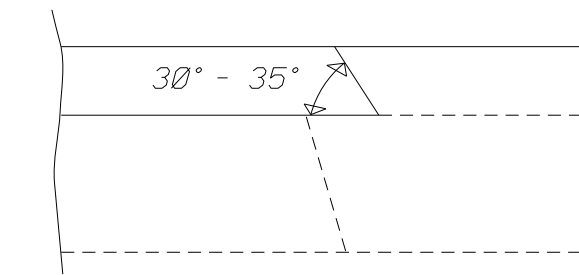

SAFETY EDGE REQUIRED
(NOT A PAY ITEM)
SAFETY EDGE DETAIL

- ① REMOVE AND UNDERCUT FAILED AREAS AS DIRECTED BY THE ENGINEER. REMOVAL OF ASPHALT PAVEMENT TO BE PAID FOR UNDER PAY ITEM 202-B007. UNDERCUT TO A DEPTH OF 3 FT BELOW FINISHED GRADE. BACKFILL WITH CRUSHED STONE TO A DEPTH OF 1 FT BELOW FINISHED GRADE WITH GEOGRID, TYPE II, BIAXIAL PAY ITEM NO. 204-A003 AND GEOTEXTILE STABILIZATION, TYPE VII, NON-WOVEN PAY ITEM NO. 209-A009 UNDERNEATH. REMOVAL OF UNDERCUT MATERIAL TO BE PAID FOR UNDER PAY ITEM NO. 203-G001, EXCESS EXCAVATION (FMXAH). BACKFILL WITH 9.5 MM, MT, ASPHALT PAVEMENT PAY ITEM NO. 403-A014 TO A MAXIMUM DEPTH OF 1 FT.
- ② PRELIMINARY PATCHING AND LEVELING REQUIRED AS DIRECTED BY ENGINEER.
- ③ 1½" & VAR. FINE MILLING OF BITUMINOUS PAVEMENT. PAY ITEM NO. 406-D001.
- ④ GRANULAR MATERIAL (CL. 3 GP. C) REQUIRED ON SHOULDER AS DIRECTED BY THE ENGINEER. PAY ITEM NO. 304-A002.
- ⑤ 1½" & VAR. 9.5 MM, MT, ASPHALT PAVEMENT PAY ITEM NO. 403-A014.
- ⑥ RUMBLE STRIPE

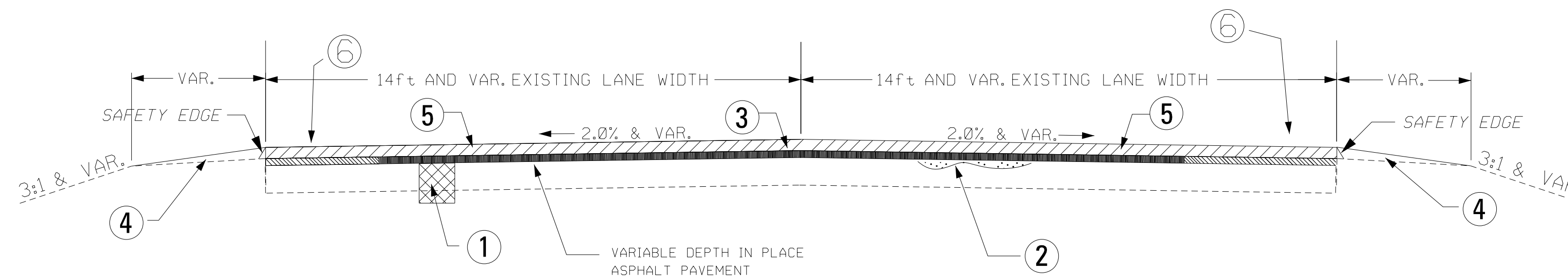

TYPICAL SECTION 2-LANE

STA. 10+00 TO STA. 748+50

GENERAL NOTES

ALL HIGH JOINTS TO BE CLIPPED AS DIRECTED BY THE ENGINEER (NOT A PAY ITEM).

PRIOR TO PLACING ANY BITUMINOUS PAVEMENT AND FINE MILLING, THE EXISTING SHOULDERS ARE TO BE BLADED FOR A MINIMUM OF 1' BEYOND THE EDGE OF THE EXISTING PAVEMENT TO REMOVE VEGETATION AND EXCESS SHOULDER MATERIAL (NOT A PAY ITEM).

EXISTING RAISED PAVEMENT MARKERS TO BE REMOVED PRIOR TO PLACEMENT OF ASPHALT PAVEMENT. (NOT A PAY ITEM).

TEMPORARY TRANSVERSE JOINTS SHALL BE INSTALLED PRIOR TO LEAVING THE PROJECT EACH DAY WITH A MINIMUM LENGTH OF 3" FOR EACH 1" OF THICKNESS

NO ADDITIONAL COMPENSATION SHALL BE MADE FOR INSTANCES WHERE CONCRETE IS ENCOUNTERED DURING MILLING OPERATIONS. ALL COSTS INCURRED FOR THIS IS TO BE ABSORBED IN OTHER PAY ITEMS.

ALL DIGOUTS MUST BE COMPLETED PRIOR TO BEGINNING OF MILLING OPERATIONS.

SOME LEVELING MAY BE REQUIRED AFTER MILLING AND BEFORE PLACEMENT OF SURFACE LIFT.

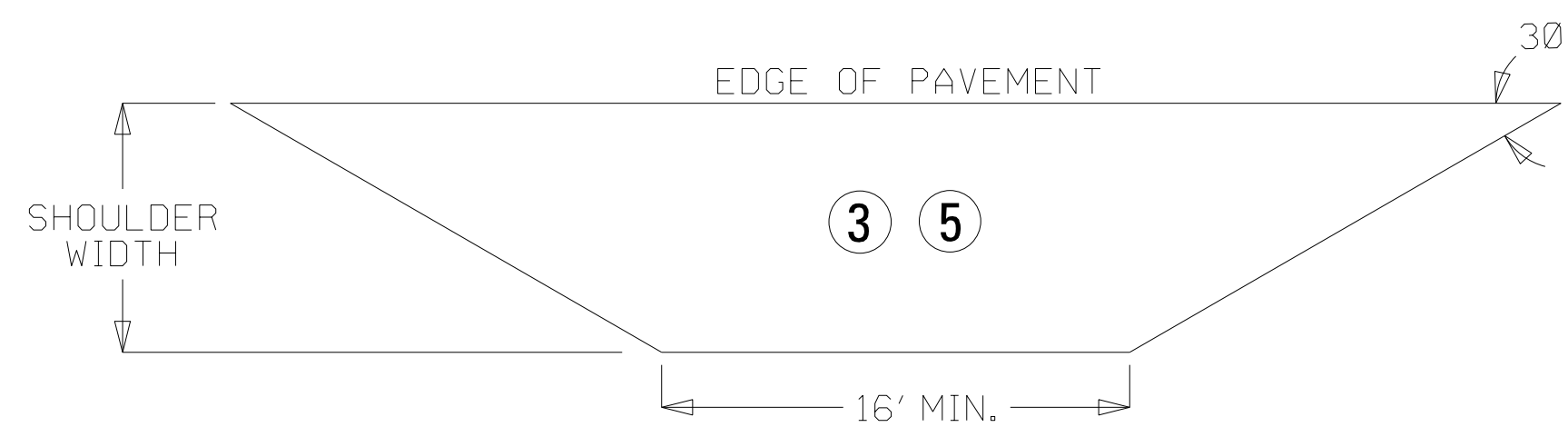

DETAIL OF RAMP APRON

IN AREAS WITH CONCRETE ISLANDS, PAVE TO THE BACK OF THE ISLAND.

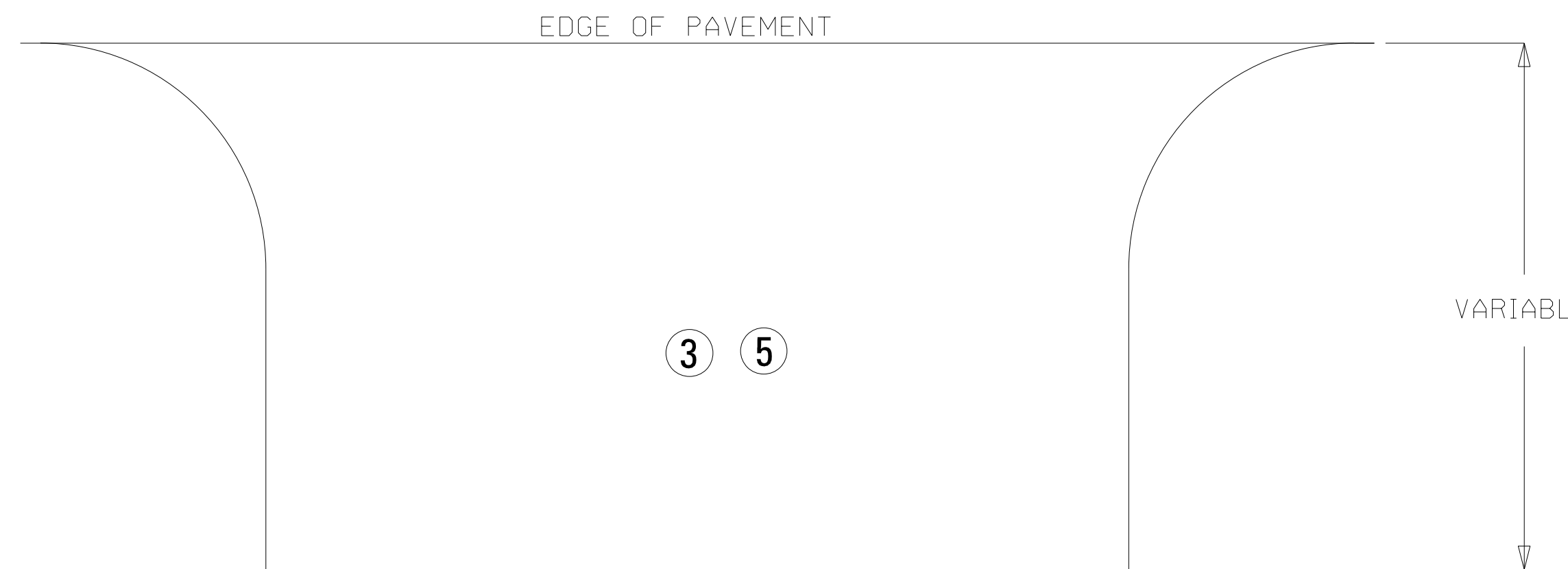

DETAIL FOR LOCAL ROAD TURNOUTS

MISSISSIPPI DEPARTMENT OF TRANSPORTATION TYPICAL SECTION MILLING & OVERLAY		
PROJECT NO.: SP-0051-04(010) COUNTY: CHICKASAW SCALE: NTS		
6/28/21 DATE	JH BY	WORKING NUMBER TS-1
FILENAME: TS-1.DGN	CHECKED: _____ DATE: _____	SHEET NUMBER 3

