

|             |                  |           |
|-------------|------------------|-----------|
| STATE       | PROJECT NUMBER   | SHEET NO. |
| MISSISSIPPI | STP-0179-00(021) | 1         |

**GENERAL INDEX**

| INCLUDED THIS PROJECT   | BEGIN WITH SHEET |
|---|------------------|
| <input checked="" type="checkbox"/> ROADWAY .....                     | 1                |
| <input type="checkbox"/> PERMANENT SIGNS .....                        | 1001             |
| <input type="checkbox"/> TRAFFIC SIGNALS .....                        | 2001             |
| <input type="checkbox"/> ITS COMPONENTS .....                         | 3001             |
| <input type="checkbox"/> LIGHTING .....                               | 4001             |
| <input type="checkbox"/> (RESERVED) .....                             | 5001             |
| <input checked="" type="checkbox"/> ROADWAY STANDARD DWGS .....       | 6001             |
| <input type="checkbox"/> BOX CULVERT STD. DRAWINGS (LRFD) .....       | 7001             |
| <input type="checkbox"/> BOX CULVERT STD. DRAWINGS (STD. SPEC.) ..... | 7501             |
| <input type="checkbox"/> BRIDGE .....                                 | 8001             |
| <input type="checkbox"/> CROSS SECTIONS .....                         | 9001             |

**BRIDGE STRUCTURES REQ'D.**

**BOX BRIDGES REQ'D.**

**STATE OF MISSISSIPPI**

**MISSISSIPPI DEPARTMENT OF TRANSPORTATION**

**PLAN AND PROFILE OF PROPOSED STATE HIGHWAY FEDERAL PROJECT NO. STP-0179-00(021)**

SR 44  
PIKE COUNTY LINE EAST 2.8 MILES TO JCT SR 583  
WALTHALL COUNTY

FMS CON. NO. 108382/ 302000

**SCALES**  
PLAN 1 IN. = 100 FT.  
PROFILE { HOR. 1 IN. = 100 FT.  
          VERT. 1 IN. = 10 FT.  
LAYOUT 1 IN. = 2,710 FT.

R-9-E | R-10-E

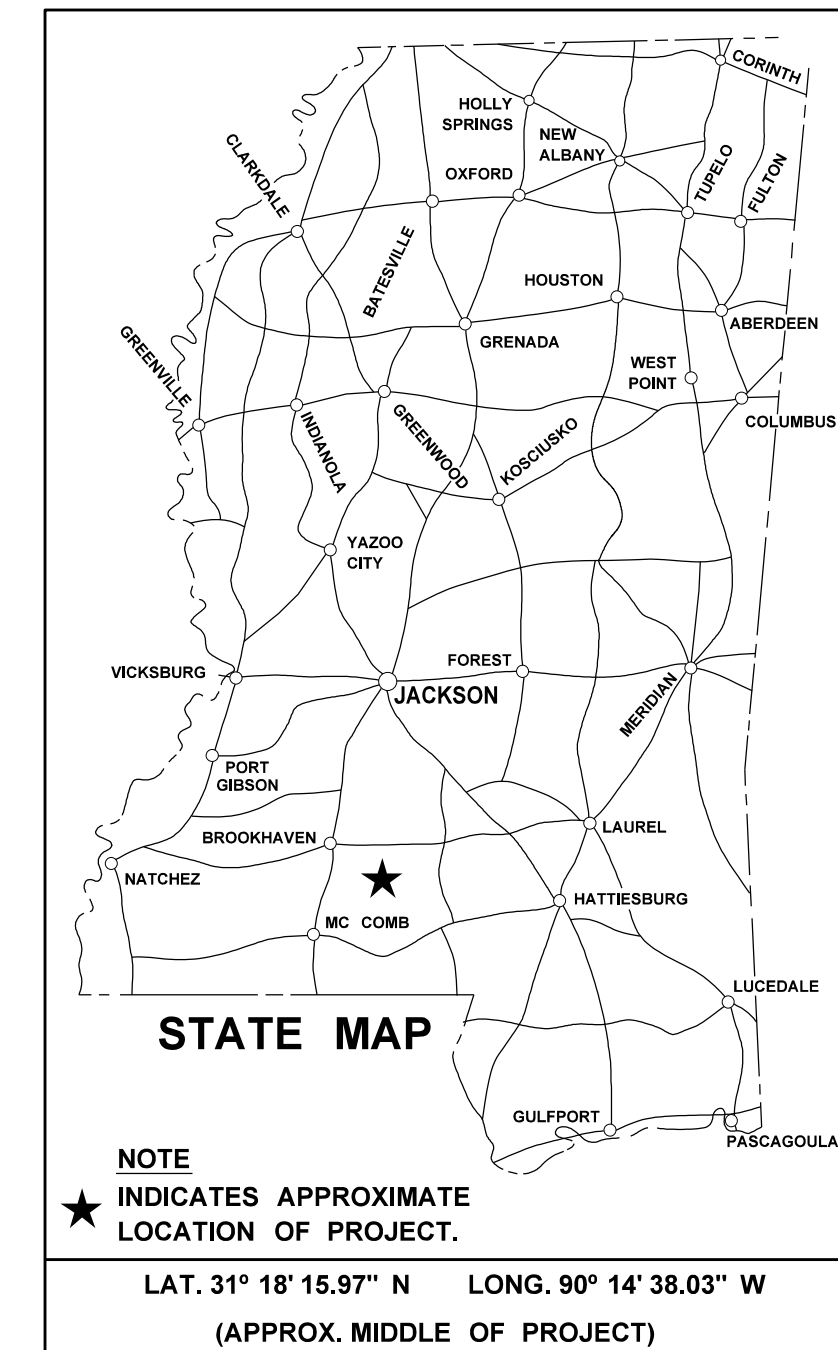
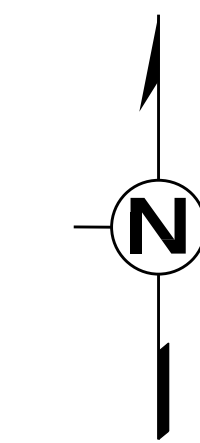

**DESIGN CONTROL**

MPH = V (SPEED DESIGN)

ADT ( ) = : ADT ( ) =

DH = : D = % T = %

**PERMITS ACQUIRED BY MDOT**

| WETLANDS AND WATERS PERMITS |                          |                          |
|-----------------------------|--------------------------|--------------------------|
|                             | WATERS                   | WETLANDS                 |
| NATIONWIDE #14              | <input type="checkbox"/> | <input type="checkbox"/> |
| NATIONWIDE (OTHER)*         | <input type="checkbox"/> | <input type="checkbox"/> |
| GENERAL*                    | <input type="checkbox"/> | <input type="checkbox"/> |
| INDIVIDUAL (404)*           | <input type="checkbox"/> | <input type="checkbox"/> |

**STORMWATER PERMIT**

Y REQUIRED, CNDI SUBMITTED BY MDOT (DISTURBED AREA = 5 ACRES)

S REQUIRED, SCNDI TO BE SUBMITTED BY CONTRACTOR (1 TO 4.99 ACRES)

N NO STORMWATER PERMIT REQUIRED (<1 ACRE)

APPROVED BY: \_\_\_\_\_

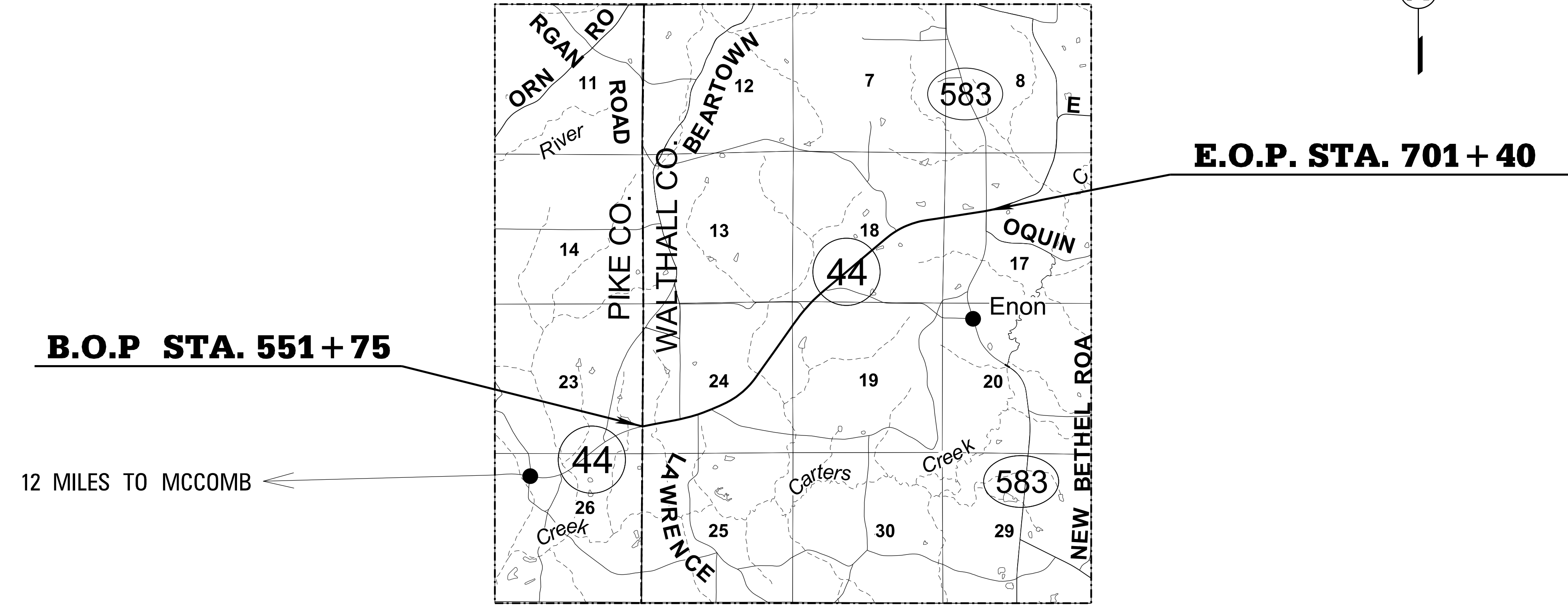

12 MILES TO MCCOMB ←

R-9-E | R-10-E

**CONVENTIONAL SYMBOLS**

- COUNTY LINE .....
- TOWN CORPORATION LINE .....
- SECTION LINE .....
- EXISTING ROAD OR TRAVELED WAY .....
- PROPOSED ROAD OR TRAVELED WAY .....
- RAILROAD .....
- SURVEY LINE .....
- BRIDGES .....

**EQUATIONS**

**LENGTH DATA**

|                           |               |           |
|---------------------------|---------------|-----------|
| LENGTH OF ROADWAY         | 14,965.00 FT. | 2.834 MI. |
| LENGTH OF BRIDGES         | FT.           | MI.       |
| LENGTH OF PROJECT (NET)   | 14,965.00 FT. | 2.834 MI. |
| LENGTH OF EXCEPTIONS      | FT.           | MI.       |
| LENGTH OF PROJECT (GROSS) | 14,965.00 FT. | 2.834 MI. |

**EXCEPTIONS**

5/20/2021 9:32:00 AM 011 TITLE SHEET.DGN



P S & E DATE: 05/13/21

APPROVED: \_\_\_\_\_

DEPUTY EXECUTIVE DIRECTOR / CHIEF ENGINEER

EXECUTIVE DIRECTOR

**MDOT**  
MISSISSIPPI DEPARTMENT OF TRANSPORTATION



|       |                  |
|-------|------------------|
| STATE | PROJECT NO.      |
| MISS. | STP-0179-00(021) |

GENERAL NOTES

- ① THE LOCATION AND SPACING OF SIGNS, SHOWN ON THE TRAFFIC CONTROL PLANS, ARE APPROXIMATE AND MAY BE ADJUSTED AS NECESSARY TO FIT FIELD CONDITIONS.
- ② ALL TRAFFIC CONTROL DEVICES ON THIS PROJECT SHALL COMPLY WITH PART VI OF THE MUTCD (LATEST EDITION).
- ③ ALL PLASTIC DRUMS SHALL HAVE A BALLASTING COLLAR MADE FROM RECYCLED TRUCK TIRES OR OTHER SUITABLE MATERIAL.
- ④ THE CONTRACTOR SHALL BE RESPONSIBLE FOR PROTECTING EXISTING STRUCTURES SUCH AS, BUT NOT LIMITED TO, PIPES, INLETS, APRONS, AND BRIDGES FROM DAMAGE WHICH MIGHT OCCUR DURING CONSTRUCTION. THE CONTRACTOR SHALL REPLACE OR REPAIR, AS DIRECTED BY THE ENGINEER, ANY STRUCTURES DAMAGED DURING THE LIFE OF THE CONTRACT. NO PAYMENT WILL BE MADE FOR REPLACEMENT OR REPAIR OF DAMAGED ITEMS.
- ⑤ FLUORESCENT ORANGE SHEETING SHALL BE USED ON ALL CONSTRUCTION AND TRAFFIC CONTROL SIGNS EXCEPT FOR THOSE DESIGNATED ON THE PLANS TO BE BLACK LEGEND AND BORDER ON WHITE BACKGROUND.
- ⑥ VEGETATIVE MATERIAL WILL BE REMOVED PRIOR TO PLACEMENT OF GRANULAR MATERIAL. THE COST OF WHICH SHALL BE ABSORBED IN OTHER ITEMS BID.
- ⑦ THE CONTRACTOR SHALL COVER ANY TEMPORARY TRAFFIC CONTROL SIGNS SHOWN IN THE TRAFFIC CONTROL PLAN THAT DO NOT APPLY TO THE CURRENT WORK OR PHASE.
- ⑧ REMOVAL OF RAISED PAVEMENT MARKERS THAT ARE IN CONFLICT WITH REQUIRED CONSTRUCTION IS NOT CONSIDERED A SEPARATE PAY ITEM. COST TO BE ABSORBED IN OTHER ITEMS BID.
- ⑨ WHERE MILLING IS REQUIRED, THE CONTRACTOR SHALL PROVIDE OUTLETS IN THE EXISTING SHOULDERS AT SUFFICIENT INTERVALS TO PREVENT POOLING OR STANDING WATER ON THE MILLED SURFACE, THE COST OF WHICH SHALL BE ABSORBED IN OTHER ITEMS BID.
- ⑩ TEMPORARY STRIPING SHALL CONFORM TO FINISHED STRIPE SPECIFICATIONS FOR ALIGNMENT, NEATNESS, AND STRAIGHTNESS.
- ⑪ ALL ADDENDA TO THESE PLANS WILL BE POSTED TO WWW.MDOT.MS.GOV UNDER THE PROPOSAL ADDENDA COLUMN. BIDDERS ARE ADVISED THAT HARD COPIES OF ANY ADDENDA FOR THIS PROJECT WILL NOT BE MAILED. IT IS THE BIDDER'S RESPONSIBILITY TO CHECK AND SEE IF ANY ADDENDA HAVE BEEN POSTED FOR THIS PROJECT.
- ⑫ STORAGE OF FLAMMABLE MATERIALS WILL NOT BE ALLOWED UNDER ANY BRIDGE STRUCTURES WITHOUT WRITTEN APPROVAL FROM THE PROJECT ENGINEER. SEE NOTICE TO BIDDERS ENTITLED "MATERIAL STORAGE UNDER BRIDGES" FOR MORE INFORMATION.
- ⑬ THE RETROREFLECTIVE SIGN SHEETING ON RIGID, TEMPORARY TRAFFIC CONTROL (ORANGE) SIGNS SHALL BE MINIMUM TYPE IX.
- ⑭ ALL SIGNS AND DELINEATORS THAT CONFLICT WITH THE CONSTRUCTION OF THIS PROJECT SHALL BE REMOVED AND RESET BY THE CONTRACTOR; COST TO BE ABSORBED IN OTHER PAY ITEMS.
- ⑮ TEMPORARY STRIPING SHALL BE REQUIRED AFTER MILLING, PRELIMINARY LEVELING, AND OVERLAYING OPERATIONS; TEMPORARY STRIPING SHALL BE PLACED IN THE SAME LOCATIONS AND LAYOUT AS PERMANENT STRIPE. ALL CENTERLINE, LANE LINES, EDGE LINES, AND NO-PASSING STRIPES THAT HAVE BEEN REMOVED DURING THE DAY'S OPERATIONS SHALL BE REPLACED WITH TEMPORARY STRIPE BEFORE WORK IS DISCONTINUED FOR THE DAY OR AS SOON THEREAFTER AS WEATHER CONDITIONS WILL PERMIT, EXCEPT THAT:
  - (1) REPLACEMENT OF NO-PASSING STRIPES MAY BE DELAYED FOR A PERIOD NOT TO EXCEED THREE (3) DAYS FOR A TWO OR THREE LANE ROAD
  - (2) TEMPORARY EDGE LINES ON PROJECTS REQUIRING SHOULDERS CONSTRUCTED OF GRANULAR MATERIAL MAY BE DELAYED FOR A PERIOD NOT TO EXCEED THREE (3) DAYS.
- ⑯ ALL ASPHALT AND CONCRETE CURBS ALONG RAMPS, LOCAL ROADS, ETC. FROM B.O.P. TO E.O.P. SHALL BE PAINTED ( TWO APPLICATIONS ) WITH WHITE TRAFFIC PAINT AND TRAFFIC BEADS ; COST TO BE ABSORBED IN OTHER PAY ITEMS.
- ⑰ IF THE ASPHALT CURB ALONG THE LOCAL ROAD IS SEVERELY DAMAGED, THE ENTIRE ASPHALT CURB WILL BE REMOVED AS DIRECTED BY THE ENGINEER; COST TO BE ABSORBED IN OTHER PAY ITEMS.
- ⑱ ALL LOCAL ROADS SHALL BE PAVED TO THE R.O.W. LIMITS OR AS DIRECTED BY THE ENGINEER.
- ⑲ GRANULAR MATERIAL WILL NOT BE ALLOWED TO BE PLACED DIRECTLY ON THE SURFACE LIFT OF ASPHALT, BUT MUST BE PLACED DIRECTLY ON THE GRAVEL SHOULDER OR A ROAD WIDENER MACHINE USED AND APPROVED BY THE PROJECT ENGINEER.
- ⑳ ALL RAMPS AND DRIVEWAY PADS SHALL BE PAVED TO THE SHOULDER LINE, MINIMUM OR FURTHER, AS DIRECTED BY THE ENGINEER WITHIN THE R.O.W. LIMITS.

GENERAL NOTES (CONT.)

- ㉑ TEMPORARY PAVEMENT JOINTS (PAPER JOINTS) SHALL BE EMPLOYED AT ALL LOCATIONS REQUIRING TRAFFIC TO TRAVERSE AN UNEVEN PAVEMENT JOINT. PAPER JOINTS SHALL BE A MINIMUM OF OF 9 FEET IN LENGTH AND SHALL BE ADEQUATELY MAINTAINED.
- ㉒ NO TEMPORARY CULVERT STREAM CROSSINGS WILL BE ALLOWED.
- ㉓ THE ASPHALT PAVING OPERATION SHALL BE COMPLETED IN THE FOLLOWING ORDER:  
 A: MILLING  
 B: PLACEMENT OF 19mm ALPHALT INLAY  
 C: PLACEMENT OF UTAP LEVELING ASPHALT  
 D: PLACEMENT OF 9.5mm ST ASPHALT

5/20/2021 9:32:02 AM 031 GN-1.DGN

|      |                         |   |            |
|------|-------------------------|---|------------|
|      |                         | MISSISSIPPI DEPARTMENT OF TRANSPORTATION        |            |
|      |                         | <b>GENERAL NOTES</b>                            |            |
|      |                         | PROJ. NO.: STP-0179-00(021)<br>COUNTY: WALTHALL |            |
|      |                         | WORKING NUMBER<br><b>GN-1</b>                   |            |
|      |                         | SHEET NUMBER                                    |            |
|      |                         | <b>3</b>  |            |
| DATE | FILE NAME: \031GN-1.dgn | DESIGN TEAM                                     | DISTRICT 7 |
|      |                         | CHECKED   | DATE       |

